

- LEGEND :
- WORKS BOUNDARY
 - PROPOSED HYDROSEEDING AREA
 - PROPOSED GABION BASE
 - PROPOSED PEDESTRIAN BRIDGE
 - TREE PROPOSED TO BE RETAINED
 - PROPOSED HEAVY STANDARD TREE

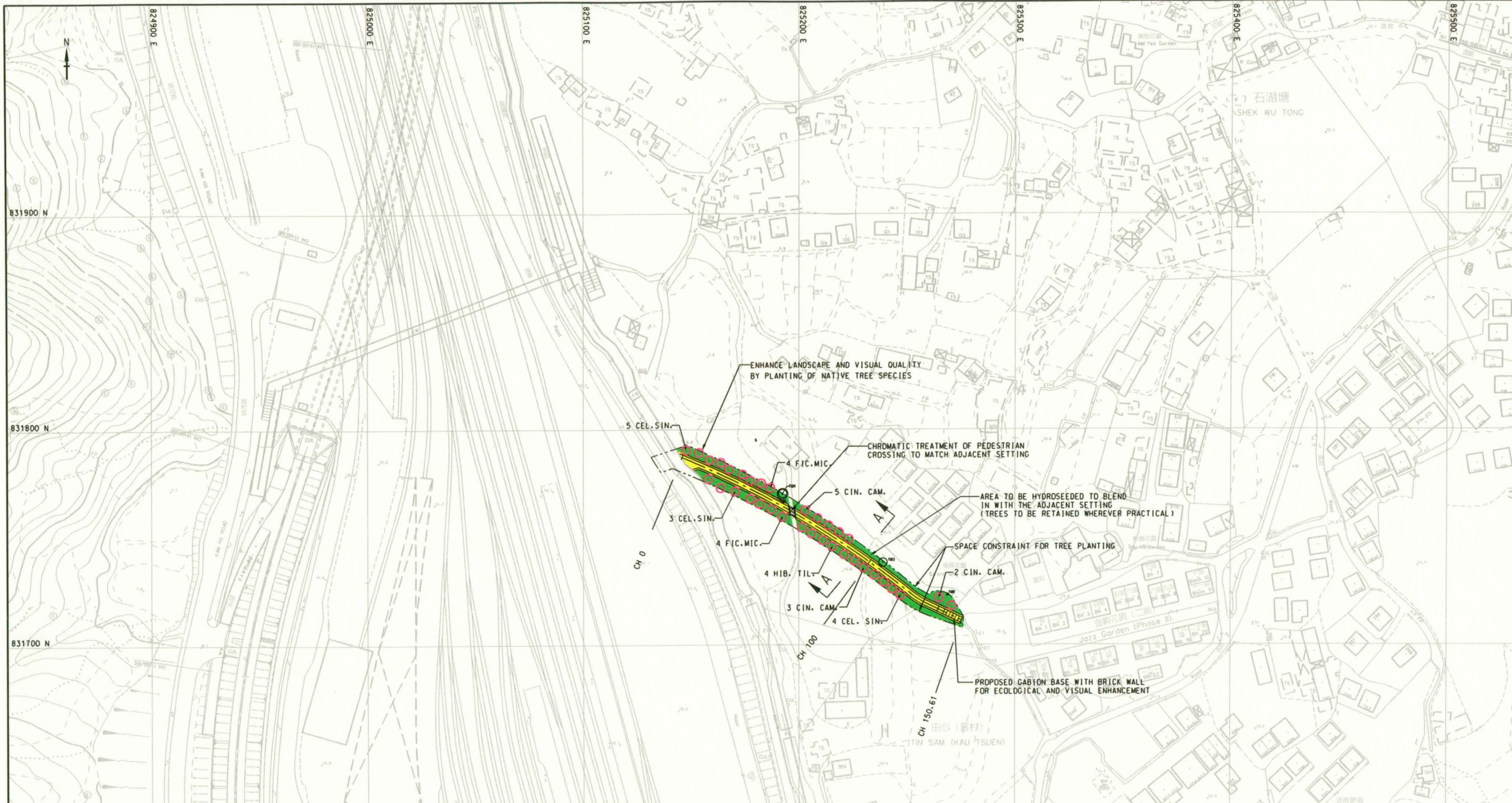

Revision	Date	GENERAL REVISION		
Initial	Designed	Checked	Drawn	Verified
	BW	JT	SC	JT
Date	8/05	8/05	8/05	8/05

Approved

AGREEMENT NO. CE 67/98

Contract title

YUEN LONG, KAM TIN, NGAU TAM MEI AND TIN SHUI WAI DRAINAGE IMPROVEMENT, STAGE 1, PHASE 2B - KAM TIN

LANDSCAPE PLAN FOR PROPOSED CHANNEL - KT14

Drawing no.	Scale
LP-01	1:2000 A3

香港特別行政區政府渠務署
THE GOVERNMENT OF THE HONG KONG
SPECIAL ADMINISTRATIVE REGION
DRAINAGE SERVICES DEPARTMENT

BLACK & VEATCH HONG KONG LIMITED
博威工程顧問有限公司

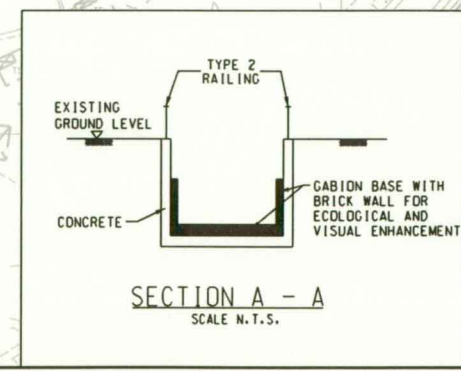
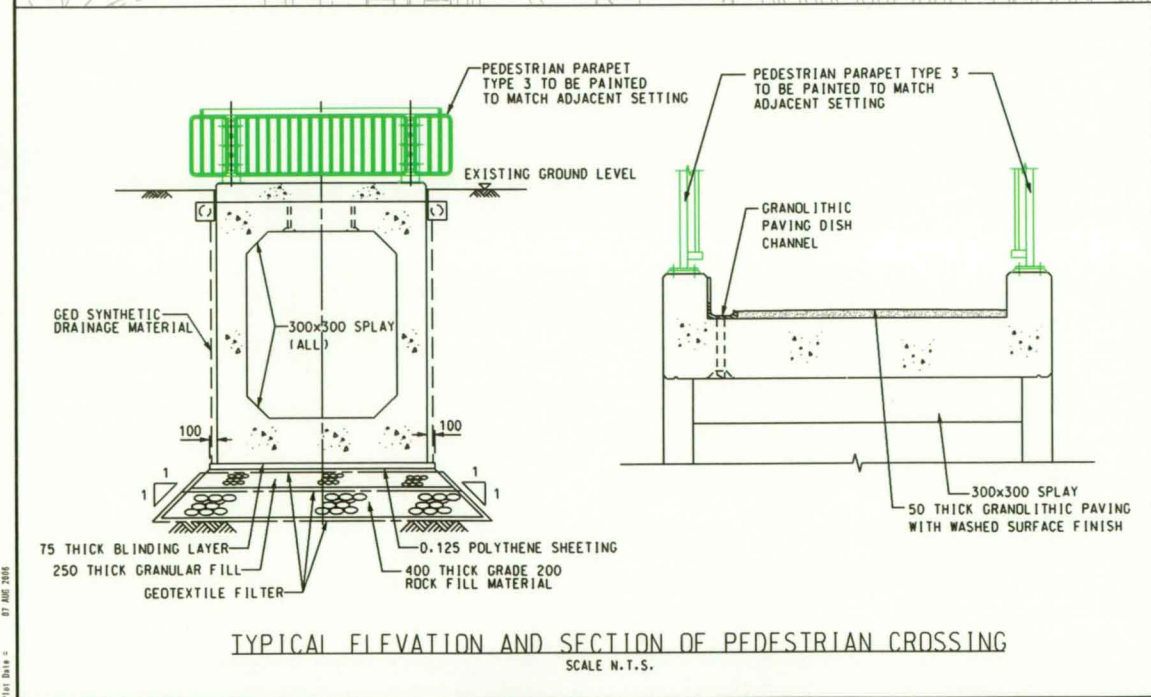

- LEGEND :
- WORKS BOUNDARY
 - PROPOSED HYDROSEEDING AND LANDSCAPE PLANTING AREA
 - PROPOSED GABION BASE
 - PROPOSED PEDESTRIAN BRIDGE/ MAINTENANCE ACCESS ROAD
 - AREA TO BE FILLED TO ADJACENT GROUND LEVEL
 - PROPOSED LOCATION FOR TRANSPLANTED TREE
 - TREE PROPOSED TO BE RETAINED
 - PROPOSED HEAVY STANDARD TREE
 - BAMBOO PLANTING AREA

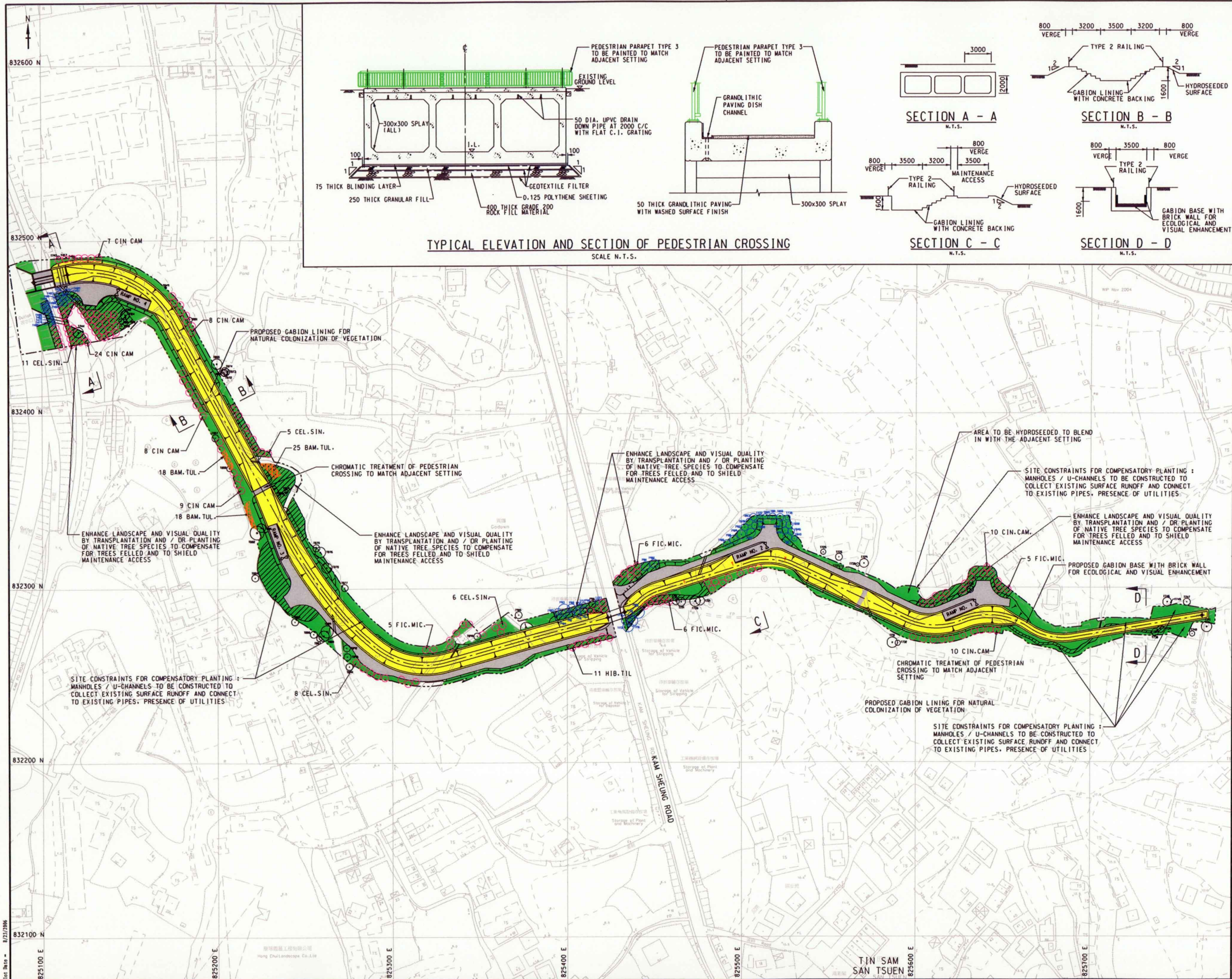

A		FEB06		GENERAL REVISION		KIL	
Revision	Date	Description				Initial	
		Designed	Checked	Drawn	Verified		
Initial	TW	KIL	HKF	KIL			
Date	8/05	8/05	8/05	8/05	8/05		

Approved

AGREEMENT NO. CE 67/98

Contract title
 YUEN LONG, KAM TIN,
 NGAU TAM MEI AND TIN SHUI WAI
 DRAINAGE IMPROVEMENT, STAGE 1,
 PHASE 2B - KAM TIN

Drawing title
 LANDSCAPE PLAN FOR
 PROPOSED CHANNEL - KT15

Drawing no.
 LP-02

Scale
 1:2000 A3

香港特別行政區政府渠務署
 THE GOVERNMENT OF THE
 HONG KONG
 SPECIAL ADMINISTRATIVE REGION
 DRAINAGE SERVICES DEPARTMENT

BLACK & VEATCH HONG KONG LIMITED
 博威工程顧問有限公司