

ATAL-Degrémont-China State Joint Venture

Contract No. DC/2008/03
Design, Build and Operate Pillar
Point Sewage Treatment Works:
Forty-sixth Monthly EM&A Report

September 2014

Environmental Resources Management



16/F, Berkshire House,
25 Westlands Road,
Quarry Bay, Hong Kong
Telephone: (852) 2271 3000
Facsimile: (852) 2723 5660
E-mail: post.hk@erm.com
<http://www.erm.com>

ATAL-Degrémont-China State Joint Venture

Contract No. DC/2008/03
Design, Build and Operate Pillar
Point Sewage Treatment Works:
Forty-sixth Monthly EM&A Report

September 2014

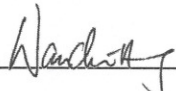
Reference 0119806

For and on behalf of ERM-Hong Kong, Limited	
Approved by:	Frank Wan
Signed:	
Position:	Partner
Certified by:	 (Environmental Team Leader – Winnie Ko)
Certified by:	 (Registered Landscape Architect No. 034 (99) – Kenneth Ng)
Date:	13 September 2014

Your Ref:
Our Ref: 60017423/C/iyyys14091201

By Hand & By Fax (2833 9162)

Drainage Services Department
Sewage Services Branch
Harbour Area Treatment Scheme Division
5/F., Western Magistracy,
2A Pok Fu Lam Road,
Hong Kong.

Attn: Mr. Kenley C.K. KWOK (T: 2159 3409)

12 September 2014

Dear Sir,

**Contract No. DC/2008/03
Design, Build and Operate
Pillar Point Sewage Treatment Works**

Monthly EM&A Report for August 2014

Reference is made to Environmental Team (ET)'s draft of the Monthly EM&A Report for August 2014 provided by email dated 11 September 2014. We have no further comment.

We hereby verify the said Monthly EM&A Report as having complied with the requirement as set out in the EM&A Manual in accordance with the condition 3.6 of Environmental Permit No. EP-321/2008/B.

Should you have any queries, please feel free to contact the undersigned at 3922 9393.

Yours faithfully,

For and on behalf of
AECOM Asia Co. Ltd.



Y T Tang
Independent Environmental Checker

c.c. AECOM – Mr. C Y Hung
ERM – Ms. Winnie Ko
ATAL–Degremont–China State JV – Mr. C.Y. Fong

(Fax No. 2404 3310)
(Fax No. 2723 5660)
(Fax No. 2811 3321)

CONTENTS

EXECUTIVE SUMMARY

1	INTRODUCTION	1
1.1	<i>PURPOSE OF THE REPORT</i>	1
1.2	<i>STRUCTURE OF THE REPORT</i>	1
2	PROJECT INFORMATION	3
2.1	<i>BACKGROUND</i>	3
2.2	<i>GENERAL SITE DESCRIPTION</i>	3
2.3	<i>CONSTRUCTION ACTIVITIES</i>	4
2.4	<i>PROJECT ORGANISATION AND MANAGEMENT STRUCTURE</i>	4
2.5	<i>STATUS OF ENVIRONMENTAL APPROVAL DOCUMENTS</i>	4
3	ENVIRONMENTAL MONITORING REQUIREMENTS	6
3.1	<i>AIR QUALITY MONITORING</i>	6
3.1.1	<i>Monitoring Location</i>	6
3.1.2	<i>Monitoring Parameter and Frequency</i>	6
3.1.3	<i>Action and Limit Levels</i>	6
3.1.4	<i>Monitoring Equipment</i>	6
3.1.5	<i>Monitoring Methodology</i>	7
3.1.6	<i>Event and Action Plan</i>	9
3.2	<i>LANDSCAPE AND VISUAL MONITORING</i>	9
3.3	<i>ENVIRONMENTAL MITIGATION MEASURES AND ENVIRONMENTAL REQUIREMENTS IN CONTRACT</i>	9
4	IMPLEMENTATION STATUS ON ENVIRONMENTAL PROTECTION REQUIREMENTS	10
5	MONITORING RESULTS	11
5.1	<i>AIR QUALITY</i>	11
6	WASTE MANAGEMENT	12
7	ENVIRONMENTAL INSPECTIONS	13
7.1	<i>WEEKLY SITE AUDITS</i>	13
7.2	<i>LANDSCAPE AND VISUAL MONITORING</i>	14
8	ENVIRONMENTAL NON-CONFORMANCE	15
8.1.1	<i>Summary of Monitoring Exceedance</i>	15
8.1.2	<i>Summary of Environmental Non-Compliance</i>	15
8.1.3	<i>Summary of Environmental Complaint</i>	15
8.1.4	<i>Summary of Environmental Summon and Successful Prosecution</i>	15
9	FUTURE KEY ISSUES	16

9.1.1	<i>Key Issues for the Coming Month</i>	16
9.1.2	<i>Monitoring Schedule for the Next Reporting Period</i>	16
9.1.3	<i>Construction Programme for the Next Three Months</i>	16
10	REVIEW OF THE EM&A DATA AND EIA PREDICTIONS	17
10.1	<i>AIR QUALITY</i>	17
10.2	<i>WASTE MANAGEMENT</i>	17
10.3	<i>CONCLUSION OF THE REVIEW</i>	18
11	CONCLUSIONS	19

LIST OF TABLES

Table 2.1	Summary of Construction Activities Undertaken in Reporting Period
Table 2.2	Summary of Environmental Licensing, Notification and Permit Status
Table 3.1	Construction Phase Air Monitoring Locations
Table 3.2	Construction Phase Air Quality Monitoring Parameters and Frequency
Table 3.3	Action and Limit Levels for Air Quality
Table 3.4	TSP Monitoring Equipment
Table 6.1	Quantities of Waste Generated from the Project
Table 9.1	Construction Works to be Undertaken in the Next Reporting Period
Table 10.1	Comparison of the HKAQO and Air Quality Monitoring Results
Table 10.2	Quantity of Actual Amount of C&D Materials, General Wastes and Chemical Wastes Generated and EIA Estimation

LIST OF ANNEXES

Annex A	Location of Project
Annex B	Works Location
Annex C	Project Organization Chart and Contact Detail
Annex D	Locations of Air Quality Monitoring Stations
Annex E	Monitoring Schedule of the Reporting Month and Next Month
Annex F	Calibration Reports for HVSSs
Annex G	24-hour and 1-hour TSP Monitoring Results
Annex H	Event / Action Plan for Air Quality Monitoring
Annex I	Implementation Schedule of Mitigation Measures
Annex J	Waste Flow Table
Annex K	Environmental complaint, Environmental Summons and Prosecution Log
Annex L	Construction Programme for the Project

EXECUTIVE SUMMARY

The construction works of *DC/2008/03 of Design, Build and Operate Pillar Point Sewage Treatment Works (the Project)* commenced on 13 November 2010. This is the 46th monthly Environmental Monitoring and Audit (EM&A) report presenting the EM&A works carried out during the period from 1 to 31 August 2014 in accordance with the EM&A Manual.

Summary of Construction Works undertaken during the Reporting Month

Works undertaken in the reporting month included:

- Construct finishing works at the Administration Building, Sludge Dewatering Building, UV Building, Septic Waste Reception Station, Reuse Water Pump Room, Sludge Skip Storage Building, PTW, CEPT, Existing Solid Handling Building, Weighbridge, Existing Outfall Pumping Station and Chemical Building;
 - Outstanding E&M works at Admin Building, Sludge Dewatering Building, PTW, CEPT, UV Building, Chemical Building, and Electrical buildings No.1, No.3 and No.4;
 - T&C at Deodorisation Unit Portion A, Deodorisation Unit Portion B and Payment Flow Meter Chamber;
 - Installation of E&M equipment at Weighbridge;
 - Building surface works at Sludge Skip Storage Building;
 - Refurbishment works at Existing Solid Handling Building;
 - Place planting soil on rooftop;
 - Chamber reinstatement at Payment Flow Meter Chamber; and
 - Demolition of Existing PTW.
-

Environmental Monitoring and Audit Progress

A summary of the monitoring activities undertaken in this reporting period is listed below:

- | | |
|---|---------|
| • 24-hour TSP Monitoring at each monitoring station (AM1 and AM2) | 5 sets |
| • 1-hour TSP Monitoring at each monitoring station (AM1 and AM2) | 15 sets |
| • Joint Environmental Site Inspection | 5 times |
| • Landscape & Visual Monitoring | Once |

Air Quality

5 sets of 24-hour TSP and 15 sets of 1-hr TSP measurements were carried out at each of the designated monitoring stations during the reporting period. No exceedance was recorded during the reporting period.

Waste Management

Waste generated from this Project includes inert construction and demolition (C&D) materials (public fill) and non-inert C&D materials (construction wastes). In total, 758.68 tonnes of inert C&D material were generated from the Project, of which 10 tonnes were reused in this Contract and the remaining 748.68 tonnes were disposed as public fill. 10.00 kg of metals, 5.00 kg of

papers/ cardboard packing and 0.00 kg of plastics were sent to recyclers for recycling during the reporting period.

Environmental Site Inspection

Five weekly joint environmental site inspections were carried out by the representatives of the Contractor, SOR and the Environmental Team (ET). Details of the audit findings and implementation status of the mitigation measures are presented in *Section 7.1*.

Landscape & Visual

Review on landscape and visual mitigation measures was performed on 22 August 2014. Details of the audit findings and implementation status of the mitigation measures are presented in *Sections 3.2* and *7.2*.

Environmental Exceedance/Non-conformance/Compliant/Summons and Prosecution

No exceedance was recorded during the reporting period.

No non-compliance event was recorded during the reporting period.

No environmental complaint and summon/prosecution was received in this reporting period.

Future Key Issues

Works to be undertaken in the next reporting month include:

-
- Construct finishing works at the Administration Building, Sludge Dewatering Building, UV Building, Septic Waste Reception Station, Reuse Water Pump Room, Sludge Skip Storage Building, PTW, CEPT, Existing Solid Handling Building, Weighbridge, Existing Outfall Pumping Station and Chemical Building;
 - Outstanding E&M works at Admin Building, Sludge Dewatering Building, PTW, CEPT, UV Building, Chemical Building, and Electrical buildings No.1, No.3 and No.4;
 - T&C at Deodorisation Unit Portion A, Deodorisation Unit Portion B and Payment Flow Meter Chamber;
 - Installation of E&M equipment at Weighbridge;
 - Building surface works at Sludge Skip Storage Building;
 - Refurbishment works at Existing Solid Handling Building;
 - Place planting soil on rooftop;
 - Chamber reinstatement at Payment Flow Meter Chamber; and
 - Demolition of Existing PTW.
-

Environmental impacts arising from the above construction activities are mainly associated with dust, construction noise, site runoffs, waste management and landscaping issues.

1 INTRODUCTION

ERM-Hong Kong, Limited (ERM) was appointed by ATAL – Degrémont – China State Joint Venture (ADC-JV) (the Contractor) as the Environmental Team (ET) to undertake the Environmental Monitoring and Audit (EM&A) programme for the *Contract No. DC/2008/03 of Design, Build and Operate Pillar Point Sewage Treatment Works (the Project)*.

1.1 PURPOSE OF THE REPORT

This is the 46th EM&A report which summarises the monitoring results and audit findings for the EM&A programme during the reporting period from 1 to 31 August 2014.

1.2 STRUCTURE OF THE REPORT

The structure of the report is as follows:

Section 1: **Introduction**

It details the scope and structure of the report.

Section 2: **Project Information**

It summarises the background and scope of the Project, site description, project organization, construction programme, construction works undertaken and status of the Environmental Permits (EP)/licences over the construction phase of the Project.

Section 3: **Environmental Monitoring Requirements**

It summarises the environmental monitoring requirements including monitoring parameters, programmes, methodologies, frequency, locations, Action and Limit Levels, Event/Action Plans, environmental mitigation measures as recommended in the approved EIA report, EP and relevant environmental requirements stated in the Contract Specification.

Section 4: **Implementation Status on Environmental Mitigation Measures**

It summarises the implementation of environmental protection measures during the reporting period.

Section 5: **Monitoring Results**

It summarises the monitoring results obtained in the reporting period.

Section 6: **Waste Management**

It summarises the quantity of public fill and construction waste generated in the reporting period

Section 7: **Environmental Site Inspection**

It summarises the audit findings of the weekly site inspections undertaken within the reporting period.

Section 8: **Environmental Non-conformance**

It summarises any exceedance of environmental performance standard, environmental complaints and summons received within the reporting period.

Section 9: **Further Key Issues**

It summarises the impact forecast and monitoring schedule for the next reporting month.

Section 10: **Review of the EM&A Data and Predictions**

It compares the monitoring data and waste quantity against the predictions in the approved Project EIA report.

Section 11: **Conclusions**

2.1**BACKGROUND**

The existing Pillar Point Sewage Treatment Works (PPSTW) is located to the north of the Tuen Mun River Trade Terminal and is abutting the Lung Mun Road in the north. It is a preliminary treatment works with screening and grit removal processes and the treated effluent is discharged to the sea (North Western Water Control Zone) via a twin submarine outfall. The *Review of the Tuen Mun and Tsing Yi Sewerage Master Plan (RTMTYSMP)*, commissioned in February 1999, recommended that the sewage treatment capacity be expanded and the plant be upgraded to chemically enhanced primary treatment (CEPT) with disinfection. This is to cater for the projected ultimate population and planned developments in the Tuen Mun area, and to improve the effluent quality reducing pollution loadings to the receiving waters.

The upgrading of the PPSTW comprises the following works:

- expanding the treatment capacity of the existing PPSTW to cope with the increased peak wet-weather sewage flow in Tuen Mun area;
- upgrading the sewage treatment level of the existing PPSTW to incorporate chemical treatment with disinfection at minimum removal rates of 70%, 55% and 99.9% of suspended solids (SS), biochemical oxygen demand (BOD) and *E.coli*, respectively;
- upgrading the existing septic waste reception facilities at PPSTW; and
- providing and upgrading ancillary facilities including the administration building, workshop, laboratory, odour control facilities, sludge handling and dewatering facilities, access roads and minor landscaping works within the STW for the operation and maintenance of the upgraded STW.

The potential environmental impacts of the Project have been studied in the *“Upgrading of Pillar Point Sewage Treatment Works”* (EIAO Register No: AEIAR-145/2008). The EIA was approved on 10 June 2008 under the *Environmental Impact Assessment Ordinance* (EIAO) and an Environmental Permit (EP-321/2008) for the works was granted on 17 November 2008. A variation of an Environmental Permit was granted on 30 May 2014 (EP-321/2008/B). Under the requirements of Condition 3.1 of EP-321/2008/B, an EM&A programme as set out in the EM&A Manual is required to be implemented.

The construction works commenced on 13 November 2010 and are scheduled for completion by 2014.

2.2**GENERAL SITE DESCRIPTION**

The open area adjacent to the existing PPSTW has been designated for the upgrading works. The layout of the upgrading works is illustrated in *Annex*

A.

2.3 CONSTRUCTION ACTIVITIES

A summary of the major construction activities undertaken in the reporting period is shown in *Table 2.1*. The locations of the construction activities are shown in *Annex B*. The construction programme of the Project in the reporting month and the upcoming month is presented in *Annex L*.

Table 2.1 *Summary of Construction Activities Undertaken in the Reporting Period*

Construction Activities Undertaken
<ul style="list-style-type: none">• Construct finishing works at the Administration Building, Sludge Dewatering Building, PTW, CEPT, UV Building, Septic Waste Reception Station, Reuse Water Pump Room, Chemical Building, Sludge Skip Storage Building, Existing Solid Handling Building, Weighbridge and Existing Outfall Pumping Station;• Outstanding E&M works at Admin Building, Sludge Dewatering Building, PTW, CEPT, UV Building, Chemical Building, and Electrical buildings No.1, No.3 and No.4;• T&C at Deodorisation Unit Portion A, Deodorisation Unit Portion B and Payment Flow Meter Chamber;• Installation of E&M equipment at Weighbridge;• Building surface works at Sludge Skip Storage Building;• Refurbishment works at Existing Solid Handling Building;• Place planting soil on rooftop;• Chamber reinstatement at Payment Flow Meter Chamber; and• Demolition of Existing PTW.

2.4 PROJECT ORGANISATION AND MANAGEMENT STRUCTURE

The project organisation chart and contact details are shown in *Annex C*.

2.5 STATUS OF ENVIRONMENTAL APPROVAL DOCUMENTS

A summary of the valid permits, licences, and/or notifications on environmental protection for this Project is presented in *Table 2.2*.

Table 2.2 *Summary of Environmental Licensing, Notification and Permit Status*

Permit/ Licences/ Notification	Reference	Validity Period	Remarks
Environmental Permit	EP-321/2008/B	Throughout the Contract	Permit granted on 30 May 2014
Notification of Construction Works under the Air Pollution Control (Construction Dust) Regulation	Ref No. 308136	Throughout the Contract	-

Permit/ Licences/ Notification	Reference	Validity Period	Remarks
Water Discharge License	WT00017778-2013	22 November 2013 - 31 October 2015	Wastewater discharge licence was issued by EPD on 22 November 2013.
Construction Noise Permit	GW-RW0190-14	1 April 2014 – 30 September 2014	-
Chemical Waste Producer Registration	5213-421-A2620-01	Throughout the Contract	Licence approved on 28 October 2010

3.1 AIR QUALITY MONITORING

3.1.1 Monitoring Location

The proposed air quality monitoring stations for the construction phase of the Project, as recommended in the approved EM&A Manual, are given in *Table 3.1* and shown in *Annex D*. The proposed locations (AM1 and AM2) have been agreed with the Drainage Services Department (DSD), Environmental Protection Department (EPD) and the Independent Environmental Checker (IEC).

Table 3.1 Construction Phase Air Monitoring Locations

Monitoring ID	Air Quality Monitoring Station
AM1	Tuen Mun EMSD Servicing Vehicle Station
AM2	River Trade Terminal Office

3.1.2 Monitoring Parameter and Frequency

The construction phase air quality monitoring has been conducted at the designated monitoring stations in accordance with the requirements stipulated in the EM&A Manual. 1-hour and 24-hour TSP levels have been monitored at the frequency and duration stated in *Table 3.2*. The construction phase TSP monitoring has been conducted as per the schedule presented in *Annex E*.

Table 3.2 Construction Phase Air Quality Monitoring Parameters and Frequency

Parameter	Frequency
24-hour average TSP	Once every 6 days
1-hour average TSP	3 times every 6 days

3.1.3 Action and Limit Levels

The Action and Limit levels have been established and presented in *Table 3.3*.

Table 3.3 Action and Limit Levels for Air Quality

Parameter	Air Monitoring Station	Action Level, μgm^{-3}	Limit Level, μgm^{-3}
24-hour TSP	AM1	183	260
	AM2	192	260
1-hour TSP	AM1	343	500
	AM2	383	500

3.1.4 Monitoring Equipment

Continuous 24-hour and 1-hour TSP monitoring was performed using High Volume Samplers (HVS) with appropriate sampling inlets located at the designated monitoring stations.

The performance specification of HVS complied with the standard method “*Determination of Suspended Particulate Matter in the Atmosphere (High Volume Method)*” as stipulated in *US EPA Standard Title 40, Code of Federation Regulations Chapter 1 (Part 50 Appendix B)*. Table 3.4 summarises the equipment that were deployed for the 24-hour and 1-hour TSP monitoring respectively.

Table 3.4 *TSP Monitoring Equipment*

Monitoring Station	Monitoring Equipment (HVS and Calibrator)
<i>24-hr and 1-hr TSP</i>	
AM1	GMW GS-2310 (S/N 7580), CM-AIR-43 (S/N 0438320)
AM2	GMW GS-2310 (S/N 1252), CM-AIR-43 (S/N 0438320)

3.1.5 *Monitoring Methodology*

The setup locations of the HVSs were listed in Table 3.1. All HVSs were free-standing with no obstruction.

The following criteria were considered in the installation of the HVSs:

- appropriate support to secure the samplers against gusty wind were provided at AM1 and AM2;
- a minimum of 2m separation from walls, parapets and penthouses was required for rooftop samplers;
- no furnace or incinerator flues was nearby;
- airflow around the sampler was unrestricted; and
- permission was obtained to set up the samplers and gain access to the monitoring stations.

Preparation of Filter Papers

- glass fibre filters were labelled and sufficient filters that were clean and without pinholes were selected;
- all filters were equilibrated in the conditioning environment for 24 hours before weighing. The conditioning environment temperature was around 25°C and not variable by more than $\pm 3^\circ\text{C}$; the relative humidity (RH) was 40%; and
- SGS Hong Kong Ltd, a HOKLAS accredited laboratory, implemented comprehensive quality assurance and quality control programmes.

Field Monitoring

- the power supply was checked to ensure that the HVSs were working properly;

- the filter holder and area surrounding the filter were cleaned;
- the filter holder was removed by loosening the foul bolts and a new filter, with stamped number upward, on a supporting screen was aligned carefully;
- the filter was properly aligned on the screen so that the gasket formed an airtight seal on the outer edges of the filter;
- swing bolts were fastened to hold the filter holder down to the frame. The pressure applied should be sufficient to avoid air leakage at the edges;
- the shelter lid was closed and secured with an aluminium strip;
- the HVSs were warmed-up for about 5 minutes to establish run-temperature conditions;
- a new flowrate record sheet was inserted into the flow recorder;
- the flow rates of the HVSs were checked and adjusted to between 1.22 and 1.37 m³ min⁻¹ which were within the range specified in the EM&A Manual (ie 0.6 to 1.7 m³ min⁻¹);
- the programmable timer was set for a sampling period of 24 hours ± 1 hour, and the starting time, weather condition and the filter number were recorded;
- the initial elapsed time was recorded;
- at the end of sampling, the sampled filter was removed carefully and folded in half l so that only surfaces with collected particulate matter were in contact;
- the filter was placed in a clean plastic envelope and sealed;
- all monitoring information was recorded on a standard data sheet; and
- filters were sent to SGS Hong Kong Ltd for analysis.

Maintenance and Calibration

- the HVSs and their accessories were maintained in good working condition, eg. motor brushes were replaced routinely and electrical wiring was checked to ensure a continuous power supply; and
- the flow rate of each HVS with mass flow controller was calibrated using an orifice calibrator. Initial calibrations of the dust monitoring equipment were conducted upon installation and prior to commissioning. Five-point calibration was carried out for HVSs using CM-AIR-43 Calibration Kit. HVSs are calibrated on a bi-monthly basis. The calibration records for the HVSs are given in *Annex F*.

Wind Data Monitoring

Average wind data (wind speed and wind direction) during the monitoring period were obtained from the meteorological station at Tuen Mun of the Hong Kong Observatory (HKO) and were presented in *Annex G*.

3.1.6 *Event and Action Plan*

The Event/Action Plan (EAP) for air quality monitoring is presented in *Annex H*.

3.2 *LANDSCAPE AND VISUAL MONITORING*

In accordance with the EM&A Manual, monthly landscape and visual monitoring is required to ensure that the design, implementation and maintenance of landscape and visual mitigation measures recommended in the approved EIA Report are fully achieved. The monitoring procedures and criteria as described in the EM&A Manual were adopted.

3.3 *ENVIRONMENTAL MITIGATION MEASURES AND ENVIRONMENTAL REQUIREMENTS IN CONTRACT*

All the relevant environmental mitigation measures listed in the EIA Report and EM&A Manual as well as the specific environmental requirements stated in the Contract Specification are summarised in *Annex I*. A summary of the key environmental mitigation measures implemented as per the Contract Requirements is also presented in *Annex I*.

**IMPLEMENTATION STATUS ON ENVIRONMENTAL PROTECTION
REQUIREMENTS**

The Contractor has implemented environmental mitigation measures and requirements as stated in the approved EIA Report, EM&A Manual and EP. The implementation status of the measures during the reporting period is summarised in *Annex I*.

5 MONITORING RESULTS

5.1 AIR QUALITY

A total of 5 sets of 24-hour and 15 sets of 1-hour TSP measurements were taken at each of the monitoring stations (AM1 and AM2) during the reporting period. The monitoring data for 24-hour and 1-hour TSP together with the wind data and graphical presentations for the past 4 months are presented in *Annex G*. The weather conditions during the monitoring period ranged from fine to sunny. The local impacts near the monitoring stations of AM1 and AM2 were mainly associated with vehicular emissions. No exceedance of Action and Limit Level of the 1-hr and 24-hr TSP was recorded during the reporting period.

Wastes generated from this Project include inert construction and demolition (C&D) materials (public fill) and non-inert C&D materials (construction waste). Construction waste comprises general refuse, metals and paper/cardboard packaging materials. Metals generated from the Project are also grouped into construction waste as the materials were not disposed of with others at public fill. Reference has been made to the Monthly Summary Waste Flow Table prepared by the Contractor (see *Annex J*). With reference to the relevant handling records and trip tickets of this Project, the quantities of different types of waste generated in the reporting month are summarised in *Table 6.1*.

Table 6.1 *Quantities of Waste Generated from the Project*

Month / Year	Quantity			
	Total Inert C&D Materials Generated ^(a)	Non-inert C&D Materials ^(b)		
		C&D Materials Recycled ^(c)	C&D Waste Disposed of at Landfill ^(d)	Chemical Waste
August 2014	758.68 tonnes	15.00 kg	9.86 tonnes	0 L

Notes:

(a) Inert C&D materials (public fill) include bricks, concrete, building debris, rubble and excavated spoil. In total, 758.68 tonnes of inert C&D waste were generated from the Project, of which 10.00 tonnes were reused in this Contract and the remaining 748.68 tonnes were disposed as public fill. The detailed waste flow is presented in *Annex J*.

(b) Non-inert C&D materials (construction wastes) include metals, paper / cardboard packaging waste, plastics and other wastes such as general refuse. Metals generated from the Project were grouped into construction wastes as the materials were not disposed of with others at the public fill.

(c) 10.00 kg of metals, 5.00 kg of papers/ cardboard packing and 0.00 kg of plastics were sent to recyclers for recycling during the reporting period.

(d) Construction wastes other than metals, paper/cardboard packaging, plastics and chemicals were disposed of at WENT Landfill by subcontractors.

7.1 WEEKLY SITE AUDITS

Joint site inspections were conducted by representatives of the Contractor, the SOR and the ET on 1, 8, 15, 22 and 26 August 2014. The IEC was also present at the joint inspection on 22 August 2014.

Major observations during the reporting period are summarised as follows:

1 August 2014

- Dead weeds were still observed to be stored by retained tree R65. The Contractor was strongly reminded to clear the dead weeds;
- Exposed stockpiles were observed at the existing PTW. The Contractor was reminded to spray water regularly to prevent fugitive dust emissions;
- Retained tree 174 was observed to have exposed roots. The Contractor was reminded to water and cover the tree roots with tarpaulin to retain moisture;
- Retained tree R22 was observed to have a broken branch. The Contractor was reminded to remove the broken branch; and
- Construction material was observed too close to the tree trunks of retained trees R21 and R22. The Contractor was reminded to move construction materials away from the retained trees and provide adequate tree protection zones.

8 August 2014

- Tree roots of retained tree 175 and N06 were observed to be exposed. The Contractor was reminded to water and cover the tree roots with tarpaulin to retain moisture and refill excavated soil as soon as possible.

15 August 2014

- Ferric chloride was observed to be accumulated at the Chemical Building. The Contractor was reminded to pump the chemical from the pit to avoid overflow; and
- Gullies near Outfall were observed to have blocked silt traps. The Contractor was reminded to change the silt traps for the gullies.

22 August 2014

- Muddy/ silty water was observed to have accumulated on the roadsides at the worksite. The Contractor was reminded to water the roads regularly to direct the muddy water towards the drains; and

- The tree protection zones of retained trees T04, T05 and T06 were observed to be missing or have collapsed. The Contractor was reminded to provide a proper tree protection zone for the retained trees..

26 August 2014

- The tree protection zones of retained trees T04, T05 and T06 were still observed to be missing or have collapsed. The Contractor was strongly reminded to provide a proper tree protection zone for the retained trees; and
- The tree trunk of retained tree N09 was observed to have fungal or insect growth. The Contractor was reminded to keep close observation of the retained tree to avoid and to investigate the cause of the defect.

Follow-up actions resulting from the last site inspections were taken as reported by the Contractor and their results were observed in the site inspections conducted in the reporting period.

7.2

LANDSCAPE AND VISUAL MONITORING

In accordance with the EM&A Manual, monthly landscape and visual monitoring is required to ensure that the design, implementation and maintenance of landscape and visual mitigation measures recommended in the EIA Report are fully achieved. A review of the landscape and visual mitigation measures was performed on 22 August 2014. It was confirmed that most of the necessary landscape and visual mitigation measures as summarised in *Annex I* were implemented by the Contractor. The major findings are summarised as follows:

22 August 2014

- The tree protection zones of retained trees T04, T05 and T06 were observed to be missing or have collapsed. The Contractor was reminded to provide a proper tree protection zone for the retained trees..

8 ENVIRONMENTAL NON-CONFORMANCE

8.1.1 *Summary of Monitoring Exceedance*

No exceedances of the Action and Limit Levels of 1-hr and 24-hr TSP was recorded during the reporting period.

8.1.2 *Summary of Environmental Non-Compliance*

No non-compliance event was recorded during the reporting period.

8.1.3 *Summary of Environmental Complaint*

No complaint was received during the reporting period. The cumulative environmental complaint log is shown in *Annex K*.

8.1.4 *Summary of Environmental Summon and Successful Prosecution*

No summon was received during the reporting period. The cumulative summons/prosecution log is shown in *Annex K*.

9.1.1 *Key Issues for the Coming Month*

Works to be undertaken for the coming monitoring period are summarised in *Table 9.1*.

Table 9.1 *Construction Works to be undertaken in the Next Reporting Period*

Construction Activities Undertaken
<ul style="list-style-type: none"> • Construct finishing works at the Administration Building, Sludge Dewatering Building, PTW, CEPT, UV Building, Septic Waste Reception Station, Reuse Water Pump Room, Chemical Building, Sludge Skip Storage Building, Existing Solid Handling Building, Weighbridge and Existing Outfall Pumping Station; • Outstanding E&M works at Admin Building, Sludge Dewatering Building, PTW, CEPT, UV Building, Chemical Building, and Electrical buildings No.1, No.3 and No.4; • T&C at Deodorisation Unit Portion A, Deodorisation Unit Portion B and Payment Flow Meter Chamber; • Installation of E&M equipment at Weighbridge; • Building surface works at Sludge Skip Storage Building; • Refurbishment works at Existing Solid Handling Building; • Place planting soil on rooftop; • Chamber reinstatement at Payment Flow Meter Chamber; and • Demolition of existing PTW.

Potential environmental impacts arising from the above construction activities will be mainly associated with dust, construction noise, site runoffs, waste management and landscaping issues.

9.1.2 *Monitoring Schedule for the Next Reporting Period*

The tentative schedule of TSP monitoring for the next reporting period was presented in *Annex E*. Environmental monitoring will be conducted at the same monitoring locations in the next reporting period. The monitoring programme has been reviewed and was considered adequate for the nature of works in progress.

9.1.3 *Construction Programme for the Next Three Months*

The most up-to-date construction programme for the Project is presented in *Annex L*.

10.1 AIR QUALITY

Since the EIA has only included a qualitative assessment of dust impact during the construction phase, a comparison was made between the monitoring results from the start of the Project and the Hong Kong Air Quality Objectives (HKAQO) (see *Table 10.1*).

Table 10.1 Comparison of the HKAQO and Air Quality Monitoring Results

Monitoring Station	Corresponding ASR in EIA	HKAQO, $\mu\text{g m}^{-3}$	Measured 24-hour TSP Monitoring Results, $\mu\text{g m}^{-3}$ (a) (b)	
		24 hour (a)	Average	Range
AM1	A1	260	74	50 - 119
AM2	A7	260	78	49 - 126

Notes:

(a) Only 24-hour TSP monitoring results were compared as there is no 1 hour TSP criterion in HKAQO.

(b) The average and range of data were calculated from the period between the commencement of the construction works and this reporting month.

The monitoring results show that the average and range of the 24-hour TSP levels recorded since the commencement of the construction works have been well below the 24-hour TSP criterion in the HKAQO. Recommended mitigation measures in *Section 3.7.1.1* of EIA have been implemented throughout the construction period and were considered effective.

10.2 WASTE MANAGEMENT

The estimated amount of waste generated from the Project and the cumulative quantities of waste generated up to this reporting month are presented in *Table 10.2*. The amount of inert C&D material sent to public fills is higher than the estimated amount in the EIA. With reference to the C&D Material Assessment (Contractor's General Submission (CSF) No.: DC200803/CSF/SAF/060026/A), the difference in quantities is mainly due to the differences in excavation depths and the excavation methods in the Contract Works and that assumed in the Reference Design. Recommended mitigation measures in *Sections 7.5.1.1* to *7.5.1.9* of the EIA will continue to be implemented during the construction stage.

Table 10.2 *Quantity of Amount of C&D Materials, General Wastes and Chemical Wastes Actually Generated and Estimated in the EIA and C&D Material Assessment*

Type of Material	Estimated Amount of Public Fill and Construction Waste in the EIA (inert & non-inert)	Estimated Amount of Public Fill and Construction Waste in C&D Material Assessment (CSF No.: DC200803/CSF/SAF/060026/A) ^(c)	Accumulated Actual Amount of Public Fill and Construction Waste Recorded ^{(a) (b)} (inert & non-inert)
Amount of C&D Materials Arising	61,489.00 m ³	77,600.00 m ³	134,730.40 m ³
Amount of C&D Materials Reused on other site	-	-	3,163.89 m ³
Amount of C&D Materials Reused on site	14,926.00 m ³	18,000.00 m ³	24,313.33 m ³
Amount of C&D Materials Sent to Fill Banks	46,563.00 m ³	59,600.00 m ³	106,086.91 m ³
General Refuse Small	-	-	2092.65 tonnes
Chemical Waste Small	-	-	810.00 L

Notes:

(a) The actual amount of C&D Materials has been recorded since the commencement of construction works.

(b) The density of soil and rock (bulked) is 1.8 tonnes/m³.

(c) The estimated amount of C&D material generated from the Contract Works was revised in the C&D Material Assessment and submitted to the SO on 9 September 2010 (CSF No.: DC200803/CSF/SAF/060026/A) because of the new plant & facility layout.

10.3 CONCLUSION OF THE REVIEW

The EIA predictions and monitoring results since the commencement of the construction works have been reviewed. The EIA concluded that the Project would not cause adverse impacts to the environment, and monitoring results have also confirmed that so far. Mitigation measures recommended in the EP, EIA and EM&A Manual will continue to be implemented throughout the construction phase of the Project.

This EM&A Report presents the EM&A programme undertaken during the reporting period from 1 to 31 August 2014 in accordance with EM&A Manual and requirements of EP (EP-321/2008/B).

No exceedance of Action and Limit Levels of 24-hour TSP and 1-hour TSP was recorded at the monitoring stations during the reporting period.

Monthly landscape and visual monitoring was conducted in the reporting period. Most of the necessary landscape and visual mitigation measures recommended in the EIA Report were implemented by the Contractor. Follow-up actions are required by the Contractor to improve protection of the retained or to-be transplanted trees.

No non-compliance event was recorded during the reporting period.

No complaint and summons/prosecution was received during the reporting period.

The ET will keep track of the EM&A programme to ensure compliance of environmental requirements and the proper implementation of all the necessary mitigation measures in the coming periods.

Annex A

Location of Project

PROPOSED FACILITIES AND BUILDINGS

SECTION 1 INLET PUMPING STATION AND PRELIMINARY TREATMENT WORKS

- ① INLET CHAMBER
- ② COARSE SCREENS AND INLET PUMPING STATION
- ③ FINE SCREEN CHANNELS
- ④ GRIT CHAMBERS
- ⑤ INLET FLOWMETER CHAMBER
- ⑥ PTW MCC ROOM

- ⑦ BLOWER ROOM
- ⑧ SCREENING SKIP HOUSE
- ⑨ ODOR DUCT SUPPORTING BRIDGE
- ⑩ SEPTIC WASTE RECEPTION STATION
- ⑪ WEIGHBRIDGE
- ⑫ ELECTRICAL BUILDING 1

- ⑬ ADMINISTRATION BUILDING
- ⑭ INLET CHAMBERS
- ⑮ PAYMENT FLOWMETER CHAMBER
- ⑯ CEPT INLET CHAMBER

SECTION 2 CEPT TANKS UV DISINFECTION

- ⑰ CEPT TANKS
- ⑱ UV DISINFECTION CHANNELS
- ⑲ REUSE WATER PUMP ROOM
- ⑳ ELECTRICAL BUILDING 3
- ㉑ ELECTRICAL BUILDING 2
- ㉒ OUTFALL PUMPING STATION CONNECTION CHAMBER
- ㉓ CHEMICAL BUILDING

SECTION 3 SLUDGE TREATMENT & HANDLING AND ODOUR CONTROL

- ㉔ SLUDGE DEMATERING BUILDING
- ㉕ DEODORISATION UNITS (B)
- ㉖ SLUDGE SKIP STORAGE BUILDING
- ㉗ SLUDGE SKIP LOADING AREA
- ㉘ DEODORISATION UNITS (A)

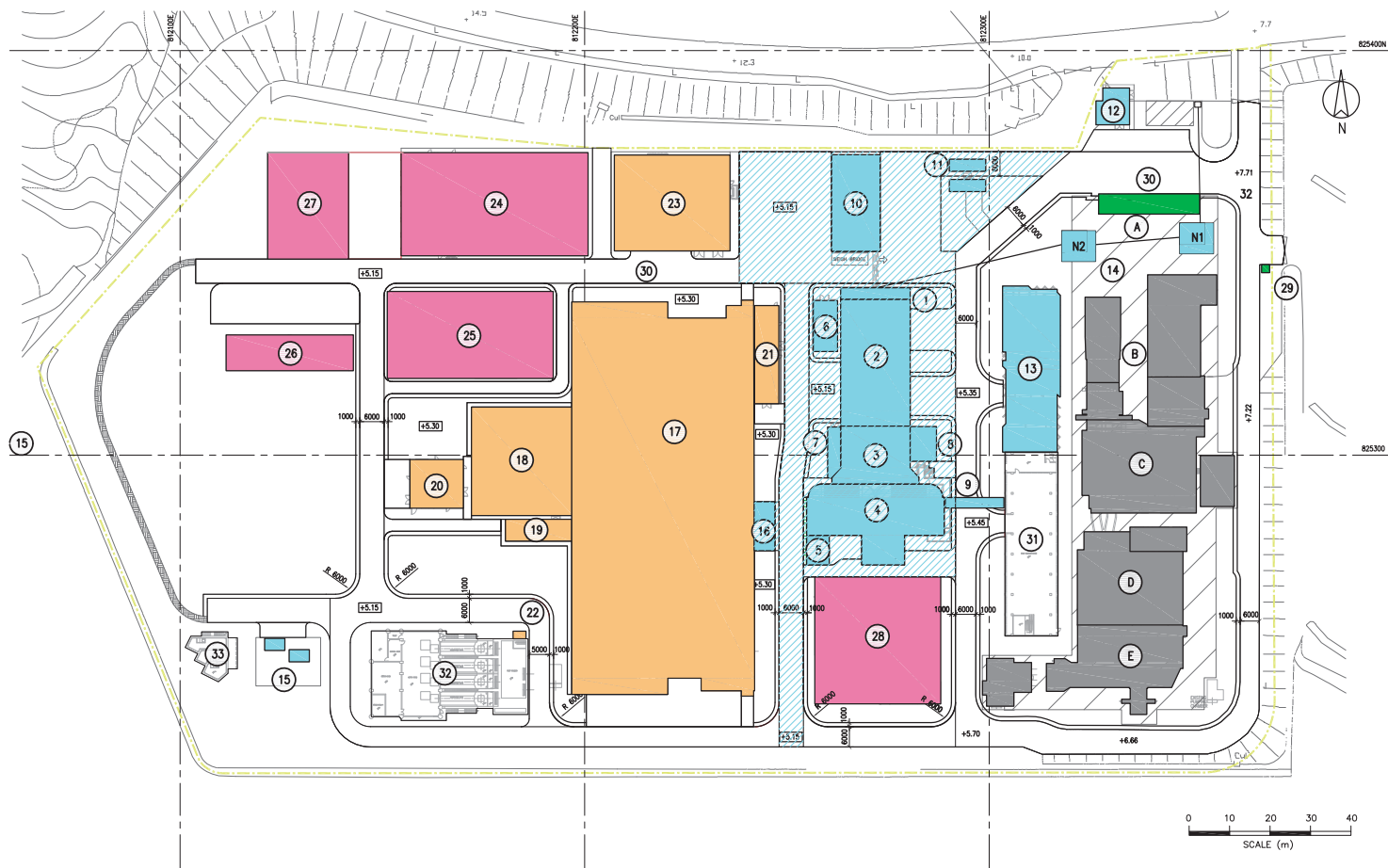
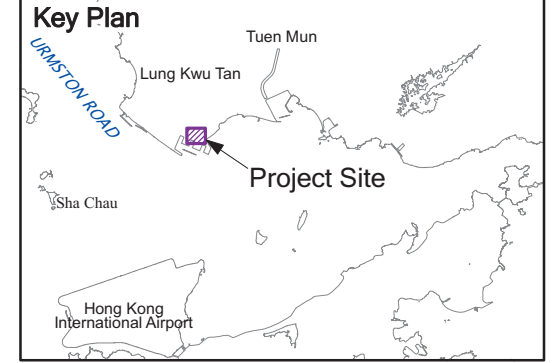

SECTION 4 EXISTING BUILDINGS TO BE DEMOLISHED

- Ⓐ ADMINISTRATION BUILDING
- Ⓑ INLET SCREW PUMPING STATION AND MOTOR HOUSE
- Ⓒ COARSE SCREENS
- Ⓓ BLOWER HOUSE AND GRIT CHANNELS
- Ⓔ FINE SCREEN CHANNELS AND FLOWMETER CHAMBER

SECTION 5 EXTERNAL WORKS

- ⑳ GATE HOUSE
- ㉑ CAR PARK

EXISTING BUILDING TO BE RETAINED

- ㉒ EXISTING SOLID HANDLING BUILDING
- ㉓ EXISTING OUTFALL PUMPING STATION
- ㉔ EXISTING TERMINAL MANHOLE

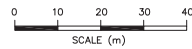

Annex B

Works Location

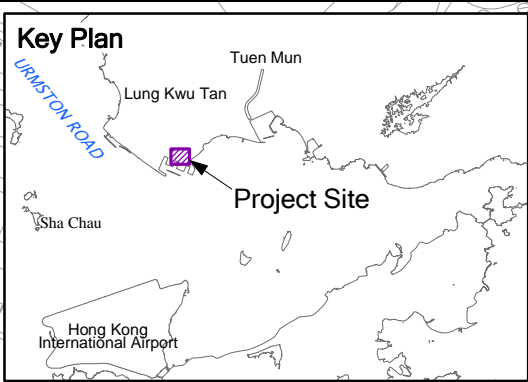

P1 & P3 - Works Areas within Existing PPSTW Facilities
P2 - Open Area for Construction of New Facilities at PPSTW

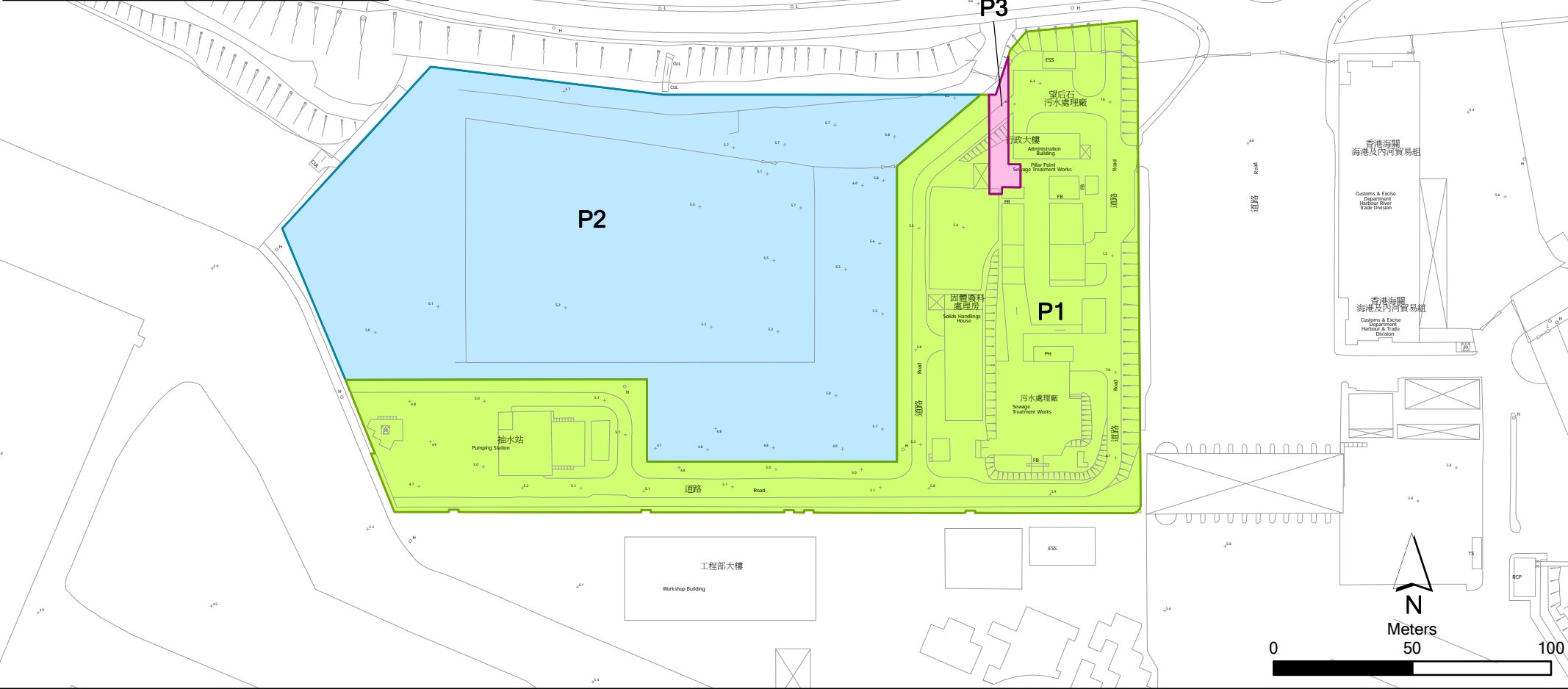

Annex B

Location of Works Areas

File: 0119806_location of works.mxd
Date: 15/12/2010



Annex C

Project Organization Chart with Contact Details

Project Organization During Construction Phase (with contact details)

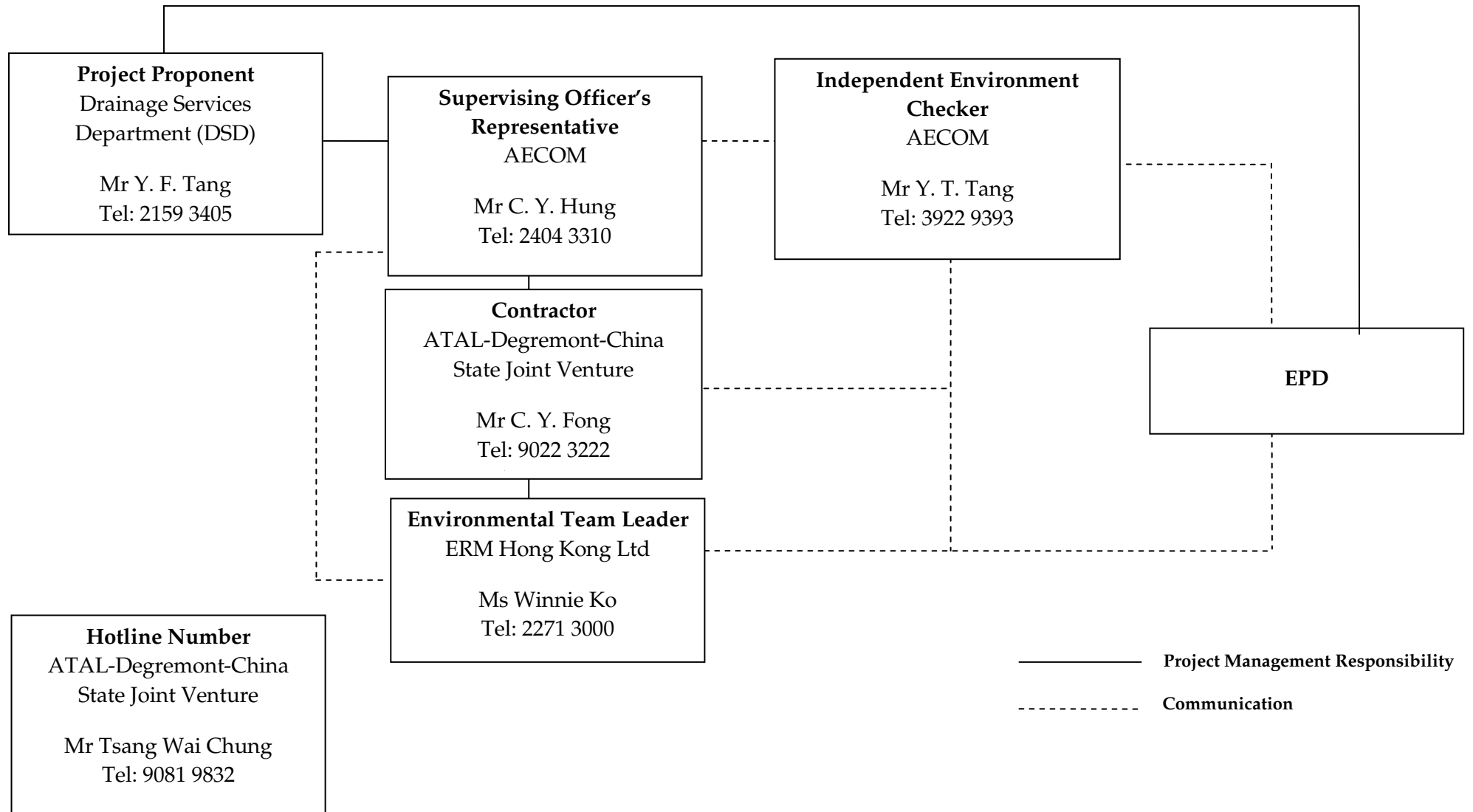

Annex D

Locations of Air Quality Monitoring Stations

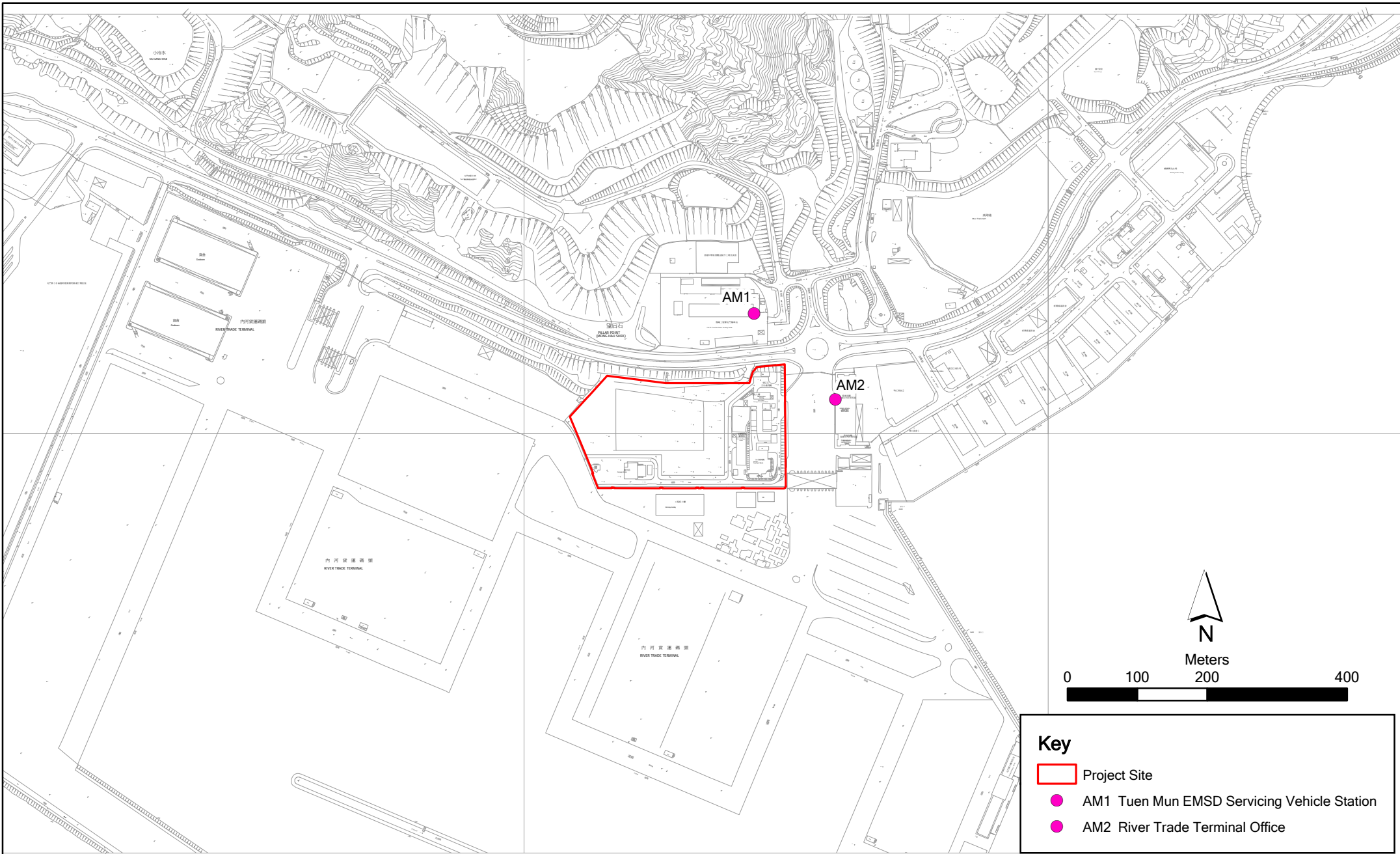

Key

- Project Site
- AM1 Tuen Mun EMSD Servicing Vehicle Station
- AM2 River Trade Terminal Office

Annex D

Contract No. DC/2008/03 Design, Build and Operate of Pillar Point Sewage Treatment Works

File: 0119806_Site Boundary.mxd
Date: 15/12/2010

**Environmental
Resources
Management**





AM1 – Tuen Mun EMSD Servicing Vehicle Station



AM2 - River Trade Terminal Office

Annex E

Monitoring Schedule of Reporting Month and Next Month

**Contract No. DC/2008/03 - Design, Build and Operate Pillar Point Sewage Treatment Works
(Tuen Mun EMSD Servicing Vehicle Station - AM1 & River Trade Terminal Office - AM2)
August 2014**

Sunday	Monday	Tuesday	Wednesday	Thursday	Friday	Saturday
					01-Aug	02-Aug
03-Aug	04-Aug	05-Aug	06-Aug	07-Aug	08-Aug	09-Aug
			3X1-hr & 1X 24-hr TSP			
10-Aug	11-Aug	12-Aug	13-Aug	14-Aug	15-Aug	16-Aug
		3X1-hr & 1X 24-hr TSP				
17-Aug	18-Aug	19-Aug	20-Aug	21-Aug	22-Aug	23-Aug
	3X1-hr & 1X 24-hr TSP				3X1-hr & 1X 24-hr TSP	
24-Aug	25-Aug	26-Aug	27-Aug	28-Aug	29-Aug	30-Aug
				3X1-hr & 1X 24-hr TSP		
31-Aug						

**Contract No. DC/2008/03 - Design, Build and Operate Pillar Point Sewage Treatment Works
(Tuen Mun EMSD Servicing Vehicle Station - AM1 & River Trade Terminal Office - AM2)
September 2014**

Sunday	Monday	Tuesday	Wednesday	Thursday	Friday	Saturday
	01-Sep	02-Sep	03-Sep	04-Sep	05-Sep	06-Sep
			3X1-hr & 1X 24-hr TSP			
07-Sep	08-Sep	09-Sep	10-Sep	11-Sep	12-Sep	13-Sep
	3X1-hr & 1X 24-hr TSP	Public Holiday			3X1-hr & 1X 24-hr TSP	
14-Sep	15-Sep	16-Sep	17-Sep	18-Sep	19-Sep	20-Sep
				3X1-hr & 1X 24-hr TSP		
21-Sep	22-Sep	23-Sep	24-Sep	25-Sep	26-Sep	27-Sep
			3X1-hr & 1X 24-hr TSP			
28-Sep	29-Sep	30-Sep				
		3X1-hr & 1X 24-hr TSP				

Annex F

Calibration Reports for HVSs

TSP Monitoring Equipment

Monitoring Station ID	Location	Monitoring Equipment		Last Calibration Date	Next Calibration Date
<i>24-hr and 1-hr TSP</i>		HVS	Calibrator		
AM1	Tuen Mun EMSD Vehicle Servicing Station	GMW GS-2310 (S/N 7580)	CM-AIR-43 (S/N 0438320)	02 July 2014	02 September 2014
AM2	River Trade Terminal Office	GMW GS-2310 (S/N 1252)	CM-AIR-43 (S/N 0438320)	02 July 2014	02 September 2014

High-Volume TSP Sampler
5-Point Calibration Record

Location : EMSD
 Calibrated by : K.T.Ho
 Date : 02/07/2014

Sampler

Model : GMWS-2310 ACCU-VOL
 Serial Number : S/N 7580

Calibration Office and Standard Calibration Relationship

Serial Number : 2454
 Service Date : 24 Mar 2014
 Slope (m) : 2.07593
 Intercept (b) : -0.00102
 Correlation Coefficient(r) : 0.99996

Standard Condition

Pstd (hpa) : 1013
 Tstd (K) : 298.18

Calibration Condition

Pa (hpa) : 1007
 Ta(K) : 305

Resistance Plate	dH [green liquid] (inch water)	Z	X=Qstd (cubic meter/min)	IC	Y
1 18 holes	11.5	3.342	1.610	54	53.22
2 13 holes	9.0	2.957	1.425	46	45.33
3 10 holes	6.8	2.570	1.238	37	36.46
4 7 holes	4.5	2.091	1.008	27	26.61
5 5 holes	2.6	1.589	0.766	18	17.74

Sampler Calibration Relationship

Slope(m):42.483 Intercept(b): -15.507 Correlation Coefficient(r): 0.9990

Checked by: Magnum Fan

Date: 10/07/2014

High-Volume TSP Sampler
5-Point Calibration Record

Location : River Trade
Calibrated by : P.F.Yeung
Date : 02/07/2014

Sampler

Model : GMWS-2310 ACCU-VOL
Serial Number : S/N 1252

Calibration Orifice and Standard Calibration Relationship

Serial Number : 2454
Service Date : 24 Mar 2014
Slope (m) : 2.07593
Intercept (b) : -0.00102
Correlation Coefficient(r) : 0.99996

Standard Condition

Pstd (hpa) : 1013
Tstd (K) : 298.18

Calibration Condition

Pa (hpa) : 1007
Ta(K) : 305

Resistance Plate	dH [green liquid] (inch water)	Z	X=Qstd (cubic meter/min)	IC	Y
1 18 holes	11.2	3.298	1.589	64	63.07
2 13 holes	9.1	2.973	1.433	56	55.19
3 10 holes	7.3	2.663	1.283	48	47.31
4 7 holes	4.6	2.114	1.019	36	35.48
5 5 holes	2.6	1.589	0.767	22	21.68

Sampler Calibration Relationship

Slope(m):49.712 Intercept(b): -16.001 Correlation Coefficient(r): 0.9995

Checked by: Magnum Fan

Date: 10/07/2014



TISCH ENVIRONMENTAL, INC.
 145 SOUTH MIAMI AVE
 VILLAGE OF CLEVELAND, OH
 45002
 513.467.9000
 877.263.7610 TOLL FREE
 513.467.9009 FAX

ORIFICE TRANSFER STANDARD CERTIFICATION WORKSHEET TE-5025A

Date - Mar 24, 2014 Rootsmeter S/N 0438320 Ta (K) - 293
 Operator Tisch Orifice I.D. - 2454 Pa (mm) - 758.19

PLATE OR Run #	VOLUME START (m3)	VOLUME STOP (m3)	DIFF VOLUME (m3)	DIFF TIME (min)	METER DIFF Hg (mm)	ORFICE DIFF H2O (in.)
1	NA	NA	1.00	1.4740	3.2	2.00
2	NA	NA	1.00	1.0340	6.4	4.00
3	NA	NA	1.00	0.9240	7.9	5.00
4	NA	NA	1.00	0.8820	8.8	5.50
5	NA	NA	1.00	0.7270	12.7	8.00

DATA TABULATION

Vstd	(x axis) Qstd	(y axis)	Va	(x axis) Qa	(y axis)
1.0103	0.6854	1.4245	0.9958	0.6755	0.8791
1.0061	0.9730	2.0146	0.9916	0.9590	1.2433
1.0040	1.0866	2.2524	0.9895	1.0709	1.3900
1.0028	1.1370	2.3623	0.9884	1.1206	1.4579
0.9976	1.3722	2.8491	0.9832	1.3524	1.7583
Qstd slope (m) = 2.07593			Qa slope (m) = 1.29991		
intercept (b) = -0.00102			intercept (b) = -0.00063		
coefficient (r) = 0.99996			coefficient (r) = 0.99996		
y axis = SQRT[H2O(Pa/760) (298/Ta)]			y axis = SQRT[H2O(Ta/Pa)]		

CALCULATIONS

Vstd = Diff. Vol [(Pa-Diff. Hg)/760] (298/Ta)
 Qstd = Vstd/Time

Va = Diff Vol [(Pa-Diff Hg)/Pa]
 Qa = Va/Time

For subsequent flow rate calculations:

Qstd = 1/m { [SQRT(H2O(Pa/760) (298/Ta))] - b }
 Qa = 1/m { [SQRT H2O(Ta/Pa)] - b }

Annex G

24-hour and 1-hour TSP Monitoring Results

Annex G - 24-hour and 1-hour TSP Monitoring Results

1-hour TSP Monitoring Results

Station AM1

Date	Start Time	Finish Time	Weather	TSP Concentration ($\mu\text{g}/\text{m}^3$)	Action Level ($\mu\text{g}/\text{m}^3$)	Limit Level ($\mu\text{g}/\text{m}^3$)	Site Conditions / Observations / Remarks	Temperature ($^{\circ}\text{C}$)	Wind Speed * (m/s)	Sampler ID	Filter ID
06-08-2014	13:10	14:10	Fine	106	343	500	Construction Work in Progress	31.0	*	7580	3911
	14:10	15:10	Fine	94	343	500	Construction Work in Progress	31.0	*	7580	3912
	15:10	16:10	Fine	99	343	500	Construction Work in Progress	31.0	*	7580	3913
12-08-2014	13:10	14:10	Fine	95	343	500	Construction Work in Progress	31.0	*	7580	3954
	14:10	15:10	Fine	109	343	500	Construction Work in Progress	31.0	*	7580	3955
	15:10	16:10	Fine	108	343	500	Construction Work in Progress	31.0	*	7580	3956
18-08-2014	13:10	14:10	Sunny	115	343	500	Construction Work in Progress	30.0	*	7580	3973
	14:10	15:10	Sunny	104	343	500	Construction Work in Progress	30.0	*	7580	3974
	15:10	16:10	Sunny	103	343	500	Construction Work in Progress	30.0	*	7580	3975
22-08-2014	13:10	14:10	Sunny	89	343	500	Construction Work in Progress	30.0	*	7580	3990
	14:10	15:10	Sunny	113	343	500	Construction Work in Progress	30.0	*	7580	3991
	15:10	16:10	Sunny	111	343	500	Construction Work in Progress	30.0	*	7580	3992
28-08-2014	13:10	14:10	Sunny	106	343	500	Construction Work in Progress	31.0	*	7580	4111
	14:10	15:10	Sunny	104	343	500	Construction Work in Progress	31.0	*	7580	4112
	15:10	16:10	Sunny	90	343	500	Construction Work in Progress	31.0	*	7580	4113
				Min.	89						
				Max.	115						
				Average	103						

* Wind Speed data is presented in the Meteorological Data table

Annex G - 24-hour and 1-hour TSP Monitoring Results

1-hour TSP Monitoring Results

Station AM2

Date	Start Time	Finish Time	Weather	TSP Concentration ($\mu\text{g}/\text{m}^3$)	Action Level ($\mu\text{g}/\text{m}^3$)	Limit Level ($\mu\text{g}/\text{m}^3$)	Site Conditions / Observations / Remarks	Temperature ($^{\circ}\text{C}$)	Wind Speed * (m/s)	Sampler ID	Filter ID
06-08-2014	13:00	14:00	Fine	102	383	500	Construction Work in Progress	31.0	*	1252	3907
	14:00	15:00	Fine	102	383	500	Construction Work in Progress	31.0	*	1252	3908
	15:00	16:00	Fine	104	383	500	Construction Work in Progress	31.0	*	1252	3909
12-08-2014	13:00	14:00	Fine	111	383	500	Construction Work in Progress	31.0	*	1252	3950
	14:00	15:00	Fine	116	383	500	Construction Work in Progress	31.0	*	1252	3951
	15:00	16:00	Fine	108	383	500	Construction Work in Progress	31.0	*	1252	3952
18-08-2014	13:00	14:00	Sunny	107	383	500	Construction Work in Progress	30.0	*	1252	3969
	14:00	15:00	Sunny	120	383	500	Construction Work in Progress	30.0	*	1252	3970
	15:00	16:00	Sunny	115	383	500	Construction Work in Progress	30.0	*	1252	3971
22-08-2014	13:00	14:00	Sunny	122	383	500	Construction Work in Progress	30.0	*	1252	3986
	14:00	15:00	Sunny	123	383	500	Construction Work in Progress	30.0	*	1252	3987
	15:00	16:00	Sunny	104	383	500	Construction Work in Progress	30.0	*	1252	3988
28-08-2014	13:00	14:00	Sunny	111	383	500	Construction Work in Progress	32.0	*	1252	3997
	14:00	15:00	Sunny	122	383	500	Construction Work in Progress	32.0	*	1252	3998
	15:00	16:00	Sunny	123	383	500	Construction Work in Progress	32.0	*	1252	3999
			Min.	102							
			Max.	123							
			Average	113							

* Wind Speed data is presented in the Meteorological Data table

Annex G - 24-hour and 1-hour TSP Monitoring Results

24-hour TSP Monitoring Results

Station AM1

Start		Finish		Weather	Filter Weight (g)		Elapsed Time Reading		Sampling Time (hrs)	Flow Rate (m ³ /min)			TSP Conc. (µg/m ³)	Action Level (µg/m ³)	Limit Level (µg/m ³)	Observations / Remarks	Sampler ID	Filter ID		
Date	Time	Date	Time		Initial	Final	Initial	Final		Initial	Final	Average								
06-08-2014	16:10	07-08-2014	16:10	Fine	2.7316	2.8669	24620.20	24644.20	24	1.31	1.31	1.31	72	183	260	Construction work in progress	7580	3914		
12-08-2014	16:10	13-08-2014	16:10	Fine	2.7402	2.8509	24647.20	24671.20	24	1.31	1.31	1.31	59	183	260	Construction work in progress	7580	3957		
18-08-2014	16:10	19-08-2014	16:10	Sunny	2.7459	2.8689	24674.20	24698.20	24	1.31	1.31	1.31	65	183	260	Construction work in progress	7580	3976		
22-08-2014	16:10	23-08-2014	16:10	Sunny	2.7493	2.8557	24701.20	24725.20	24	1.31	1.31	1.31	56	183	260	Construction work in progress	7580	3993		
28-08-2014	16:10	29-08-2014	16:10	Sunny	2.7105	2.8292	24728.20	24752.20	24	1.31	1.31	1.31	63	183	260	Construction work in progress	7580	4114		
												Min.	56							
												Max.	72							
												Average	63							

24-hour TSP Monitoring Results

Station AM2

Start		Finish		Weather	Filter Weight (g)		Elapsed Time Reading		Sampling Time (hrs)	Flow Rate (m ³ /min)			TSP Conc. (µg/m ³)	Action Level (µg/m ³)	Limit Level (µg/m ³)	Observations / Remarks	Sampler ID	Filter ID		
Date	Time	Date	Time		Initial	Final	Initial	Final		Initial	Final	Average								
06-08-2014	16:00	07-08-2014	16:00	Fine	2.7487	2.8609	24619.20	24643.20	24	1.22	1.22	1.22	64	192	260	Construction work in progress	1252	3910		
12-08-2014	16:00	13-08-2014	16:00	Fine	2.7524	2.8700	24646.20	24670.20	24	1.22	1.22	1.22	67	192	260	Construction work in progress	1252	3953		
18-08-2014	16:00	19-08-2014	16:00	Sunny	2.7299	2.8471	24673.20	24697.20	24	1.22	1.22	1.22	67	192	260	Construction work in progress	1252	3972		
22-08-2014	16:00	23-08-2014	16:00	Sunny	2.7443	2.8724	24700.20	24724.20	24	1.22	1.22	1.22	73	192	260	Construction work in progress	1252	3989		
28-08-2014	16:00	29-08-2014	16:00	Sunny	2.7038	2.8291	24727.20	24751.20	24	1.22	1.22	1.22	71	192	260	Construction work in progress	1252	4000		
												Min.	64							
												Max.	73							
												Average	68							

Meteorological Data Extracted from the Hong Kong Observatory

Date	Weather	Tuen Mun Station						
				Average Air Temperature (°C)	Average Relative Humidity (%)	Total Rainfall (mm)	Average Wind Speed (km/h)	Wind Direction
06-08-2014	Fine	26	31	28.1	69-97	36.5	0-18	S/SE
07-08-2014	Fine	26	32	29.0	71-96	14.5	0-14	S/SE
12-08-2014	Fine	26	33	29.4	73-98	102.9	0-18	SW/SE
13-08-2014	Fine	25	29	26.6	89-98	166.1	0-18	S
18-08-2014	Sunny	27	32	29.9	63-87	0.0	0-15	S
19-08-2014	Sunny	25	32	28.5	72-94	42.1	0-22	S/SW
22-08-2014	Sunny	26	32	29.1	61-92	0.0	0-18	S/SE
23-08-2014	Sunny	26	33	29.5	67-89	Trace	0-18	SE
28-08-2014	Sunny	28	32	29.8	69-87	0.3	0-25	SE
29-08-2014	Sunny	27	33	29.9	57-88	0.0	0-21	SE

Annex G TSP Monitoring Results

1-hr TSP Levels for the Past 4 Months AM1 (Tuen Mun EMSD Vehicle Servicing Station)

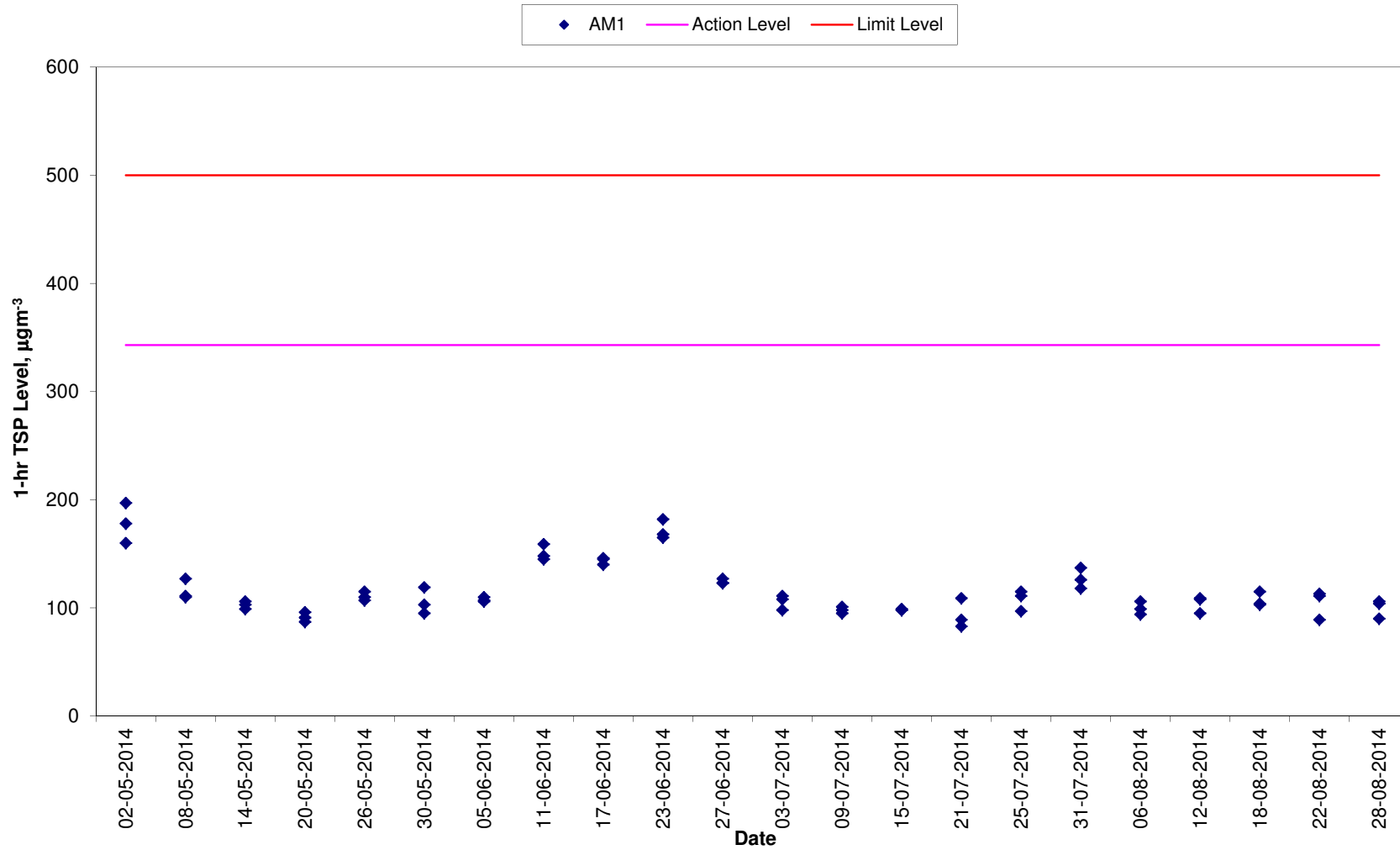

Annex G TSP Monitoring Results

1-hr TSP Levels for the Past 4 Months AM2 (River Trade Terminal Office)

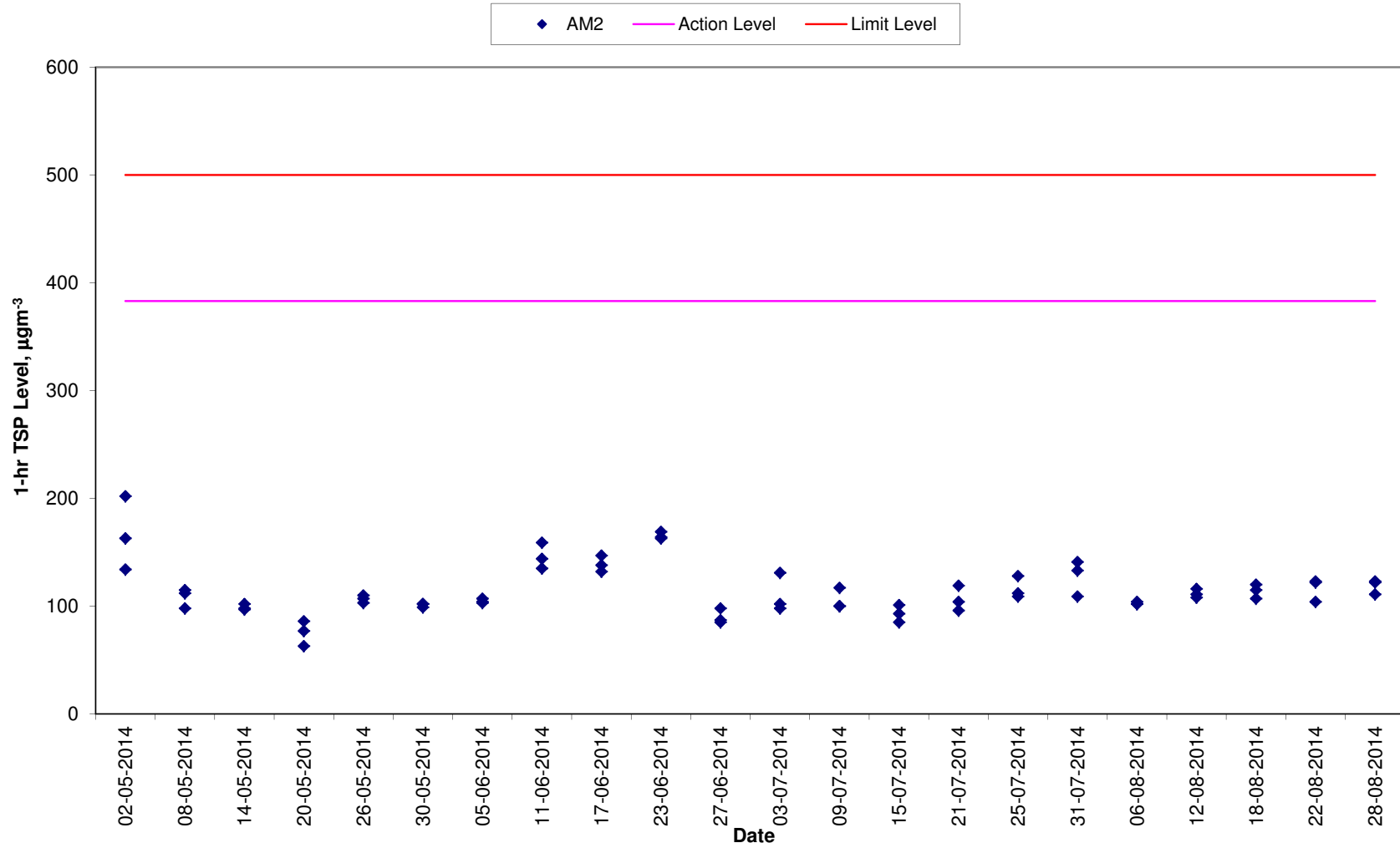

Annex G TSP Monitoring Results

24-hr TSP Levels for the Past 4 Months
AM1 (Tuen Mun EMSD Vehicle Servicing Station)

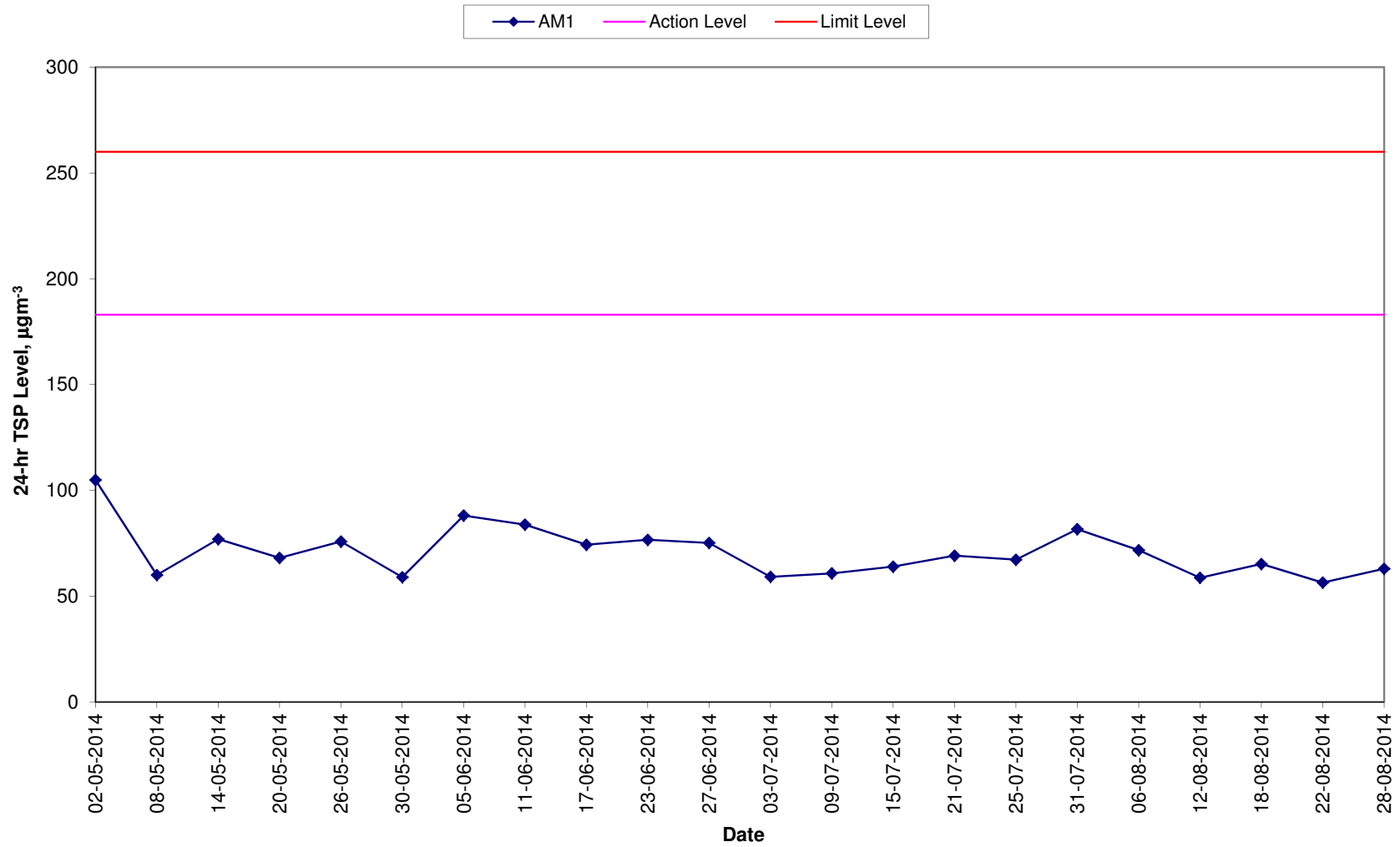

Annex G TSP Monitoring Results

24-hr TSP Levels for the Past 4 Months AM2 (River Trade Terminal Office)

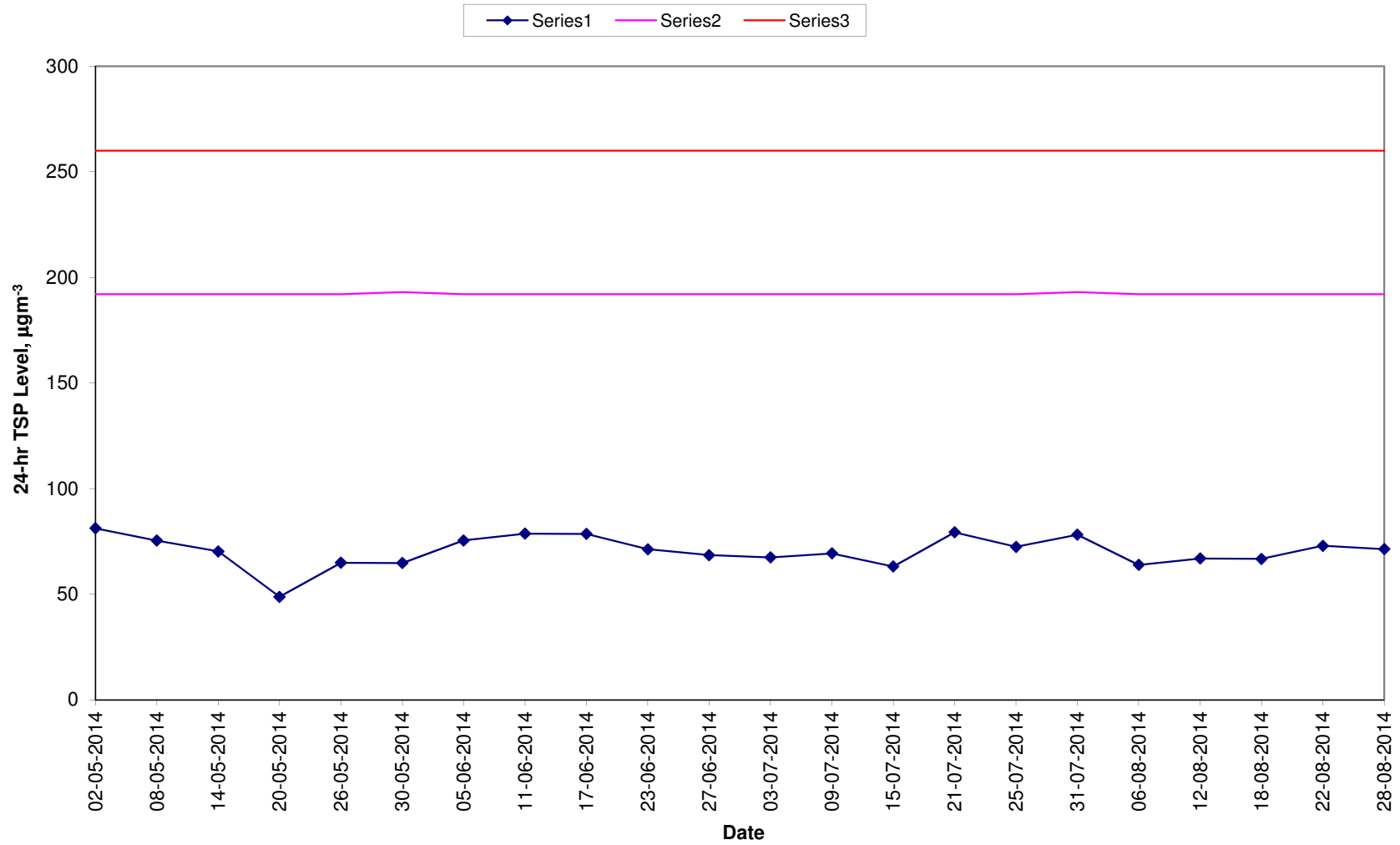

Annex H

Event/Action Plan for Air Quality Monitoring

Table H1 *Event Action Plan for Air Quality Monitoring*

Action Level/Limit Level	Environmental Team Leader (ETL)	Independent Environmental Checker (IEC)	Supervising Officer Representative (SOR)	Contractor
<i>Action Level</i>				
Exceedance for one sample	<ul style="list-style-type: none"> Identify source, investigate the causes of complaint and propose remedial measures; Inform IEC and SOR; Repeat measurement to confirm findings; Increase monitoring frequency to daily. 	<ul style="list-style-type: none"> Check monitoring data submitted by ET; Check Contractor’s working method. 	<ul style="list-style-type: none"> Notify Contractor and DSD. 	<ul style="list-style-type: none"> Rectify any unacceptable practice; Amend working methods if appropriate.
Exceedance for two or more consecutive samples	<ul style="list-style-type: none"> Identify source; Inform IEC and SOR; Advise the SOR on the effectiveness of the proposed remedial measures; Repeat measurements to confirm findings; Increase monitoring frequency to daily; Discuss with IEC and Contractor on remedial actions required; If exceedance continues, arrange meeting with IEC and SOR; If exceedance stops, cease additional monitoring. 	<ul style="list-style-type: none"> Check monitoring data submitted by ET; Check Contractor’s working method; Discuss with ET and Contractor on possible remedial measures; Advise the ET on the effectiveness of the proposed remedial measures; Supervise Implementation of remedial measures. 	<ul style="list-style-type: none"> Confirm receipt of notification of exceedance in writing; Notify Contractor and DSD; Ensure remedial measures properly implemented. 	<ul style="list-style-type: none"> Submit proposals for remedial actions to IEC within three working days of notification; Implement the agreed proposals; Amend proposal if appropriate.

Action Level/Limit Level	Environmental Team Leader (ETL)	Independent Environmental Checker (IEC)	Supervising Officer Representative (SOR)	Contractor
<i>Limit Level</i>				
Exceedance for one sample	<ul style="list-style-type: none"> Identify source, investigate the causes of exceedance and propose remedial measures; Inform IEC, SOR, DSD and EPD; Repeat measurement to confirm finding; Increase monitoring frequency to daily; Assess effectiveness of Contractor's remedial actions and keep IEC, EPD, DSD and SOR informed of the results. 	<ul style="list-style-type: none"> Check monitoring data submitted by ET; Check Contractor's working method; Discuss with ET and Contractor on possible remedial measures; Advise the SOR on the effectiveness of the proposed remedial measures; Supervise implementation of remedial measures. 	<ul style="list-style-type: none"> Confirm receipt of notification of exceedance in writing; Notify Contractor; Ensure remedial measures properly implemented. 	<ul style="list-style-type: none"> Take immediate action to avoid further exceedance; Submit proposals for remedial actions to IEC within three working days of notification; Implement the agreed proposals; Amend proposal if appropriate.
Exceedance for two or more consecutive samples	<ul style="list-style-type: none"> Notify IEC, SOR, DSD and EPD; Identify source; Repeat measurement to confirm findings; Increase monitoring frequency to daily; Carry out analysis of Contractor's working procedures to determine possible mitigation to be implemented; Arrange meeting with IEC and SOR to discuss the remedial actions to be taken; Assess effectiveness of Contractor's remedial actions and keep IEC, EPD, DSD and SOR informed of the results; If exceedance stops, cease additional monitoring. 	<ul style="list-style-type: none"> Discuss amongst SOR, ET, and Contractor on the potential remedial actions; Review Contractor's remedial actions whenever necessary to assure their effectiveness and advise the SOR accordingly; Supervise the implementation of remedial measures. 	<ul style="list-style-type: none"> Confirm receipt of notification of exceedance in writing; Notify Contractor; In consolidation with the IEC, agree with the Contractor on the remedial measures to be implemented; Ensure remedial measures properly implemented; If exceedance continues, consider what portion of the work is responsible and instruct the Contractor to stop that portion of work until the exceedance is abated. 	<ul style="list-style-type: none"> Take immediate action to avoid further exceedance; Submit proposals for remedial actions to IEC within three working days of notification; Implement the agreed proposals; Resubmit proposals if problem still not under control; Stop the relevant portion of works as determined by the SOR until the exceedance is abated.

Annex I

Implementation Schedule of Mitigation Measures

Annex I Summary of Mitigation Measures Implementation Schedule

Type of Impact	Environmental Protection Measures	Location/ Timing	Status
<i>Summary of Environmental Mitigation Measures in the EIA and EM&A Manual</i>			
<i>Construction Phase</i>			
Air Quality	Dust mitigation measures stipulated in <i>the Air Pollution Control (Construction Dust) Regulation</i> shall be incorporated to control Post emission. Notice shall be given to authority prior to commencing of work.	Work sites / during construction period	Notice of works commencement was submitted to EPD on 3 August 2010.
Water Quality	The practices outlined in ProPECC PN 1/94 Construction Site Drainage should be adopted. It is recommended to install perimeter channels in the works areas to intercept runoff as site boundary prior to the commencement of any earthwork. To prevent storm runoff from washing across exposed soil surfaces, intercepting channels should be provided. Drainage channels are also required to convey site runoff to sand/silt traps and oil interceptors. Provision of regular cleaning and maintenance can ensure the normal operation of these facilities throughout the construction period. Any practical options for the diversion and re-alignment of drainage should comply with both engineering and environmental requirements in order to ensure adequate hydraulic capacity of all drains.	Work site/During the construction period	<>
Water Quality	There is a need to apply to EPD for a discharge license under the WPCO for discharging effluent from the construction site. The discharge quality is required to meet the requirements specified in the discharge license. All the runoff and wastewater generated from the works areas should be treated so that it satisfies all the standards listed in the TM-DSS. Reuse and recycling of the treated effluent can minimize water consumption and reduce the effluent discharge volume. The beneficial uses of the treated effluent may include dust suppression, wheel washing and general cleaning. If monitoring of the treated effluent quality from the works areas is required during the construction phase of the Project, the monitoring should be carried out in accordance with the WPCO license which is under the ambit of regional office (RO) of EPD.	Work site/During the construction period	√ Discharge licence was awarded by EPD on 7 December 2010.
Water Quality	The construction programme should be properly planned to minimize soil excavation, if any, in rainy seasons. This prevents soil erosion from	Work site/During the construction period	<>

Type of Impact	Environmental Protection Measures	Location/ Timing	Status
	<p>exposed soil surfaces. Any exposed soil surfaces should also be properly protected to minimize dust emission. In areas where a large amount of exposed soil exists, earth bunds or sand bags should be provided. Exposed stockpiles should be covered with tarpaulin or impervious sheets at all times. The stockpiles of materials should be placed at locations away from any stream course so as to avoid releasing materials into the water bodies. Final surfaces of earthworks should be compacted and protected by permanent work. It is suggested that haul roads should be paved with concrete and the temporary access roads protected using crushed stone or gravel, wherever practicable. Wheel washing facilities should be provided at all site exists to ensure that earth, mud and debris would not be carried out of the works areas by vehicles.</p>		
Water Quality	<p>Good sites practices should be adopted to clean the rubbish and litter on the construction sites so as to prevent the rubbish and litter from spreading from the site area. It is recommended to clean the construction sites on a regular basis.</p>	Work site/During the construction period	√
Water Quality	<p>The presence of construction workers generates sewage. It is recommended to provide sufficient chemical toilets in the works areas. The toilet facilities should be more than 30m from any watercourse. A licensed water collector should be deployed to clean the chemical toilets on a regular basis. The construction workers can also make use of the existing toilet facilities within the PPSTW as necessary.</p>	Work site/During the construction period	√
Water Quality	<p>Notices should be posted at conspicuous locations to remind the workers not to discharge any sewage or wastewater into the nearby environment during the construction phase of the project. Regular environmental audit on the construction phase of the project. Regular environmental audit on the construction site can provide an effective control of any malpractices and can achieve continual improvement of environmental performance on site.</p>	Work site/During the construction period	√
Waste Management	<p>Contractor must register as a chemical waste producer if chemical wastes would be produced from the construction activities. The Waste Disposal Ordinance (Cap 354) and its subsidiary regulations in particular the Waste Disposal (Chemical Waste) (General) Regulation</p>	Work site/During the construction period	√

Type of Impact	Environmental Protection Measures	Location/ Timing	Status
	should be observed and complied with for control of chemical wastes.		
Waste Management	Any service shop and maintenance facilities should be located on hard standings within a bunded area, and stumps and oil interceptors should be provided. Maintenance of vehicles and equipment involving activities with potential for leakage and spillage should only be undertaken within the areas appropriately equipped to control these discharges.	Work site/During the construction period	√
Waste Management	<p>Disposal of chemical wastes should be carried out in compliance with the Waste Disposal Ordinance. The Code of Practice on the Packaging, Labelling and Storage of Chemical Wastes published under the Waste Disposal Ordinance details the requirements to deal with the chemical wastes. General requirements are given as follows:</p> <ul style="list-style-type: none"> • Suitable containers should be used to hold the chemical wastes to avoid leakage or spillage during storage, handling and transport. • Chemical waste containers should be suitably labelled, to notify and warn the personnel who are handling the wastes, to avoid accidents. • Storage area should be selected at a safe location on site and adequate space should be allocated to the storage area. 	Work site/During the construction period	√
Waste Management	<p><i>Good Site Practices</i> Recommendations for good site practices during the construction activities include:</p> <ul style="list-style-type: none"> • Nomination of an approved person, such as a site manager, to be responsible for good site practices, arrangements for collection and effective disposal to an appropriate facility, of all wastes generated at the site • Training of site personnel in proper waste management and chemical handling procedures • Provision of sufficient waste disposal points and regular collection of waste • Appropriate measures to minimise windblown litter and dust during transportation of waste by either covering trucks or by 	Work site/During the construction period	√

Type of Impact	Environmental Protection Measures	Location/ Timing	Status
	<p>transporting wastes in enclosed containers</p> <ul style="list-style-type: none"> • Regular cleaning and maintenance programme for drainage systems, sumps and oil interceptors. • Separation of chemical wastes for special handling and appropriate treatment at the Chemical Waste Treatment Facility. 		
Waste Management	<p><i>Waste Reduction Measures</i></p> <p>Waste reduction is best achieved at the planning and design stage, as well as by ensuring the implementation of good site practices. Recommendations to achieve waste reduction include:</p> <ul style="list-style-type: none"> • Segregation and storage of different types of waste in different containers, skips or stockpiles to enhance reuse or recycling of materials and their proper disposal. • Encourage collection of aluminium cans by providing separate labelled bins to enable this waste to be segregated from other general refuse generated by the work force • Proper storage and site practices to minimise the potential for damage or contamination of construction materials. • Plan and stock construction materials carefully to minimise amount of waste generated and avoid unnecessary generation of waste. 	Work site / During planning & design stage, and construction stage	√
Waste Management	<p><i>General Refuse</i></p> <p>General refuse should be stored in enclosed bins or compaction units separate from C&D material. A reputable waste collector should be employed by the contractor to remove general refuse from the site, separately from C&D material. Preferably an enclosed and covered area should be provided to reduce the occurrence of 'wind blown' light material.</p>	Work site / During the construction period	√
Waste Management	<p><i>Construction and Demolition Material</i></p> <p>In order to minimise the impact resulting from collection and transportation of C&D material for off-site disposal, the excavated</p>	Work site / During design stage & construction period	√

Type of Impact	Environmental Protection Measures	Location/ Timing	Status
	<p>material generated from site formation works for the proposed new facilities and units at the STW should be reused on-site as far as practicable. The surplus excavated material should be disposed of at the designated public fill reception facility, as agreed with the Secretary of the Public Fill Committee, for other beneficial uses.</p>		
Waste Management	<p>Mitigation measures and good site practices should be followed to control potential environmental impact from handling and transportation of C&D material. The mitigation measures include:</p> <ul style="list-style-type: none"> • Where it is unavoidable to have transient stockpiles of C&D material pending collection for disposal, the transient stockpiles shall be located away from waterfront or storm drains as far as possible. • Open stockpiles of construction materials or construction wastes on-site should be covered with tarpaulin or similar fabric. • Skip hoist for material transport should be totally enclosed by impervious sheeting. • Every vehicle should be washed to remove any dusty materials from its body and wheels before leaving a construction site • The area where vehicle washing takes place and the section of the road between the washing facilities and the exit point should be paved with concrete, bituminous materials or hardcores. • The load of dusty materials carried by vehicle leaving a construction site should be covered entirely by clean impervious sheeting to ensure dust materials do not leak from the vehicle. • All dusty materials should be sprayed with water prior to any loading, unloading or transfer operation so as to maintain the dusty materials wet. • The height from which excavated materials are dropped should be controlled to a minimum practical height to limit fugitive dust generation from unloading. 	Work site / During design stage & construction period	√
Waste Management	<p>When disposing C&D material at a public filling facility, it shall be noted that the material shall only consist of earth, building debris and broken rock and concrete. The material shall be free from marine mud, household refuse, plastic, metals, industrial and chemical waste, animal</p>	Work site/During design stage & construction period	√

Type of Impact	Environmental Protection Measures	Location/ Timing	Status
	<p>and vegetable matter, and other material considered to be unsuitable by the Filling Supervisor. In order to monitor the disposal of the surplus C&D material at the designed public fill reception facility and to control fly tipping, a trip-ticket system should be included as one of the contractual requirements and implemented by an Environmental Team undertaking the Environmental Monitoring and Audit work with reference to the ETWB TCW No. 31/2004 "Trip Ticket System for Disposal of Construction and Demolition Materials" as attached in Appendix 7-1. An Independent Environmental Checker should be responsible for auditing the results of the system.</p>		
Waste Management	<p><i>Chemical Waste</i></p> <p>If chemical wastes are produced at the construction site, the Contractor would be required to register with the EPD as a Chemical Waste Producer and to follow the guidelines stated in the Code of Practice on the Packaging, Labelling and Storage of Chemical Wastes. Good quality containers compatible with the chemical wastes should be used, and incompatible chemicals should be stored separately. Appropriate labels should be securely attached on each chemical waste container indicating the corresponding chemical characteristics of the chemical waste, such as explosive, flammable, oxidizing, irritant, toxic, harmful, corrosive, etc. The Contractor shall use a licensed collector to transport and dispose of the chemical wastes, to either the Chemical Waste Treatment Centre, or another licensed facility, in accordance with the Waste Disposal (Chemical Waste) (General) Regulation.</p>	Work site / During the construction period	√
Landscape & Visual	<p><u>Temporary Tree Nurseries</u></p> <p>Temporary tree nurseries may be set up for the transplanted tree and proposed trees at an early stage to allow small trees to grow during the construction periods. By the time when planting area becomes available, trees mature and increase in trunk & spread size. They will require minimal pruning and suffer much less damage during transplanting when comparing the travel distance from an on-site nursery to an off-site nursery.</p> <p>Besides, these trees may also be positioned as visual mitigation during</p>	Work site/ During design stage & construction period	√. A tree nursery has been set up off-site near the site office.

Type of Impact	Environmental Protection Measures	Location/ Timing	Status
	the construction period.		
Landscape & Visual	<p><u>No-intrusion Zone</u></p> <p>To maximize protection to existing trees and ground vegetation, construction contracts may designate “No-intrusion Zone” to various areas within the site boundary with rigid and durable fencing for each individual no-intrusion zone. The contractor should close monitor and restrict the site working staff not to enter the “no-intrusion zone”, even for non-direct construction activities and storage of equipment.</p>	Work site/During design stage & construction period	<>
Landscape & Visual	<p><u>Hoarding</u></p> <p>Hoarding or boundary fencing for construction shall be considered. It should be sensitively designed, subtle, camouflaged and more ‘permeable’ so that they fit into the existing environment when looking from outside.</p>	Work site/During design stage & construction period	√
Landscape & Visual	<p><u>Dust and Erosion Control for Exposed Soil</u></p> <p>Excavation works and demolition of existing building blocks and which will be highly visible form surrounding areas should be well planned and with precautions to suppress dust. Exposed soil shall be covered or ‘camouflaged’ and watered often. Areas that are expected to be left with bare soil for a long period of time after excavation shall be properly covered with suitable protective fabric. Silt and erosion shall be controlled by ground barriers around the slope cutting area..</p>	Work site/During design stage & construction period	<>
Landscape & Visual	<p><u>Existing Tree Record Inventory</u></p> <p>All retained trees should be record photographically at the commencement of the Contract, and carefully protected during the construction period. Detailed tree protection specification shall be allowed and included in the Contract Specification, which specifying the tree protection requirement, submission and approval system, and the tree monitoring system.</p>	Work site/During design stage & construction period	√

Type of Impact	Environmental Protection Measures	Location/ Timing	Status
Landscape & Visual	<p><u>Construction Light</u></p> <p>All security floodlights for construction sites shall be equipped with adjustable shield, frosted diffusers and reflective covers, and be carefully controlled to minimize light pollution and night-time glare to nearby residences and GIC users. The Contractor shall consider other security measures which shall minimize the visual impacts.</p>	Work site / During design stage & construction period	√
Landscape & Visual	<p><u>Tree Transplanting</u></p> <p>Apart from the 18 numbers of "<i>Leucaena leucocephala</i>", which are proposed to be felled in accordance with ETWB TCW No. 3/2006, all the affected trees shall be transplanted. Where practicable, trees shall be directly transplanted to permanent on-site locations. The location of the transplanted tree is shown in Figure 8.9.1.</p>	Work site / During design stage & construction period	√.
Landscape & Visual	<p><u>Tree Compensation Ratio</u></p> <p>The total number of compensatory trees planted in the project area shall not be less than 1:1 ratios by new trees. Required numbers and locations of compensatory trees shall be determined and agreed with Government during the tree felling application process under ETWCTC 3/2006. Compensatory trees shall be at least heavy standard size to create "immediate" greening effect. 81 numbers of "<i>Cassia surattensis</i>" will be provided as the additional compensatory planting for loss of greenery in the area due to removal of the affected trees. The location of the additional compensatory planting is shown in Figure 8.9.1.</p>	Work site / During design stage & construction period	N/A
Landscape & Visual	<p><u>Re-use of Existing Soil and Advance formation of Planting Area</u></p> <p>Existing topsoil shall be re-used where possible for new planting areas within the project. Advance formation of planting area and early implementation of the plating works can minimize adverse impact on trees. The construction program shall consider using the soil removed from one phase for backfilling another. Suitable storage ground, gathering ground and mixing ground may be set up on-site as necessary.</p>	Work site / During design stage & construction period	√

Type of Impact	Environmental Protection Measures	Location/ Timing	Status
Landscape & Visual	<p><u>Establishment Period</u></p> <p>12 month establishment period for the soft landscape works will be allowed in the main contract. Most construction contracts in Hong Kong require the Contractor to carry out routine horticultural operations, including watering, pruning, weeding, pest control, replacement of dead plants etc. to ensure healthy establishment of new planting during a 12 month establishment period. This period also serves as a kind of warranty / guarantee on the quality of the plants supplied and installed by the Contractor. Monthly monitoring during the first year of establishment period is recommended.</p>	Work site/During operation period	N/A. To be implemented during operation phase of Project.
Landscape & Visual	<p><u>Re-instatement of excavated Area</u></p> <p>All excavated area and disturbed area for utilities diversion, temporary road diversion, and pipeline woks will be reinstated to former conditions, subject to applicable Government Standards.</p>	Work site / During design stage & operation period	N/A. To be implemented during operation phase of Project.
Landscape & Visual	<p><u>Appearance and Greening for the proposed structures</u></p> <p>Compatible design, construction materials and surface finishes of the proposed structure should match with the nearby existing external appearance of PPSTW buildings for achieving visual uniformity. Finishing materials shall have due consideration to form, basic color, color/ tone variation, micro-and macro-texture, and reflectivity/ light absorbance to avoid glare. Planting, such as turf, low groundcovers and climbers, may also be planted on top of these elements to provide greening and aesthetic effect.</p>	Work site / During design stage & operation period	N/A. To be implemented during operation phase of Project.
<i>Summary of Key Environmental Mitigation Measures in Contract Requirements</i>			
Air Quality	Only Ultra-low-sulphur diesel (ULSD) should be used for all diesel-operated plants and equipments on site	Work sites / during construction period	√
Air Quality and Noise	Plants and equipments of good operation conditions should be used on site.	Work sites / during construction period	√
Noise	No diesel hammers should be used for piling works	Work sites / during construction period	√
Noise	Construction Noise Permits (CNP) should be applied for works conducted outside non-restricted hours.	Work sites / during construction period	√
Noise	Quiet construction equipments and the quietest practicable working	Work sites / during construction period	√

Type of Impact	Environmental Protection Measures	Location/ Timing	Status
	methodologies should be adopted for works whenever feasible. Noise labels should be provided for air compressors. Hoods and cover panels of generators and air compressors should be closed during operation. Noise labels should be provided for air compressors and hand-held percussive breakers.		
Waste Management	Temporary works construction on site should minimize the use of timber to reduce the quantity of C&D waste generated during works period.	Work sites / during construction period	√
Landscape and Visual	Retained or to-be-transplanted trees on site should be properly protected from physical damages and soil compacts with temporary fencing or hessian armouring whenever feasible.	Work sites / during construction period	<>

Remark:

- √ Compliance of Mitigation Measures
- <> Compliance of Mitigation but need improvement
- x Non-compliance of Mitigation Measures
- ▲ Non-compliance of Mitigation Measures but rectified by ATAL-Degrémont-China State JV
- Δ Deficiency of Mitigation Measures but rectified by ATAL-Degrémont-China State JV
- N/A Not Applicable in Reporting Period

Annex J

Waste Flow Table

**Contract No. : DC/2008/03 - Design, Build and Operate Pillar Point Sewage Treatment Works
Monthly Summary Waste Flow Table**

Month	Actual Quantities of Inert C&D Materials Generated (see Note 13)					Actual Quantities of Non-inert C&D Materials (Construction Waste) Generated (see Note 13)				
	Total Quantity Generated	Reused in the Contract	Reused in other Projects	Hard Rocks & Large Broken Concrete	Disposed as Public Fill	Metals (see Note 1)	Paper/ cardboard packaging (see Note 1)	Plastics (see Note 2)	Chemical Waste	Others, e.g. general refuse (see Note 3)
	tonne	tonne	tonne	tonne	tonne	kilogram	kilogram	kilogram	Litre	tonne
Nov 2010	2,248.00	0.00	0.00	55.00	2248.00	60.00	100.00	0.00	0.00	18.05 (see Note 4)
Dec 2010	11,314.00 (see Note 4)	0.00	0.00	225.00	11314.00	100.00	120.00	20.00	0.00	28.40 (see Note 4)
Jan 2011	58,383.00 (see Note 4)	0.00	0.00	3,000.00	58,382.90	250.00	280.00	60.00	0.00	4.59 (see Note 4)
Sub-total	71,945.00	0.00	0.00	3280.00	71944.90	410.00	500.00	80.00	0.00	51.04
Feb 2011	12,855.00	0.00	0.00	1,050.00	12,854.70	100.00	150.00	50.00	0.00	2.43 (see Note 4)
Mar 2011	22,859.00	0.00	0.00	1,500.00	22,858.70	150.00	180.00	55.00	0.00	9.02
Apr 2011	8,547.00 (see Note 7)	0.00	5,684.00(see Note 5, 7)	550.00	2,863.30	50.00	30.00	15.00	0.00	5.78
Sub-total	44,261.00	0.00	5684.00	3100.00	38576.70	300.00	360.00	120.00	0.00	17.23
May 2011	6,293.00 (see Note 7)	0.00	11.00 (see Note 5, 7)	425.00	6,282.00 (see Note 7)	45.00	25.00	10.00	360.00 (see Note 7)	8.83
Jun 2011	4,587.00 (see Note 7)	0.00	0.00 (see Note 7)	313.00	4,586.00 (see Note 7)	40.00	30.00	15.00	0.00	7.10
Jul 2011	523.00	0.00	0.00	25.00	522.90	15.00	5.00	10.00	0.00	7.20
Sub-total	11,403.00	0.00	11.00	763.00	11391.50	100.00	60.00	32.00	360.00	23.13
Aug 2011	571.00 (see Note 11)	0.00	0.00	50.00	571.00 (see Note 11)	0.00	0.00	15.00	450.00 (see Note 8)	6.12
Sept 2011	235.00	0.00	0.00	25.00	235	20.00	0.00	0.00	0.00	12.15 (see Note 9)
Oct 2011	5,705.00 (see Note 10)	0.00	0.00	650.00	5,705.00 (see Note 10)	100.00	0.00	0.00	0.00	2.98
Sub-total	6,511.00	0.00	0.00	725.00	6511.00	120.00	0.00	15.00	450.00	21.25
Nov 2011	6,294.00	0.00	0.00	775.00	6,294.00	50.00	0.00	0.00	0.00	44.84
Dec 2011	3,011.00	0.00	0.00	263.00	3,011.00	20.00	0.00	0.00	0.00	17.14
Jan 2012	349.00	64.00	0.00	25.00	284.60	20.00	150.00	0.00	0.00	49.01

Month	Actual Quantities of Inert C&D Materials Generated (see Note 13)					Actual Quantities of Non-inert C&D Materials (Construction Waste) Generated (see Note 13)				
	Total Quantity Generated	Reused in the Contract	Reused in other Projects	Hard Rocks & Large Broken Concrete	Disposed as Public Fill	Metals (see Note 1)	Paper/ cardboard packaging (see Note 1)	Plastics (see Note 2)	Chemical Waste	Others, e.g. general refuse (see Note 3)
	tonne	tonne	tonne	tonne	tonne	kilogram	kilogram	kilogram	Litre	tonne
Sub-total	9,654.00	64.00	0.00	1063.00	9589.60	90.00	150.00	0.00	0.00	110.99
Feb 2012	3,371.00	30.00	0.00	2,810.00	3,341.00	150.00	0.00	0.00	0.00	48.72
Mar 2012	6,460.00	3,000.00	0.00	625.00	3,459.70	30.00	0.00	0.00	0.00	41.10
Apr 2012	3,774.00	3,000.00	0.00	250.00	774.40	40.00	0.00	0.00	0.00	40.01
Sub-total	13,605.00	6,030.00	0.00	3685.00	7575.10	220.00	0.00	0.00	0.00	129.83
May 2012	7,936.00	5,600.00	0.00	750.00	2,336.20	40.00	0.00	10.00	0.00	75.19
Jun 2012	13,091.00	7,500.00	0.00	875.00	5,590.80	40.00	35.50	8.00	0.00	66.74
Jul 2012	11,972.00	8,600.00	0.00	825.00	3,372.50	40.00	36.40	5.00	0.00	100.50
Sub-total	32,999.00	21,700.00	0.00	2450.00	11299.50	120.00	70.90	23.00	0.00	242.43
Aug 2012	11,660.00	11,000.00	0.00	950.00	659.80	30.00	10.00	6.00	0.00	78.77
Sept 2012	3,055.00	1,500.00	0.00	920.00	1,555.38	30.00	40.00	5.00	0.00	118.80
Oct 2012	2,657.00	200.00	0.00	500.00	2,457.01	30.00	59.40	8.00	0.00	124.04
Sub-total	17,372.00	12,700.00	0.00	2370.00	4672.19	90.00	109.40	19.00	0.00	321.61
Nov 2012	2,691.00	250.00	0.00	750.00	2,441.01	50.00	25.00	10.00	0.00	128.08
Dec 2012	4,319.00	400.00	0.00	200.00	3,919.13	60.00	20.00	15.00	0.00	165.28
Jan 2013	4,442.00	100.00	0.00	200.00	4,341.56	200.00	40.00	20.00	0.00	111.23
Sub-total	11,452.00	750.00	0.00	1150.00	10701.70	310.00	85.00	45.00	0.00	404.59
Feb 2013	1,286.00	85.00	0.00	50.00	1,201.23	180.00	35.00	16.00	0.00	99.44
Mar 2013	900.00	900.00	0.00	120.00	0.00	120.00	45.00	10.00	0.00	97.43
Apr 2013	680.00	680.00	0.00	300.00	0.00	22.00	50.00	15.00	0.00	80.21
Sub-total	2866.00	1665.00	0.00	470.00	1201.23	322.00	130.00	41.00	0.00	277.08
May 2013	1443.37	100.00	0.00	1020.00	1343.37	40.00	43.00	9.00	0.00	46.88 (see Note 16)

Month	Actual Quantities of Inert C&D Materials Generated (see Note 13)					Actual Quantities of Non-inert C&D Materials (Construction Waste) Generated (see Note 13)				
	Total Quantity Generated	Reused in the Contract	Reused in other Projects	Hard Rocks & Large Broken Concrete	Disposed as Public Fill	Metals (see Note 1)	Paper/ cardboard packaging (see Note 1)	Plastics (see Note 2)	Chemical Waste	Others, e.g. general refuse (see Note 3)
	tonne	tonne	tonne	tonne	tonne	kilogram	kilogram	kilogram	Litre	tonne
June 2013	1993.06	50.00	0.00	850.00	1943.06	100.00	60.00	5.00	0.00	53.89
July 2013	1246.64	100.00	0.00	1100.00	1146.64	100.00	60.00	10.00	0.00	71.15
Sub-total	4683.07	250.00	0.00	2970.00	4433.07	240.00	163.00	24.00	0.00	171.92
August 2013	873.73	120.00	0.00	700.00	753.73	50.00	60.00	8.00	0.00	63.95
September 2013	748.43	50.00	0.00	650.00	698.43	40.00	60.00	5.00	0.00	41.28
October 2013	1701.99	45.00	0.00	1500.00	1656.99	20.00	60.00	5.00	0.00	34.79
Sub-total	3324.15	215.00	0.00	2850.00	3109.15	110.00	180.00	18.00	0.00	140.02
November 2013	1602.35	60.00	0.00	1490.00	1542.35	18.00	60.00	50.00	0.00	36.44
December 2013	1357.16	80.00	0.00	1100.00	1277.16	35.00	60.00	50.00	0.00	16.84
January 2014	714.34	20.00	0.00	690.00	694.34	16.00	60.00	97.00	0.00	27.82
Sub-total	3,673.85	160.00	0.00	3,280.00	3,513.85	69.00	180.00	197.00	0.00	81.10
February 2014	944.11	20.00	0.00	900.00	924.11	50.00	60.00	1120.00	0.00	7.66
March 2014	1200.95	50.00	0.00	1100.00	1150.95	40.00	50.00	5.00	0.00	19.78
April 2014	1803.58	50.00	0.00	1700.00	1753.58	40.00	30.00	5.00	0.00	12.13
Sub-total	3948.64	120.00	0.00	3700.00	3828.64	130.00	140.00	1130.00	0.00	39.57
May 2014	576.53	50.00	0.00	500.00	526.53	40.00	30.00	5.00	0.00	14.07
June 2014	707.48	30.00	0.00	640.00	677.48	30.00	20.00	0.00	0.00	11.65
July 2014	675.82	20.00	0.00	640.00	655.82	20.00	10.00	0.00	0.00	25.28
Sub-total	1959.83	100.00	0.00	1780.00	1859.83	90.00	60.00	5.00	0.00	51.00
August 2014	758.68	10.00	0.00	740.00	748.68	10.00	5.00	0.00	0.00	9.86

Month	Actual Quantities of Inert C&D Materials Generated (see Note 13)					Actual Quantities of Non-inert C&D Materials (Construction Waste) Generated (see Note 13)				
	Total Quantity Generated	Reused in the Contract	Reused in other Projects	Hard Rocks & Large Broken Concrete	Disposed as Public Fill	Metals (see Note 1)	Paper/ cardboard packaging (see Note 1)	Plastics (see Note 2)	Chemical Waste	Others, e.g. general refuse (see Note 3)
	tonne	tonne	tonne	tonne	tonne	kilogram	kilogram	kilogram	Litre	tonne
Total	240415	43764	5695	34376	190956	2731	2193	1752	810	2093

- Notes:
- (1) Metal and paper/cardboard packaging were collected by recycler for recycling.
 - (2) Plastics refer to plastic bottles/containers, plastic sheets/foam from packaging material collected by recycler for recycling.
 - (3) General refuse was disposed of at WENT by subcontractors.
 - (4) The waste flow data for November and December 2010, January and February 2011 was updated in March 2011 based on SOR's comments and has been confirmed by the Contractor.
 - (5) The inert C&D materials were reused in the Contract No. EP/SP/58/08 at Tuen Mun Tsang Tsui.
 - (6) Chemical waste was collected through the licensed chemical waste collector, Dunwell Ind. (Holdings) Ltd, with the waste collection licence number 7111-757-W0015-WC.
 - (7) The waste flow data for April, May and June 2011 was updated in August 2011 based on SOR's comments and has been confirmed by the Contractor.
 - (8) The waste flow data of chemical waste for August 2011 was updated in October 2011 based on Contractor's revised waste flow summary.
 - (9) The waste flow data of general refuse for September 2011 was updated in November 2011 based on Contractor's revised waste flow summary.
 - (10) The waste flow data of C&D material for October 2011 was updated in December 2011 based on Contractor's revised waste flow summary.
 - (11) The waste flow data of C&D material for August 2011 was updated in January 2012 based on SOR's comments and has been confirmed by the Contractor.
 - (12) The waste flow data of metal and paper/cardboard packaging for June 2011 was revised in August 2012.
 - (13) The quantity of inert and non-inert C&D material generated from May 2012 to December and imported fill material was updated by the Contractor on 6 November 2012.
 - (14) The quantity of Rocks & Broken Concrete from November 2010 to November 2012 was updated by the Contractor on 12 December 2012.
 - (15) The quantity of C&D material reused in this Contract in Oct, Nov and Dec 2012 were updated by the Contractor on 5 January 2013.
 - (16) The quantity of general refuse in this Contract for May 2013 was updated by the Contractor in June 2013.

Annex K

Environmental Complaint,
Environmental Summons
and Persecution Log

Annex K Cumulative Complaint and Summons/Prosecutions Log

Reporting Month	Number of Complaints in Reporting Month	Number of Summons/Prosecutions in Reporting Month
November 2010	0	0
December 2010	0	0
January 2011	0	0
February 2011	0	0
March 2011	0	0
April 2011	0	0
May 2011	0	0
June 2011	0	0
July 2011	0	0
August 2011	0	0
September 2011	0	0
October 2011	0	0
November 2011	0	0
December 2011	0	0
January 2012	0	0
February 2012	0	0
March 2012	0	0

Reporting Month	Number of Complaints in Reporting Month	Number of Summons/Prosecutions in Reporting Month
April 2012	0	0
May 2012	0	0
June 2012	0	0
July 2012	0	0
August 2012	0	0
September 2012	0	0
October 2012	0	0
November 2012	0	0
December 2012	0	0
January 2013	0	0
February 2013	0	0
March 2013	0	0
April 2013	0	0
May 2013	0	0
June 2013	0	0
July 2013	0	0
August 2013	0	0
September 2013	0	0
October 2013	0	0
November 2013	0	0

Reporting Month	Number of Complaints in Reporting Month	Number of Summons/Prosecutions in Reporting Month
December 2013	0	0
January 2014	0	0
February 2014	0	0
March 2014	0	0
April 2014	0	0
May 2014	0	0
June 2014	0	0
July 2014	0	0
August 2014	0	0
Overall Total	0	0

Annex L

Construction Programme of the Project

Activity ID	Description	Original Duration	Early Start	Early Finish	Late Start	Late Finish	Actual Start	Actual Finish	2014							
									JUN	JUL	AUG	SEP	OCT	NOV		
Design and Design Checking of Permanent Works																
Submission and Consent																
Submission and Approval																
DPD071397	DDA7A: P&ID Final Package Apr/ No comment	120	19JUN2012	25SEP2014	19JUN2012	17MAY2014	19JUN2012									DDA7A: P&ID Final Package
DPD072395	DDA7B: Ctrl Philosophy Final Pack. Subm.	120	01JAN2014	16AUG2014	01JAN2014	17JAN2014	01JAN2014									DDA7B: Ctrl Philosophy Final Pack. Subm.
DPD072397	DDA7B: Ctrl Philosophy Final Pack. Apr/No Com.	120	17AUG2014	14DEC2014	18JAN2014	17MAY2014										
DPD077197	DDA8A: Pump sys Final Pack. Apr/No Com.	120	19JUN2012	25SEP2014	19JUN2012	17MAY2014	19JUN2012									DDA8A: Pump sys Final Pack.
DPD077395	DDA8B: Odour Duct Final Pack. Subm.	60	17MAY2014	15SEP2014	17MAY2014	17JAN2014	17MAY2014									DDA8B: Odour Duct Final Pack.
DPD077397	DDA8B: Odour Duct Final Pack. Apr/No Com.	120	16SEP2014	13JAN2015	18JAN2014	17MAY2014										
DPD077797	DDA8C: Pipe/Duct Supp. Final Pack. Apr/No Com.	120	05OCT2012	25SEP2014	05OCT2012	17MAY2014	05OCT2012									DDA8C: Pipe/Duct Supp. Fin
DPD081195	DDA9A-D: Elect. sys design Final Pack. Subm.	90	17MAY2014	15OCT2014	17MAY2014	17JAN2014	17MAY2014									DDA9A-D: Elect. sys
DPD081197	DDA9A-D: Elect. sys dgn Final Pack. Apr/No Com.	120	16OCT2014	12FEB2015	18JAN2014	17MAY2014										
DPD081595	DDA9E: UPS Final Pack. Subm.	60	17MAY2014	15SEP2014	17MAY2014	17JAN2014	17MAY2014									DDA9E: UPS Final Pack. Subm.
DPD081597	DDA9E: UPS Final Pack. Apr/No Com.	120	16SEP2014	13JAN2015	18JAN2014	17MAY2014										
DPD081795	DDA9F: E&L sys Final Pack. Subm.	90	17MAY2014	15OCT2014	17MAY2014	17JAN2014	17MAY2014									DDA9F: E&L sys Fin
DPD081797	DDA9F: E&L sys Final Pack. Apr/No Com.	120	16OCT2014	12FEB2015	18JAN2014	17MAY2014										
DPD084197	DDA9J: Hazardous Zone Final Pack. Apr/No Com.	120	22MAR2012	25SEP2014	22MAR2012	17MAY2014	22MAR2012									DDA9J: Hazardous Zone Fin
DPD084395	DDA9K: Renew. Engy. Final Pack. Subm.	90	17MAY2014	15OCT2014	17MAY2014	17JAN2014	17MAY2014									DDA9K: Renew. Eng
DPD084397	DDA9K: Renew. Engy. Final Pack. Apr/No Com.	120	16OCT2014	12FEB2015	18JAN2014	17MAY2014										
DPD084595	DDA9L Elect Typ.Drg Final Pack. Subm.	60	17MAY2014	15SEP2014	17MAY2014	17JAN2014	17MAY2014									DDA9L Elect Typ.Drg Final Pack.
DPD084597	DDA9L Elect Typ.Drg Final Pack. Apr/No Com.	120	16SEP2014	13JAN2015	18JAN2014	17MAY2014										
DPD090900	Remaining Works: Approve of Other DDA submission	0		16AUG2014		17MAY2014										◆ Remaining Works: Approve of Other DDA su
DPD093400	E&M CMS Subm (Control & Instr.) Approval	150	01JUN2013	04NOV2014	01JUN2013	17MAY2014	01JUN2013									E&M CMS S
DPD093800	E&M CMS Subm (BS-P&D.) Approval	150	01JUN2013	04NOV2014	01JUN2013	17MAY2014	01JUN2013									E&M CMS S
DPD104100	PTW: DDA13EFGH Civil Final Pack. Subm.	120	31JAN2012	25SEP2014	31JAN2012	17MAY2014	31JAN2012									PTW: DDA13EFGH Civil Fin
DPD104500	PTW: DDA13ABCD E&M Final Pack. Subm.	120	02JAN2012	15OCT2014	02JAN2012	17MAY2014	02JAN2012									PTW: DDA13ABCD
DPD154100	Septic: DDA14EFGH Civil Final Pack. Subm.	120	31MAY2012	15OCT2014	31MAY2012	17MAY2014	31MAY2012									Septic: DDA14EFGH
DPD154500	Septic: DDA14ABCD E&M Final Pack. Subm.	120	06AUG2012	25SEP2014	06AUG2012	17MAY2014	06AUG2012									Septic: DDA14ABCD E&M F
DPD176100	WB & Acc: DDA27EF Civil Final Pack. Subm.	90	27NOV2012	15OCT2014	27NOV2012	17MAY2014	27NOV2012									WB & Acc: DDA27E
DPD176500	WB & Acc: DDA27AD E&M Final Pack. Subm.	60	28JUL2014	25SEP2014	19NOV2013	17JAN2014										WB & Acc: DDA27AD E&M F
DPD176600	WB & Acc: DDA27AD E&M Final Pack. Apr/No Com.	120	26SEP2014	23JAN2015	18JAN2014	17MAY2014										
DPD214500	CEPT: DDA15ABCD E&M Final Pack. Subm.	120	30MAR2012	25OCT2014	30MAR2012	17MAY2014	30MAR2012									CEPT: DDA15A
DPD314500	UV: DDA17ABCD E&M Final Pack. Subm.	120	18JUL2012	25OCT2014	18JUL2012	17MAY2014	18JUL2012									UV: DDA17ABC
DPD503551	Chemical: DDA 22D E&MCR Dwg - SO rtoC x 2	28	04NOV2011	11AUG2014	04NOV2011	17MAY2014	04NOV2011									Chemical: DDA 22D E&MCR Dwg - SO rtoC x 2
DPD714100	DOU: DDA18EFGH Civil Final Pack. Subm.	120	09MAR2012	25OCT2014	09MAR2012	17JAN2014	09MAR2012									DOU: DDA18EF
DPD714200	DOU: DDA18EFGH Civil Final Pack. Apr/No Com.	120	26OCT2014	22FEB2015	18JAN2014	17MAY2014										
DPD714500	DOU: DDA18ABCD E&M Final Pack. Subm.	120	17MAY2014	04NOV2014	17MAY2014	17JAN2014	17MAY2014									DOU: DDA1
DPD714600	DOU: DDA18ABCD E&M Final Pack. Apr/No Com.	120	05NOV2014	04MAR2015	18JAN2014	17MAY2014										

Start date	14JUL2010
Finish date	04JUL2015
Data date	28JUL2014
Run date	03SEP2014
Page number	1A
Project name	PR45
c Primavera Systems, Inc.	

Page 1A of 5B
 PPSTW Remaining Works Programme After Substantial Completion - update 28 July 2014 - Three Months Rolling

- Early bar
- Progress bar
- Critical bar
- Summary bar
- ◆ Start milestone point
- ◆ Finish milestone point

Activity ID	Description	Original Duration	Early Start	Early Finish	Late Start	Late Finish	Actual Start	Actual Finish	2014												
									JUN	JUL	AUG	SEP	OCT	NOV							
DPD804500	Admin B: DDA23ABCD E&M Final Pack. Subm.	120	17MAY2014	15OCT2014	17MAY2014	17JAN2014	17MAY2014														
DPD804600	Admin B: DDA23ABCD E&M Final Pack. Apr/No Com.	120	16OCT2014	12FEB2015	18JAN2014	17MAY2014															
DPD905500	EB1: DDA19ACD E&M Final Pack. Subm.	90	26JUL2012	15OCT2014	26JUL2012	17MAY2014	26JUL2012														
DPD906100	EB3/MCC: DDA20EFGH Civil Final Pack. Subm.	120	17MAY2014	15OCT2014	17MAY2014	17JAN2014	17MAY2014														
DPD906200	EB3/MCC: DDA20EFGH Civil Final Pack. Apr/No Com.	120	16OCT2014	12FEB2015	18JAN2014	17MAY2014															
DPD907100	RefurB: DDA25EFG Civil Final Pack. Subm.	120	06SEP2014	03JAN2015	20SEP2013	17JAN2014															
DPD907500	RefurB: DDA25ABCD E&M Final Pack. Subm.	120	20SEP2014	17JAN2015	20SEP2013	17JAN2014															
DPD908100	Flow MC: DDA24EF Civil Final Pack. Subm.	120	01JUL2014	04NOV2014	01JUL2014	17JAN2014	01JUL2014														
DPD908200	Flow MC: DDA24EF Civil Final Pack. Apr/No Com.	120	05NOV2014	04MAR2015	18JAN2014	17MAY2014															
DPD908500	Flow MC: DDA24BD E&M Final Pack. Subm.	90	08OCT2014	05JAN2015	20OCT2013	17JAN2014															
DPD918100	Mis: DDA28 Civil Final Pack. Subm.	120	28JUL2014	24NOV2014	20SEP2013	17JAN2014															
DPD923751	Mis: DDA 28I Road & Ext. Lighting - Rtoc x2	28	11JAN2012	16AUG2014	11JAN2012	17MAY2014	11JAN2012														
DPD929300	CLP: DDA29 Civil Final Pack. Subm.	60	17MAY2014	16AUG2014	17MAY2014	17JAN2014	17MAY2014														
DPD929400	CLP: DDA29 Civil Final Pack. Apr/No Com.	120	17AUG2014	14DEC2014	18JAN2014	17MAY2014															
DPD929500	CLP: DDA29 E&M Final Pack. Subm.	60	17MAY2014	16AUG2014	17MAY2014	17JAN2014	17MAY2014														
DPD929600	CLP: DDA29 E&M Final Pack. Apr/No Com.	120	17AUG2014	14DEC2014	18JAN2014	17MAY2014															
DPD999910	Dummy: End of Design Stage	1	28JUL2014	28JUL2014	17MAY2014	17MAY2014															
Civil and Structural Works																					
Chemically Enhanced Primary Treatment System																					
Building and Structures																					
CCC156660B	CEPT: MCC Gravel on roof	6	21JUL2014	06AUG2014	21JUL2014	17MAY2014	21JUL2014														
Septic Waste Collection Facilities																					
Building and Structures																					
CCC170740B	Septic: FRP frame for louver	1	28JUL2014	28JUL2014	28JUL2014	28JUL2014															
CCC170900B	Septic: Insulation board on roof	1	28JUL2014	28JUL2014	28JUL2014	28JUL2014															
CCC170910B	Septic: Cement sand screeding on roof	2	28JUL2014	28JUL2014	28JUL2014	28JUL2014															
Auxiliary Building																					
Building and Structures																					
CCC970105	Gate House: Commencement of Construction	0	28JUL2014		20SEP2013																
CCC970110	Gate House: Excavation	6	28JUL2014	04AUG2014	28JUL2014	18DEC2013	28JUL2014														
CCC970120	Gate House: Foundation	10	05AUG2014	18AUG2014	19DEC2013	02JAN2014															
CCC970130	Gate House: Backfilling Work	5	19AUG2014	25AUG2014	03JAN2014	08JAN2014															
CCC970140	Gate House: Superstructure	20	26AUG2014	22SEP2014	09JAN2014	06FEB2014															
CCC970150	Gate House: Remove Temp Support	18	23SEP2014	17OCT2014	10FEB2014	01MAR2014															
CCC970160	Gate House: ABWF Works	20	23SEP2014	21OCT2014	07FEB2014	01MAR2014															
CCC970200	Gate House: Temporary Gate House for FS insp	30	05AUG2014	15SEP2014	08APR2014	17MAY2014															
Landscaping Works																					
Miscellaneous Works																					
CMT995350	Landscape Preparation Works	4	22MAY2014	30JUL2014	22MAY2014	04DEC2013	22MAY2014														

Start date	14JUL2010
Finish date	04JUL2015
Data date	28JUL2014
Run date	03SEP2014
Page number	2A
Project name	PR45
© Primavera Systems, Inc.	

Page 2A of 5B
 PPSTW Remaining Works Programme After Substantial Completion - update 28 July 2014 - Three Months Rolling

- █ Early bar
- █ Progress bar
- █ Critical bar
- █ Summary bar
- ◆ Start milestone point
- ◆ Finish milestone point

Activity ID	Description	Original Duration	Early Start	Early Finish	Late Start	Late Finish	Actual Start	Actual Finish	2014							
									JUN	JUL	AUG	SEP	OCT	NOV		
CMT995360	Planting Works	7	31JUL2014	08AUG2014	05DEC2013	12DEC2013										
CMT995370	Establishment Works	8	11AUG2014	20AUG2014	28APR2014	08MAY2014										
CMT995380	Landscape Establishment Works	8	11AUG2014	20AUG2014	28APR2014	08MAY2014										
CMT995390	Tree Transplantation	8	21AUG2014	01SEP2014	09MAY2014	17MAY2014										
CMT995400	Preservation and Protection of Trees	8	21AUG2014	01SEP2014	09MAY2014	17MAY2014										
CMT995410	Irrigation System	8	31JUL2014	11AUG2014	09MAY2014	17MAY2014										
CMT995510	Landscape Softworks (West Area)	120	11AUG2014	28JAN2015	13DEC2013	17MAY2014										
CMT995750	Landscape Preparation PTW Area	4	13OCT2014	16OCT2014	28AUG2013	02SEP2013										
CMT995760	Planting Works	7	17OCT2014	27OCT2014	02SEP2013	10SEP2013										
CMT995770	Establishment Works	8	28OCT2014	06NOV2014	10SEP2013	19SEP2013										
CMT995780	Landscape Establishment Works	8	28OCT2014	06NOV2014	10SEP2013	19SEP2013										
CMT995810	Irrigation System	8	17OCT2014	28OCT2014	06MAR2014	14MAR2014										
CMT995910	Landscape Softworks (ex PTW Area)	120	28OCT2014	15APR2015	13DEC2013	17MAY2014										
Refurbishment and Renewal Works																
Miscellaneous Works																
CCM000110	Refurbishment of Existing Buildings / Structures	60	10FEB2014	05SEP2014	10FEB2014	19SEP2013	10FEB2014									
External Works																
Miscellaneous Works																
CWM101088	Flowmeter: Arrange bypass pipe A	15	28JUL2014	15AUG2014	08AUG2013	28AUG2013										
CWM101090	Flowmeter: Const. Weir A at Extg Outfall Manhole	6	18AUG2014	25AUG2014	27SEP2013	07OCT2013										
CWM101109	Flowmeter: Arrange bypass pipe B	20	18AUG2014	12SEP2014	29AUG2013	26SEP2013										
CWM101110	Flowmeter: Const. Weir B at Extg Outfall Manhole	6	15SEP2014	22SEP2014	27SEP2013	07OCT2013										
CWM101120	Flowmeter: Backfill	12	26JUN2014	12AUG2014	26JUN2014	05FEB2014	26JUN2014									
CWM101500	Boundary Wall: Provision of New U-channel	60	23JAN2014	12SEP2014	23JAN2014	17MAY2014	23JAN2014									
CWM101600	Construction of Sitewide Roadworks	60	28NOV2013	19SEP2014	28NOV2013	12MAR2014	28NOV2013									
CWM101675	Construction of Access M010	30	15FEB2014	06AUG2014	15FEB2014	17MAY2014	15FEB2014									
CWM101680	Formation of Access M006 0+00 to 0+50	15	28JUL2014	15AUG2014	29APR2014	17MAY2014										
CWM101683	Construction of Access M006 0+00 to 0+50	30	12MAY2014	22AUG2014	12MAY2014	21FEB2014	12MAY2014									
CWM101685	Formation of Access M006 0+50 to 0+110	15	13AUG2014	02SEP2014	06FEB2014	22FEB2014										
CWM101688	Construction of Access M006 0+50 to 0+110	15	03SEP2014	23SEP2014	24FEB2014	12MAR2014										
CWM101689	Construction of Access M001	30	31MAY2014	05SEP2014	31MAY2014	19FEB2014	31MAY2014									
CWM101800	Installation of Sitewide Drainage	380	02JUN2012	19SEP2014	02JUN2012	12MAR2014	02JUN2012									
CWM103210	Demolish Extg Structures of PTW	75	01MAY2014	25SEP2014	01MAY2014	13AUG2013	01MAY2014									
CWM1033210	Backfill Extg PTW Area	75	28JUL2014	10OCT2014	14JUN2013	28AUG2013										
CWM215110B	Stockpile Area: Storm Drain bet S19 /CP20 to S20	51	23JAN2014	28JUL2014	23JAN2014	17MAY2014	23JAN2014									
CWM215120B	Stockpile Area: Storm Drain bet S20 to S21	30	16FEB2014	14AUG2014	16FEB2014	17MAY2014	16FEB2014									
CWM216020B	Access M004: Storm Drain bet R2 to R1	24	14FEB2014	06AUG2014	14FEB2014	26APR2014	14FEB2014									
CWM216030B	Access M004: Storm Drain bet R1 to S3	28	31JUL2014	27AUG2014	20APR2014	17MAY2014										

Start date	14JUL2010
Finish date	04JUL2015
Data date	28JUL2014
Run date	03SEP2014
Page number	3A
Project name	PR45
© Primavera Systems, Inc.	

Page 3A of 5B
 PPSTW Remaining Works Programme After Substantial Completion - update 28 July 2014 - Three Months Rolling

- █ Early bar
- █ Progress bar
- █ Critical bar
- █ Summary bar
- ◆ Start milestone point
- ◆ Finish milestone point

Activity ID	Description	Original Duration	Early Start	Early Finish	Late Start	Late Finish	Actual Start	Actual Finish	2014					
									JUN	JUL	AUG	SEP	OCT	NOV
CWM216120B	Access M003: Storm Drain bet S2A to CP2A / CP2B	25	14FEB2014	07AUG2014	14FEB2014	17MAY2014	14FEB2014		Access M003: Storm Drain bet S2A to CP2A / CP2B					
CWM216130B	Access M003: Storm Drain bet S2A to CP2E / CP2D	25	26FEB2014	19AUG2014	26FEB2014	17MAY2014	26FEB2014		Access M003: Storm Drain bet S2A to CP2E / CP2D					
CWM217000B	U channel	125	12OCT2013	10SEP2014	12OCT2013	17MAY2014	12OCT2013		U channel					
CWM225205B	LV Cable Ducts East of Extg PTW after demolish	30	26SEP2014	25OCT2014	07APR2014	06MAY2014			LV Cable Ducts East of Extg PTW after demolish					
CWM226300B	ELV Cable Ducts around stockpile area	24	21DEC2013	26AUG2014	21DEC2013	12MAR2014	21DEC2013		ELV Cable Ducts around stockpile area					
CWM229020	BW: ChC0+00 to ChC0+122.4 Type B	30	21FEB2014	24AUG2014	21FEB2014	09APR2014	21FEB2014		BW: ChC0+00 to ChC0+122.4 Type B					
CWM229200	BW: Main Gate at ChC0 / ChB0 Type B	7	27FEB2014	24AUG2014	27FEB2014	09APR2014	27FEB2014		BW: Main Gate at ChC0 / ChB0 Type B					
CWM229450	BW: ChD0+200 to ChD0+407.89 Type B	30	27FEB2014	24AUG2014	27FEB2014	09APR2014	27FEB2014		BW: ChD0+200 to ChD0+407.89 Type B					
CXT995340	Construction of Car Park	28	13OCT2014	19NOV2014	10APR2014	17MAY2014			Construction of Car Park					
CXT995420	Formation of Weighbridge at Egress	10	28JUL2014	08AUG2014	22JAN2014	07FEB2014			Formation of Weighbridge at Egress					
CXT995425	Weighbridge at Egress	40	11AUG2014	06OCT2014	08FEB2014	26MAR2014			Weighbridge at Egress					
CXT995430	Remaining Roadwork at Access M001 and M003	18	08SEP2014	02OCT2014	20FEB2014	12MAR2014			Remaining Roadwork at Access M001 and M003					
Statutory Works														
Fire Services - FSD														
Building and Structures														
SSF200510	FS: Submit Form FS314 & FS501 (2)	1	03OCT2014	03OCT2014	13MAR2014	13MAR2014			FS: Submit Form FS314					
SSF200520	FS: Inspection and re-inspection (2)	25	05NOV2014	09DEC2014	14MAR2014	12APR2014			FS: Inspection and re-inspection (2)					
Plumbing - WSD														
Building and Structures														
SSP200550	Watermain (PW2,CW2,GW2): WSD Insp & Re-insp.	25	29OCT2014	02DEC2014	26MAR2014	28APR2014			Watermain (PW2,CW2,GW2): WSD Insp & Re-insp.					
SSP203510	Watermain (FW &IW): Submit WW046 Part 4	1	28JUL2014	28JUL2014	14MAR2014	14MAR2014			Watermain (FW &IW): Submit WW046 Part 4					
SSP203520	Watermain (FW&IW): WSD Inspection and Re-insp'	25	29OCT2014	02DEC2014	15MAR2014	14APR2014			Watermain (FW&IW): WSD Inspection and Re-insp'					
E&M Works														
Procurement and Installation														
Building and Structures														
EMW163000	Access Control System Installation	55	15NOV2013	20OCT2014	15NOV2013	17MAY2014	15NOV2013		Access Control System Installation					
EMW164000	ALPR System Installation	55	15NOV2013	22AUG2014	15NOV2013	17MAY2014	15NOV2013		ALPR System Installation					
EMW165030	Access system installation (AB)	14	22MAR2014	08AUG2014	22MAR2014	17MAY2014	22MAR2014		Access system installation (AB)					
EMW165100	Egress Weight Bridge System Installation	25	07OCT2014	10NOV2014	27MAR2014	29APR2014			Egress Weight Bridge System Installation					
EMW165130	Access system installation in Gate House	14	22OCT2014	10NOV2014	30APR2014	17MAY2014			Access system installation in Gate House					
EMW165210	Access system installation (In WB)	14	22MAR2014	08AUG2014	22MAR2014	17MAY2014	22MAR2014		Access system installation (In WB)					
EMW601117	Sludge: Centrifuge Enclosure Manufact. & Delivey	40	17JUN2014	06AUG2014	17JUN2014	14APR2014	17JUN2014		Sludge: Centrifuge Enclosure Manufact. & Delivey					
EMW603116	Sludge: Centrifuge 1 Enclosure Installation	15	07AUG2014	27AUG2014	15APR2014	07MAY2014			Sludge: Centrifuge 1 Enclosure Installation					
EMW603126	Sludge: Centrifuge 2 Enclosure Installation	15	07AUG2014	27AUG2014	15APR2014	07MAY2014			Sludge: Centrifuge 2 Enclosure Installation					
EMW603136	Sludge: Centrifuge 3 Enclosure Installation	15	07AUG2014	27AUG2014	15APR2014	07MAY2014			Sludge: Centrifuge 3 Enclosure Installation					
EMW821140	Flowmeter: Flowmeter - Verification	10	23SEP2014	07OCT2014	08OCT2013	19OCT2013			Flowmeter: Flowmeter - Verification					
EMW9449810	OFPS: Refurbishment E&M equipment	80	01APR2014	19SEP2014	01APR2014	19SEP2013	01APR2014		OFPS: Refurbishment E&M equipment					
EMW951020	Outdoor: Lighting East of PTW Area	10	27OCT2014	07NOV2014	07MAY2014	17MAY2014			Outdoor: Lighting East of PTW Area					

Start date	14JUL2010
Finish date	04JUL2015
Data date	28JUL2014
Run date	03SEP2014
Page number	4A
Project name	PR45
© Primavera Systems, Inc.	

Page 4A of 5B
 PPSTW Remaining Works Programme After Substantial Completion - update 28 July 2014 - Three Months Rolling

- Early bar
- Progress bar
- Critical bar
- Summary bar
- Start milestone point
- Finish milestone point

Activity ID	Description	Original Duration	Early Start	Early Finish	Late Start	Late Finish	Actual Start	Actual Finish	2014									
									JUN	JUL	AUG	SEP	OCT	NOV				
EMW951040	Outdoor: Lighting near existing OFPS	10	27AUG2014	09SEP2014	26MAR2014	07APR2014												
EMW951050	Outdoor: Lighting West of Skip Hse Area	10	10SEP2014	23SEP2014	08APR2014	22APR2014												
EMW951070	Outdoor: Lighting Test	20	24SEP2014	22OCT2014	23APR2014	17MAY2014												
EMW952010	Gate House: E&M Installation	30	22OCT2014	02DEC2014	03MAR2014	07APR2014												
EMW952050	Gate House: FS installation	10	22OCT2014	04NOV2014	03MAR2014	13MAR2014												
EMW953005	Outdoor: Boundary Wall CCTV mount detl. & Mat.	30	28JUL2014	05SEP2014	22FEB2014	28MAR2014												
EMW953010	Outdoor: Boundary Wall CCTV Installation	30	08SEP2014	20OCT2014	29MAR2014	09MAY2014												
Testing and Commissioning																		
DOU A																		
Building and Structures																		
EMT715085	DOU A: HKOASLAB approval and preparation	30	15JUL2014	11AUG2014	15JUL2014	10MAY2014	15JUL2014											
EMT715100	DOU A: Performance Test	7	12AUG2014	18AUG2014	11MAY2014	17MAY2014												
DOU B																		
Building and Structures																		
EMT725085	DOU A: HKOASLAB approval and preparation	30	15JUL2014	11AUG2014	15JUL2014	10MAY2014	15JUL2014											
EMT725100	DOU B: Performance Test	7	12AUG2014	18AUG2014	11MAY2014	17MAY2014												
Control System																		
Building and Structures																		
EMT813100	Control/SCADA: Migration PLC LCP OFPS with Exist	60	01APR2014	01AUG2014	01APR2014	17MAY2014	01APR2014											
EMT817010	Control/SCADA: Sham Tseng MSII Test	30	26MAY2014	11AUG2014	26MAY2014	17MAY2014	26MAY2014											
Building Services																		
Building and Structures																		
EMT851010	SiteWide: Noise Measurement	30	15JUL2014	26AUG2014	15JUL2014	17MAY2014	15JUL2014											

Start date	14JUL2010
Finish date	04JUL2015
Data date	28JUL2014
Run date	03SEP2014
Page number	5A
Project name	PR45
© Primavera Systems, Inc.	

- Early bar
- Progress bar
- Critical bar
- Summary bar
- ◆ Start milestone point
- ◆ Finish milestone point