

Contract No. DC/2008/03

**Design, Build and Operate Pillar Point Sewage
Treatment Works**

Environmental Permit No. EP-321/2008/B – Condition 2.9

**As-built Drawings on Landscape and Visual Mitigation
Measures with an Explanatory Statement**

**Submitted by ATAL - Degremont - China State Joint
Venture dated 24 November 2015**



Certified by _____
Mandy To
Environmental Team Leader (ETL)
ERM-Hong Kong, Ltd

Date _____
25 November 2015

Our ref: 0119806_As-built Landscape Drawings_ETL Certification_20151125.docx

Your Ref:
Our Ref: 60017423/C/oylw15120202

By Hand & By Fax (2833 9162)

Drainage Services Department
Sewage Services Branch
Harbour Area Treatment Scheme Division
5/F., Western Magistracy,
2A Pok Fu Lam Road,
Hong Kong.

Attn: Mr. Edwin Lau (T: 2159 3409)

2 December 2015

Dear Sir,

**Contract No. DC/2008/03
Design, Build and Operate
Pillar Point Sewage Treatment Works**

As-built drawings on landscape and visual mitigation measures

Reference is made to Environmental Team (ET)'s draft of the as-built drawings on landscape and visual mitigation measures provided by email dated 25 November and 2 December 2015. We have no further comment.

We hereby verify the said as-built drawings in accordance with the condition 2.9 of Environmental Permit No. EP-321/2008/B.

Should you have any queries, please feel free to contact the undersigned at 3922 9393.

Yours faithfully,

For and on behalf of
AECOM Asia Co. Ltd.



Y T Tang
Independent Environmental Checker

c.c. AECOM – Mr. C Y Hung (Fax No. 2404 2744)
ERM – Ms. Mandy To (Fax No. 2723 5660)
ATAL–Degremont–China State JV – Mr. Barry Lee (Fax No. 2811 3321)









Contract No. DC/2008/03

Design, Build and Operate
Pillar Point Sewage
Treatment Works

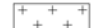
Environmental Permit No.
EP-321/2008/B - Condition
2.9

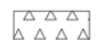
As-built Drawings on
Landscape and Visual
Mitigation Measures

LEGEND:

-  SITE BOUNDARY
-  EXISTING FOOTPATH AND MAINTAIN LANDSCAPE IN FRONT OF EXISTING SHRUB
-  PLANTING AREA (GROUND LEVEL)
-  CONCRETE PAVER (DWG NO. C-LA-GEN-7901)
-  HARD PAVEMENT
-  LEISURE PATH (DWG NO. C-LA-GEN-7902)
-  SMALL-SIZE FEATURE FLOWERING SHRUBS (DWG NO. C-LA-GEN-7831 - 834)
-  MEDIUM-SIZE FEATURE SHRUBS (DWG NO. C-LA-GEN-7831 - 834)
-  CLIMBING PLANTS FOR SCREENING

COMPENSATED TREE SCHEDULE

CODE	BOTANICAL NAME	CHINESE NAME	HEIGHT (mm)	SPREAD (mm)	CALIPER (mm)	QUANTITY
BT	Bridelia Tormentosa	土密樹			Heavy Standard	10
CES	Celtis Sinensis	朴樹			Heavy Standard	14
CO	Cleistocalyx Operculatus	水翁			Heavy Standard	35
FV	Ficus Virens	大葉榕			Heavy Standard	20
HT	Hibiscus Tilianus	黃槿	5000	3500	120	90
IR	Ilex Rotunda	鐵東青			Heavy Standard	25
PP	Pongamia Pinnata	水黃皮			Heavy Standard	10
RT	Reevesia Thyrsoides	梭羅樹			Heavy Standard	5
SS	Sapium Sebiferum	烏柏			Heavy Standard	10
SL	Sterculia lanceolata	假蒴婆			Heavy Standard	20
VO	Viburnum Odoratissimum	珊瑚樹			Heavy Standard	10

 434 DEAD TRANSPLANTED TREE REPLACED BY HEAVY STANDARD TREE

 137 TRANSPLANTED TREE WITH TREE TAG

 HT 1 COMPENSATED TREE WITH SPECIES AND NUMBER

 TREE IN TRANSPLANT SCHEDULE BUT RETAINED ON SITE WITHOUT TRANSPLANT

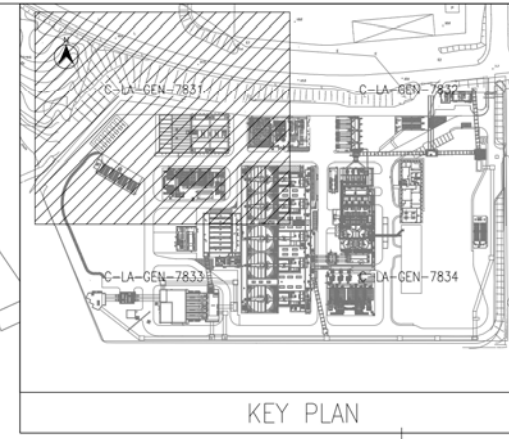

- NOTES:
- FOR CONCRETE PAVER, REFER TO DRAWING NO. C-LA-GEN-201.
 - FOR LEISURE PATH PAVING, REFER TO DRAWING NO. C-LA-GEN-7920.
 - FOR REINFORCED GRASS PAVING SYSTEM, REFER TO DRAWING NO. C-LA-GEN-7903.
 - FOR LEVEL & GRADING PLAN, REFER TO DRAWING NO. C-GL-GEN-5031-5034.
 - DRAWINGS C-LA-GEN-7831 TO 7834 SHOW COMPENSATORY TREES AND TRANSPLANTED TREES ONLY.

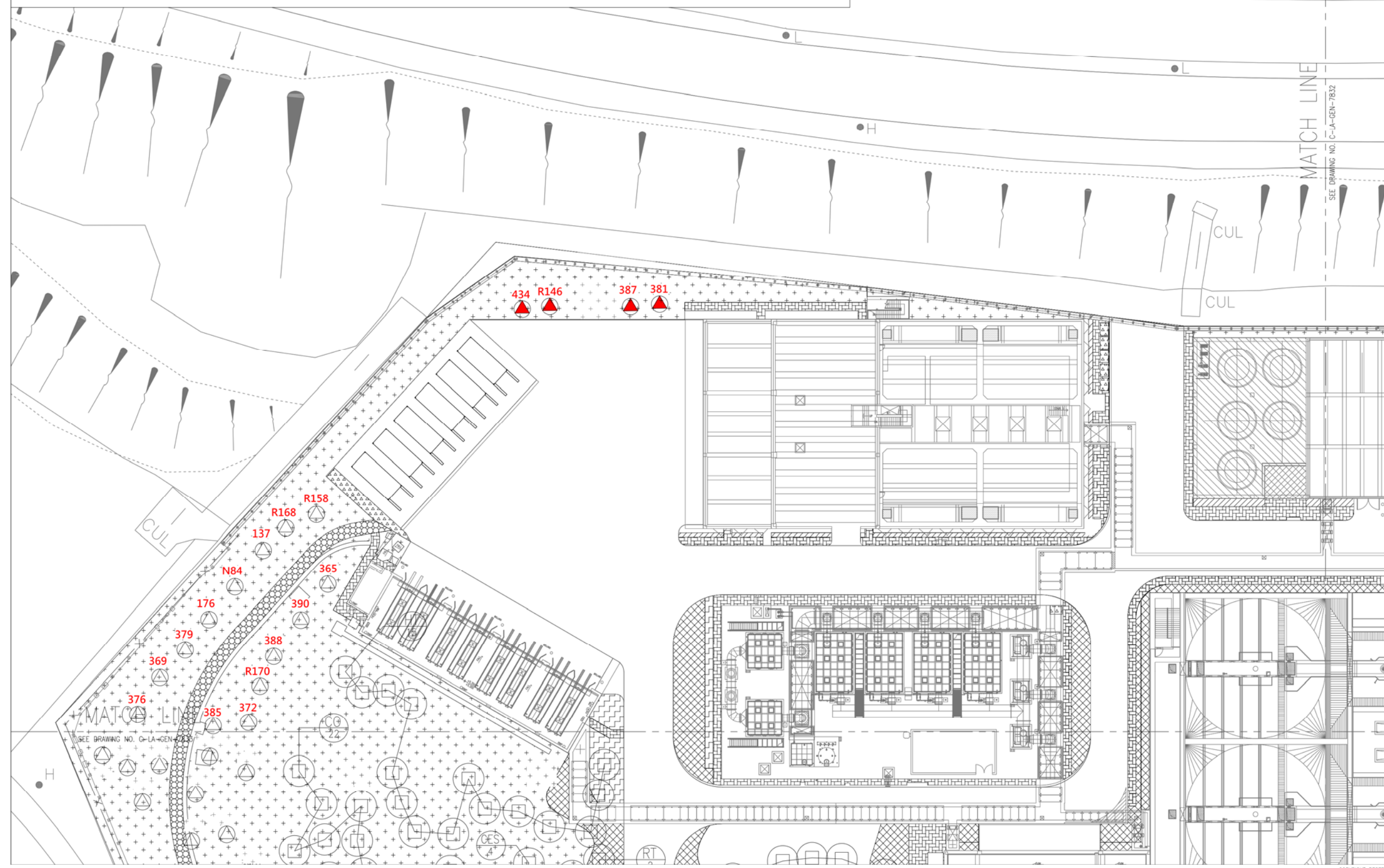

REV.	DATE	BY	CH.	APP.	DESCRIPTION
K	16/11/15	YL	DH	PT	AS-BUILT DRAWING
J	21/03/14	YL	DH	PT	SO COMMENT
H	17/02/14	YL	DH	PT	SO COMMENT
G	27/12/13	YL	DH	PT	SO COMMENT
F	07/11/13	YL	DH	PT	SO COMMENT
E	21/06/13	YL	DH	PT	SO COMMENT
D	16/10/12	AW	DH	PT	SO COMMENT
C	17/04/12	AW	DH	PT	SO COMMENT
B	19/01/12	AW	DH	PT	SO COMMENT
A	20/06/11	AW	DH	PT	DDA SUBMISSION

AS - BUILT

APPROVED _____ DATE _____
FOR
ATAL-Degrémont-China State JV

 THE GOVERNMENT OF HONG KONG
SPECIAL ADMINISTRATIVE REGION
DRAINAGE SERVICES DEPARTMENT

SUPERVISING OFFICER
AECOM

CONTRACTOR
ATAL   
ATAL - Degrémont - China State Joint Venture

DESIGNER
ARUP OVE ARUP & PARTNERS HONG KONG LIMITED

DESIGN CHECKER
 HYDER CONSULTING LIMITED

CONTRACT NO. DC/2008/03
DESIGN, BUILD AND OPERATE
PILLAR POINT SEWAGE TREATMENT WORKS

DRAWING TITLE
AS-BUILT DRAWING
MASTER LANDSCAPE PLAN AND
TREE PLANTING PLAN

(SHEET 1 OF 4)

DESIGNED EL	CHECKED DH	APPROVED PT
CAD FILE NO. 214196_C-LA-GEN7831.dwg	DRAWN WM	SCALE 1:250
DRAWING NO.	DATE 10/11/10	REV. K

C-LA-GEN-7831



+12.2

+12.0

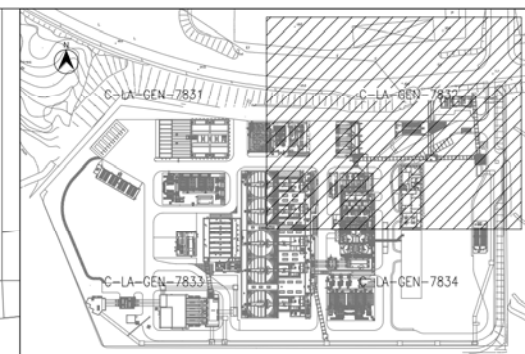

KEY PLAN

- NOTES:
1. FOR CONCRETE PAVER, REFER TO DRAWING NO. C-LA-GEN-201.
 2. FOR LEISURE PATH PAVING, REFER TO DRAWING NO. C-LA-GEN-7902.
 3. FOR REINFORCED GRASS PAVING SYSTEM, REFER TO DRAWING NO. C-LA-GEN-7903.
 4. FOR LEVEL & GRADING PLAN, REFER TO DRAWING NO. C-GL-GEN-5031-5034.
 5. DRAWINGS C-LA-GEN-7831 TO 7834 SHOW COMPENSATORY TREES AND TRANSPLANTED TREES ONLY.

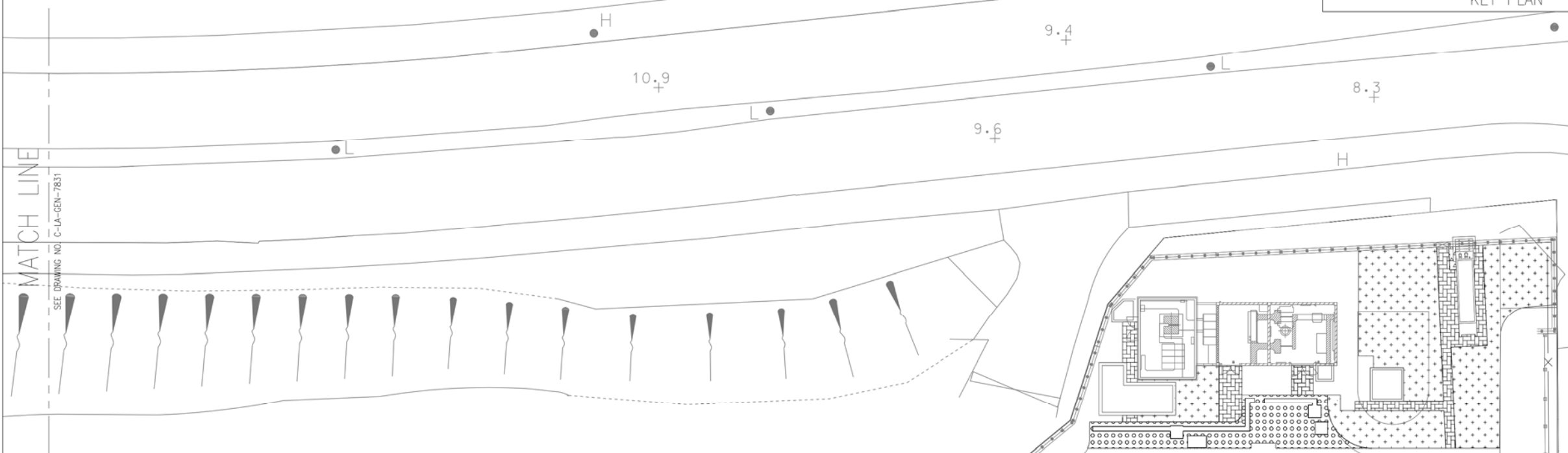

REV.	DATE	BY	CH.	APP.	DESCRIPTION
L	16/11/15	YL	DH	PT	AS-BUILT DRAWING
K	21/03/14	YL	DH	PT	SO COMMENT
J	17/02/14	YL	DH	PT	SO COMMENT
H	27/12/13	YL	DH	PT	SO COMMENT
G	07/11/13	YL	DH	PT	SO COMMENT
F	21/06/13	YL	DH	PT	SO COMMENT
E	24/09/12	AW	DH	PT	SO COMMENT
D	04/09/12	AW	DH	PT	SO COMMENT
C	17/04/12	AW	DH	PT	SO COMMENT
B	19/01/12	AW	DH	PT	SO COMMENT
A	20/06/11	AW	DH	PT	DDA SUBMISSION

AS - BUILT

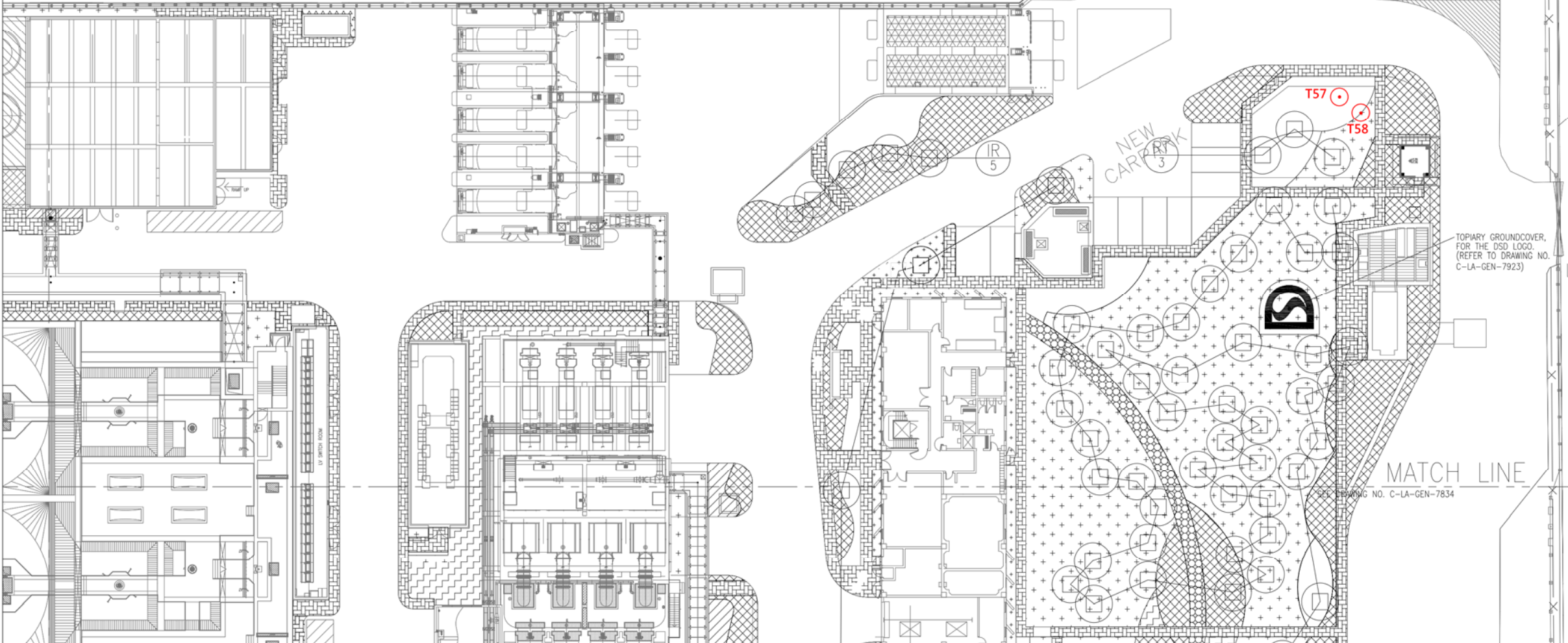

APPROVED _____ DATE _____
FOR
ATAL-Degremont-China State JV

 THE GOVERNMENT OF HONG KONG
SPECIAL ADMINISTRATIVE REGION
DRAINAGE SERVICES DEPARTMENT

SUPERVISING OFFICER

CONTRACTOR
  
ATAL - Degrémont - China State Joint Venture

DESIGNER
 OVE ARUP & PARTNERS HONG KONG LIMITED

DESIGN CHECKER
 HYDER CONSULTING LIMITED

CONTRACT NO. DC/2008/03
DESIGN, BUILD AND OPERATE
PILLAR POINT SEWAGE TREATMENT WORKS

DRAWING TITLE
AS-BUILT DRAWING
MASTER LANDSCAPE PLAN AND
TREE PLANTING PLAN

(SHEET 2 OF 4)

DESIGNED	CHECKED	APPROVED	DATE
EL	DH	PT	
CAD FILE NO. 214196_C-LA-GEN7832.dwg	DRAWN WM	SCALE 1:250	DATE 10/11/10
DRAWING NO. C-LA-GEN-7832	REV. L		

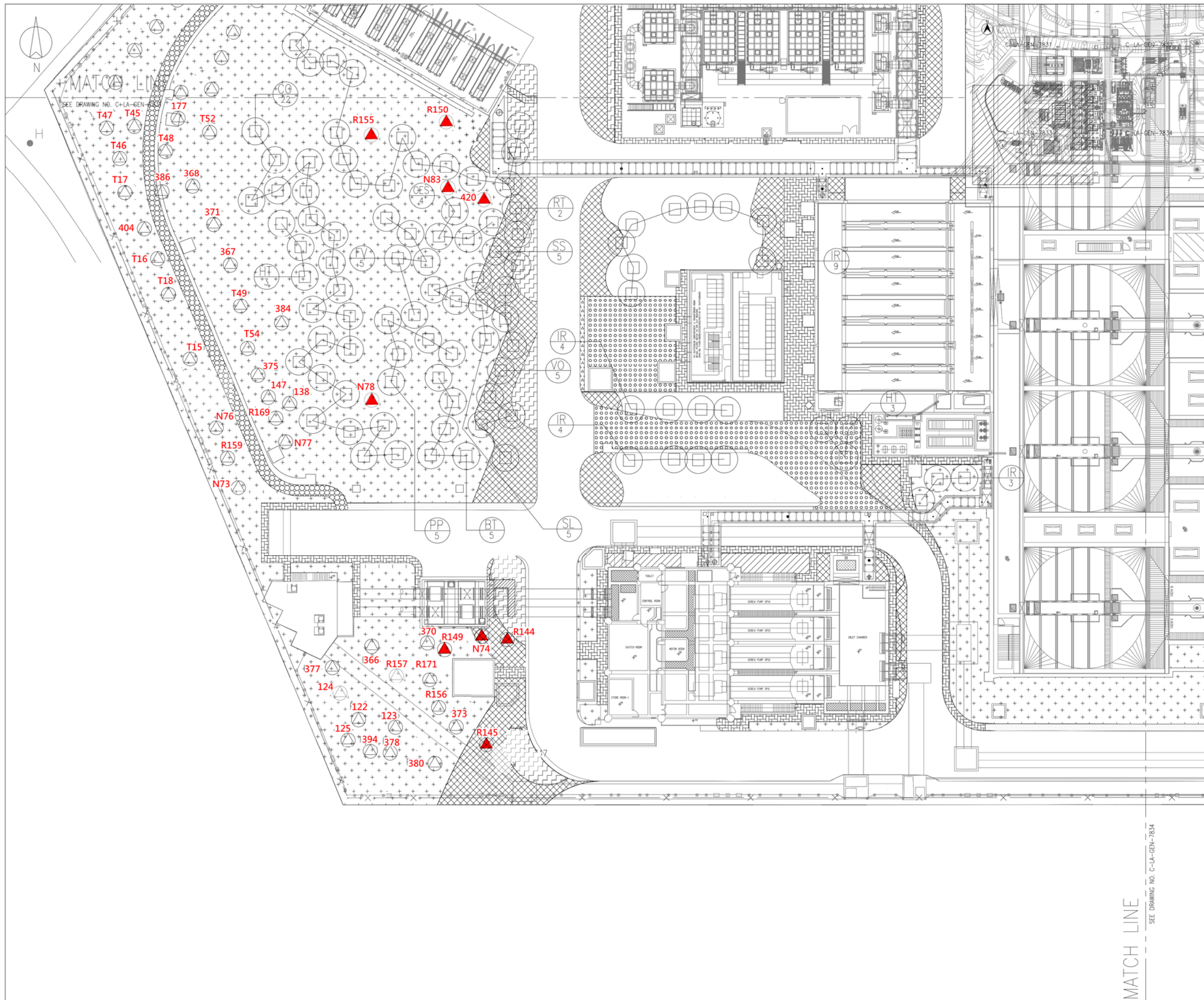

- NOTES:
1. FOR CONCRETE PAVER, REFER TO DRAWING NO. C-LA-GEN-201.
 2. FOR LEISURE PATH PAVING, REFER TO DRAWING NO. C-LA-GEN-7902.
 3. FOR REINFORCED GRASS PAVING SYSTEM, REFER TO DRAWING NO. C-LA-GEN-7903.
 4. FOR LEVEL & GRADING PLAN, REFER TO DRAWING NO. C-GL-GEN-5031-5034.
 5. DRAWINGS C-LA-GEN-7831 TO 7834 SHOW COMPENSATORY TREES AND TRANSPLANTED TREES ONLY.



L	16/11/15	YL	DH	PT	AS-BUILT DRAWING
K	17/06/14	YL	DH	PT	SO COMMENT
J	21/03/14	YL	DH	PT	SO COMMENT
H	17/02/14	YL	DH	PT	SO COMMENT
G	27/12/13	YL	DH	PT	SO COMMENT
F	07/11/13	YL	DH	PT	SO COMMENT
E	21/06/13	YL	DH	PT	SO COMMENT
D	04/09/12	AW	DH	PT	SO COMMENT
C	17/04/12	AW	DH	PT	SO COMMENT
B	19/01/12	AW	DH	PT	SO COMMENT
A	20/06/11	AW	DH	PT	DDA SUBMISSION
REV.	DATE	BY	CH.	APP.	DESCRIPTION

AS - BUILT

APPROVED _____ DATE _____
FOR
ATAL-Degrémont-China State JV

 THE GOVERNMENT OF HONG KONG
SPECIAL ADMINISTRATIVE REGION
DRAINAGE SERVICES DEPARTMENT

SUPERVISING OFFICER
AECOM

CONTRACTOR
ATAL   
ATAL - Degrémont - China State Joint Venture

DESIGNER
ARUP OVE ARUP & PARTNERS HONG KONG LIMITED

DESIGN CHECKER
 HYDER CONSULTING LIMITED

CONTRACT NO. DC/2008/03
DESIGN, BUILD AND OPERATE
PILLAR POINT SEWAGE TREATMENT WORKS

DRAWING TITLE
AS-BUILT DRAWING
MASTER LANDSCAPE PLAN AND
TREE PLANTING PLAN

(SHEET 3 OF 4)

DESIGNED EL	CHECKED DH	APPROVED PT
CAD FILE NO. 214196_C-LA-GEN7833.dwg	DRAWN WM	SCALE 1:250
DRAWING NO. C-LA-GEN-7833	DATE 10/11/10	REV. L

MATCH LINE SEE DRAWING NO. C-LA-GEN-7834

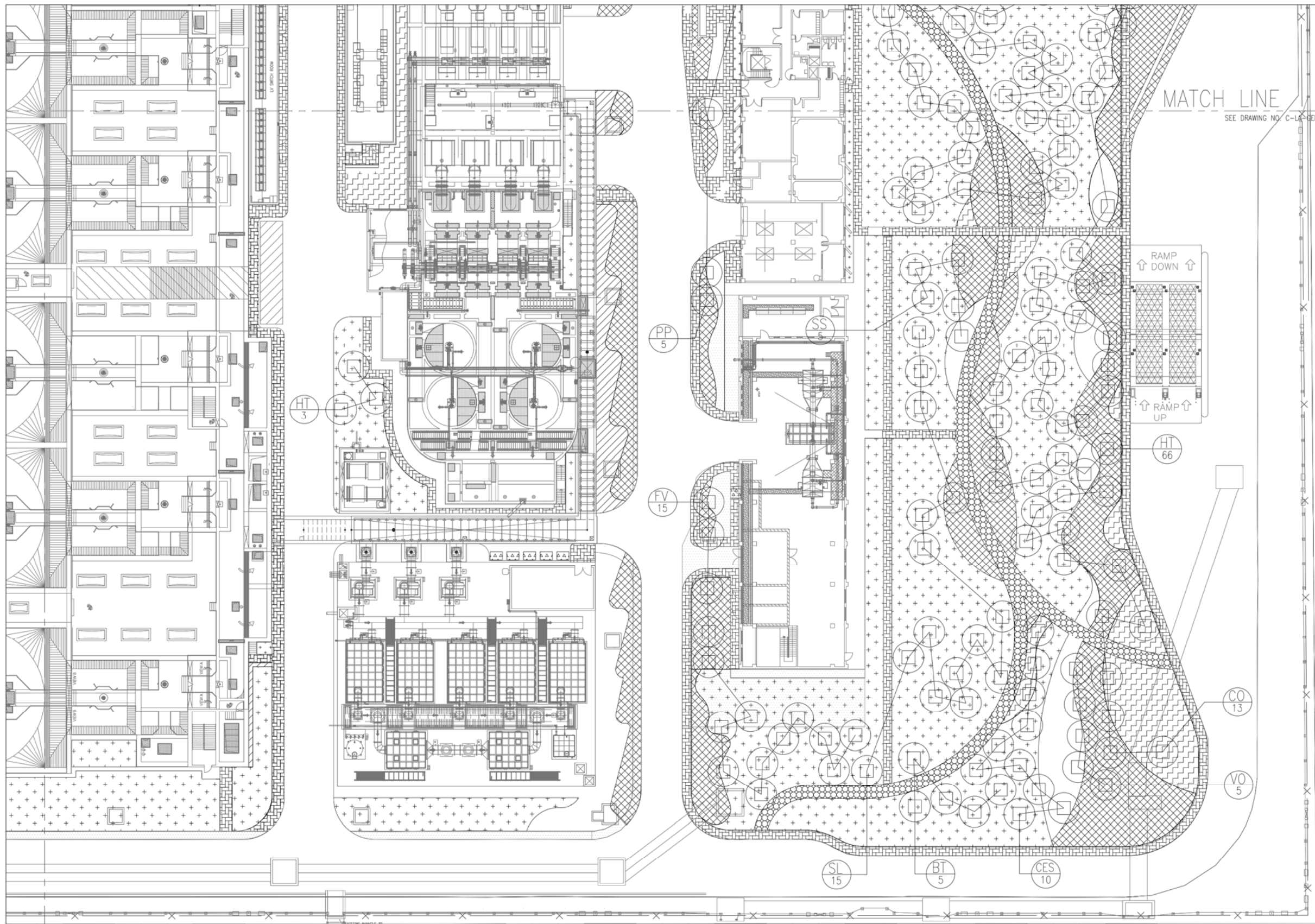

MATCH LINE
SEE DRAWING NO. C-LA-GEN-7832

- NOTES:
1. FOR CONCRETE PAVER, REFER TO DRAWING NO. C-LA-GEN-201.
 2. FOR LEISURE PATH PAVING, REFER TO DRAWING NO. C-LA-GEN-7902.
 3. FOR REINFORCED GRASS PAVING SYSTEM, REFER TO DRAWING NO. C-LA-GEN-7903.
 4. FOR LEVEL & GRADING PLAN, REFER TO DRAWING NO. C-GL-GEN-5031-5034.
 5. DRAWINGS C-LA-GEN-7831 TO 7834 SHOW COMPENSATORY TREES AND TRANSPLANTED TREES ONLY.

REV.	DATE	BY	CH.	APP.	DESCRIPTION
K	16/11/15	YL	DH	PT	AS-BUILT DRAWING
J	21/03/14	AW	DH	PT	SO COMMENT
H	17/02/14	AW	DH	PT	SO COMMENT
G	27/12/13	AW	DH	PT	SO COMMENT
F	07/11/12	AW	DH	PT	SO COMMENT
E	24/09/12	AW	DH	PT	SO COMMENT
D	04/09/12	AW	DH	PT	SO COMMENT
C	17/04/12	AW	DH	PT	SO COMMENT
B	19/01/12	AW	DH	PT	SO COMMENT
A	20/06/11	AW	DH	PT	DDA SUBMISSION

AS - BUILT

APPROVED _____ DATE _____
FOR
ATAL-Degrémont-China State JV



SUPERVISING OFFICER
AECOM



ATAL - Degrémont - China State Joint Venture

DESIGNER
ARUP OVE ARUP & PARTNERS HONG KONG LIMITED

DESIGN CHECKER
Hyder HYDER CONSULTING LIMITED

CONTRACT NO. DC/2008/03
DESIGN, BUILD AND OPERATE
PILLAR POINT SEWAGE TREATMENT WORKS

DRAWING TITLE
AS-BUILT DRAWING
MASTER LANDSCAPE PLAN AND
TREE PLANTING PLAN

(SHEET 4 OF 4)

DESIGNED	CHECKED	APPROVED
EL	DH	PT
CAD FILE NO. 214196_C-LA-GEN7834.dwg	DRAWN WM	SCALE 1:250
DRAWING NO.	DATE 10/11/10	REV. K

C-LA-GEN-7834

MATCH LINE
SEE DRAWING NO. C-LA-GEN-7833

Explanatory Statements

LEGEND:

- SITE BOUNDARY
- EXISTING FOOTPATH AND MAINTAIN LANDSCAPE IN FRONT OF EXISTING SHRUB
- PLANTING AREA (GROUND LEVEL)
- CONCRETE PAVER (DWG NO. C-LA-GEN-7901)
- HARD PAVEMENT
- LEISURE PATH (DWG NO. C-LA-GEN-7902)
- SMALL-SIZE FEATURE FLOWERING SHRUBS (DWG NO. C-LA-GEN-7831 - 834)
- MEDIUM-SIZE FEATURE SHRUBS (DWG NO. C-LA-GEN-7831 - 834)
- CLIMBING PLANTS FOR SCREENING

434
 DEAD TRANSPLANTED TREE REPLACED BY HEAVY STANDARD TREE

137
 TRANSPLANTED TREE WITH TREE TAG

HT 1
 COMPENSATED TREE WITH SPECIES AND NUMBER

TREE IN TRANSPLANT SCHEDULE BUT RETAINED ON SITE WITHOUT TRANSPLANT

R155
 RELOCATED TRANSPLANTED TREE

R155
 ORIGINAL LOCATION OF TRANSPLANTED TREE

Conflict with lamp pole

EXPLANATION AND INDICATION FOR RELOCATION

ORIGINAL LOCATION OF COMPENSATORY TREE

COMPENSATED TREE SCHEDULE

CODE	BOTANICAL NAME	CHINESE NAME	HEIGHT (mm)	SPREAD (mm)	CALIPER (mm)	QUANTITY
BT	Bridelia Tomentosa	土密樹			Heavy Standard	10
CES	Celtis Sinensis	朴樹			Heavy Standard	14
CO	Cleistocalyx Operculatus	水翁			Heavy Standard	35
FV	Ficus Virens	大葉榕			Heavy Standard	20
HT	Hibiscus Tilianus	黃槿	5000	3500	120	90
IR	Ilex Rotunda	鐵東青			Heavy Standard	25
PP	Pongamia Pinnata	水黃皮			Heavy Standard	10
RT	Reevesia Thyrsoides	梭羅樹			Heavy Standard	5
SS	Sapium Sebiferum	烏柏			Heavy Standard	10
SL	Sterculia lanceolata	假蒴婆			Heavy Standard	20
VO	Viburnum Odoratissimum	珊瑚樹			Heavy Standard	10

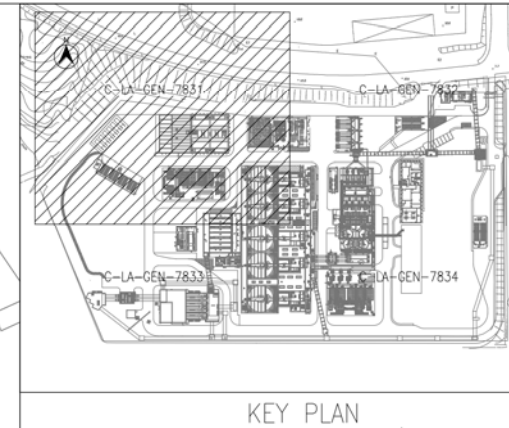

- NOTES:
- FOR CONCRETE PAVER, REFER TO DRAWING NO. C-LA-GEN-201.
 - FOR LEISURE PATH PAVING, REFER TO DRAWING NO. C-LA-GEN-7920.
 - FOR REINFORCED GRASS PAVING SYSTEM, REFER TO DRAWING NO. C-LA-GEN-7903.
 - FOR LEVEL & GRADING PLAN, REFER TO DRAWING NO. C-GL-GEN-5031-5034.
 - DRAWINGS C-LA-GEN-7831 TO 7834 SHOW COMPENSATORY TREES AND TRANSPLANTED TREES ONLY.

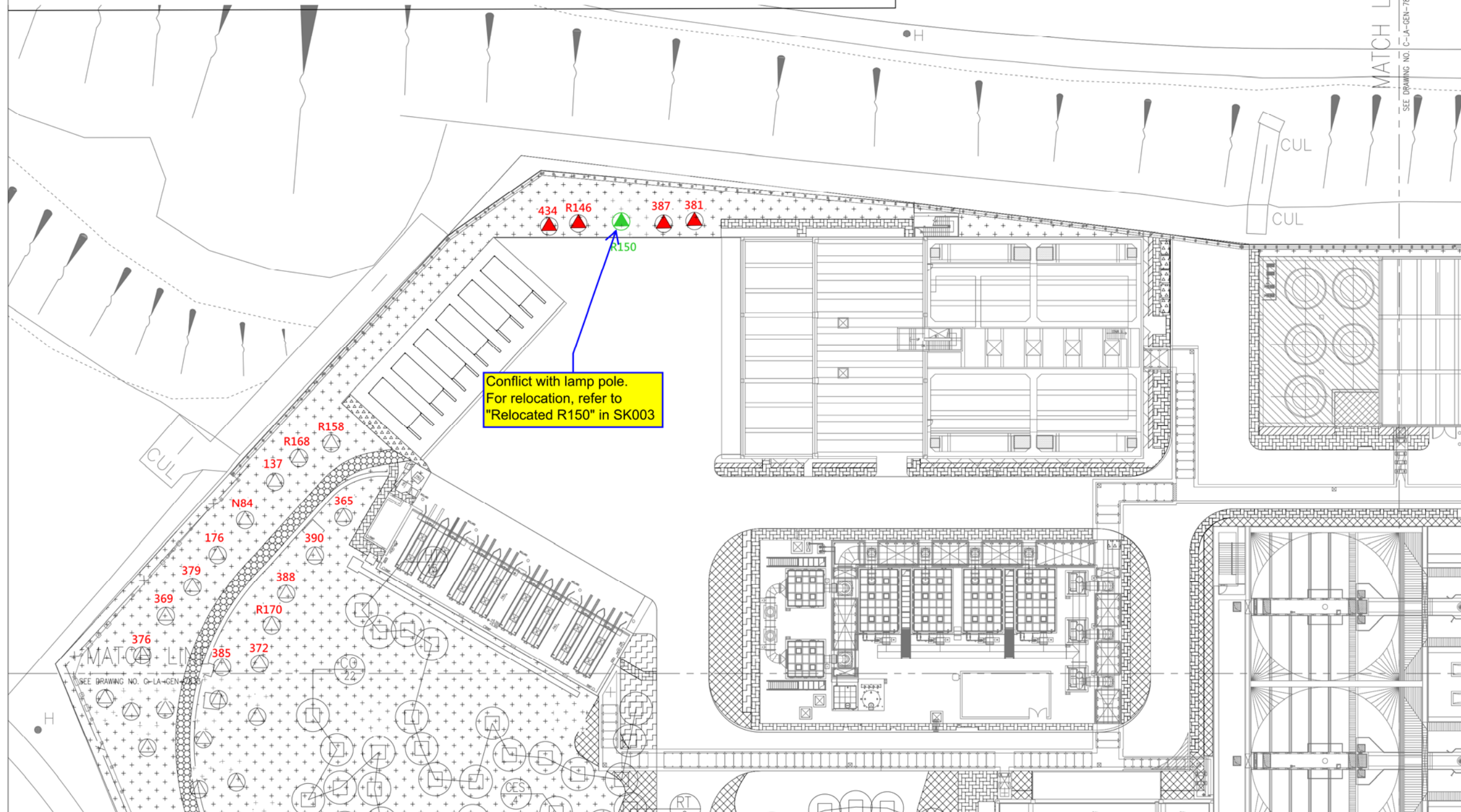

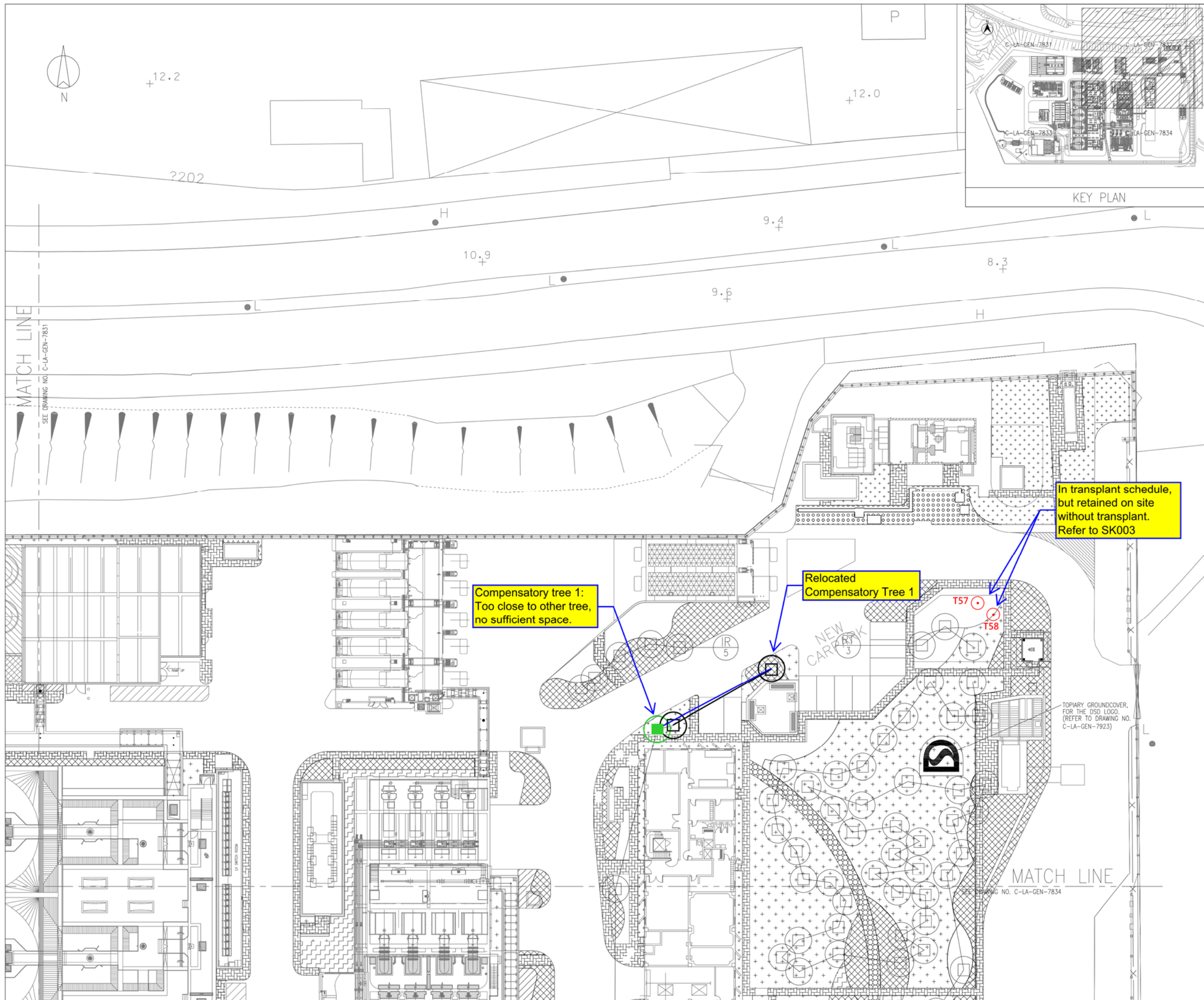

- NOTES:
1. FOR CONCRETE PAVER, REFER TO DRAWING NO. C-LA-GEN-201.
 2. FOR LEISURE PATH PAVING, REFER TO DRAWING NO. C-LA-GEN-7902.
 3. FOR REINFORCED GRASS PAVING SYSTEM, REFER TO DRAWING NO. C-LA-GEN-7903.
 4. FOR LEVEL & GRADING PLAN, REFER TO DRAWING NO. C-GL-GEN-5031-5034.
 5. DRAWINGS C-LA-GEN-7831 TO 7834 SHOW COMPENSATORY TREES AND TRANSPLANTED TREES ONLY.

AS - BUILT

In transplant schedule, but retained on site without transplant. Refer to SK003

Compensatory tree 1: Too close to other tree, no sufficient space.

Relocated Compensatory Tree 1

APPROVED _____ DATE _____
FOR
ATAL-Degremont-China State JV

THE GOVERNMENT OF HONG KONG
SPECIAL ADMINISTRATIVE REGION
DRAINAGE SERVICES DEPARTMENT

SUPERVISING OFFICER
AECOM

CONTRACTOR
ATAL **CEC** **CSCEC**

ATAL - Degremont - China State Joint Venture

DESIGNER
ARUP OVE ARUP & PARTNERS HONG KONG LIMITED

DESIGN CHECKER
Hyder HYDER CONSULTING LIMITED

CONTRACT NO. DC/2008/03
DESIGN, BUILD AND OPERATE
PILLAR POINT SEWAGE TREATMENT WORKS

DRAWING TITLE
AS-BUILT DRAWING
MASTER LANDSCAPE PLAN AND
TREE PLANTING PLAN

(SHEET 2 OF 4)

DESIGNED EL	CHECKED DH	APPROVED PT	DATE 10/11/10
CAD FILE NO. 214196_C-LA-GEN7832.dwg	DRAWN WM	SCALE 1:250	REV.

SK002

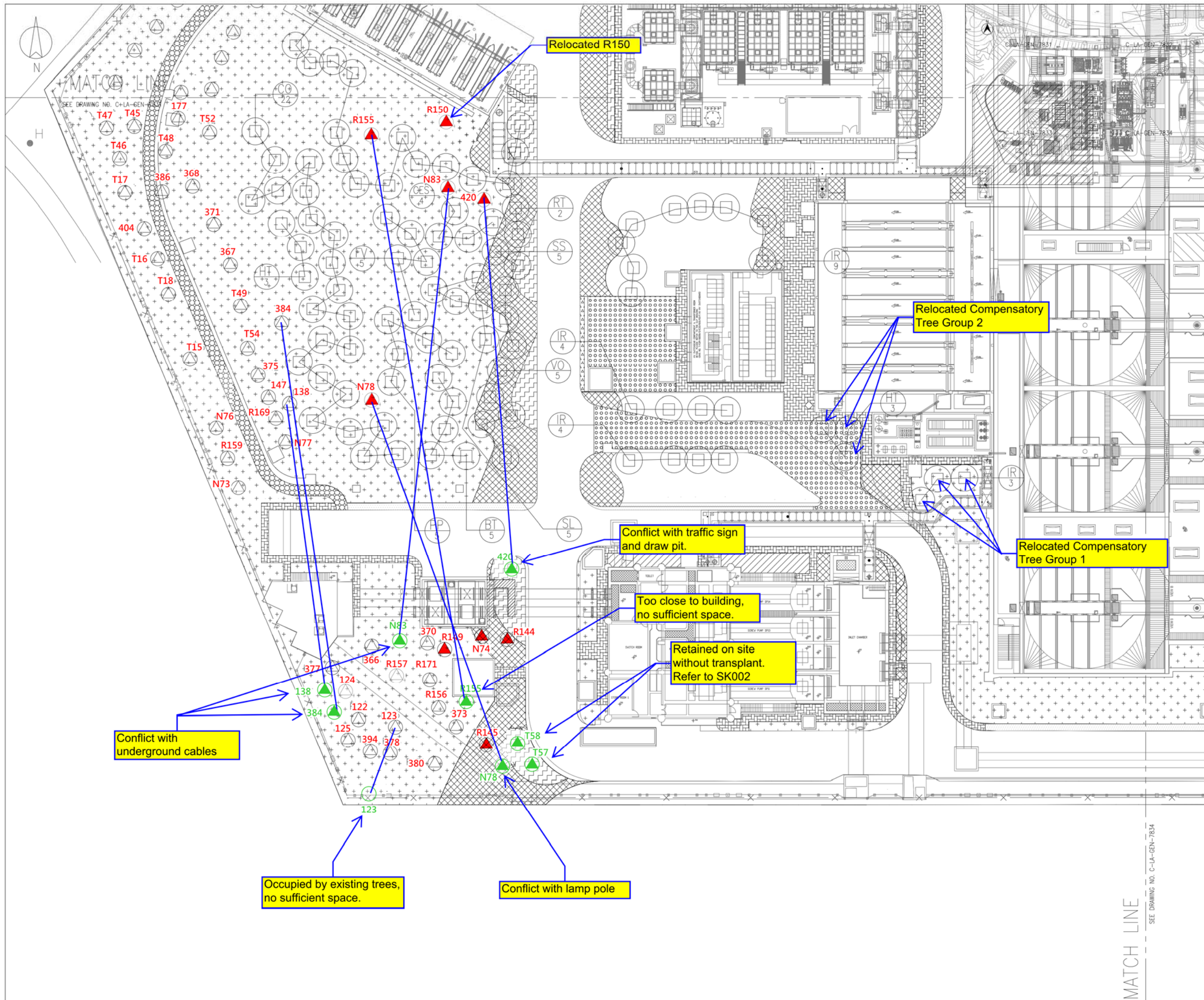

- NOTES:
1. FOR CONCRETE PAVER, REFER TO DRAWING NO. C-LA-GEN-201.
 2. FOR LEISURE PATH PAVING, REFER TO DRAWING NO. C-LA-GEN-7902.
 3. FOR REINFORCED GRASS PAVING SYSTEM, REFER TO DRAWING NO. C-LA-GEN-7903.
 4. FOR LEVEL & GRADING PLAN, REFER TO DRAWING NO. C-GL-GEN-5031-5034.
 5. DRAWINGS C-LA-GEN-7831 TO 7834 SHOW COMPENSATORY TREES AND TRANSPLANTED TREES ONLY.

AS - BUILT

APPROVED _____ DATE _____
FOR
ATAL-Degrémont-China State JV

THE GOVERNMENT OF HONG KONG
SPECIAL ADMINISTRATIVE REGION
DRAINAGE SERVICES DEPARTMENT

SUPERVISING OFFICER
AECOM

CONTRACTOR
ATAL **ARUP** **HYDER**

ATAL - Degrémont - China State Joint Venture
DESIGNER
ARUP OVE ARUP & PARTNERS HONG KONG LIMITED

DESIGN CHECKER
Hyder HYDER CONSULTING LIMITED

CONTRACT NO. DC/2008/03
DESIGN, BUILD AND OPERATE
PILLAR POINT SEWAGE TREATMENT WORKS

DRAWING TITLE
AS-BUILT DRAWING
MASTER LANDSCAPE PLAN AND
TREE PLANTING PLAN

(SHEET 3 OF 4)

DESIGNED EL	CHECKED DH	APPROVED PT
CAD FILE NO. 214196_C-LA-GEN7833.dwg	DRAWN WM	SCALE 1:250
DRAWING NO.	DATE 10/11/10	REV.

SK003

MATCH LINE SEE DRAWING NO. C-LA-GEN-7834

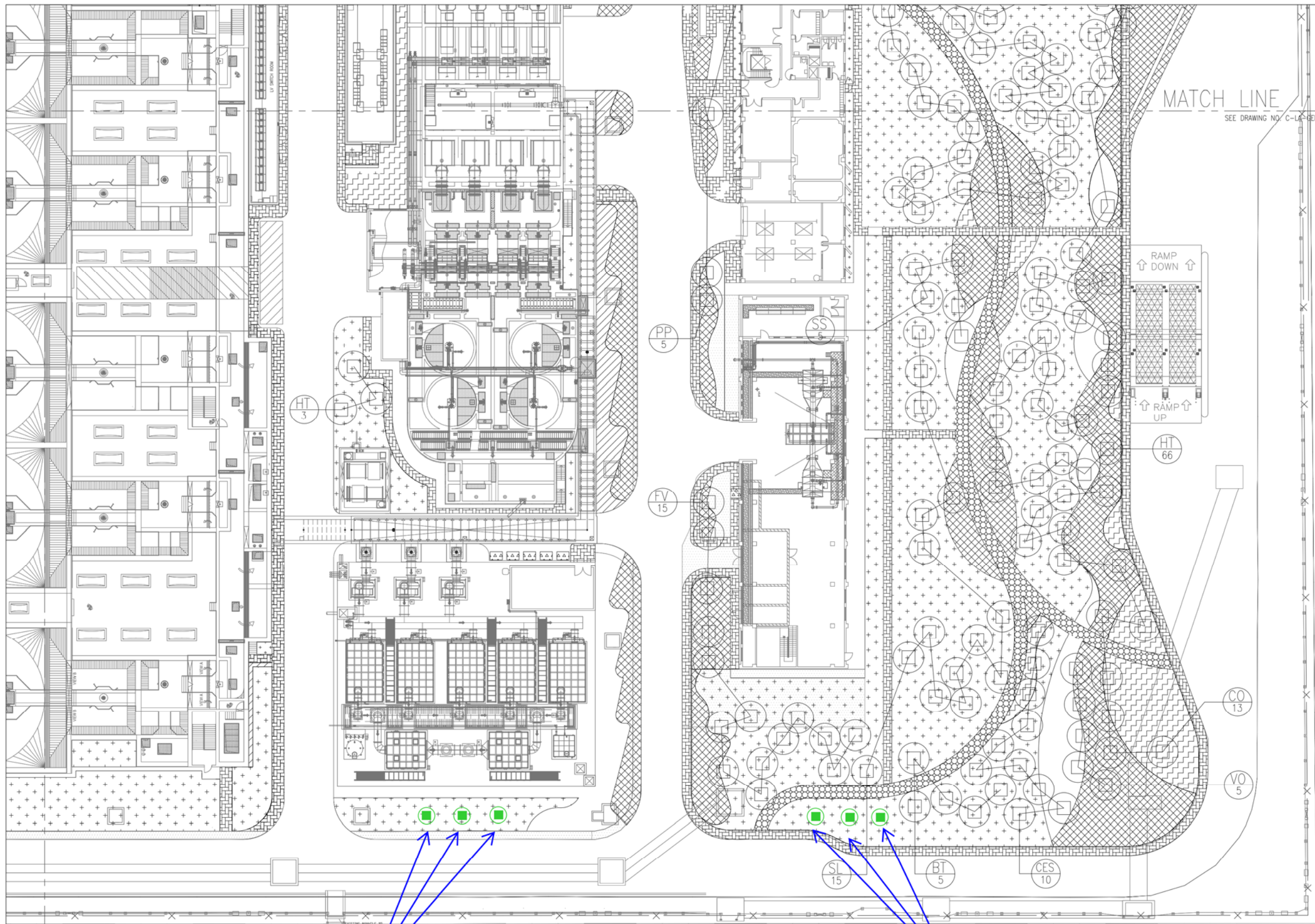

- NOTES:
1. FOR CONCRETE PAVER, REFER TO DRAWING NO. C-LA-GEN-201.
 2. FOR LEISURE PATH PAVING, REFER TO DRAWING NO. C-LA-GEN-7902.
 3. FOR REINFORCED GRASS PAVING SYSTEM, REFER TO DRAWING NO. C-LA-GEN-7903.
 4. FOR LEVEL & GRADING PLAN, REFER TO DRAWING NO. C-GL-GEN-5031-5034.
 5. DRAWINGS C-LA-GEN-7831 TO 7834 SHOW COMPENSATORY TREES AND TRANSPLANTED TREES ONLY.

AS - BUILT

APPROVED _____ DATE _____
FOR
ATAL-Degrémont-China State JV

THE GOVERNMENT OF HONG KONG
SPECIAL ADMINISTRATIVE REGION
DRAINAGE SERVICES DEPARTMENT

SUPERVISING OFFICER
AECOM

CONTRACTOR
ATAL

ATAL - Degrémont - China State Joint Venture

DESIGNER
ARUP OVE ARUP & PARTNERS HONG KONG LIMITED

DESIGN CHECKER
 HYDER CONSULTING LIMITED

CONTRACT NO. DC/2008/03
DESIGN, BUILD AND OPERATE
PILLAR POINT SEWAGE TREATMENT WORKS

DRAWING TITLE
AS-BUILT DRAWING
MASTER LANDSCAPE PLAN AND
TREE PLANTING PLAN

(SHEET 4 OF 4)

DESIGNED EL	CHECKED DH	APPROVED PT
CAD FILE NO. 214196_C-LA_GEN7834.dwg	DRAWN WM	SCALE 1:250
DRAWING NO.	DATE 10/11/10	REV.

Compensatory Tree Group 2:
Conflict with existing trees.
For relocation, refer to SK003.

Compensatory Tree Group 1:
Conflict with lamp pole and cables.
For relocation, refer to SK003.

MATCH LINE
SEE DRAWING NO C-LA-GEN-7833

MATCH LINE
SEE DRAWING NO C-LA-GEN-7832



L

Table 1 - 69 Nos. of Transplanted Tree Schedule

Tree Tag	Species	Status as on 14 Aug 2015	History	Compensation Provided
N73	Psidium Guajava	Transplanted	N/A	N/A
N74	Macaranga Tanarius	Dead and replaced	Dead in Portion T1	C1
N76	Plumeria Alba	Transplanted	N/A	N/A
N77	Plumeria Alba	Transplanted	N/A	N/A
N78	Melia Azedarach	Dead and replaced	Dead in Portion T1	C2
N83	Psidium Guajava	Dead and replaced	Dead in Portion T1	C3
N84	Bauhinia Spp	Transplanted	N/A	N/A
122	Hibiscus Tiliaceus	Transplanted	N/A	N/A
123	Hibiscus Tiliaceus	Transplanted	N/A	N/A
124	Hibiscus Tiliaceus	Transplanted	N/A	N/A
125	Hibiscus Tiliaceus	Transplanted	N/A	N/A
137	Hibiscus Tiliaceus	Transplanted	N/A	N/A
138	Hibiscus Tiliaceus	Transplanted	N/A	N/A
147	Hibiscus Tiliaceus	Transplanted	N/A	N/A
176	Casuarina Equisetifolia	Transplanted	N/A	N/A
177	Casuarina Equisetifolia	Transplanted	N/A	N/A
T15	Hibiscus Tiliaceus	Transplanted	N/A	N/A
T16	Hibiscus Tiliaceus	Transplanted	N/A	N/A
T17	Hibiscus Tiliaceus	Transplanted	N/A	N/A
T18	Hibiscus Tiliaceus	Transplanted	N/A	N/A
365	Hibiscus Tiliaceus	Transplanted	N/A	N/A
366	Hibiscus Tiliaceus	Transplanted	N/A	N/A
367	Hibiscus Tiliaceus	Transplanted	N/A	N/A
368	Hibiscus Tiliaceus	Transplanted	N/A	N/A
369	Hibiscus Tiliaceus	Transplanted	N/A	N/A
370	Hibiscus Tiliaceus	Transplanted	N/A	N/A
371	Hibiscus Tiliaceus	Transplanted	N/A	N/A
372	Hibiscus Tiliaceus	Transplanted	N/A	N/A
373	Hibiscus Tiliaceus	Transplanted	N/A	N/A
375	Hibiscus Tiliaceus	Transplanted	N/A	N/A
376	Hibiscus Tiliaceus	Transplanted	N/A	N/A
377	Hibiscus Tiliaceus	Transplanted	N/A	N/A
378	Hibiscus Tiliaceus	Transplanted	N/A	N/A
379	Hibiscus Tiliaceus	Transplanted	N/A	N/A
380	Hibiscus Tiliaceus	Transplanted	N/A	N/A
381	Hibiscus Tiliaceus	Dead and replaced	Damage by typhoon "Vicente"	C4
384	Hibiscus Tiliaceus	Transplanted	N/A	N/A
385	Hibiscus Tiliaceus	Transplanted	N/A	N/A
386	Hibiscus Tiliaceus	Transplanted	N/A	N/A
387	Hibiscus Tiliaceus	Dead and replaced	Damage by typhoon "Vicente"	C5
388	Hibiscus Tiliaceus	Transplanted	N/A	N/A
390	Hibiscus Tiliaceus	Transplanted	N/A	N/A
394	Hibiscus Tiliaceus	Transplanted	N/A	N/A
404	Dimocarpus Longan	Transplanted	N/A	N/A
420	Bombax Ceiba	Poor health condition and replaced	Poor health condition in Portion T1	C6
434	Melia Azedarach	Dead and replaced	Dead in Portion T1	C7
T45	Hibiscus Tiliaceus	Transplanted	N/A	N/A
T46	Hibiscus Tiliaceus	Transplanted	N/A	N/A
T47	Hibiscus Tiliaceus	Transplanted	N/A	N/A
T48	Hibiscus Tiliaceus	Transplanted	N/A	N/A
T49	Hibiscus Tiliaceus	Transplanted	N/A	N/A
T52	Hibiscus Tiliaceus	Transplanted	N/A	N/A
T54	Hibiscus Tiliaceus	Transplanted	N/A	N/A
T57	Ficus Elastica	Retained on site	N/A	N/A
T58	Morus Alba	Retained on site	N/A	N/A
R144	Morus Alba	Dead and replaced	Dead in Portion T1	C8
R145	Morus Alba	Dead and replaced	Dead in Portion T1	C9
R146	Morus Alba	Dead and replaced	Dead in Portion T1	C10
R149	Delonix Regia	Removed and Replaced	Poor structural condition with potential safety risk	C11
R150	Morus Alba	Dead and replaced	Dead in Portion T1	C12

Tree Tag	Species	Status as on 14 Aug 2015	History	Compensation Provided
R155	Psidium Guajava	Dead and replaced	Dead in Portion T1	C13
R156	Psidium Guajava	Transplanted	N/A	N/A
R157	Psidium Guajava	Transplanted	N/A	N/A
R158	Magnolia Grandiflora	Transplanted	N/A	N/A
R159	Psidium Guajava	Transplanted	N/A	N/A
R168	Hibiscus Tiliaceus	Transplanted	N/A	N/A
R169	Hibiscus Tiliaceus	Transplanted	N/A	N/A
R170	Hibiscus Tiliaceus	Transplanted	N/A	N/A
R171	Hibiscus Tiliaceus	Transplanted	N/A	N/A

Remark:

- Contractor keeps doing conservation measures throughout the project period, including continuous monitoring, fungal control, pruning for crossing or dead branch, reinforce tree support, apply fertilizer and regularly watering.
- For compensation provided from C1 to C13, refer to Table 2.

Table 2 - Schedule of Compensatory Trees for Transplanted Trees

Compensation Provided	Original		Compensation	
	Tree Tag	Species	Species	Reason
C1	N74	Macaranga Tanarius	Ficus Virens	Macaranga Tanarius is ineligible for transplanting on or off site because of its low chance of surviving or recovering to its normal form after transplanting.
C2	N78	Melia Azedarach	Melia Azedarach	N/A
C3	N83	Psidium Guajava	Ceclis Sinensis	Psidium Guajava is not available in market
C4	381	Hibiscus Tiliaceus	Hibiscus Tiliaceus	N/A
C5	387	Hibiscus Tiliaceus	Hibiscus Tiliaceus	N/A
C6	420	Bombax Ceiba	Bombax Ceiba	N/A
C7	434	Melia Azedarach	Melia Azedarach	N/A
C8	R144	Morus Alba	Cleistocalys Operculatus	Morus Alba is not available in market
C9	R145	Morus Alba	Ficus Virens	Morus Alba is not available in market
C10	R146	Morus Alba	Hibiscus Tiliaceus	Morus Alba is not available in market
C11	R149	Delonix Regia	Delonix Regia	N/A
C12	R150	Morus Alba	Ficus Virens	Morus Alba is not available in market
C13	R155	Psidium Guajava	Ceclis Sinensis	Psidium Guajava is not available in market

Remark:

All compensatory trees are in heavy standard size.

Table 3 - Relocation Schedule

Original		Relocated		Reason
Tree Tag	Drawing Ref.	Tree Tag	Drawing Ref.	
R150	SK001	Relocated R150	SK003	Conflict with lamp pole
T57	SK003	T57	SK002	Retained on site without transplant
T58	SK003	T58	SK002	Retained on site without transplant
138	SK003	138	SK003	Conflict with underground cables
384	SK003	384	SK003	Conflict with underground cables
123	SK003	123	SK003	Occupied by existing trees, no sufficient space
N83	SK003	N83	SK003	Conflict with underground cables
420	SK003	420	SK003	Conflict with traffic sign and draw pit
R155	SK003	R155	SK003	Too close to building, no sufficient space
N78	SK003	N78	SK003	Conflict with lamp pole
Compensatory Tree 1	SK002	Relocated Compensatory Tree 1	SK002	Too close to other tree, no sufficient space
Compensatory Tree Group 1	SK004	Relocated Compensatory Tree Group 1	SK003	Conflict with lamp pole and cables
Compensatory Tree Group 2	SK004	Relocated Compensatory Tree Group 2	SK003	Conflict with existing trees