

**Contract No. HY/2012/08
Tuen Mun - Chek Lap Kok Link -
Northern Connection Sub-sea Tunnel
Section**

*Ninety Monthly Environmental Monitoring &
Audit (EM&A) Report*

7 May 2021

Environmental Resources Management
2509, 25/F One Harbourfront
18 Tak Fung Street
Hung Hom, Kowloon
Hong Kong
Telephone 2271 3000
Facsimile 2723 5660

www.erm.com



Contract No. HY/2012/08 Tuen Mun – Chek Lap Kok Link – Northern Connection Sub-sea Tunnel Section

**Environmental Resources
Management**

2509, 25/F One Harbourfront
18 Tak Fung Street
Hungghom, Kowloon
Hong Kong
Telephone: (852) 2271 3000
Facsimile: (852) 2723 5660
E-mail: post.hk@erm.com
http://www.erm.com

*Ninety Monthly Environmental Monitoring & Audit
(EM&A) Report*

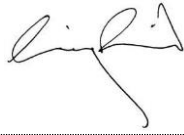
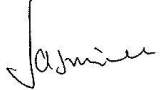
Document Code: 0212330_90th Monthly EM&A_20210507.doc

Client: DBJV		Project No: 0212330			
Summary: This document presents the Ninety Monthly EM&A Report for Tuen Mun – Chek Lap Kok Link Northern Connection Sub-sea Tunnel Section.		Date: 7 May 2021			
		Approved by: 			
		<i>Mr Craig Reid Partner</i>			
		Certified by: 			
		<i>Dr Jasmine Ng ET Leader</i>			
	90 th Monthly EM&A Report	VAR	JN	CAR	12/05/21
Revision	Description	By	Checked	Approved	Date
<p>This report has been prepared by Environmental Resources Management the trading name of 'ERM Hong-Kong, Limited', with all reasonable skill, care and diligence within the terms of the Contract with the client, incorporating our General Terms and Conditions of Business and taking account of the resources devoted to it by agreement with the client.</p> <p>We disclaim any responsibility to the client and others in respect of any matters outside the scope of the above.</p>		<p>Distribution</p> <p><input type="checkbox"/> Internal</p> <p><input checked="" type="checkbox"/> Public</p> <p><input type="checkbox"/> Confidential</p>			
		 			

12 May 2021

By Fax (2293 6300) and By Post

AECOM Asia Co. Ltd.
Supervising Officer Representative's Office
No.8 Mong Fat Street, Tuen Mun, New Territories, Hong Kong

Attention: Mr. Roger Man

Dear Mr. Man,

**Re: Agreement No. CE 48/2011 (EP)
Environmental Project Office for the
HZMB Hong Kong Link Road, HZMB Hong Kong Boundary Crossing Facilities, and
Tuen Mun-Chek Lap Kok Link – Investigation**

**Contract No. HY/2012/08
TM-CLKL – Northern Connection Sub-sea Tunnel Section
90th Monthly EM&A Report for April 2021 (EP-354/2009/D)**

Reference is made to the Monthly EM&A Report for April 2021 (ET's ref.: "0212330_90th Monthly EM&A_20210507.doc") certified by the ET Leader and provided to us via e-mail on 7 May 2021.

Please be informed that we have no adverse comments on the captioned Report. We write to verify the captioned submission in accordance with Condition 4.4 of EP-354/2009/D.

Thank you for your attention. Please do not hesitate to contact the undersigned or the ENPO Leader Mr. Y. H. Hui should you have any queries.

Yours sincerely,



Brian Tam
Independent Environmental Checker
Tuen Mun – Chek Lap Kok Link

c.c.

HyD	Mr. Patrick Ng	(By Fax: 3188 6614)
HyD	Mr. Alan Ip	(By Fax: 3188 6614)
AECOM	Mr. Conrad Ng	(By Fax: 3922 9797)
ERM	Dr. Jasmine Ng	(By Fax: 2723 5660)
DBJV	Mr. Bryan Lee	(By Fax: 2293 7499)

Internal: DY, YH, ENPO Site

Table of Contents

	<i>EXECUTIVE SUMMARY</i>	<i>1</i>
<i>1</i>	<i>INTRODUCTION</i>	<i>3</i>
<i>1.1</i>	<i>BACKGROUND</i>	<i>3</i>
<i>1.2</i>	<i>SCOPE OF REPORT</i>	<i>4</i>
<i>1.3</i>	<i>ORGANIZATION STRUCTURE</i>	<i>4</i>
<i>1.4</i>	<i>SUMMARY OF CONSTRUCTION WORKS</i>	<i>5</i>
<i>2</i>	<i>EM&A RESULTS</i>	<i>6</i>
<i>2.1</i>	<i>AIR QUALITY</i>	<i>6</i>
<i>2.2</i>	<i>WATER QUALITY MONITORING</i>	<i>6</i>
<i>2.3</i>	<i>DOLPHIN MONITORING</i>	<i>8</i>
<i>2.4</i>	<i>EM&A SITE INSPECTION</i>	<i>12</i>
<i>2.5</i>	<i>WASTE MANAGEMENT STATUS</i>	<i>12FD</i>
<i>2.6</i>	<i>ENVIRONMENTAL LICENSES AND PERMITS</i>	<i>12</i>
<i>2.7</i>	<i>IMPLEMENTATION STATUS OF ENVIRONMENTAL MITIGATION MEASURES</i>	<i>14</i>
<i>2.8</i>	<i>SUMMARY OF EXCEEDANCES OF THE ENVIRONMENTAL QUALITY PERFORMANCE LIMIT</i>	<i>14</i>
<i>2.9</i>	<i>SUMMARY OF COMPLAINTS, NOTIFICATION OF SUMMONS AND SUCCESSFUL PROSECUTIONS</i>	<i>14</i>
<i>3</i>	<i>FUTURE KEY ISSUES</i>	<i>15</i>
<i>3.1</i>	<i>CONSTRUCTION ACTIVITIES FOR THE COMING MONTH</i>	<i>15</i>
<i>3.2</i>	<i>KEY ISSUES FOR THE COMING MONTH</i>	<i>15</i>
<i>3.3</i>	<i>MONITORING SCHEDULE FOR THE COMING MONTH</i>	<i>15</i>
<i>4</i>	<i>CONCLUSIONS AND RECOMMENDATIONS</i>	<i>16</i>
<i>4.1</i>	<i>CONCLUSIONS</i>	<i>16</i>

<i>APPENDIX A</i>	<i>PROJECT ORGANIZATION FOR ENVIRONMENTAL WORKS</i>
<i>APPENDIX B</i>	<i>CONSTRUCTION PROGRAMME</i>
<i>APPENDIX C</i>	<i>ENVIRONMENTAL MITIGATION AND ENHANCEMENT MEASURE IMPLEMENTATION SCHEDULES</i>
<i>APPENDIX D</i>	<i>COPIES OF CALIBRATION CERTIFICATE FOR AIR QUALITY MONITORING AND WATER QUALITY MONITORING</i>
<i>APPENDIX E</i>	<i>EM&A MONITORING SCHEDULES</i>
<i>APPENDIX F</i>	<i>OPERATIONAL PHASE DOLPHIN MONITORING SURVEY</i>
<i>APPENDIX G</i>	<i>OPERATIONAL PHASE WATER QUALITY MONITORING RESULTS</i>
<i>APPENDIX H</i>	<i>CUMULATIVE STATISTICS ON EXCEEDANCES, COMPLAINTS, NOTIFICATIONS OF SUMMONS AND SUCCESSFUL PROSECUTIONS</i>
<i>APPENDIX I</i>	<i>WASTE FLOW TABLE</i>

EXECUTIVE SUMMARY

Under *Contract No. HY/2012/08*, Dragages – Bouygues Joint Venture (DBJV) is commissioned by the Highways Department (HyD) to undertake the design and construction of the Northern Connection Sub-sea Tunnel Section of the Tuen Mun – Chek Lap Kok Link Project (TM-CLK Link Project) while AECOM Asia Company Limited was appointed by HyD as the Supervising Officer. For implementation of the environmental monitoring and audit (EM&A) programme under the Contract, ERM-Hong Kong, Limited (ERM) has been appointed as the Environmental Team (ET) in accordance with *Environmental Permit No. EP-354/2009/A*. Ramboll Hong Kong Ltd. was employed by HyD as the Independent Environmental Checker (IEC) and Environmental Project Office (ENPO). Subsequent applications for variation of environmental permits (VEP), *EP-354/2009/B*, *EP-354/2009/C* and *EP-354/2009/D*, were granted on 28 January 2014, 10 December 2014 and 13 March 2015, respectively.

The construction phase of the Contract commenced on 1 November 2013 and will tentatively be completed in 2021. The impact monitoring of the EM&A programme, including air quality, water quality, marine ecological monitoring and environmental site inspections, were commenced on 1 November 2013.

This is the Ninetieth Monthly EM&A report presenting the EM&A works carried out during the period from 1 to 30 April 2021 for the *Contract No. HY/2012/08 Northern Connection Sub-sea Tunnel Section* (the “Contract”) in accordance with the Updated EM&A Manual of the TM-CLK Link Contract. As informed by the Contractor, there was no major activities undertaken in the reporting period.

Termination proposal for construction EM&A programme was approved by EPD on 19 March 2021. The construction phase EM&A programme of the Contract has been terminated since 19 March 2021.

A summary of monitoring and audit activities conducted in the reporting period is listed below:

Operational Phase Water Quality Monitoring 1 session

Operational Phase Dolphin Monitoring 2 sessions

Implementation of Marine Mammal Exclusion Zone

No marine works were undertaken during the reporting period, therefore, daily 250 m marine mammal exclusion zone monitoring was not undertaken during the reporting period.

Summary of Breaches of Action/Limit Levels

Breaches of Action and Limit Levels for Air Quality

No Action and Limit Level exceedance was recorded.

Environmental Complaints, Non-compliance & Summons

No non-compliance with EIA recommendations, EP conditions and other requirements associated with the construction of this Contract was recorded in this reporting period.

No environmental complaint was received in this reporting period.

No environmental summons was received in this reporting period.

Reporting Change

There was no reporting change in the reporting period.

Upcoming Works for the Next Reporting Month

There are no major works to be undertaken in May 2021.

Future Key Issue

There are no major works to be undertaken in May 2021.

1.1

BACKGROUND

According to the findings of the Northwest New Territories (NWNT) Traffic and Infrastructure Review conducted by the Transport Department, Tuen Mun Road, Ting Kau Bridge, Lantau Link and North Lantau Highway would be operating beyond capacity after 2016. This forecast has been based on the estimated increase in cross boundary traffic, developments in the Northwest New Territories (NWNT), and possible developments in North Lantau, including the Airport developments, the Lantau Logistics Park (LLP) and the Hong Kong – Zhuhai – Macao Bridge (HZMB). In order to cope with the anticipated traffic demand, two new road sections between NWNT and North Lantau – Tuen Mun – Chek Lap Kok Link (TM-CLKL) and Tuen Mun Western Bypass (TMWB) are proposed.

An Environmental Impact Assessment (EIA) of TM-CLKL (the Project) was prepared in accordance with the EIA Study Brief (No. ESB-175/2007) and the *Technical Memorandum of the Environmental Impact Assessment Process (EIAO-TM)*. The EIA Report was submitted under the Environmental Impact Assessment Ordinance (EIAO) in August 2009. Subsequent to the approval of the EIA Report (EIAO Register Number AEIAR-146/2009), an Environmental Permit (EP-354/2009) for TM-CLKL was granted by the Director of Environmental Protection (DEP) on 4 November 2009, and EP variation (VEP) (EP-354/2009/A) was issued on 8 December 2010. Subsequent applications for variation of environmental permits (VEPs), *EP-354/2009/B*, *EP-354/2009/C* and *EP-354/2009/D*, were granted on 28 January 2014, 10 December 2014 and 13 March 2015, respectively.

Under *Contract No. HY/2012/08*, Dragages – Bouygues Joint Venture (DBJV) is commissioned by the Highways Department (HyD) to undertake the design and construction of the Northern Connection Sub-sea Tunnel Section of TM-CLKL while AECOM Asia Company Limited was appointed by HyD as the Supervising Officer. For implementation of the environmental monitoring and audit (EM&A) programme under the Contract, ERM-Hong Kong, Limited (ERM) has been appointed as the Environmental Team (ET). Ramboll Hong Kong Ltd. was employed by HyD as the Independent Environmental Checker (IEC) and Environmental Project Office (ENPO).

Layout of the Contract components is presented in *Figure 1.1*.

The construction phase of the Contract commenced on 1 November 2013 and will tentatively be completed in 2021. The impact monitoring phase of the EM&A programme, including air quality, water quality, marine ecological monitoring and environmental site inspections, were commenced on 1 November 2013.

Termination proposal for construction EM&A programme was approved by EPD on 19 March 2021. The construction phase EM&A programme of the Contract has been terminated since 19 March 2021.

1.2 SCOPE OF REPORT

This is the Ninetieth Monthly EM&A Report under the *Contract No. HY/2012/08 Tuen Mun – Chek Lap Kok Link – Northern Connection Sub-sea Tunnel Section*. This report presents a summary of the environmental monitoring and audit works in April 2021.

1.3 ORGANIZATION STRUCTURE

The organization structure of the Contract is shown in *Appendix A*. The key personnel contact names and contact details are summarized in *Table 1.1* below.

Table 1.1 *Contact Information of Key Personnel*

Party	Position	Name	Telephone	Fax
Highways Department	Engr 24/SD	Ken T.M. Cheng	2762 4062	3188 6614
SOR (AECOM Asia Company Limited)	Chief Resident Engineer	Roger Man	2293 6388	2293 6300
ENPO / IEC (Ramboll Hong Kong Ltd.)	ENPO Leader	Y.H. Hui	3465 2850	3465 2899
	IEC	Brian Tam	9700 6767	3465 2899
Contractor (Dragages – Bouygues Joint Venture)	Deputy Environmental Manager	Bryan Lee	2293 7323	2293 7499
	24-hour hotline		2293 7330	
ET (ERM-HK)	ET Leader	Jasmine Ng	2271 3311	2723 5660

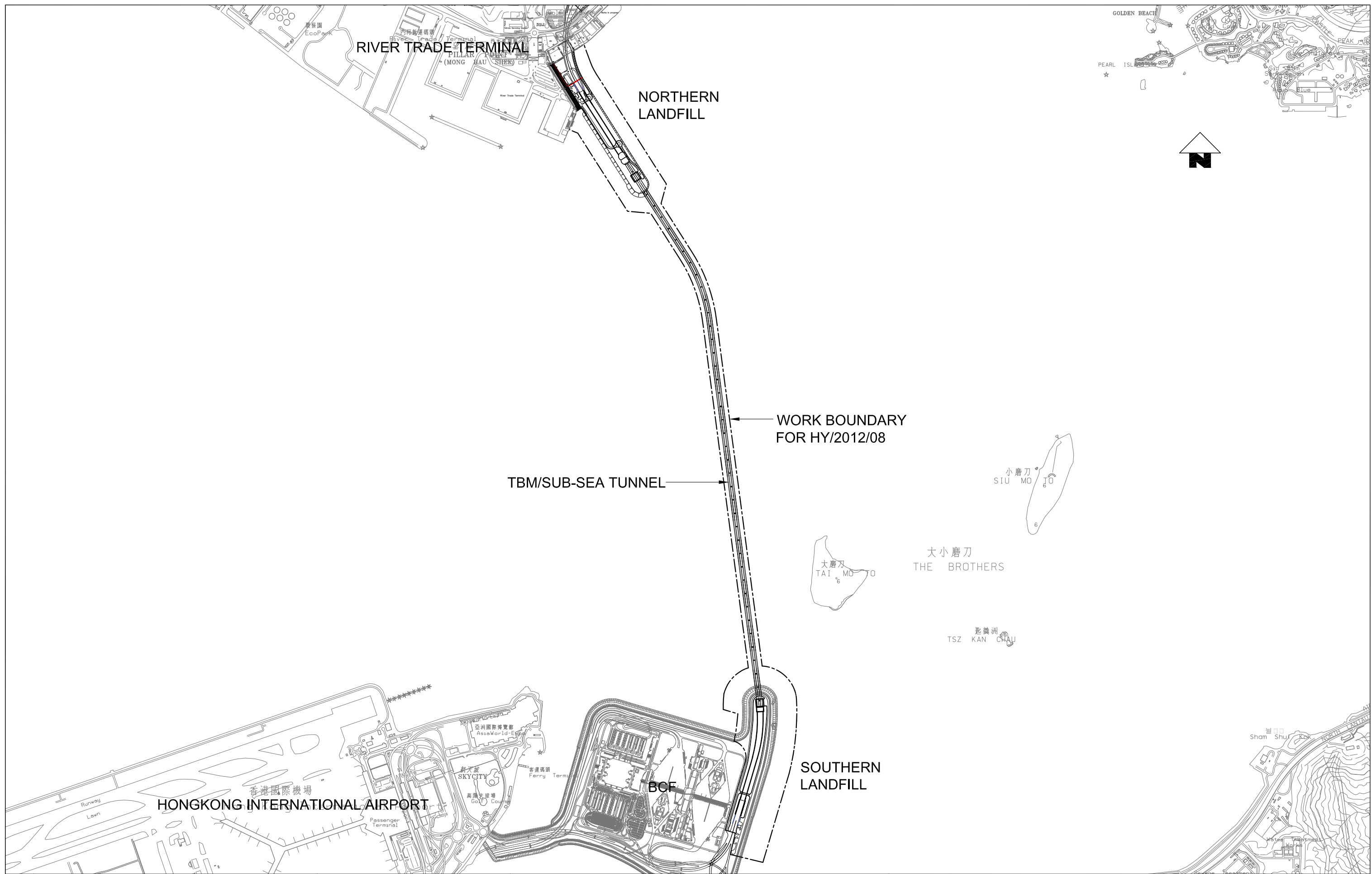

Designed By	PKV	Date	11SEP13
Drawn By	DAI	Checked	PKV
Approved By	SPo	Date	11SEP2013
Rev.	Description	Date	Checked
A	FIRST ISSUE	11SEP13	PKV

Main Contractor

 A member of the Bouygues Construction group
 Dragages - Bouygues Joint Venture 寶嘉 - 布依格聯營

Client

 路政署
HIGHWAYS DEPARTMENT

Contractor's Designer

 Ove Arup & Partners
 Hong Kong Limited

Project
 Contract No. HY/2012/08
 Tuen Mun - Chek Lap Kok Link -
 Northern Connection Sub-Sea Tunnel Section
 Drawing Title
Figure 1.1

Drawing no.	TMCLKL8-DBJ-GEN-DWG-00174
Scale	1:25000 @ A3
CADD Ref.	TMCLKL8-DBJ-GEN-DWG-00174-DFT-A
Issue Status	DFT (DRAFT)
Revision	A

1.4 SUMMARY OF CONSTRUCTION WORKS

The construction phase of this Contract was commenced on 1 November 2013. The construction programme is shown in *Appendix B*.

As per DBJV's information, there was no major activities undertaken in the reporting period.

The Environmental Sensitive Receivers in the vicinity of the Contract are shown in *Figure 1.2*.

The implementation schedule of environmental mitigation measures is presented in *Appendix C*.

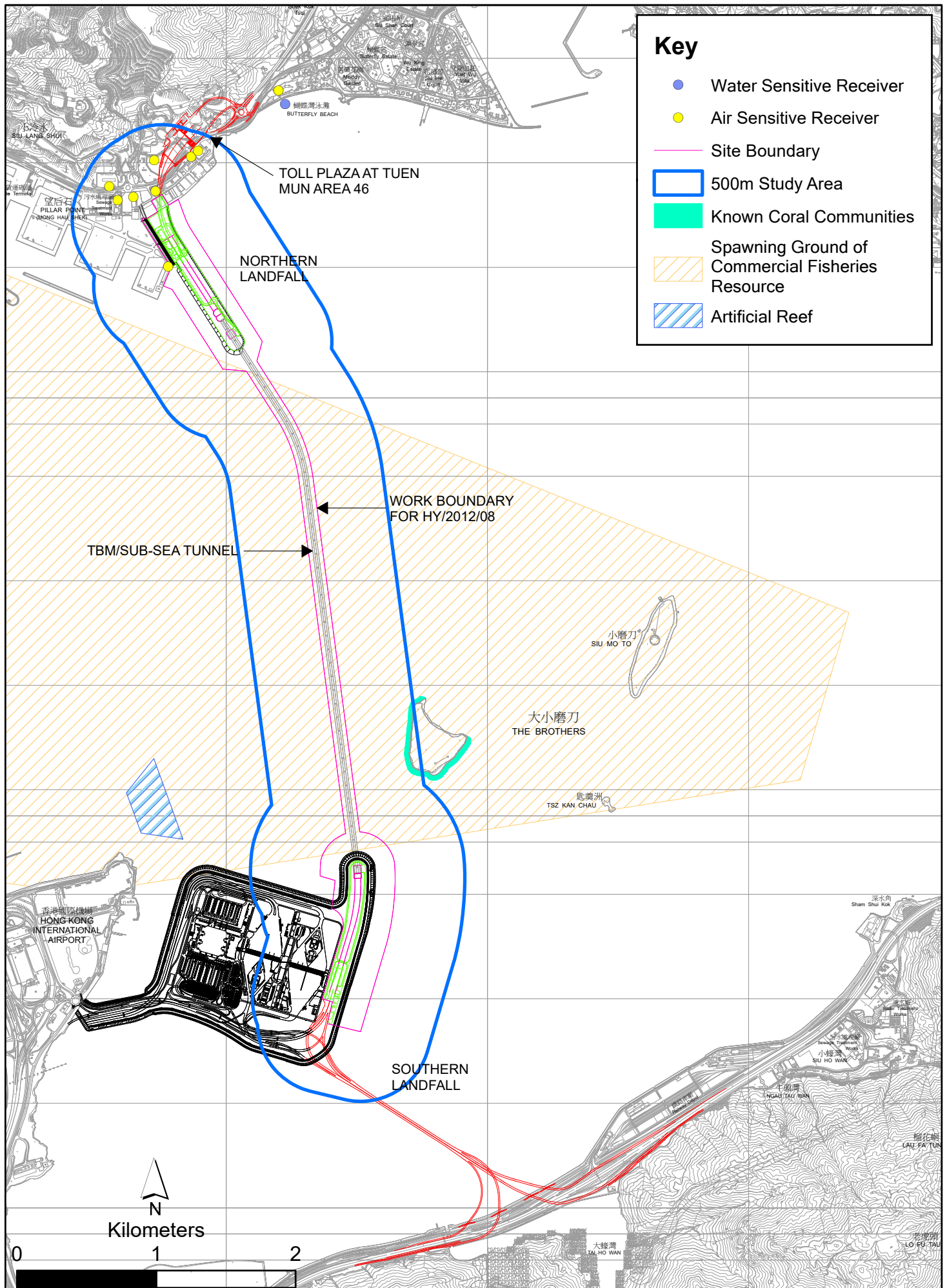

Figure 1.2 Environmental Sensitive Receivers in the vicinity of Contract No. HY/2012/08 Tuen Mun - Chek Lap Kok Link - Northern Connection Sub-Sea Tunnel Section

File: T:\GIS\CONTRACT\0212330\I\mxd\0212330_EMnA_Env_Sensitive_Receiver.mxd
Date: 15/4/2014

The EM&A programme required environmental monitoring for air quality, water quality and marine ecology as well as environmental site inspections for air quality, noise, water quality, waste management, marine ecology and landscape and visual impacts. The EM&A requirements and related findings for each component are summarized in the following sections

2.1 AIR QUALITY

Termination proposal for construction EM&A programme was approved by EPD on 19 March 2021. The construction phase EM&A programme of the Contract has been terminated since 19 March 2021.

2.2 WATER QUALITY MONITORING

2.2.1 Monitoring Requirements & Equipment

According to the Updated EM&A Manual, a operational phase water quality monitoring shall be performed monthly during the first year of Project operation at all designated monitoring stations including control stations. The operation phase water quality monitoring shall be ceased after the first year of operation of the Project subject to the first year review. Operational phase water quality monitoring commenced in June 2020. Locations of water quality monitoring stations presented in *Figure 2.1* and in *Table 2.1*.

Table 2.1 *Locations of Operational Phase Water Quality Monitoring Stations and the Corresponding Monitoring Requirements*

Station ID	Type	Coordinates		*Parameters, unit	Depth	Frequency
		Easting	Northing			
IS(Mf)11	Impact Station (Close to HKBCF construction site)	813562	820716	<ul style="list-style-type: none"> • Temperature(°C) • pH(pH unit) • Turbidity (NTU) • Water depth (m) • Salinity (ppt) 	3 water depths: 1m below sea	Monthly at each station, at mid- flood and mid-ebb tides during the construction period of the Contract.
SR4(N2)	Sensitive receiver (Tai Ho Inlet)	814688	817996	<ul style="list-style-type: none"> • DO (mg/L and % of saturation) 	surface, mid- depth and 1m above sea bed.	
CS2(A)	Control Station	805232	818606	<ul style="list-style-type: none"> • SS (mg/L) 		

Station ID	Type	Coordinates		*Parameters, unit	Depth	Frequency
CS(Mf)5	Control Station	817990	821129		If the water depth is less than 3m, mid-depth sampling only. If water depth is less than 6m, mid-depth may be omitted.	

***Notes:**

In addition to the parameters presented monitoring location/position, time, water depth, sampling depth, tidal stages, weather conditions and any special phenomena or works underway nearby were also recorded.

With reference to the EM&A Report under Contract No. HY/2011/03, water quality monitoring station SR3 was relocated to SR3(N) since 1 September 2017.

With reference to the EM&A Report under Contract No. HY/2011/03, water quality monitoring station SR4 was relocated to SR4(N) since 1 January 2018.

With reference to the EM&A Report under Contract No. HY/2011/03, water quality monitoring station SR4(N) was relocated to SR4(N2) since 21 August 2019.

With reference to the EM&A Report under Contract No. HY/2011/03, water quality monitoring station CS2 was relocated to CS2(A) since 23 August 2017.

Table 2.2 summarizes the equipment used in the operational phase water quality monitoring programme. Copies of the calibration certificates are attached in *Appendix D*.

Table 2.2 Water Quality Monitoring Equipment

Equipment	Model
Multi-Parameters	YSI ProDss 15M100005; 18A104824
Positioning Equipment	Furuno GP-170
Water Depth Detector	Lowrance Mark 5x / Garmin Striker 4

2.2.2 Monitoring Schedule for the Reporting Month

The schedule for operational phase water quality monitoring in April 2021 is provided in *Appendix E*.

2.2.3 Results and Observations

One monitoring event for operational phase water quality monitoring was conducted at all designated monitoring stations in the reporting month. Operational phase water quality monitoring results are provided in *Appendix G*.

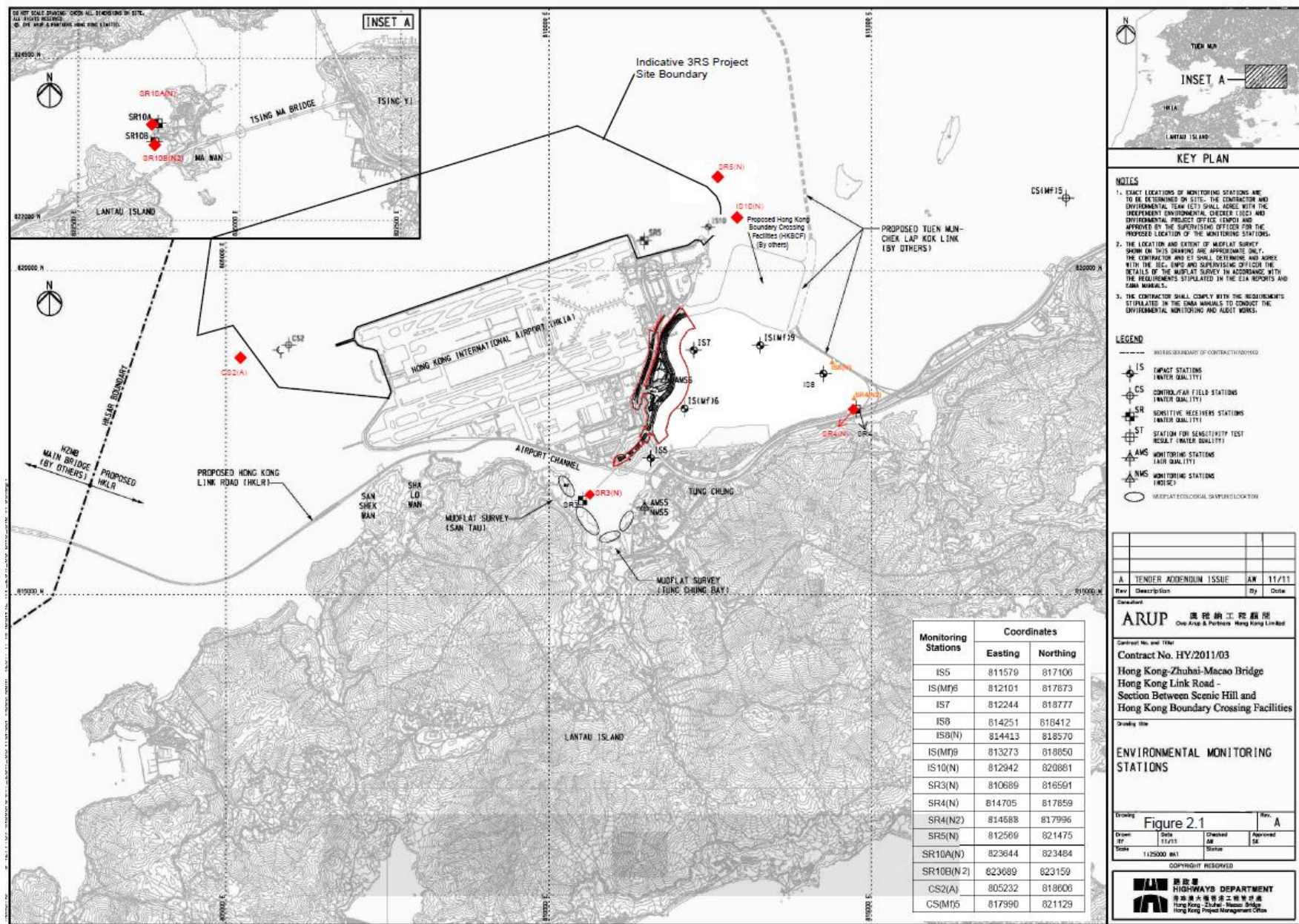

Figure 2.1

Operational Phase Water Quality Monitoring Stations SR3(N), CS2(A), SR4(N2) & CS(Mf)5

(Source from Contract No. HY/2011/03 EM&A Report)

Environmental
Resources
Management



2.3 DOLPHIN MONITORING

2.3.1 Monitoring Requirements

Operational Phase dolphin monitoring is required to be conducted by a qualified dolphin specialist team to evaluate whether there have been any effects on the dolphins. In order to fulfil the EM&A requirements and make good use of available resources, Contract No. HY/2012/08 has taken over the responsibility for implementation of dolphin monitoring from HZMB HKLR Contract No. HY/2011/03 since October 2019.

2.3.2 Monitoring Equipment

Table 2.3 summarises the equipment used for the operational phase dolphin monitoring.

Table 2.3 *Dolphin Monitoring Equipment*

Equipment	Model
Global Positioning System (GPS)	Garmin 18X-PC Geo One Phottix
Camera	Nikon D90 300m 2.8D fixed focus Nikon D90 20-300m zoom lens
Laser Binocular	Infinitor LRF 1000
Marine Binocular	Bushell 7 x 50 marine binocular with compass and reticules
Vessel for Monitoring	65 foot single engine motor vessel with viewing platform 4.5m above water level

2.3.3 Monitoring Parameter, Frequencies & Duration

Dolphin monitoring should cover all transect lines in Northeast Lantau (NEL) and the Northwest Lantau (NWL) survey areas twice per month throughout the entire construction period and operational phase. The monitoring data should be compatible with, and should be made available for, long-term studies of small cetacean ecology in Hong Kong. In order to provide a suitable long-term dataset for comparison, identical methodology and line transects employed in baseline dolphin monitoring was followed in the impact dolphin monitoring and operational phase dolphin monitoring.

2.3.4 Monitoring Location

The operational phase dolphin monitoring was carried out in the NEL and NWL along the line transect as depicted in Figure 2.2. The co-ordinates of all transect lines are shown in Table 2.4 below.

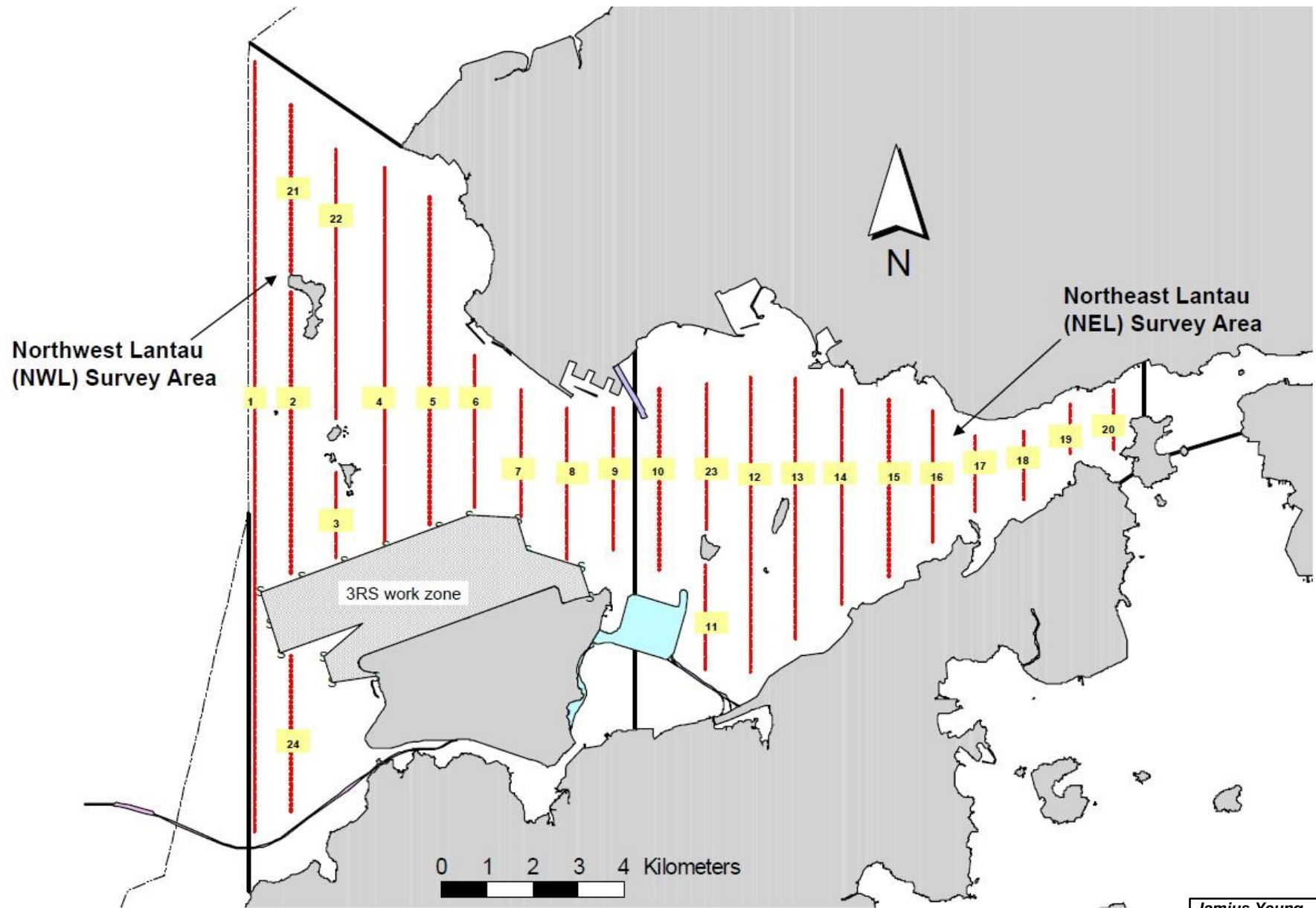

Figure 2.2

Layout of Transect Lines of Dolphin Monitoring in Northwest and Northeast Lantau Areas

Table 2.4 Operational Phase Dolphin Monitoring Line Transect Co-ordinates

Line No.		Easting	Northing	Line No.		Easting	Northing
1	Start Point	804671	815456	13	Start Point	816506	819480
1	End Point	804671	831404	13	End Point	816506	824859
2	Start Point	805476	820800*	14	Start Point	817537	820220
2	End Point	805476	826654	14	End Point	817537	824613
3	Start Point	806464	821150*	15	Start Point	818568	820735
3	End Point	806464	822911	15	End Point	818568	824433
4	Start Point	807518	821500*	16	Start Point	819532	821420
4	End Point	807518	829230	16	End Point	819532	824209
5	Start Point	808504	821850*	17	Start Point	820451	822125
5	End Point	808504	828602	17	End Point	820451	823671
6	Start Point	809490	822150*	18	Start Point	821504	822371
6	End Point	809490	825352	18	End Point	821504	823761
7	Start Point	810499	822000*	19	Start Point	822513	823268
7	End Point	810499	824613	19	End Point	822513	824321
8	Start Point	811508	821123	20	Start Point	823477	823402
8	End Point	811508	824254	20	End Point	823477	824613
9	Start Point	812516	821303	21	Start Point	805476	827081
9	End Point	812516	824254	21	End Point	805476	830562
10	Start Point	813525	821176	22	Start Point	806464	824033
10	End Point	813525	824657	22	End Point	806464	829598
11	Start Point	814556	818853	23	Start Point	814559	821739
11	End Point	814556	820992	23	End Point	814559	824768
12	Start Point	815542	818807	24*	Start Point	805476*	815900*
12	End Point	815542	824882	24*	End Point	805476*	819100*

Remarks: The coordinates of several starting and ending points have been revised due to the presence of a work zone to the north of the airport platform with intense construction activities in association with the construction of the third runway expansion for the Hong Kong International Airport. Co-ordinates in red and marked with asterisk are revised co-ordinates of transect line.

2.3.5 *Monitoring Schedule for the Reporting Month*

Dolphin monitoring was carried out on 8, 22, 27 and 29 April 2021. The dolphin monitoring schedule for the reporting month is shown in *Appendix E*.

2.3.6 *Results & Observations*

A total of 257.50 km of survey effort was collected, with 100% of the total survey effort being conducted under favourable weather conditions (i.e. Beaufort Sea State 3 or below with good visibility) in April 2021. Among the two areas, 94.30 km and 163.20 km of survey effort were collected from NEL and NWL survey areas, respectively. The total survey effort conducted on primary and secondary lines were 192.19 km and 65.31 km respectively. The survey efforts are summarized in *Appendix F*.

No Chinese White Dolphins was sighted in the two sets of surveys in April 2021.

No dolphin sighting was made in the proximity of the TM-CLKL alignment.

The southern end of transect line no. 8 was not travelled on 22 and 27 April 2021 during the dolphin monitoring due to the presence of construction boats along the transect line. Part of the transect line was not travelled due to safety concerns.

Encounter rates of Chinese White Dolphins are deduced from the survey effort and on-effort sighting data made under favourable conditions (Beaufort 3 or below) in April 2021 with the results present in *Tables 2.5* and *2.6*.

Table 2.5 *Individual Survey Event Encounter Rates*

		Encounter rate (STG) (no. of on-effort dolphin sightings per 100 km of survey effort)	Encounter rate (ANI) (no. of dolphins from all on-effort sightings per 100 km of survey effort)
		Primary Lines Only	Primary Lines Only
NEL	Set 1: April 8th / 22nd	0.0	0.0
	Set 2: April 27th / 29th	0.0	0.0
NWL	Set 1: April 8th / 22nd	0.0	0.0
	Set 2: April 27th / 29th	0.0	0.0

Note: Dolphin Encounter Rates are deduced from the Two Sets of Surveys (Two Surveys in Each Set) in April 2021 in Northeast (NEL) and Northwest Lantau (NWL)

Table 2.6 *Monthly Average Encounter Rates*

	Encounter rate (STG) (no. of on-effort dolphin sightings per 100 km of survey effort)		Encounter rate (ANI) (no. of dolphins from all on-effort sightings per 100 km of survey effort)	
	Primary Lines Only	Both Primary and Secondary Lines	Primary Lines Only	Both Primary and Secondary Lines
Northeast Lantau	0.0	0.0	0.0	0.0

Northwest Lantau	0.0	0.0	0.0	0.0
-------------------------	-----	-----	-----	-----

Note: Overall dolphin encounter rates (sightings per 100 km of survey effort) from all four surveys are conducted in April 2021 on primary lines only as well as both primary lines and secondary lines in Northeast and Northwest Lantau.

According to the EM&A Manual, Operational Phase Monitoring on dolphin monitoring shall be undertaken based upon the frequency of forty-eight, one-day survey events at a frequency of 2 per month over a period of 24 months following cessation of the construction. The schedule for operational phase monitoring on dolphin monitoring in April 2021 is provided in *Appendix E*.

2.3.7

Implementation of Marine Mammal Exclusion Zone

No marine works were undertaken during the reporting period, therefore, daily 250 m marine mammal exclusion zone monitoring was not undertaken during the reporting period.

2.4 EM&A SITE INSPECTION

Termination proposal for construction EM&A programme was approved by EPD on 19 March 2021. The construction phase EM&A programme of the Contract has been terminated since 19 March 2021.

2.5 WASTE MANAGEMENT STATUS

The Contractor had submitted application form for registration as chemical waste producer under the Contract. Sufficient numbers of receptacles were available for general refuse collection and sorting.

Wastes generated during this reporting period included mainly construction wastes (inert and non-inert). Reference has been made to the waste flow table prepared by the Contractor (*Appendix I*). The quantities of different types of wastes are summarized in *Table 2.7*.

Table 2.7 Quantities of Different Waste Generated in the Reporting Month

Month/Year	Inert Construction Waste ^(a) (tonnes)	Inert Construction Waste Re-used (tonnes)	Non-inert Construction Waste ^(b) (tonnes)	Recyclable Materials ^(c) (kg)	Chemical Wastes (kg)	Marine Sediment (m ³)		
						Category L	Category M (M _p & M _f)	Mixed (L+M)
April 2021	8	0	68	0	0	0	0	0

Notes:

- (a) Inert construction wastes include hard rock and large broken concrete, and materials disposed as public fill.
- (b) Non-inert construction wastes include general refuse disposed at landfill.
- (c) Recyclable materials include metals, paper, cardboard, plastics, timber and others.

The Contractor was advised to properly maintain on site C&D materials and waste collection, sorting and recording system, dispose of C&D materials and wastes at designated ground and maximize reuse/ recycle of C&D materials and wastes. The Contractor was also reminded to properly maintain the site tidiness and dispose of the wastes accumulated on site regularly and properly.

For chemical waste containers, the Contractor was reminded to treat properly and store temporarily in designated chemical waste storage area on site in accordance with the Code of Practice on the Packaging, Labelling and Storage of Chemical Wastes.

2.6 ENVIRONMENTAL LICENSES AND PERMITS

The status of environmental licensing and permit is summarized in *Table 2.8* below.

Table 2.8 *Summary of Environmental Licensing and Permit Status*

License/ Permit	License or Permit No.	Date of Issue	Date of Expiry	License/ Permit Holder	Remarks
Environmental Permit	EP-354/2009/D	13 March 2015	Throughout the Contract	HyD	Application for VEP on 3 March 2015 to supersede EP-354/2009/C
Construction Dust Notification	435068	27 June 2018	Throughout the Contract	DBJV	Northern Landfall
Construction Dust Notification	435505	12 July 2018	Throughout the Contract	DBJV	Southern Landfall
Chemical Waste Registration	5213-422-D2516-02	18 January 2017	Throughout the Contract	DBJV	Northern Landfall
Chemical Waste Registration	5213-951-D2591-01	25 May 2016	Throughout the Contract	DBJV	Southern Landfall
Construction Waste Disposal Account	7018108	28 August 2013	Throughout the Contract	DBJV	Waste disposal in Contract No. HY/2012/08
Waste Water Discharge License	WT00031435-2018	2 August 2018	31 August 2023	DBJV	Southern Landfall
Waste Water Discharge License	WT00034060-2019	25 July 2019	30 June 2024	DBJV	Northern Landfall (4 Discharge Point)

Notes:

HyD = Highways Department

DBJV = Dragages - Bouygues Joint Venture

VEP = Variation of Environmental Permit

2.7 *IMPLEMENTATION STATUS OF ENVIRONMENTAL MITIGATION MEASURES*

In response to the site audit findings, the Contractors carried out all corrective actions.

A summary of the Implementation Schedule of Environmental Mitigation Measures (EMIS) is presented in *Appendix C*. The necessary mitigation measures relevant to this Contract were implemented properly.

2.8 *SUMMARY OF EXCEEDANCES OF THE ENVIRONMENTAL QUALITY PERFORMANCE LIMIT*

No Action and Limit Level exceedance of was recorded.

Cumulative statistics are provided in *Appendix H*.

2.9 *SUMMARY OF COMPLAINTS, NOTIFICATION OF SUMMONS AND SUCCESSFUL PROSECUTIONS*

The Environmental Complaint Handling Procedure is provided in *Figure 2.3*.

No environmental complaint was received in this reporting period.

No environmental summons was received in this reporting period.

Statistics on complaints, notifications of summons and successful prosecutions are summarized in *Appendix H*.

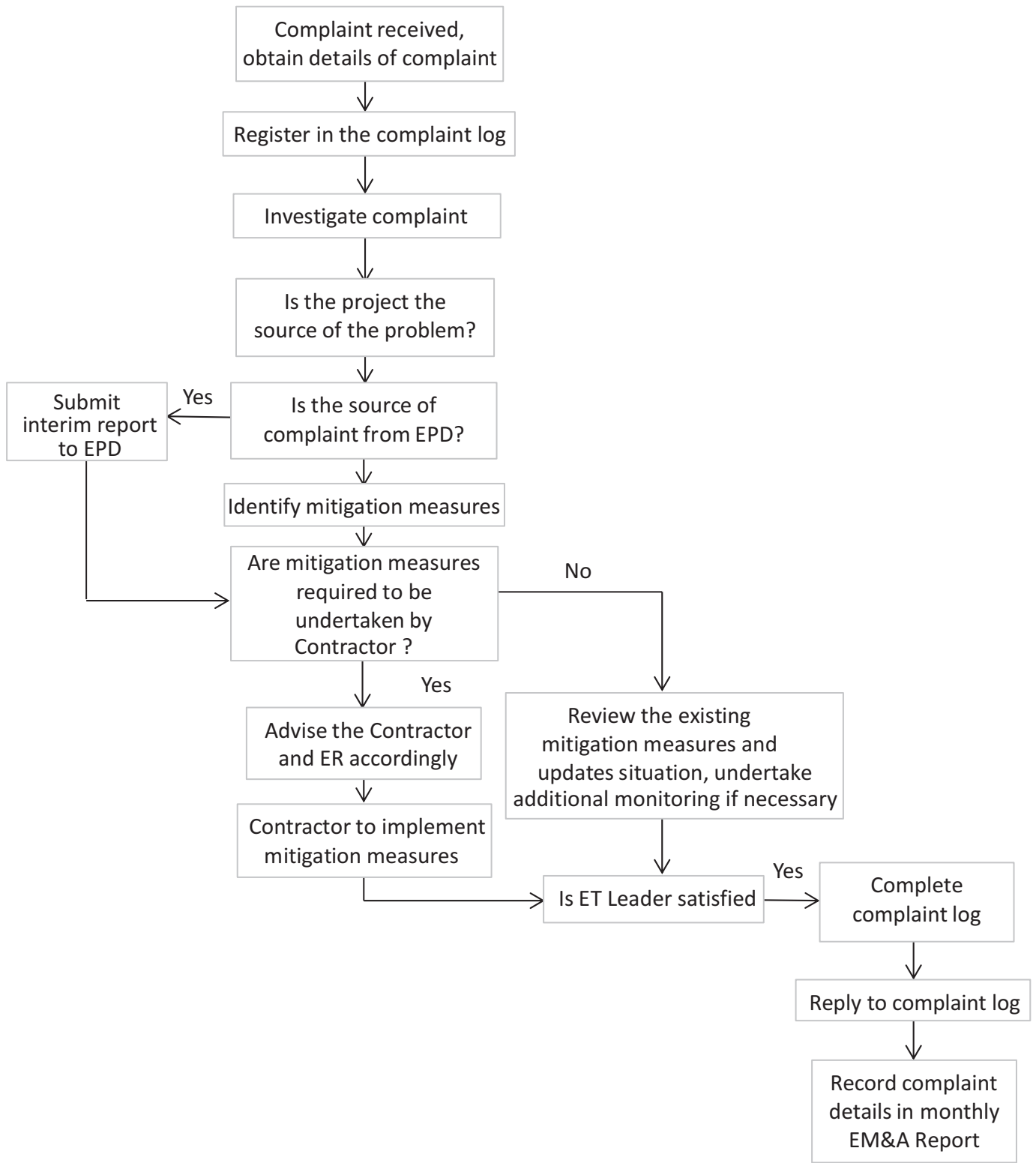

Environmental Complaint Handling Procedure

Figure 2.3

FILE: 0215660n2.cdr
DATE: 06/12/2013

Environmental
Resources
Management



3 *FUTURE KEY ISSUES*

3.1 *CONSTRUCTION ACTIVITIES FOR THE COMING MONTH*

There are no major works to be undertaken in May 2021.

3.2 *KEY ISSUES FOR THE COMING MONTH*

There are no major works to be undertaken in May 2021.

3.3 *MONITORING SCHEDULE FOR THE COMING MONTH*

The tentative schedule for environmental monitoring in May 2021 is provided in *Appendix E*.

*4.1**CONCLUSIONS*

This Ninetieth EM&A Report presents the findings of the EM&A activities undertaken during the period from 1 to 30 April 2021, in accordance with the Updated EM&A Manual and the requirements of EP-354/2009/D.

Operational phase water quality monitoring and operational phase dolphin monitoring were carried out in this reporting month.

No Action and Limit Level exceedance was recorded.

No Chinese White Dolphin sighting was recorded during the two sets of surveys in April 2021.

No non-compliance event was recorded during the reporting period.

No environmental complaint was received in this reporting period.

No environmental summons was received in this reporting period.

Termination proposal for construction EM&A programme was approved by EPD on 19 March 2021. The construction phase EM&A programme of the Contract has been terminated since 19 March 2021.

Appendix A

Project Organization for Environmental Works

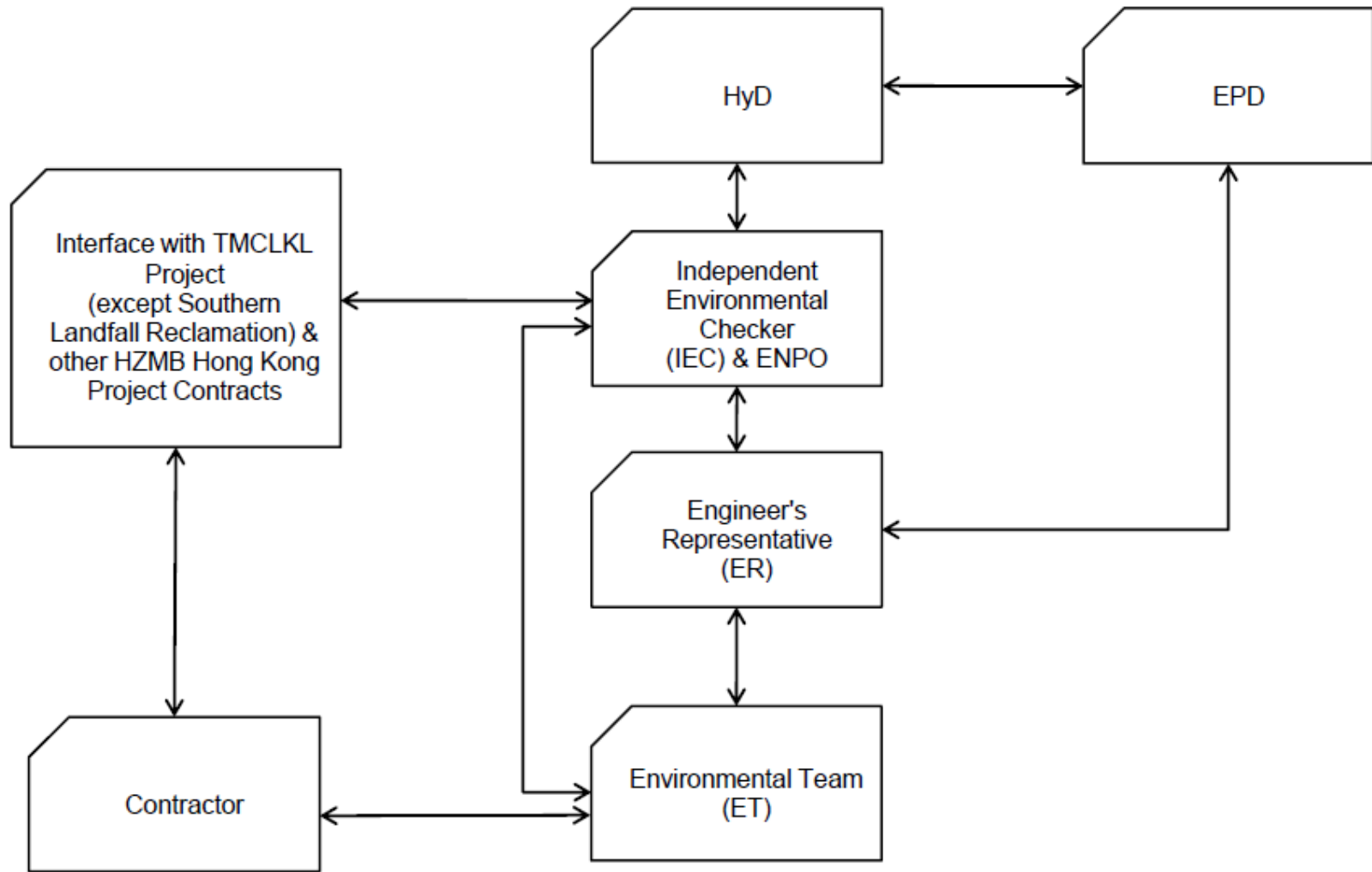

↔ Line of Communication

Appendix B

Construction Programme

Appendix C

Environmental Mitigation
and Enhancement Measure
Implementation Schedules

Contract No. HY/2012/08
Tuen Mun – Chek Lap Kok Link
Northern Connection Sub-sea Tunnel Section
Environmental Mitigation and Enhancement Measure Implementation Schedule

EIA Reference	EM&A Manual Reference	Environmental Protection Measures	Location/ Timing	Implementation Agent	Relevant Standard or Requirement	Implementation Stages			Status *
						D	C	O	
Air Quality									
4.8.1	3.8	An effective watering programme of twice daily watering with complete coverage, is estimated to reduce by 50%. This is recommended for all areas in order to reduce dust levels to a minimum;	All areas / throughout construction period	Contractor	TMEIA Avoid smoke impacts and disturbance		Y		N/A
4.8.1	3.8	Watering of the construction sites in Lantau for 8 times/day and in Tuen Mun for 12 times/day to reduce dust emissions by 87.5% and 91.7% respectively and shall be undertaken.	All areas / throughout construction period	Contractor	TMEIA Avoid dust generation		Y		N/A
4.8.1	3.8	The Contractor shall, to the satisfaction of the Engineer, install effective dust suppression measures and take such other measures as may be necessary to ensure that at the Site boundary and any nearby sensitive receiver, dust levels are kept to acceptable levels.	All areas / throughout construction period	Contractor	TMEIA Avoid dust generation		Y		N/A
4.8.1	3.8	The Contractor shall not burn debris or other materials on the works areas.	All areas / throughout construction period	Contractor	TMEIA Avoid dust generation		Y		N/A
4.8.1	3.8	In hot, dry or windy weather, the watering programme shall maintain all exposed road surfaces and dust sources wet.	All unpaved haul roads / throughout construction period in hot, dry or windy weather	Contractor	TMEIA Avoid smoke impacts and disturbance		Y		N/A
4.8.1	3.8	Where breaking of oversize rock/concrete is required, watering shall be implemented to control dust. Water spray shall be used during the handling of fill material at the site and at active cuts, excavation and fill sites where dust is likely to be created.	All areas / throughout construction period	Contractor	TMEIA Avoid dust generation		Y		N/A
4.8.1	3.8	Open dropping heights for excavated materials shall be controlled to a maximum height of 2m to minimise the fugitive dust arising from unloading.	All areas / throughout construction period	Contractor	TMEIA Avoid dust generation		Y		N/A
4.8.1	3.8	During transportation by truck, materials shall not be loaded to a level higher than the side and tail boards, and shall be dampened or covered before transport.	All areas / throughout construction period	Contractor	TMEIA Avoid dust generation		Y		N/A

Legend: D=Design, C=Construction, O=Operation

Note: Funding Agent for all mitigation measures will be the Highways Department of the Hong Kong SAR Government

Contract No. HY/2012/08
Tuen Mun – Chek Lap Kok Link
Northern Connection Sub-sea Tunnel Section
Environmental Mitigation and Enhancement Measure Implementation Schedule

EIA Reference	EM&A Manual Reference	Environmental Protection Measures	Location/ Timing	Implementation Agent	Relevant Standard or Requirement	Implementation Stages			Status *
						D	C	O	
4.8.1	3.8	Materials having the potential to create dust shall not be loaded to a level higher than the side and tail boards, and shall be covered by a clean tarpaulin. The tarpaulin shall be properly secured and shall extend at least 300mm over the edges of the side and tail boards.	All areas / throughout construction period	Contractor	TMEIA Avoid dust generation		Y		N/A
4.8.1	3.8	No earth, mud, debris, dust and the like shall be deposited on public roads. Wheel washing facility shall be usable prior to any earthworks excavation activity on the site.	All site exits / throughout construction period	Contractor	TMEIA Avoid dust		Y		N/A
4.8.1	3.8	Areas of exposed soil shall be minimised to areas in which works have been completed shall be restored as soon as is practicable.	All exposed surfaces / throughout construction period	Contractor	TMEIA Avoid dust generation		Y		N/A
4.8.1	3.8	All stockpiles of aggregate or spoil shall be enclosed or covered and water applied in dry or windy condition.	All areas / throughout construction period	Contractor	TMEIA Avoid dust generation		Y		N/A
4.11	Section 3	EM&A in the form of 1 hour and 24 hour dust monitoring and site audit.	All representative existing ASRs / throughout construction period	Contractor	EM&A Manual		Y		N/A
WATER QUALITY									
<i>Marine Works (Sequence A)</i>									
6.1	Annex A	Construction of seawalls to be advanced by at least 200m before the main reclamation dredging and filling can commence. The protection by advanced seawall is a dynamic process depending on the progress of the construction activities and the stage when such protection could be realised is illustrated in Figure 6.2a and detailed in Appendix D6a. The part of the works where such measures can be undertaken for the majority of the time includes the following locations: - TM-CLKL northern reclamation;	All areas/ prior to dredging and backfilling works	Contractor	TM-EIAO		Y		N/A
6.1	-	a maximum of 50% public fill to be used for all seawall filling below +2.5mPD for TM-CLKL southern and northern landfalls.	TM-CLKL seawall filling	Contractor	TM-EIAO		Y		N/A

Legend: D=Design, C=Construction, O=Operation

Note: Funding Agent for all mitigation measures will be the Highways Department of the Hong Kong SAR Government

Contract No. HY/2012/08
Tuen Mun – Chek Lap Kok Link
Northern Connection Sub-sea Tunnel Section
Environmental Mitigation and Enhancement Measure Implementation Schedule

EIA Reference	EM&A Manual Reference	Environmental Protection Measures	Location/ Timing	Implementation Agent	Relevant Standard or Requirement	Implementation Stages			Status *
						D	C	O	
6.1	-	a maximum of 30% public fill to be used for reclamation filling below +2.5mPD for TM-CLKL southern landfall	TM-CLKL southern landfall reclamation filling	Contractor	TM-EIAO		Y		N/A
6.1	-	a maximum of 100% public fill to be used for reclamation filling below +2.5mPD for TM-CLKL northern landfall	TM-CLKL northern landfall reclamation filling	Contractor	TM-EIAO		Y		N/A
6.1	-	Use of cage type silt curtains round all grab dredgers during the HKBCF, HKLR and TM-CLKL southern reclamation works.	All areas dredging works	Contractor	TM-EIAO		Y		N/A
	Figure 1.1 of Annex C	A layer of floating type silt curtain will be applied when dredging and reclamation works are being undertaken at Portion N-a as shown in Figure 1.1 of Annex C of the EM&A Manual.	All areas/ through out marine works	Contractor	TM-EIAO		Y		N/A
6.1	-	Trailer suction hopper dredgers shall not allow mud to overflow.	All areas/ throughout construction period	Contractor	Marine Fill Committee Guidelines. DASO permit conditions.		Y		N/A
6.1	-	The use of Lean Material Overboard (LMOB) systems shall be prohibited.	All areas/ throughout construction period	Contractor	Marine Fill Committee Guidelines. DASO permit conditions.		Y		N/A
6.1	Annex A	For other parts of the reclamation works construction of seawalls to be advanced by at least 200m before the main reclamation dredging and filling can commence. It should be noted that the protection by advanced seawall is a dynamic process depending on the progress of the construction activities and the stage when such protection could be realised is illustrated in Figure 6.2b and detailed in Appendices D6b. The part of the works where such measures can be undertaken for the majority of the time includes the following locations: - TM-CLKL northern reclamation; - Reclamation filling for Portion D of HKBCF; Reclamation filling for FSD berth of HKBCF; and - Reclamation dredging and filling for Portion 1 of HKLR;	TM-CLKL northern landfall, Portion D of HKBCF and HKLR	Contractor	TM-EIAO		Y		N/A
Figure 6.2b Appendix D6b									

Legend: D=Design, C=Construction, O=Operation

Note: Funding Agent for all mitigation measures will be the Highways Department of the Hong Kong SAR Government

Contract No. HY/2012/08
Tuen Mun – Chek Lap Kok Link
Northern Connection Sub-sea Tunnel Section
Environmental Mitigation and Enhancement Measure Implementation Schedule

EIA Reference	EM&A Manual Reference	Environmental Protection Measures	Location/ Timing	Implementation Agent	Relevant Standard or Requirement	Implementation Stages			Status *
						D	C	O	
6.1	-	The filling material for the other parts of the works are the same as Sequence A;	All other areas/backfilling works	Contractor	TM-EIAO		Y		N/A
6.1	5.7	Cage type silt curtain (with steel enclosure) shall be used for grab dredgers working in the site of HKBCF and TM- CLKL southern reclamation. Cage type silt curtains will be applied round all grab dredgers at other works area.	HKBCF, HKLR and TM-CLKL grab dredging	Contractor	TM-EIAO		Y		N/A
6.1	Annex A	A layer of floating type silt curtain will be applied around all works as defined in Appendix D6b.	All areas/ through out marine works	Contractor	TM-EIAO		Y		N/A
6.1	-	TM-CLKL northern landfall: - Reclamation filling shall not proceed until at least 200m section of leading seawall at both the east and west sides of the reclamation are formed above +2.5 mPD, except for 100m gaps for marine access;	All areas/ through out marine works	Contractor	TM-EIAO		Y		N/A
<i>General Marine Works</i>									
6.1	-	Use of TBM for the construction of the submarine tunnel.	Tunnel works / Construction phase	Contractor	TM-EIAO		Y		N/A
6.1	-	Export dredged spoils from NWWCZ.	All areas as much as possible / dredging activities	Contractor	DASO Permit conditions		Y		N/A
6.1	-	Where public fill is proposed for filling below +2.5mPD, the fine content in the public fill will be controlled to 25%	All areas/ backfilling works	Contractor	TM-EIAO		Y		N/A
6.1	-	Where sand fill is proposed for filling below +2.5mPD, the fine content in the sand fill will be controlled to 5%.	All areas/ backfilling works	Contractor	TM-EIAO		Y		N/A
6.1	-	Mechanical grabs shall be designed and maintained to avoid spillage and should seal tightly while being lifted.	All areas/ throughout construction period	Contractor	Marine Fill Committee Guidelines. DASO permit conditions.		Y		N/A
6.1	-	Barges and hopper dredgers shall have tight fitting seals to their bottom openings to prevent leakage of material.	All areas/ throughout construction period	Contractor	Marine Fill Committee Guidelines. DASO permit conditions.		Y		N/A

Legend: D=Design, C=Construction, O=Operation

Note: Funding Agent for all mitigation measures will be the Highways Department of the Hong Kong SAR Government

Contract No. HY/2012/08
Tuen Mun – Chek Lap Kok Link
Northern Connection Sub-sea Tunnel Section
Environmental Mitigation and Enhancement Measure Implementation Schedule

EIA Reference	EM&A Manual Reference	Environmental Protection Measures	Location/ Timing	Implementation Agent	Relevant Standard or Requirement	Implementation Stages			Status *
						D	C	O	
6.1	-	Any pipe leakages shall be repaired quickly. Plant should not be operated with leaking pipes.	All areas/ throughout construction period	Contractor	Marine Fill Committee Guidelines. DASO permit conditions.		Y		N/A
6.1	-	Loading of barges and hoppers shall be controlled to prevent splashing of dredged material to the surrounding water. Barges or hoppers shall not be filled to a level which will cause overflow of materials or pollution of water during loading or transportation.	All areas/ throughout construction period	Contractor	Marine Fill Committee Guidelines. DASO permit conditions.		Y		N/A
6.1	-	Excess material shall be cleaned from the decks and exposed fittings of barges and hopper dredgers before the vessel is moved.	All areas/ throughout construction period	Contractor	Marine Fill Committee Guidelines. DASO permit conditions.		Y		N/A
6.1	-	Adequate freeboard shall be maintained on barges to reduce the likelihood of decks being washed by wave action;	All areas/ throughout construction period	Contractor	Marine Fill Committee Guidelines. DASO permit conditions.		Y		N/A
6.1	-	All vessels shall be sized such that adequate clearance is maintained between vessels and the sea bed at all states of the tide to ensure that undue turbidity is not generated by turbulence from vessel movement or propeller wash.	All areas/ throughout construction period	Contractor	Marine Fill Committee Guidelines. DASO permit conditions.		Y		N/A
6.1	-	The works shall not cause foam, oil, grease, litter or other objectionable matter to be present in the water within and adjacent to the works site.	All areas/ throughout construction period	Contractor	Marine Fill Committee Guidelines. DASO permit conditions.		Y		N/A
6.1	5.2	Silt curtain shall have proved effectiveness from the producer and shall be fully maintained throughout the works by the contractor.	All areas/ throughout construction period	Contractor	TM-EIAO		Y		N/A

Legend: D=Design, C=Construction, O=Operation

Note: Funding Agent for all mitigation measures will be the Highways Department of the Hong Kong SAR Government

Contract No. HY/2012/08
Tuen Mun – Chek Lap Kok Link
Northern Connection Sub-sea Tunnel Section
Environmental Mitigation and Enhancement Measure Implementation Schedule

EIA Reference	EM&A Manual Reference	Environmental Protection Measures	Location/ Timing	Implementation Agent	Relevant Standard or Requirement	Implementation Stages			Status *
						D	C	O	
6.1	-	The daily maximum production rates shall not exceed those assumed in the water quality assessment.	All areas/ throughout construction period	Contractor	TM-EIAO		Y		N/A
6.1	-	The dredging and filling works shall be scheduled to spread the works evenly over a working day.	All areas/ throughout construction period	Contractor	TM-EIAO		Y		N/A
<i>Land Works</i>									
6.1	-	Wastewater from temporary site facilities should be controlled to prevent direct discharge to surface or marine waters.	All areas/ throughout construction period	Contractor	TM-EIAO		Y		N/A
6.1	-	Sewage effluent and discharges from on-site kitchen facilities shall be directed to Government sewer in accordance with the requirements of the WPCO or collected for disposal offsite. The use of soakaways shall be avoided.	All areas/ throughout construction period	Contractor	TM-EIAO		Y		N/A
6.1	-	Storm drainage shall be directed to storm drains via adequately designed sand/silt removal facilities such as sand traps, silt traps and sediment basins. Channels, earth bunds or sand bag barriers should be provided on site to properly direct stormwater to such silt removal facilities. Catchpits and perimeter channels should be constructed in advance of site formation works and earthworks.	All areas/ throughout construction period	Contractor	TM-EIAO		Y		N/A
6.1	-	Silt removal facilities, channels and manholes shall be maintained and any deposited silt and grit shall be removed regularly, including specifically at the onset of and after each rainstorm.	All areas/ throughout construction period	Contractor	TM-EIAO		Y		N/A
6.1	-	Temporary access roads should be surfaced with crushed stone or gravel.	All areas/ throughout construction period	Contractor	TM-EIAO		Y		N/A
6.1	-	Rainwater pumped out from trenches or foundation excavations should be discharged into storm drains via silt removal facilities.	All areas/ throughout construction period	Contractor	TM-EIAO		Y		N/A
6.1	-	Measures should be taken to prevent the washout of construction materials, soil, silt or debris into any drainage system.	All areas/ throughout construction period	Contractor	TM-EIAO		Y		N/A
6.1	-	Open stockpiles of construction materials (e.g. aggregates and sand) on site should be covered with tarpaulin or similar fabric during rainstorms.	All areas/ throughout construction period	Contractor	TM-EIAO		Y		N/A

Legend: D=Design, C=Construction, O=Operation

Note: Funding Agent for all mitigation measures will be the Highways Department of the Hong Kong SAR Government

Contract No. HY/2012/08
Tuen Mun – Chek Lap Kok Link
Northern Connection Sub-sea Tunnel Section
Environmental Mitigation and Enhancement Measure Implementation Schedule

EIA Reference	EM&A Manual Reference	Environmental Protection Measures	Location/ Timing	Implementation Agent	Relevant Standard or Requirement	Implementation Stages			Status *
						D	C	O	
6.1	5.8	Manholes (including any newly constructed ones) should always be adequately covered and temporarily sealed so as to prevent silt, construction materials or debris from getting into the drainage system, and to prevent storm run-off from getting into foul sewers.	All areas/ throughout construction period	Contractor	TM-EIAO		Y		N/A
6.1	-	Discharges of surface run-off into foul sewers must always be prevented in order not to unduly overload the foul sewerage system.	All areas/ throughout construction period	Contractor	TM-EIAO		Y		N/A
6.1	-	All vehicles and plant should be cleaned before they leave the construction site to ensure that no earth, mud or debris is deposited by them on roads. A wheel washing bay should be provided at every site exit.	All areas/ throughout construction period	Contractor	TM-EIAO		Y		N/A
6.1	-	Wheel wash overflow shall be directed to silt removal facilities before being discharged to the storm drain.	All areas/ throughout construction period	Contractor	TM-EIAO		Y		N/A
6.1	-	Section of construction road between the wheel washing bay and the public road should be surfaced with crushed stone or coarse gravel.	All areas/ throughout construction period	Contractor	TM-EIAO		Y		N/A
6.1	-	Wastewater generated from concreting, plastering, internal decoration, cleaning work and other similar activities, shall be screened to remove large objects.	All areas/ throughout construction period	Contractor	TM-EIAO		Y		N/A
6.1	-	Vehicle and plant servicing areas, vehicle wash bays and lubrication facilities shall be located under roofed areas. The drainage in these covered areas shall be connected to foul sewers via a petrol interceptor in accordance with the requirements of the WPCO or collected for off site disposal.	All areas/ throughout construction period	Contractor	TM-EIAO		Y		N/A
6.1	-	The Contractor shall prepare an oil / chemical cleanup plan and ensure that leakages or spillages are contained and cleaned up immediately.	All areas/ throughout construction period	Contractor	TM-EIAO		Y		N/A
6.1	-	Waste oil should be collected and stored for recycling or disposal, in accordance with the Waste Disposal Ordinance.	All areas/ throughout construction period	Contractor	TM-EIAO Waste Disposal Ordinance		Y		N/A

Legend: D=Design, C=Construction, O=Operation

Note: Funding Agent for all mitigation measures will be the Highways Department of the Hong Kong SAR Government

Contract No. HY/2012/08
Tuen Mun – Chek Lap Kok Link
Northern Connection Sub-sea Tunnel Section
Environmental Mitigation and Enhancement Measure Implementation Schedule

EIA Reference	EM&A Manual Reference	Environmental Protection Measures	Location/ Timing	Implementation Agent	Relevant Standard or Requirement	Implementation Stages			Status *
						D	C	O	
6.1	-	All fuel tanks and chemical storage areas should be provided with locks and be sited on sealed areas. The storage areas should be surrounded by bunds with a capacity equal to 110% of the storage capacity of the largest tank.	All areas/ throughout construction period	Contractor	TM-EIAO		Y		N/A
6.1	-	Surface run-off from bunded areas should pass through oil/grease traps prior to discharge to the stormwater system.	All areas/ throughout construction period	Contractor	TM-EIAO		Y		N/A
6.1	-	Roadside gullies to trap silt and grit shall be provided prior to discharging the stormwater into the marine environment. The sumps will be maintained and cleaned at regular intervals.	Roadside/ design and operation	Design Consultant/ Contractor	TM-EIAO	Y		Y	N/A
6.1	Section 5	All construction works shall be subject to routine audit to ensure implementation of all EIA recommendations and good working practice.	All areas/ throughout construction period	Contractor	EM&A Manual		Y		N/A
<i>Water Quality Monitoring</i>									
6.1	Section 5	Water quality monitoring shall be undertaken for suspended solids, turbidity, and dissolved oxygen. Nutrients and metal parameters shall also be measured for Mf sediment operations (only HKBCF and HKLR required handling of Mf sediment) during baseline, backfilling and post construction period. One year operation phase water quality monitoring at designated stations.	Designated monitoring stations as defined in EM&A Manual, Section 5/ Before, through-out marine construction period, post construction and monthly operational phase water quality monitoring for a year.	Contractor	EM&A Manual		Y	Y	Operational phase water quality monitoring commenced in June 2020.
ECOLOGY									
8.14	6.3	Specification for and implement pre, during and post construction dolphin abundance monitoring.	All Areas/Detailed Design/ during construction works/post construction	Design Consultant/ Contractor	TMEIA	Y	Y	Y	✓
8.14	6.3,6.5	Specification and implementation of 250m dolphin exclusion zone.	All dredging and reclamation areas/Detailed Design/during all reclamation and dredging works	Design Consultant/ Contractor	TMEIA	Y	Y		N/A
8.15	6.3, 6.5	Specification and deployment of an artificial reef of an area of 3,600m ² in an area where fishing activities are prohibited.	Area of prohibited fishing activities/Detailed Design/towards end of construction period	TM-CLKL/ HKBCF Design Consultant/TM-CLKL/ HKBCF Contractor	TMEIA	Y		Y	N/A. To be implemented by AFCD.

Legend: D=Design, C=Construction, O=Operation

Note: Funding Agent for all mitigation measures will be the Highways Department of the Hong Kong SAR Government

Contract No. HY/2012/08
Tuen Mun – Chek Lap Kok Link
Northern Connection Sub-sea Tunnel Section
Environmental Mitigation and Enhancement Measure Implementation Schedule

EIA Reference	EM&A Manual Reference	Environmental Protection Measures	Location/ Timing	Implementation Agent	Relevant Standard or Requirement	Implementation Stages			Status *
						D	C	O	
8.14	6.3, 6.5	Specification and implementation of marine vessel control specifications	All areas/Detailed Design/during construction works	Design Consultant/ Contractor	TMEIA	Y	Y		N/A
8.14	6.3, 6.5	Design and implementation of acoustic decoupling methods for dredging and reclamation works	All areas/ Detailed Design/during dredging and reclamation works	Design Consultant/ Contractor	TMEIA	Y	Y		N/A
8.15	6.3, 6.4	Pre-construction phase survey and coral translocation	Detailed Design/Prior to construction	Design Consultant/ Contractor	TMEIA	Y	Y		N/A
8.15	6.5	Audit coral translocation success	Post translocation	Contractor	TMEIA		Y		N/A
7.13	6.5	The loss of habitat shall be supplemented by enhancement planting in accordance with the landscape mitigation schedule.	All areas / As soon as accessible	Contractor	TMEIA		Y		N/A
7.13	6.5	Spoil heaps shall be covered at all times.	All areas / Throughout construction period	Contractor	TMEIA		Y		N/A
7.13	6.5	Avoid damage and disturbance to the remaining and surrounding natural habitat	All areas / Throughout construction period	Contractor	TMEIA		Y		N/A
7.13	6.5	Placement of equipment in designated areas within the existing disturbed land	All areas / Throughout construction period	Contractor	TMEIA		Y		N/A
7.13	6.5	Disturbed areas to be reinstated immediately after completion of the works.	All areas / Throughout construction period	Contractor	TMEIA		Y		N/A
7.13	6.5	Construction activities should be restricted to the proposed works boundary.	All areas / Throughout construction period	Contractor	TMEIA		Y		N/A
LANDSCAPE AND VISUAL									
10.9	7.6	The colour and shape of the toll control buildings, ventilation building and administration building shall adopt a design which could blend it into the vicinity elements, and the details will be developed in detailed design stage (DM2)	All areas/detailed design	Design Consultant	TMEIA	Y			N/A
10.9	7.6	Aesthetic design of the viaduct, retaining wall and other structures will be developed under ACABAS submission (DM5)	All areas/detailed design	Design Consultant	TMEIA	Y			N/A
10.9	7.6	Screening of construction works by hoardings around works area in visually unobtrusive colours, to screen works (CM5)	All areas/detailed design/ during construction/post construction	Design Consultant/ Contractor	TMEIA	Y	Y		N/A
10.9	7.6	Control night-time lighting and glare by hooding all lights (CM6)	All areas/detailed design/ during construction	Design Consultant/ Contractor	TMEIA	Y	Y		N/A
10.9	7.6	Ensure no run-off into water body adjacent to the Project Area (CM7)	All areas/detailed design/ during construction	Design Consultant/ Contractor	TMEIA	Y	Y		N/A
10.9	7.6	Avoidance of excessive height and bulk of buildings and structures (CM8)	All areas/detailed design/ during construction	Design Consultant/ Contractor	TMEIA	Y	Y		N/A

Legend: D=Design, C=Construction, O=Operation

Note: Funding Agent for all mitigation measures will be the Highways Department of the Hong Kong SAR Government

Contract No. HY/2012/08
Tuen Mun – Chek Lap Kok Link
Northern Connection Sub-sea Tunnel Section
Environmental Mitigation and Enhancement Measure Implementation Schedule

EIA Reference	EM&A Manual Reference	Environmental Protection Measures	Location/ Timing	Implementation Agent	Relevant Standard or Requirement	Implementation Stages			Status *
						D	C	O	
10.9	7.6	Aesthetically pleasing design (visually unobtrusive and non-reflective) as regard to the form, material and finishes shall be incorporated to all buildings, engineering structures and associated infrastructure facilities (OM5)	All areas/detailed design/ during construction / during operation	Design Consultant/ Contractor	TMEIA	Y	Y	Y	N/A
10.9	7.6	Avoidance of excessive height and bulk of buildings and structures (OM6)	All areas/detailed design/ during construction / during operation	Design Consultant/ Contractor	TMEIA	Y	Y	Y	N/A
WASTE									
12.6		The Contractor shall identify a coordinator for the management of waste.	Contract mobilisation	Contractor	TMEIA		Y		N/A
12.6		The Contractor shall prepare and implement a Waste Management Plan which specifies procedures such as a ticketing system, to facilitate tracking of loads and to ensure that illegal disposal of wastes does not occur, and protocols for the maintenance of records of the quantities of wastes generated, recycled and disposed. A recording system for the amount of waste generated, recycled and disposed (locations) should be established.	Contract mobilisation	Contractor	TMEIA, Works Branch Technical Circular No. 5/99 for the Trip-ticket System for Disposal of Construction and Demolition Material		Y		N/A

Legend: D=Design, C=Construction, O=Operation

Note: Funding Agent for all mitigation measures will be the Highways Department of the Hong Kong SAR Government

Contract No. HY/2012/08
Tuen Mun – Chek Lap Kok Link
Northern Connection Sub-sea Tunnel Section
Environmental Mitigation and Enhancement Measure Implementation Schedule

EIA Reference	EM&A Manual Reference	Environmental Protection Measures	Location/ Timing	Implementation Agent	Relevant Standard or Requirement	Implementation Stages			Status *
						D	C	O	
12.6		The Contractor shall apply for and obtain the appropriate licenses for the disposal of public fill, chemical waste and effluent discharges.	Contract mobilisation	Contractor	TMEIA, Land (Miscellaneous Provisions) Ordinance (Cap 28); Waste Disposal Ordinance (Cap 354); Dumping at Sea Ordinance (Cap 466); Water Pollution Control Ordinance.		Y		✓
12.6	8.1	Training shall be provided to workers about the concepts of site cleanliness and appropriate waste management procedures including waste reduction, reuse and recycling.	Contract Mobilisation	Contractor	TMEIA		Y		N/A
12.6	8.1	The extent of cutting operation should be optimised where possible. Earth retaining structures and bored pile walls should be proposed to minimise the extent of cutting.	All areas / throughout construction period	Contractor	TMEIA		Y		N/A
12.6	8.1	The surplus surcharge should be transferred to a fill bank	Reclamation areas / after surcharge works	Contractor	TMEIA		Y		N/A
12.6	8.1	Rock armour from the existing seawall should be reused on the new sloping seawall as far as possible	All areas / throughout construction period	Contractor	TMEIA		Y		N/A
12.6	8.1	The site and surroundings shall be kept tidy and litter free.	All areas / throughout construction period	Contractor	TMEIA		Y		N/A
12.6	8.1	No waste shall be burnt on site.	All areas / throughout construction period	Contractor	TMEIA		Y		N/A
12.6	8.1	Provisions to be made in contract documents to allow and promote the use of recycled aggregates where appropriate.	Detailed Design	Design Consultant	TMEIA	Y			N/A
12.6	8.1	The Contractor shall be prohibited from disposing of C&D materials at any sensitive locations. The Contractor should propose the final disposal sites in the EMP and WMP for approval before implementation.	All areas / throughout construction period	Contractor	TMEIA		Y		✓
12.6	8.1	Stockpiled material shall be covered by tarpaulin and /or watered as appropriate to prevent windblown dust/ surface run off.	All areas / throughout construction period	Contractor	TMEIA		Y		N/A
12.6	8.1	Excavated material in trucks shall be covered by tarpaulins to reduce the potential for spillage and dust generation.	All areas / throughout construction period	Contractor	TMEIA		Y		N/A

Legend: D=Design, C=Construction, O=Operation

Note: Funding Agent for all mitigation measures will be the Highways Department of the Hong Kong SAR Government

Contract No. HY/2012/08
Tuen Mun – Chek Lap Kok Link
Northern Connection Sub-sea Tunnel Section
Environmental Mitigation and Enhancement Measure Implementation Schedule

EIA Reference	EM&A Manual Reference	Environmental Protection Measures	Location/ Timing	Implementation Agent	Relevant Standard or Requirement	Implementation Stages			Status *
						D	C	O	
12.6	8.1	Wheel washing facilities shall be used by all trucks leaving the site to prevent transfer of mud onto public roads.	All areas / throughout construction period	Contractor	TMEIA		Y		N/A
12.6	8.1	Dredged marine mud shall be disposed of in a gazetted marine disposal ground under the requirements of the Dumping at Seas Ordinance.	Reclamation areas / throughout dredging works	Contractor	TMEIA		Y		N/A
12.6	8.1	Standard formwork or pre-fabrication should be used as far as practicable so as to minimise the C&D materials arising. The use of more durable formwork/plastic facing for construction works should be considered. The use of wooden hoardings should be avoided and metal hoarding should be used to facilitate recycling. Purchasing of construction materials should avoid over-ordering and wastage.	All areas / throughout construction period	Contractor	TMEIA		Y		N/A
12.6	8.1	The Contractor should recycle as many C&D materials (this is a waste section) as possible on-site. The public fill and C&D waste should be segregated and stored in separate containers or skips to facilitate the reuse or recycling of materials and proper disposal. Where practicable, the concrete and masonry should be crushed and used as fill materials. Steel reinforcement bar should be collected for use by scrap steel mills. Different areas of the sites should be considered for segregation and storage activities.	All areas / throughout construction period	Contractor	TMEIA		Y		N/A
12.6	8.1	All falsework will be steel instead of wood.	All areas / throughout construction period	Contractor	TMEIA		Y		N/A
12.6	8.1	Chemical waste producers should register with the EPD. Chemical waste should be handled in accordance with the Code of Practice on the Packaging, Handling and Storage of Chemical Wastes as follows: <i>f</i> suitable for the substance to be held, resistant to corrosion, maintained in good conditions and securely closed; <i>f</i> Having a capacity of <450L unless the specifications have been approved by the EPD; and <i>w</i> Chinese according to the instructions prescribed in Schedule 2 of the Regulations. <i>f</i> Clearly labelled and used solely for the storage of chemical wastes; <i>f</i> Enclosed with at least 3 sides; <i>f</i> Impermeable floor and bund with	All areas / throughout construction period	Contractor	TMEIA		Y		N/A

Legend: D=Design, C=Construction, O=Operation

Note: Funding Agent for all mitigation measures will be the Highways Department of the Hong Kong SAR Government

*Contract No. HY/2012/08
Tuen Mun – Chek Lap Kok Link
Northern Connection Sub-sea Tunnel Section
Environmental Mitigation and Enhancement Measure Implementation Schedule*

EIA Reference	EM&A Manual Reference	Environmental Protection Measures	Location/ Timing	Implementation Agent	Relevant Standard or Requirement	Implementation Stages			Status *
						D	C	O	
		capacity to accommodate 110% of the volume of the largest container or 20% by volume of the chemical waste stored in the area, whichever is greatest; f Adequate ventilation; f Sufficiently covered to prevent rainfall entering (water collected within the bund must be tested and disposed of as chemical waste, if necessary); and f Incompatible materials are adequately separated.							
12.6	8.1	Waste oils, chemicals or solvents shall not be disposed of to drain,	All areas / throughout construction period	Contractor	TMEIA		Y		N/A
12.6	8.1	Adequate numbers of portable toilets should be provided for on-site workers. Portable toilets should be maintained in reasonable states, which will not deter the workers from utilising them.	All areas / throughout construction period	Contractor	TMEIA		Y		N/A
12.6	8.1	Night soil should be regularly collected by licensed collectors.	All areas / throughout construction period	Contractor	TMEIA		Y		N/A
12.6	8.1	General refuse arising on-site should be stored in enclosed bins or compaction units separately from C&D and chemical wastes. Sufficient dustbins shall be provided for storage of waste as required under the Public Cleansing and Prevention of Nuisances By-laws. In addition, general refuse shall be cleared daily and shall be disposed of to the nearest licensed landfill or refuse transfer station. Burning of refuse on construction sites is prohibited.	All areas / throughout construction period	Contractor	TMEIA		Y		✓
12.6	8.1	All waste containers shall be in a secure area on hardstanding;	All areas / throughout construction period	Contractor	TMEIA		Y		N/A
12.6	8.1	Training shall be provided to workers about the concepts of site cleanliness and appropriate waste management procedure, including waste reduction, reuse and recycling.	All areas / throughout construction period	Contractor	TMEIA		Y		N/A
12.6	8.1	Office wastes can be reduced by recycling of paper if such volume is sufficiently large to warrant collection. Participation in a local collection scheme by the Contractor should be advocated. Waste separation facilities for paper, aluminium cans, plastic bottles, etc should be provided on-site.	Site Offices/ throughout construction period	Contractor	TMEIA		Y		N/A
12.6	Section 8	EM&A of waste handling, storage, transportation, disposal procedures and documentation through the site audit programme shall be undertaken.	All areas / throughout construction period	Contractor	EM&A Manual		Y		N/A

Legend: D=Design, C=Construction, O=Operation

Note: Funding Agent for all mitigation measures will be the Highways Department of the Hong Kong SAR Government

*Contract No. HY/2012/08
Tuen Mun – Chek Lap Kok Link
Northern Connection Sub-sea Tunnel Section
Environmental Mitigation and Enhancement Measure Implementation Schedule*

EIA Reference	EM&A Manual Reference	Environmental Protection Measures	Location/ Timing	Implementation Agent	Relevant Standard or Requirement	Implementation Stages			Status *
						D	C	O	
CULTURAL HERITAGE									
11.8	Section 9	EM&A in the form of audit of the mitigation measures	All areas / throughout construction period	Highways Department	EIAO-TM		Y		N/A

*** Remarks:**

- ✓ Compliance of Mitigation Measures
- <> Compliance of Mitigation but need improvement
- x Non-compliance of Mitigation Measures
- ▲ Non-compliance of Mitigation Measures but rectified by Contractor
- Δ Deficiency of Mitigation Measures but rectified by Contractor
- N/A Not Applicable in Reporting Period

Legend: D=Design, C=Construction, O=Operation

Note: Funding Agent for all mitigation measures will be the Highways Department of the Hong Kong SAR Government

Appendix D

Copies of
Calibration
Certificates for
Water Quality
Monitoring



專業化驗有限公司

QUALITY PRO TEST-CONSULT LIMITED

Unit 10, 14/F, Wah Wai Centre, 38-40 Au Pui Wan St., Fotan, Hong Kong

Email: info@qualityprotest.com; Website: www.qualityprotest.com

Tel: (852) 3956 8717; Fax: (852) 3956 3928

REPORT OF EQUIPMENT PERFORMANCE CHECK/ CALIBRATION

Report No. : BA030094
Date of Issue : 26 March 2021
Page No. : 1 of 2

PART A – CUSTOMER INFORMATION

Enovative Environmental Service Ltd.
Flat 2207, Yu Fun House,
Yu Chui Court, Shatin
New Territories, Hong Kong
Attn: Mr. Thomas WONG

PART B – DESCRIPTION

Name of Equipment : YSI ProDSS (Multi-Parameters)
Manufacturer : YSI (a xylem brand)
Serial Number : 15M100005
Date of Received : Mar 25, 2021
Date of Calibration : Mar 25, 2021
Date of Next Calibration^(a) : Jun 24, 2021

PART C – REFERENCE METHODS/ DOCUMENTS FOR THE CALIBRATION

Parameter	Reference Method
pH at 25°C	APHA 21e 4500-H ⁺ B
Dissolved Oxygen	APHA 21e 4500-O G
Conductivity at 25°C	APHA 21e 2510 B
Salinity	APHA 21e 2520 B
Turbidity	APHA 21e 2130 B
Temperature	Section 6 of international Accreditation New Zealand Technical Guide no. 3 Second edition March 2008: Working Thermometer Calibration Procedure.

PART D – CALIBRATION RESULTS^(b,c)

(1) pH at 25°C

Target (pH unit)	Displayed Reading ^(d) (pH Unit)	Tolerance ^(e) (pH Unit)	Results
4.00	4.02	0.02	Satisfactory
7.42	7.38	-0.04	Satisfactory
10.01	10.30	0.29	Satisfactory

Tolerance of pH should be less than ± 0.20 (pH unit)

(2) Temperature

Reading of Ref. thermometer (°C)	Displayed Reading (°C)	Tolerance (°C)	Results
10	10.4	0.4	Satisfactory
20	20.1	0.1	Satisfactory
48	48.3	0.3	Satisfactory

Tolerance limit of temperature should be less than ± 2.0 (°C)

~ CONTINUED ON NEXT PAGE ~

Remark(s): -

- ^(a) The "Date of Next Calibration" is recommended according to best practice principals as practiced by QPT or quoted from relevant international standards.
^(b) The results relate only to the calibrated equipment as received
^(c) The performance of the equipment stated in this report is checked with independent reference material and results compared against a calibrated secondary source.
^(d) "Displayed Reading" denotes the figure shown on item under calibration/ checking regardless of equipment precision or significant figures.
^(e) The "Tolerance Limit" mentioned is the acceptance criteria applicable for similar equipment used by Quality Pro Test-Consult Ltd. or quoted from relevant international standards..

LEE Chun-ning, Desmond
Senior Chemist



專業化驗有限公司

QUALITY PRO TEST-CONSULT LIMITED

Unit 10, 14/F, Wah Wai Centre, 38-40 Au Pui Wan St., Fotan, Hong Kong

Email: info@qualityprotest.com; Website: www.qualityprotest.com

Tel: (852) 3956 8717; Fax: (852) 3956 3928

REPORT OF EQUIPMENT PERFORMANCE CHECK/ CALIBRATION

Report No. : BA030094
Date of Issue : 26 March 2021
Page No. : 2 of 2

PART D – CALIBRATION RESULTS (Cont'd)

(3) Dissolved Oxygen

Expected Reading (mg/L)	Displayed Reading (mg/L)	Tolerance (mg/L)	Results
0.36	0.28	-0.08	Satisfactory
2.81	2.58	-0.23	Satisfactory
5.45	5.72	0.27	Satisfactory
8.40	8.64	0.24	Satisfactory

Tolerance limit of dissolved oxygen should be less than ± 0.50 (mg/L)

(4) Conductivity at 25°C

Conc. of KCl (M)	Expected Reading ($\mu\text{S/cm}$)	Displayed Reading ($\mu\text{S/cm}$)	Tolerance (%)	Results
0.001	146.9	152.1	3.54	Satisfactory
0.01	1412	1278	-9.49	Satisfactory
0.1	12890	12810	-0.62	Satisfactory
0.5	58670	59234	0.96	Satisfactory
1.0	111900	114225	2.08	Satisfactory

Tolerance limit of conductivity should be less than ± 10.0 (%)

(5) Salinity

Expected Reading (g/L)	Displayed Reading (g/L)	Tolerance (%)	Results
10	9.8	-2.00	Satisfactory
20	20.5	2.50	Satisfactory
30	29.8	-0.67	Satisfactory

Tolerance limit of salinity should be less than ± 10.0 (%)

(6) Turbidity

Expected Reading (NTU)	Displayed Reading ⁽¹⁾ (NTU)	Tolerance ⁽²⁾ (%)	Results
0	0.05	--	Satisfactory
10	9.8	-1.6	Satisfactory
20	18.9	-5.7	Satisfactory
100	96.4	-3.6	Satisfactory
800	822	2.8	Satisfactory

Tolerance limit of turbidity should be less than ± 10.0 (%)

~ END OF REPORT ~

Remark(s): -

⁽¹⁾ "Displayed Reading" presents the figures shown on item under calibration/ checking regardless of equipment precision or significant figures.

⁽²⁾ The "Tolerance Limit" mentioned is the acceptance criteria applicable for similar equipment used by Quality Pro Test-Consult Ltd. or quoted from relevant international standards.



專業化驗有限公司
QUALITY PRO TEST-CONSULT LIMITED

Unit 10, 14/F, Wah Wai Centre, 38-40 Au Pui Wan St., Fotan, Hong Kong
Email: info@qualityprotest.com; Website: www.qualityprotest.com
Tel: (852) 3956 8717; Fax: (852) 3956 3928

REPORT OF EQUIPMENT PERFORMANCE CHECK/ CALIBRATION

Report No. : BA030006
Date of Issue : 01 March 2021
Page No. : 1 of 2

PART A – CUSTOMER INFORMATION

Enovative Environmental Service Ltd.
Flat 2207, Yu Fun House,
Yu Chui Court, Shatin
New Territories, Hong Kong
Attn: Mr. Thomas WONG

PART B – DESCRIPTION

Name of Equipment : YSI ProDSS (Multi-Parameters)
Manufacturer : YSI (a xylem brand)
Serial Number : 18A104824
Date of Received : Feb 25, 2021
Date of Calibration : Feb 25, 2021
Date of Next Calibration^(a) : May 24, 2021

PART C – REFERENCE METHODS/ DOCUMENTS FOR THE CALIBRATION

Parameter	Reference Method
pH at 25°C	APHA 21e 4500-H ⁺ B
Dissolved Oxygen	APHA 21e 4500-O G
Conductivity at 25°C	APHA 21e 2510 B
Salinity	APHA 21e 2520 B
Turbidity	APHA 21e 2130 B
Temperature	Section 6 of international Accreditation New Zealand Technical Guide no. 3 Second edition March 2008: Working Thermometer Calibration Procedure.

PART D – CALIBRATION RESULTS^(b,c)

(1) pH at 25°C

Target (pH unit)	Displayed Reading ^(d) (pH Unit)	Tolerance ^(e) (pH Unit)	Results
4.00	4.02	0.02	Satisfactory
7.42	7.45	0.03	Satisfactory
10.01	10.09	0.08	Satisfactory

Tolerance of pH should be less than ± 0.20 (pH unit)

(2) Temperature

Reading of Ref. thermometer (°C)	Displayed Reading (°C)	Tolerance (°C)	Results
10	10.0	0.0	Satisfactory
21	20.4	-0.6	Satisfactory
41	40.9	-0.1	Satisfactory

Tolerance limit of temperature should be less than ± 2.0 (°C)

~ CONTINUED ON NEXT PAGE ~

Remark(s): -

- ^(a) The "Date of Next Calibration" is recommended according to best practice principals as practiced by QPT or quoted from relevant international standards.
^(b) The results relate only to the calibrated equipment as received
^(c) The performance of the equipment stated in this report is checked with independent reference material and results compared against a calibrated secondary source.
^(d) "Displayed Reading" denotes the figure shown on item under calibration/ checking regardless of equipment precision or significant figures.
^(e) The "Tolerance Limit" mentioned is the acceptance criteria applicable for similar equipment used by Quality Pro Test-Consult Ltd. or quoted from relevant international standards..

LEE Chun-ning, Desmond
Senior Chemist



REPORT OF EQUIPMENT PERFORMANCE CHECK/ CALIBRATION

Report No. : BA030006
Date of Issue : 01 March 2021
Page No. : 2 of 2

PART D – CALIBRATION RESULTS (Cont'd)

(3) Dissolved Oxygen

Expected Reading (mg/L)	Displayed Reading (mg/L)	Tolerance (mg/L)	Results
0.21	0.01	-0.20	Satisfactory
4.55	6.21	1.66	Satisfactory
6.42	4.56	-1.86	Satisfactory
8.78	8.49	-0.29	Satisfactory

Tolerance limit of dissolved oxygen should be less than ± 0.50 (mg/L)

(4) Conductivity at 25°C

Conc. of KCl (M)	Expected Reading ($\mu\text{S}/\text{cm}$)	Displayed Reading ($\mu\text{S}/\text{cm}$)	Tolerance (%)	Results
0.001	146.9	146.7	-0.14	Satisfactory
0.01	1412	1436	1.70	Satisfactory
0.1	12890	12699	-1.48	Satisfactory
0.5	58670	58421	-0.42	Satisfactory
1.0	111900	111486	-0.37	Satisfactory

Tolerance limit of conductivity should be less than ± 10.0 (%)

(5) Salinity

Expected Reading (g/L)	Displayed Reading (g/L)	Tolerance (%)	Results
10	9.88	-1.20	Satisfactory
20	19.84	-0.80	Satisfactory
30	30.52	1.73	Satisfactory

Tolerance limit of salinity should be less than ± 10.0 (%)

(6) Turbidity

Expected Reading (NTU)	Displayed Reading ^(f) (NTU)	Tolerance ^(g) (%)	Results
0	0.11	--	Satisfactory
10	10.23	2.3	Satisfactory
20	20.45	2.3	Satisfactory
100	102.38	2.4	Satisfactory
800	798.46	-0.2	Satisfactory

Tolerance limit of turbidity should be less than ± 10.0 (%)

~ END OF REPORT ~

Remark(s): -

^(f) "Displayed Reading" presents the figures shown on item under calibration/ checking regardless of equipment precision or significant figures.

^(g) The "Tolerance Limit" mentioned is the acceptance criteria applicable for similar equipment used by Quality Pro Test-Consult Ltd. or quoted from relevant international standards.

Appendix E

EM&A Monitoring Schedules

**HY/2012/08 - Tuen Mun - Chek Lap Kok Link - Northern Landfall
Operational Phase Marine Water Quality Monitoring (WQM) Schedule (April 2021)**

Sunday	Monday	Tuesday	Wednesday	Thursday	Friday	Saturday
				1-Apr	2-Apr	3-Apr
4-Apr	5-Apr	6-Apr	7-Apr	8-Apr	9-Apr	10-Apr
11-Apr	12-Apr	13-Apr	14-Apr	15-Apr	16-Apr	17-Apr
			ebb tide 12:39 - 16:09 flood tide 6:12 - 9:42			
18-Apr	19-Apr	20-Apr	21-Apr	22-Apr	23-Apr	24-Apr
25-Apr	26-Apr	27-Apr	28-Apr	29-Apr	30-Apr	

**HY/2012/08 - Tuen Mun - Chek Lap Kok Link
Northern Connection Sub-sea Tunnel Section
Operational Phase Dolphin Monitoring Survey Monitoring Schedule - April 2021**

Sunday	Monday	Tuesday	Wednesday	Thursday	Friday	Saturday
				01-Apr	02-Apr	03-Apr
04-Apr	05-Apr	06-Apr	07-Apr	08-Apr	09-Apr	10-Apr
				Operational Phase Dolphin Monitoring		
11-Apr	12-Apr	13-Apr	14-Apr	15-Apr	16-Apr	17-Apr
18-Apr	19-Apr	20-Apr	21-Apr	22-Apr	23-Apr	24-Apr
				Operational Phase Dolphin Monitoring		
25-Apr	26-Apr	27-Apr	28-Apr	29-Apr	30-Apr	
		Operational Phase Dolphin Monitoring		Operational Phase Dolphin Monitoring		

**HY/2012/08 - Tuen Mun - Chek Lap Kok Link - Northern Landfall
Operational Phase Marine Water Quality Monitoring (WQM) Schedule (May 2021)**

Sunday	Monday	Tuesday	Wednesday	Thursday	Friday	Saturday
						1-May
2-May	3-May	4-May	5-May	6-May	7-May	8-May
9-May	10-May	11-May	12-May	13-May	14-May	15-May
16-May	17-May	18-May	19-May	20-May	21-May	22-May
					ebb tide 7:58 - 10:58 flood tide 12:27 - 15:57	
23-May	24-May	25-May	26-May	27-May	28-May	29-May
30-May	31-May					

**HY/2012/08 - Tuen Mun - Chek Lap Kok Link
Northern Connection Sub-sea Tunnel Section
Tentative Operational Phase Dolphin Monitoring Survey Monitoring Schedule - May 2021**

Sunday	Monday	Tuesday	Wednesday	Thursday	Friday	Saturday
						01-May
02-May	03-May	04-May	05-May	06-May	07-May	08-May
	Operational Phase Dolphin Monitoring					
09-May	10-May	11-May	12-May	13-May	14-May	15-May
	Operational Phase Dolphin Monitoring					
16-May	17-May	18-May	19-May	20-May	21-May	22-May
	Operational Phase Dolphin Monitoring					
23-May	24-May	25-May	26-May	27-May	28-May	29-May
	Operational Phase Dolphin Monitoring					
30-May	31-May					

The schedule is subject to agreement from the EPD on the monitoring times. The schedule will be revised in view of adverse(safety,weather etc) conditions.

Appendix F

Operational Phase Dolphin Monitoring Survey

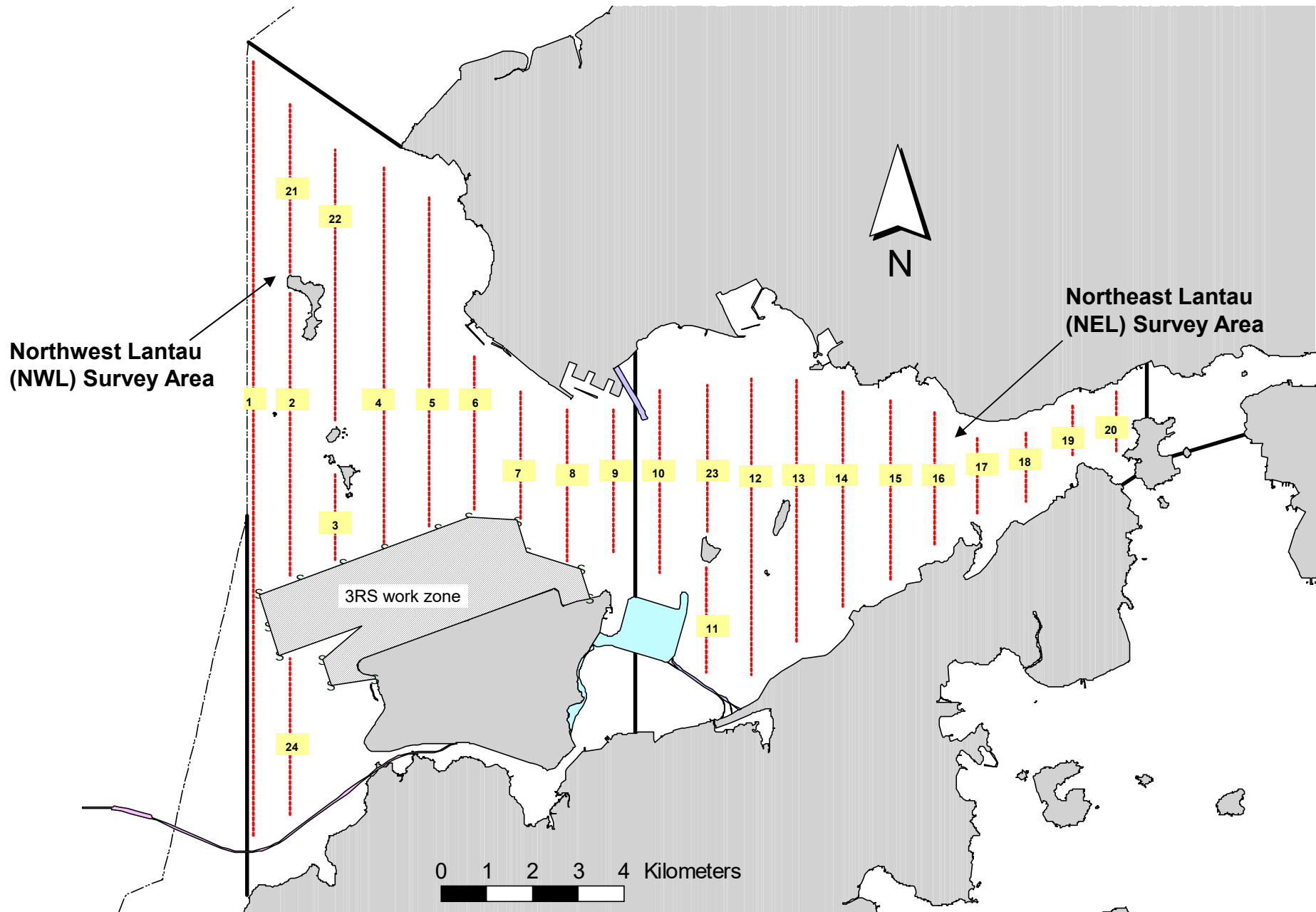

Figure 1. Transect Line Layout in Northwest and Northeast Lantau Survey Areas

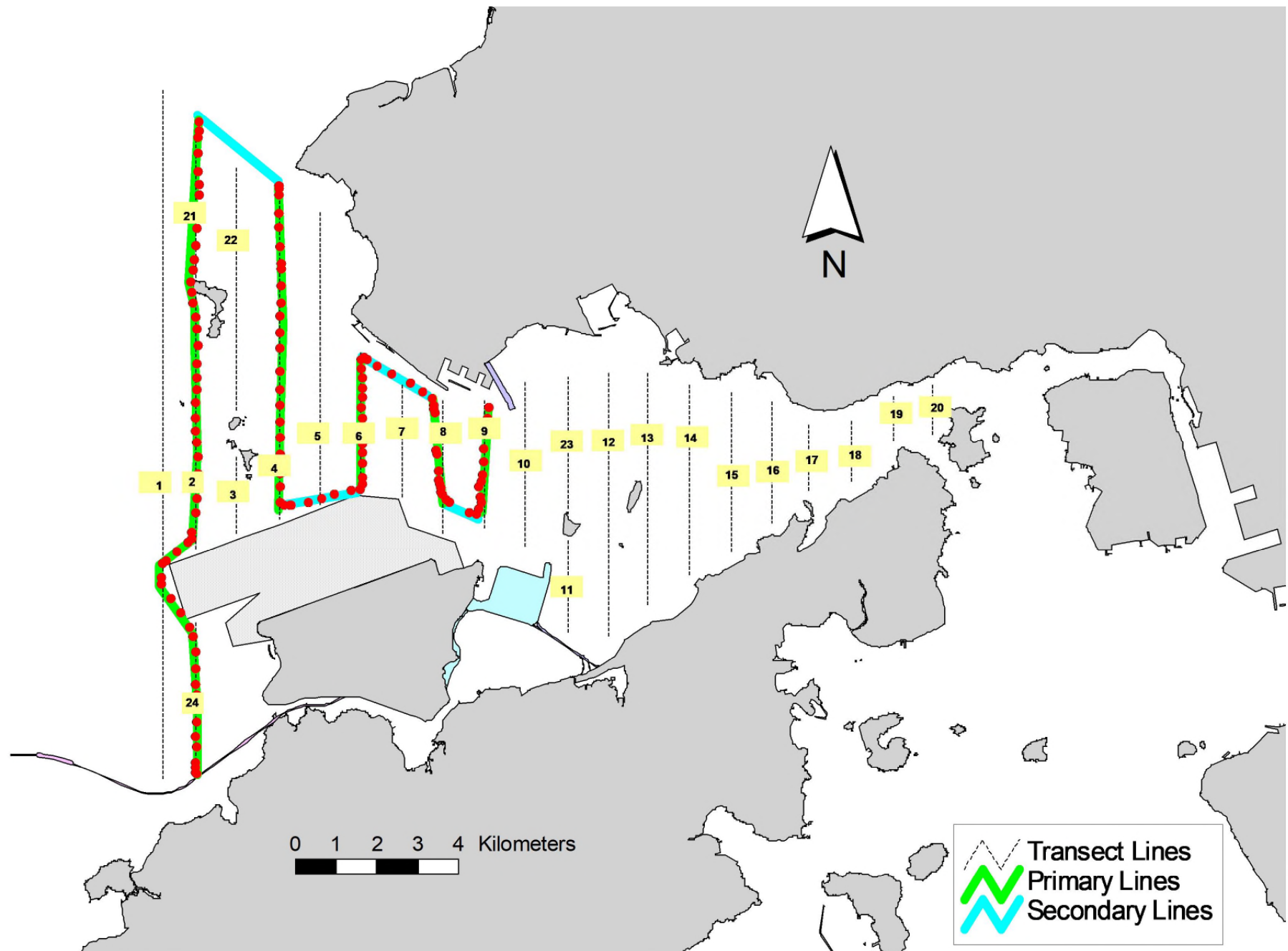

Figure 3. Survey Route on April 22nd, 2021

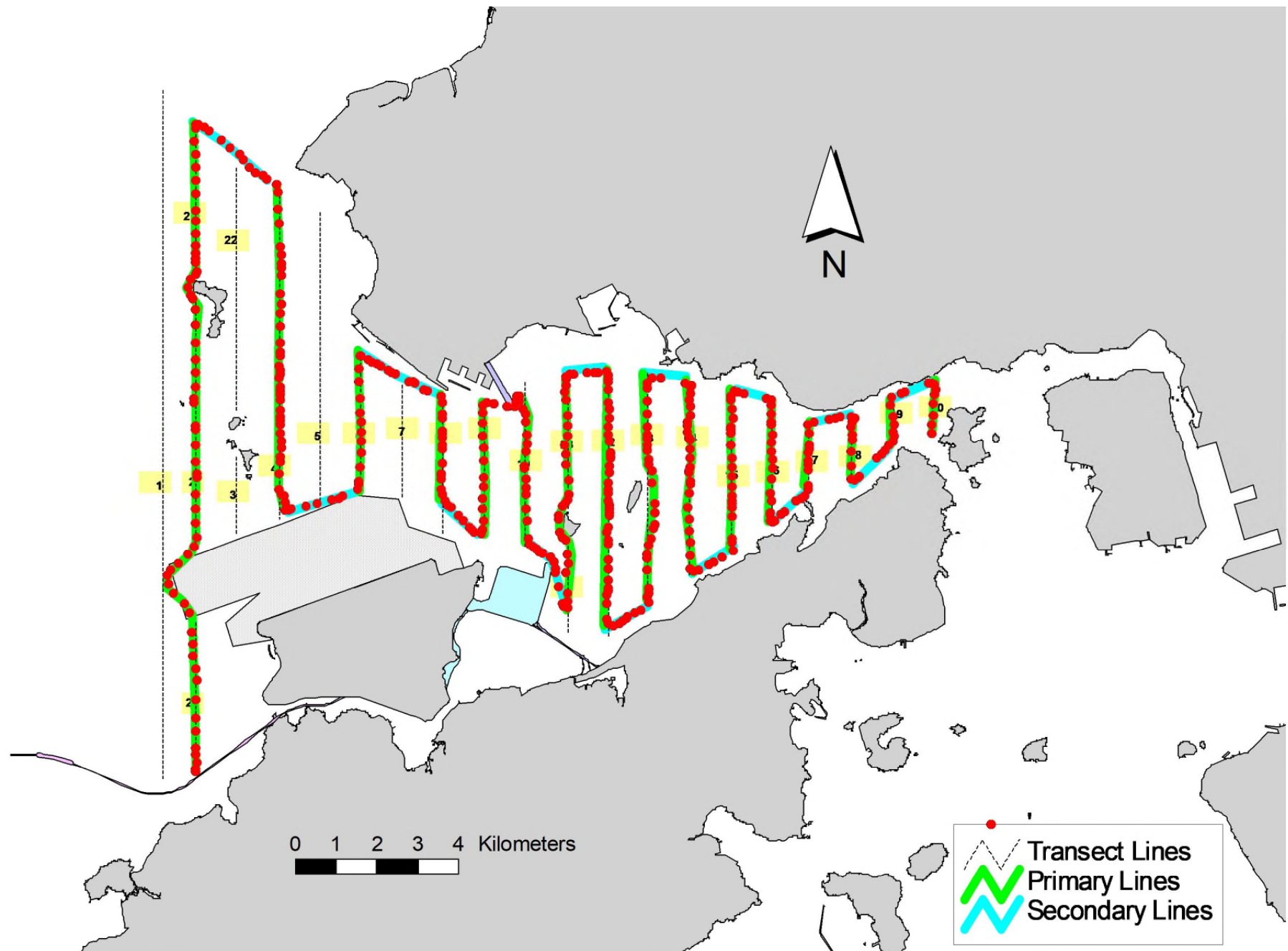

Figure 4. Survey Route on April 27th, 2021

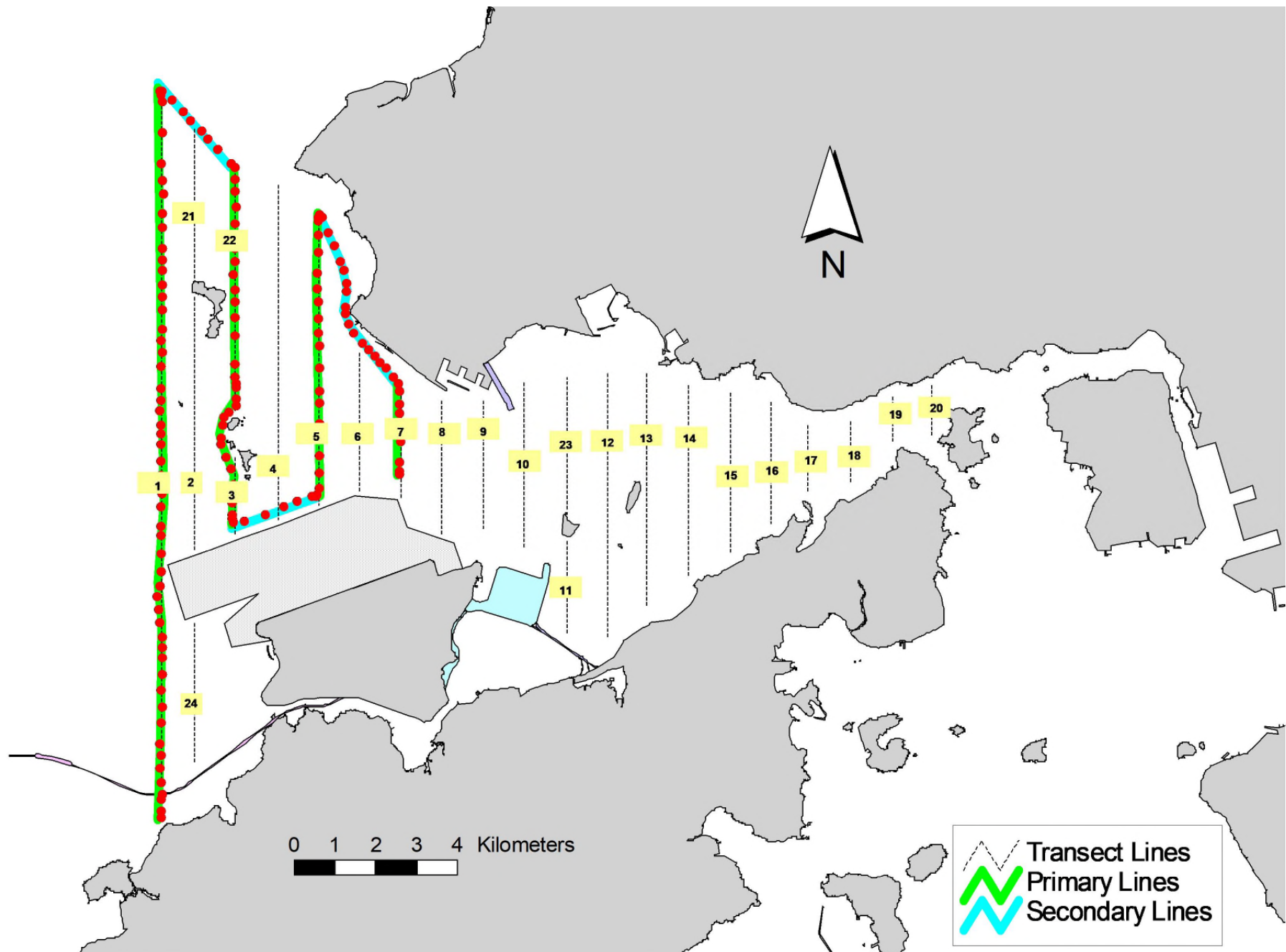

Figure 5. Survey Route on April 29th, 2021

Appendix I. TMCLKL Survey Effort Database (April 2021)

(Abbreviations: BEAU = Beaufort Sea State; P = Primary Line Effort; S = Secondary Line Effort)

DATE	AREA	BEAU	EFFORT	SEASON	VESSEL	TYPE	P/S
8-Apr-21	NW LANTAU	2	25.85	SPRING	STANDARD36826	TMCLKL	P
8-Apr-21	NW LANTAU	3	6.95	SPRING	STANDARD36826	TMCLKL	P
8-Apr-21	NW LANTAU	2	10.8	SPRING	STANDARD36826	TMCLKL	S
8-Apr-21	NE LANTAU	2	34.14	SPRING	STANDARD36826	TMCLKL	P
8-Apr-21	NE LANTAU	2	11.56	SPRING	STANDARD36826	TMCLKL	S
22-Apr-21	NW LANTAU	1	5.79	SPRING	STANDARD36826	TMCLKL	P
22-Apr-21	NW LANTAU	2	26.6	SPRING	STANDARD36826	TMCLKL	P
22-Apr-21	NW LANTAU	2	11.11	SPRING	STANDARD36826	TMCLKL	S
27-Apr-21	NW LANTAU	2	15.81	SPRING	STANDARD36826	TMCLKL	P
27-Apr-21	NW LANTAU	3	12.76	SPRING	STANDARD36826	TMCLKL	P
27-Apr-21	NW LANTAU	2	8.23	SPRING	STANDARD36826	TMCLKL	S
27-Apr-21	NW LANTAU	3	3	SPRING	STANDARD36826	TMCLKL	S
27-Apr-21	NE LANTAU	2	5.3	SPRING	STANDARD36826	TMCLKL	P
27-Apr-21	NE LANTAU	3	31.17	SPRING	STANDARD36826	TMCLKL	P
27-Apr-21	NE LANTAU	2	3.7	SPRING	STANDARD36826	TMCLKL	S
27-Apr-21	NE LANTAU	3	8.43	SPRING	STANDARD36826	TMCLKL	S
29-Apr-21	NW LANTAU	2	16.6	SPRING	STANDARD36826	TMCLKL	P
29-Apr-21	NW LANTAU	3	11.22	SPRING	STANDARD36826	TMCLKL	P
29-Apr-21	NW LANTAU	2	7.08	SPRING	STANDARD36826	TMCLKL	S
29-Apr-21	NW LANTAU	3	1.40	SPRING	STANDARD36826	TMCLKL	S

Appendix G

Operational
Phase Water
Quality
Monitoring
Results

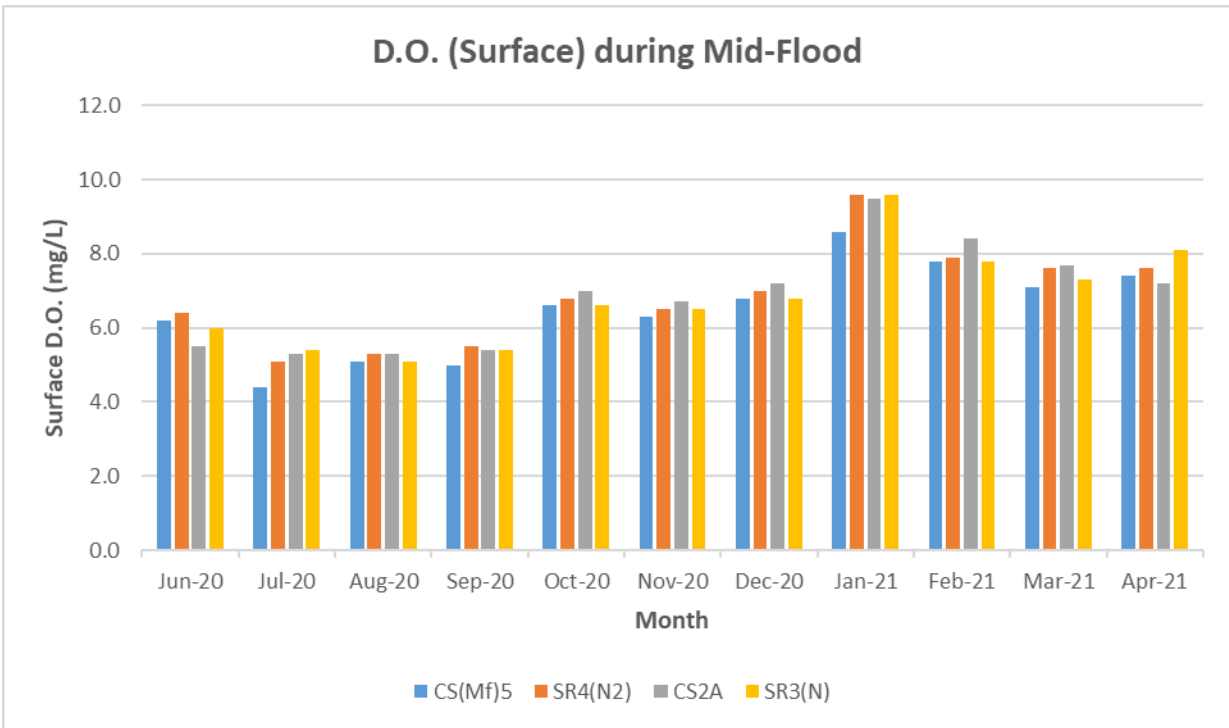
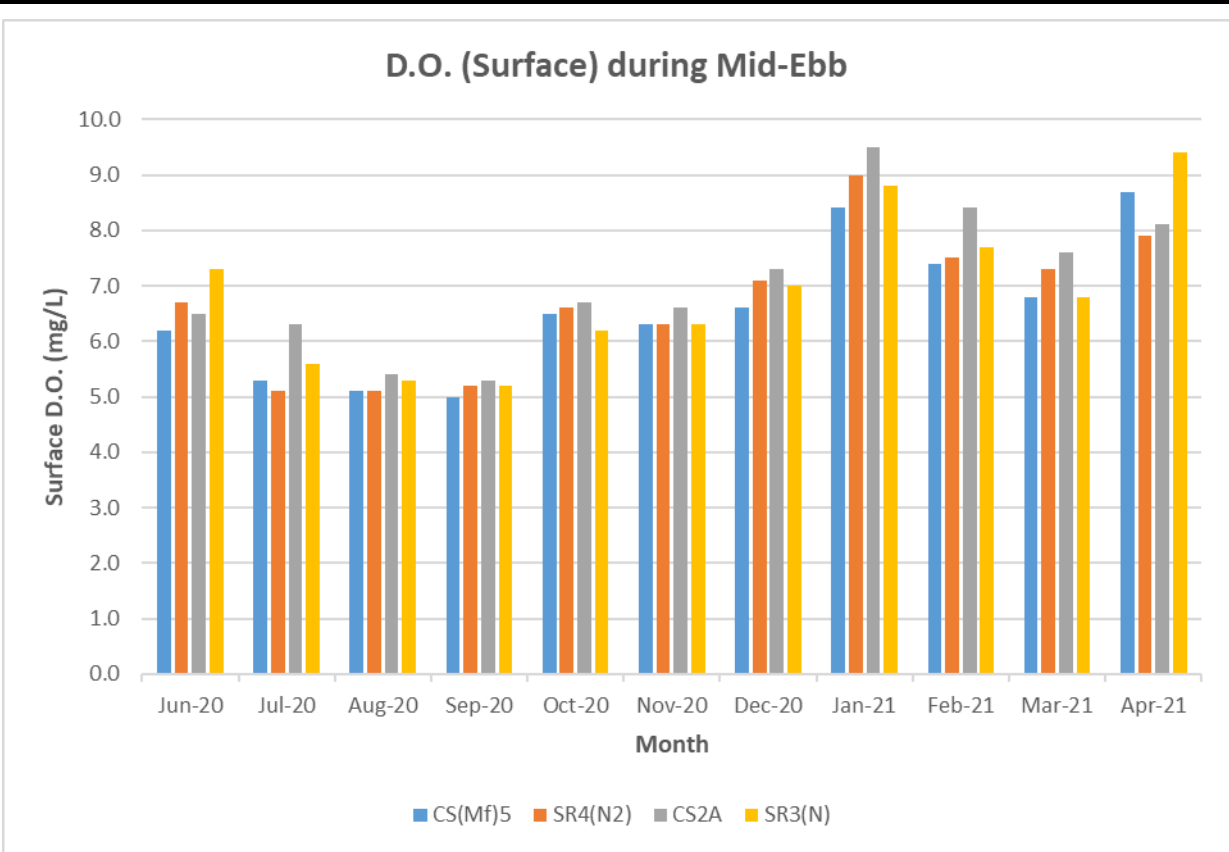

Figure G1 Operational Phase Monitoring – Mean Level of Dissolved Oxygen (mg/L) in surface waters between 1 June 2020 and 30 April 2021. The weather conditions during the monitoring period varied mostly from sunny to cloudy.

Ref: 0212330_Impact-WQM_April 2021_graphs_Rev a.xls



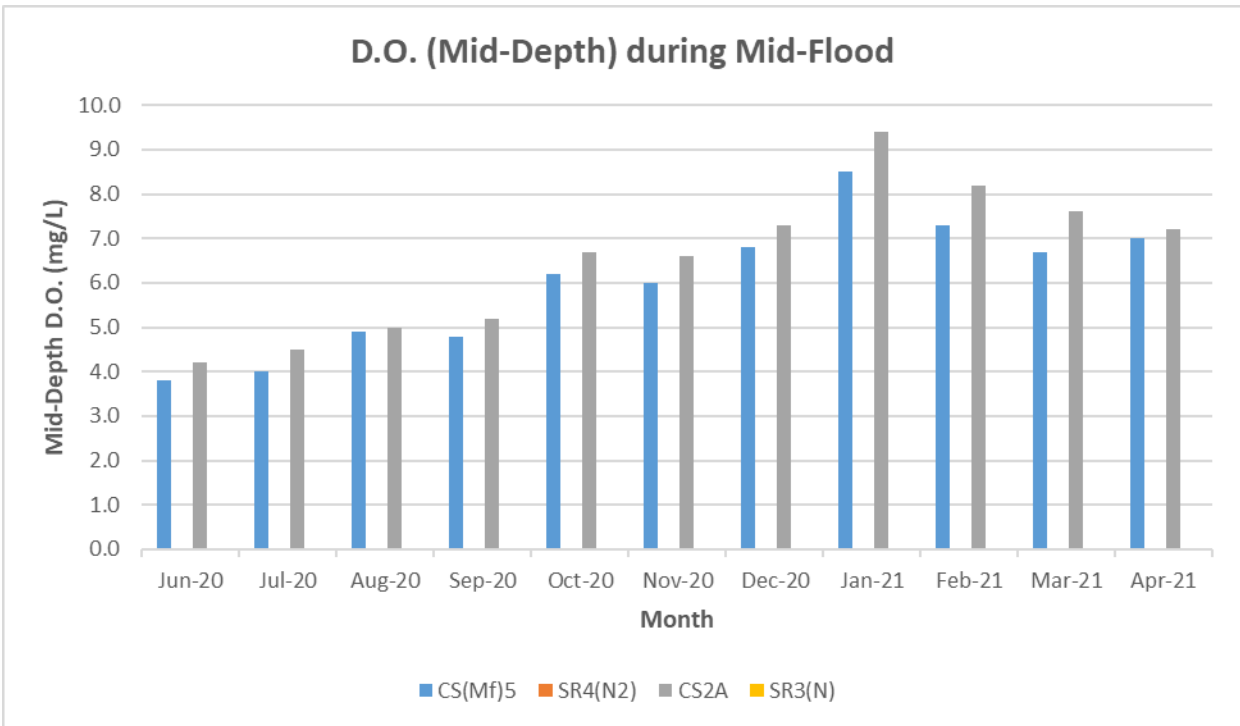
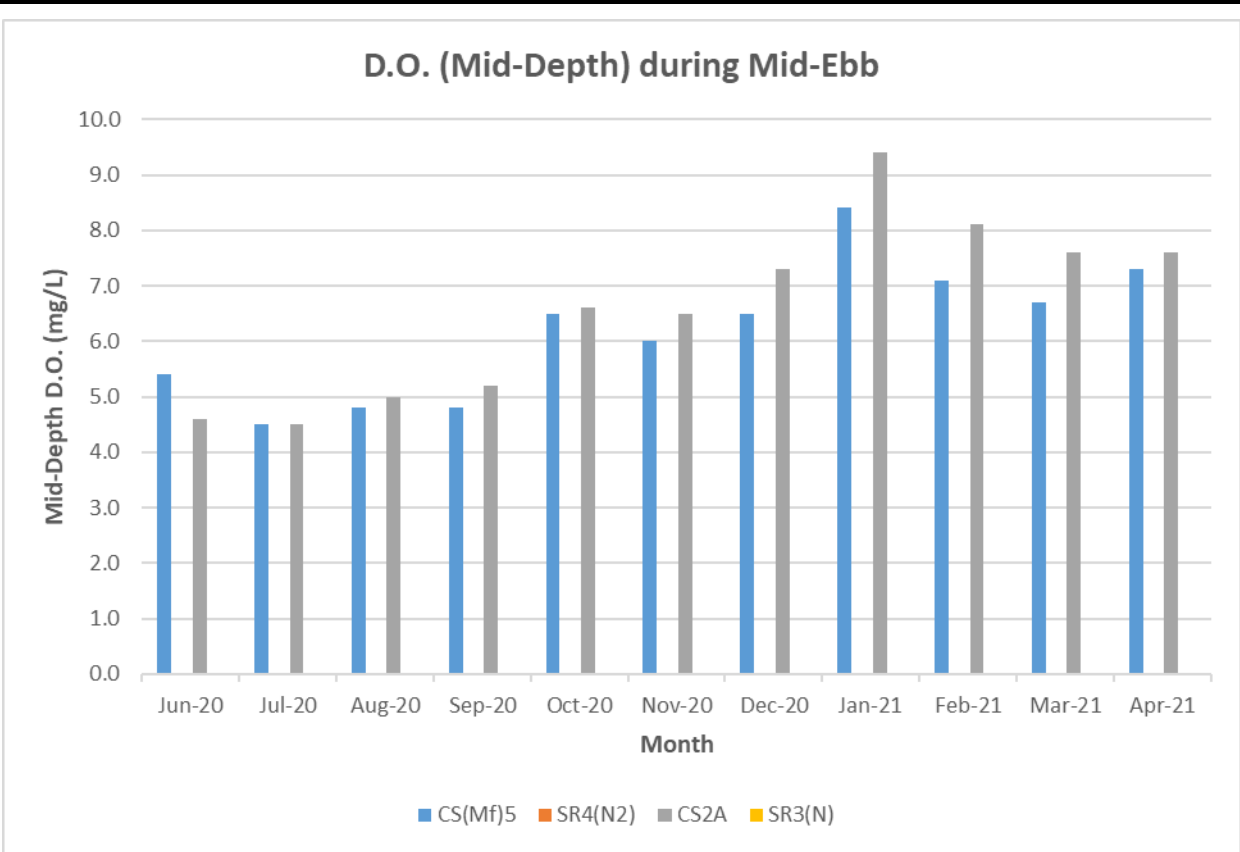

Figure G2 Operational Phase Monitoring - Mean Level of Dissolved Oxygen (mg/L) in mid-depth waters between 1 June 2020 and 30 April 2021. The weather conditions during the monitoring period varied mostly from sunny to cloudy.

Ref: 0212330_Impact-WQM_April 2021_graphs_Rev a.xls



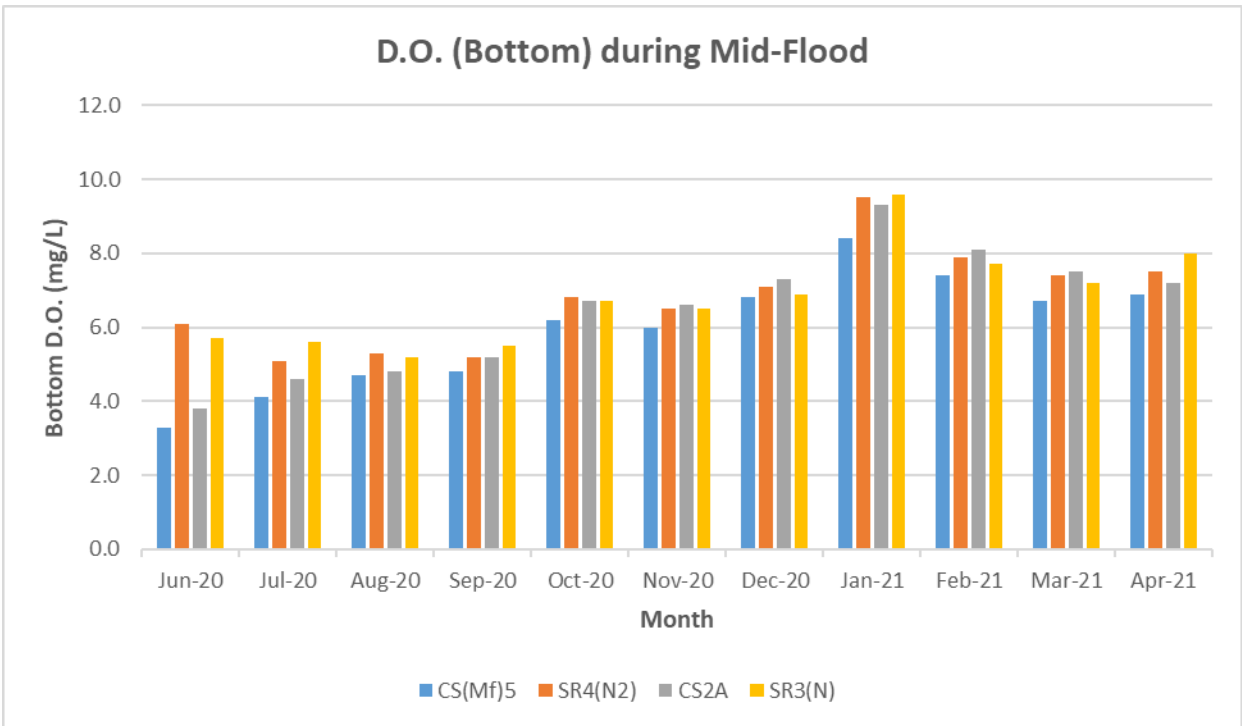
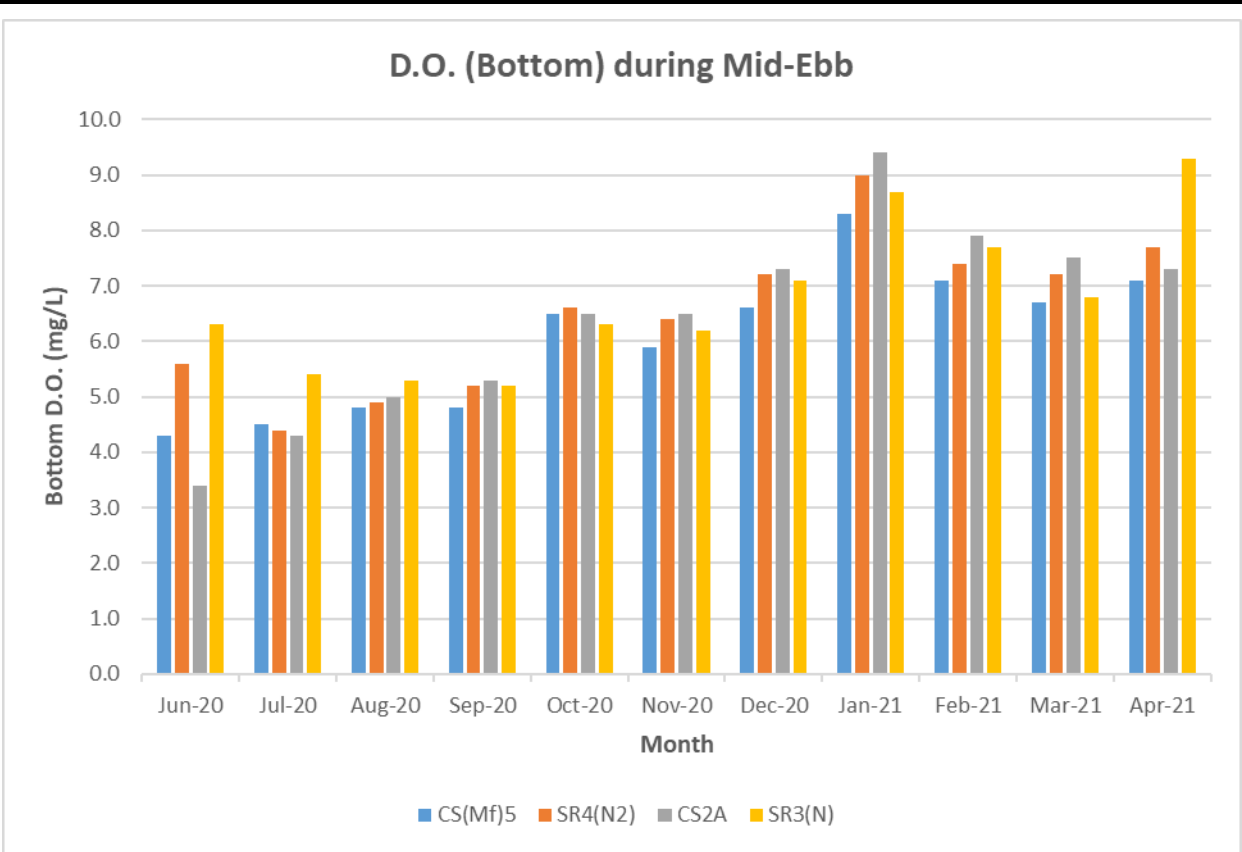

Figure G3 Operational Phase Monitoring - Mean Level of Dissolved Oxygen (mg/L) in bottom waters between 1 June 2020 and 30 April 2021. The weather conditions during the monitoring period varied mostly from sunny to cloudy.

Ref: 0212330_Impact-WQM_April 2021_graphs_Rev a.xls



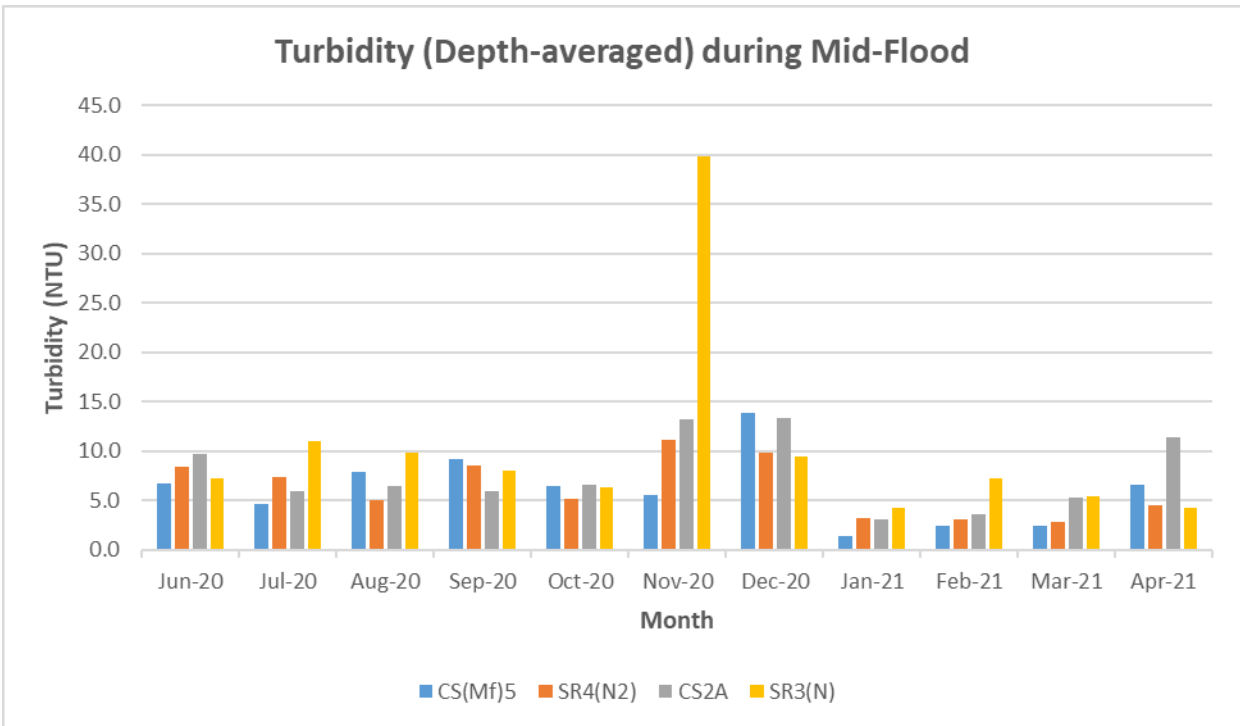
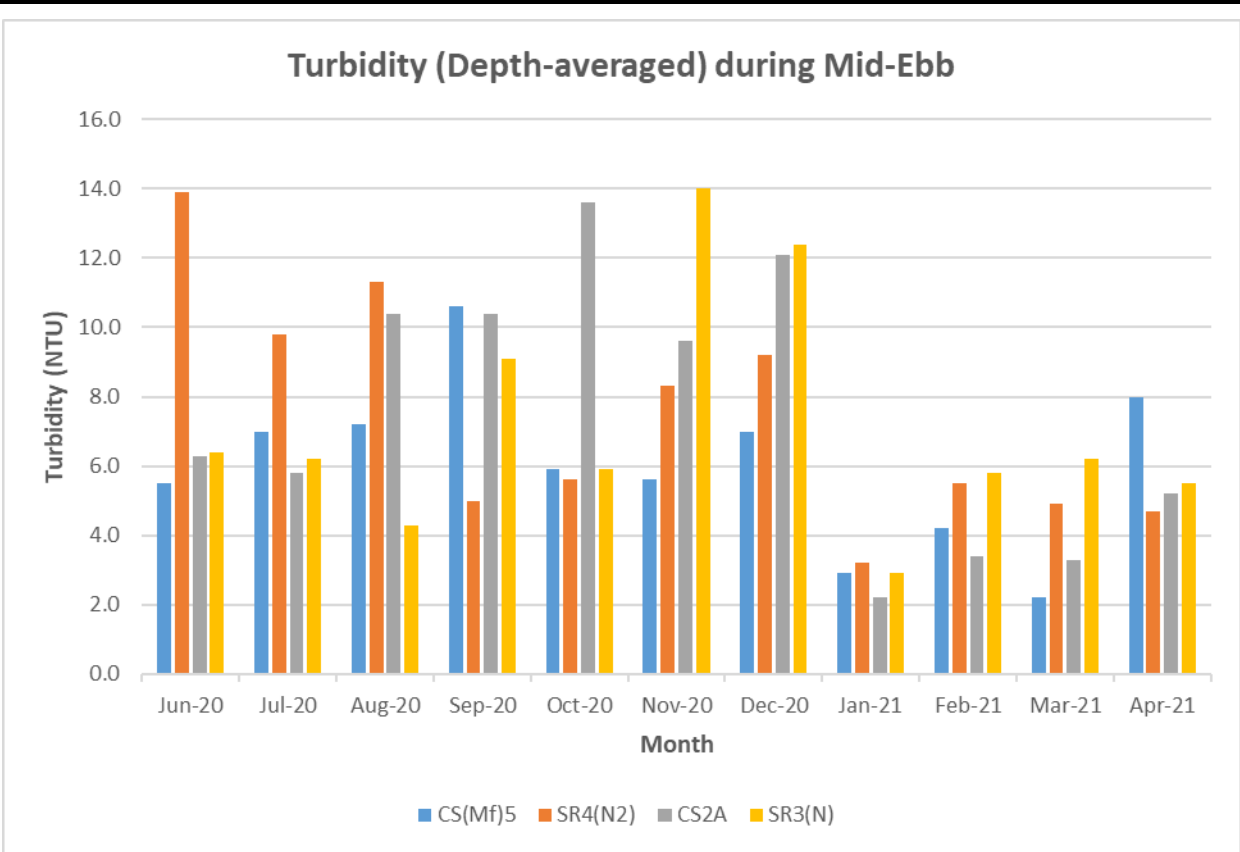

Figure G4 Operational Phase Monitoring - Mean Depth-averaged Level of Turbidity (NTU) between 1 June 2020 and 30 April 2021. The weather conditions during the monitoring period varied mostly from sunny to cloudy.

Ref: 0212330_Impact-WQM_April 2021_graphs_Rev a.xls



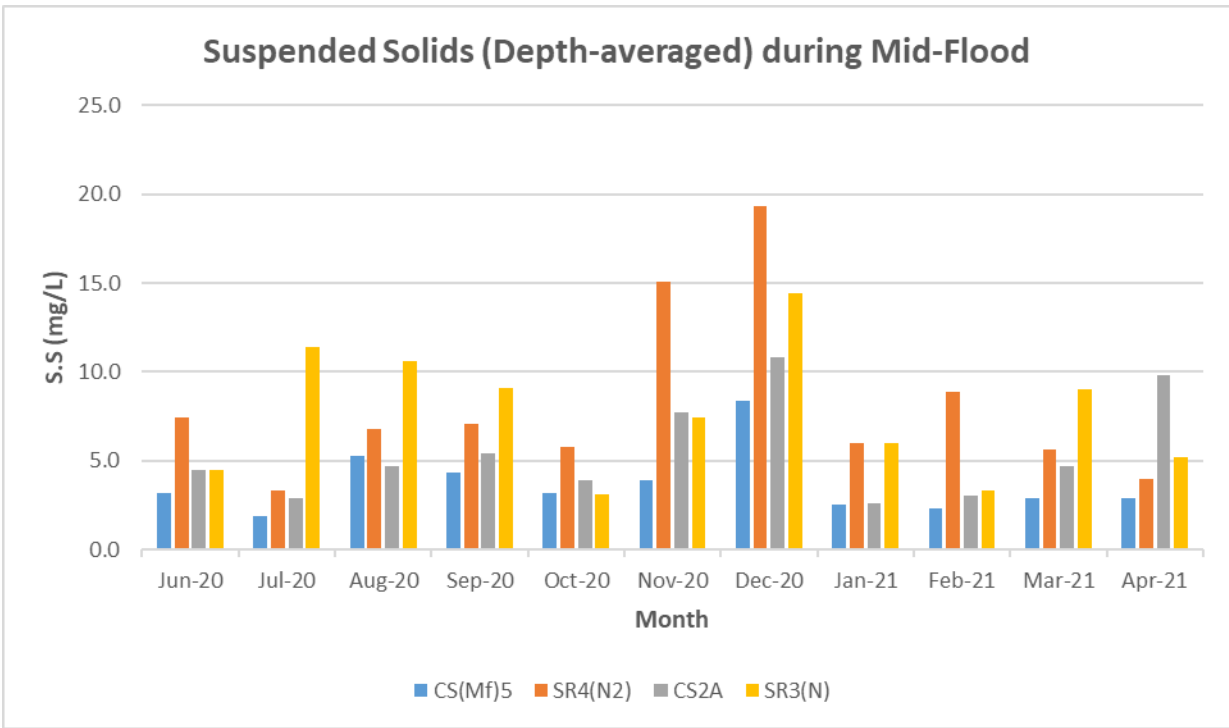
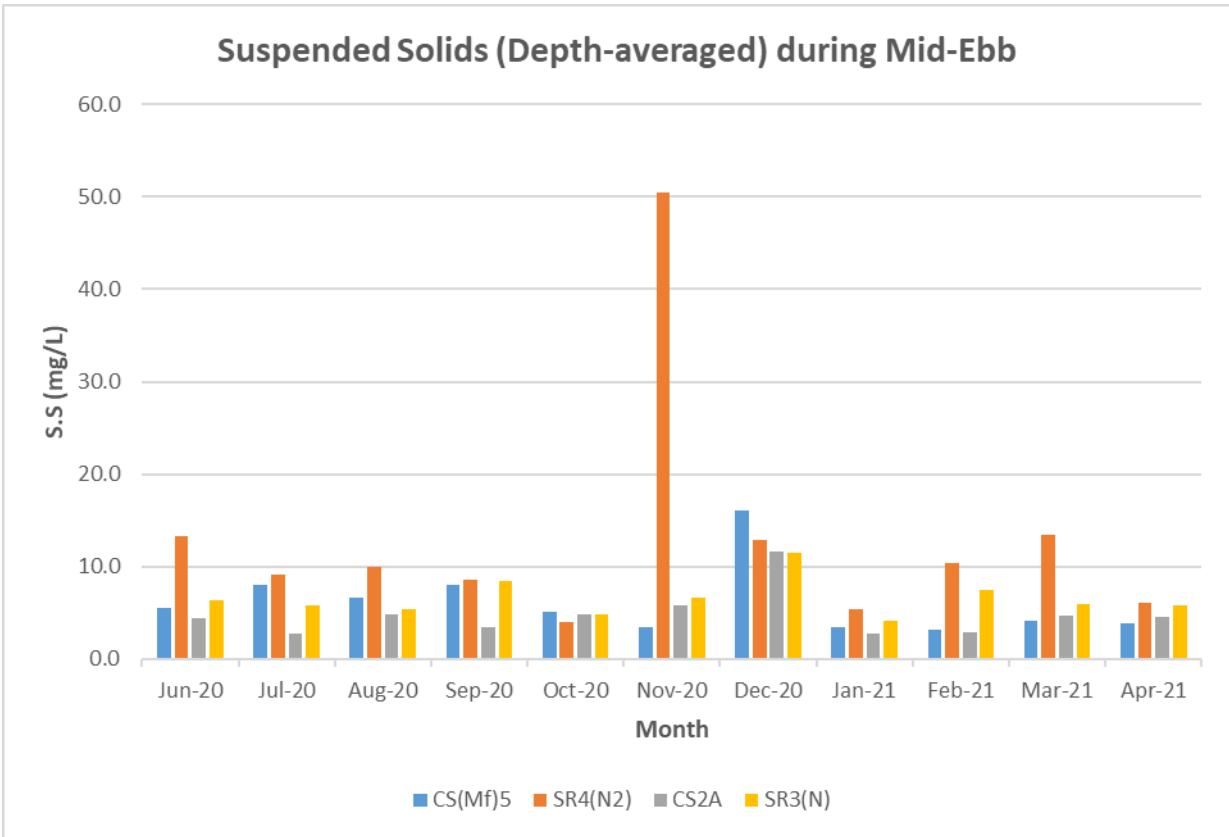

Figure G5 Operational Phase Monitoring – Mean Depth-averaged Level of Suspended Solids (mg/L) between 1 June 2020 and 30 April 2021. The weather conditions during the monitoring period varied mostly from sunny to cloudy.

Ref: 0212330_Impact-WQM_April 2021_graphs_Rev a.xls



Date	Tide	Station	Weather Condition	Sea Condition	Sampling Time	Water Depth (m)	Water Level	Sampling depth (m)	Replicate	Water Temperature (°C)	pH	Salinity (ppt)	Dissolved Oxygen (DO) (mg/L)	DO Saturation (%)	Turbidity (NTU)	Suspended Solids (SS) (mg/L)	Depth-averaged		
																	DO (mg/L)	Turbidity (NTU)	SS (mg/L)
14-04-21	Mid-Ebb	CS(M)5	Cloudy	Moderate	14:48	13.0	Surface	1.0	1	25.5	8.2	29.1	8.6	131.8	3.4	4.8	8.0	8.0	3.9
									2	25.3	8.1	29.4	8.7	125.4	3.3	4.5			
							Middle	6.5	1	24.7	8.0	30.3	7.2	102.8	9.1	4.2			
									2	24.7	8.0	30.4	7.3	103.6	9.5	3.3			
							Bottom	12.0	1	24.6	8.0	30.7	7.0	100.2	11.1	2.9			
									2	24.6	8.0	30.6	7.2	103.6	11.3	3.7			
		SR4(N2)	Cloudy	Calm	13:28	3.7	Surface	1.0	1	25.4	8.1	30.5	7.8	113.0	5.8	6.4	7.9	4.7	6.1
									2	25.4	8.1	30.5	7.9	114.3	5.3	5.4			
							Bottom	2.7	1	25.4	8.1	30.5	7.7	111.1	3.8	6.5			
									2	25.3	8.1	30.5	7.7	112.1	3.7	6.2			
							Surface	1.0	1	25.3	8.1	30.6	8.1	116.7	4.2	4.6			
									2	25.2	8.1	30.7	8.1	117.3	4.7	4.4			
		CS2A	Cloudy	Moderate	12:57	6.2	Surface	1.0	1	24.9	8.1	31.4	7.6	109.1	4.7	4.3	7.9	5.2	4.5
									2	24.7	8.1	31.4	7.6	109.0	5.1	4.2			
							Middle	3.1	1	24.4	8.1	31.5	7.2	103.6	6.1	4.7			
									2	24.3	8.1	31.5	7.3	104.2	6.3	4.5			
							Bottom	5.2	1	24.4	8.1	31.5	7.2	103.6	6.1	4.7			
									2	24.3	8.1	31.5	7.3	104.2	6.3	4.5			
		SR3(N)	Cloudy	Moderate	14:08	4.4	Surface	1.0	1	25.5	8.2	29.6	9.3	134.7	5.2	6.2	9.4	5.5	5.8
									2	25.5	8.2	29.6	9.4	135.7	5.0	6.0			
							Bottom	3.4	1	25.5	8.2	29.7	9.3	133.7	5.7	5.0			
									2	25.4	8.2	29.6	9.2	132.7	5.9	5.8			
							Surface	1.0	1	24.7	8.0	30.1	7.4	105.9	2.2	3.2			
									2	24.8	8.0	29.8	7.4	106.2	2.2	3.5			
14-04-21	Mid-Flood	CS(M)5	Cloudy	Moderate	7:16	12.5	Surface	1.0	1	24.7	8.0	30.1	7.4	105.9	2.2	3.2	7.2	6.6	2.9
									2	24.8	8.0	29.8	7.4	106.2	2.2	3.5			
							Middle	6.3	1	24.4	8.0	30.9	7.0	99.3	7.1	3.0			
									2	24.4	8.0	31.0	6.9	97.9	7.2	2.8			
							Bottom	11.5	1	24.4	8.0	31.1	6.9	98.4	10.7	2.3			
									2	24.4	8.0	31.1	6.9	98.2	10.2	2.7			
		SR4(N2)	Cloudy	Calm	8:32	3.5	Surface	1.0	1	25.1	8.1	30.4	7.5	108.7	4.2	3.6	7.6	4.5	4.0
									2	25.2	8.1	30.4	7.6	108.9	4.2	3.8			
							Bottom	2.5	1	25.1	8.1	30.5	7.5	107.6	4.6	3.9			
									2	25.1	8.1	30.5	7.5	107.7	5.0	4.7			
							Surface	1.0	1	24.4	8.1	31.3	7.2	103.0	10.5	10.2			
									2	24.4	8.1	31.3	7.2	103.3	10.5	10.4			
		CS2A	Cloudy	Moderate	9:07	6.4	Surface	1.0	1	24.3	8.1	31.4	7.2	102.6	11.4	10.2	7.2	11.4	9.8
									2	24.3	8.1	31.4	7.2	102.6	11.4	10.2			
							Middle	3.2	1	24.3	8.1	31.4	7.2	102.6	11.4	10.2			
									2	24.3	8.1	31.5	7.1	102.0	11.3	9.3			
							Bottom	5.4	1	24.3	8.1	31.5	7.2	102.7	12.4	9.1			
									2	24.3	8.1	31.4	7.2	102.4	12.4	9.6			
		SR3(N)	Cloudy	Calm	8:00	4.2	Surface	1.0	1	24.9	8.1	29.5	8.0	114.6	4.0	5.9	8.1	4.3	5.2
									2	24.9	8.1	29.5	8.1	115.3	3.9	5.6			
							Bottom	3.2	1	24.9	8.1	29.5	7.9	113.3	4.6	4.6			
									2	24.9	8.1	29.5	8.0	114.4	4.8	4.7			
							Surface	1.0	1	24.9	8.1	29.5	8.0	114.6	4.0	5.9			
									2	24.9	8.1	29.5	8.1	115.3	3.9	5.6			

Appendix H

Cumulative Statistics on
Exceedances, Complaints,
Notifications of Summons
and Successful Prosecutions

Table H1 *Cumulative Statistics on Exceedances*

Parameters	Level of Exceedance	Total No. recorded in this reporting month	Total No. recorded since Contract commencement
1-hr TSP	Action	0	122
	Limit	0	15
24-hr TSP	Action	0	12
	Limit	0	4
Water Quality	Action	0	167
	Limit	0	19
Impact Dolphin Monitoring	Action	0	11
	Limit	0	19

Table H2 *Cumulative Statistics on Complaints, Notifications of Summons and Successful Prosecutions*

Reporting Period	Cumulative Statistics		
	Complaints	Notifications of Summons	Successful Prosecutions
This Reporting Month (April 2021)	0	0	0
Total No. received since Contract commencement	17	1	0

Appendix I

Waste Flow Table

Monthly Summary Waste Flow Table

Name of Department: HyD

Contract No. / Works Order No.: HY/2012/08

Monthly Summary Waste Flow Table for April 2021 [to be submitted not later than the 15th day of each month following reporting month]

(All quantities shall be rounded off to 3 decimal places.)

Month	Monthly Break-down of <u>Inert</u> Construction & Demolition Materials (i.e. Public Fill Materials)				
	(a)=(b)+(c)+(d)+(e) Total Quantity Generated	(b) Hard Rock and Large Broken Concrete	(c) Reused in the Contract	(d) Reused in other Projects	(e) Disposed of as Public Fill
	(in '000 ton)	(in '000 ton)	(in '000 ton)	(in '000 ton)	(in '000 ton)
Sub-total	3205.825	0.000	336.902	889.467	1979.479
Jan-2020	1.031	0.000	0.000	0.000	1.031
Feb-2020	0.210	0.000	0.000	0.000	0.210
Mar-2020	0.409	0.000	0.000	0.000	0.409
Apr-2020	0.008	0.000	0.000	0.000	0.008
May-2020					
Jun-2020					
Half Year Sub-total					
Jul-2020					
Aug-2020					
Sep-2020					
Oct-2020					
Nov-2020					
Dec-2020					
Project Total Quantities	3207.483	0.000	336.902	889.467	1981.137

Month	Actual Quantities of <u>Non-inert</u> Construction Waste Generated Monthly								
	Metals		Paper/ cardboard packaging		Plastics (see Note 3)		Chemical Waste		Others, e.g. General Refuse disposed at Landfill
	(in '000kg)		(in '000kg)		(in '000kg)		(in '000kg)		(in '000ton)
	generated	recycled	generated	recycled	generated	recycled	generated	Disposed	generated
Sub-total	9919.11	9919.11	18.28	18.28	16.84	16.84	93.807	93.807	28.243
Jan-2020	0.00	0.00	0.00	0.00	0.00	0.00	0.00	0.00	0.071
Feb-2020	0.00	0.00	0.00	0.00	0.00	0.00	0.00	0.00	0.011
Mar-2020	0.00	0.00	0.00	0.00	0.00	0.00	0.00	0.00	0.034
Apr-2020	0.00	0.00	0.00	0.00	0.00	0.00	0.00	0.00	0.068
May-2020									
Jun-2020									
Half Year Sub-total									
Jul-2020									
Aug-2020									
Sep-2020									
Oct-2020									
Nov-2020									
Dec-2020									
Project Total Quantities	9919.11	9919.11	18.28	18.28	16.84	16.84	93.807	93.807	28.427

Forecast of Total Quantities of Construction and Demolition Materials to be Generated from the Contract*				
Total Quantity Generated	Hard Rock and Large Broken Concrete	Reused in the Contract	Reused in other Projects	Disposed of as Public Fill
(in '000 ton)	(in '000 ton)	(in '000 ton)	(in '000 ton)	(in '000 ton)
3200.000	0.000	350.000	1000.000	2000.000

Forecast of Total Quantities of Construction and Demolition Materials to be Generated from the Contract*				
Metals	Paper/ cardboard packaging	Plastics (see Note 3)	Chemical Waste	General Refuse disposed of at Landfill
(in '000kg)	(in '000kg)	(in '000kg)	(in '000kg)	(in '000 ton)
10000.00	20.00	18.00	120.00	30.000

- Notes:
- (1) The performance targets are given in the **ER Appendix 8J Clause 14** and the EM & A Manual(s).
 - (2) The waste flow table shall also include C&D materials to be imported for use at the Site.
 - (3) Plastics refer to plastic bottles/containers, plastic sheets/foam from packaging material.
 - (4) The Contractor shall also submit the latest forecast of the total amount of C&D materials expected to be generated from the Works, together with a breakdown of the nature where the amount of C&D materials expected to be generated from the Works is equal to or exceeding 50,000 m³. (**ER Part 8 Clause 8.8.5 (d) (ii)** refers).