

**Contract No. HY/2012/07  
Tuen Mun - Chek Lap Kok Link -  
Southern Connection Viaduct Section**

*Seventy Seventh Monthly EM&A Report*

14 April 2020

**Environmental Resources Management**  
2507, 25/F One Harbourfront  
18 Tak Fung Street  
Hung Hom, Kowloon  
Hong Kong  
Telephone 2271 3000  
Facsimile 2723 5660

*www.erm.com*



# Contract No. HY/2012/07 Tuen Mun – Chek Lap Kok Link – Southern Connection Viaduct Section

**Environmental Resources  
Management**

2507, 25/F One Harbourfront  
18 Tak Fung Street  
Hungghom, Kowloon  
Hong Kong  
Telephone: (852) 2271 3000  
Facsimile: (852) 2723 5660  
E-mail: post.hk@erm.com  
http://www.erm.com

*Seventy-Seventh Monthly EM&A Report*

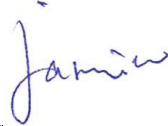
**Document Code: 0215660\_77th Monthly EM&A\_20200414.doc**

Client:  Gammon		Project No:  0215660			
Summary:  This document presents the Seventy-seventh Monthly EM&A Report for Tuen Mun – Chek Lap Kok Link – Southern Connection Viaduct Section.		Date: 14 April 2020			
		Approved by: 			
		Mr Craig Reid Partner			
		Certified by: 			
		Dr Jasmine Ng ET Leader			
	Seventy Seventh Monthly EM&A Report	CW	JN	CAR	14/4/20
Revision	Description	By	Checked	Approved	Date
<p>This report has been prepared by Environmental Resources Management the trading name of 'ERM Hong-Kong, Limited', with all reasonable skill, care and diligence within the terms of the Contract with the client, incorporating our General Terms and Conditions of Business and taking account of the resources devoted to it by agreement with the client.</p> <p>We disclaim any responsibility to the client and others in respect of any matters outside the scope of the above.</p>		<p>Distribution</p> <p><input type="checkbox"/> Internal</p> <p><input checked="" type="checkbox"/> Public</p> <p><input type="checkbox"/> Confidential</p>			
		 			

14 April 2020

By Fax (3691 2899) and By Post

AECOM Asia Company Limited  
Supervising Officer's Representative Office  
780 Cheung Tung Road Lantau, Hong Kong

Attention: Mr. Daniel Ip

Dear Mr. Ip,

**Re: Agreement No. CE 48/2011 (EP)  
Environmental Project Office for the  
HZMB Hong Kong Link Road, HZMB Hong Kong Boundary Crossing Facilities, and  
Tuen Mun-Chek Lap Kok Link – Investigation**

**Contract No. HY/2012/07  
TM-CLKL – Southern Connection Viaduct Section  
77<sup>th</sup> Monthly EM&A Report for March 2020**

Reference is made to the Environmental Team's submission of the monthly EM&A report for March 2020 (ET's ref.: "0215660\_77th Monthly EM&A\_20200414.doc" dated 14 April 2020) certified by the ET Leader and provided to us via e-mail on 14 April 2020.

Please be informed that we have no adverse comments on the captioned submission. We write to verify the captioned submission in accordance with Condition 4.4 of EP-354/2009/D.

Thank you for very much your attention. Please feel free to contact the undersigned or the ENPO Leader, Mr. Y H Hui, should you require further information.

Yours sincerely,  
For and on behalf of  
Ramboll Hong Kong Limited



F. C. Tsang  
Independent Environmental Checker  
Tuen Mun-Chek Lap Kok Link

c.c.

HyD	Mr. Patrick Ng	(By Fax: 3188 6614)
HyD	Mr. Andy HO	(By Fax: 3188 6614)
AECOM	Mr. Conrad Ng	(By Fax: 3922 9797)
ERM	Dr. Jasmine Ng	(By Fax: 2723 5660)
Gammon	Mr. Roy Leung	(By Fax: 3520 0486)

Internal: DY, YH, RY, ENPO Site

Q:\Projects\HYDHZMBEEM00\02\_Proj\_Mgt\02\_Corr\HYDHZMBEEM00\_0\_7978L.20.doc.doc

## TABLE OF CONTENTS

	<i>EXECUTIVE SUMMARY</i>	<i>1</i>
<i>1</i>	<i>INTRODUCTION</i>	<i>3</i>
<i>1.1</i>	<i>BACKGROUND</i>	<i>3</i>
<i>1.2</i>	<i>SCOPE OF REPORT</i>	<i>4</i>
<i>1.3</i>	<i>ORGANIZATION STRUCTURE</i>	<i>4</i>
<i>1.4</i>	<i>SUMMARY OF CONSTRUCTION WORKS</i>	<i>5</i>
<i>2</i>	<i>EM&amp;A RESULTS</i>	<i>6</i>
<i>2.1</i>	<i>AIR QUALITY</i>	<i>6</i>
<i>2.2</i>	<i>NOISE MONITORING</i>	<i>6</i>
<i>2.3</i>	<i>WATER QUALITY MONITORING</i>	<i>6</i>
<i>2.4</i>	<i>DOLPHIN MONITORING</i>	<i>6</i>
<i>2.5</i>	<i>EM&amp;A SITE INSPECTION</i>	<i>7</i>
<i>2.6</i>	<i>WASTE MANAGEMENT STATUS</i>	<i>7</i>
<i>2.7</i>	<i>ENVIRONMENTAL LICENSES AND PERMITS</i>	<i>8</i>
<i>2.8</i>	<i>IMPLEMENTATION STATUS OF ENVIRONMENTAL MITIGATION MEASURES</i>	<i>10</i>
<i>2.9</i>	<i>SUMMARY OF EXCEEDANCES OF THE ENVIRONMENTAL QUALITY PERFORMANCE LIMIT</i>	<i>10</i>
<i>2.10</i>	<i>SUMMARY OF COMPLAINTS, NOTIFICATION OF SUMMONS AND SUCCESSFUL PROSECUTIONS</i>	<i>10</i>
<i>3</i>	<i>FUTURE KEY ISSUES</i>	<i>11</i>
<i>3.1</i>	<i>CONSTRUCTION PROGRAMME FOR THE COMING MONTH</i>	<i>11</i>
<i>3.2</i>	<i>KEY ISSUES FOR THE COMING MONTH</i>	<i>11</i>
<i>3.3</i>	<i>MONITORING SCHEDULE FOR THE COMING MONTH</i>	<i>11</i>
<i>4</i>	<i>CONCLUSIONS AND RECOMMENDATIONS</i>	<i>12</i>
<i>4.1</i>	<i>CONCLUSIONS</i>	<i>12</i>



### *List of Appendices*

- Appendix A Project Organization for Environmental Works
- Appendix B Three Month Rolling Construction Programmes
- Appendix C Implementation Schedule of Environmental Mitigation Measures (EMIS)
- Appendix D Monthly Summary of Waste Flow Table
- Appendix E Cumulative Statistics on Exceedances, Complaints, Notifications of Summons and Successful Prosecutions

## EXECUTIVE SUMMARY

Under *Contract No. HY/2012/07*, Gammon Construction Limited (GCL) is commissioned by the Highways Department (HyD) to undertake the design and construction of the Southern Connection Viaduct Section of the Tuen Mun – Chek Lap Kok Link Project (TM-CLK Link Project) while AECOM Asia Company Limited was appointed by HyD as the Supervising Officer. For implementation of the environmental monitoring and audit (EM&A) programme under the Contract, ERM-Hong Kong, Limited (ERM) has been appointed as the Environmental Team (ET). Ramboll Hong Kong Ltd. was employed by the HyD as the Independent Environmental Checker (IEC) and Environmental Project Office (ENPO) in accordance with *Environmental Permit No. EP-354/2009/A*. Further applications for variation of environmental permit (VEP), *EP-354/2009/B*, *EP-354/2009/C* and *EP-354/2009/D*, were granted on 28 January 2014, 10 December 2014 and 13 March 2015, respectively.

The southern landfall of TM-CLK Link lies alongside the Hong Kong - Zhuhai - Macao Bridge Hong Kong Boundary Crossing Facilities (HKBCF) where a reclamation area is constructed by *Contract No. HY/2010/02* under *Environmental Permit No. EP-353/2009/K* and *EP-354/2009/D*. Upon the agreement and confirmation between the Supervising Officer Representatives and Contractors of *HY/2010/02* and *HY/2012/07* in September 2015, part of the reclamation area for southern landfall under *EP-353/2009/K* and *EP-354/2009/D* was handed-over to *Contract No. HY/2012/07*. Another part of the southern landfall area under *EP-354/2009/D* was handed-over to *Contract No. HY/2012/07* after completion of reclamation works by *Contract No. HY/2010/02* in June 2016.

The construction phase of the Contract commenced on 31 October 2013. The impact monitoring of the EM&A programme, including air quality, noise, water quality and marine ecological monitoring as well as environmental site inspections, commenced on 31 October 2013.

This is the seventy-seventh Monthly EM&A report presenting the EM&A works carried out during the period from 1 to 16 March 2020 for the Southern Connection Viaduct Section in accordance with the Updated EM&A Manual of the TM-CLK Link Project. As informed by the Contractor, there are no major works to be undertaken in the monitoring period of March 2020.

A summary of monitoring and audit activities conducted in the reporting period is listed below:

Joint Environmental Site Inspection	2 sessions
-------------------------------------	------------

### **Breaches of Action and Limit Levels for Air Quality**

No air quality monitoring was scheduled for the reporting month as construction works was substantially completed on 31 July 2019.

Notification of temporary suspension of air quality monitoring has been approved by EPD on 28 August 2019.

Termination proposal for construction EM&A programme was approved by EPD on 16 March 2020. The construction phase EM&A programme of the Contract has been terminated since 16 March 2020. No construction air quality monitoring programme was undertaken in the reporting period.

#### **Breaches of Action and Limit Levels for Noise**

No noise monitoring was scheduled for the reporting month as construction works was substantially completed on 31 July 2019. Notification of temporary suspension of noise monitoring has been approved by EPD on 28 August 2019.

Termination proposal for construction EM&A programme was approved by EPD on 16 March 2020. The construction phase EM&A programme of the Contract has been terminated since 16 March 2020. No construction noise monitoring programme was undertaken in the reporting period.

#### **Impact Dolphin Monitoring**

Termination proposal for construction EM&A programme was approved by EPD on 16 March 2020. The construction phase EM&A programme of the Contract has been terminated since 16 March 2020. No dolphin impact monitoring programme was undertaken in the reporting period.

No marine works were undertaken during the reporting period, therefore, daily 250 m marine mammal exclusion zone monitoring was not undertaken during the reporting period.

#### **Environmental Complaints, Non-compliance & Summons**

No environmental complaints, notification of summons or successful prosecution recorded in the reporting period.

#### **Reporting Change**

Termination proposal for construction EM&A programme was approved by EPD on 16 March 2020. The construction phase EM&A programme of the Contract has been terminated since 16 March 2020.

#### **Upcoming Works for the Next Reporting Period**

There are no major works to be undertaken in April 2020.

#### **Future Key Issues**

There are no major works to be undertaken in April 2020.

# 1 INTRODUCTION

## 1.1 BACKGROUND

According to the findings of the Northwest New Territories (NWNT) Traffic and Infrastructure Review conducted by the Transport Department, Tuen Mun Road, Ting Kau Bridge, Lantau Link and North Lantau Highway would be operating beyond capacity after 2016. This forecast has been based on the estimated increase in cross boundary traffic, developments in the Northwest New Territories (NWNT), and possible developments in North Lantau, including the Airport developments, the Lantau Logistics Park (LLP) and the Hong Kong – Zhuhai – Macao Bridge (HZMB). In order to cope with the anticipated traffic demand, two new road sections between NWNT and North Lantau – Tuen Mun – Chek Lap Kok Link (TM-CLKL) and Tuen Mun Western Bypass (TMWB) are proposed.

An Environmental Impact Assessment (EIA) of TM-CLKL (the Project) was prepared in accordance with the EIA Study Brief (No. ESB-175/2007) and the *Technical Memorandum of the Environmental Impact Assessment Process (EIAO-TM)*. The EIA Report was submitted under the Environmental Impact Assessment Ordinance (EIAO) in August 2009. Subsequent to the approval of the EIA Report (EIAO Register Number AEIAR-146/2009), an Environmental Permit (EP-354/2009) for TM-CLKL was granted by the Director of Environmental Protection (DEP) on 4 November 2009, and EP variation (EP-354/2009/A) was issued on 8 December 2010.

Under *Contract No. HY/2012/07*, Gammon Construction Limited (GCL) is commissioned by the Highways Department (HyD) to undertake the design and construction of the Southern Connection Viaduct Section of TM-CLKL (“the Contract”) while AECOM Asia Company Limited was appointed by HyD as the Supervising Officer. For implementation of the environmental monitoring and audit (EM&A) programme under the Contract, ERM-Hong Kong, Limited (ERM) has been appointed as the Environmental Team (ET). Ramboll Hong Kong Ltd. was employed by HyD as the Independent Environmental Checker (IEC) and Environmental Project Office (ENPO) in accordance with *Environmental Permit No. EP-354/2009/A*. Further applications for variation of environmental permit (VEP), *EP-354/2009/B*, *EP-354/2009/C* and *EP-354/2009/D*, were granted on 28 January 2014, 10 December 2014 and 13 March 2015, respectively.

The southern landfall of TM-CLK Link lies alongside the Hong Kong - Zhuhai - Macao Bridge Hong Kong Boundary Crossing Facilities (HKBCF) where a reclamation area is constructed by *Contract No. HY/2010/02* under *Environmental Permit No. EP-353/2009/K* and *EP-354/2009/D*. Upon the agreement and confirmation between the Supervising Officer Representatives and Contractors of *HY/2010/02* and *HY/2012/07* in September 2015, part of the reclamation area for southern landfall under *EP-353/2009/K* and *EP-354/2009/D* was handed-over to *Contract No. HY/2012/07*. Another part of the

southern landfall area under *EP-354/2009/D* was handed-over to *Contract No. HY/2012/07* after completion of reclamation works by *Contract No. HY/2010/02* in June 2016.

The construction phase of the Contract commenced on 31 October 2013. The impact monitoring phase of the EM&A programme, including air quality, noise, water quality and marine ecological monitoring as well environmental site inspections, commenced on 31 October 2013.

Termination proposal for construction EM&A programme was approved by EPD on 16 March 2020. The construction phase EM&A programme of the Contract has been terminated since 16 March 2020.

The general layout plan of the Contract components is presented in *Figures 1.1 & 1.2a to l*.

## **1.2 SCOPE OF REPORT**

This is the seventy-seventh Monthly EM&A Report under the *Contract No. HY/2012/07 Tuen Mun – Chek Lap Kok Link – Southern Connection Viaduct Section*. This report presents a summary of the environmental monitoring and audit works during the period from 1 to 16 March 2020.

## **1.3 ORGANIZATION STRUCTURE**

The organization structure of the Contract is shown in *Appendix A*. The key personnel contact names and contact details are summarized in *Table 1.1* below.



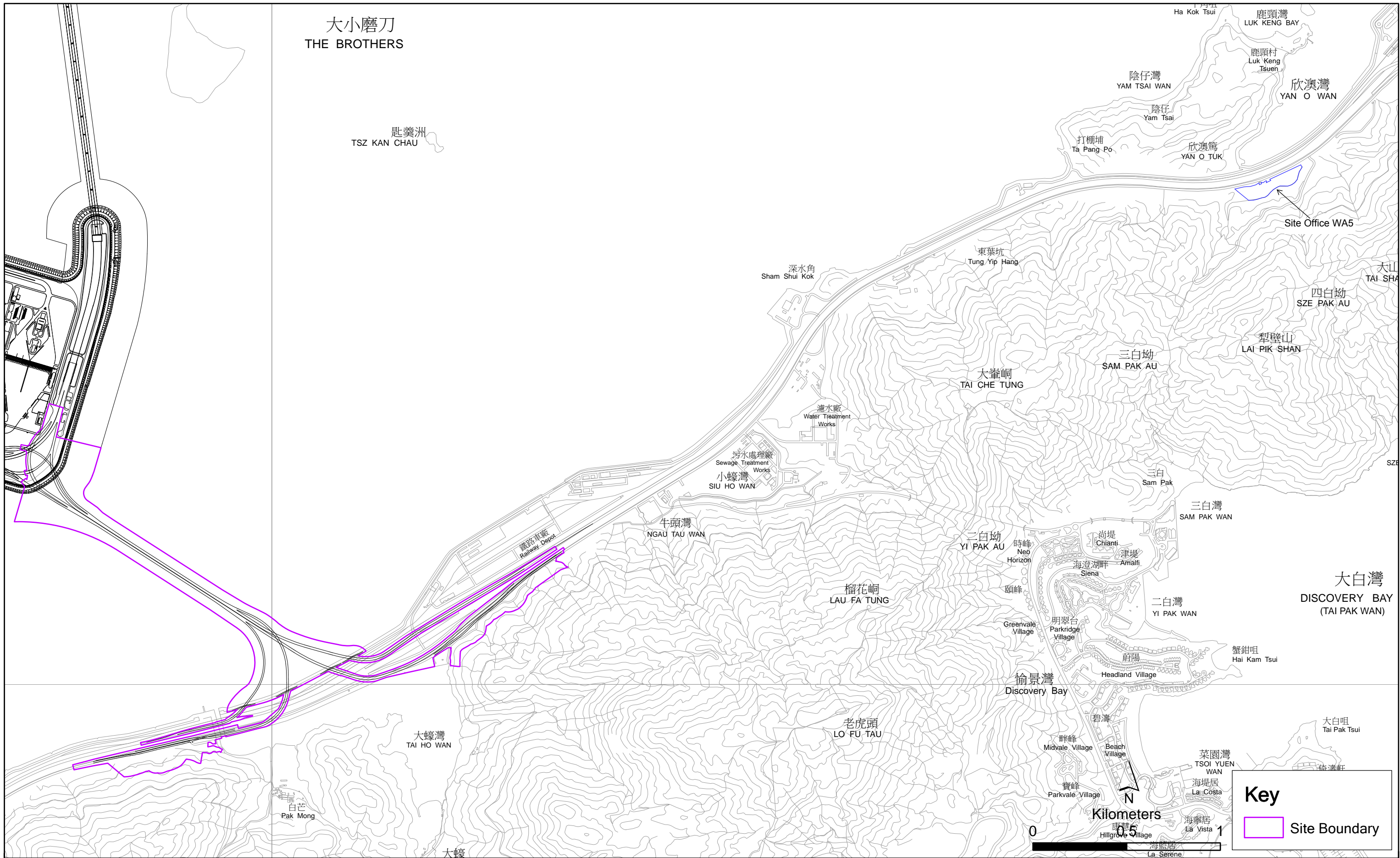

Figure 1.1

General Layout Plan of the Project

Environmental  
Resources  
Management





Proj File by: H:\AECOM\2012\02\240249\C1\2000.dgn  
 Path: P:\Projects\2012\02\240249\C1\2000.dgn  
 Project Management: Hinkley  
 Designer: LHM/BB  
 Checker: SLYT  
 Approver: CWN  
 ISO AT 50mm x 61mm  
 Only

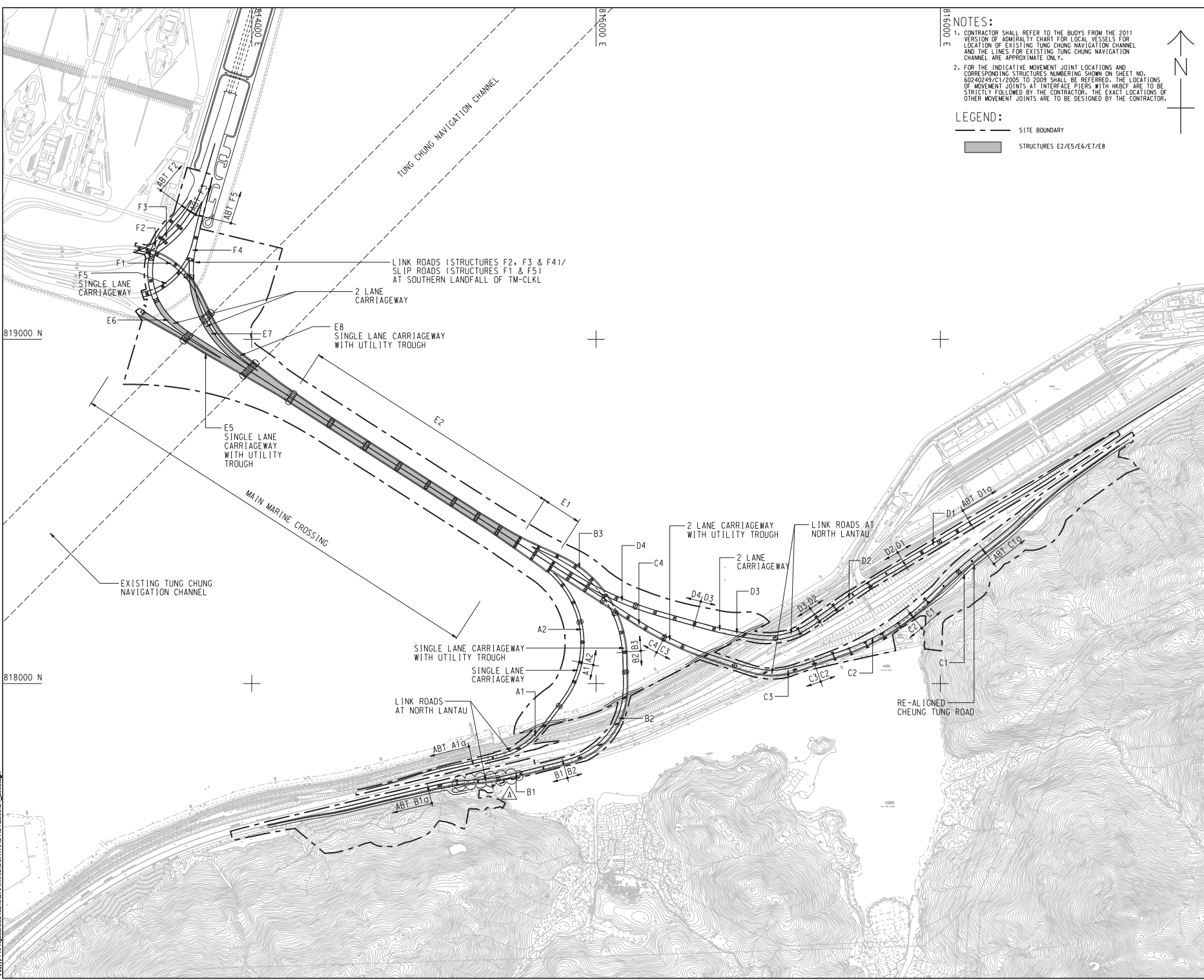

**NOTES:**

- CONTRACTOR SHALL REFER TO THE BUOYS FROM THE 2011 VERSION OF ADMIRALTY CHART FOR LOCAL VESSELS FOR LOCATION OF EXISTING TUNG CHUNG NAVIGATION CHANNEL AND THE LINES FOR EXISTING TUNG CHUNG NAVIGATION CHANNEL ARE APPROXIMATE ONLY.
- FOR THE INDICATIVE MOVEMENT JOINT LOCATIONS AND CORRESPONDING STRUCTURES NUMBERING SHOWN ON SHEET NO. 60240249/C1/2005 TO 2009 SHALL BE REFERRED. THE LOCATIONS OF MOVEMENT JOINTS AT INTERFACE PIERS WITH HKBCF ARE TO BE STRICTLY FOLLOWED BY THE CONTRACTOR. THE EXACT LOCATIONS OF OTHER MOVEMENT JOINTS ARE TO BE DESIGNED BY THE CONTRACTOR.

**LEGEND:**

— SITE BOUNDARY

▬ STRUCTURES E2/E5/E6/E7/E8

**AECOM**

**PROJECT**  
TUEN MUN - CHEK LAP KOK LINK

**CONTRACT TITLE**  
TUEN MUN - CHEK LAP KOK LINK - SOUTHERN CONNECTION VIADUCT SECTION

**CLIENT**  
路政署  
HIGHWAYS DEPARTMENT  
港務局  
Hong Kong - Zhuhai - Hainan Bridge  
Hong Kong Project Management Office

**CONSULTANT**  
AECOM Asia Company Ltd.  
www.aecom.com

**SUB-CONSULTANTS**

# Figure 1.2a

**ISSUE/REVISION**

NO.	DATE	DESCRIPTION	CHK.

**STATUS**

SCALE	DIMENSION UNIT
A1 : 6000	METRES

**KEY PLAN**

<b>PROJECT NO.</b> 60240249	<b>CONTRACT NO.</b> HY/2012/07
<b>SHEET TITLE</b> SOUTHERN CONNECTION GENERAL LAYOUT PLAN	
<b>SHEET NUMBER</b> 60240249/C1/2000A	

This drawing has been prepared for the use of AECOM's client. It may not be used, modified, reproduced or related parts by third parties, except as approved by AECOM. AECOM accepts no responsibility for any errors or omissions in this drawing or for any consequences arising therefrom. All measurements must be obtained from the latest drawings.

DO NOT SCALE DRAWING. CHECK ALL DIMENSIONS ON SITE.

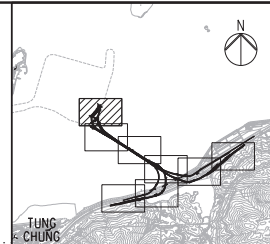
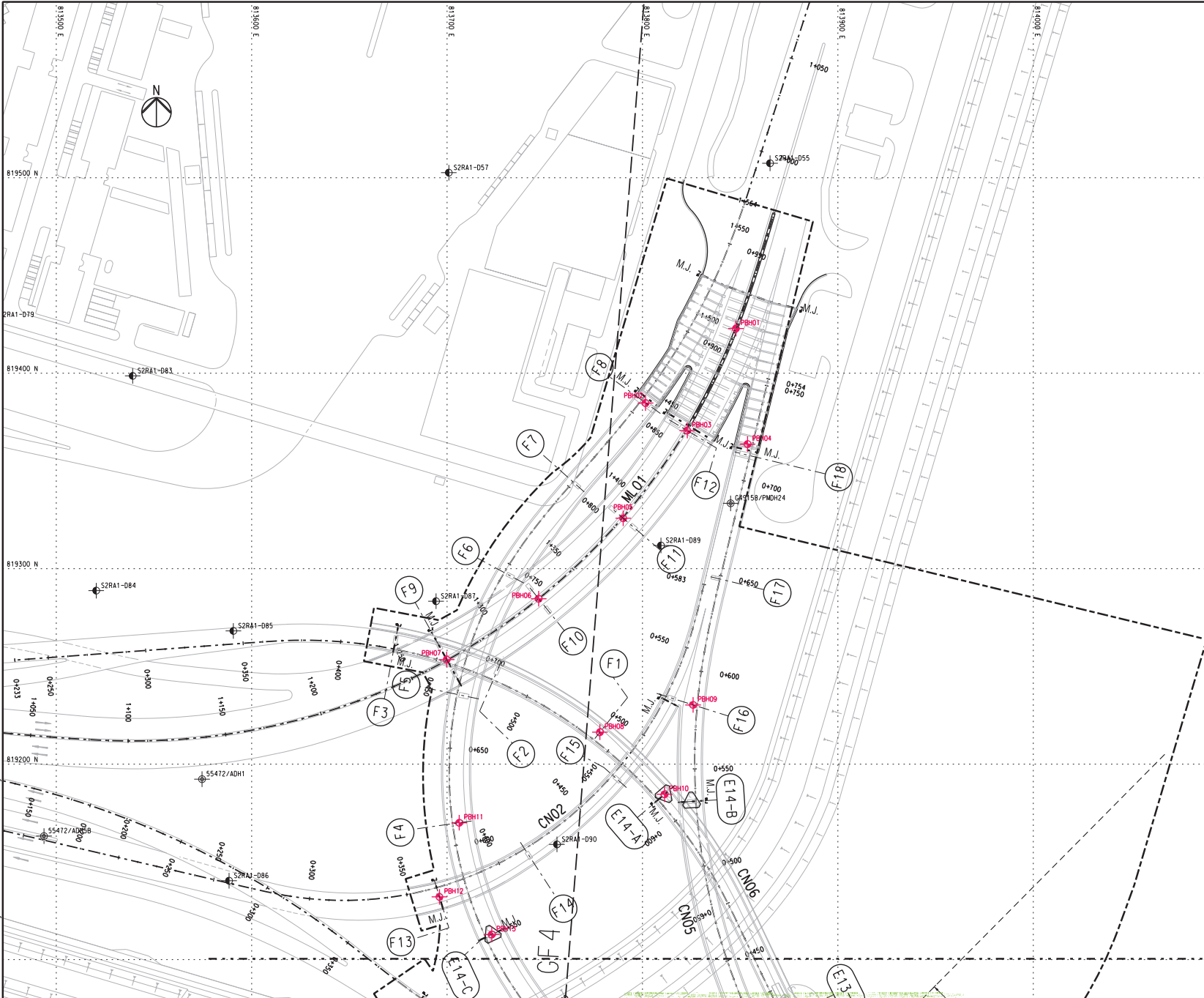

**KEY PLAN**

**NOTES**  
 1. THIS DRAWING SHALL BE READ IN CONJUNCTION WITH DRAWING NO. J3518/P/OAP/04/1000 AND OTHER RELEVANT DRAWINGS.

- LEGEND**
- SITE BOUNDARY
  - GF1 FAULT
  - EXISTING G.I.-STATIONS :
    - ⊕ BOREHOLE BY GIU DATA EXCLUDING VC
    - ⊕ BOREHOLE BY GCL CONTRACT HY/2012/04
    - ⊕ BOREHOLE BY GCL CONTRACT NL8/97
    - ⊕ BOREHOLE BY GCL CONTRACT HY/2009/23
    - ⊕ TRIAL PIT BY GCL CONTRACT HY/2012/04
  - SLOPE STRIPPING BY GCL CONTRACT HY/2012/04
  - PROPOSED G.I.-STATIONS :
    - ⊕ PBH01 PROPOSED BOREHOLE
    - ⊕ TP01 PROPOSED TRIAL PIT
    - ⊕ CH01 PROPOSED COREHOLE
    - SS01 SS02 PROPOSED SLOPE STRIPPING

MATCH LINE  
 FOR CONTINUATION  
 SEE DRG. J3518/P/OAP/04/01101

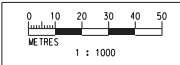

Printed by : 12/09/2013  
 File name : E:\3518\99\REC\DRG\20130927\Ground Investigation Plan\CAD\231498\_P\_OAP\_04\_01000.dwg

Rev	Description	By	Date	Rev	Description	By	Date
A	SUBMISSION	RC	07/13				
B	SUBMISSION	RC	07/13				
C	SUBMISSION	RC	09/13				

Drawn	Date	Client
RL	07/13	
Checked	Approved	
DS	DOP	
Scale		
1:1000 @ A1 / 1:2000 @ A3		

路政署  
**HIGHWAYS DEPARTMENT**  
 香港特別行政區運輸及房屋局  
 Transport and Planning  
 Hong Kong - Zhuhai - Macao Bridge  
 Hong Kong Project Management Office

Supervising Officer: **AECOM**  
 Contractor: **Gammon**

Project Title  
**Contract No. HY/2012/07**  
**Tuen Mun - Chek Lap Kok Link**  
**Southern Connection Viaduct Section**

Originator: **ARUP**

Drawing title  
**Figure 1.2b**

Drawing no. **J3518/P/OAP/04/01100** Rev. **C**



DO NOT SCALE DRAWING. CHECK ALL DIMENSIONS ON SITE.

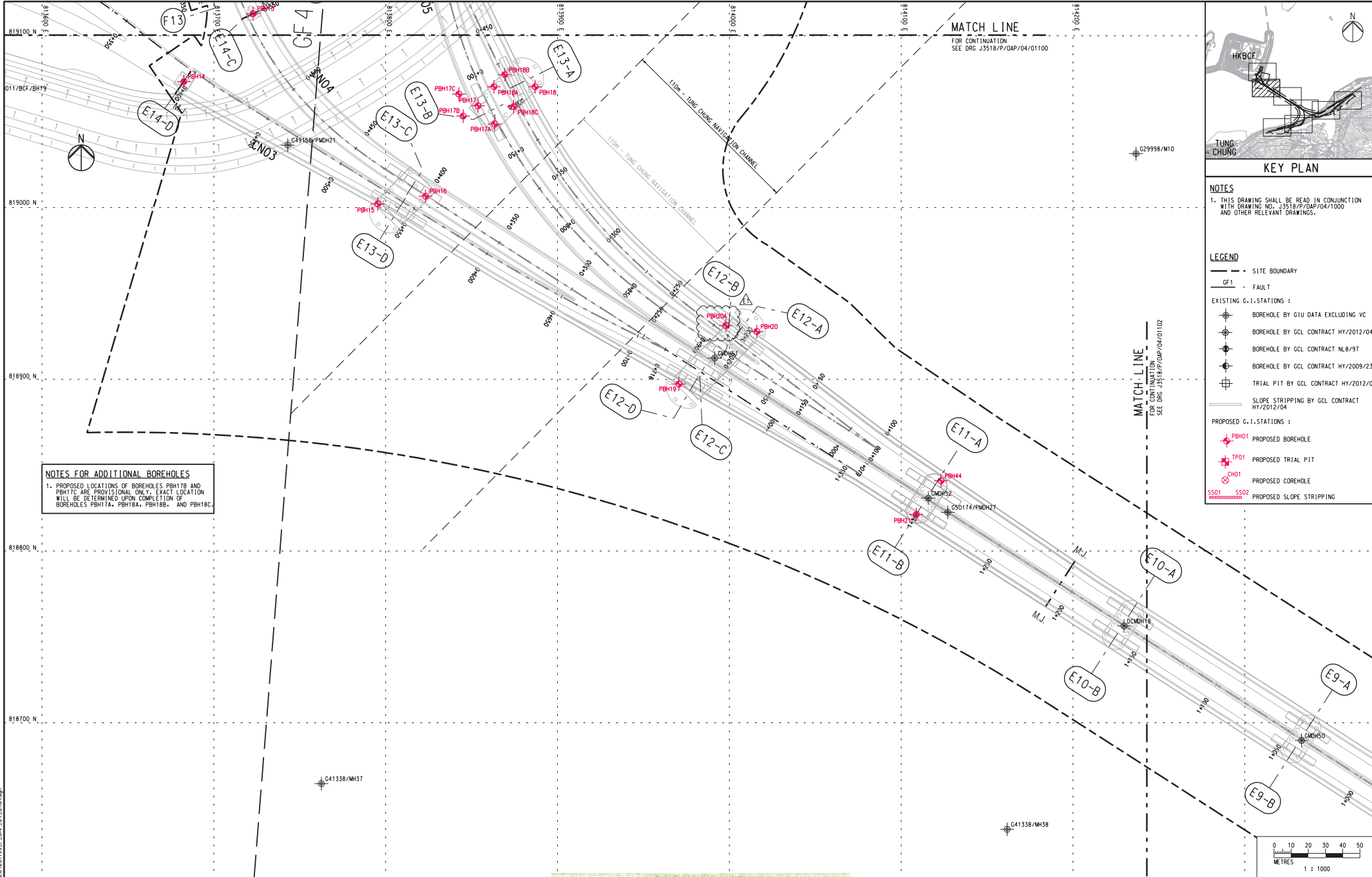

MATCH LINE  
FOR CONTINUATION  
SEE DRG J3518/P/OAP/04/01100

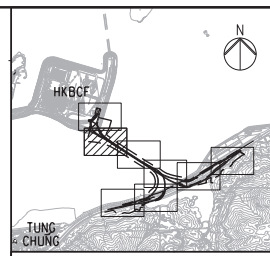

KEY PLAN

NOTES  
1. THIS DRAWING SHALL BE READ IN CONJUNCTION WITH DRAWING NO. J3518/P/OAP/04/1000 AND OTHER RELEVANT DRAWINGS.

- LEGEND
- - - SITE BOUNDARY
  - GF1 - FAULT
  - EXISTING G.I. STATIONS :
    - ⊕ BOREHOLE BY GIU DATA EXCLUDING VC
    - ⊕ BOREHOLE BY GCL CONTRACT HY/2012/04
    - ⊕ BOREHOLE BY GCL CONTRACT NL8/97
    - ⊕ BOREHOLE BY GCL CONTRACT HY/2009/23
    - ⊕ TRIAL PIT BY GCL CONTRACT HY/2012/04
    - ▬ SLOPE STRIPPING BY GCL CONTRACT HY/2012/04
  - PROPOSED G.I. STATIONS :
    - ⊕ PBH01 PROPOSED BOREHOLE
    - ⊕ TP01 PROPOSED TRIAL PIT
    - ⊕ CH01 PROPOSED COREHOLE
    - SS01 SS02 PROPOSED SLOPE STRIPPING

NOTES FOR ADDITIONAL BOREHOLES  
1. PROPOSED LOCATIONS OF BOREHOLES PBH17B AND PBH17C ARE PROVISIONAL ONLY. EXACT LOCATION WILL BE DETERMINED UPON COMPLETION OF BOREHOLES PBH17A, PBH18A, PBH18B, AND PBH18C.

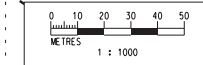

Printed by : 05.11.13  
Filename : E:\23499\WIP\GEO\23499\_P\_OAP\_04\_01100.dgn

Rev	Description	By	Date	Rev	Description	By	Date
A	SUBMISSION	RC	07/13				
B	SUBMISSION	RC	07/13				
C	SUBMISSION	RC	09/13				
D	SUBMISSION	RC	10/13				
E1	FOR INTERNAL REVIEW	RC	11/13				

Drawn	RL	Date	07/13
Checked	DS	Approved	DOP
Scale	1:1000 @ A1; 1:2000 @ A3		

  

Client	路政署 HIGHWAYS DEPARTMENT 香港渠务局 Hong Kong - Zhuhai - Macao Bridge Hong Kong Project Management Office
Supervising Officer	AECOM
Contractor	Gammon
Originator	ARUP

Project Title	Contract No. HY/2012/07 Tuen Mun - Chek Lap Kok Link Southern Connection Viaduct Section
Drawing title	<b>Figure 1.2c</b>
Drawing no.	J3518/P/OAP/04/01101
Rev.	E1

DO NOT SCALE DRAWING. CHECK ALL DIMENSIONS ON SITE.

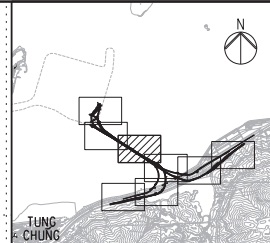
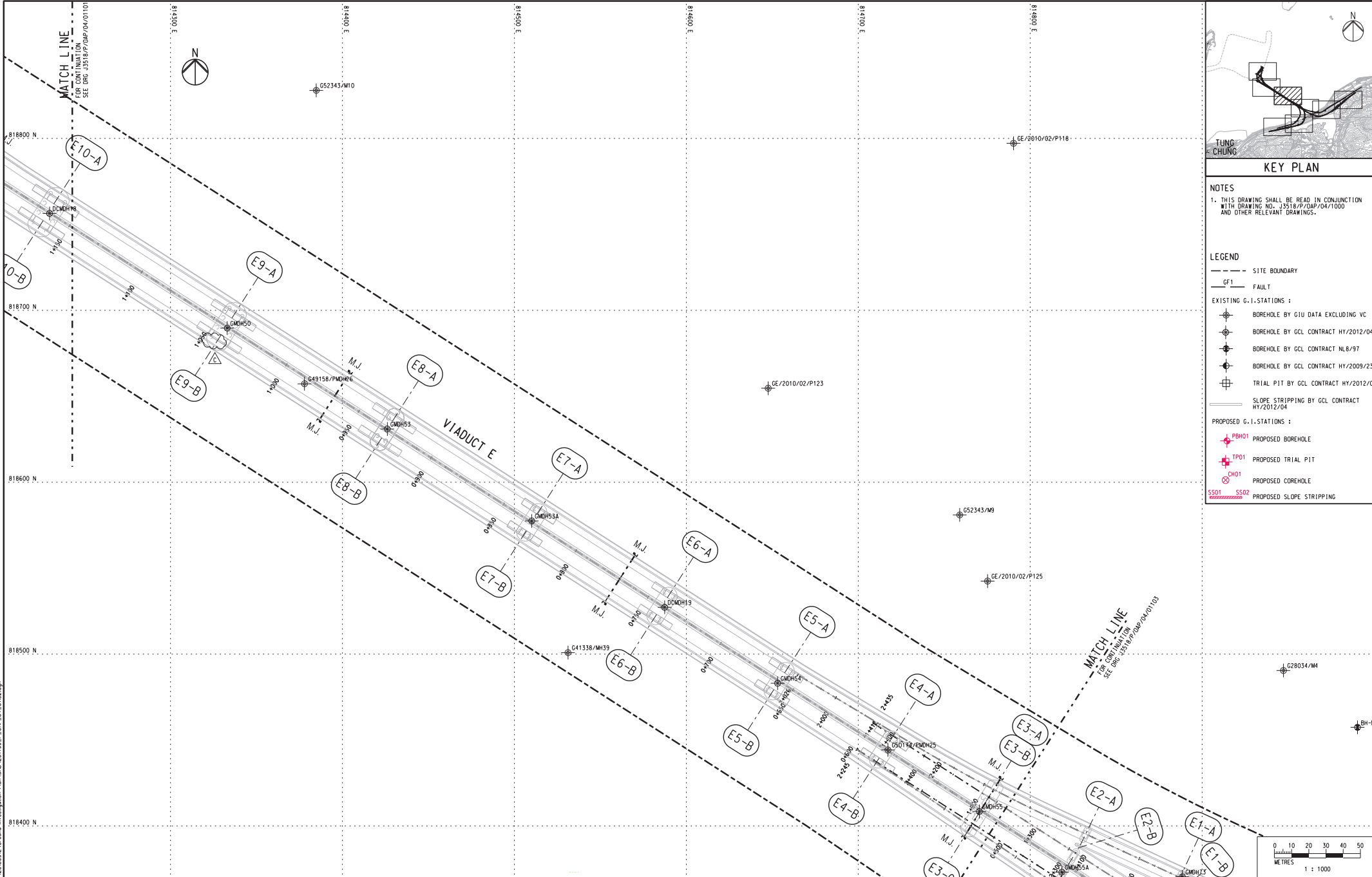

**KEY PLAN**

**NOTES**  
 1. THIS DRAWING SHALL BE READ IN CONJUNCTION WITH DRAWING NO. J3518/P/OAP/04/1000 AND OTHER RELEVANT DRAWINGS.

- LEGEND**
- SITE BOUNDARY
  - GF1- FAULT

EXISTING G.I.-STATIONS :

    - ⊕ BOREHOLE BY GIU DATA EXCLUDING VC
    - ⊕ BOREHOLE BY GCL CONTRACT HY/2012/04
    - ⊕ BOREHOLE BY GCL CONTRACT NL8/97
    - ⊕ BOREHOLE BY GCL CONTRACT HY/2009/23
    - ⊕ TRIAL PIT BY GCL CONTRACT HY/2012/04
    - SLOPE STRIPPING BY GCL CONTRACT HY/2012/04

PROPOSED G.I.-STATIONS :

    - ⊕ PBH01 PROPOSED BOREHOLE
    - ⊕ TP01 PROPOSED TRIAL PIT
    - ⊕ CH01 PROPOSED COREHOLE
    - SS01 SS02 PROPOSED SLOPE STRIPPING

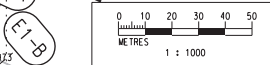

Printed by : 12/09/2013  
 File name : J:\3518\99\REC\000\2013092\Ground Investigation Plan\CAD\23498\_P\_OAP\_04\_01102.dgn

Rev	Description	By	Date	Rev	Description	By	Date	Drawn	Date	Client	Project Title	Drawing title		
A	SUBMISSION	RC	07/13					RL	07/13	路政署 <b>HIGHWAYS DEPARTMENT</b> 港珠澳大桥香港工程管理有限公司 Hong Kong Southern Connection Viaduct Project Hong Kong Project Management Office	Contract No. HY/2012/07 Tuen Mun - Chek Lap Kok Link Southern Connection Viaduct Section	<b>Figure 1.2d</b>		
B	SUBMISSION	RC	07/13				Checked	Approved						
C	SUBMISSION	RC	09/13				DS	DOP						
								Scale	1:1000 @ A1 / 1:2000 @ A3		Supervising Officer	Contractor	Originator	
										<b>AECOM</b>	<b>Gammon</b>	<b>ARUP</b>	Drawing no. J3518/P/OAP/04/01102	Rev. C



DO NOT SCALE DRAWING. CHECK ALL DIMENSIONS ON SITE.

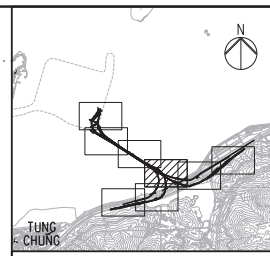
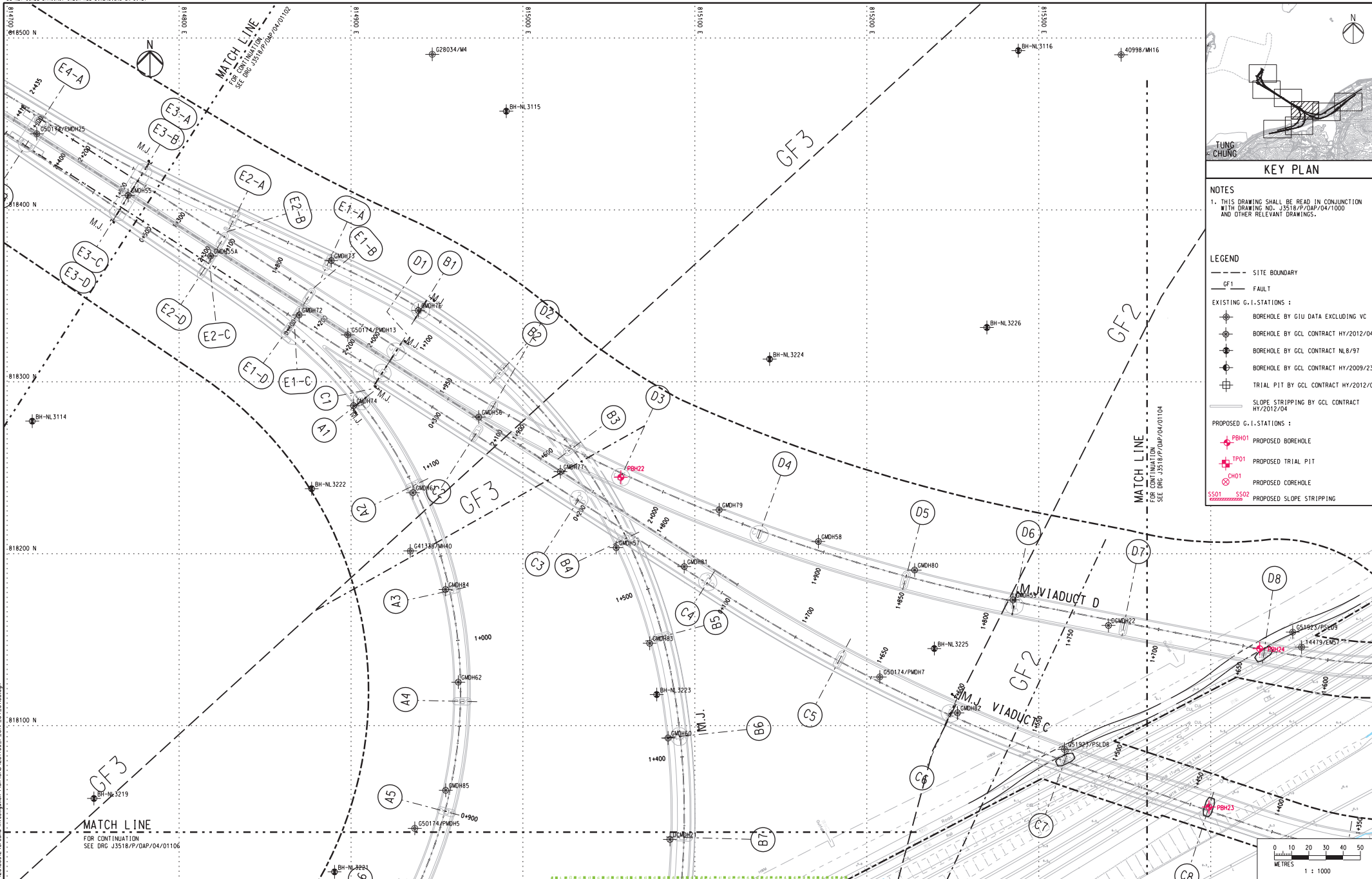

**KEY PLAN**

**NOTES**  
 1. THIS DRAWING SHALL BE READ IN CONJUNCTION WITH DRAWING NO. J3518/P/OAP/04/1000 AND OTHER RELEVANT DRAWINGS.

- LEGEND**
- SITE BOUNDARY
  - - - FAULT
  - EXISTING G.I. STATIONS :
    - ⊕ BOREHOLE BY GIU DATA EXCLUDING VC
    - ⊕ BOREHOLE BY GCL CONTRACT HY/2012/04
    - ⊕ BOREHOLE BY GCL CONTRACT NL8/97
    - ⊕ BOREHOLE BY GCL CONTRACT HY/2009/23
    - ⊕ TRIAL PIT BY GCL CONTRACT HY/2012/04
  - PROPOSED G.I. STATIONS :
    - ⊕ PBH01 PROPOSED BOREHOLE
    - ⊕ TP01 PROPOSED TRIAL PIT
    - ⊕ CH01 PROPOSED COREHOLE
    - SS01 SS02 PROPOSED SLOPE STRIPPING

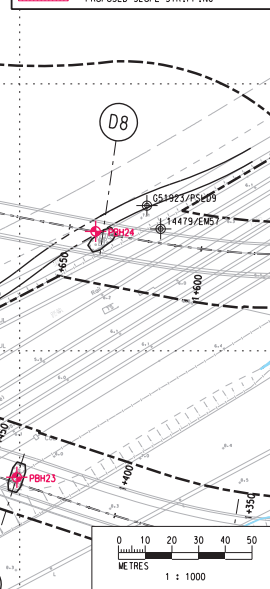

Printed by : 13/9/2013  
 File name : J3518/P/OAP/04/1000.dwg  
 Record : 20130927 Ground Investigation Plan CAD\23498\_P\_OAP\_04\_01003.dwg

Rev	Description	By	Date	Rev	Description	By	Date	Drawn	Date	Client	Project Title	Drawing title	
A	SUBMISSION	RC	07/13					RL	07/13	路政署 <b>HIGHWAYS DEPARTMENT</b> 港珠澳大桥香港工程管理局 Hong Kong - Zhuhai - Macao Bridge Hong Kong Project Management Office	Contract No. HY/2012/07 Tuen Mun - Chek Lap Kok Link Southern Connection Viaduct Section	<b>Figure 1.2e</b>	
B	SUBMISSION	RC	07/13				Checked	Approved					
C	SUBMISSION	RC	09/13				DS	DOP					
								Scale					
								1:1000 @ A1 / 1:2000 @ A3	Supervising Officer		Contractor		Originator
								<b>AECOM</b>		<b>Gammon</b>		<b>ARUP</b>	
											Drawing no. J3518/P/OAP/04/01103	Rev. C	

DO NOT SCALE DRAWING. CHECK ALL DIMENSIONS ON SITE.

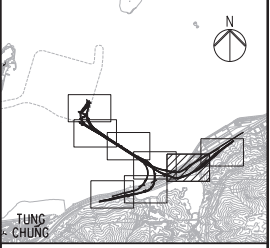
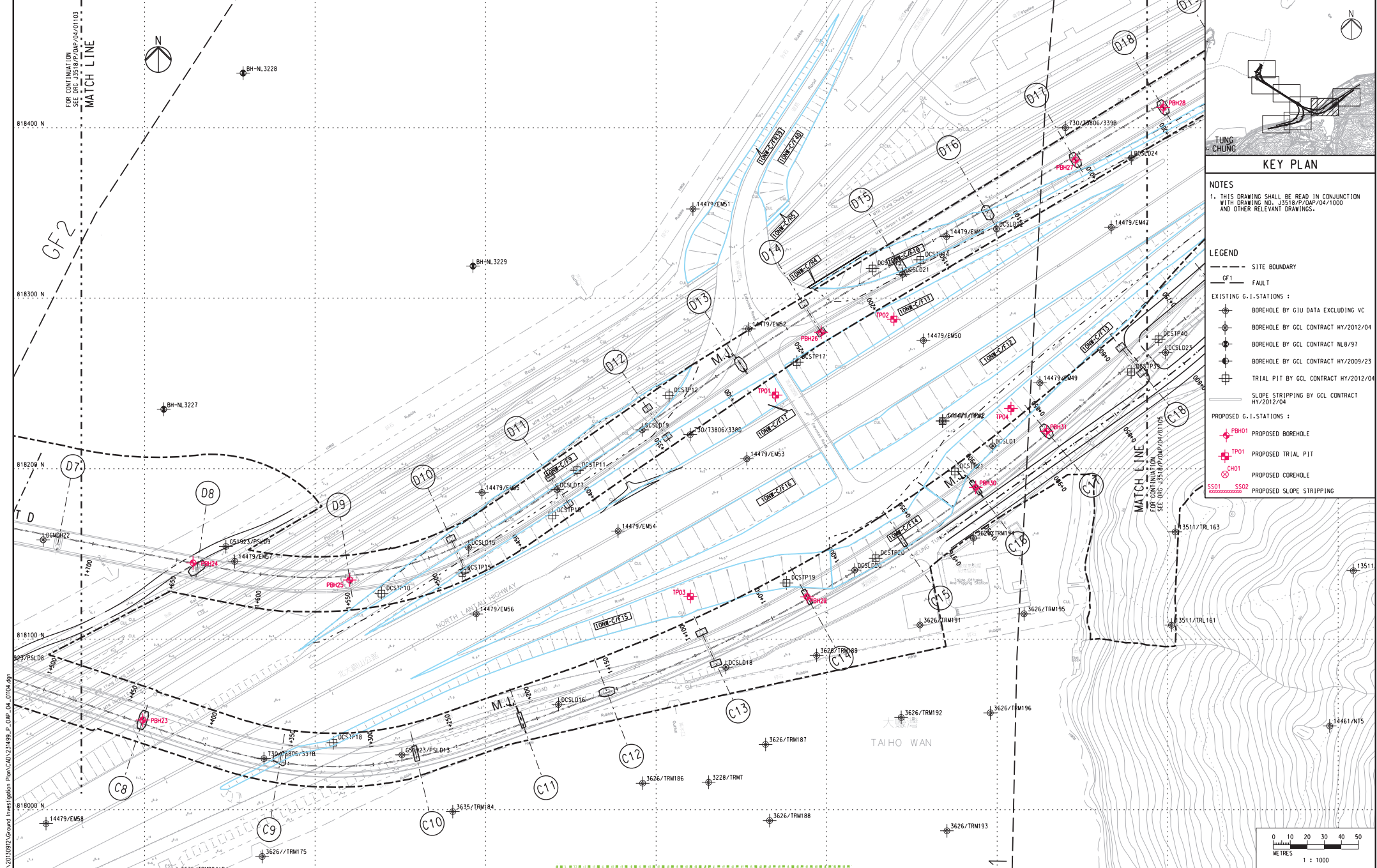

**KEY PLAN**

**NOTES**  
 1. THIS DRAWING SHALL BE READ IN CONJUNCTION WITH DRAWING NO. J3518/P/OAP/04/1000 AND OTHER RELEVANT DRAWINGS.

- LEGEND**
- SITE BOUNDARY
  - GF1- FAULT
  - EXISTING G.I. STATIONS :
    - ⊕ BOREHOLE BY GIU DATA EXCLUDING VC
    - ⊕ BOREHOLE BY GCL CONTRACT HY/2012/04
    - ⊕ BOREHOLE BY GCL CONTRACT NL6/97
    - ⊕ BOREHOLE BY GCL CONTRACT HY/2009/23
    - ⊕ TRIAL PIT BY GCL CONTRACT HY/2012/04
  - PROPOSED G.I. STATIONS :
    - ⊕ PBH01 PROPOSED BOREHOLE
    - ⊕ TP01 PROPOSED TRIAL PIT
    - ⊕ CH01 PROPOSED COREHOLE
    - SS01 SS02 PROPOSED SLOPE STRIPPING

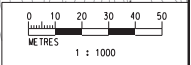

Rev	Description	By	Date	Rev	Description	By	Date
A	SUBMISSION	RC	07/13				
B	SUBMISSION	RC	07/13				
C	SUBMISSION	RC	09/13				

Checked	Approved
DS	DOP

Scale
1:1000 @ A1 / 1:2000 @ A3

Client

Supervising Officer

Project Title

Contract No. HY/2012/07  
 Tuen Mun - Chek Lap Kok Link  
 Southern Connection Viaduct Section

Contractor

Originator

Drawing title

# Figure 1.2f

Drawing no. J3518/P/OAP/04/01104 Rev. C

Printed by : 12/09/2013  
 File name : J:\3518\99\REC\000\20120927\Ground Investigation Plan\CAD\231498\_P\_OAP\_04\_01104.dwg



DO NOT SCALE DRAWING. CHECK ALL DIMENSIONS ON SITE.

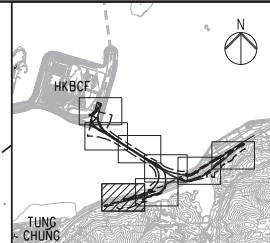
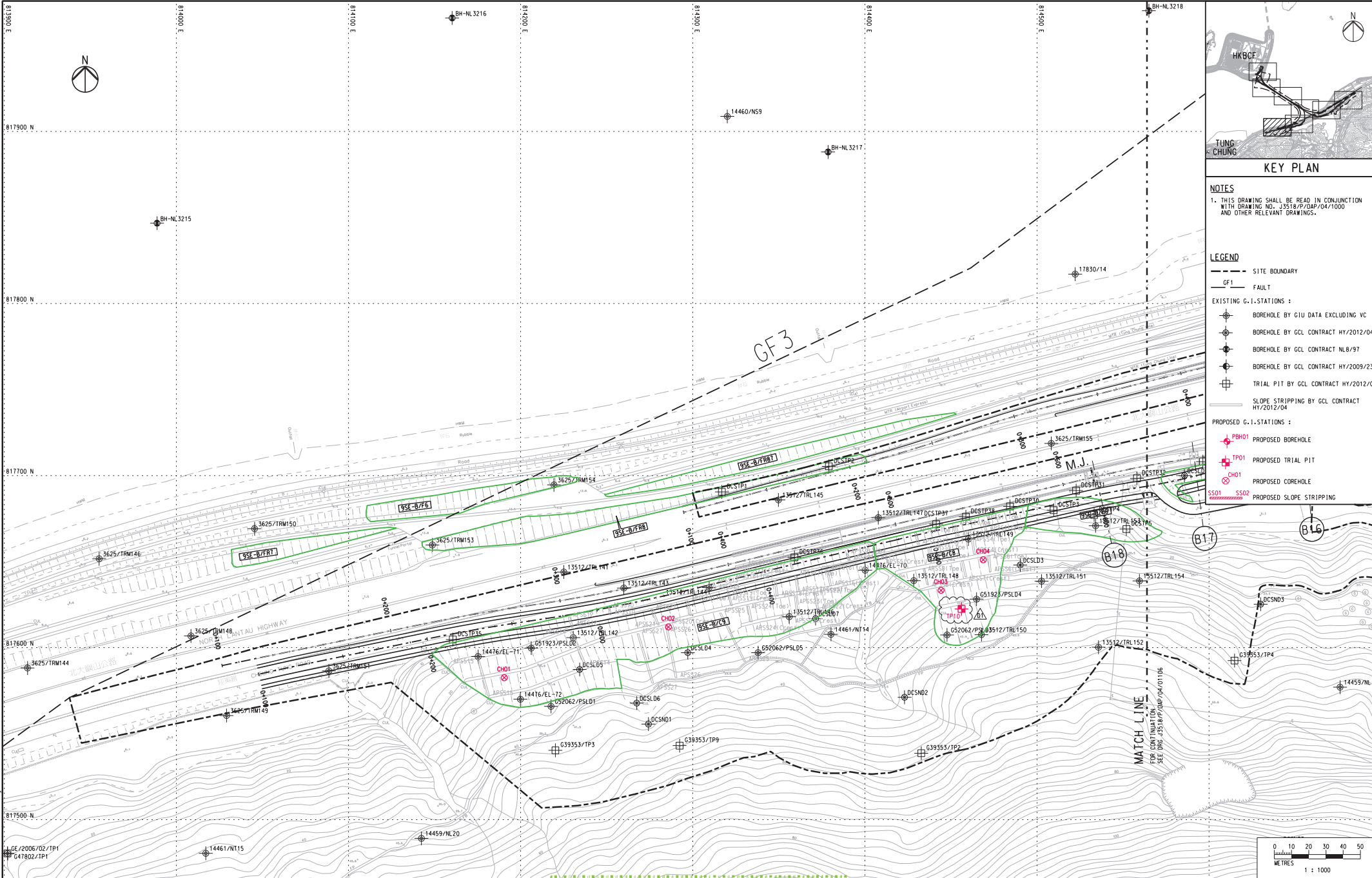

**KEY PLAN**

**NOTES**  
 1. THIS DRAWING SHALL BE READ IN CONJUNCTION WITH DRAWING NO. J3518/P/OAP/04/1000 AND OTHER RELEVANT DRAWINGS.

- LEGEND**
- SITE BOUNDARY
  - GF1 FAULT
  - EXISTING G.I. STATIONS:
    - ⊕ BOREHOLE BY GIU DATA EXCLUDING VC
    - ⊕ BOREHOLE BY GCL CONTRACT HY/2012/04
    - ⊕ BOREHOLE BY GCL CONTRACT NL6/97
    - ⊕ BOREHOLE BY GCL CONTRACT HY/2009/23
    - ⊕ TRIAL PIT BY GCL CONTRACT HY/2012/04
  - SLOPE STRIPPING BY GCL CONTRACT HY/2012/04
  - PROPOSED G.I. STATIONS:
    - ⊕ PBH01 PROPOSED BOREHOLE
    - ⊕ TP01 PROPOSED TRIAL PIT
    - ⊕ CH01 PROPOSED COREHOLE
    - SS01 SS02 PROPOSED SLOPE STRIPPING

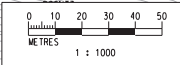

Printed by : 07/11/2013  
 File name : J:\3518\p\oap\04\1000\dwg

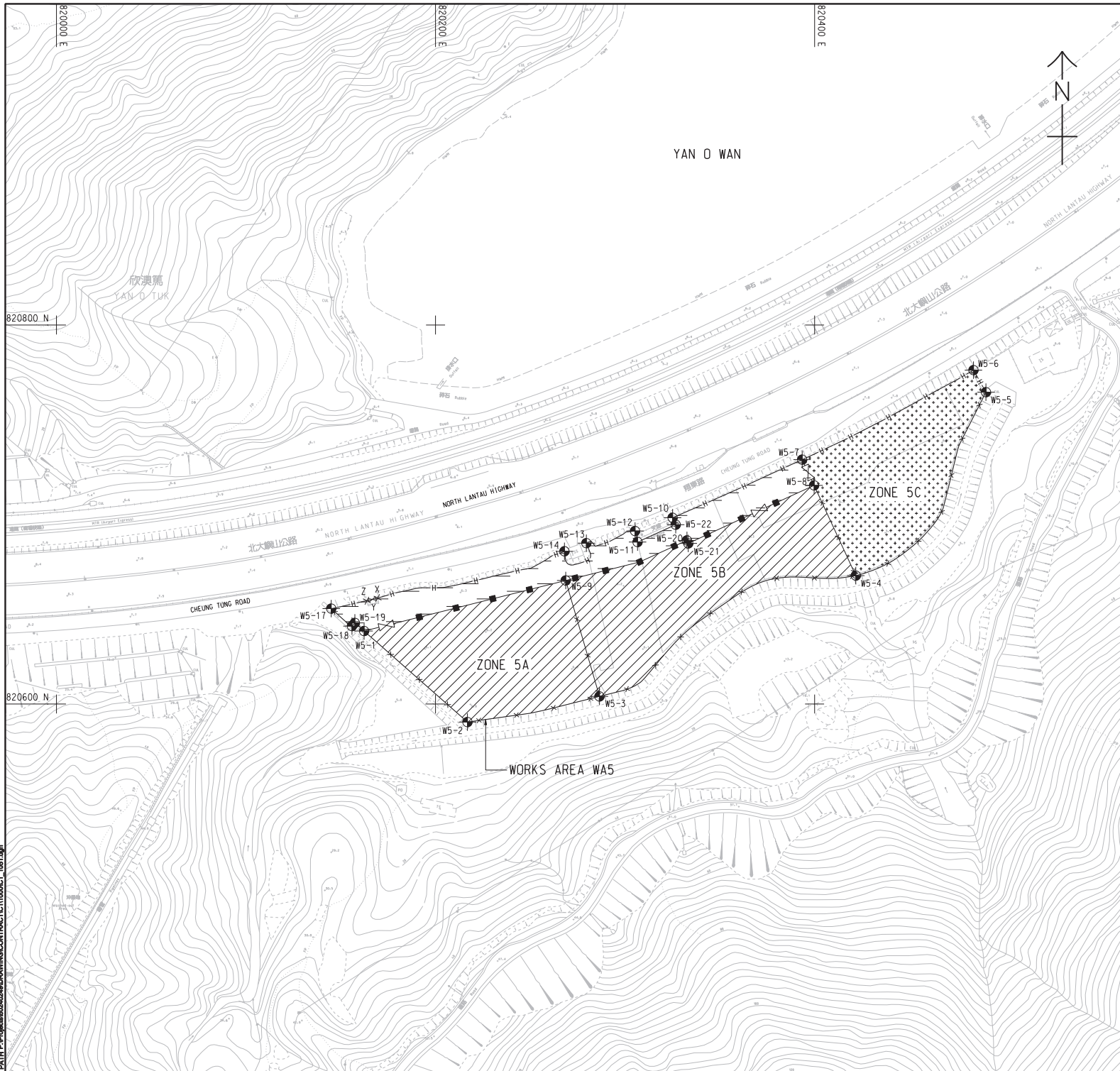

<table border="1" style="width: 100%; border-collapse: collapse;"> <thead> <tr> <th>Rev</th> <th>Description</th> <th>By</th> <th>Date</th> <th>Rev</th> <th>Description</th> <th>By</th> <th>Date</th> </tr> </thead> <tbody> <tr> <td>A</td> <td>SUBMISSION</td> <td>RC</td> <td>07/13</td> <td></td> <td></td> <td></td> <td></td> </tr> <tr> <td>B</td> <td>SUBMISSION</td> <td>RC</td> <td>07/13</td> <td></td> <td></td> <td></td> <td></td> </tr> <tr> <td>C</td> <td>SUBMISSION</td> <td>RC</td> <td>09/13</td> <td></td> <td></td> <td></td> <td></td> </tr> <tr> <td>D1</td> <td>FOR INTERNAL REVIEW</td> <td>RC</td> <td>11/13</td> <td></td> <td></td> <td></td> <td></td> </tr> </tbody> </table>	Rev	Description	By	Date	Rev	Description	By	Date	A	SUBMISSION	RC	07/13					B	SUBMISSION	RC	07/13					C	SUBMISSION	RC	09/13					D1	FOR INTERNAL REVIEW	RC	11/13					<table border="1" style="width: 100%; border-collapse: collapse;"> <thead> <tr> <th>Drawn</th> <th>Date</th> <th>Checked</th> <th>Approved</th> </tr> </thead> <tbody> <tr> <td>RL</td> <td>07/13</td> <td>DS</td> <td>DOP</td> </tr> </tbody> </table> <p>Scale 1:1000 @ A1 / 1:2000 @ A3</p>	Drawn	Date	Checked	Approved	RL	07/13	DS	DOP	<p>Client</p> <p>Supervising Officer</p>	<p>Project Title</p> <p>Contract No. HY/2012/07                  Tuen Mun - Chek Lap Kok Link                  Southern Connection Viaduct Section</p> <p>Contractor</p>	<p>Drawing title</p> <h2 style="margin: 0;">Figure 1.2g</h2> <p>Drawing no. J3518/P/OAP/04/01107 Rev. D1</p>
Rev	Description	By	Date	Rev	Description	By	Date																																													
A	SUBMISSION	RC	07/13																																																	
B	SUBMISSION	RC	07/13																																																	
C	SUBMISSION	RC	09/13																																																	
D1	FOR INTERNAL REVIEW	RC	11/13																																																	
Drawn	Date	Checked	Approved																																																	
RL	07/13	DS	DOP																																																	

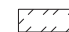

**NOTES:**

- THIS DRAWING SHALL BE READ IN CONJUNCTION WITH THE WORKS AREA KEY PLAN IN SHEET NO. 60240249/C1/1000.
- THE SETTING OUT INFORMATION AND WORKS AREA CONDITIONS SHOWN IN THIS DRAWING ARE FOR REFERENCE ONLY. THE WORKS AREA BOUNDARY SHALL BE IN ACCORDANCE WITH THE ENGINEERING CONDITIONS FOR TEMPORARY GOVERNMENT LAND ALLOCATION NO. T15 619. IN CASE OF DISCREPANCY BETWEEN THE BOUNDARY SHOWN ON THIS DRAWING AND THE BOUNDARY INDICATED ON THE ENGINEERING CONDITIONS, THE LATTER SHALL PREVAIL.
- DEMARCATION OF THE WORKS AREA SHALL BE DETERMINED ON SITE.
- REFER TO HIGHWAYS DEPARTMENT STANDARD DRAWING NOS. H6110 AND H6111 FOR DETAILS OF HOARDING.
- REFER TO HIGHWAYS DEPARTMENT STANDARD DRAWING NOS. H6121 AND H6122 FOR DETAILS OF CHAIN LINK FENCE.
- REFER TO HIGHWAYS DEPARTMENT STANDARD DRAWING NO. H6121 FOR DETAILS OF GATE.
- CHAIN LINK FENCE SHALL BE ERECTED ALONG THE WORKS AREA BOUNDARY. THE ALIGNMENT AND EXTENT OF CHAIN LINK FENCE SHOWN ARE INDICATIVE ONLY AND SHALL BE CONFIRMED BY THE SUPERVISING OFFICER.
- THE LOCATION AND WIDTH OF GATE SHOWN ARE INDICATIVE ONLY AND SHALL BE CONFIRMED BY THE SUPERVISING OFFICER.
- NO STRUCTURES SHALL BE ERECTED OTHER THAN SUCH STRUCTURES NOT EXCEEDING TWO STOREYS IN HEIGHT, WHICH ARE APPROVED BY THE DISTRICT LANDS OFFICER AS BEING APPROPRIATE FOR THE USE OF THE SITE AS A WORKS AREA.
- THE TENTATIVE OCCUPATION PERIOD SHALL BE REFERRED TO EMPLOYER'S REQUIREMENTS PART 2 AND PART 14 SECTION 1 CLAUSE 1.45A.
- THE WORKS AREAS SHOWN ON THIS DRAWING ARE TO BE SHARE-USED AMONG THE CONTRACTS OF TM-CLK RELATED CONTRACTS. THE AREAS HATCHED WITH  ARE TENTATIVELY ALLOCATED FOR THE USE OF THIS CONTRACT.
- THE COMMON AREA SHALL BE CONCRETE PAVED BY THE CONTRACTOR.

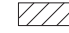
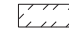
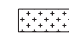
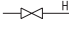
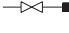
**LEGEND:**

-  WORKS AREA UNDER THIS CONTRACT
-  COMMON AREA (MAINTAINED UNDER THIS CONTRACT) TO BE SHARE-USED WITH OTHER CONTRACTS
-  WORKS AREA FOR THIS CONTRACT TO BE EARLY HANDED OVER BY THE CONTRACTOR.
-  HOARDING AND GATE (TO BE ERECTED AND MAINTAINED UNDER THIS CONTRACT)
-  CHAIN LINK FENCE AND GATE (TO BE ERECTED AND MAINTAINED BY OTHERS)
-  CHAIN LINK FENCE AND GATE (TO BE ERECTED AND MAINTAINED UNDER THIS CONTRACT)

**SETTING OUT COORDINATES OF WORKS AREA W5**

POINT	COORDINATES	
	EASTING	NORTHING
W5-1	820162.308	820638.492
W5-2	820216.839	820590.455
W5-3	820286.496	820603.985
W5-4	820421.757	820667.742
W5-5	820490.425	820764.554
W5-6	820483.839	820776.180
W5-7	820393.451	820728.958
W5-8	820399.746	820715.343
W5-9	820268.674	820665.173
W5-10	820325.075	820698.276
W5-11	820306.587	820685.458
W5-12	820305.269	820691.287
W5-13	820279.580	820684.863
W5-14	820268.027	820680.572
X	820169.407	820655.859
Y	820166.601	820655.172
Z	820163.794	820654.484
W5-17	820144.957	820650.334
W5-18	820155.899	820641.093
W5-19	820157.432	820642.788
W5-20	820332.642	820686.314
W5-21	820333.350	820684.738
W5-22	820326.723	820694.608

**ISSUE/REVISION**

NO.	DATE	DESCRIPTION	CHK.
1	OCT. 12	TENDER DRAWING	CWN

**STATUS**

SCALE	DIMENSION UNIT
A1:1000	METRES

**KEY PLAN**

**Figure 1.2h**

This drawing has been prepared for the use of the contractor. It may not be used, modified, reproduced or reissued without the prior written approval of AECOM. AECOM accepts no responsibility for any errors or omissions in this drawing. The contractor shall be responsible for the accuracy of the information provided in this drawing. AECOM shall not be held liable for any errors or omissions in this drawing.







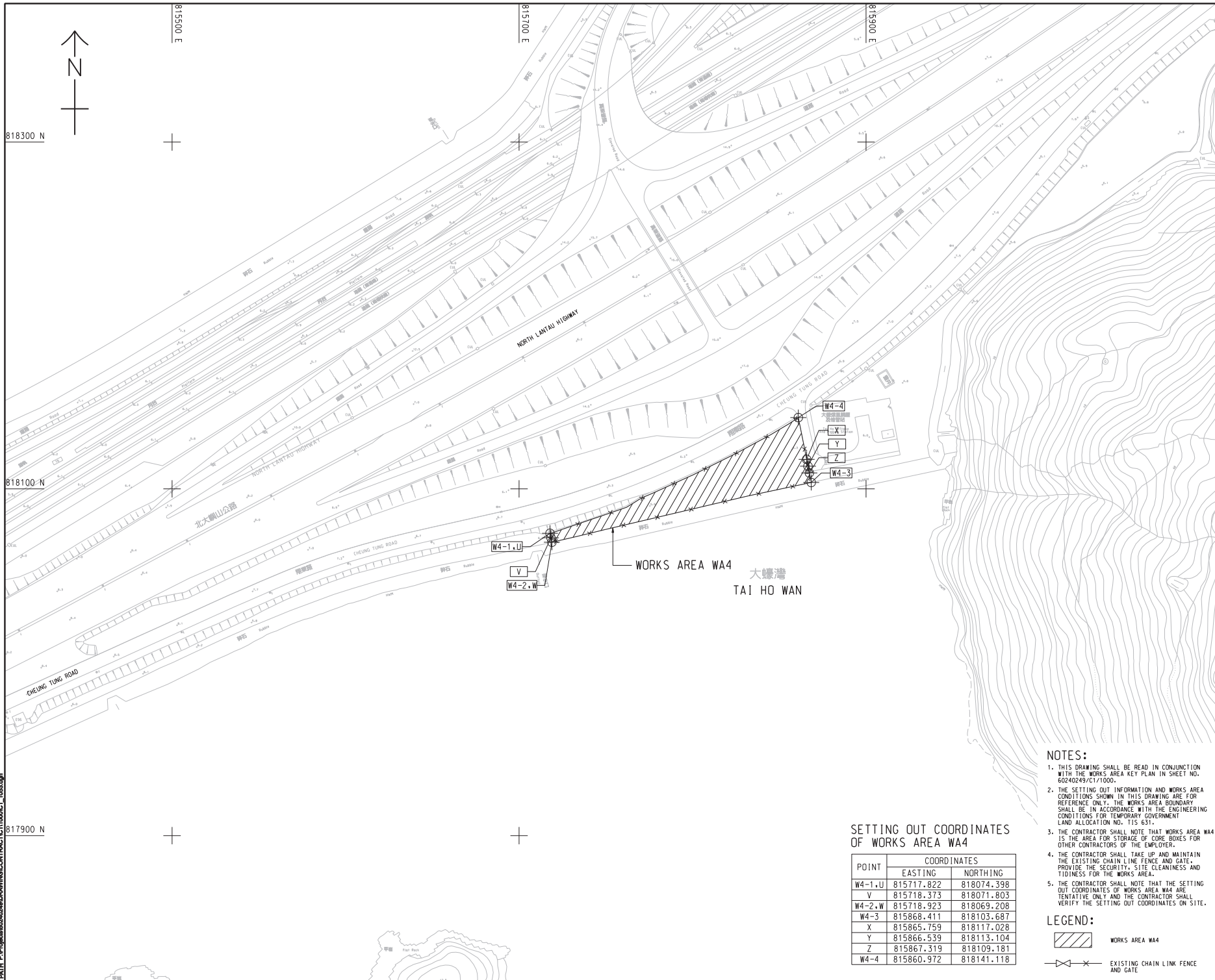

SETTING OUT COORDINATES OF WORKS AREA WA4

POINT	COORDINATES	
	EASTING	NORTHING
W4-1,U	815717.822	818074.398
V	815718.373	818071.803
W4-2,W	815718.923	818069.208
W4-3	815868.411	818103.687
X	815865.759	818117.028
Y	815866.539	818113.104
Z	815867.319	818109.181
W4-4	815860.972	818141.118

- NOTES:**
- THIS DRAWING SHALL BE READ IN CONJUNCTION WITH THE WORKS AREA KEY PLAN IN SHEET NO. 60240249/C1/100.
  - THE SETTING OUT INFORMATION AND WORKS AREA CONDITIONS SHOWN IN THIS DRAWING ARE FOR REFERENCE ONLY. THE WORKS AREA BOUNDARY SHALL BE IN ACCORDANCE WITH THE ENGINEERING CONDITIONS FOR TEMPORARY GOVERNMENT LAND ALLOCATION NO. T15 631.
  - THE CONTRACTOR SHALL NOTE THAT WORKS AREA WA4 IS THE AREA FOR STORAGE OF CORE BOXES FOR OTHER CONTRACTORS OF THE EMPLOYER.
  - THE CONTRACTOR SHALL TAKE UP AND MAINTAIN THE EXISTING CHAIN LINK FENCE AND GATE. PROVIDE THE SECURITY, SITE CLEANLINESS AND TIDINESS FOR THE WORKS AREA.
  - THE CONTRACTOR SHALL NOTE THAT THE SETTING OUT COORDINATES OF WORKS AREA WA4 ARE TENTATIVE ONLY AND THE CONTRACTOR SHALL VERIFY THE SETTING OUT COORDINATES ON SITE.

**LEGEND:**

WORKS AREA WA4

EXISTING CHAIN LINK FENCE AND GATE

**AECOM**

**PROJECT**  
 TUEN MUN - CHEK LAP KOK LINK

**CONTRACT TITLE**  
 TUEN MUN - CHEK LAP KOK LINK - SOUTHERN CONNECTION VIADUCT SECTION

**CLIENT**  
 路政署 HIGHWAYS DEPARTMENT  
 港務大樓管理工程處  
 Hong Kong + Zhuhai + Hainan Bridge  
 Hong Kong Project Management Office

**CONSULTANT**  
 AECOM Asia Company Ltd.  
 www.aecom.com

**SUB-CONSULTANTS**  
 2/11/2012/16

**Figure 1.2j**

**ISSUE/REVISION**

NO.	DATE	DESCRIPTION	CHK.
1	NOV. 12	TENDER ADDENDUM NO. 1	C/W

**SCALE**  
 A1 : 1:1000

**DIMENSION UNIT**  
 大呎  
 METRES

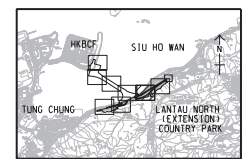

**PROJECT NO.**  
 60240249

**CONTRACT NO.**  
 HY/2012/07

**SHEET TITLE**  
 WORKS AREA WA4

**SHEET NUMBER**  
 60240249/C1/1053

This drawing has been prepared for the use of AECOM, except as may be otherwise approved by AECOM, and shall not be used for any other purpose without the written consent of AECOM. Do not scale this drawing. All measurements must be taken from the actual dimensions.

DO NOT SCALE DRAWING. CHECK ALL DIMENSIONS ON SITE.

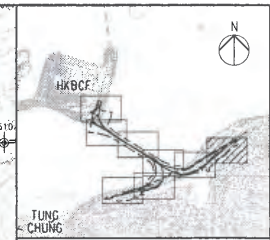
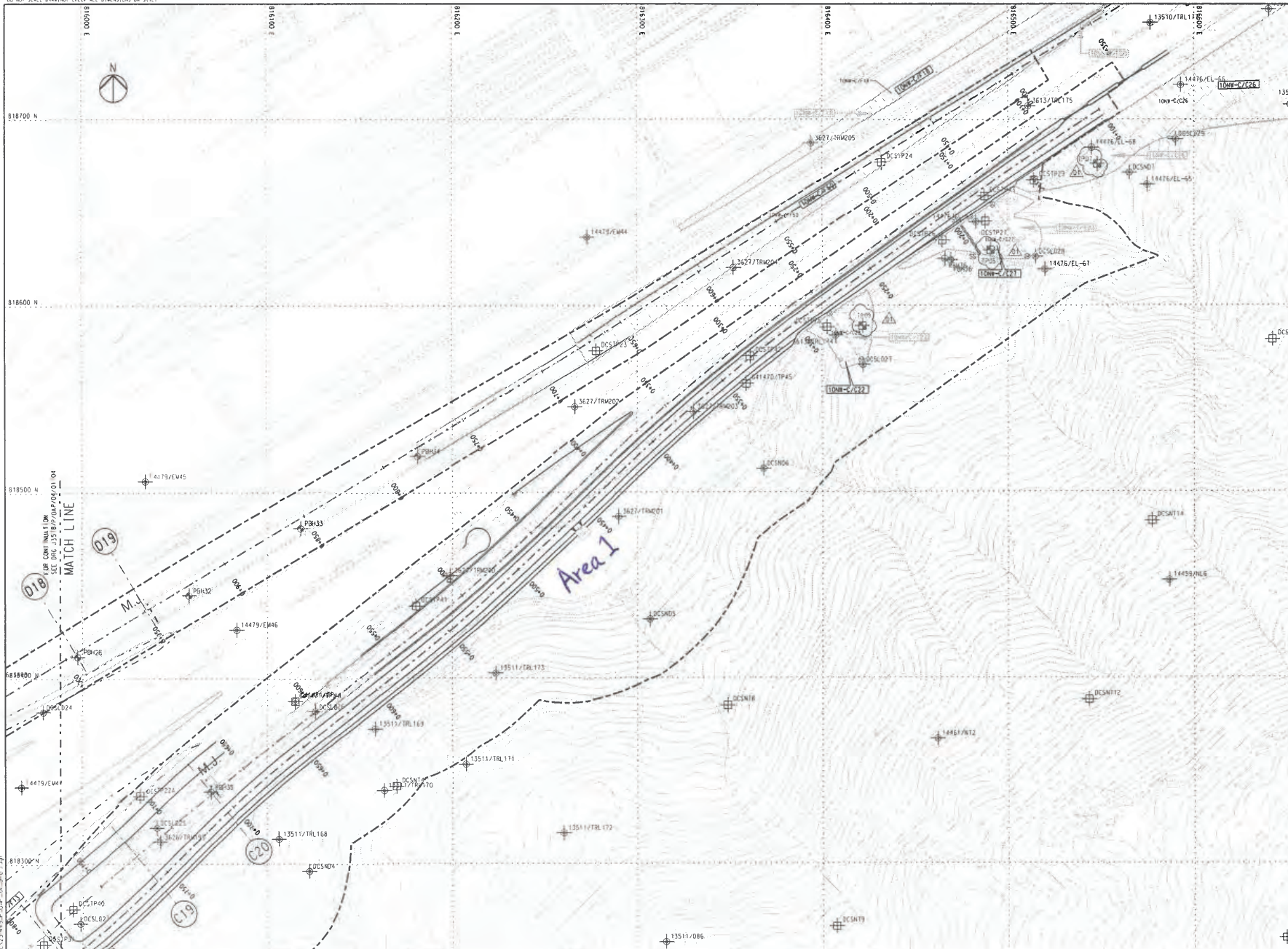

**NOTES**  
 THIS DRAWING SHALL BE READ IN CONJUNCTION WITH DRAWING NO. J3518/P/OAP/04/1000 AND OTHER RELEVANT DRAWINGS.

- LEGEND**
- SITE BOUNDARY
  - GF1 FAULT
- EXISTING G.I. STATIONS :
- ⊕ BOREHOLE BY GIU DATA EXCLUDING VC
  - ⊕ BOREHOLE BY GCL CONTRACT HY/2012/04
  - ⊕ BOREHOLE BY GCL CONTRACT N6.8/97
  - ⊕ BOREHOLE BY GCL CONTRACT HY/2009/23
  - ⊕ TRIAL PIT BY GCL CONTRACT HY/2012/04
  - ⊕ SLOPE STRIPPING BY GCL CONTRACT HY/2012/04
- PROPOSED G.I. STATIONS :
- ⊕ B-0 PROPOSED BOREHOLE
  - ⊕ T-0 PROPOSED TRIAL PIT
  - ⊕ C-01 PROPOSED COREHOLE
  - ⊕ S502 PROPOSED SLOPE STRIPPING

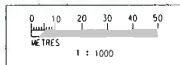

Rev	Description	By	Date	Rev	Description	By	Date
01	ISSUED FOR CONSTRUCTION	RL	31/7/13				
02	ISSUED FOR CONSTRUCTION	RL	27/7/13				
03	ISSUED FOR CONSTRUCTION	RL	29/7/13				
04	ISSUED FOR CONSTRUCTION	RL	19/7/12				

Drawn	Date	Client
RL	07/13	路政署 HIGHWAYS DEPARTMENT 港珠澳大桥香港工程指挥部 Hong Kong - Zhuhai - Macao Bridge Hong Kong Project Management Office
Checked	Approved	
DS	DOP	
Scale		

Scale: 1:1000 @ A1 / 1:2000 @ A3

	Project Title Contract No. HY/2012/07 Tuen Mun - Chek Lap Kok Link Southern Connection Viaduct Section
Supervising Officer <b>AECOM</b>	Contractor <b>Gammon</b>
Originator <b>ARUP</b>	

Drawing title  
**Figure 1.2k**

Drawing no. J3518/P/OAP/04/01105 Rev. D1

1:1000 @ A1 / 1:2000 @ A3  
 1:1000 @ A1 / 1:2000 @ A3





**Table 1.1**      **Contact Information of Key Personnel**

<b>Party</b>	<b>Position</b>	<b>Name</b>	<b>Telephone</b>	<b>Fax</b>
HyD (Highways Department)	Project Coordinator	Stanley Chan	2762 3406	3188 6614
	Senior Engineer	Steven Shum	2762 4133	3188 6614
SOR (AECOM Asia Company Limited)	Chief Resident Engineer	Daniel Ip	3553 3800	2492 2057
	Resident Engineer	Chan Wah Fu	2293 6434	3691 2899
ENPO / IEC (Ramboll Hong Kong Ltd.)	ENPO Leader	Y.H. Hui	3465 2850	3465 2899
	IEC	Dr. F.C. Tsang	3465 2851	3465 2899
Contractor (Gammon Construction Limited)	Environmental Officer	Roy Leung	3520 0387	3520 0486
	24-hour Complaint Hotline		9738 4332	
ET (ERM-HK)	ET Leader	Dr. Jasmine Ng	2271 3311	2723 5660

#### **1.4**      **SUMMARY OF CONSTRUCTION WORKS**

The construction phase of the Contract commenced on 31 October 2013. The three-month rolling construction programme is shown in Appendix B. The jetty removal works and reinstatement was hand over to *Contract No.: HY/2012/08 TMCLKL Northern Connection Sub-Sea Tunnel Section*.

As informed by the Contractor, no major works were carried out in the reporting month.

The Environmental Sensitive Receivers in the vicinity of the Project are shown in *Figure 1.3*.

The environmental mitigation measures implementation schedule is presented in Appendix C.





## 2 *EM&A RESULTS*

The EM&A programme required environmental monitoring for air quality, noise, water quality and marine ecology as well as environmental site inspections for air quality, noise, water quality, waste management, marine ecology and landscape and visual impacts. The EM&A requirements and related findings for each component are summarized in the following sections.

### 2.1 *AIR QUALITY*

No air quality monitoring was scheduled for the reporting month as construction works was substantially completed on 31 July 2019. Notification of temporary suspension of air quality monitoring has been approved by EPD on 28 August 2019.

Termination proposal for construction EM&A programme was approved by EPD on 16 March 2020. The construction phase EM&A programme of the Contract has been terminated since 16 March 2020. No construction air quality monitoring programme was undertaken in the reporting period.

### 2.2 *NOISE MONITORING*

No noise monitoring was scheduled for the reporting month as construction works was substantially completed on 31 July 2019. Notification of temporary suspension of noise monitoring has been approved by EPD on 28 August 2019.

Termination proposal for construction EM&A programme was approved by EPD on 16 March 2020. The construction phase EM&A programme of the Contract has been terminated since 16 March 2020. No construction noise monitoring programme was undertaken in the reporting period.

### 2.3 *WATER QUALITY MONITORING*

Post-construction water quality monitoring was completed on 23 December 2019.

### 2.4 *DOLPHIN MONITORING*

Termination proposal for construction EM&A programme was approved by EPD on 16 March 2020. The construction phase EM&A programme of the Contract has been terminated since 16 March 2020. No dolphin impact monitoring programme was undertaken in the reporting period.

### 2.4.1 *Marine Mammal Exclusion Zone Monitoring*

No marine works were undertaken during the reporting period, therefore, daily 250 m marine mammal exclusion zone monitoring was not undertaken during the reporting period.

Passive Acoustic Monitoring (PAM) had been decommissioned as no marine piling works was carried out outside the daylight hours since September 2015.

### 2.5 *EM&A SITE INSPECTION*

Site inspections were carried out on a weekly basis to monitor the implementation of proper environmental pollution control and mitigation measures under the Contract. In the reporting month, two (2) site inspections were carried out on 2 and 13 March 2020.

Key observations during the site inspections are summarized in *Table 2.1*.

**Table 2.1** *Specific Observations Identified during the Weekly Site Inspections in this Reporting Month*

<b>Inspection Date</b>	<b>Environmental Observations</b>	<b>Recommendations/ Remarks</b>
2 March 2020	Viaduct C • Nil.	Viaduct C • Nil.
13 March 2020	Viaduct D • Nil.	Viaduct D • Nil.

No particular observations were identified during environmental site inspections in the reporting month.

Termination proposal for construction EM&A programme was approved by EPD on 16 March 2020. The construction phase EM&A programme of the Contract has been terminated since 16 March 2020. No weekly site audit was undertaken since 16 March 2020.

### 2.6 *WASTE MANAGEMENT STATUS*

The Contractor has submitted application form for registration as chemical waste producer under the Contract. Sufficient numbers of receptacles were available for general refuse collection and sorting.

Wastes generated during this reporting period include mainly construction wastes (inert and non-inert) and recyclable materials. Reference has been made to the waste flow table prepared by the Contractor (*Appendix D*). The quantities of different types of wastes are summarized in *Table 2.2*.

**Table 2.2 Quantities of Different Waste Generated in the Reporting Period**

Month/ Year	Inert C&D Materials <sup>(a)</sup> (m <sup>3</sup> )	Imported Fill (m <sup>3</sup> )	Inert Constructio n Waste Re- used (m <sup>3</sup> )	Non-inert Constructio n Waste <sup>(b)</sup> (kg)	Recyclable Materials <sup>(c)</sup> (kg)	Chemical Wastes (kg)	Marine Sediment (m <sup>3</sup> )		
							Category L	Category M (M <sub>p</sub> & M <sub>f</sub> )	Category H
March 2020	38	0	0	0	0	0	0	0	0

**Notes:**

- (a) Inert construction wastes include hard rock and large broken concrete, and materials disposed as public fill.
- (b) Non-inert construction wastes include general refuse disposed at landfill.
- (c) Recyclable materials include metals, paper, cardboard, plastics, timber, felled trees and others.

The Contractor was advised to properly maintain on site C&D materials and waste collection, sorting and recording system, dispose of C&D materials and wastes at designated ground and maximize reuse/ recycle of C&D materials and wastes. The Contractor was also reminded to properly maintain the site tidiness and dispose of the wastes accumulated on site regularly and properly.

For chemical waste containers, the Contractor was reminded to treat properly and store temporarily in designated chemical waste storage area on site in accordance with the *Code of Practice on the Packaging, Labelling and Storage of Chemical Wastes*.

**2.7 ENVIRONMENTAL LICENSES AND PERMITS**

The status of environmental licensing and permit is summarized in *Table 2.3* below.

**Table 2.3 Summary of Environmental Licensing and Permit Status**

License/ Permit	License or Permit No.	Date of Issue	Date of Expiry	License/ Permit Holder	Remarks
Environmental Permit	EP-354/2009/D	13 Mar 2015	N/A	HyD	Tuen Mun- Chek Lap Kok Link
Environmental Permit	EP-353/2009/K	11 Apr 2016	N/A	HyD	Hong Kong Boundary Crossing Facilities
Construction Dust Notification	361571	5 Jul 2013	N/A	GCL	
Construction Dust Notification	362093	17 Jul 2013	N/A	GCL	For Area 23
Chemical Waste Registration	5213-961-G2380-13	10 Oct 2013	N/A	GCL	Chemical waste produced in Contract No. HY/2012/07 (Area 1 adjacent to Cheng Tung Road, Siu Ho Wan)
Chemical Waste Registration	5213-961-G2380-14	10 Oct 2013	N/A	GCL	Chemical waste produced in Contract No. HY/2012/07 (Area 2 adjacent to Cheung Tung Road, Pak Mong Village)
Chemical Waste Registration	5213-974-G2588-03	4 Nov 2013	N/A	GCL	Chemical waste produced in Contract No. HY/2012/07 (WA5 adjacent to Cheung Tung Road, Yam O)
Chemical Waste Registration	5213-951-G2380-17	12 Jun 2014	N/A	GCL	Viaducts A, B, C, D & E
Construction Waste Disposal Account	7017735	10 Jul 2013	N/A	GCL	-
Construction Waste Disposal Account	7019470	3 Mar 2014	N/A	GCL	Vessel CHIT Account
Construction Noise Permit for night works and works in general holidays	GW-RS1108-19	12 December 2019	11 June 2020	GCL	Broad Permit for Whole Site Areas
Construction Noise Permit for night works and works in general holidays	GW-RW0592-19	18 December 2019	13 June 2020	GCL	General works at WA5
Construction Noise Permit for night works and works in general holidays	GW-RS0153-20	19 March 2020	31 March 2020	GCL	Defect Repairing at under-bridge of Viaduct B and C

## 2.8 ***IMPLEMENTATION STATUS OF ENVIRONMENTAL MITIGATION MEASURES***

In response to the site audit findings, the Contractors carried out corrective actions.

A summary of the Implementation Schedule of Environmental Mitigation Measures (EMIS) is presented in *Appendix C*. The necessary mitigation measures were implemented properly for this Contract.

The landscape and visual (L&V) mitigation measures were also monitored on weekly basis in the reporting period. The monitoring status is summarized in *Appendix C*.

## 2.9 ***SUMMARY OF EXCEEDANCES OF THE ENVIRONMENTAL QUALITY PERFORMANCE LIMIT***

Post-construction water quality monitoring was completed on 23 December 2019.

No air quality, noise and dolphin impact monitoring was conducted in the reporting period.

Cumulative statistics on exceedances is provided in *Appendix E*.

## 2.10 ***SUMMARY OF COMPLAINTS, NOTIFICATION OF SUMMONS AND SUCCESSFUL PROSECUTIONS***

The Environmental Complaint Handling Procedure is provided in *Figure 2.1*.

There was no environmental complaint, notification of summons or successful prosecution recorded in the reporting period.

Statistics on complaints, notifications of summons, successful prosecutions are summarized in *Appendix E*.

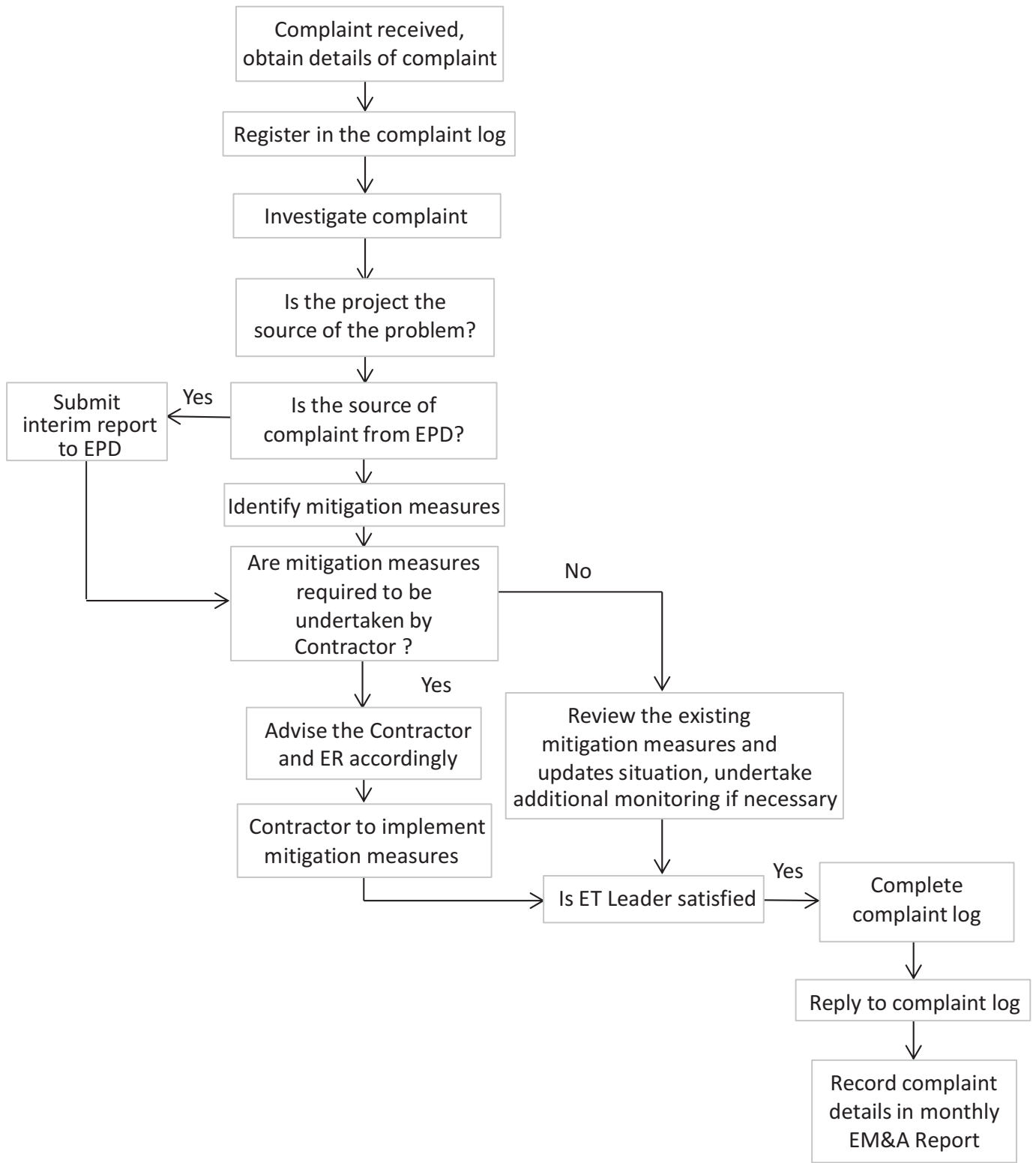

Figure 2.1

Environmental Complaint Handling Procedure

FILE: 0215660n2.cdr  
DATE: 06/12/2013

Environmental  
Resources  
Management



### 3 *FUTURE KEY ISSUES*

#### 3.1 *CONSTRUCTION PROGRAMME FOR THE COMING MONTH*

As informed by the Contractor, there are no major works to be undertaken in April 2020.

#### 3.2 *KEY ISSUES FOR THE COMING MONTH*

As informed by the Contractor, there are no major works to be undertaken in April 2020.

#### 3.3 *MONITORING SCHEDULE FOR THE COMING MONTH*

Termination proposal for construction EM&A programme was approved by EPD on 16 March 2020. The construction phase EM&A programme of the Contract has been terminated since 16 March 2020.

## 4 CONCLUSIONS AND RECOMMENDATIONS

### 4.1 CONCLUSIONS

This Seventy-seventh Monthly EM&A Report presents the findings of the EM&A activities undertaken during the period from 1 to 16 March 2020 in accordance with the Updated EM&A Manual and the requirements of the Environmental Permits (*EP-354/2009/D* and *EP-353/2009/K*).

No Air quality (1-hour TSP and 24-hour TSP), noise and dolphin monitoring were carried out in the reporting month. Post-construction water quality monitoring (DO, turbidity and SS) was completed on 23 December 2019.

Environmental site inspections were carried out two (2) times in March 2020. Recommendations on remedial actions were given to the Contractor for the deficiencies identified during the site audits.

There was no environmental complaint, notification of summons or successful prosecution recorded in the reporting period.

Termination proposal for construction EM&A programme was approved by EPD on 16 March 2020. The construction phase EM&A programme of the Contract has been terminated since 16 March 2020.



Appendix A

## Project Organization for Environmental Works

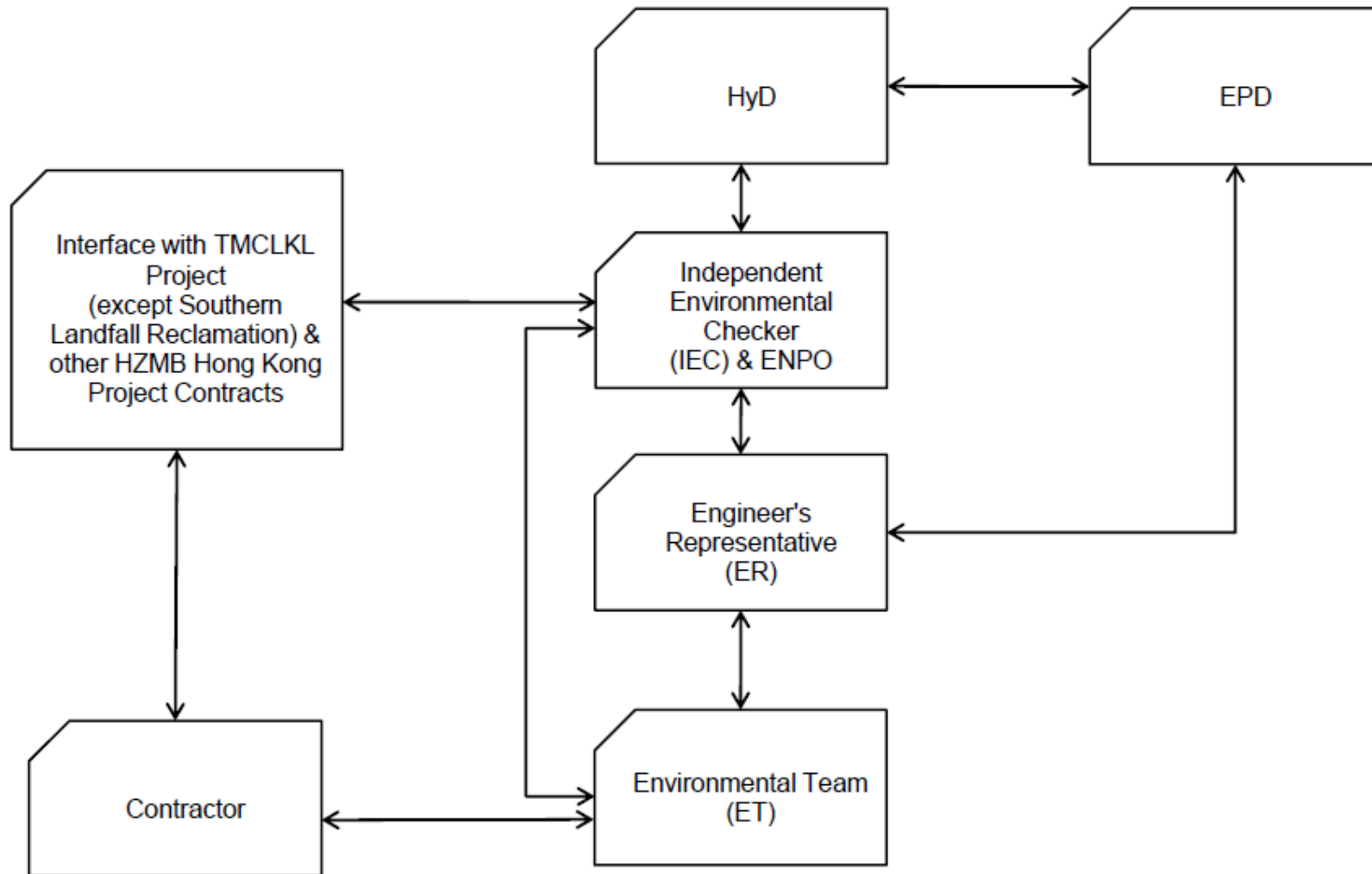

↔ Line of Communication

Appendix B

## Three-Month Rolling Construction Programme





Appendix C

# Environmental Mitigation and Enhancement Measure Implementation Schedules

(In reference to CINOTECH (2011) Agreement No.  
CE35/2011 EP Baseline Environmental Monitoring for  
Hong Kong-Zhuhai-Macao Bridge Tuen Mun-Chek Lap  
Kok Link - Investigation. Updated EM&A Manual for  
Tuen Mun-Chek Lap Kok Link)

*Contract No. HY/2012/07  
Tuen Mun – Chek Lap Kok Link  
Southern Connection Viaduct Section  
Environmental Mitigation and Enhancement Measure Implementation Schedule*

EIA Reference	EM&A Manual Reference	Environmental Protection Measures	Location/ Timing	Implementation Agent	Relevant Standard or Requirement	Implementation Stages			Status
						D	C	O	
<b>AIR QUALITY</b>									
4.8.1	3.8	An effective watering programme of eight daily watering with complete coverage, is estimated to reduce by 50%. This is recommended for all areas in order to reduce dust levels to a minimum;	All areas / throughout construction period	Contractor	TMEIA Avoid smoke impacts and disturbance		Y		n/a
4.8.1	3.8	The Contractor shall, to the satisfaction of the Engineer, install effective dust suppression measures and take such other measures as may be necessary to ensure that at the Site boundary and any nearby sensitive receiver, dust levels are kept to acceptable levels.	All areas / throughout construction period	Contractor	TMEIA Avoid dust generation		Y		n/a
4.8.1	3.8	The Contractor shall not burn debris or other materials on the works areas.	All areas / throughout construction period	Contractor	TMEIA Avoid dust generation		Y		n/a
4.8.1	3.8	In hot, dry or windy weather, the watering programme shall maintain all exposed road surfaces and dust sources wet.	All unpaved haul roads / throughout construction period in hot, dry or windy weather	Contractor	TMEIA Avoid smoke impacts and disturbance		Y		n/a
4.8.1	3.8	Where breaking of oversize rock/concrete is required, watering shall be implemented to control dust. Water spray shall be used during the handling of fill material at the site and at active cuts, excavation and fill sites where dust is likely to be created.	All areas / throughout construction period	Contractor	TMEIA Avoid dust generation		Y		n/a
4.8.1	3.8	Open dropping heights for excavated materials shall be controlled to a maximum height of 2m to minimise the fugitive dust arising from unloading.	All areas / throughout construction period	Contractor	TMEIA Avoid dust generation		Y		n/a
4.8.1	3.8	During transportation by truck, materials shall not be loaded to a level higher than the side and tail boards, and shall be dampened or covered before transport.	All areas / throughout construction period	Contractor	TMEIA Avoid dust generation		Y		n/a

EIA Reference	EM&A Manual Reference	Environmental Protection Measures	Location/ Timing	Implementation Agent	Relevant Standard or Requirement	Implementation Stages			Status
						D	C	O	
4.8.1	3.8	Materials having the potential to create dust shall not be loaded to a level higher than the side and tail boards, and shall be covered by a clean tarpaulin. The tarpaulin shall be properly secured and shall extend at least 300mm over the edges of the side and tail boards.	All areas / throughout construction period	Contractor	TMEIA Avoid dust generation		Y		n/a
4.8.1	3.8	No earth, mud, debris, dust and the like shall be deposited on public roads. Wheel washing facility shall be usable prior to any earthworks excavation activity on the site.	All site exits / throughout construction period	Contractor	TMEIA Avoid dust		Y		n/a
4.8.1	3.8	Areas of exposed soil shall be minimised to areas in which works have been completed shall be restored as soon as is practicable.	All exposed surfaces / throughout construction period	Contractor	TMEIA Avoid dust generation		Y		n/a
4.8.1	3.8	All stockpiles of aggregate or spoil shall be enclosed or covered and water applied in dry or windy condition.	All areas / throughout construction period	Contractor	TMEIA Avoid dust generation		Y		n/a
4.11	Section 3	EM&A in the form of 1 hour and 24 hour dust monitoring and site audit	All representative existing ASRs / throughout construction period	Contractor	EM&A Manual		Y		n/a
<b>NOISE</b>									
5.11	Section 4	Noise monitoring	All existing representative sensitive receivers / during North Lantau Viaduct construction	Contractor	EM&A Manual		Y		n/a
<b>WATER QUALITY</b>									
<i>General Marine Works</i>									
6.10	-	Bored piling to be undertaken within a metal casing.	Marine viaducts of TM-CLKL and HKLR/ bored piling	Contractor	TM-EIAO		Y		Marine works under this Contract were completed.
6.10	-	Barges and hopper dredgers shall have tight fitting seals to their bottom openings to prevent leakage of material.	All areas/ throughout construction period	Contractor	Marine Fill Committee Guidelines. DASO permit conditions.		Y		



EIA Reference	EM&A Manual Reference	Environmental Protection Measures	Location/ Timing	Implementation Agent	Relevant Standard or Requirement	Implementation Stages			Status
						D	C	O	
6.10	-	Any pipe leakages shall be repaired quickly. Plant should not be operated with leaking pipes.	All areas/ throughout construction period	Contractor	Marine Fill Committee Guidelines. DASO permit conditions.		Y		Marine works under this Contract were completed.
6.10	-	Loading of barges and hoppers shall be controlled to prevent splashing of dredged material to the surrounding water. Barges or hoppers shall not be filled to a level which will cause overflow of materials or pollution of water during loading or transportation.	All areas/ throughout construction period	Contractor	Marine Fill Committee Guidelines. DASO permit conditions.		Y		
6.10	-	Excess material shall be cleaned from the decks and exposed fittings of barges and hopper dredgers before the vessel is moved	All areas/ throughout construction period	Contractor	Marine Fill Committee Guidelines. DASO permit conditions.		Y		
6.10	-	Adequate freeboard shall be maintained on barges to reduce the likelihood of decks being washed by wave action;	All areas/ throughout construction period	Contractor	Marine Fill Committee Guidelines. DASO permit conditions.		Y		
6.10	-	All vessels shall be sized such that adequate clearance is maintained between vessels and the sea bed at all states of the tide to ensure that undue turbidity is not generated by turbulence from vessel movement or propeller wash.	All areas/ throughout construction period	Contractor	Marine Fill Committee Guidelines. DASO permit conditions.		Y		
6.10	-	The works shall not cause foam, oil, grease, litter or other objectionable matter to be present in the water within and adjacent to the works site.	All areas/ throughout construction period	Contractor	Marine Fill Committee Guidelines. DASO permit conditions.		Y		
<i>Temporary Staging work</i>									
	5.2	Regular inspection for the accumulation of floating refuse and collection of floating refuse if required	During temporary staging works	Contractor			Y		Marine works under this Contract were completed.
	5.2	Provision of temporary drainage system on the temporary staging for collection of construction site runoff to allow appropriate treatment before discharge into the sea	During temporary staging works	Contractor			Y		
	5.2	Wastewater generated from construction works such as bored / drilling water will be collected, treated, neutralized and de-silted through silt trap or sedimentation tank before disposal	During temporary staging works	Contractor			Y		

EIA Reference	EM&A Manual Reference	Environmental Protection Measures	Location/ Timing	Implementation Agent	Relevant Standard or Requirement	Implementation Stages			Status
						D	C	O	
	5.2	One additional water quality monitoring station is proposed at station SR4a. In case elevated SS or turbidity is identified during the water quality monitoring, the source of pollution will be tracked down and be removed as soon as possible. In case depletion of dissolved oxygen is identified, artificial aeration will be arranged at the monitoring station SR4a,	During temporary staging works	Contractor			Y		Marine works under this Contract were completed.
<i>Land Works</i>									
6.10	-	Wastewater from temporary site facilities should be controlled to prevent direct discharge to surface or marine waters.	All areas/ throughout construction period	Contractor	TM-EIAO		Y		✓
6.10	-	Sewage effluent and discharges from on-site kitchen facilities shall be directed to Government sewer in accordance with the requirements of the WPCO or collected for disposal offsite. The use of soakaways shall be avoided.	All areas/ throughout construction period	Contractor	TM-EIAO		Y		✓
6.10	-	Storm drainage shall be directed to storm drains via adequately designed sand/silt removal facilities such as sand traps, silt traps and sediment basins. Channels, earth bunds or sand bag barriers should be provided on site to properly direct stormwater to such silt removal facilities. Catchpits and perimeter channels should be constructed in advance of site formation works and earthworks.	All areas/ throughout construction period	Contractor	TM-EIAO		Y		✓
6.10	-	Silt removal facilities, channels and manholes shall be maintained and any deposited silt and grit shall be removed regularly, including specifically at the onset of and after each rainstorm.	All areas/ throughout construction period	Contractor	TM-EIAO		Y		✓
6.10	-	Temporary access roads should be surfaced with crushed stone or gravel.	All areas/ throughout construction period	Contractor	TM-EIAO		Y		✓
6.10	-	Rainwater pumped out from trenches or foundation excavations should be discharged into storm drains via silt removal facilities.	All areas/ throughout construction period	Contractor	TM-EIAO		Y		✓
6.10	-	Measures should be taken to prevent the washout of construction materials, soil, silt or debris into any drainage system.	All areas/ throughout construction period	Contractor	TM-EIAO		Y		✓

EIA Reference	EM&A Manual Reference	Environmental Protection Measures	Location/ Timing	Implementation Agent	Relevant Standard or Requirement	Implementation Stages			Status
						D	C	O	
6.10	-	Open stockpiles of construction materials (e.g. aggregates and sand) on site should be covered with tarpaulin or similar fabric during rainstorms.	All areas/ throughout construction period	Contractor	TM-EIAO		Y		✓
6.10	5.8	Manholes (including any newly constructed ones) should always be adequately covered and temporarily sealed so as to prevent silt, construction materials or debris from getting into the drainage system, and to prevent storm run-off from getting into foul sewers.	All areas/ throughout construction period	Contractor	TM-EIAO		Y		✓
6.10	-	Discharges of surface run-off into foul sewers must always be prevented in order not to unduly overload the foul sewerage system.	All areas/ throughout construction period	Contractor	TM-EIAO		Y		✓
6.10	-	All vehicles and plant should be cleaned before they leave the construction site to ensure that no earth, mud or debris is deposited by them on roads. A wheel washing bay should be provided at every site exit.	All areas/ throughout construction period	Contractor	TM-EIAO		Y		✓
6.10	-	Wheel wash overflow shall be directed to silt removal facilities before being discharged to the storm drain.	All areas/ throughout construction period	Contractor	TM-EIAO		Y		✓
6.10	-	Section of construction road between the wheel washing bay and the public road should be surfaced with crushed stone or coarse gravel.	All areas/ throughout construction period	Contractor	TM-EIAO		Y		✓
6.10	-	Wastewater generated from concreting, plastering, internal decoration, cleaning work and other similar activities, shall be screened to remove large objects.	All areas/ throughout construction period	Contractor	TM-EIAO		Y		✓
6.10	-	Vehicle and plant servicing areas, vehicle wash bays and lubrication facilities shall be located under roofed areas. The drainage in these covered areas shall be connected to foul sewers via a petrol interceptor in accordance with the requirements of the WPCO or collected for offsite disposal.	All areas/ throughout construction period	Contractor	TM-EIAO		Y		✓
6.10	-	The Contractor shall prepare an oil / chemical cleanup plan and ensure that leakages or spillages are contained and cleaned up immediately.	All areas/ throughout construction period	Contractor	TM-EIAO		Y		✓
6.10	-	Waste oil should be collected and stored for recycling or disposal, in accordance with the Waste Disposal Ordinance.	All areas/ throughout construction period	Contractor	TM-EIAO Waste Disposal Ordinance		Y		✓

EIA Reference	EM&A Manual Reference	Environmental Protection Measures	Location/ Timing	Implementation Agent	Relevant Standard or Requirement	Implementation Stages			Status
						D	C	O	
6.10	-	All fuel tanks and chemical storage areas should be provided with locks and be sited on sealed areas. The storage areas should be surrounded by bunds with a capacity equal to 110% of the storage capacity of the largest tank.	All areas/ throughout construction period	Contractor	TM-EIAO		Y		✓
6.10	-	Surface run-off from bunded areas should pass through oil/grease traps prior to discharge to the stormwater system.	All areas/ throughout construction period	Contractor	TM-EIAO		Y		✓
6.10	-	Roadside gullies to trap silt and grit shall be provided prior to discharging the stormwater into the marine environment. The sumps will be maintained and cleaned at regular intervals.	Roadside/design and operation	Design Consultant/ Contractor	TM-EIAO	Y		Y	✓
6.10	Section 5	All construction works shall be subject to routine audit to ensure implementation of all EIA recommendations and good working practice.	All areas/ throughout construction period	Contractor	EM&A Manual		Y		✓
<i>Water Quality Monitoring</i>									
6.10	Section 5	Water quality monitoring shall be undertaken for suspended solids, turbidity, and dissolved oxygen. Nutrients and metal parameters shall also be measured for Mf sediment operations (only HKBCF and HKLR required handling of Mf sediment) during baseline, backfilling and post construction period. One year operation phase water quality monitoring at designated stations	Designated monitoring stations as defined in EM&A Manual, Section 5/ Before, through-out marine construction period, post construction and monthly operational phase water quality monitoring for a year.	Contractor	EM&A Manual		Y	Y	Post construction period for water quality monitoring was completed on 23 December 2019.
<b>ECOLOGY</b>									
8.14	6.3	Specification for and implement pre, during and post construction dolphin abundance monitoring.	All Areas/Detailed Design/ during construction works/post construction	Design Consultant/ Contractor	TMEIA	Y	Y	Y	n/a
8.14	6.3	Specification for bored piling monitoring	Detailed Design	Design Consultant	TMEIA	Y			n/a
8.14	6.3	Implement any recommendations of the bored piling	Southern marine	Contractor	TMEIA		Y		n/a

EIA Reference	EM&A Manual Reference	Environmental Protection Measures	Location/ Timing	Implementation Agent	Relevant Standard or Requirement	Implementation Stages			Status
						D	C	O	
		monitoring	viaduct/Throughout construction during bored piling						
8.14	6.3,6.5	Avoidance of peak CWD calving season in May and June for driving of metal caissons during bored piling works	Southern marine viaduct/ May and June during bored piling	Contractor	TMEIA		Y		n/a
8.14	6.3,6.5	Specification and implementation of 250m dolphin exclusion zone.	All marine bored piling and temporary staging works areas/Detailed Design/during all marine bored piling and temporary staging works	Design Consultant/ Contractor	TMEIA	Y	Y		n/a
8.15	6.3, 6.5	Specification and deployment of an artificial reef of an area of 3,600 m <sup>2</sup> in an area where fishing activities are prohibited.	Area of prohibited fishing activities/Detailed Design/towards end of construction period	TM-CLKL/ HKBCF Design Consultant/ TM-CLKL/ HKBCF Contractor	TMEIA	Y		Y	n/a To be enforced by AFCD.
8.14	6.3, 6.5	Specification and implementation of marine vessel control specifications	All areas/Detailed Design/during construction works	Design Consultant/ Contractor	TMEIA	Y	Y		n/a
8.14	6.3, 6.5	Design and implementation of acoustic decoupling methods for marine bored piling and the whole lifespan of temporary staging works.	All areas/ Detailed Design/during marine bored piling and temporary staging works	Design Consultant/ Contractor	TMEIA	Y	Y		n/a
8.15	6.3, 6.4	Pre-construction phase survey and coral translocation	Tai Ho Wan (donor site) and Yam Tsui Wan (receptor site) /Detailed Design/Prior to construction	Design Consultant/ Contractor	TMEIA	Y	Y		n/a
8.15	6.5	Audit coral translocation success	Yam Tsui Wan (receptor site)/Post translocation	Contractor	TMEIA		Y		Completed in October 2014
7.13	6.5	Undertaken gabion wall works in	North Lantau slope	Contractor	TMEIA		Y		n/a



EIA Reference	EM&A Manual Reference	Environmental Protection Measures	Location/ Timing	Implementation Agent	Relevant Standard or Requirement	Implementation Stages			Status
						D	C	O	
		Stream NL1 in the dry season	works/dry season/construction phase						
7.13	6.5	The loss of habitat shall be supplemented by enhancement planting in accordance with the landscape mitigation schedule.	All areas / As soon as accessible	Contractor	TMEIA		Y		n/a. To be approved by AFCD/LCSD
7.13	6.5	Spoil heaps shall be covered at all times.	All areas / Throughout construction period	Contractor	TMEIA		Y		n/a
7.13	6.5	Avoid damage and disturbance to the remaining and surrounding natural habitat	All areas / Throughout construction period	Contractor	TMEIA		Y		n/a
7.13	6.5	Placement of equipment in designated areas within the existing disturbed land	All areas / Throughout construction period	Contractor	TMEIA		Y		n/a
7.13	6.5	Disturbed areas to be reinstated immediately after completion of the works.	All areas / Throughout construction period	Contractor	TMEIA		Y		n/a
7.13	6.5	Construction activities should be restricted to the proposed works boundary	All areas / Throughout construction period	Contractor	TMEIA		Y		n/a
<b>LANDSCAPE AND VISUAL</b>									
10.9	7.6	Round angle, patterned finishes, and oval shaped pier were considered in the viaduct design, and further details will be developed under ACABAS submission (DM3)	All areas/detailed design	Design Consultant	TMEIA		Y		n/a
10.9	7.6	Details of the street furniture will be developed in the detailed design stage (DM4)	All areas/detailed design	Design Consultant	TMEIA		Y		n/a
10.9	7.6	Aesthetic design of the viaduct, retaining wall and other structures will be developed under ACABAS submission (DM5)	All areas/detailed design	Design Consultant	TMEIA		Y		n/a
10.9	7.6	Existing trees on boundary of the Project Area shall be carefully protected during construction. Detailed Tree Protection Specification shall be provided in the Contract Specification. Under this specification, the Contractor shall be required to submit, for approval, a detailed	All areas/detailed design/ during construction	Design Consultant/ Contractor	TMEIA		Y	Y	n/a



EIA Reference	EM&A Manual Reference	Environmental Protection Measures	Location/ Timing	Implementation Agent	Relevant Standard or Requirement	Implementation Stages			Status
						D	C	O	
		working method statement for the protection of trees prior to undertaking any works adjacent to all retained trees, including trees in contractor's works areas. (Tree protection measures will be detailed at Tree Removal Application stage) (CM1)							
10.9	7.6	Trees unavoidably affected by the works shall be transplanted where practical. Trees will be transplanted straight to their final receptor site and not held in a temporary nursery. A detailed Tree Transplanting Specification shall be provided in the Contract Specification. Sufficient time for necessary tree root and crown preparation periods shall be allowed in the project programme (CM2)	All areas/detailed design/ during construction	Design Consultant/ Contractor	TMEIA	Y	Y		n/a
10.9	7.6	Hillside and roadside screen planting to proposed roads, associated structures and slope works (CM3).	All areas/detailed design/ during construction/post construction	Design Consultant/ Contractor	TMEIA	Y	Y		✓
10.9	7.6	Hydroseeding or sheeting of soil stockpiles with visually unobtrusive material (in earth tone) (CM4)	All areas/detailed design/ during construction/post construction	Design Consultant/ Contractor	TMEIA	Y	Y		n/a
10.9	7.6	Screening of construction works by hoardings around works area in visually unobtrusive colours, to screen works (CM5)	All areas/detailed design/ during construction/post construction	Design Consultant/ Contractor	TMEIA	Y	Y		n/a
10.9	7.6	Control night-time lighting and glare by hooding all lights (CM6)	All areas/detailed design/ during construction	Design Consultant/ Contractor	TMEIA	Y	Y		n/a
10.9	7.6	Ensure no run-off into water body adjacent to the Project Area (CM7)	All areas/detailed design/ during construction	Design Consultant/ Contractor	TMEIA	Y	Y		n/a
10.9	7.6	Avoidance of excessive height and bulk of buildings and structures (CM8)	All areas/detailed design/ during construction	Design Consultant/ Contractor	TMEIA	Y	Y		n/a

EIA Reference	EM&A Manual Reference	Environmental Protection Measures	Location/ Timing	Implementation Agent	Relevant Standard or Requirement	Implementation Stages			Status
						D	C	O	
10.9	7.6	Recycle/Reuse all felled trees and vegetation, e.g. mulching (CM9)	All areas/detailed design/ during construction	Design Consultant/ Contractor	TMEIA	Y	Y		n/a No felled trees or vegetation suitable for recycle
10.9	7.6	Compensatory tree planting shall be provided to the satisfaction of relevant Government departments. Required numbers and locations of compensatory trees shall be determined and agreed separately with Government during the Tree Felling Application process under ETWBTC 3/2006 (CM10).	All areas/detailed design/ during construction	Design Consultant/ Contractor	TMEIA	Y	Y		n/a
10.9	7.6	Re-vegetation of affected woodland/shrubland with native species (OM1)	All areas/detailed design/ during construction/ during operation	Design Consultant/ Contractor	TMEIA	Y	Y	Y	n/a. To be implemented by AFCD/HyD/ L CSD
10.9	7.6	Tall buffer screen tree / shrub / climber planting should be incorporated to soften hard engineering structures and facilities (OM2)	All areas/detailed design/ during construction/ during operation	Design Consultant/ Contractor	TMEIA	Y	Y	Y	n/a To be implemented by HyD/LCSD
10.9	7.6	Streetscape elements (e.g. paving, signage, street furniture, lighting etc.) shall be sensitively designed in a manner that responds to the local context, and minimises potential negative landscape and visual impacts. Lighting units should be directional and minimise unnecessary light spill (OM3)	All areas/detailed design/ during construction / during operation	Design Consultant/ Contractor	TMEIA	Y	Y	Y	n/a. To be implemented by HyD/LCSD
10.9	7.6	Structure, ornamental tree / shrub / climber planting should be provided along roadside amenity strips, central dividers and newly formed slopes to enhance the townscape quality and further greenery enhancement	All areas/detailed design/ during construction / during operation	Design Consultant/ Contractor	TMEIA	Y	Y	Y	n/a. To be implemented by

EIA Reference	EM&A Manual Reference	Environmental Protection Measures	Location/ Timing	Implementation Agent	Relevant Standard or Requirement	Implementation Stages			Status
						D	C	O	
		(OM4)							HyD/LCSD
10.9	7.6	Aesthetically pleasing design (visually unobtrusive and non-reflective) as regard to the form, material and finishes	All areas/detailed design/ during construction / during operation	Design Consultant/ Contractor	TMEIA	Y	Y	Y	n/a. To be implemented by HyD
<b>WASTE</b>									
12.6		The Contractor shall identify a coordinator for the management of waste.	Contract mobilisation	Contractor	TMEIA		Y		✓
12.6		The Contractor shall prepare and implement a Waste Management Plan which specifies procedures such as a ticketing system, to facilitate tracking of loads and to ensure that illegal disposal of wastes does not occur, and protocols for the maintenance of records of the quantities of wastes generated, recycled and disposed. A recording system for the amount of waste generated, recycled and disposed (locations) should be established.	Contract mobilisation	Contractor	TMEIA, Works Branch Technical Circular No. 5/99 for the Trip-ticket System for Disposal of Construction and Demolition Material		Y		✓
12.6		The Contractor shall apply for and obtain the appropriate licenses for the disposal of public fill, chemical waste and effluent discharges.	Contract mobilisation	Contractor	TMEIA, Land (Miscellaneous Provisions) Ordinance (Cap 28); Waste Disposal Ordinance (Cap 354); Dumping at Sea Ordinance (Cap 466); Water Pollution Control Ordinance.		Y		✓
12.6	8.1	Training shall be provided to workers about the concepts of site cleanliness and appropriate waste management procedures including waste reduction, reuse and recycling.	Contract Mobilisation	Contractor	TMEIA		Y		✓
12.6	8.1	The extent of cutting operation should be optimised	All areas / throughout	Contractor	TMEIA		Y		✓

EIA Reference	EM&A Manual Reference	Environmental Protection Measures	Location/ Timing	Implementation Agent	Relevant Standard or Requirement	Implementation Stages			Status
						D	C	O	
		where possible. Earth retaining structures and bored pile walls should be proposed to minimise the extent of cutting.	construction period						
12.6	8.1	Rock armour from the existing seawall should be reused on the new sloping seawall as far as possible	All areas / throughout construction period	Contractor	TMEIA		Y		✓
12.6	8.1	The site and surroundings shall be kept tidy and litter free.	All areas / throughout construction period	Contractor	TMEIA		Y		✓
12.6	8.1	No waste shall be burnt on site.	All areas / throughout construction period	Contractor	TMEIA		Y		✓
12.6	8.1	Provisions to be made in contract documents to allow and promote the use of recycled aggregates where appropriate.	Detailed Design	Design Consultant	TMEIA	Y			n/a
12.6	8.1	The Contractor shall be prohibited from disposing of C&D materials at any sensitive locations. The Contractor should propose the final disposal sites in the EMP and WMP for approval before implementation.	All areas / throughout construction period	Contractor	TMEIA		Y		✓
12.6	8.1	Stockpiled material shall be covered by tarpaulin and /or watered as appropriate to prevent windblown dust/ surface run off.	All areas / throughout construction period	Contractor	TMEIA		Y		✓
12.6	8.1	Excavated material in trucks shall be covered by tarpaulins to reduce the potential for spillage and dust generation.	All areas / throughout construction period	Contractor	TMEIA		Y		✓
12.6	8.1	Wheel washing facilities shall be used by all trucks leaving the site to prevent transfer of mud onto public roads.	All areas / throughout construction period	Contractor	TMEIA		Y		✓
12.6	8.1	Standard formwork or pre-fabrication should be used as far as practicable so as to minimise the C&D materials arising. The use of more durable formwork/ plastic facing for construction works should be considered. The use of wooden hoardings should be avoided and metal hoarding should be used to facilitate recycling. Purchasing of construction	All areas / throughout construction period	Contractor	TMEIA		Y		✓

EIA Reference	EM&A Manual Reference	Environmental Protection Measures	Location/ Timing	Implementation Agent	Relevant Standard or Requirement	Implementation Stages			Status
						D	C	O	
		materials should avoid over-ordering and wastage.							
12.6	8.1	The Contractor should recycle as many C&D materials (this is a waste section) as possible on-site. The public fill and C&D waste should be segregated and stored in separate containers or skips to facilitate the reuse or recycling of materials and proper disposal. Where practicable, the concrete and masonry should be crushed and used as fill materials. Steel reinforcement bar should be collected for use by scrap steel mills. Different areas of the sites should be considered for segregation and storage activities.	All areas / throughout construction period	Contractor	TMEIA		Y		✓
12.6	8.1	All falsework will be steel instead of wood.	All areas / throughout construction period	Contractor	TMEIA		Y		✓
12.6	8.1	Chemical waste producers should register with the EPD. Chemical waste should be handled in accordance with the Code of Practice on the Packaging, Handling and Storage of Chemical Wastes as follows: <ul style="list-style-type: none"> <li>- suitable for the substance to be held, resistant to corrosion, maintained in good conditions and securely closed;</li> <li>- Having a capacity of &lt;450L unless the specifications have been approved by the EPD; and</li> <li>- Displaying a label in English and Chinese according to the instructions prescribed in Schedule 2 of the Regulations. Clearly labelled and used solely for the storage of chemical wastes;</li> <li>- Enclosed with at least 3 sides;</li> <li>- Impermeable floor and bund with capacity to accommodate 110% of the volume of the largest container or 20% by volume of the chemical waste stored in the area, whichever is greatest;</li> </ul>	All areas / throughout construction period	Contractor	TMEIA		Y		✓



EIA Reference	EM&A Manual Reference	Environmental Protection Measures	Location/ Timing	Implementation Agent	Relevant Standard or Requirement	Implementation Stages			Status
						D	C	O	
		<ul style="list-style-type: none"> <li>- Adequate ventilation;</li> <li>- Sufficiently covered to prevent rainfall entering (water collected within the bund must be tested and disposed of as chemical waste, if necessary); and</li> <li>- Incompatible materials are adequately separated.</li> </ul>							
12.6	8.1	Waste oils, chemicals or solvents shall not be disposed of to drain,	All areas / throughout construction period	Contractor	TMEIA		Y		✓
12.6	8.1	Adequate numbers of portable toilets should be provided for on-site workers. Portable toilets should be maintained in reasonable states, which will not deter the workers from utilising them.	All areas / throughout construction period	Contractor	TMEIA		Y		✓
12.6	8.1	Night soil should be regularly collected by licensed collectors.	All areas / throughout construction period	Contractor	TMEIA		Y		✓
12.6	8.1	General refuse arising on-site should be stored in enclosed bins or compaction units separately from C&D and chemical wastes. Sufficient dustbins shall be provided for storage of waste as required under the Public Cleansing and Prevention of Nuisances By-laws. In addition, general refuse shall be cleared daily and shall be disposed of to the nearest licensed landfill or refuse transfer station. Burning of refuse on construction sites is prohibited.	All areas / throughout construction period	Contractor	TMEIA		Y		✓
12.6	8.1	All waste containers shall be in a secure area on hard standing;	All areas / throughout construction period	Contractor	TMEIA		Y		✓
12.6	8.1	Training shall be provided to workers about the concepts of site cleanliness and appropriate waste management procedure, including waste reduction, reuse and recycling.	All areas / throughout construction period	Contractor	TMEIA		Y		✓
12.6	8.1	Office wastes can be reduced by recycling of	Site Offices/	Contractor	TMEIA		Y		✓

EIA Reference	EM&A Manual Reference	Environmental Protection Measures	Location/ Timing	Implementation Agent	Relevant Standard or Requirement	Implementation Stages			Status
						D	C	O	
		paper if such volume is sufficiently large to warrant collection. Participation in a local collection scheme by the Contractor should be advocated. Waste separation facilities for paper, aluminium cans, plastic bottles, etc should be provided on-site.	throughout construction period						
12.6	Section 8	EM&A of waste handling, storage, transportation, disposal procedures and documentation through the site audit programme shall be undertaken.	All areas / throughout construction period	Contractor	EM&A Manual		Y		✓
<b>CULTURAL HERITAGE</b>									
11.8	Section 9	EM&A in the form of audit of the mitigation measures	All areas / throughout construction period	Highways Department	EIAO-TM		Y		n/a

**Notes:**

Legend: D=Design, C=Construction, O=Operation

Note: Funding Agent for all mitigation measures will be the Highways Department of the Hong Kong SAR Government

**Status:**

- ✓ Compliance of Mitigation Measures
- <> Compliance of Mitigation but need improvement
- x Non-compliance of Mitigation Measures
- ▲ Non-compliance of Mitigation Measures but rectified by Contractor
- Δ Deficiency of Mitigation Measures but rectified by Contractor
- n/a Not Applicable in Reporting Period

Appendix D

## Monthly Summary of Waste Flow Table

**Contract No. : HY/2012/07**

**Tuen Mun Chek Lap Kok Link – Southern Connection Viaduct Section**

**Monthly Summary Waste Flow Table for 2020 (Year)**

Month\Material	Actual Quantities of Inert C&D Materials Generation								Actual Quantities of Recyclables Generation			
	Total Quantity Generated	Hard Rock and Large Broken Concrete	Reused in the Contract	Reused in other Projects	Disposed as Public Fills	Imported Fill	Chemical Waste	General Refuse	Metals	Felled trees	Paper/ cardboard packaging	Plastics
Unit	('000m <sup>3</sup> )	('000m <sup>3</sup> )	('000m <sup>3</sup> )	('000m <sup>3</sup> )	('000m <sup>3</sup> )	('000m <sup>3</sup> )	('000Kg)	('000Kg)	('000Kg)	('000Kg)	('000Kg)	('000Kg)
Jan	-	0.000	-	-	-	-	-	12.260	-	-	-	-
Feb	0.048	0.048	-	-	0.048	-	-	-	-	-	-	-
Mar	0.038	0.038	-	-	0.038	-	-	-	-	-	-	-
Apr	-	0.000	-	-	-	-	-	-	-	-	-	-
May	-	0.000	-	-	-	-	-	-	-	-	-	-
Jun	-	0.000	-	-	-	-	-	-	-	-	-	-
<b>SUB-TOTAL</b>	<b>0.086</b>	<b>0.086</b>	<b>0.000</b>	<b>-</b>	<b>0.086</b>	<b>0.000</b>	<b>-</b>	<b>12.260</b>	<b>-</b>	<b>0.000</b>	<b>-</b>	<b>-</b>
Jul	-	0.000	-	-	-	-	-	-	-	-	-	-
Aug	-	0.000	-	-	-	-	-	-	-	-	-	-
Sep	-	0.000	-	-	-	-	-	-	-	-	-	-
Oct	-	0.000	-	-	-	-	-	-	-	-	-	-
Nov	-	0.000	-	-	-	-	-	-	-	-	-	-
Dec	-	0.000	-	-	-	-	-	-	-	-	-	-
<b>TOTAL</b>	<b>0.086</b>	<b>0.086</b>	<b>-</b>	<b>-</b>	<b>0.086</b>	<b>-</b>	<b>-</b>	<b>12.260</b>	<b>-</b>	<b>-</b>	<b>-</b>	<b>-</b>

**Notes :**

- 1 - The waste flow table shall also include C&D materials that are specified in the Contract to be imported for use at the Site.
- 2 - Plastics refer to plastic bottles/containers, plastic sheets/foam from packaging material.
- 3 - Broken concrete for recycling into aggregates.
- 4 - Assumed 5 kg per damaged water-filled barrier.
- 5 - Disposed as Public Fills includes Hard Rock and Large Broken Concrete.

Appendix E

Cumulative Statistics on  
Exceedances, Complaints,  
Notifications of Summons  
and Successful Prosecutions



*Appendix E1 Cumulative Statistics on Exceedances*

		Total No. recorded in this reporting month	Total No. recorded since contract commencement
1-Hr TSP	Action	0	0
	Limit	0	2
24-Hr TSP	Action	0	2
	Limit	0	0
Noise	Action	0	0
	Limit	0	0
Water Quality	Action	0	272
	Limit	0	27
Impact Dolphin Monitoring	Action	0	11
	Limit	0	19

*Appendix E2 Cumulative Statistics on Complaints, Notifications of Summons and Successful Prosecutions*

Reporting Period	Cumulative Statistics		
	Complaints	Notifications of Summons	Successful Prosecutions
This Reporting Month (March 2020)	0	0	0
Total No. received since contract commencement	14	0	0