

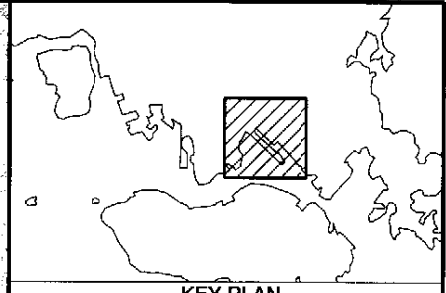

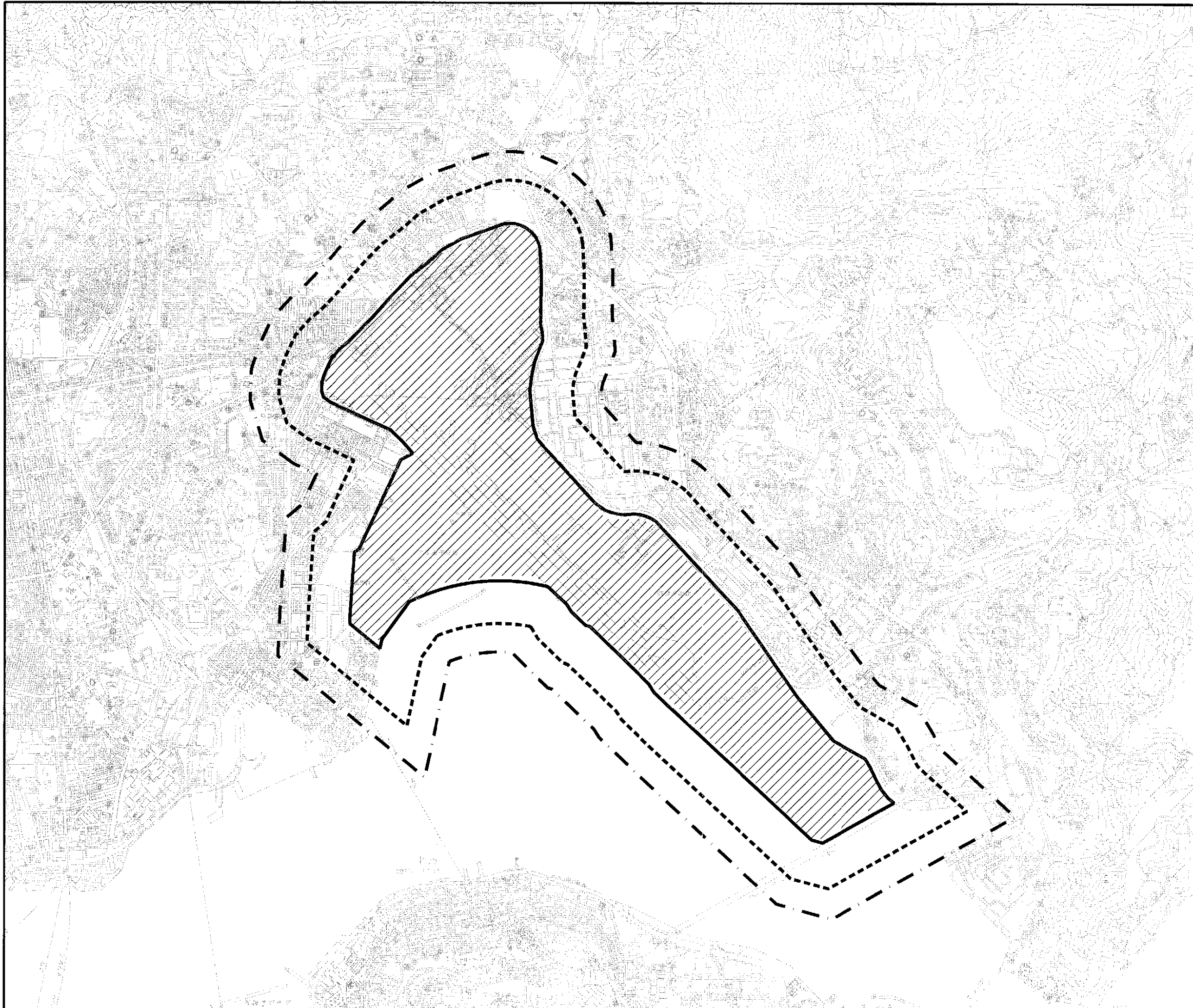

**SECTION 1**



- LEGEND**
-  New Development Area
  -  300m from the boundary of New Development Area
  -  500m from the boundary of New Development Area

| Rev | Description | By | Date |
|-----|-------------|----|------|
|     |             |    |      |
|     |             |    |      |
|     |             |    |      |

Consultants

**ARUP** Ove Arup & Partners Hong Kong Limited

Murray Harrison Limited      ACIA Limited  
 Au Poonford Consultants Limited      Environmental Management Limited  
 Montgomery Watson Hong Kong Limited      Rocco Design Limited  
 Wonnell Limited

Project Title

**AGREEMENT NO. CE 32/99  
 COMPREHENSIVE FEASIBILITY STUDY  
 FOR THE REVISED SCHEME OF  
 SOUTH EAST KOWLOON DEVELOPMENT**

Drawing title

**SITE PLAN OF NEW DEVELOPMENT  
 AREA AND ASSESSMENT AREA**

|             |                     |          |             |
|-------------|---------------------|----------|-------------|
| Drawing no. | <b>22936/EN/150</b> | Rev.     |             |
| Drawn       | PCL                 | Date     | DEC 00      |
| Checked     |                     | Approved |             |
| Scale       | 1:25000 ON A3 SIZE  | Status   | PRELIMINARY |

Printer by : SUSER'S 04 JUN 2001  
 File name : 8FILES

COPYRIGHT RESERVED



拓展署  
 Territory Development  
 Department, Hong Kong  
 九龍拓展處  
 KOWLOON DEVELOPMENT OFFICE

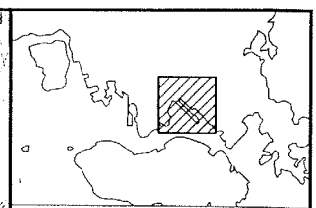
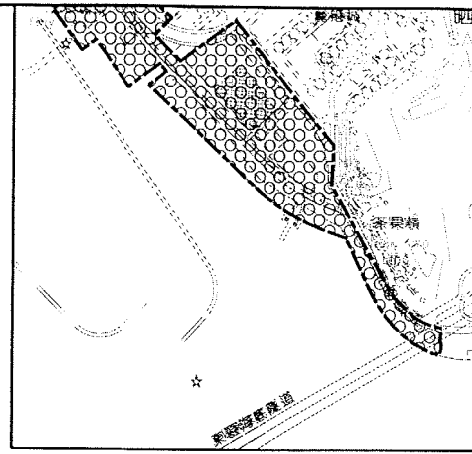
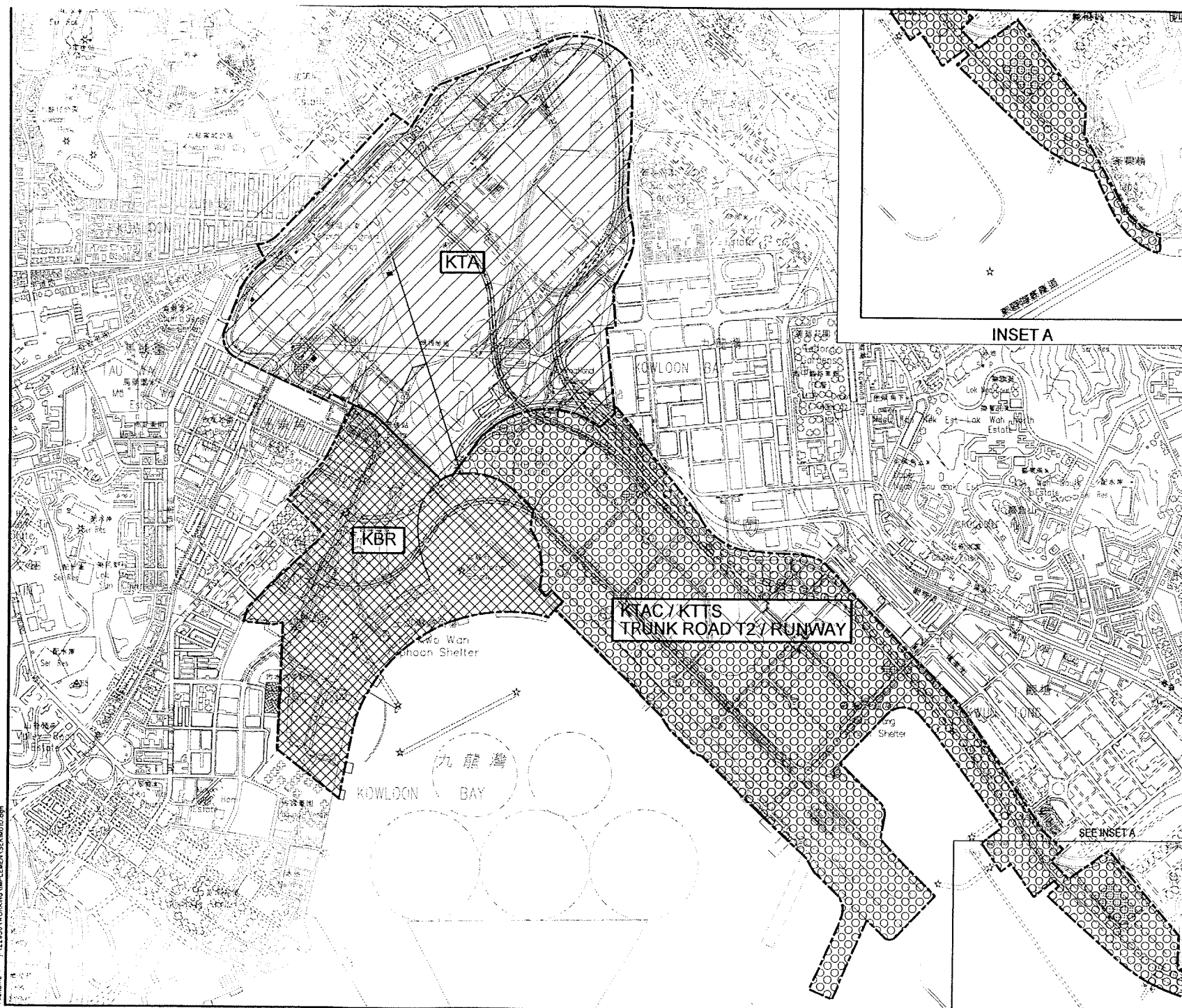

INSET A

SEE INSET A

| Rev | Description | By | Date |
|-----|-------------|----|------|
|     |             |    |      |

Consultants  
**ARUP** One Arup & Partners Hong Kong Limited  
 Murray Harrison Limited      ACLA Limited  
 Au Poon & Associates Limited      Environmental Management Limited  
 Montgomery Watson Hong Kong Limited      Ricci Design Limited  
 Wihard Limited

Project title  
**AGREEMENT NO. CE 32/99  
 COMPREHENSIVE FEASIBILITY STUDY  
 FOR THE REVISED SCHEME OF  
 SOUTH EAST KOWLOON DEVELOPMENT**

Drawing title  
**DEVELOPMENT PACKAGES**

Drawing no. **22936/IM/010**      Rev. -

| Drawn | Date   | Checked | Approved |
|-------|--------|---------|----------|
|       | JAN 01 |         |          |

Scale: NTS      Status: PRELIMINARY

COPYRIGHT RESERVED

 拓展署  
 Territory Development  
 Department, Hong Kong  
 九龍拓展處  
 KOWLOON DEVELOPMENT OFFICE

Printer by : W. MAK      2001/02/27  
 Filename : I:\22936\WORKING\IMPLEMENT\SEM\M010.dgn

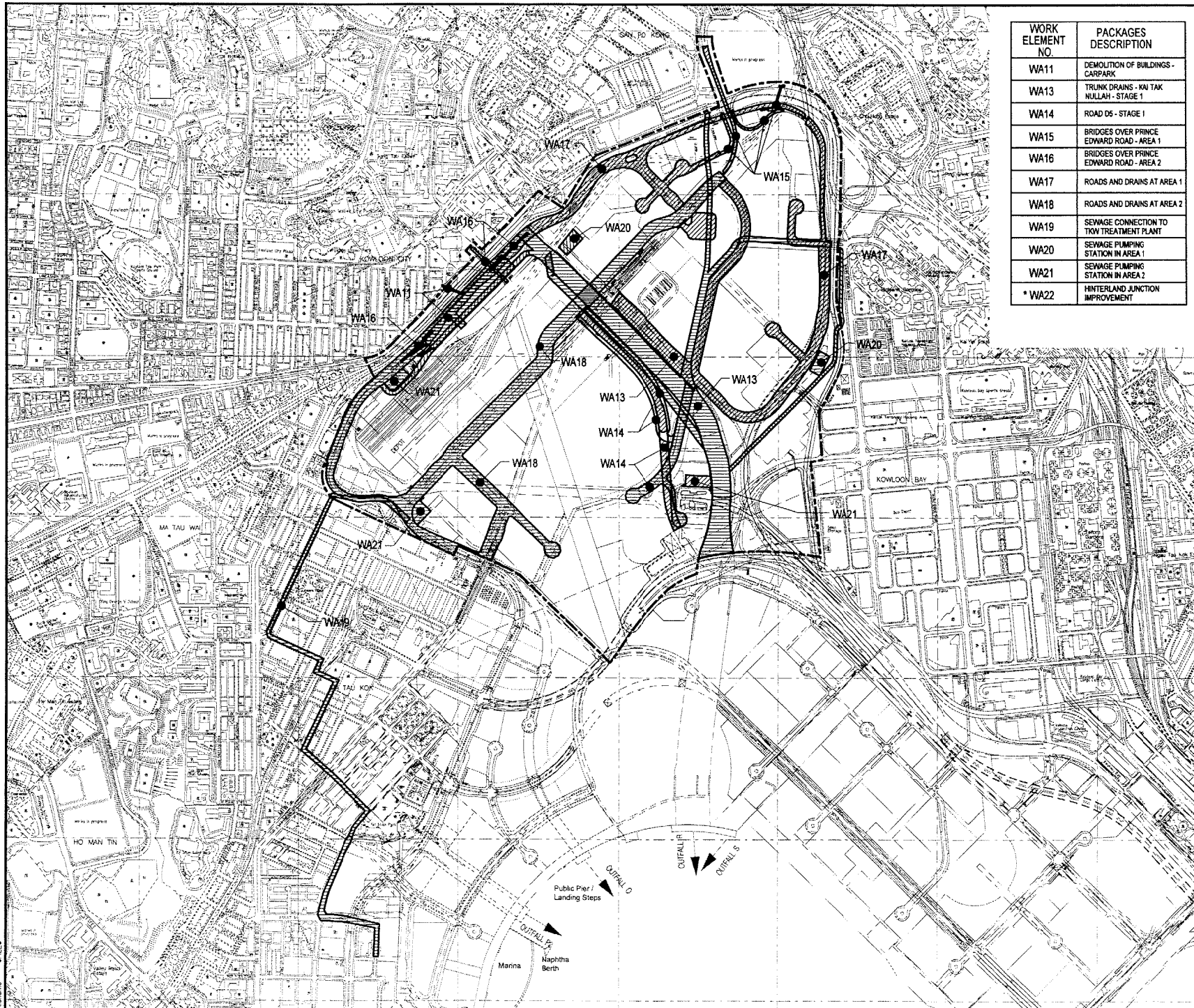

| WORK ELEMENT NO. | PACKAGES DESCRIPTION                     |
|------------------|--|
| WA11             | DEMOLITION OF BUILDINGS - CARPARK        |
| WA13             | TRUNK DRAINS - KAI TAK NULLAH - STAGE 1  |
| WA14             | ROAD D5 - STAGE 1                        |
| WA15             | BRIDGES OVER PRINCE EDWARD ROAD - AREA 1 |
| WA16             | BRIDGES OVER PRINCE EDWARD ROAD - AREA 2 |
| WA17             | ROADS AND DRAINS AT AREA 1               |
| WA18             | ROADS AND DRAINS AT AREA 2               |
| WA19             | SEWAGE CONNECTION TO TKW TREATMENT PLANT |
| WA20             | SEWAGE PUMPING STATION IN AREA 1         |
| WA21             | SEWAGE PUMPING STATION IN AREA 2         |
| * WA22           | HINTERLAND JUNCTION IMPROVEMENT          |

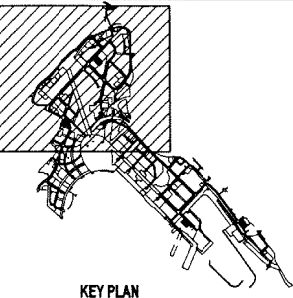

KEY PLAN

\* FOR WA22, SEE DRG. NO. 22936/IM/701.

| Rev | Description    | By | Date      |
|-----|----------------|----|-----------|
| A   | MINOR REVISION |    | Y.Y. DDD1 |

|                                     |                                     |
|-------------------------------------|-------------------------------------|
| Consultants                         |                                     |
| <b>ARUP</b>                         | One Am & Partners Hong Kong Limited |
| Munry Harries Limited               | ACIA Limited                        |
| Au Priced Consultants Limited       | Environmental Management Limited    |
| Montgomery Nelson Hong Kong Limited | Roads Design Limited                |
| Wilson Limited                      |                                     |
| Project title                       |                                     |

AGREEMENT NO. CE 32/99  
 COMPREHENSIVE FEASIBILITY STUDY  
 FOR THE REVISED SCHEME OF  
 SOUTH EAST KOWLOON DEVELOPMENT

Drawing title

**KTA DEVELOPMENT PACKAGE  
 WORKS ELEMENT**

|             |              |          |             |
|-------------|--------------|----------|-------------|
| Drawing no. | 22936/IM/011 | Rev.     | A           |
| Drawn       | WMAK         | Date     | JAN 01      |
| Checked     |              | Approved |             |
| Scale       | 1:5000       | Status   | PRELIMINARY |

COPYRIGHT RESERVED

拓展署  
 Territory Development  
 Department, Hong Kong  
 九龍拓展署  
 KOWLOON DEVELOPMENT OFFICE

| WORK ELEMENT NO. | PACKAGES DESCRIPTION  |
|------------------|---|
| WB11             | RECLAMATION AT KAI TAK APPROACH CHANNEL                     |
| WB12             | RECLAMATION OF KWUN TONG TYPHOON SHELTER                    |
| WB13             | RECLAMATION AT CHA KWO LING PCWA                            |
| WB14             | TRUNK DRAINS - KAI TAK NULLAH - STAGE 2                     |
| WB15             | TRUNK DRAINS AREAS 4 AND 5                                  |
| WB16             | TRUNK DRAINS AREAS 5 AND 6                                  |
| WB17             | RECLAMATION OF TYPHOON SHELTER BREAKWATER IN KTTS (AREA 6B) |
| WB18             | TEMPORARY RELOCATION OF PCWA                                |
| WB19             | PERMANENT RELOCATION OF PCWA                                |
| WB20             | REPROVISION OF VEHICULAR FERRY PIER                         |
| WB21             | PROVISION OF TOURIST EXCURSION PIER                         |

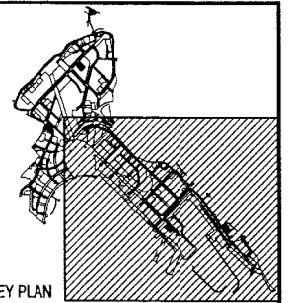

KEY PLAN

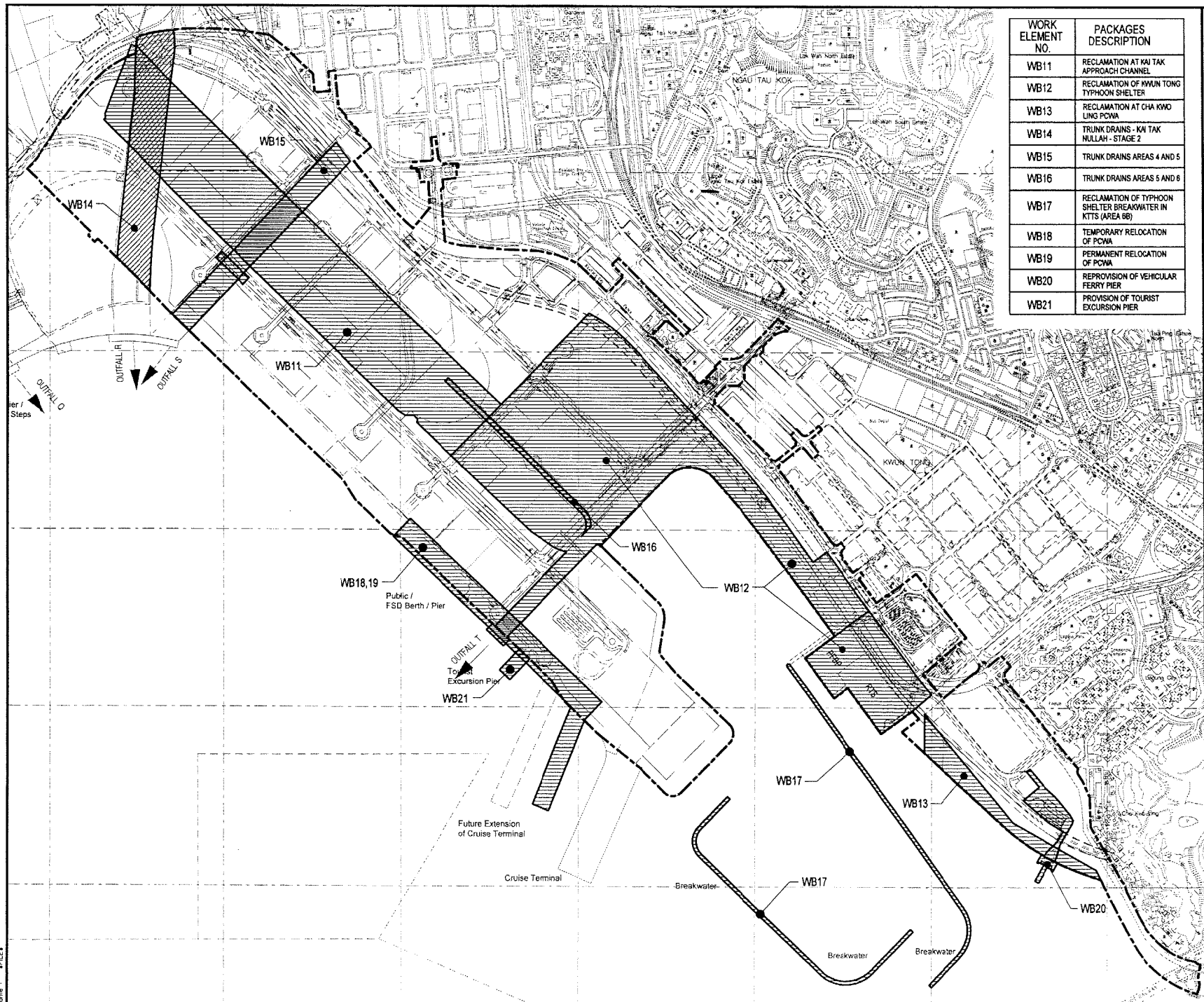

|  |                                  |                                       |             |
|--|----------------------------------|---------------------------------------|-------------|
| A                                      | MINOR REVISION                   | YY                                    | 0401        |
| Rev                                    | Description                      | By                                    | Date        |
| Consultants                            |                                  |                                       |             |
| <b>ARUP</b>                            |                                  | Ove Arup & Partners Hong Kong Limited |             |
| Murray Harrison Limited                | AGLA Limited                     |                                       |             |
| Au Pooled Consultants Limited          | Environmental Management Limited |                                       |             |
| Hongkong Watson Hong Kong Limited      | Rocco Design Limited             |                                       |             |
| Project Site                           |                                  |                                       |             |
| <b>AGREEMENT NO.CE 32/99</b>           |                                  |                                       |             |
| <b>COMPREHENSIVE FEASIBILITY STUDY</b> |                                  |                                       |             |
| <b>FOR THE REVISED SCHEME OF</b>       |                                  |                                       |             |
| <b>SOUTH EAST KOWLOON DEVELOPMENT</b>  |                                  |                                       |             |
| Drawing title                          |                                  |                                       |             |
| <b>KTAC / KTTS DEVELOPMENT</b>         |                                  |                                       |             |
| <b>WORKS ELEMENT</b>                   |                                  |                                       |             |
| Drawing no.                            |                                  |                                       |             |
| 22936/11/012                           |                                  | Rev.                                  | A           |
| Drawn                                  | Date                             | Checked                               | Approved    |
| WMAX                                   | JAN 2001                         |                                       |             |
| Scale                                  | 1:5000                           | Status                                | PRELIMINARY |
| COPYRIGHT RESERVED                     |                                  |                                       |             |



拓展署  
Territory Development  
Department, Hong Kong  
九龍拓展署  
KOWLOON DEVELOPMENT OFFICE

Printer by : BUSEK  
Filename : FILE1

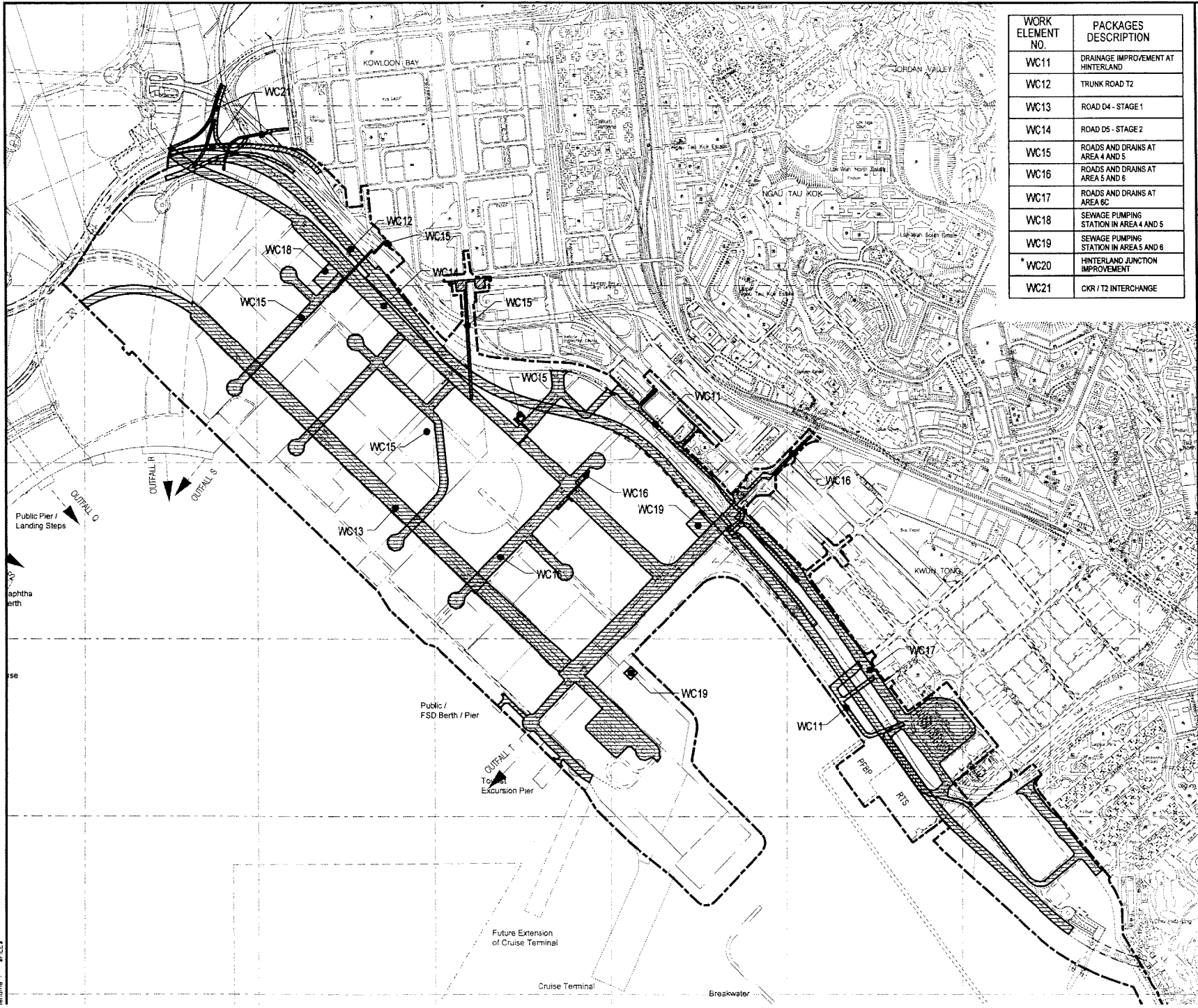

| WORK ELEMENT NO. | PACKAGES DESCRIPTION                   |
|------------------|--|
| WC11             | DRAINAGE IMPROVEMENT AT HINTERLAND     |
| WC12             | TRUNK ROAD T2                          |
| WC13             | ROAD D4 - STAGE 1                      |
| WC14             | ROAD D5 - STAGE 2                      |
| WC15             | ROADS AND DRAINS AT AREA 4 AND 5       |
| WC16             | ROADS AND DRAINS AT AREA 5 AND 6       |
| WC17             | ROADS AND DRAINS AT AREA 6C            |
| WC18             | SEWAGE PUMPING STATION IN AREA 4 AND 5 |
| WC19             | SEWAGE PUMPING STATION IN AREA 5 AND 6 |
| * WC20           | HINTERLAND JUNCTION IMPROVEMENT        |
| WC21             | CKR / T2 INTERCHANGE                   |

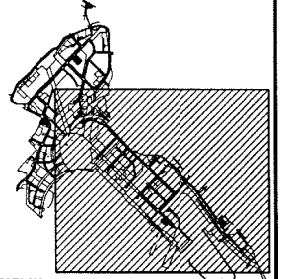

KEY PLAN

\* FOR WC20, SEE DRG. 22936/MM/701.

|  |                                  |                                       |             |        |
|--|----------------------------------|---------------------------------------|-------------|--------|
| A                                      |                                  | MINOR REVISION                        | BY          | DATE   |
| Rev                                    | Description                      |                                       | By          | Date   |
| Consultants                            |                                  |                                       |             |        |
| <b>ARUP</b>                            |                                  | Ove Arup & Partners Hong Kong Limited |             |        |
| Murray Henderson Limited               | ACLA Limited                     |                                       |             |        |
| Au Pookoi Consultants Limited          | Environmental Management Limited |                                       |             |        |
| Mong Guan Wai Hong Kong Limited        | Rocco Design Limited             |                                       |             |        |
| Wetzel Limited                         |                                  |                                       |             |        |
| Project title                          |                                  |                                       |             |        |
| <b>AGREEMENT NO. CE 32/99</b>          |                                  |                                       |             |        |
| <b>COMPREHENSIVE FEASIBILITY STUDY</b> |                                  |                                       |             |        |
| <b>FOR THE REVISED SCHEME OF</b>       |                                  |                                       |             |        |
| <b>SOUTH EAST KOWLOON DEVELOPMENT</b>  |                                  |                                       |             |        |
| Drawing title                          |                                  |                                       |             |        |
| <b>TRUNK ROAD T2 /</b>                 |                                  |                                       |             |        |
| <b>RUNWAY DEVELOPMENT</b>              |                                  |                                       |             |        |
| <b>WORKS ELEMENT</b>                   |                                  |                                       |             |        |
| Drawing no.                            |                                  | 22936/MM/013                          |             | Rev. A |
| Drawn                                  | Date                             | Checked                               | Approved    |        |
| WMAK                                   | JAN 2001                         |                                       |             |        |
| Scale                                  | 1:5000                           | Status                                | PRELIMINARY |        |

COPYRIGHT RESERVED

拓展署  
Territory Development  
Department, Hong Kong  
九龍拓展處  
KOWLOON DEVELOPMENT OFFICE

Inter by : SUSERR EDATES  
Incentive : \$FILES

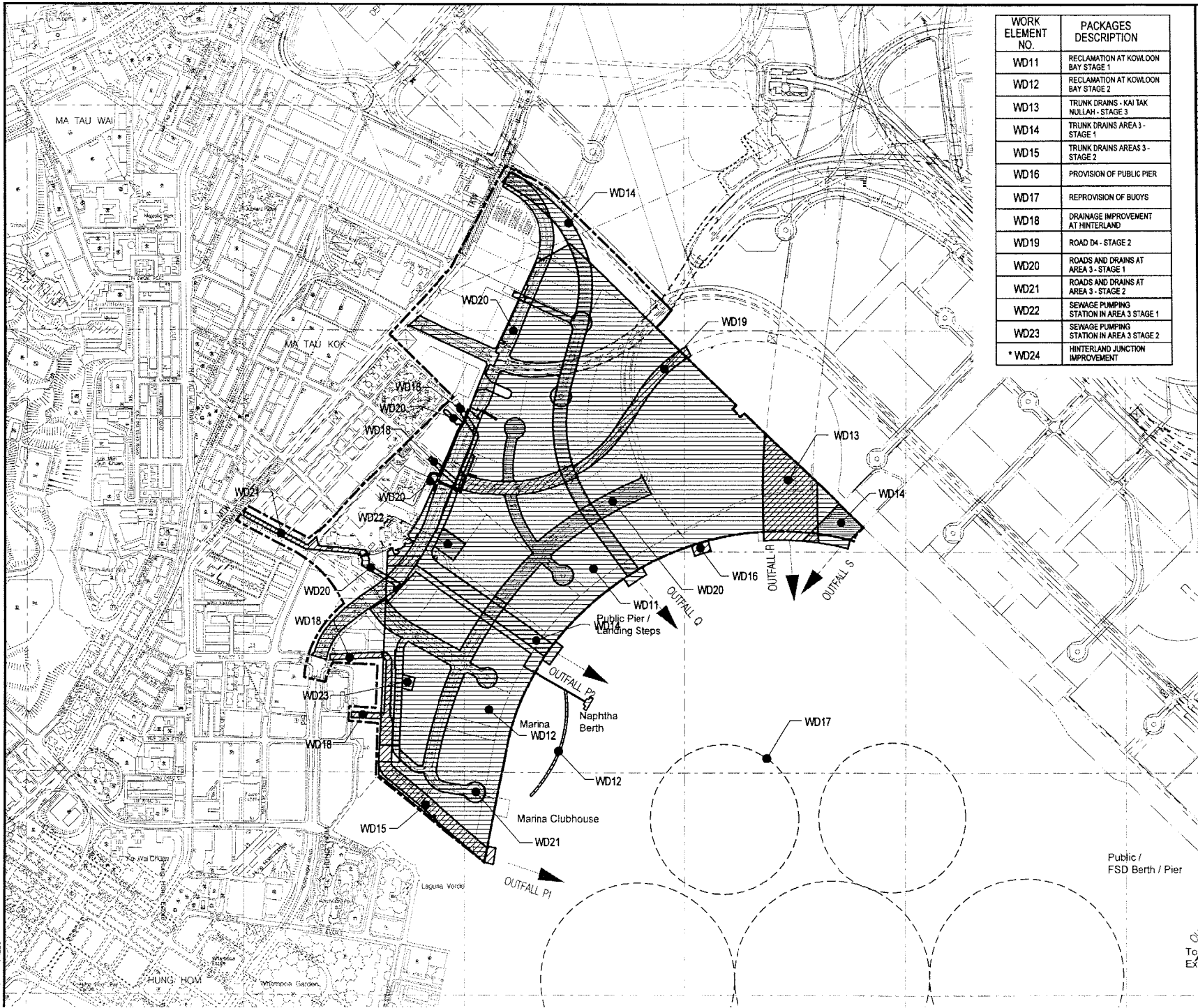

| WORK ELEMENT NO. | PACKAGES DESCRIPTION                     |
|------------------|--|
| WD11             | RECLAMATION AT KOWLOON BAY STAGE 1       |
| WD12             | RECLAMATION AT KOWLOON BAY STAGE 2       |
| WD13             | TRUNK DRAINS - KAI TAK NULLAH - STAGE 3  |
| WD14             | TRUNK DRAINS AREA 3 - STAGE 1            |
| WD15             | TRUNK DRAINS AREAS 3 - STAGE 2           |
| WD16             | PROVISION OF PUBLIC PIER                 |
| WD17             | REPROVISION OF BUOYS                     |
| WD18             | DRAINAGE IMPROVEMENT AT HINTERLAND       |
| WD19             | ROAD D4 - STAGE 2                        |
| WD20             | ROADS AND DRAINS AT AREA 3 - STAGE 1     |
| WD21             | ROADS AND DRAINS AT AREA 3 - STAGE 2     |
| WD22             | SEWAGE PUMPING STATION IN AREA 3 STAGE 1 |
| WD23             | SEWAGE PUMPING STATION IN AREA 3 STAGE 2 |
| * WD24           | HINTERLAND JUNCTION IMPROVEMENT          |

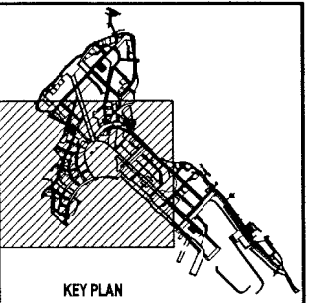

KEY PLAN

FOR \* WD24, SEE DRG. 22936/IM/701.

|   |             |                |      |          |
|---|-------------|----------------|------|----------|
| A   |             | MINOR REVISION | BY   | DATE     |
| Rev.  | Description | By             | Date |          |
| <b>ARUP</b> One Arup & Partners Hong Kong Limited<br>Money/Partner Limited ACLA Limited<br>Ai Pui-rob Consultants Limited Environmental Management Limited<br>Montgomery Watson Hong Kong Limited Rocco Design Limited<br>WSP Limited |             |                |      |          |
| Project Title   |             |                |      |          |
| <b>AGREEMENT NO. CE 32/99</b><br><b>COMPREHENSIVE FEASIBILITY STUDY</b><br><b>FOR THE REVISED SCHEME OF</b><br><b>SOUTH EAST KOWLOON DEVELOPMENT</b>  |             |                |      |          |
| Drawing Title   |             |                |      |          |
| <b>KBR DEVELOPMENT</b><br><b>WORKS ELEMENT</b>  |             |                |      |          |
| Drawing No.   |             | 22936/IM/014   |      | Rev.     |
| Drawn   |             | Date           |      | Checked  |
| WJMK  |             | JAN 2001       |      | Approved |
| Scale   |             | 1:400          |      | Status   |
|   |             | PRELIMINARY    |      |          |
| COPYRIGHT RESERVED  |             |                |      |          |
| 拓展處<br>Territory Development<br>Department, Hong Kong<br>九龍拓展處<br>KOWLOON DEVELOPMENT OFFICE  |             |                |      |          |

Drawn by: BUSEERS DATE: 11/11/00  
 Checked by: PELLE