

SECTION 12

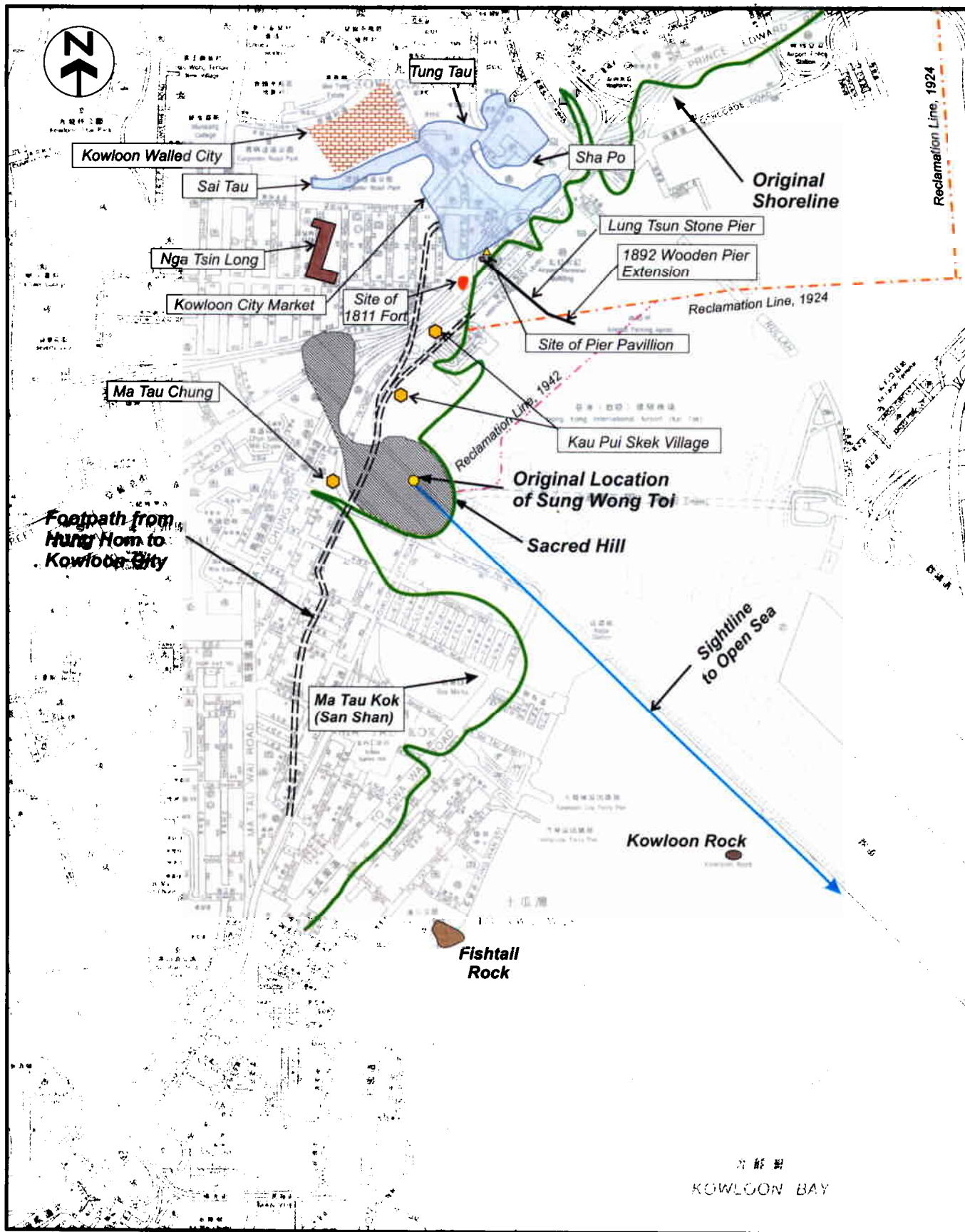

Drawing No. 22936/EN/001 Original Coastline of Kai Tak Area and Locations of Important Historical Features

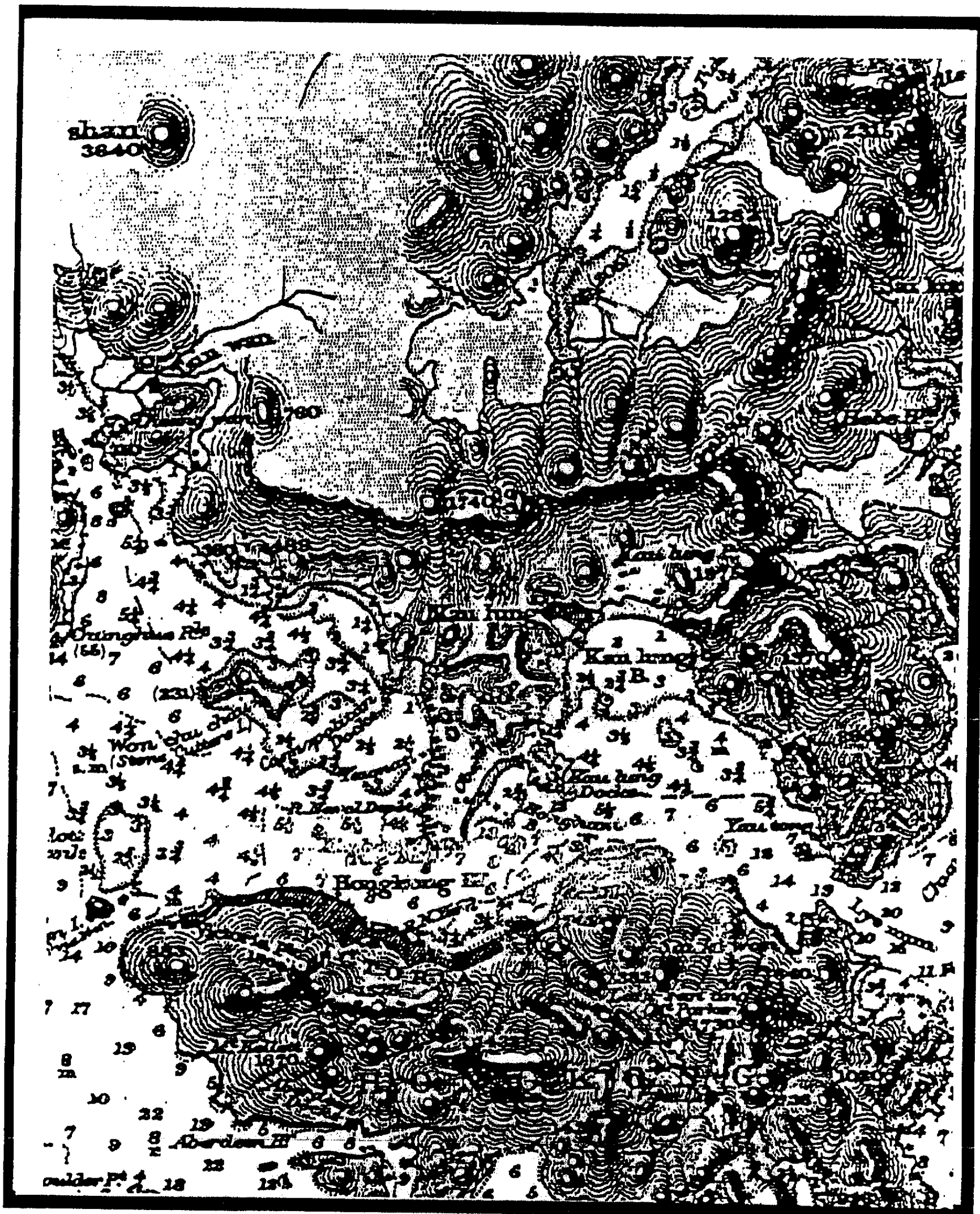

Drawing No. 22936/EN/026 British Admiralty Chart, 1898

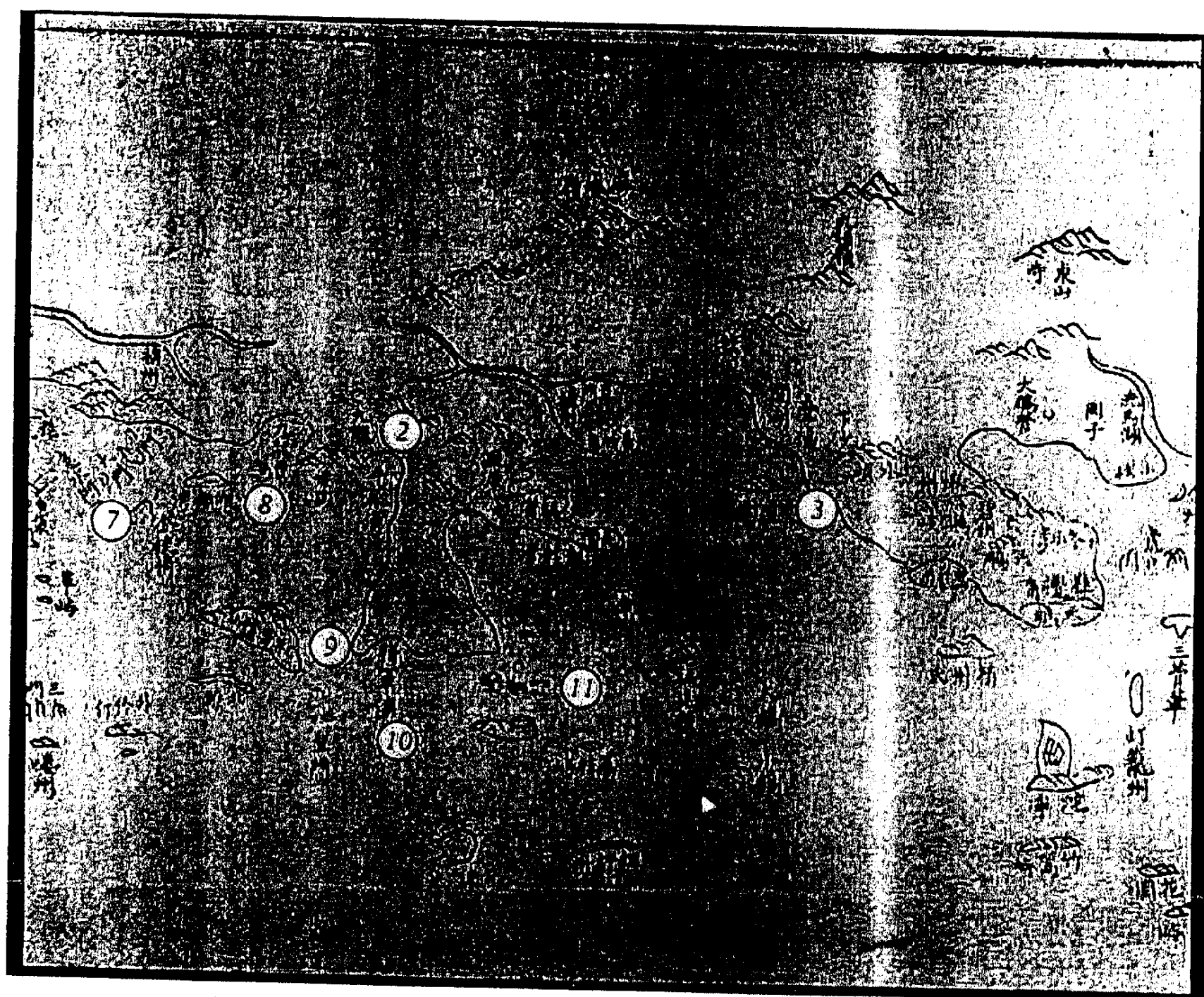

- Legend:
- 2 Kowloon
 - 3 Pin Chau
 - 7 Kap Shui Mun
 - 8 Ngong Shuen Chau (Stonecutters Island)
 - 9 Red Incense Burner Hill (Hong Kong Island)
 - 10 Tseung Kwan O (Junk Bay)
 - 11 Fat Ton Mun

Drawing No. 22936/EN/027 Section of Map of the Entire Coastline by Chan Lun Kwing in Hoi Kwok Man Kin Luk (Record of the Countries of the Sea) printed in Ngai Hoi Chu Chan, 1744



- Legend:
- 2 Wu Tung City
 - 5 Tai Po Tau (Tai Po)
 - 6 Kowloon
 - 7 Lei Yue Mun
 - 8 Tuen Mun
 - 11 Tai Hai / Kai Shan (Lantau)
 - 12 Kap Shui Mun
 - 13 Red Incense Burner (Hong Kong)
 - 14 Ngong Shuen Chan (Stonecutters Island)

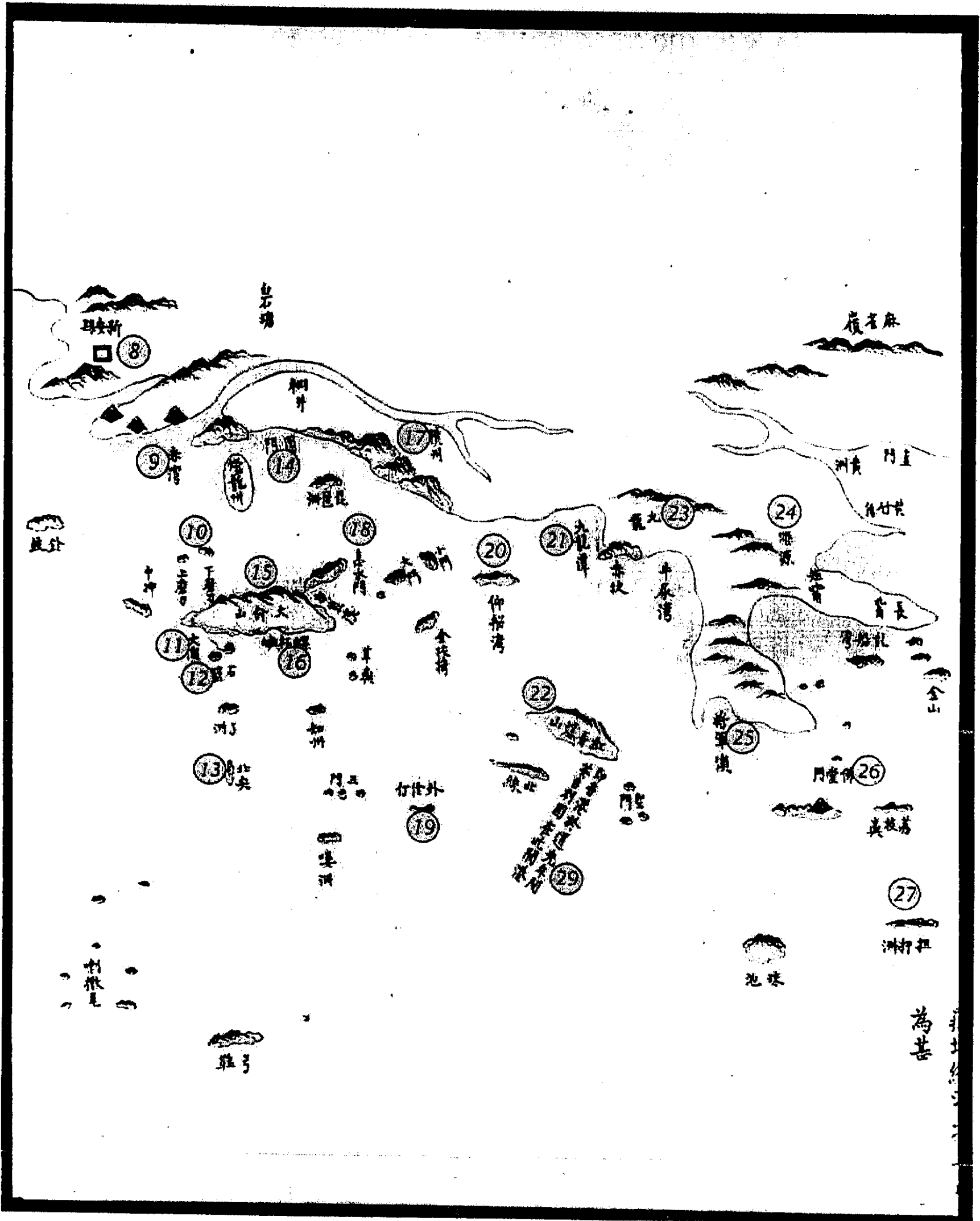

- | | | | | |
|---------|----|---------------|----|-------------------------------------|
| Legend: | 8 | San On County | 19 | Ngoi Ling Ding |
| | 9 | Chik Wan | 20 | Stonecutters Island |
| | 11 | Tai O | 21 | Kowloon Tam |
| | 12 | Shek Pik | 22 | Hung Heung Lo Shan |
| | 13 | Beijian | 23 | Kowloon |
| | 14 | Tuen Mun | 24 | Lek Yuen |
| | 15 | Tai Yue Shan | 25 | Junk Bay |
| | 16 | Loh Pui O | 26 | Fat Tong Mung |
| | 17 | Wang Chau | 27 | Tam Kon Chau |
| | 18 | Kap Shui Mun | | founded a port in the Ching Dynasty |

Drawing No. 22936/EN/029 1840 Map of the Coast of China

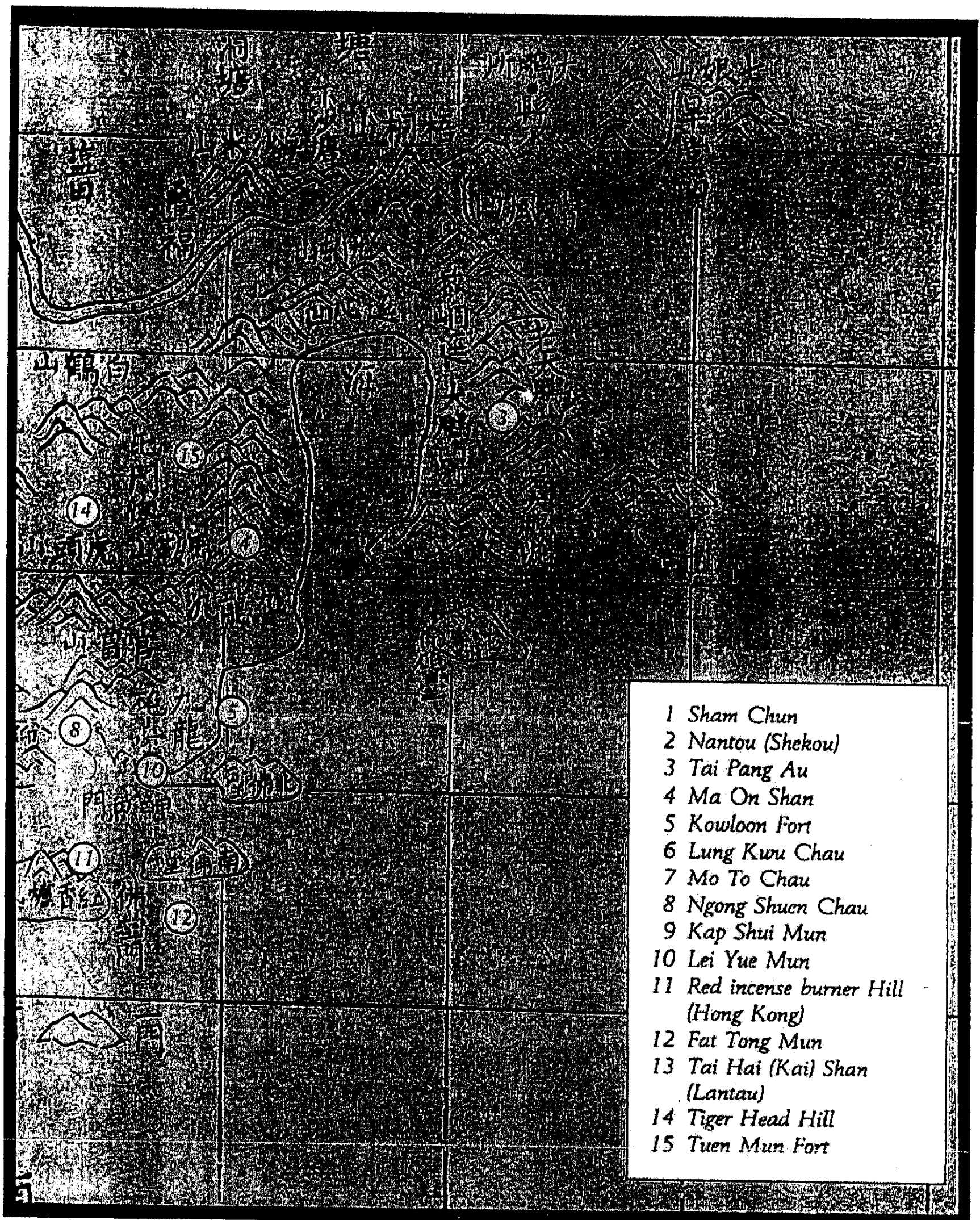

Drawing No. 22936/EN/030 Sun On District from a Kwang Tung Gazetteer, c.1864

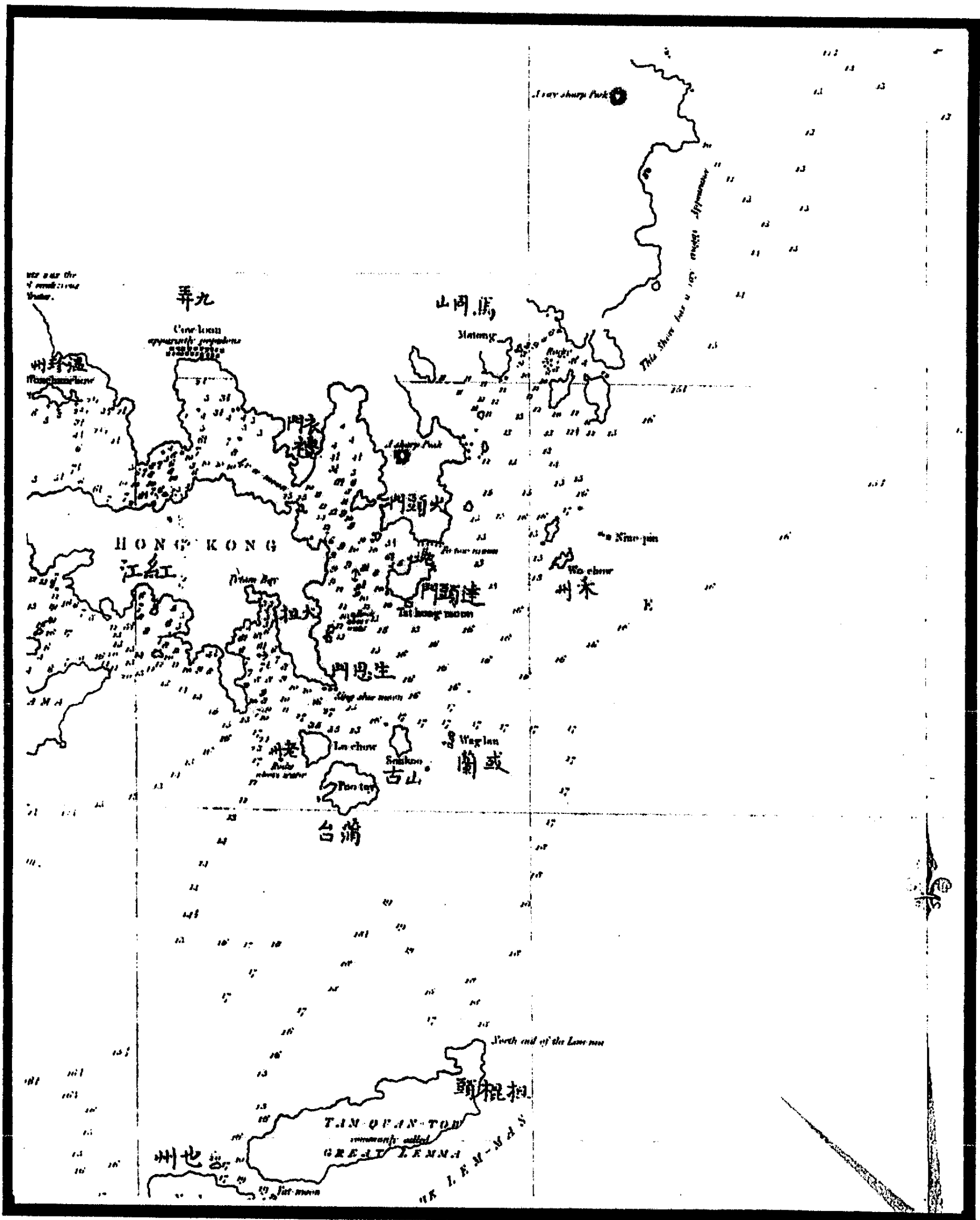

Drawing No. 22936/EN/031 Section of a Marine Chart of Macau Roads prepared for the East India Company by Daniel Ross and Philip Maughan, Lieutenants of the Bombay Marine

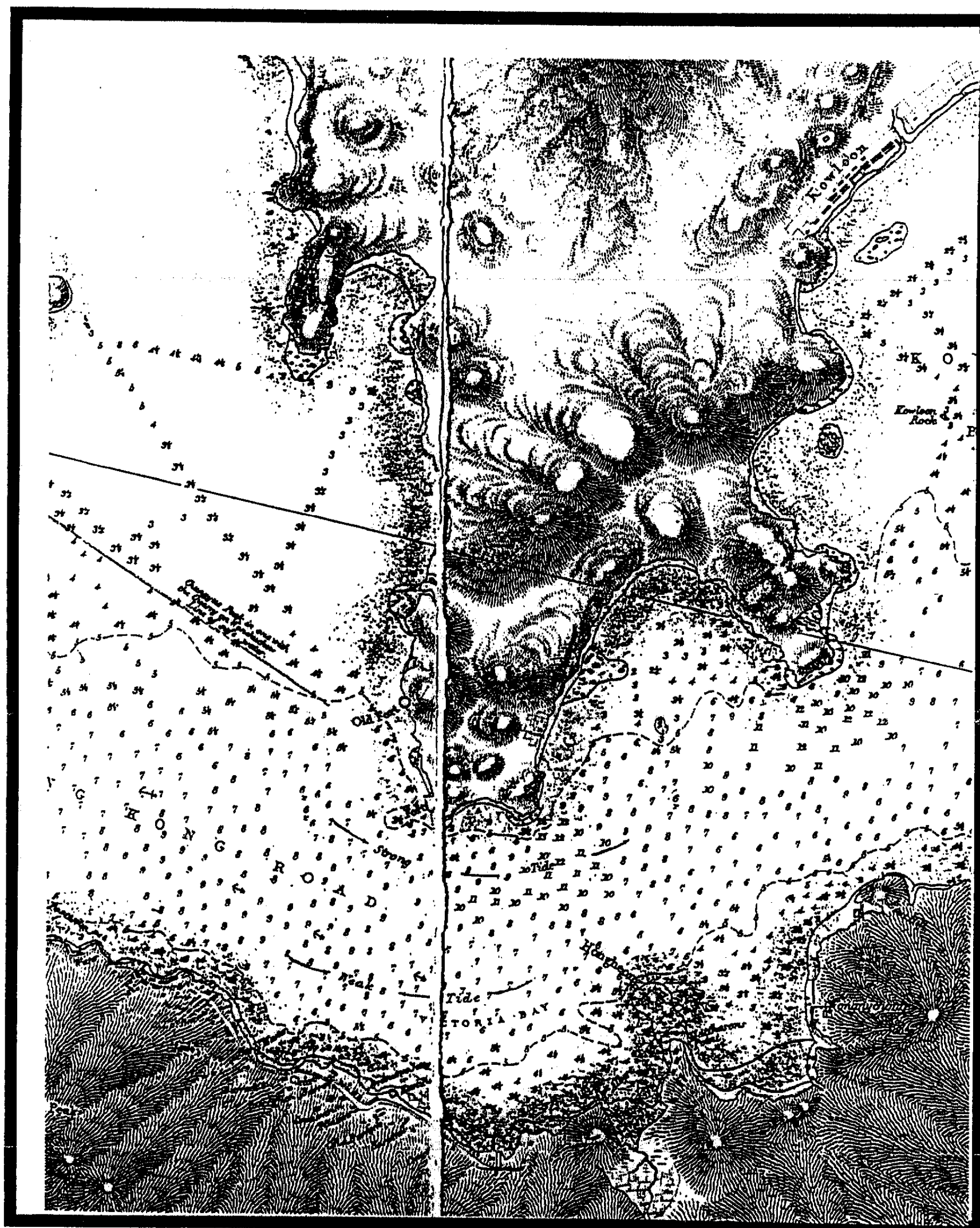

Drawing No. 22936/EN/032 British Admiralty Chart prepared following Hydrographic Surveys by Sir Edward Belcher

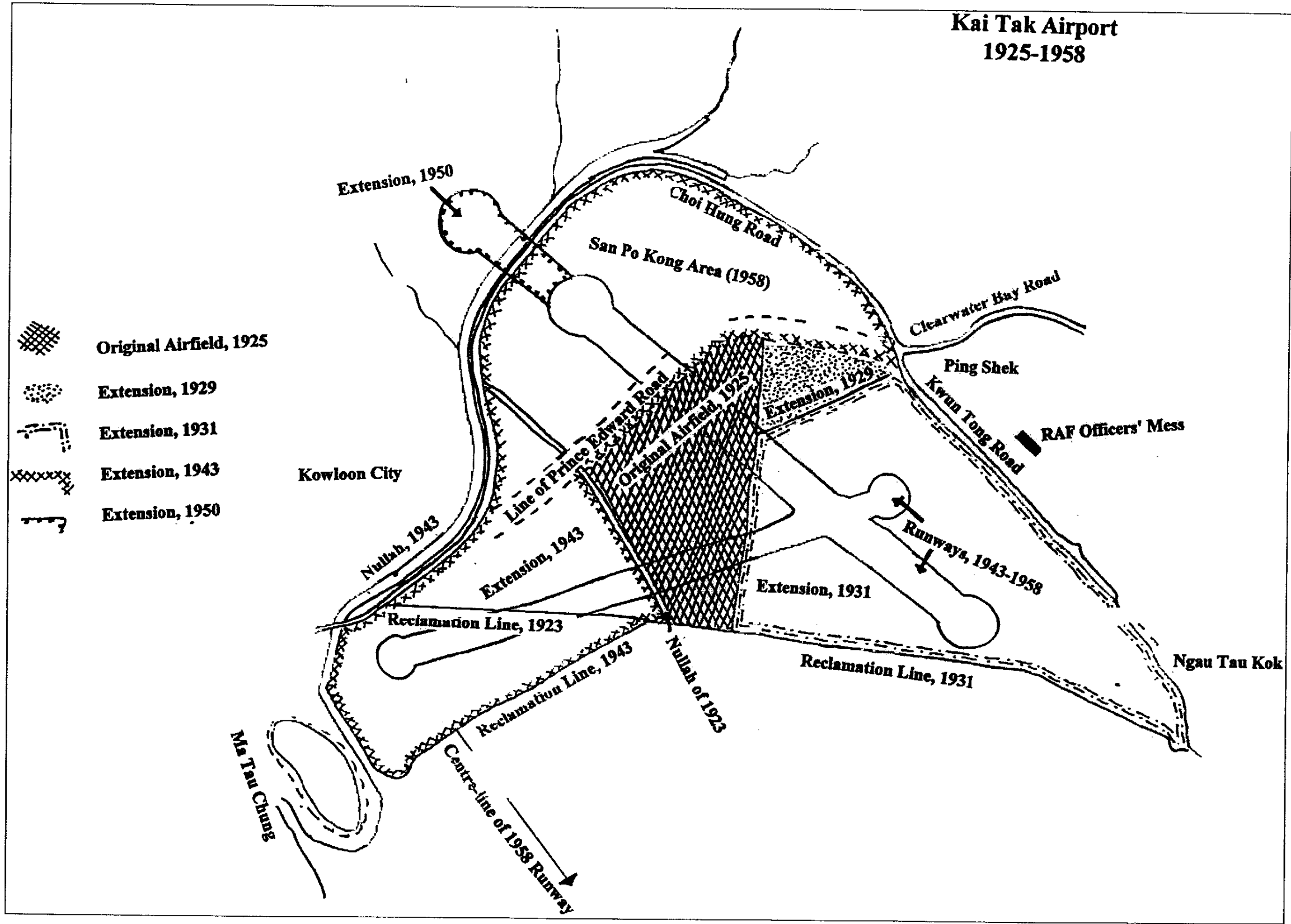

Drawing No. 22936/EN/108 Kai Tak Airport 1925 - 1958

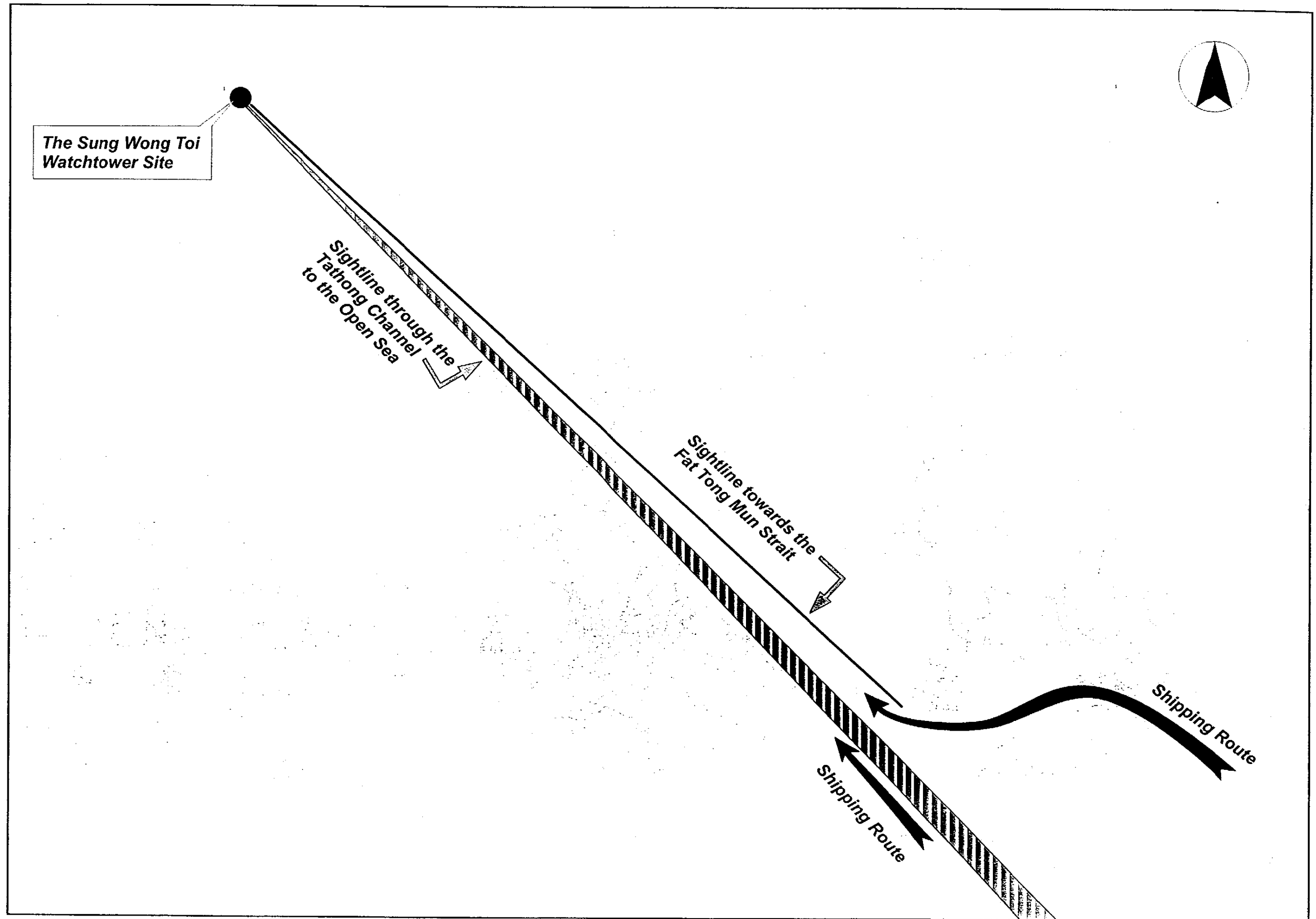

Drawing No 22936/EN/109 The Sung Wong Toi and the Sightlines to the Open Sea