

SECTION 9

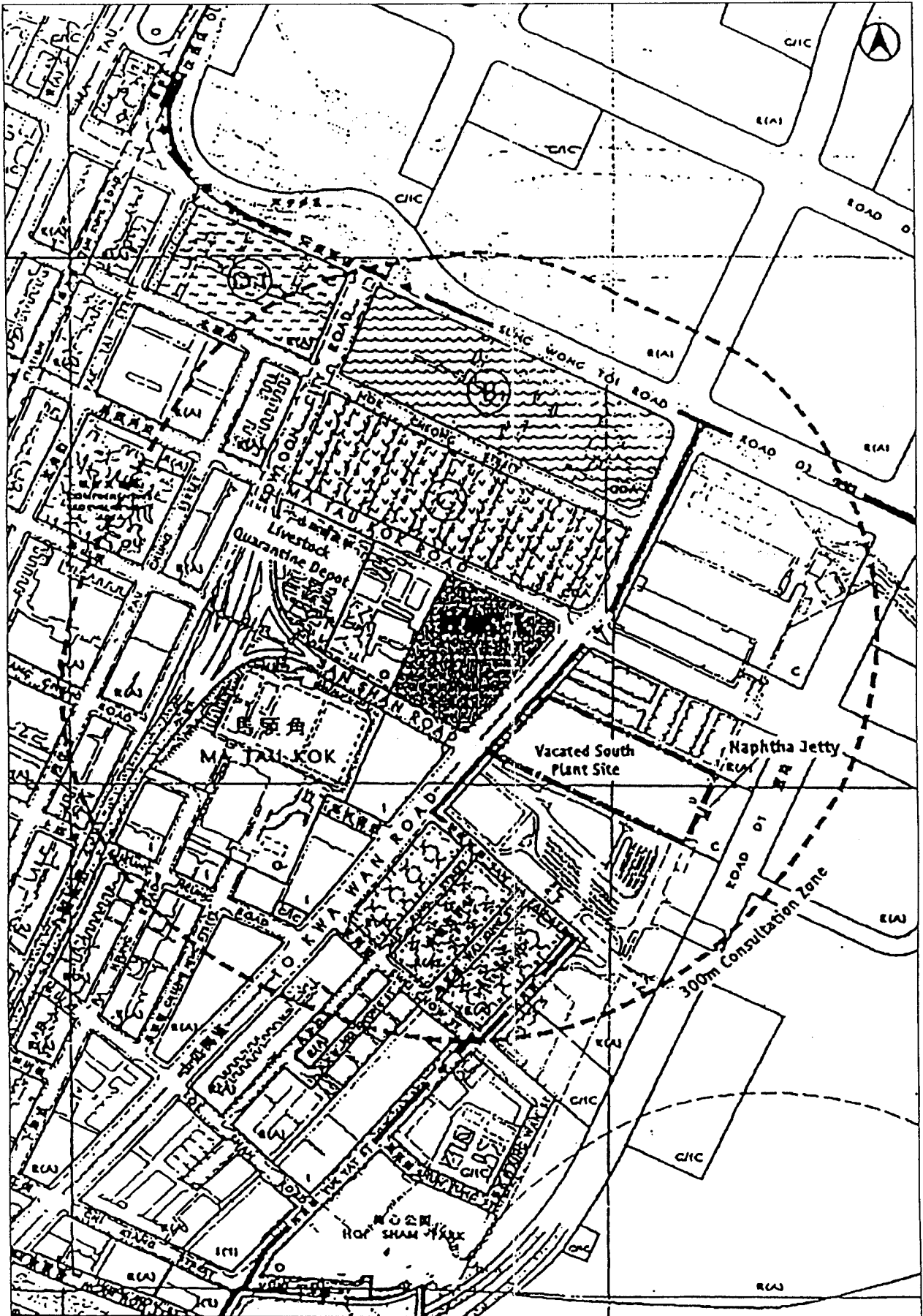

Drawing No. 22936/EN/034 Consultation Zone of the Ma Tau Kok Gas Works

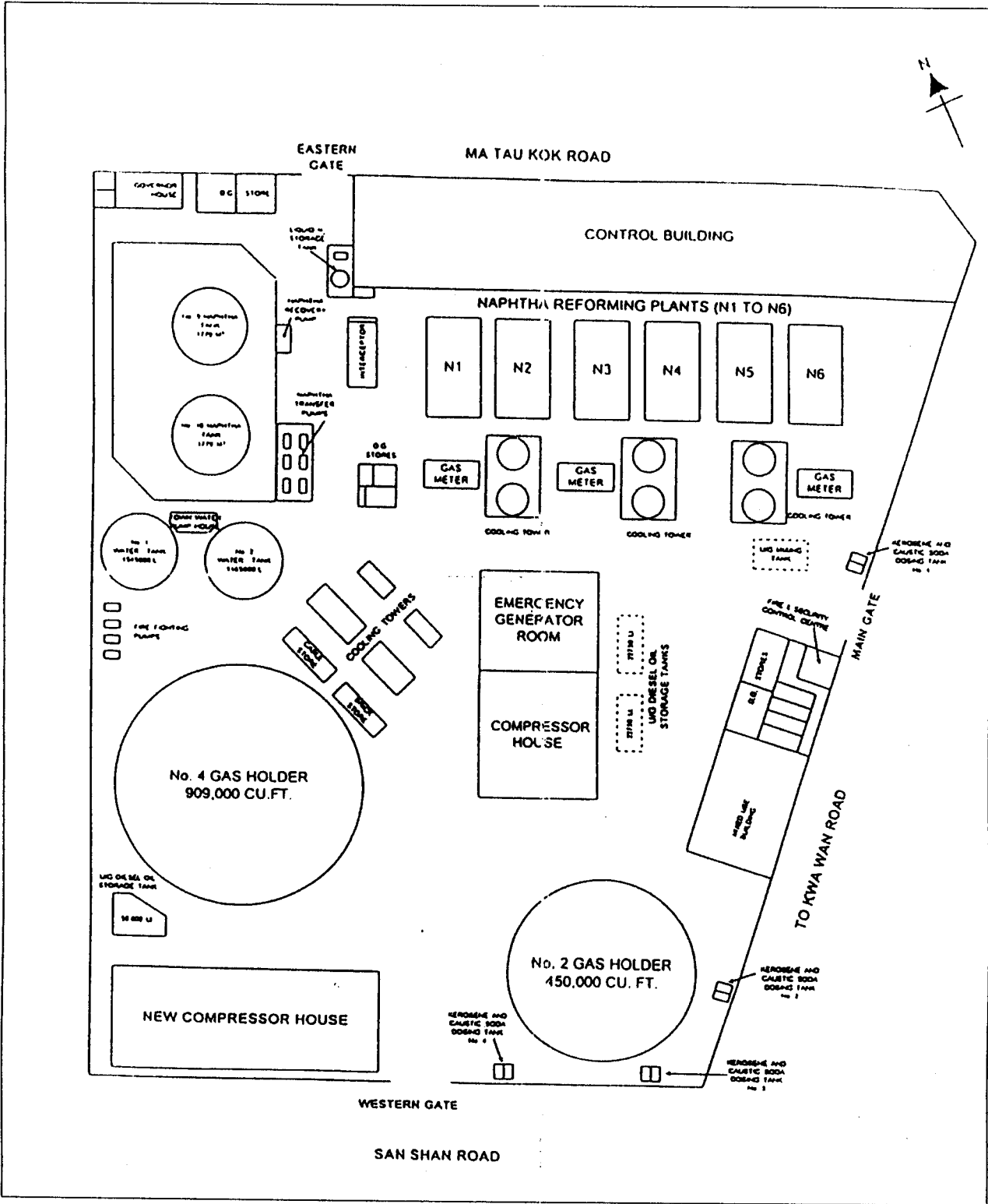

Drawing No. 22936/EN/035 Site Layout of Ma Tau Kok Gas Works

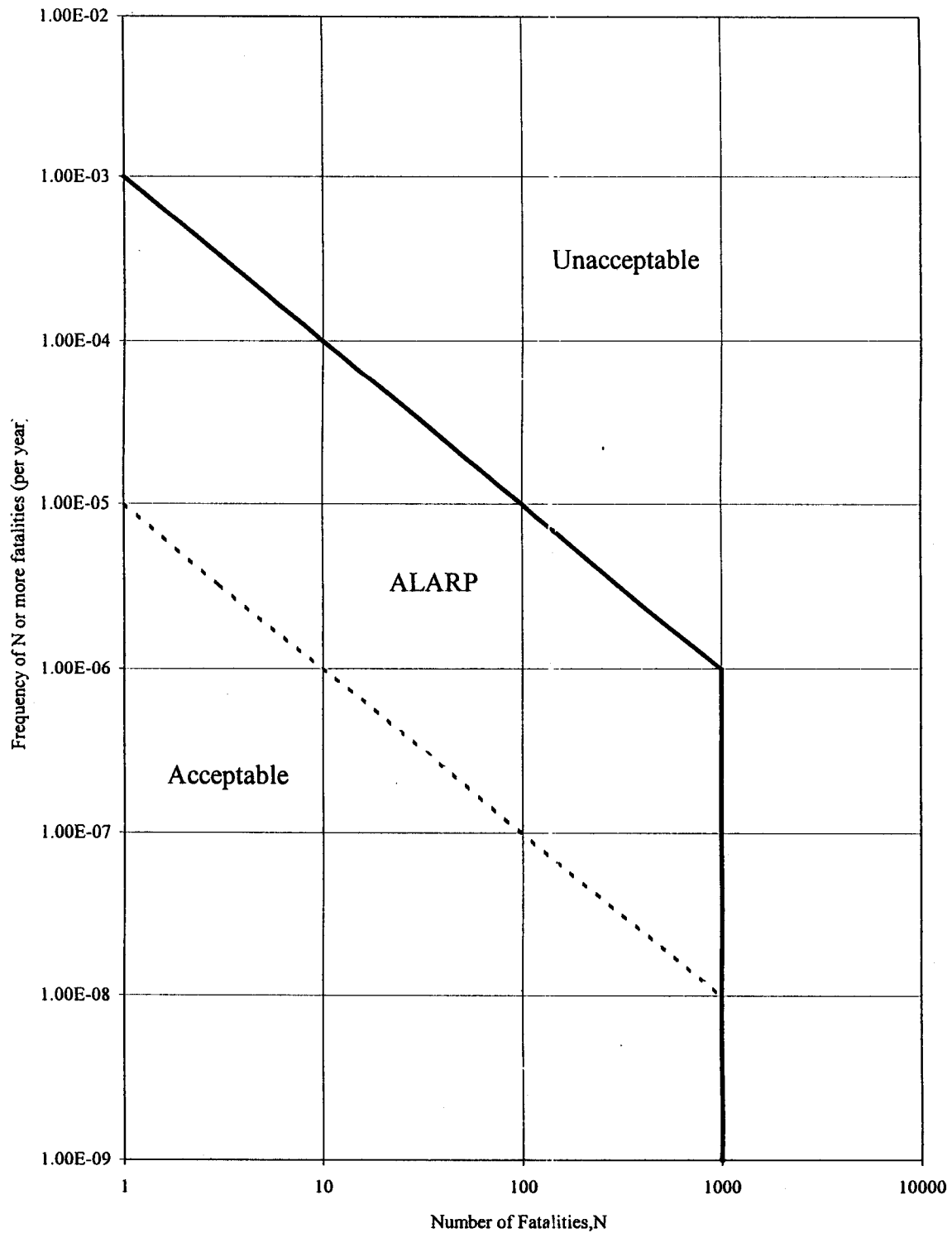

HK RG Upper Limit
 HK RG Lower Limit

Within the ALARP region, the acceptability of the societal risk is borderline and should be reduced to levels which are "as low as reasonably practical".



Drawing No. 22936/EN/110 Locations of Existing Hazardous Facilities

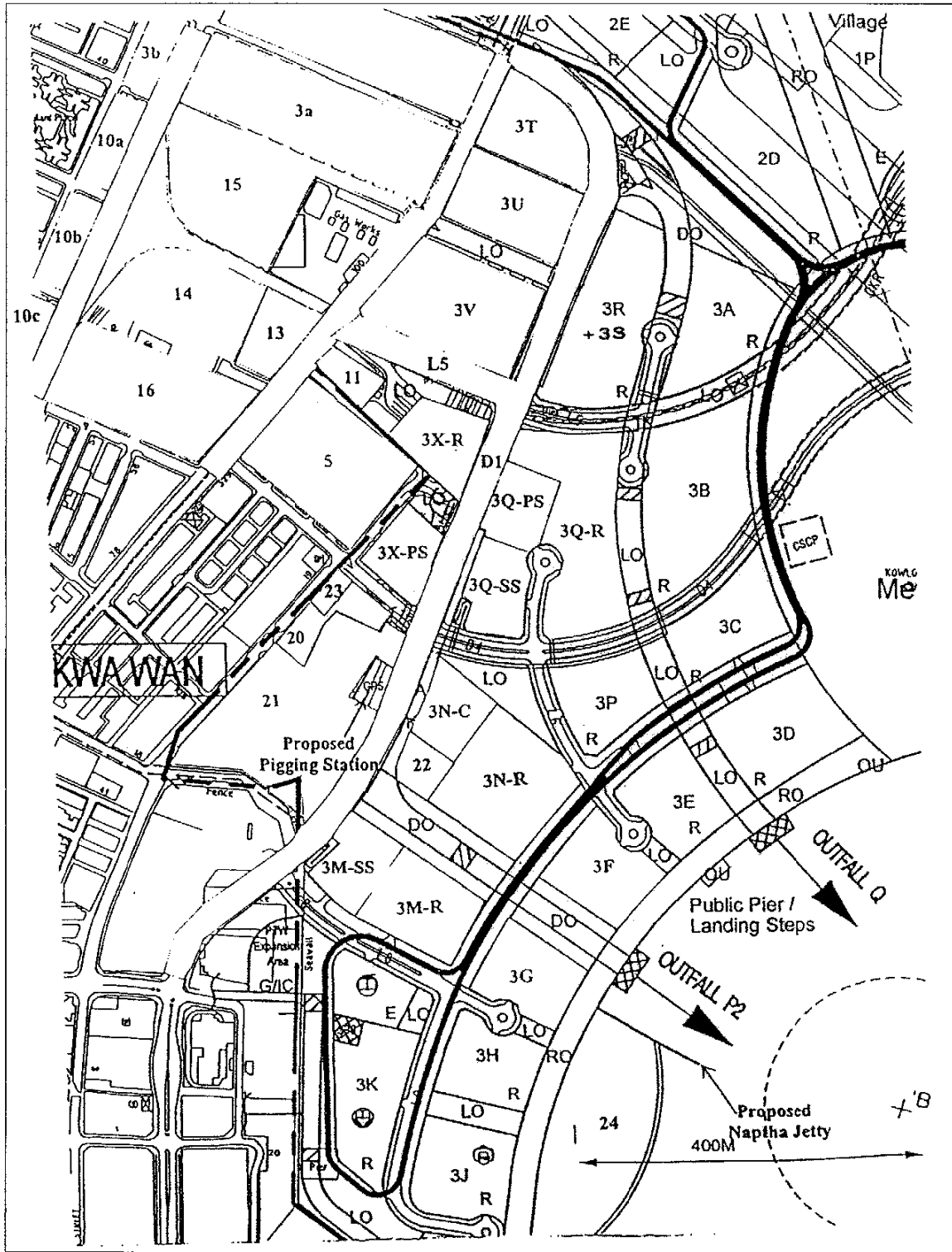

Drawing No. 22936/EN/356 Population Around the Ma Tau Kok Gas Works

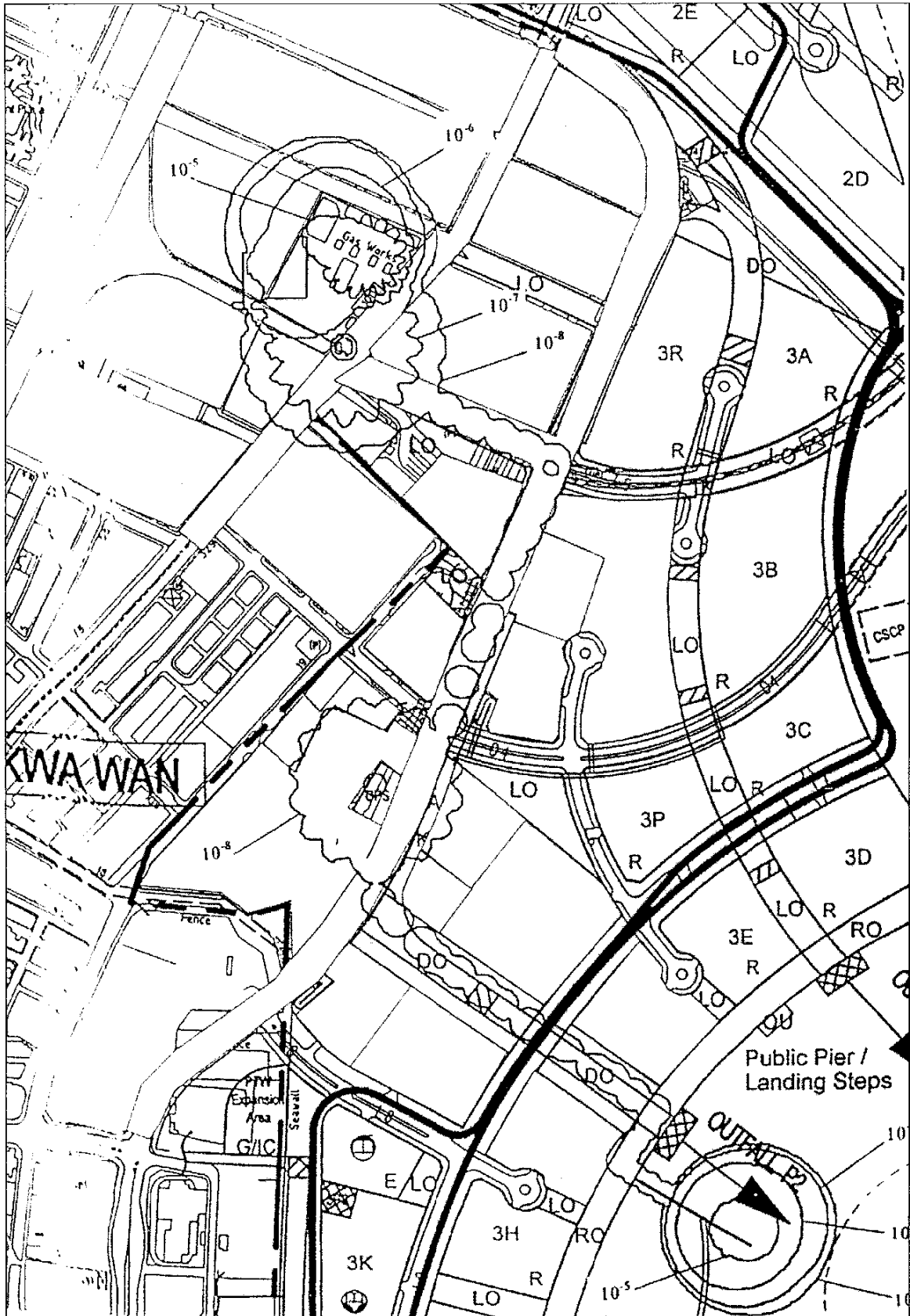

Drawing No. 22936/EN/357 Individual Risk Contours for Base Case
(Risk Assessment for Ma Tau Kok Gas Works)

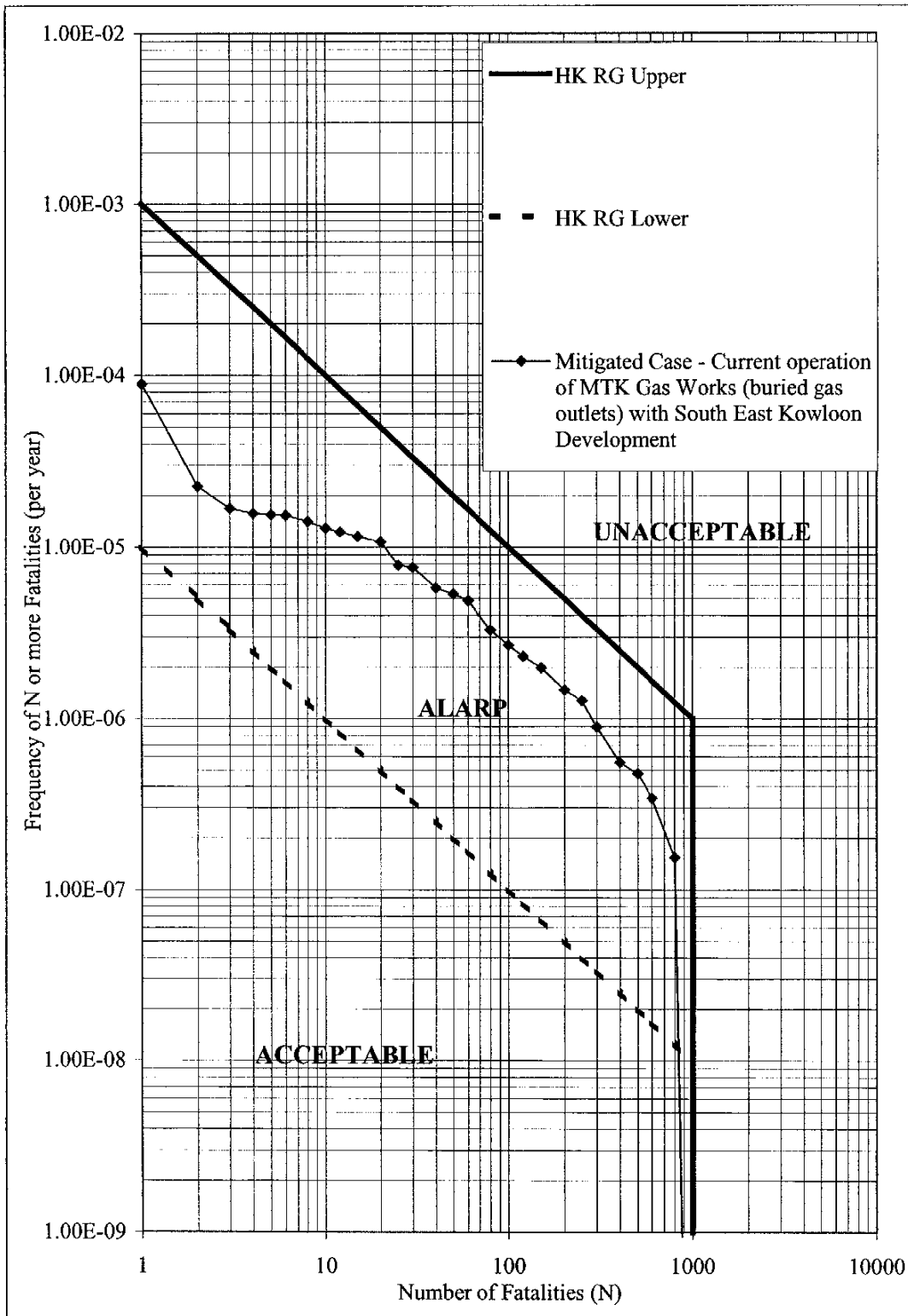

Drawing No. 22936/EN/358 FN Curve for Base Case
(Risk Assessment for Ma Tau Kok Gas Works)

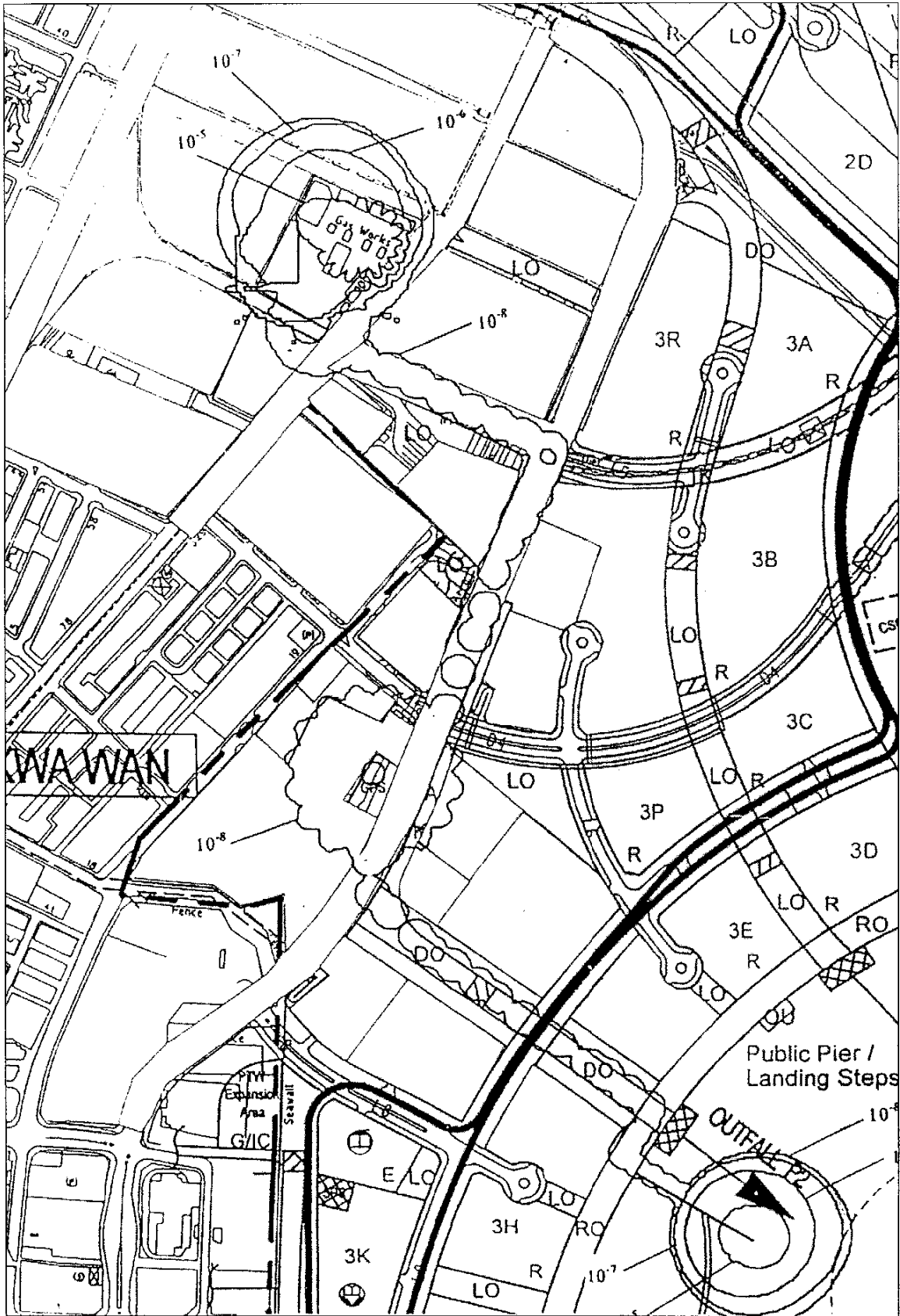

**Drawing No. 22936/EN/359 Individual Risk Contours for Mitigated Base Case (Buried Gas Outlets)
 (Current Operation of MTK Gas Works with SEKD)
 (Risk Assessment for Ma Tau Kok Gas Works)**

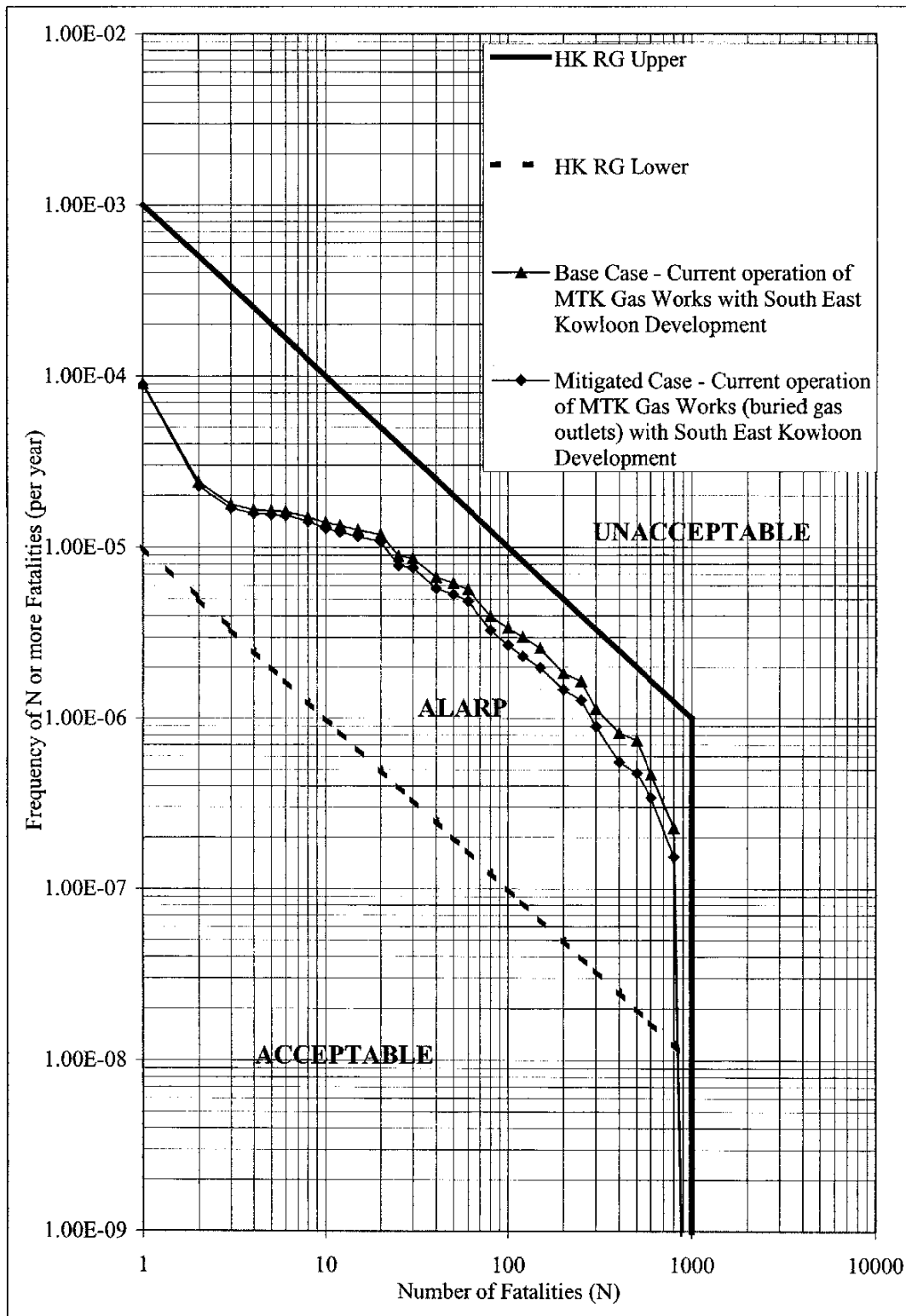

Drawing No. 22936/EN/360 FN Curve for Mitigated Base Case (Buried Gas Outlets)
 (Current Operation of MTK Gas Works with SEKD)
 (Risk Assessment for Ma Tau Kok Gas Works)

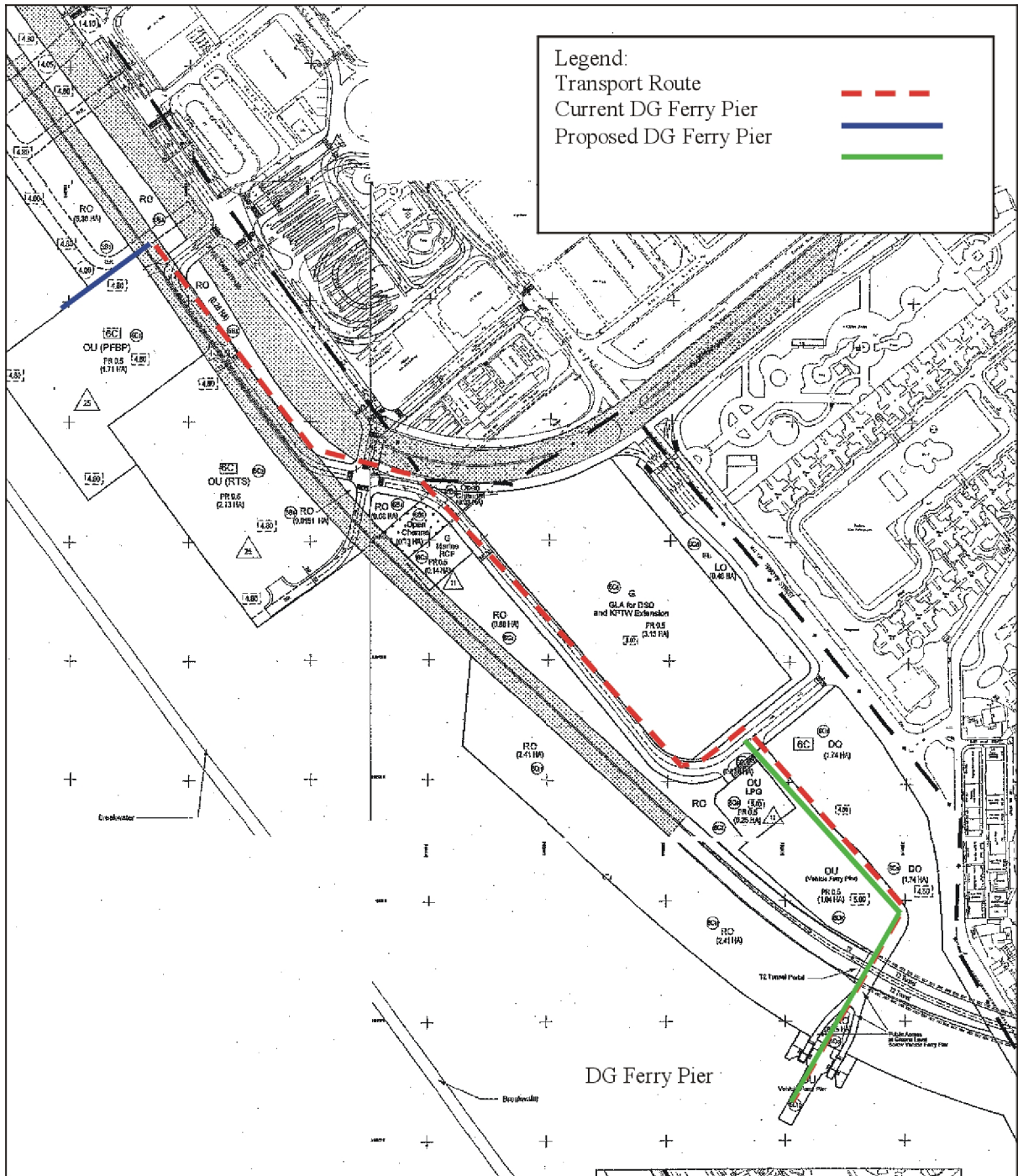

Drawing No. 22936/EN/361

Location of the Proposed Relocated DGVFP and Transport Route

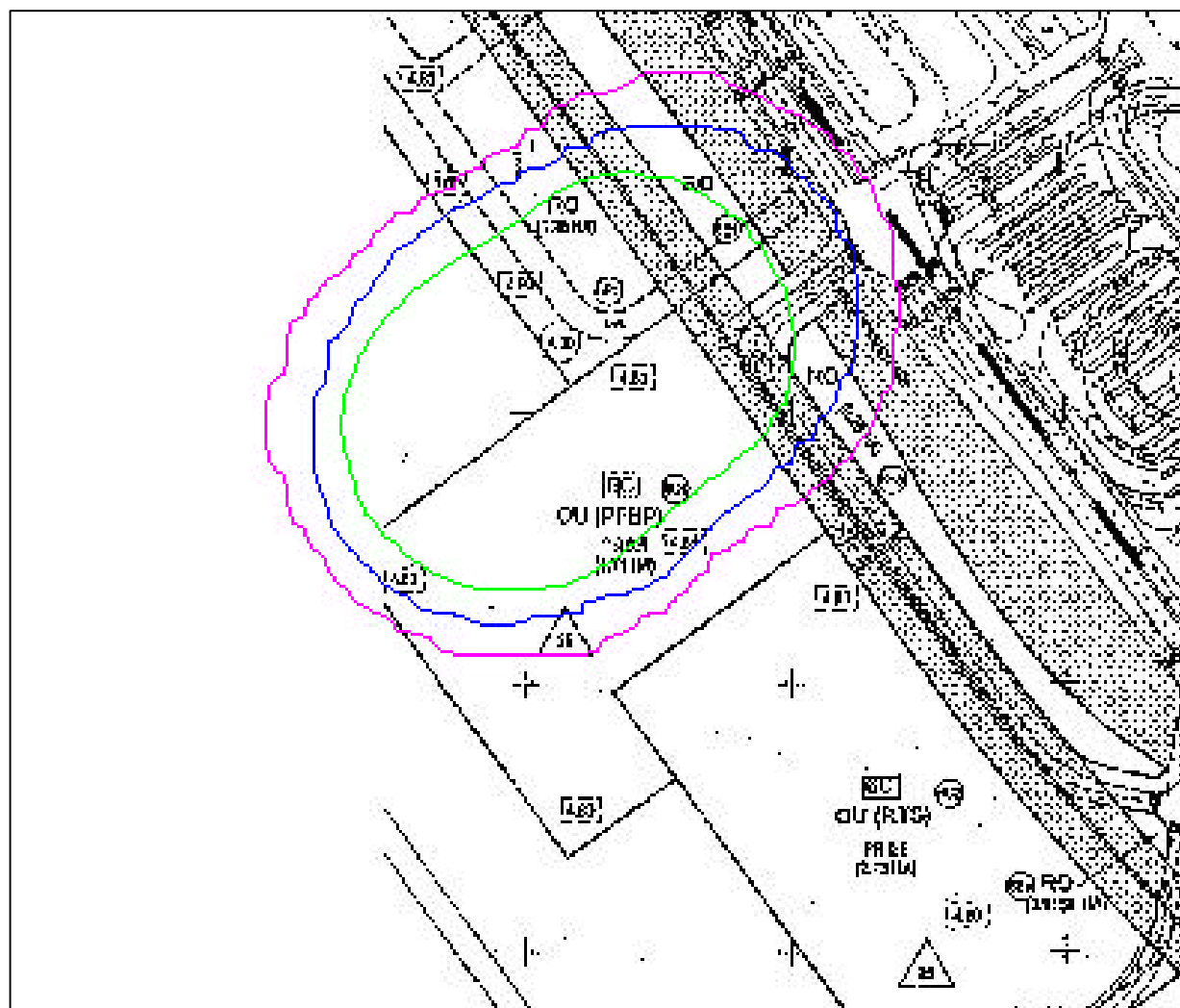

Legend:	
1 x 10 ⁻⁵ per year	—
1 x 10 ⁻⁶ per year	—
1 x 10 ⁻⁷ per year	—
1 x 10 ⁻⁸ per year	—

Drawing No. 22936/EN/393

Individual Risk Contour, Current Pier Location
 Combined 2001 DG Trade

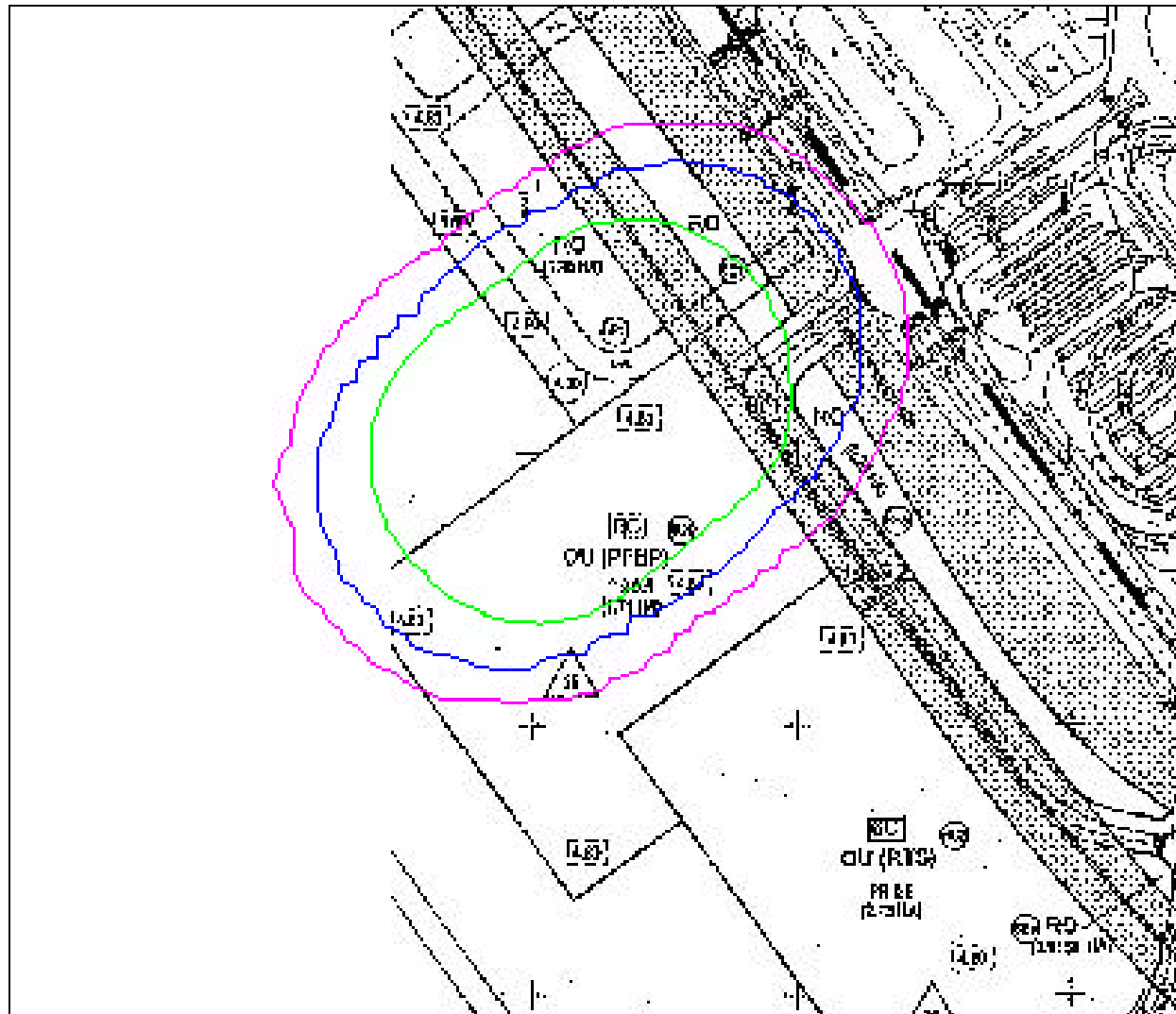

Legend:

1×10^{-5} per year	Red line
1×10^{-6} per year	Green line
1×10^{-7} per year	Blue line
1×10^{-8} per year	Magenta line

Drawing No. 22936/EN/394

Individual Risk Contour, Current Pier Location
2001 LPG Trade

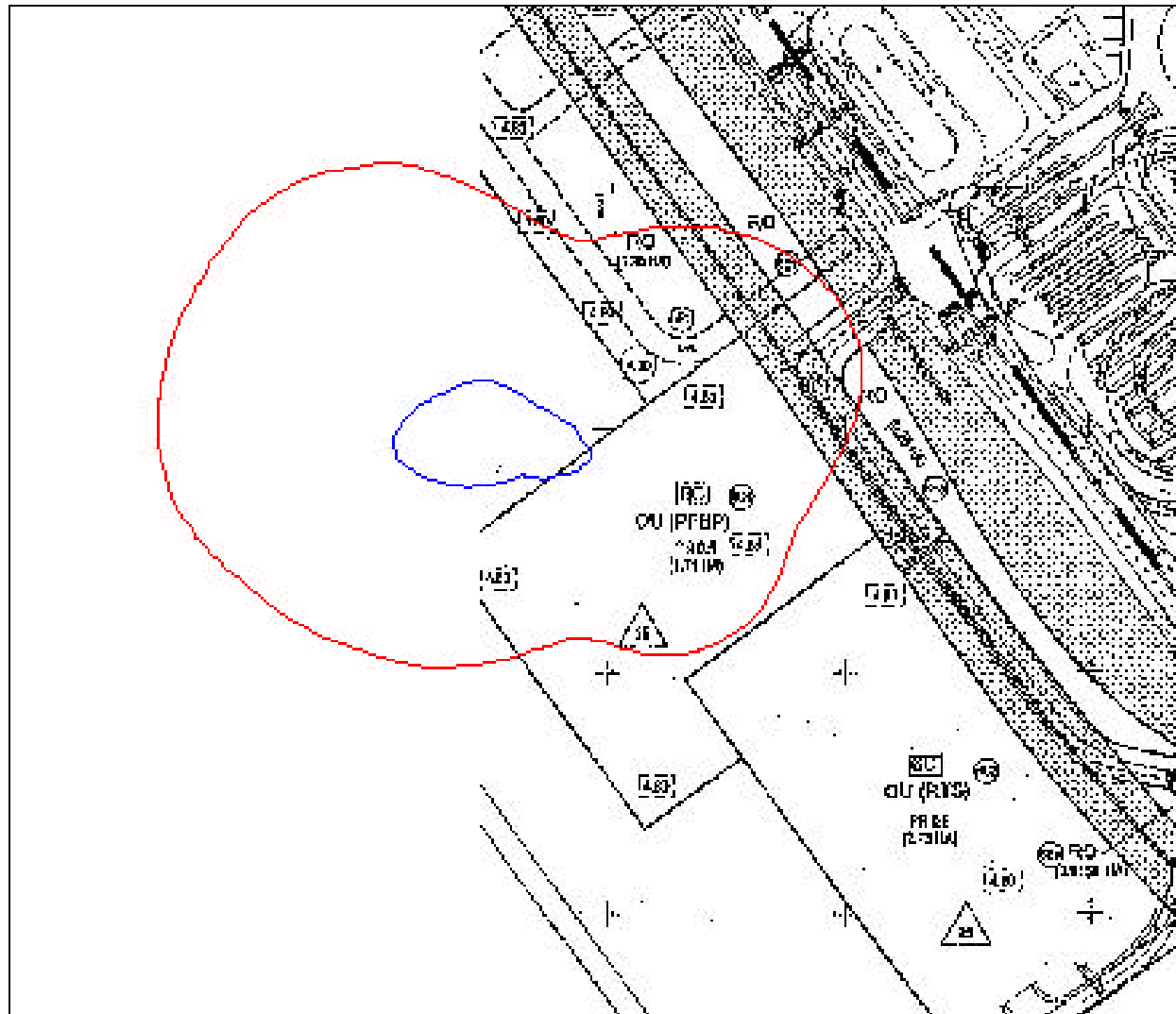

Legend:
 1×10^{-8} per year ————
 1×10^{-9} per year ————

Drawing No. 22936/EN/395

Individual Risk Contour, Current Pier Location
2001 Chlorine Trade

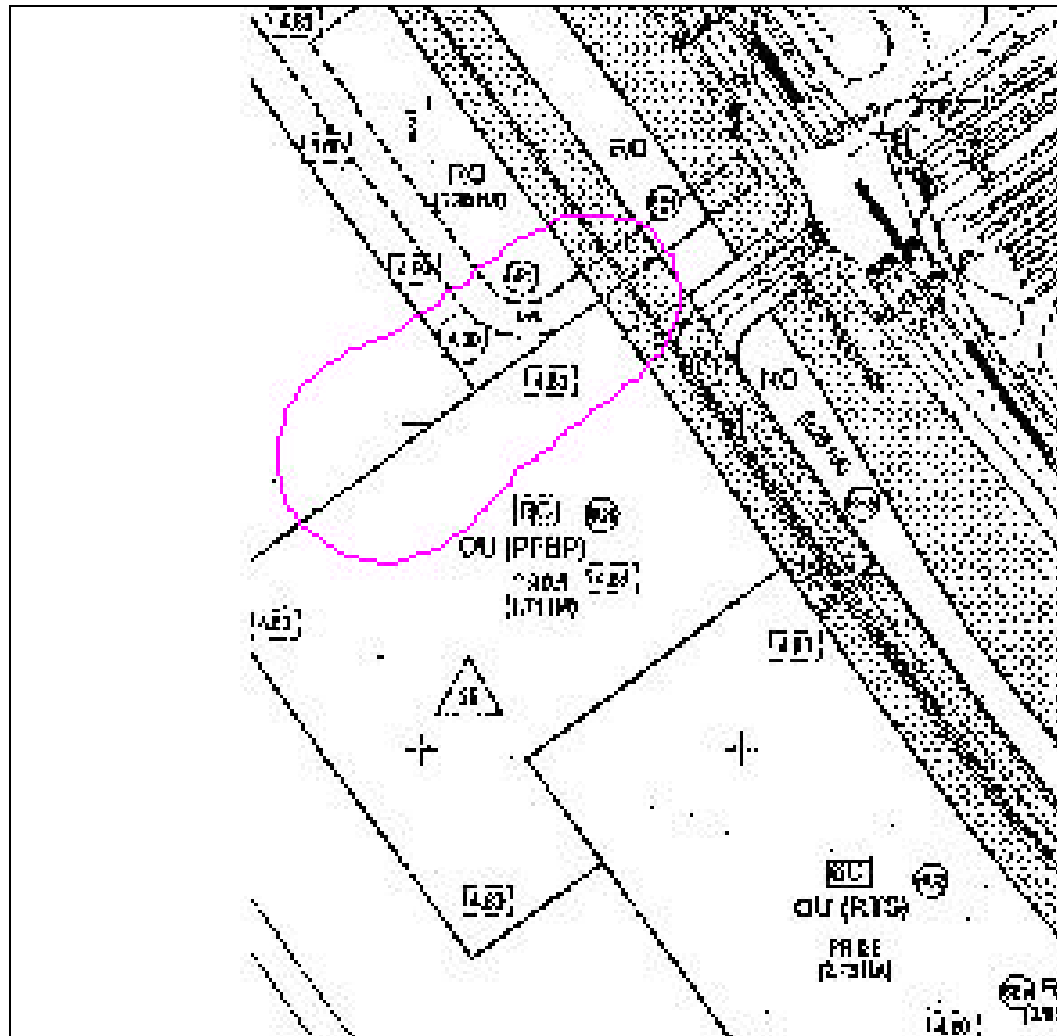

Legend:

1×10^{-5} per year	—
1×10^{-6} per year	—
1×10^{-7} per year	—
1×10^{-8} per year	—

Drawing No. 22936/EN/396

Individual Risk Contour, Current Pier Location
2001 Hydrocarbon Trade

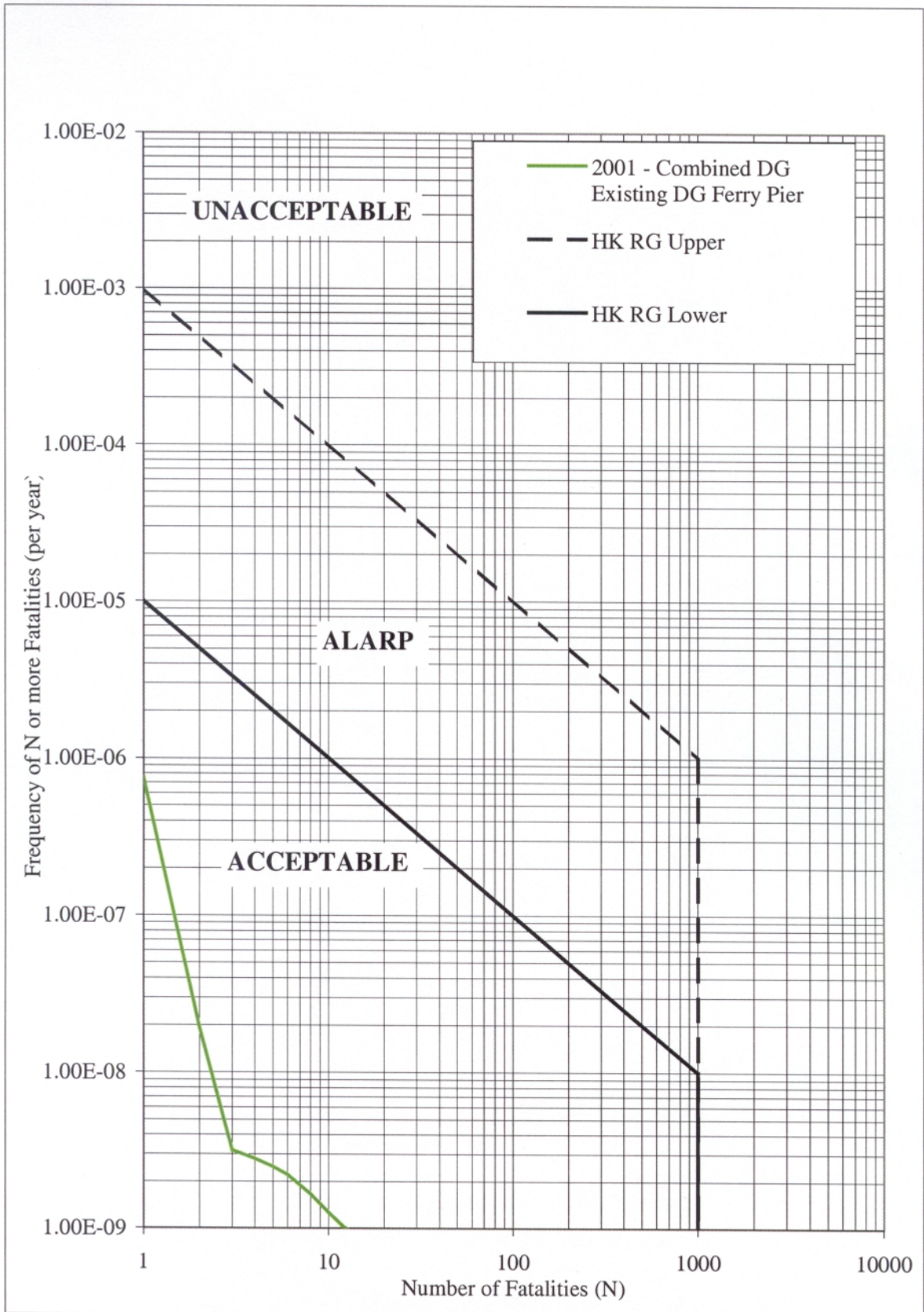

Drawing No. 22936/EN/397 Transport Risk Curve for Current Pier Location
2001 Combined 2001 Trade

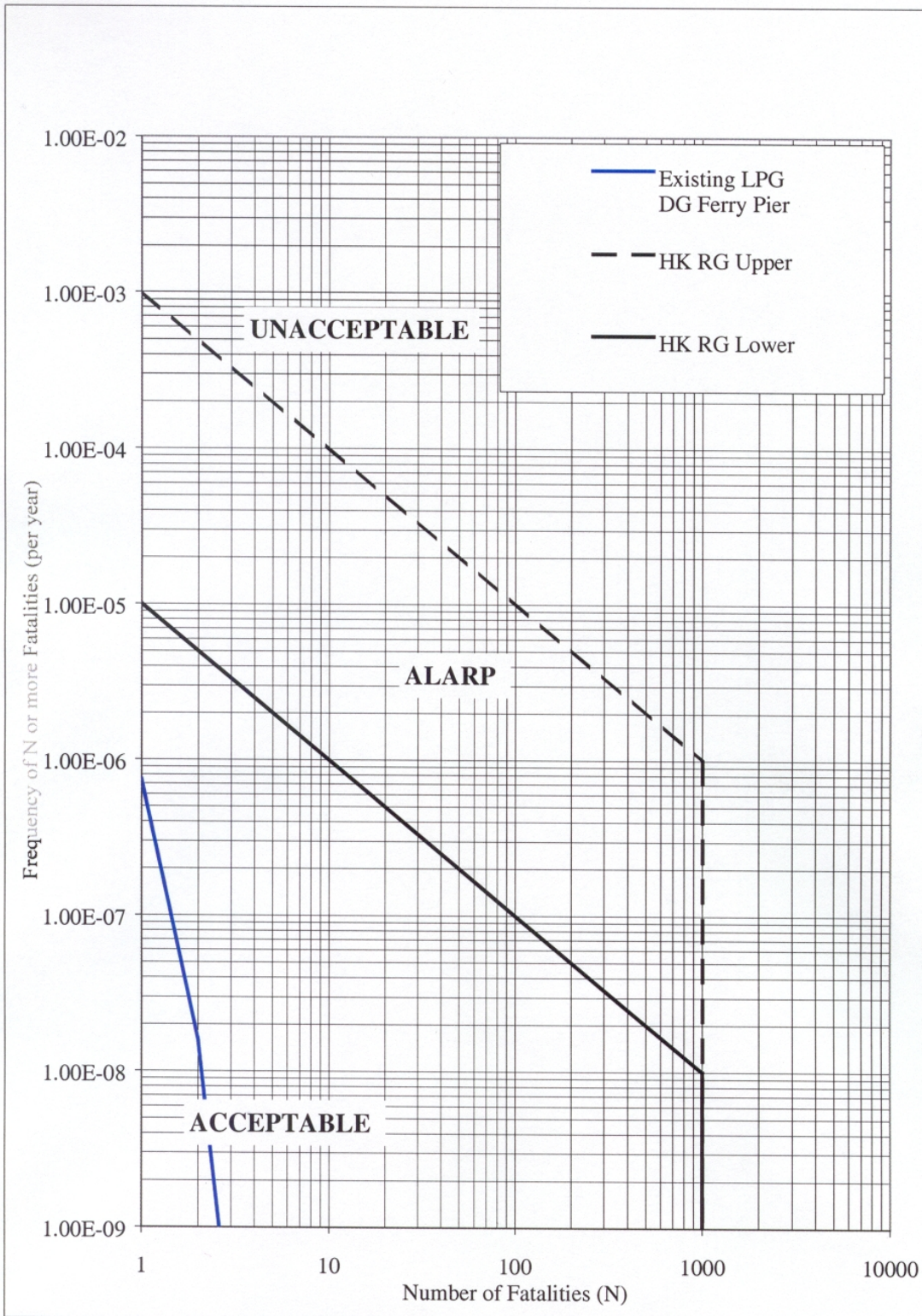

Drawing No. 22936/EN/398 Transport Risk Curve for Current Pier Location
2001 LPG Trade

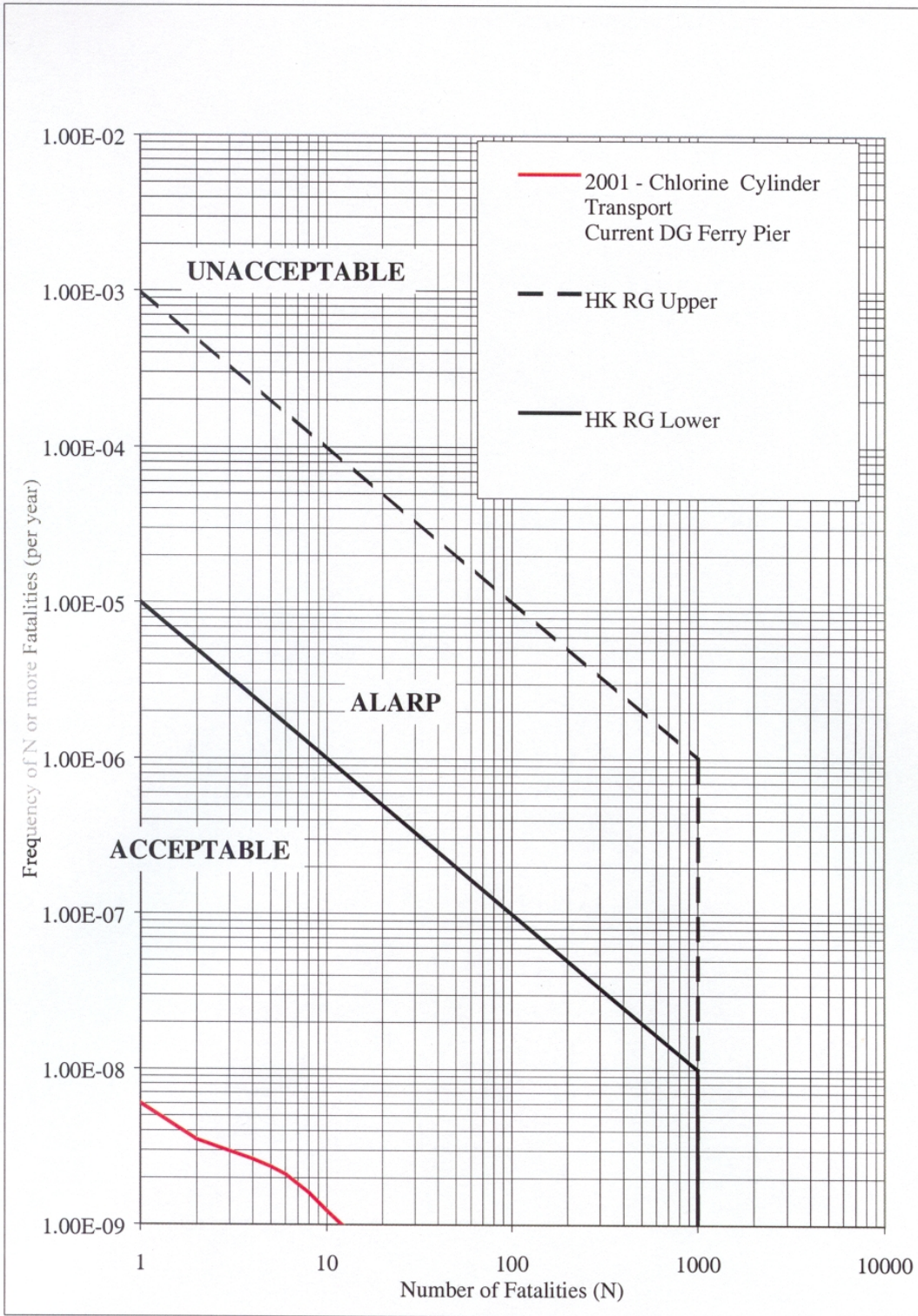

Drawing No. 22936/EN/399 Transport Risk Curve for Current Pier Location
2001 Chlorine Trade

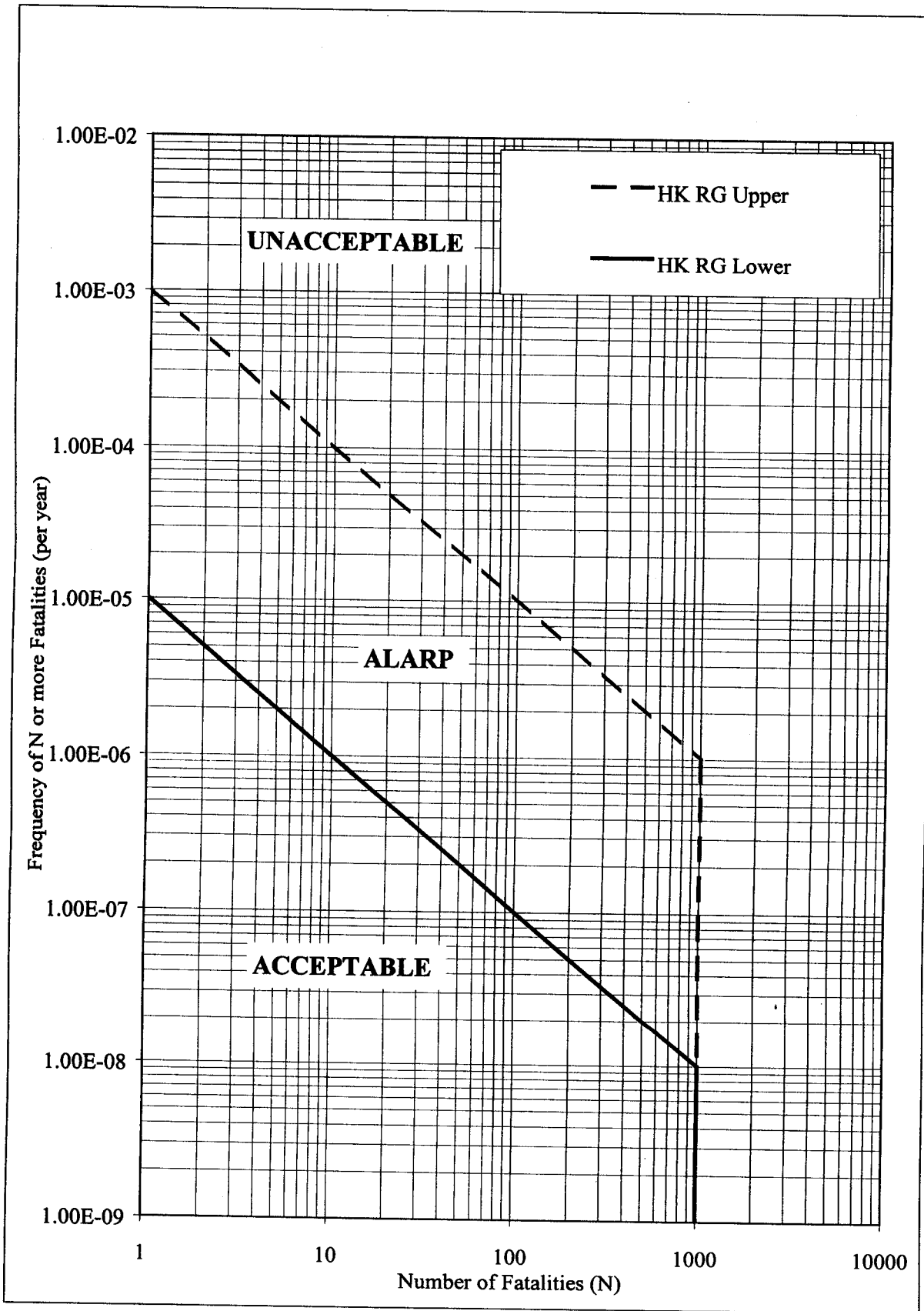

Drawing No. 22936/EN/400

Transport Risk Curve for Current Pier Location
2001 Hydrocarbon Trade

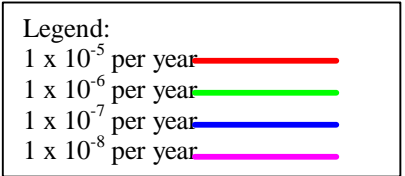
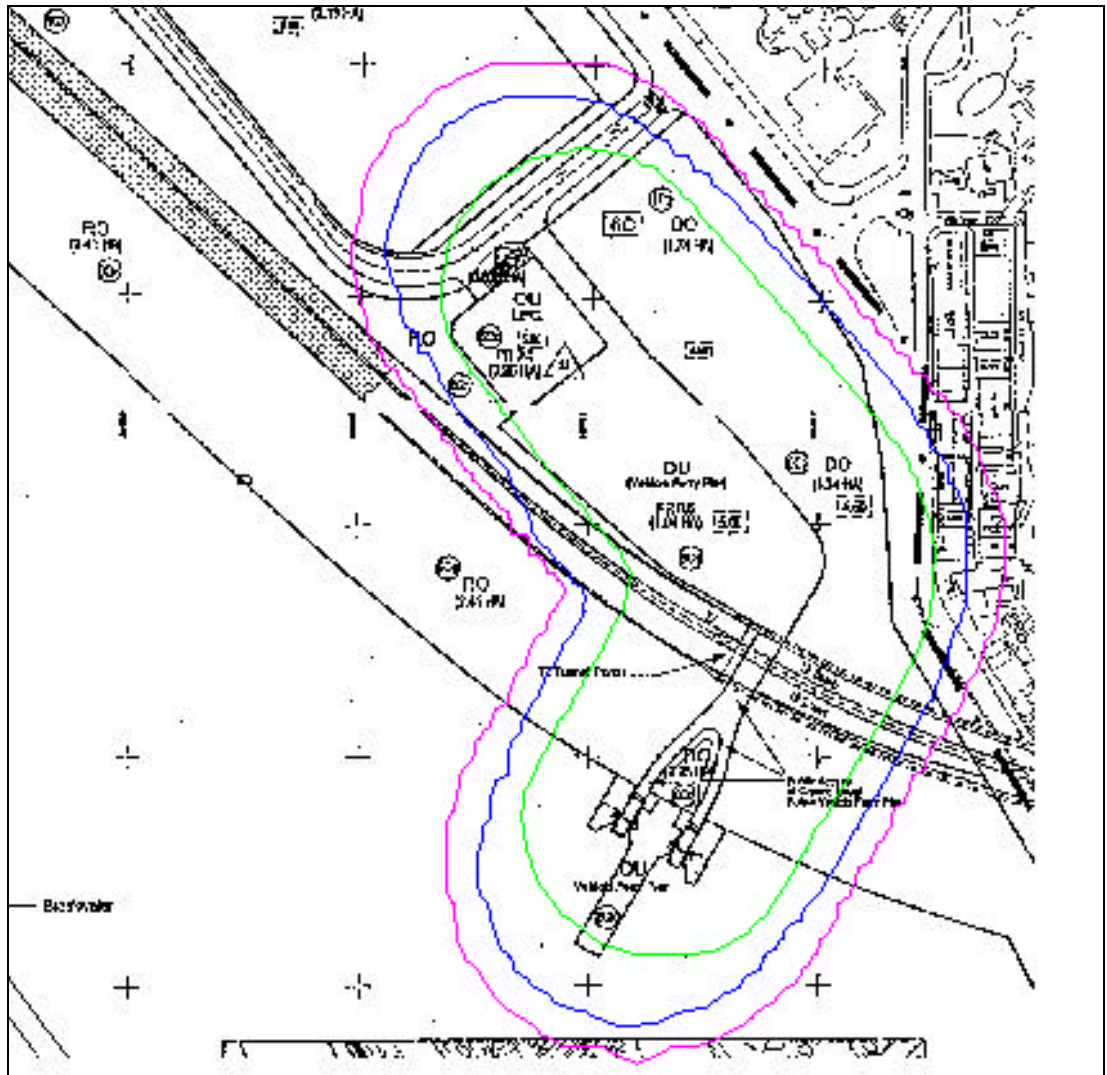

Drawing No. 22936/EN/401

Individual Risk Contour, Proposed Pier Location
 Combined DG Traffic - 2001

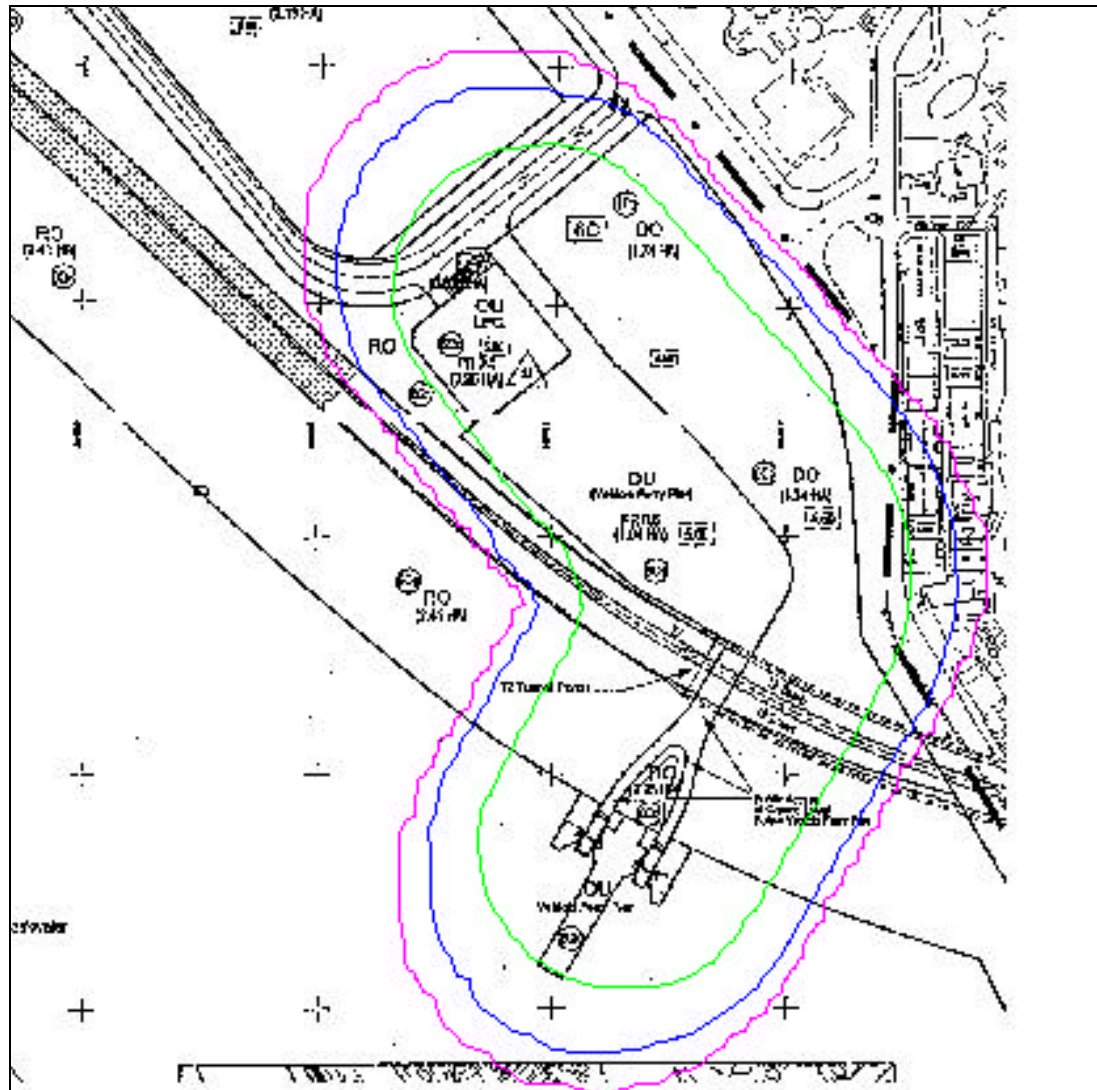

Legend:

1×10^{-5} per year	Red line
1×10^{-6} per year	Green line
1×10^{-7} per year	Blue line
1×10^{-8} per year	Magenta line

Drawing No. 22936/EN/402

Individual Risk Contour, Proposed Pier Location
 Combined DG Traffic - 2012

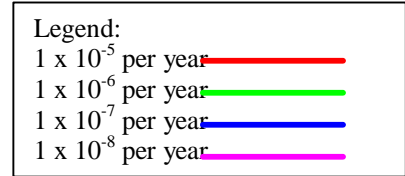
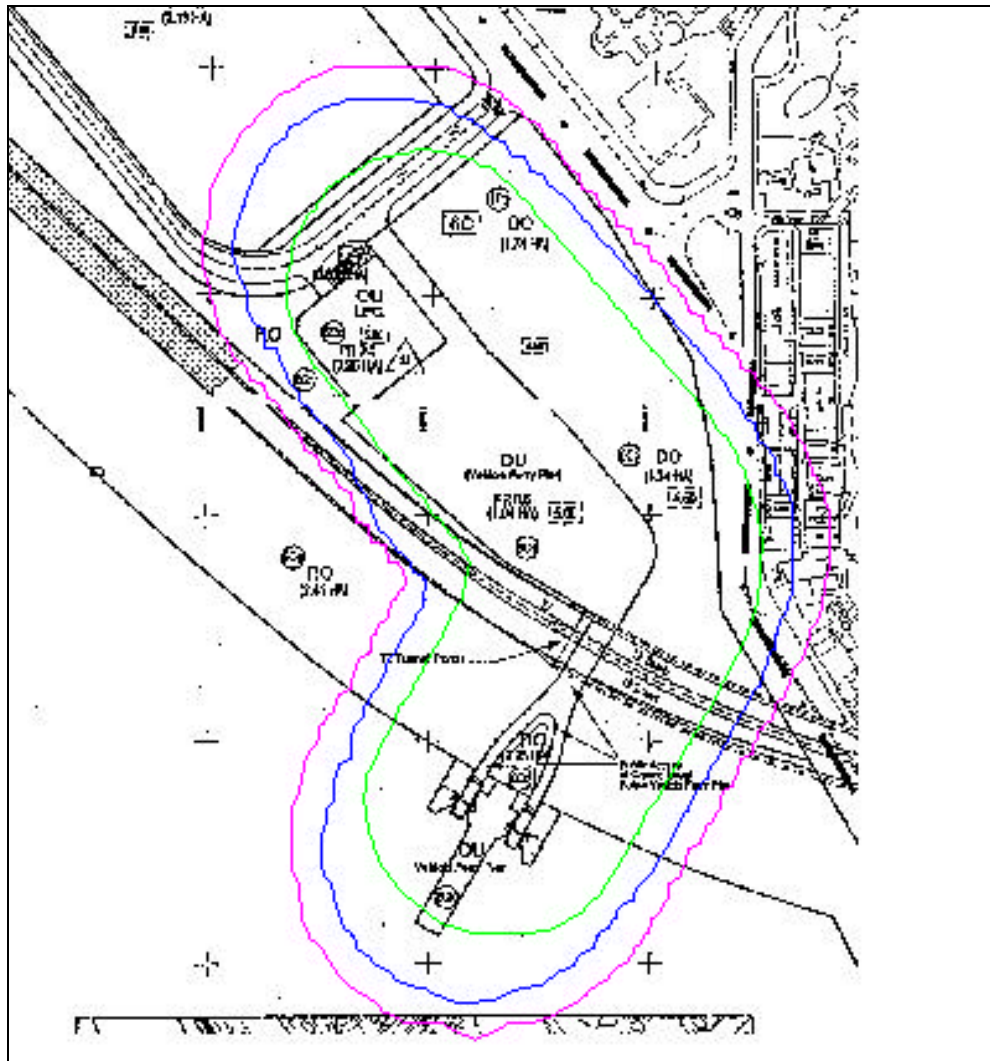

Drawing No. 22936/EN/403

Individual Risk Contour, Proposed Pier Location
LPG Transport - 2001

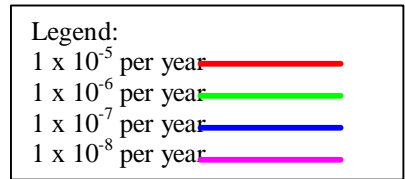
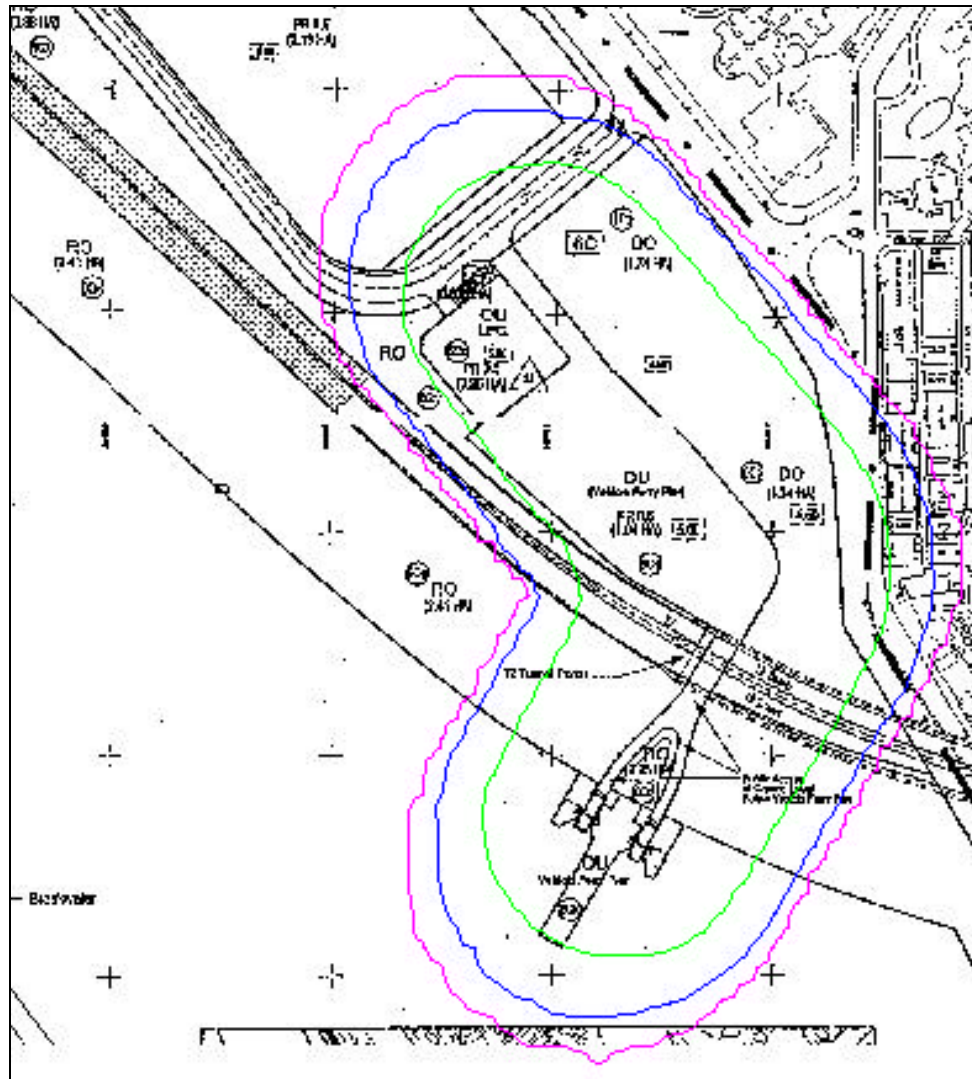

Drawing No. 22936/EN/404

Individual Risk Contour, Proposed Pier Location
LPG Transport - 2012

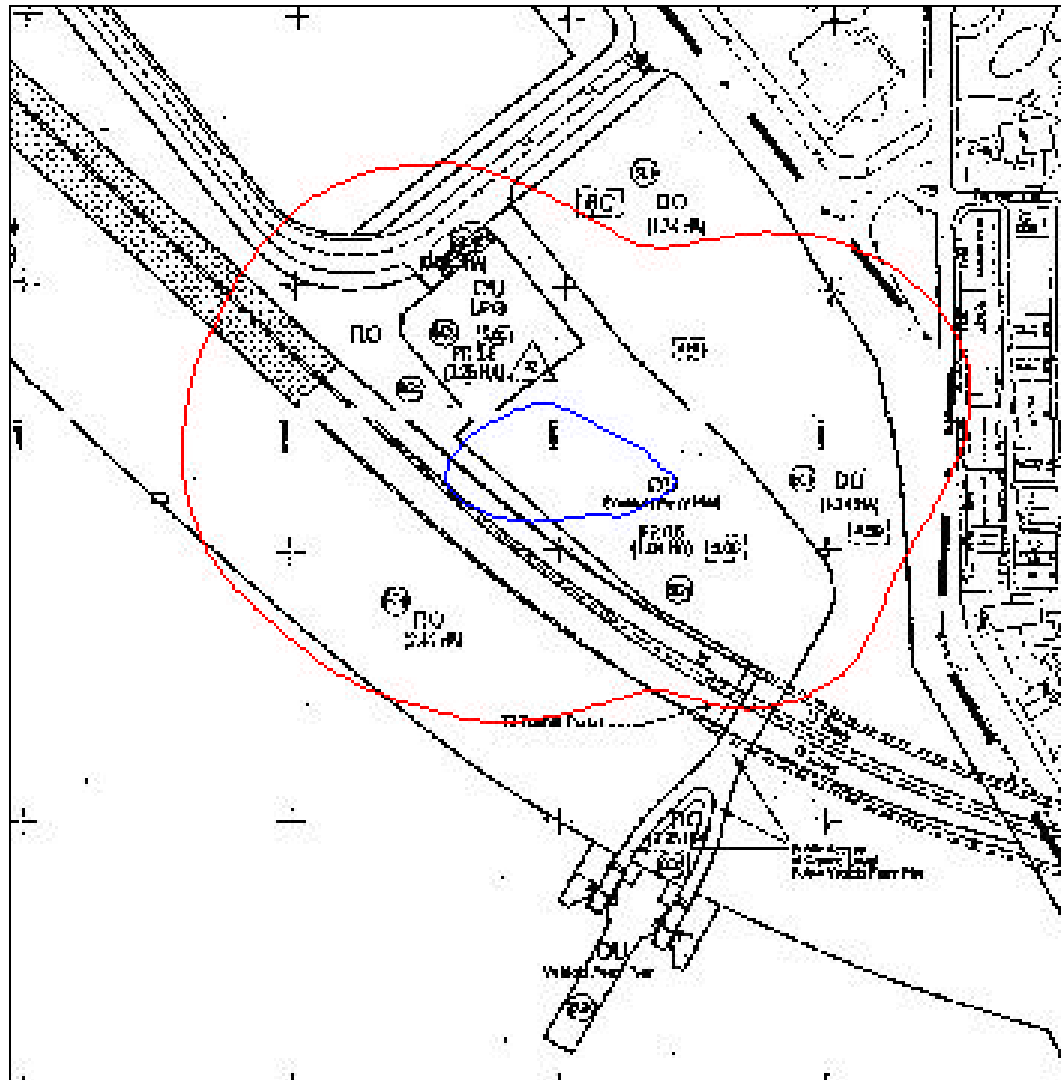

Legend:
 1×10^{-8} per year ———— (red line)
 1×10^{-9} per year ———— (blue line)

Drawing No. 22936/EN/405

Individual Risk Contour, Proposed Pier Location
 Chlorine Transport - 2001

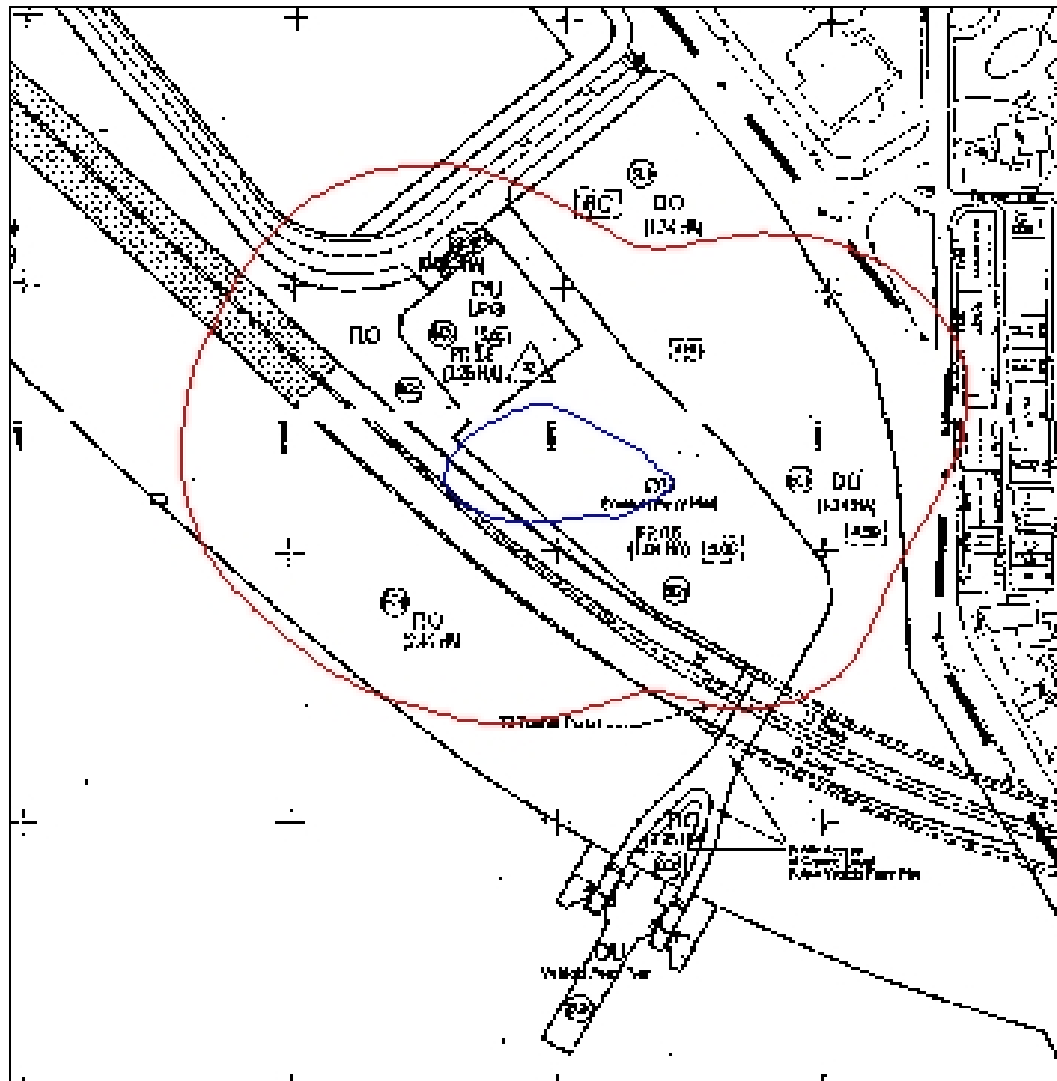

Legend:
 1×10^{-9} per year ———
 1×10^{-8} per year ———

Drawing No. 22936/EN/406 Individual Risk Contour, Proposed Pier Location

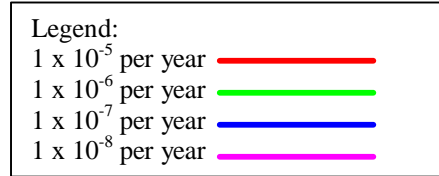
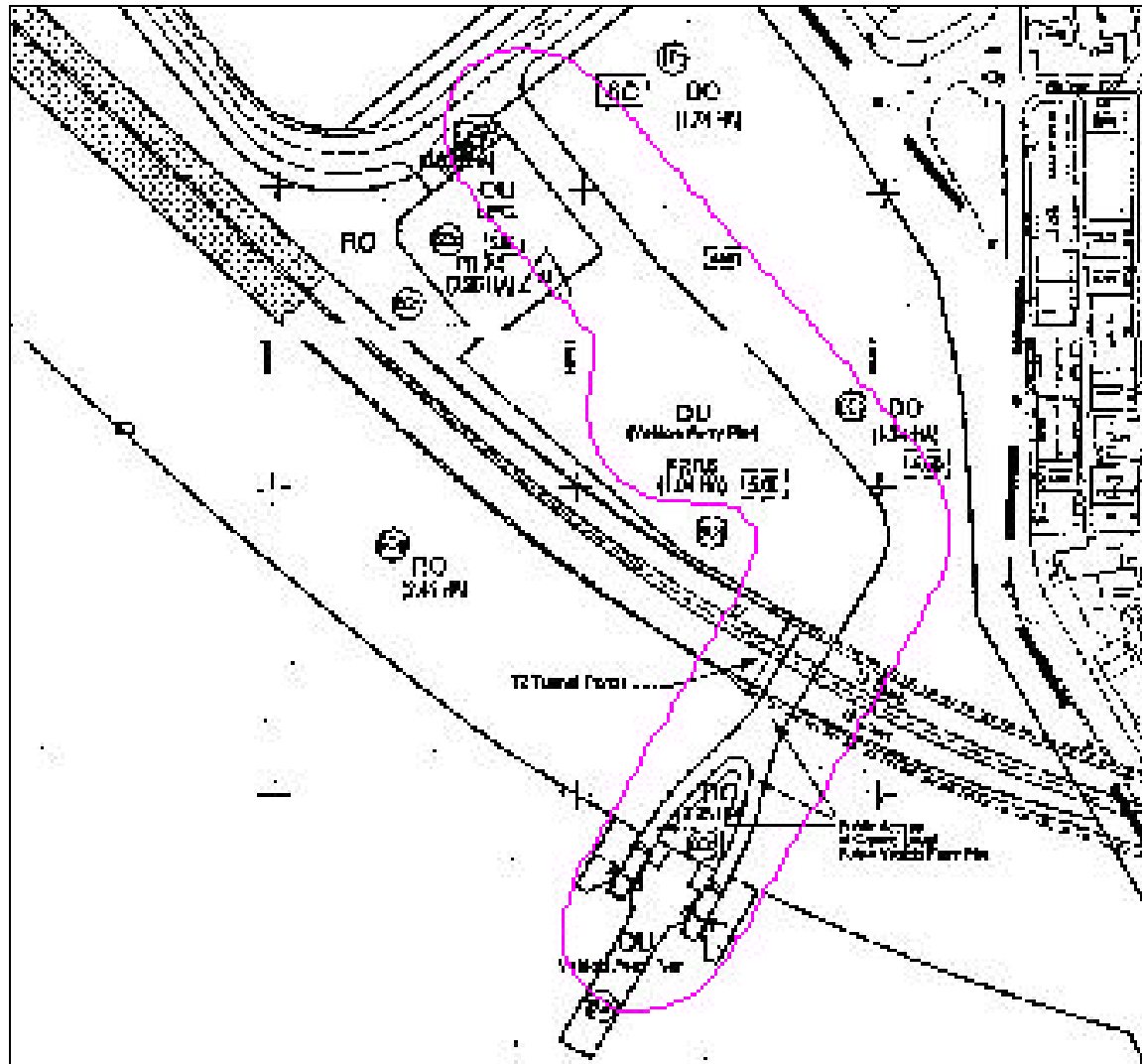

Drawing No. 22936/EN/407

Individual Risk Contour, Proposed Pier Location
Hydrocarbon Transport - 2001

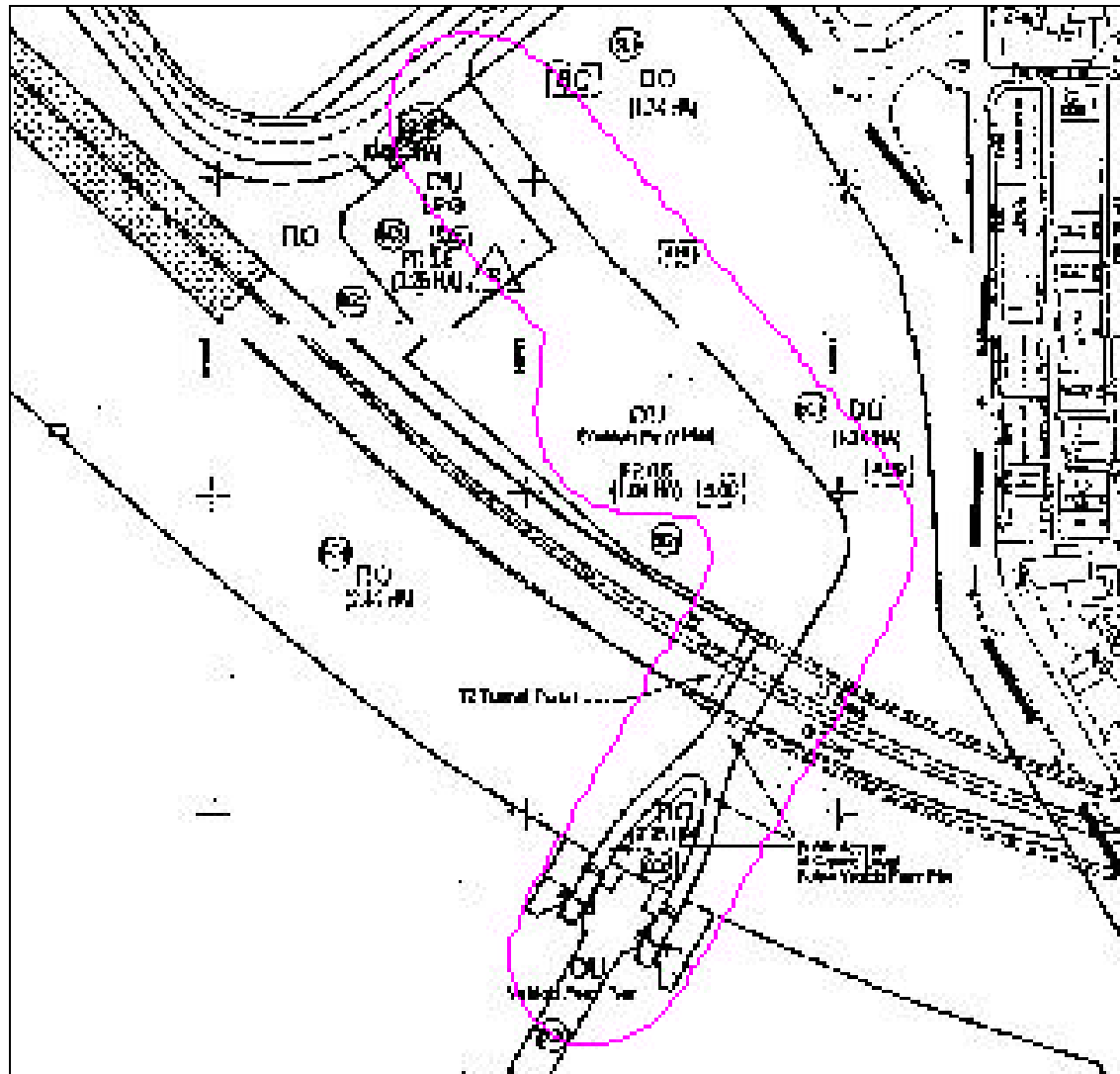

Legend:

1×10^{-5} per year	Red line
1×10^{-6} per year	Green line
1×10^{-7} per year	Blue line
1×10^{-8} per year	Magenta line

Drawing No. 22936/EN/408

Individual Risk Contour, Proposed Pier Location
Hydrocarbon Transport - 2012

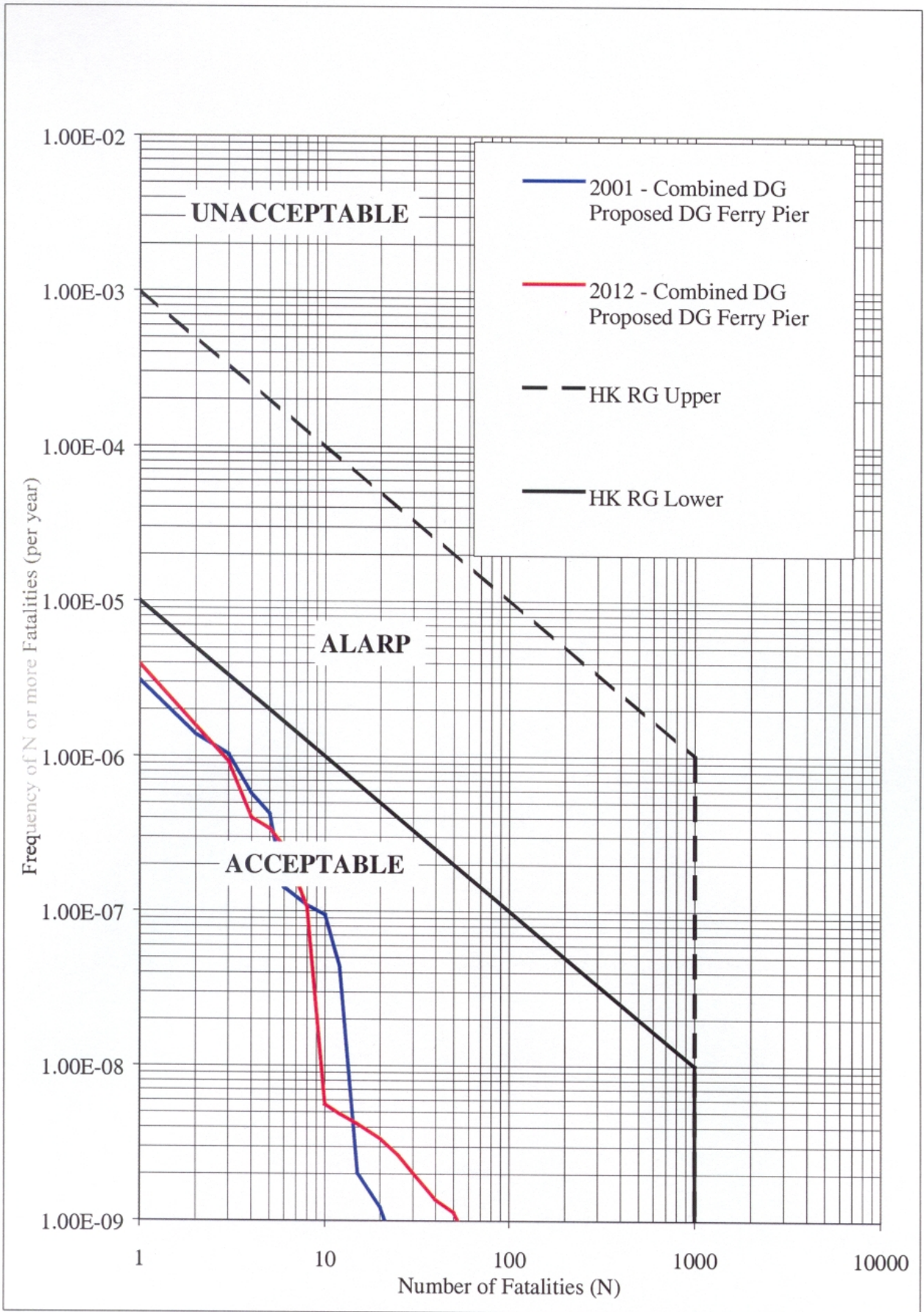

Drawing No. 22936/EN/409 Societal Risk Curve for Proposed Pier Location
 Combined Trade – 2001 versus 2012

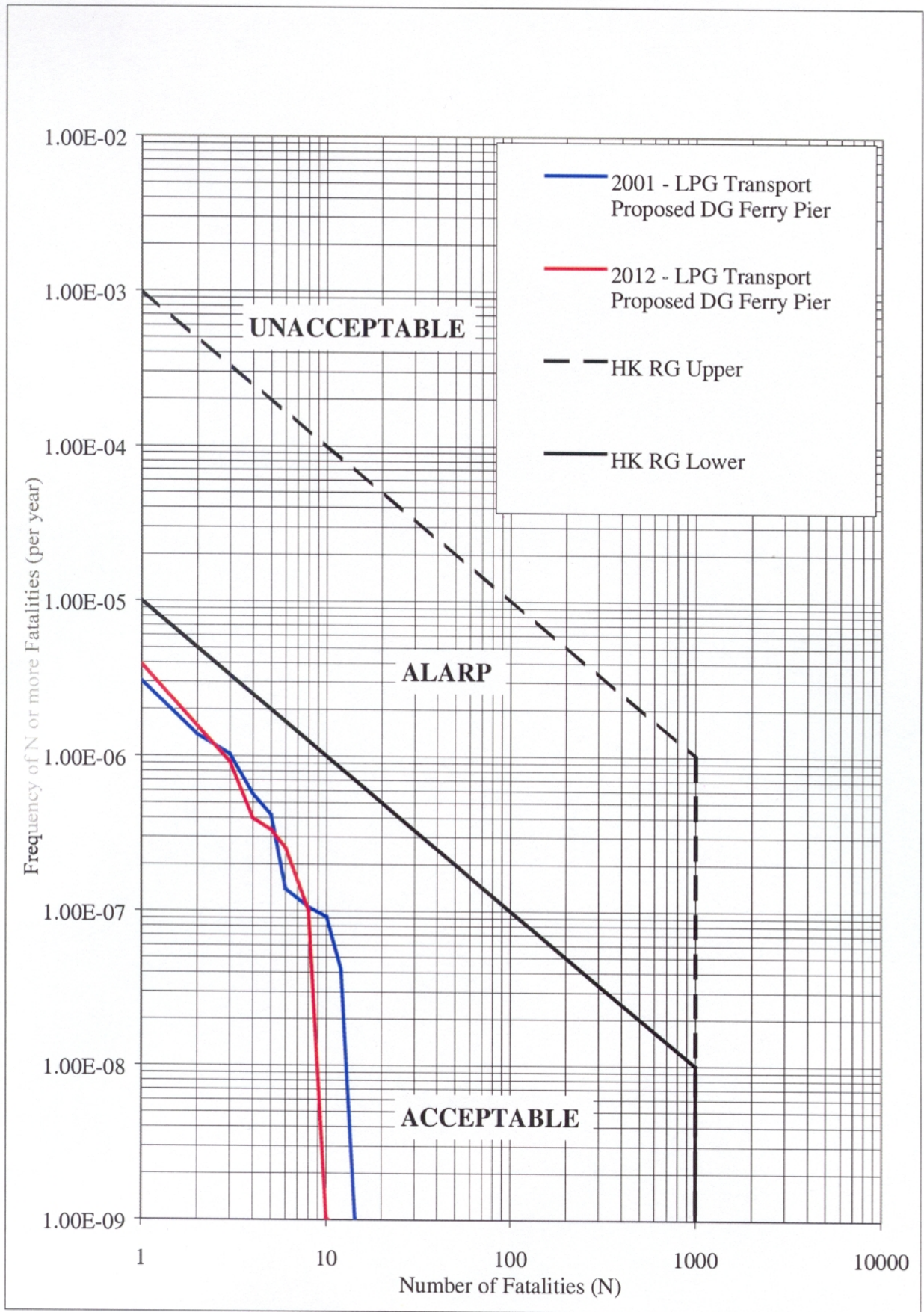

Drawing No. 22936/EN/410 Societal Risk Curve for Proposed Pier Location
LPG Trade - 2001 versus 2012

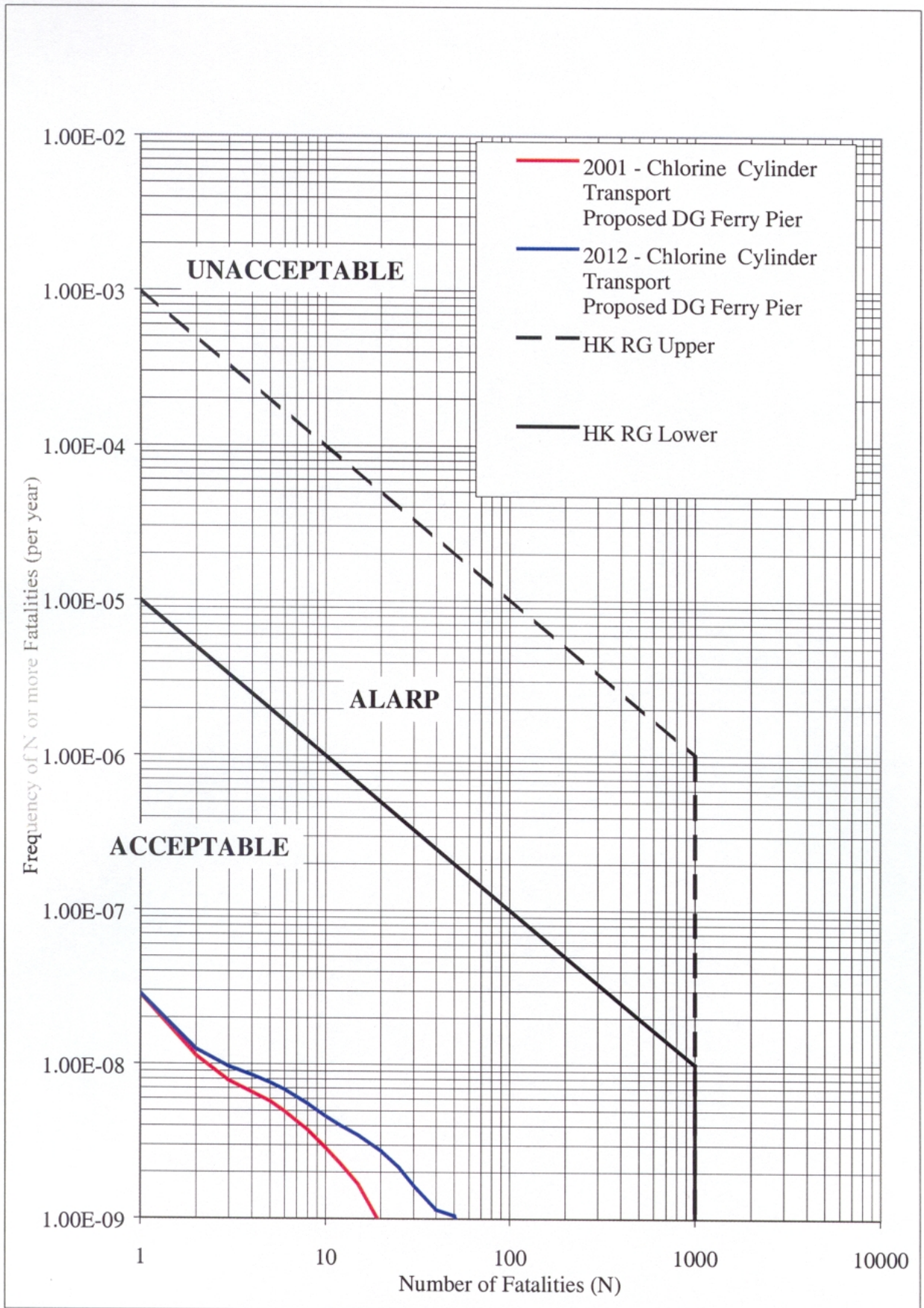

Drawing No. 22936/EN/411 Societal Risk Curve for Proposed Pier Location Chlorine Cylinders Trade – 2001 versus 2012

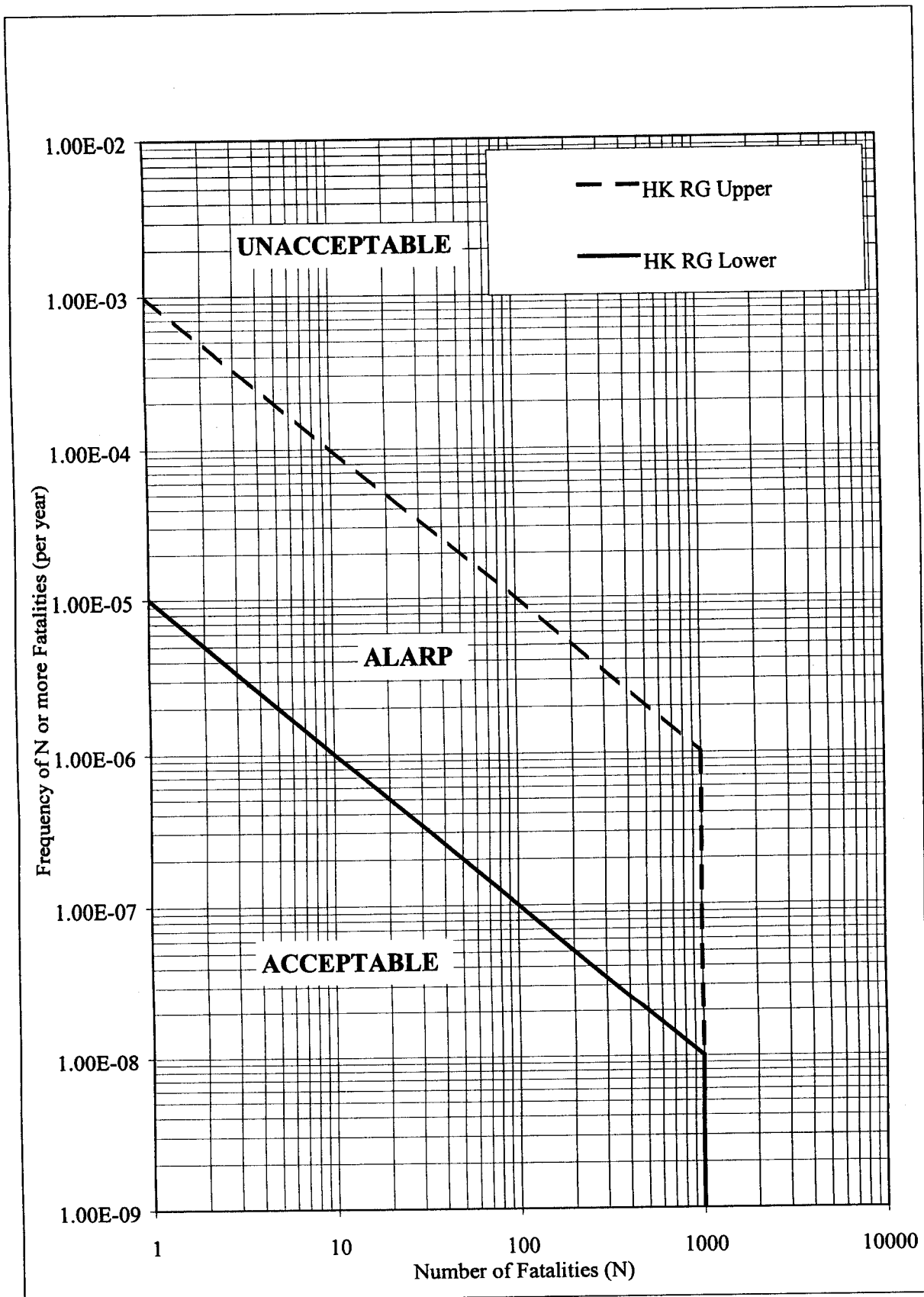

Drawing No. 22936/EN/412

Societal Risk Curve for Proposed Pier Location
Hydrocarbons Trade - 2001 versus 2012

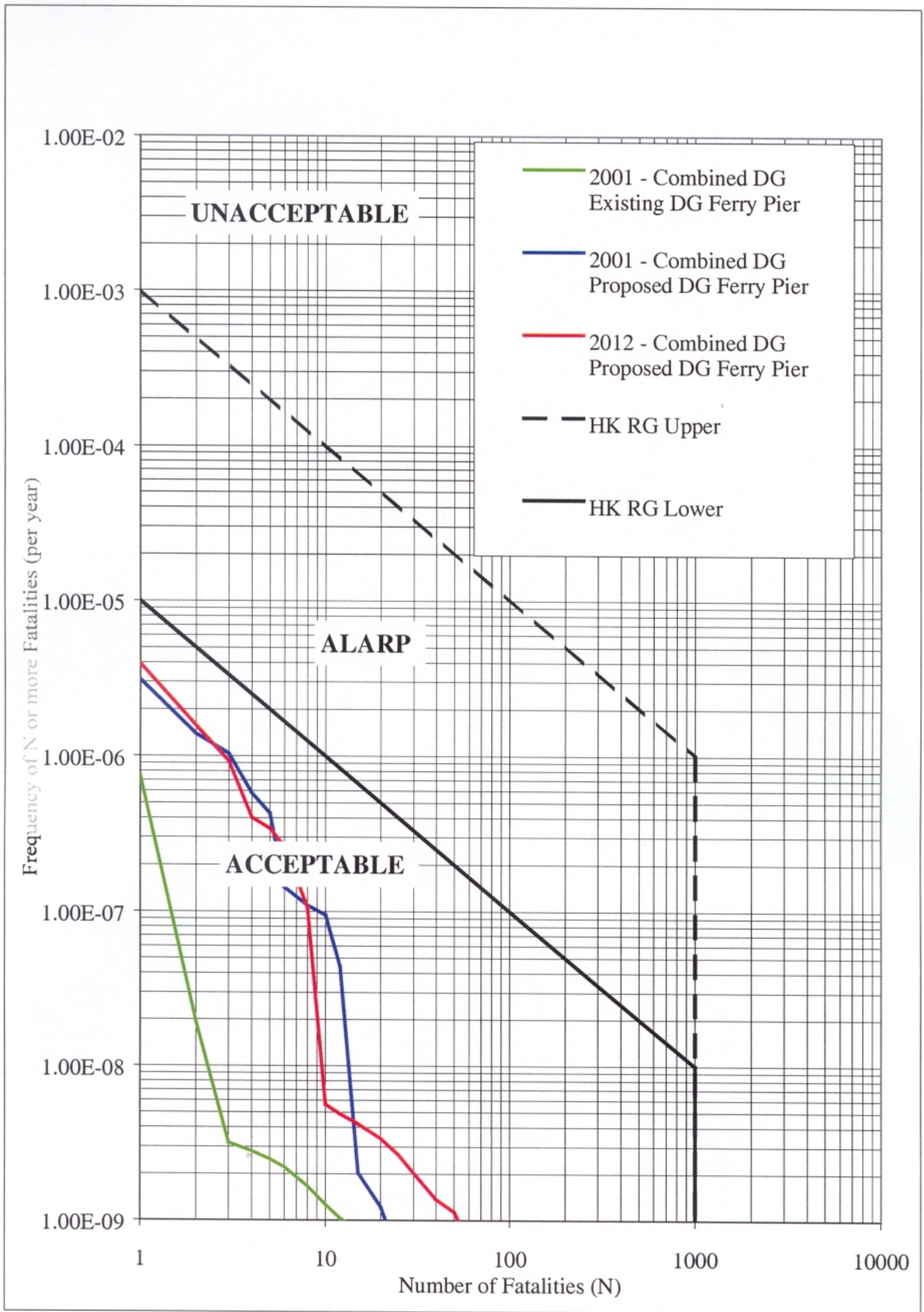

Drawing No. 22936/EN/413 Societal Risk Curve DG Ferry Pier Risk Comparison

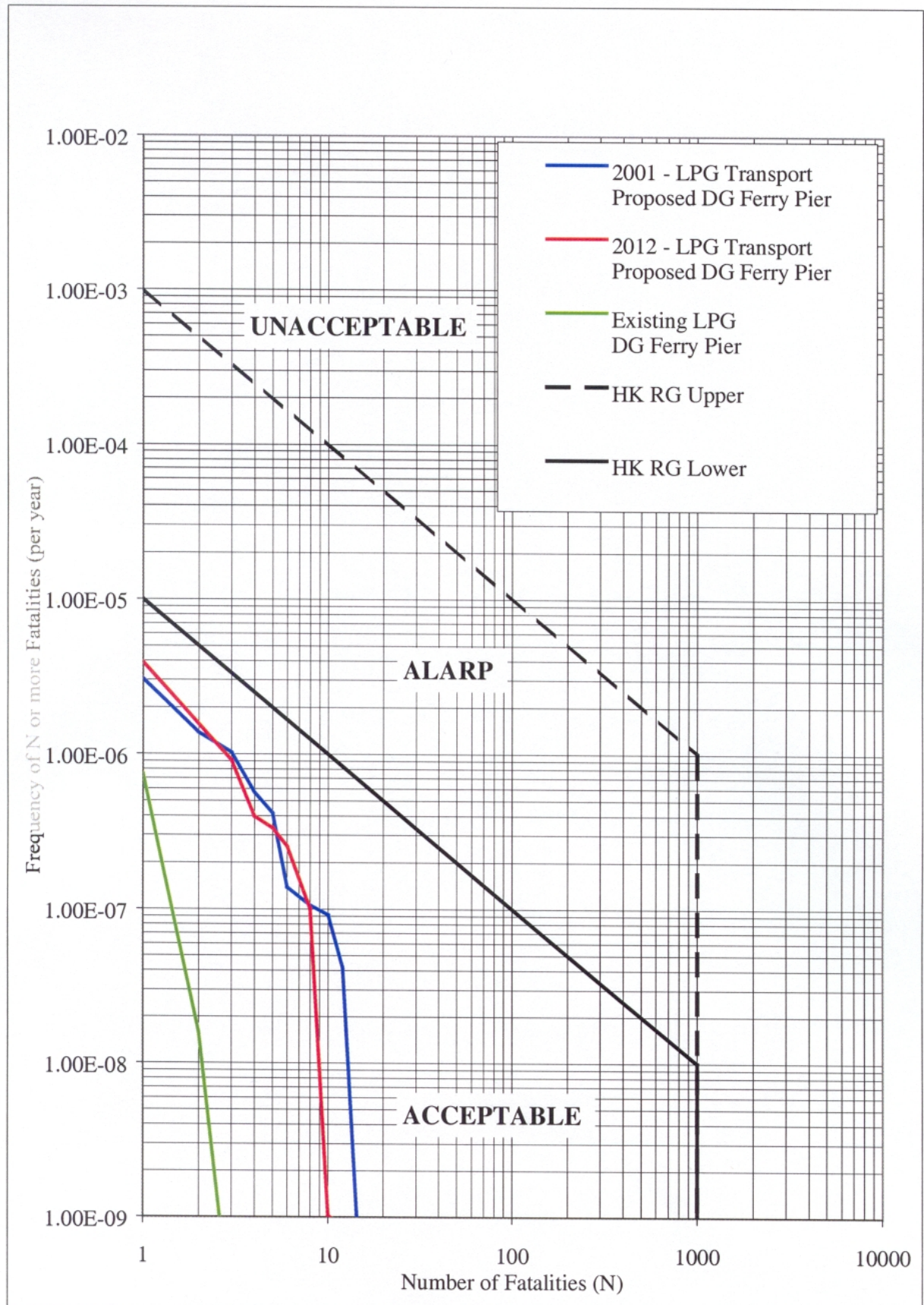

Drawing No. 22936/EN/414 Societal Risk Curve LPG Transport DG Ferry Pier Risk Comparison

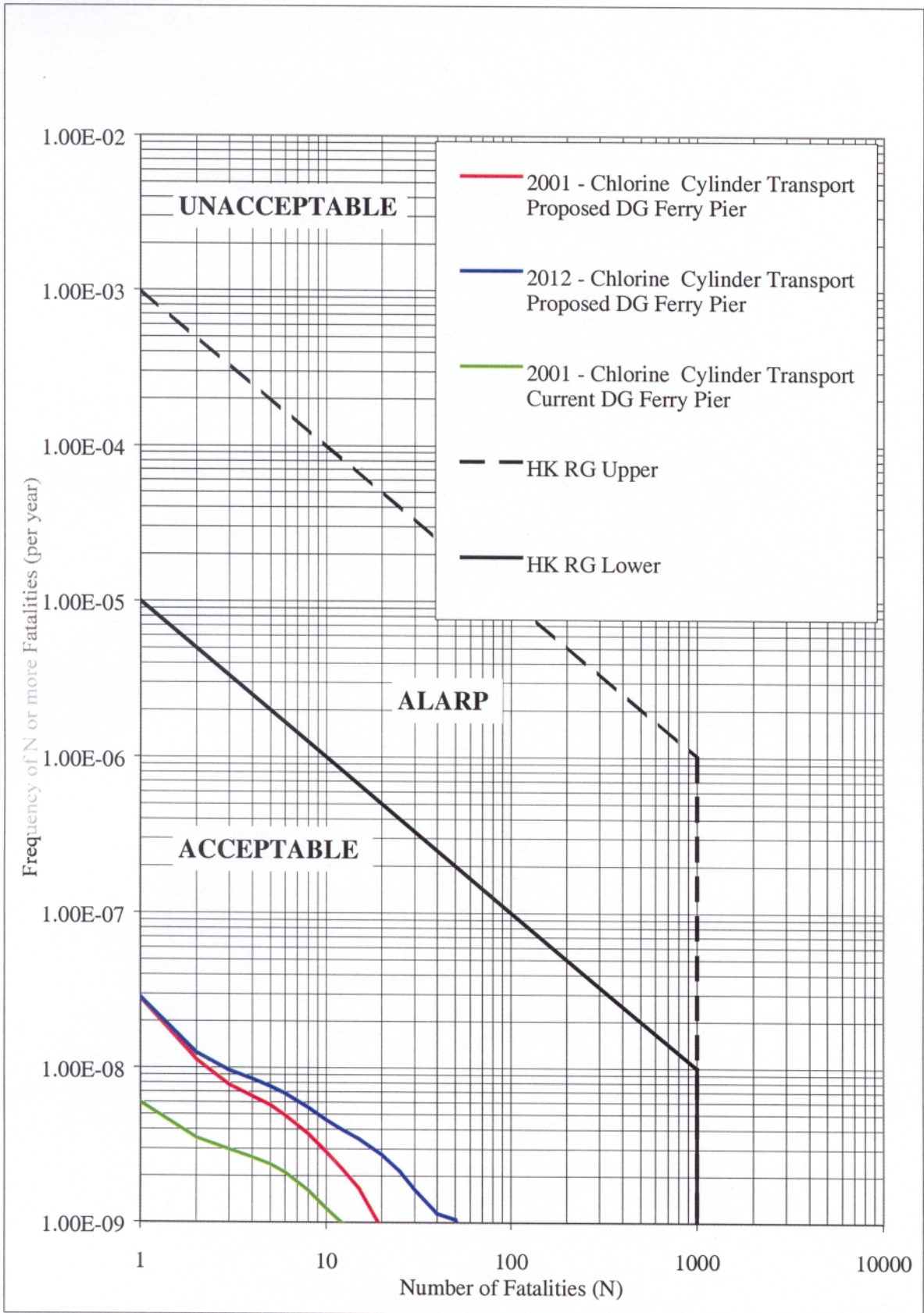

Drawing No. 22936/EN/415 Societal Risk Curve Chlorine Transport DG Ferry Pier Risk Comparison

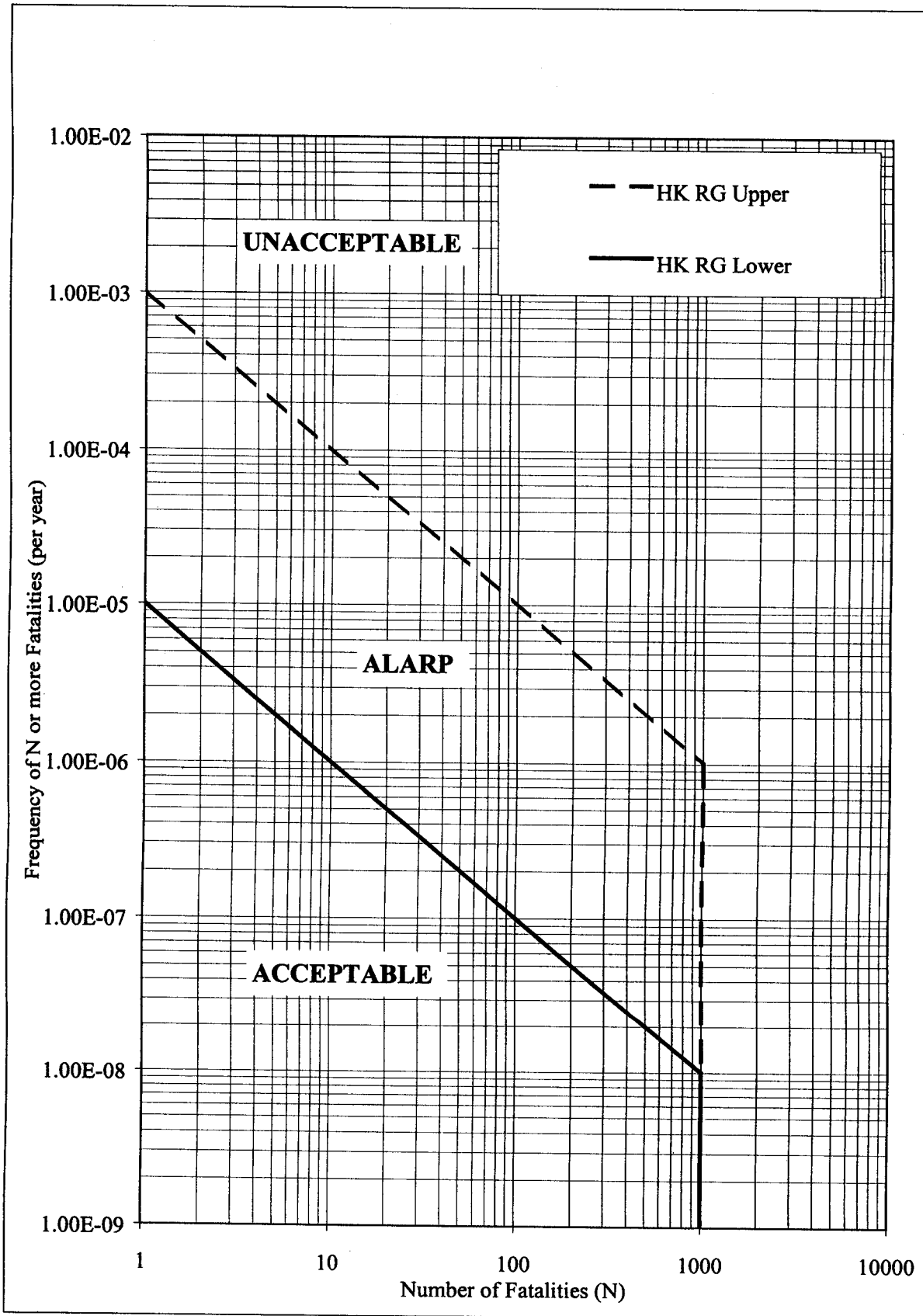

Drawing No. 22936/EN/416

Societal Risk Curve
Hydrocarbon Transport DG Ferry Pier Risk Comparison

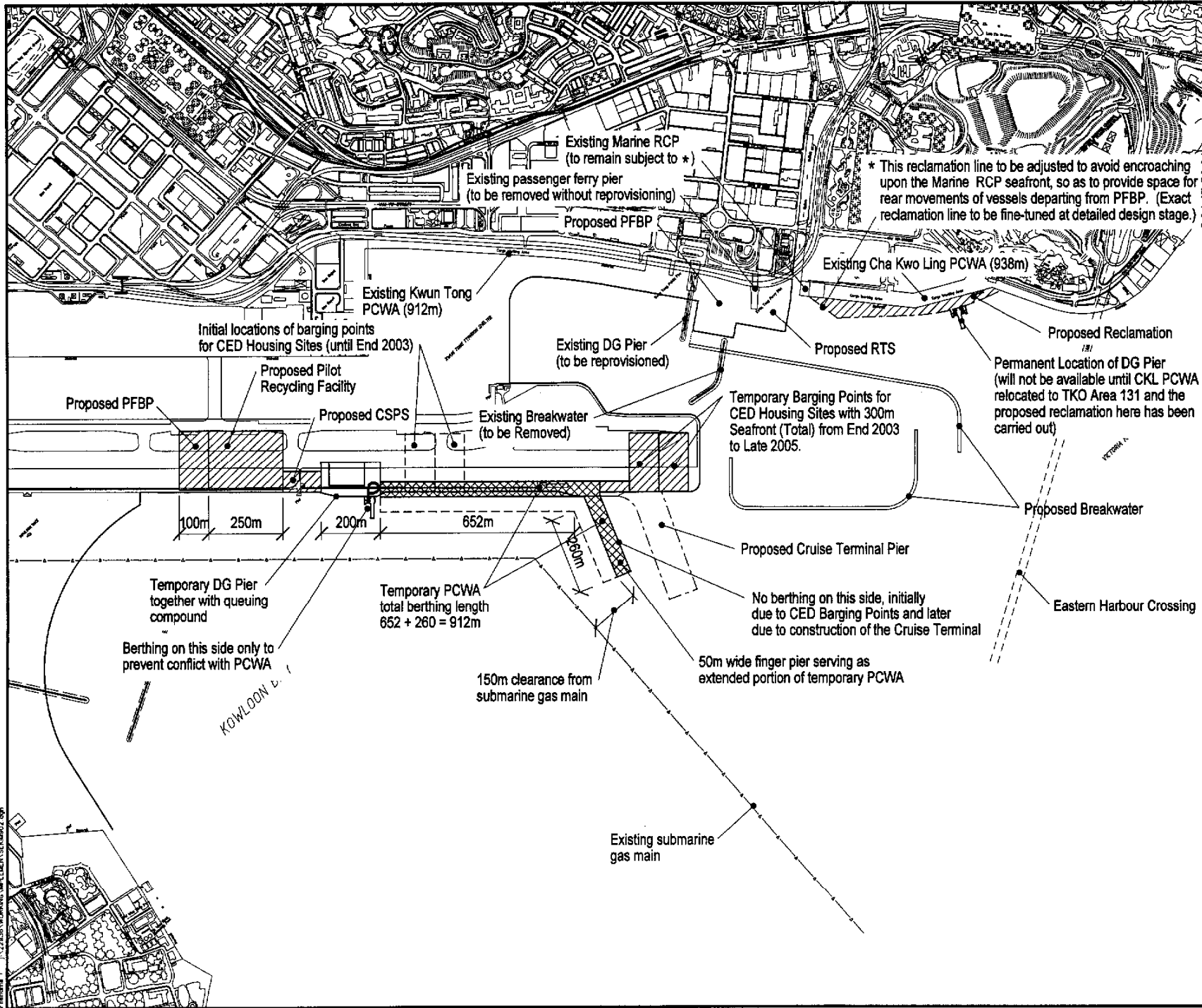

Rev.	Description	By	Date
Consultants			
ARUP One Asia & Partners Hong Kong Limited			
Wong Hing-kin Limited	AGL Limited		
As Pooled Consultants Limited	Environmental Management Limited		
Manjivani Wai-hon Hong Kong Limited	Pace Design Limited		
Winnal Limited			

Project title

AGREEMENT NO. CE 32/99
COMPREHENSIVE FEASIBILITY STUDY
FOR THE REVISED SCHEME OF
SOUTH EAST KOWLOON DEVELOPMENT

Drawing title

TEMPORARY REPROVISIONING OF
DG PIER AND KWUN TONG PCWA
FINGER PIER OPTION

Drawing no.	22936/1M/902	Rev.	-
Drawn	WJMAK	Date	MARCH 01
Checked		Approved	
Scale	N.T.S.	Status	PRELIMINARY

COPYRIGHT RESERVED



拓展署
 Territory Development
 Department, Hong Kong
 九龍發展處
 KOWLOON DEVELOPMENT OFFICE

Printed by: WJMAK
 File name: IN22936/1M/902/1M/902.dwg
 Date: 01/03/01

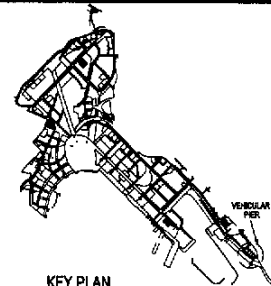
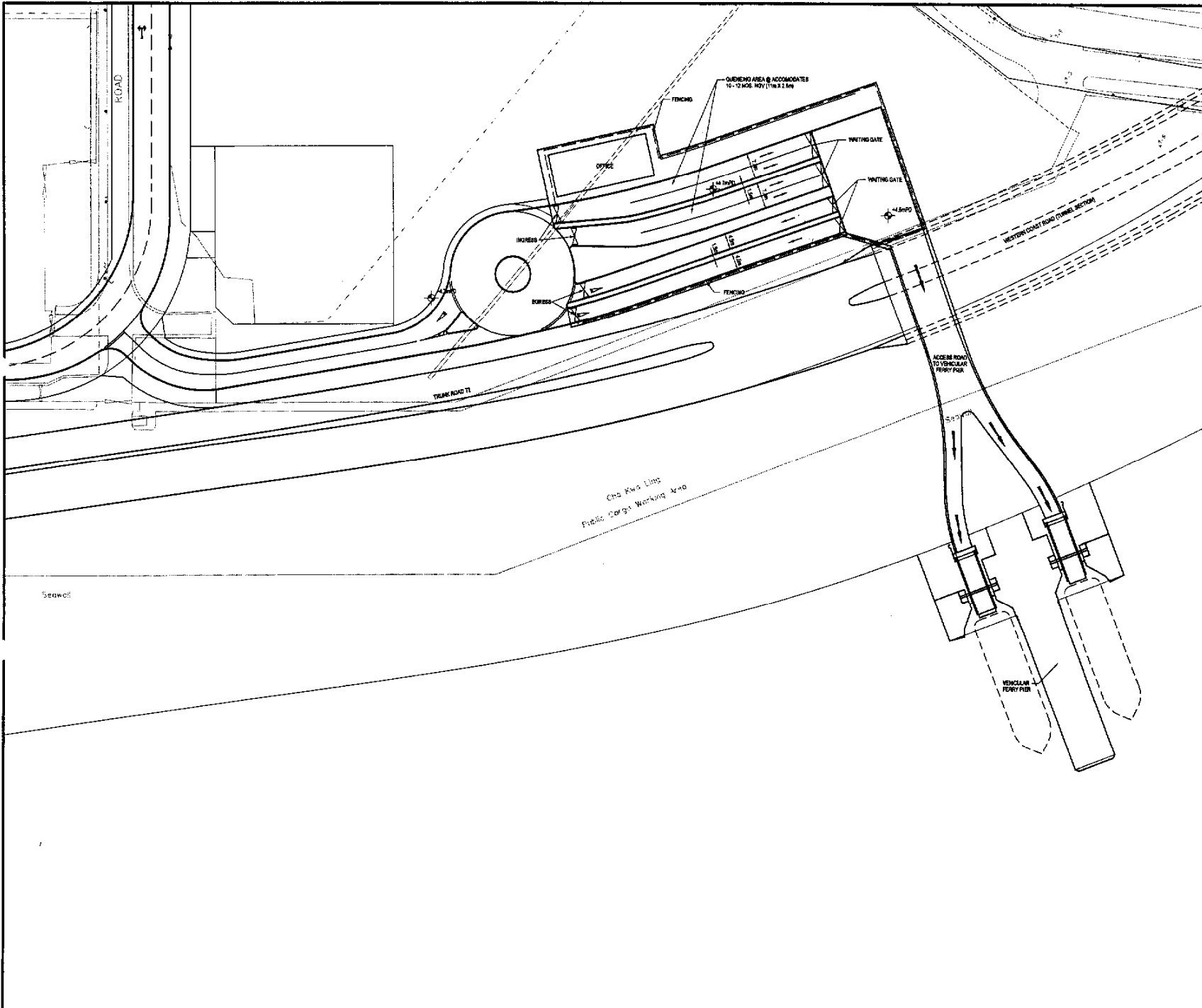

KEY PLAN

NOTE

THIS DRAWING SHALL BE READ IN CONJUNCTION WITH 22938/MS/12/REV. 123.

C	TOP COMMENT INCORPORATED	CC	05/01
B	MINOR REVISION	PM	04/01
A	MINOR REVISION	PM	03/01
Rev	Description	By	Date

Consultants
ARUP One Asia & Partners Hong Kong Limited
 Hoeng Fattion Limited
 Jui Pui Fook Consultants Limited
 Hoeng Fook Yuen Hong Kong Limited
 Wai Hoi Limited
 ACLA Limited
 Environmental Management Limited
 Rocco Design Limited

Project title
**AGREEMENT NO. CE 32/99
 COMPREHENSIVE FEASIBILITY STUDY
 FOR THE REVISED SCHEME OF
 SOUTH EAST KOWLOON DEVELOPMENT**

Drawing title
**VEHICULAR FERRY PIER
 SCHEMATIC GENERAL
 LAYOUT PLAN**

Drawing no.	22938/MS/121	Rev.	C
Drawn	WJMK	Date	NOV/00
Checked		Approved	
Scale	1:500 AS AT 1:2000 AS/AS	Status	PRELIMINARY

Copyright Reserved



拓展署
 Territory Development
 Department, Hong Kong
 九龍拓展處
 KOWLOON DEVELOPMENT OFFICE

Printed by: WISEER
 Drawn by: WJMK
 Date: 12/11/00

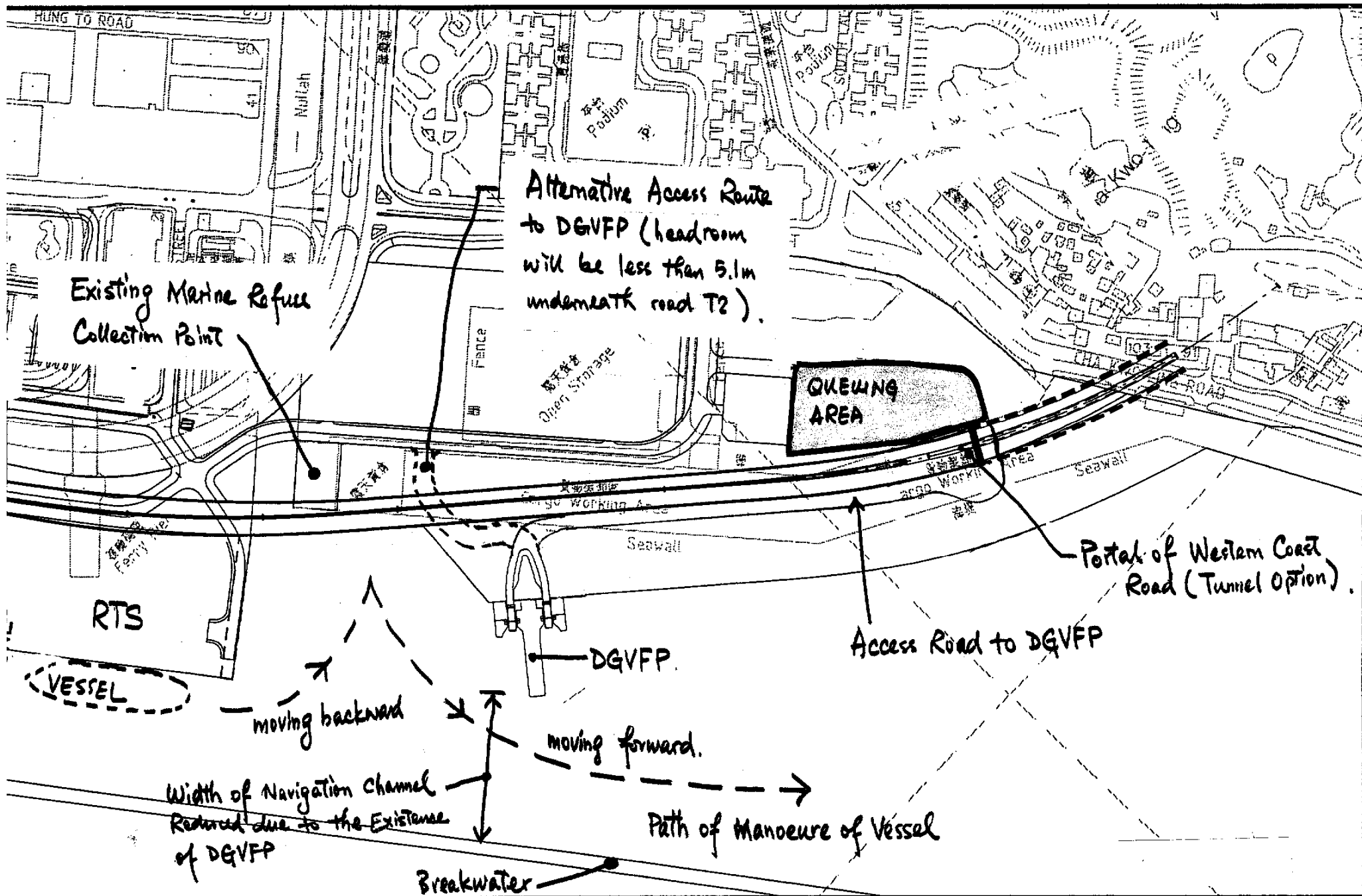

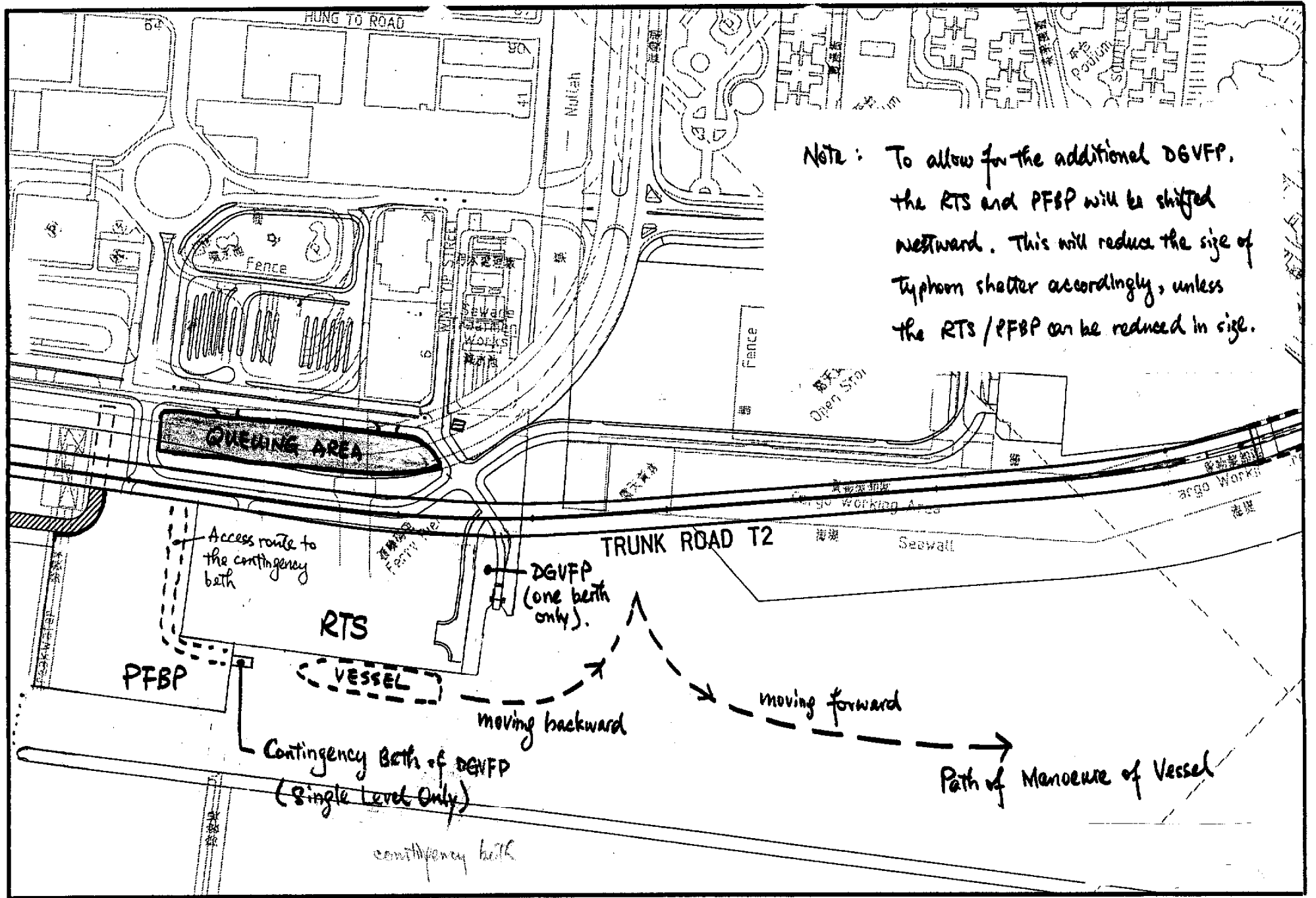

NOTE: To allow for the additional DGVFP, the RTS and PFBP will be shifted westward. This will reduce the size of typhoon shelter accordingly, unless the RTS/PFBP can be reduced in size.