

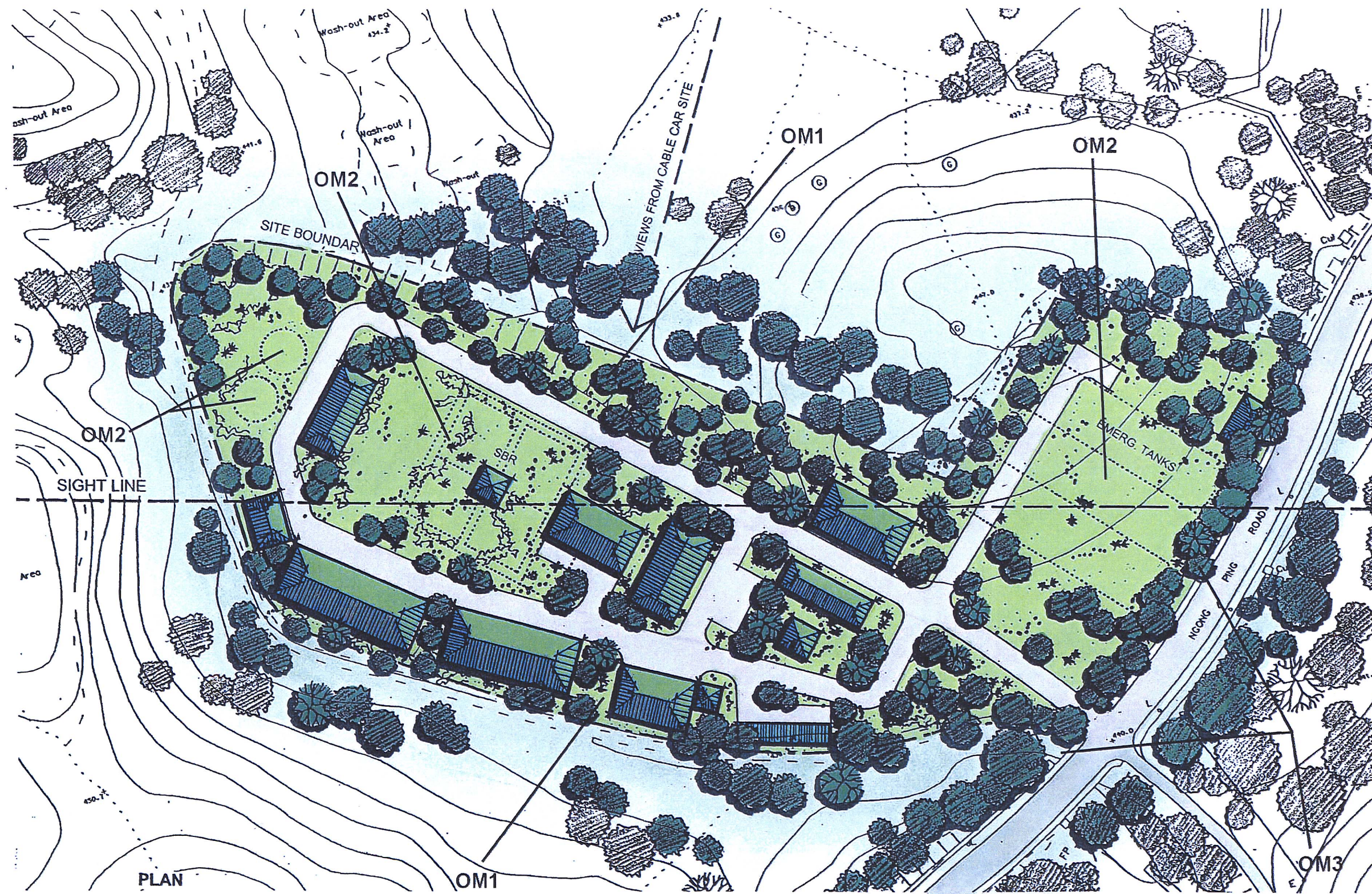

--- Site Boundary

Mitigation Measures

- OM1 Grass hydroseeding and planting of native shrubs and trees to provide green backdrop to the development, and to blend the slope into the surrounding natural slopes, and to compensate for grass and shrubs and trees lost during construction
  - OM2 Grass hydroseeding (with groundcover) on top of the underground structures within STW site
  - OM3 Grass hydroseeding and tree and shrub planting to screen elevated structures along the southeastern boundary of STW site, to provide visual interest, and to provide shade and shelter
  - OM4 Sensitive architectural and chromatic treatment of the elevated structures
  - OM5 Night lighting should be designed to minimise glare to all receivers
- Note: OM4 and OM5 apply to all buildings within STW site



Rev	Description	By	Date

Consultants

**ARUP** Ove Arup & Partners Hong Kong Limited

Project title  
**AGREEMENT NO. CE 29/2001  
 OUTLYING ISLANDS STAGE 1 PHASE 1  
 NGONG PING SEWAGE TREATMENT  
 WORKS AND SEWERAGE**

Drawing title  
**LANDSCAPE MITIGATION MEASUR  
 OPERATIONAL PHASE**

Drawing no. 23400/EN/044 Rev.

Drawn	Date	Checked	Approved
	APR 02		

Scale 1:1000 Status

COPYRIGHT RESERVED

香港特別行政區政府渠務署  
 DRAINAGE SERVICES DEPARTMENT  
 GOVERNMENT OF THE  
 HONG KONG  
 SPECIAL ADMINISTRATIVE REGION