

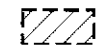

AS
 DO NOT SCALE DRAWING CHECK ALL DIMENSIONS ON SITE.
 ALL RIGHTS RESERVED.
 © OVE ARUP & PARTNERS HONG KONG LIMITED.

LEGEND:

-  100m LIMIT FOR SWC ETA STUDY
-  SOUNDING SURVEY UNDERTAKEN BY AMO IN MARCH 2002
-  PROPOSED PILE CAPS
-  AREA REQUIRED DIVER INSPECTION BY AMO IN JUNE 2002

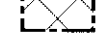
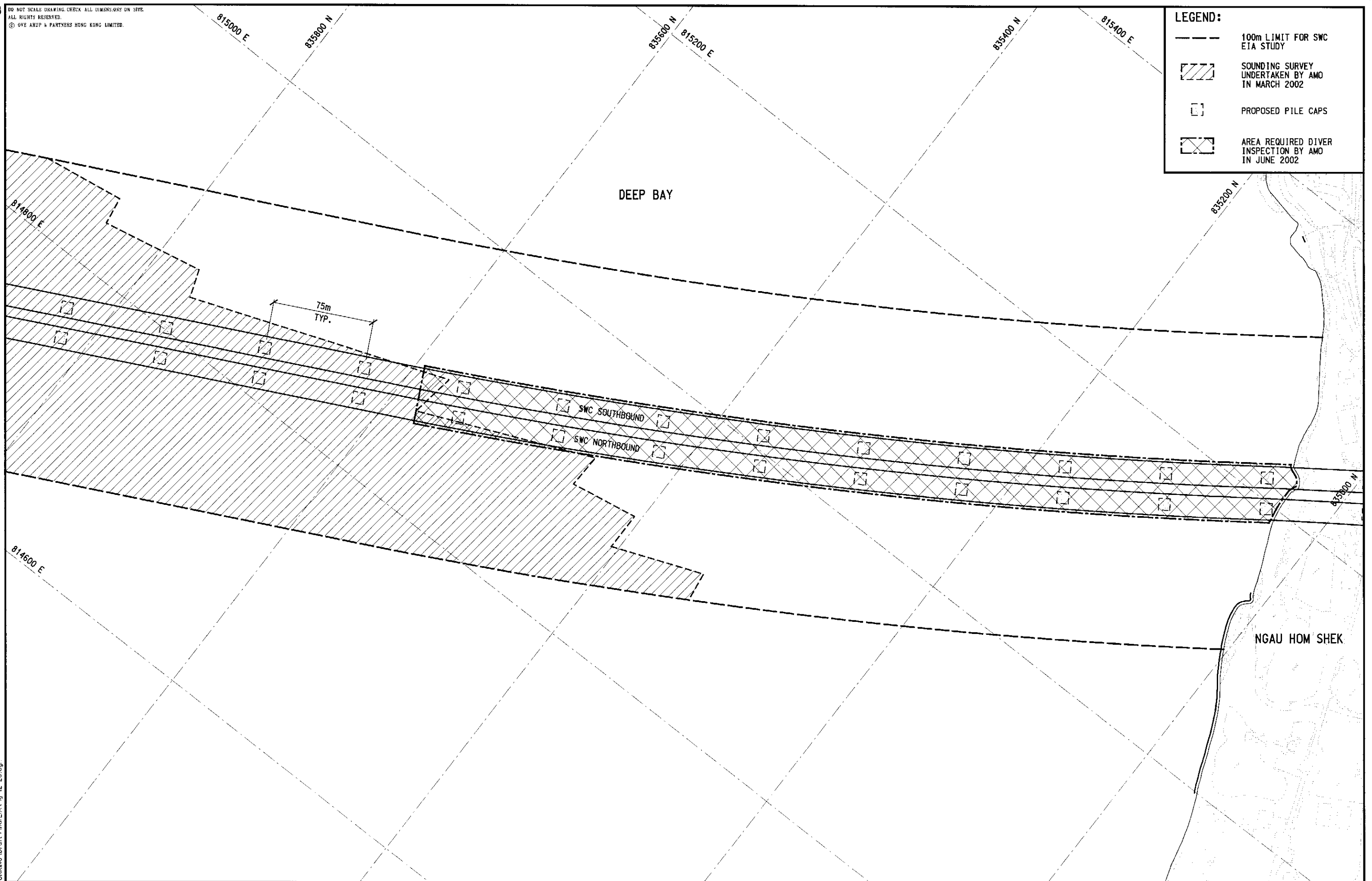

Printer by : W.MAK 03/09/2002
 Filename : J:\23306\WORKING\Draft Final EIA\fig-12-20.dgn

Mark	Date	By	Rev.

Designed By
AM
 Drawn By
YM
 Checked By
SK
 in Charge
SYC
 Date
MAY 2002

 **路政署**
HIGHWAYS DEPARTMENT
 主要工程管理處
 Major Works Project Management Office

Consultant
ARUP 奧雅納工程顧問
 Ove Arup & Partners Hong Kong Limited
 Supported By:
 Environmental Management Ltd. ○
 BMT Asia Pacific Ltd. ○
 Urbis Ltd. ○

Project Title
 Shenzhen Western Corridor
 Investigation & Planning

Drawing Title
**MARINE ARCHAEOLOGICAL
 INVESTIGATION IN DEEP BAY**

Cad Filename FIG-12-20	Cad Date MAY 2002
Scale 1:2500	Drawing No. FIGURE 12.20
Drawing Status	Rev. —