

- LEGEND**
- LIMIT OF THE WORK
 - EXISTING TREE TO BE RETAINED
 - ⊗ EXISTING TREE GROUPS TO BE RETAINED
 - COMPENSATORY TREE PLANTING
 - TRANSPLANTED TREES AS PER TREE SURVEY & LANDSCAPE PROPOSAL
 - ▨ SHADE TOLERANT PLANTING
 - ▩ RE-INSTATED / NEW GRASSLAND

ID No. Mitigation Measure

- OM1 Woodland tree and shrub planting should be implemented adjacent to the Deep Bay road where it is at grade. This will include cut and filled slopes.
- OM2 Implementation of bio-engineering techniques to the cut slopes.
- OM3 Climbing plants should be used to soften the appearance of viaduct columns at ground level.
- OM4 Woodland tree and shrub planting should be undertaken at cut slopes so as to compensate for vegetation lost during construction. Any affected slope areas should be hydroseeded and planted with woodland species, avoid shortcrofing.
- OM5 Native shrub planting should be undertaken to screen the proposed works and blend it into the landscape.
- OM6 Planting should be incorporated where possible to screen the road and bridge in low level views from adjacent areas, and to tone down the extent of hard paving and surfaces and reduce the amount of glare.
- OM7 Sensitive architectural design of engineering and other built structures, including form and finishes, this will include but not limited to: barriers, paved surfaces, retaining walls, walls, columns, buildings, and other structures, light standards, etc. The design of built structures shall be to the satisfaction of the ACABAS.
- OM8 Lighting of road and bridge, should be designed to minimise glare to all receivers. Poles and fittings should be designed to conform with the bridge design.
- OM9 Transplanted Tree Stock

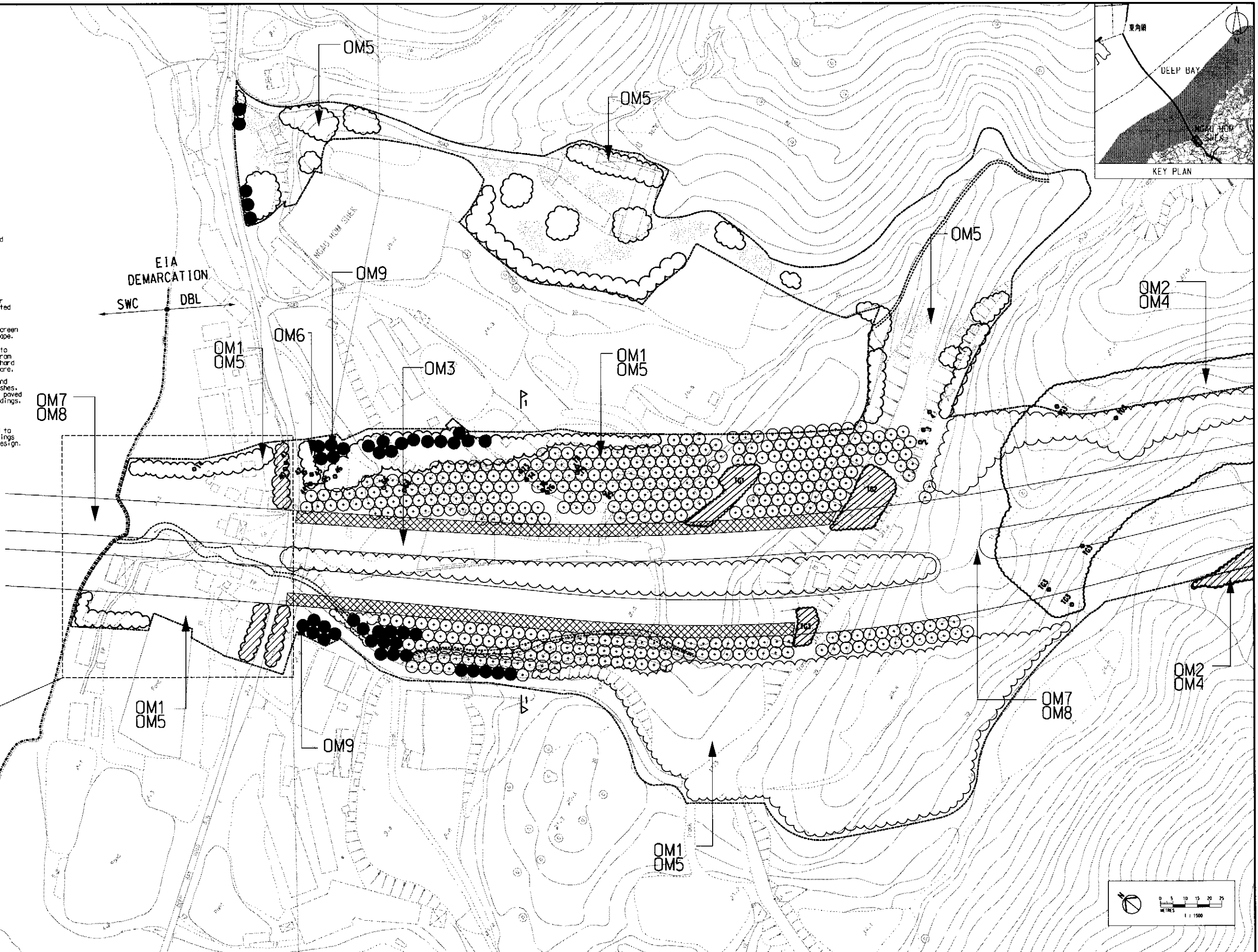
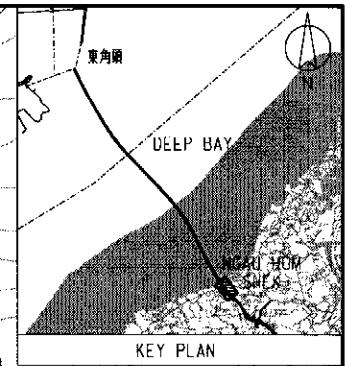

AREA TO BE PLANTED WITH SHALLOW ROOTING SHRUBS TO ENSURE AND SITES ARE PROTECTED

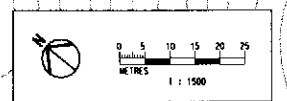

Printer by : Toi
 File name : f:\a026\egm\1\13\fig13-13.dgn
 29 AUG 2002 10:27:26

Designed By	CD
Drawn By	TI
Checked By	CD
In Charge	CD
Date	OCT 2001



Consultant
ARUP 奧雅納工程顧問
 Ove Arup & Partners Hong Kong Limited
 Supported by:
 Environmental Management Ltd.
 M.T. Asia Pacific Ltd.
 Urbis Ltd.

Project Title
Shenzhen Western Corridor Investigation & Planning

Drawing Title
MITIGATION MEASURES IN OPERATION PHASE

Code File name	FIG13-13.DGN	Code Date	JAN 2002
Scale	1 : 1500		
Drawing No.	FIGURE 13.13		
Drawing Status		Rev.	0