

Figure 7.27 Map showing the location of the cultural heritage feature in the village of Cheung Kang

Scale: (1 : 1000)  
 0 10 20 30 m

AGREEMENT NO. CE 16/99  
 FEASIBILITY STUDY FOR HOUSING  
 DEVELOPMENT AT WHITEHEAD AND  
 LEE ON IN MA ON SHAN, SHATIN

**& Binnie**  
 Binnie Black & Veatch Hong Kong Limited  
 博威工程顧問有限公司  
 Engineers and Architects

Project: Feasibility Study for Housing Development  
 at Whitehead and Lee On in Ma On Shan, Sha Tin

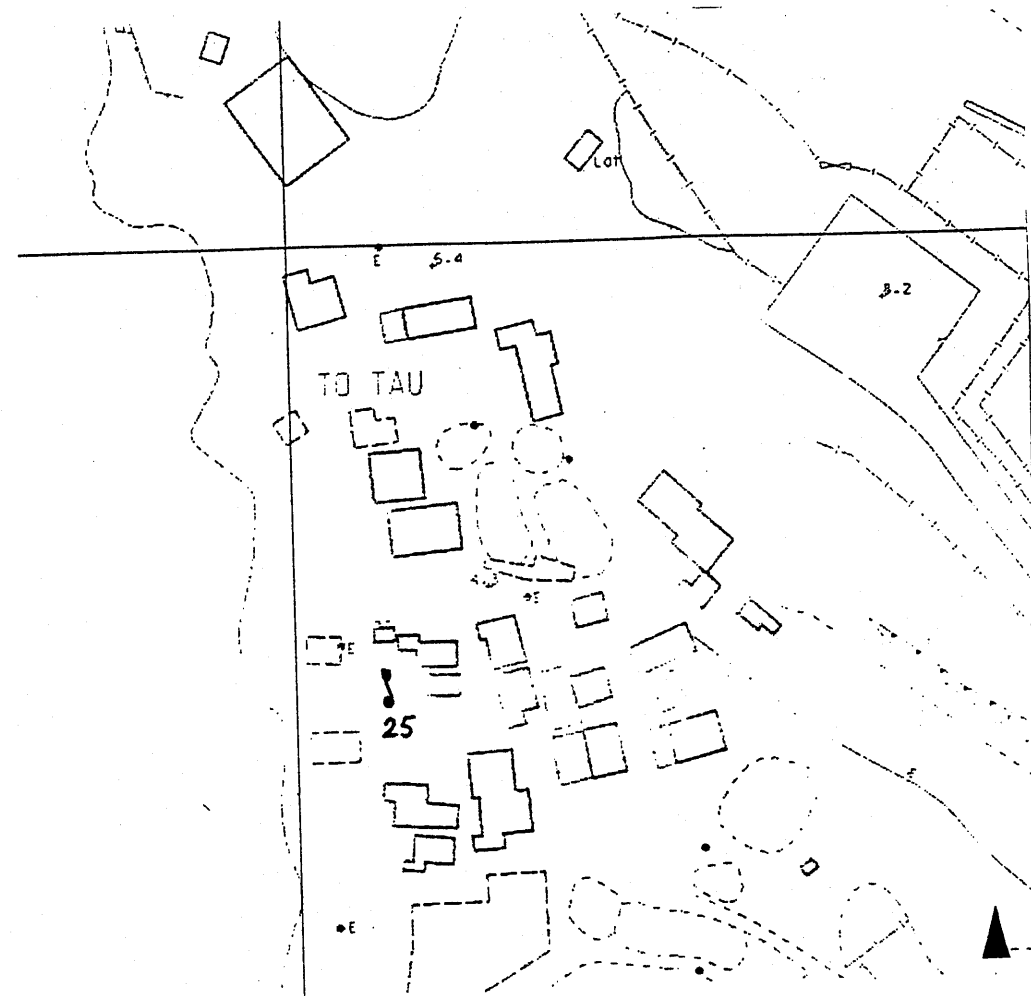

Figure 7.28 Map showing the location of the cultural heritage feature in the village of To Tau Tsuen

Scale: (1 : 1000)  
 0 10 20 30 m

AGREEMENT NO. CE 16/99  
 FEASIBILITY STUDY FOR HOUSING  
 DEVELOPMENT AT WHITEHEAD AND  
 LEE ON IN MA ON SHAN, SHATIN

**& Binnie**  
 Binnie Black & Veatch Hong Kong Limited  
 博威工程顧問有限公司  
 Engineers and Architects

Project: Feasibility Study for Housing Development  
 at Whitehead and Lee On in Ma On Shan, Sha Tin