



中華電力

CLP Power

20 November, 2002

Maunsell Environmental Management Consultants Ltd.  
Room 1213-1219  
Grand Central Plaza, Tower 2  
138 Shatin Rural Committee Road  
Shatin, N.T.

Attention : Terence Kong

Our ref. : N-2002-6956

Your ref. : A04202/c/tchk/1

Maunsell Environmental Management Consultants Ltd.			
Received	22.11.02		
File No.	/C/F/Q		
TS	AYK	TJC	Sign Off
MKO	JLAM	TYUT	
Env. Consultant	TCHK		
Others			
Revised To			
Reply Date			

香港新界上水嘉富坊十六號  
16 Ka Fu Close, Sheung Shui  
New Territories, Hong Kong

電話 Tel (852) 2678 2156

傳真 Fax (852) 2678 2180

網址 Website www.clpgroup.com

Dear Sir/Madam,

**Plan of Electricity Cables Surrounding the Proposed Development between Shuen Wan Landfill and Tai Po Sewage Treatment Work**

We refer to your letter dated 06 November, 2002 and enclose herewith our record sheet(s) showing the present location(s) of this Company's underground cables and / or overhead lines. The alignments of the cables and overhead lines could be altered in the future to meet the requirements of our power system.

You will find certain measurements, dimensions and distances marked on these record sheets. Although these figures are accurate to the best of our knowledge, site conditions may have altered since the measurements were taken. As such, CLP Power's record sheets are sent to you on the express condition that the locations of the underground cables and / or overhead lines and all measurements are our best approximation only, and should not be taken as accurate.

We request you, for the sake of safety, not to disturb any part of our equipment. No work or excavation shall be done in close proximity to any of our equipment without giving prior notice to us. We shall hold you responsible for any damage caused to our equipment.

You are advised to contact our Operations Engineer – Sheung Shui, Mr. Y. S. Yip on telephone number 2678 2020 as soon as you are ready to commence work. To facilitate site co-ordination, please provide us with the name(s) of the responsible person(s), contact telephone number and tentative work commencement date.

2/.....



Cont. Page 2 of 2

Our ref. : N-2002-6956

Please be informed that the record of public lighting within your work site should be referred to Lighting Division of Highways Department on telephone number 2370 4830 for details.

Yours faithfully,



for W.M. Yim  
Planning & Design Manager  
North Region

cc.

Encl.: "Guidelines For Contractor's Personnel When Working In Close Proximity To Electric Cable(s)" is attached for your reference/attention.

Drawing reference No: N-2002-6956-001 to N-2002-6956-002

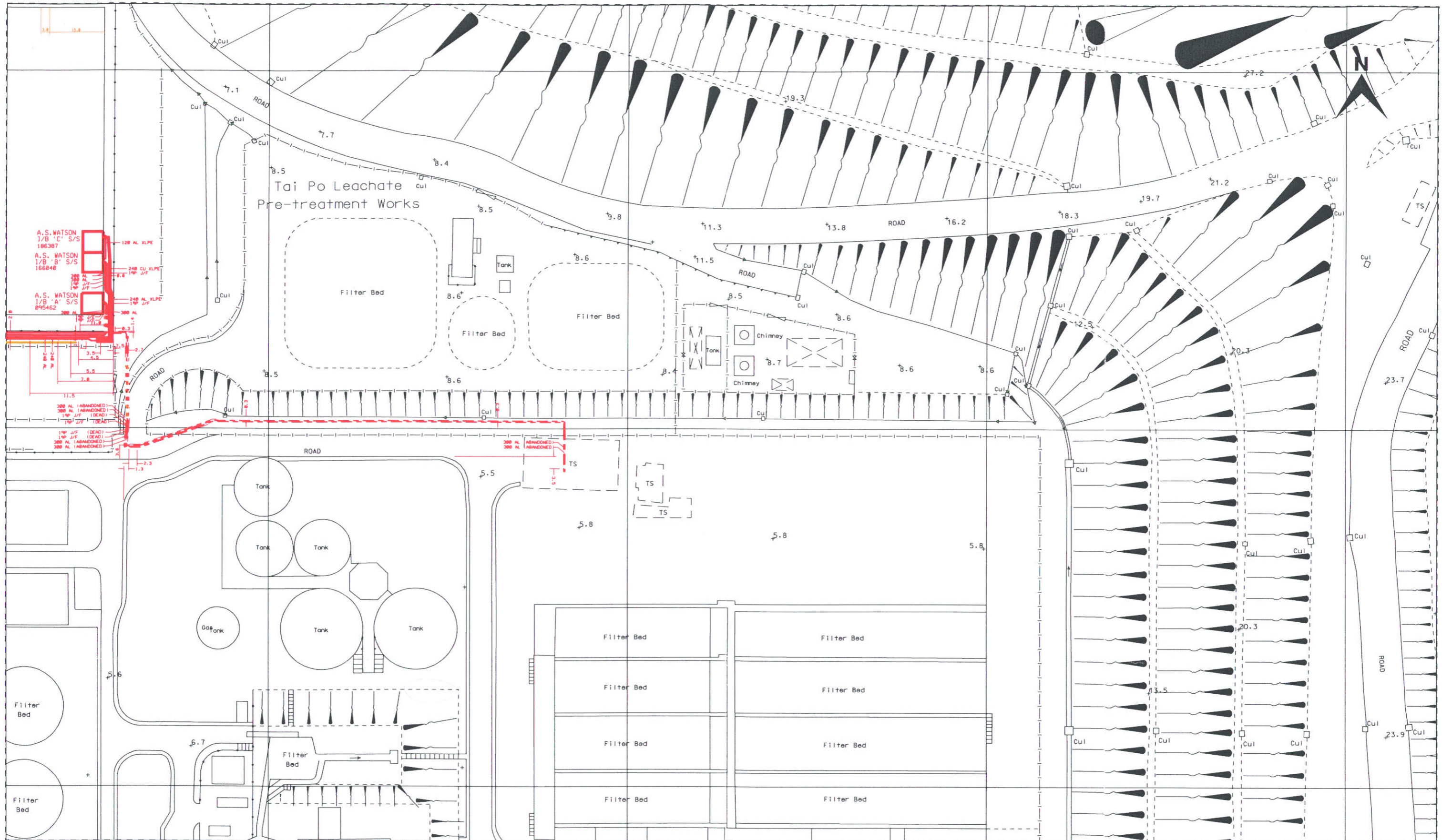

LEGEND					
	IN SERVICE UNDERGROUND TRANSMISSION CABLE, SUBMARINE CABLE		L.V. OVERHEAD LINE (1 PHASE)		FIBRE OPTIC
	IN SERVICE UNDERGROUND 132kV CABLE		L.V. OVERHEAD LINE (3 PHASE)		TRANSMISSION OHL TOWER
	IN SERVICE UNDERGROUND 66kV CABLE		L.V. OVERHEAD LINE (ABC)		NOT IN SERVICE UNDERGROUND PILOT CABLE
	IN SERVICE UNDERGROUND 33kV CABLE		L.V. OVERHEAD LINE (PVC)		PILOT CABLE THROUGH DUCT
	IN SERVICE UNDERGROUND 11kV CABLE		11kV OVERHEAD LINE		CABLE THROUGH DUCT
	IN SERVICE SUBMARINE 11kV CABLE		33kV OVERHEAD LINE		SUBSTATION
	IN SERVICE UNDERGROUND LV CABLE		DUCT LINE		

ALL LOCATIONS, MEASUREMENTS, DIMENSIONS AND DISTANCES ARE FOR CLP POWER INTERNAL USE ONLY. THEY SHOULD NOT BE SCALED AND ASSUMED ACCURATE. CLP POWER ACCEPTS NO RESPONSIBILITY IN THE EVENT OF ANY INACCURACY. EXTREME CARE MUST BE EXERCISED WHEN WORKING IN CLOSE PROXIMITY TO OUR EQUIPMENT. PLEASE CONTACT OUR REGIONAL OFFICE AS SOON AS YOU ARE READ TO COMMENCE WORK.



中華電力  
CLP Power

MAP NO: **CLP Facility Records Map 07NE01A, 07NE01C**

SCALE: 1:1000      PRINTED ON: 19-11-2002

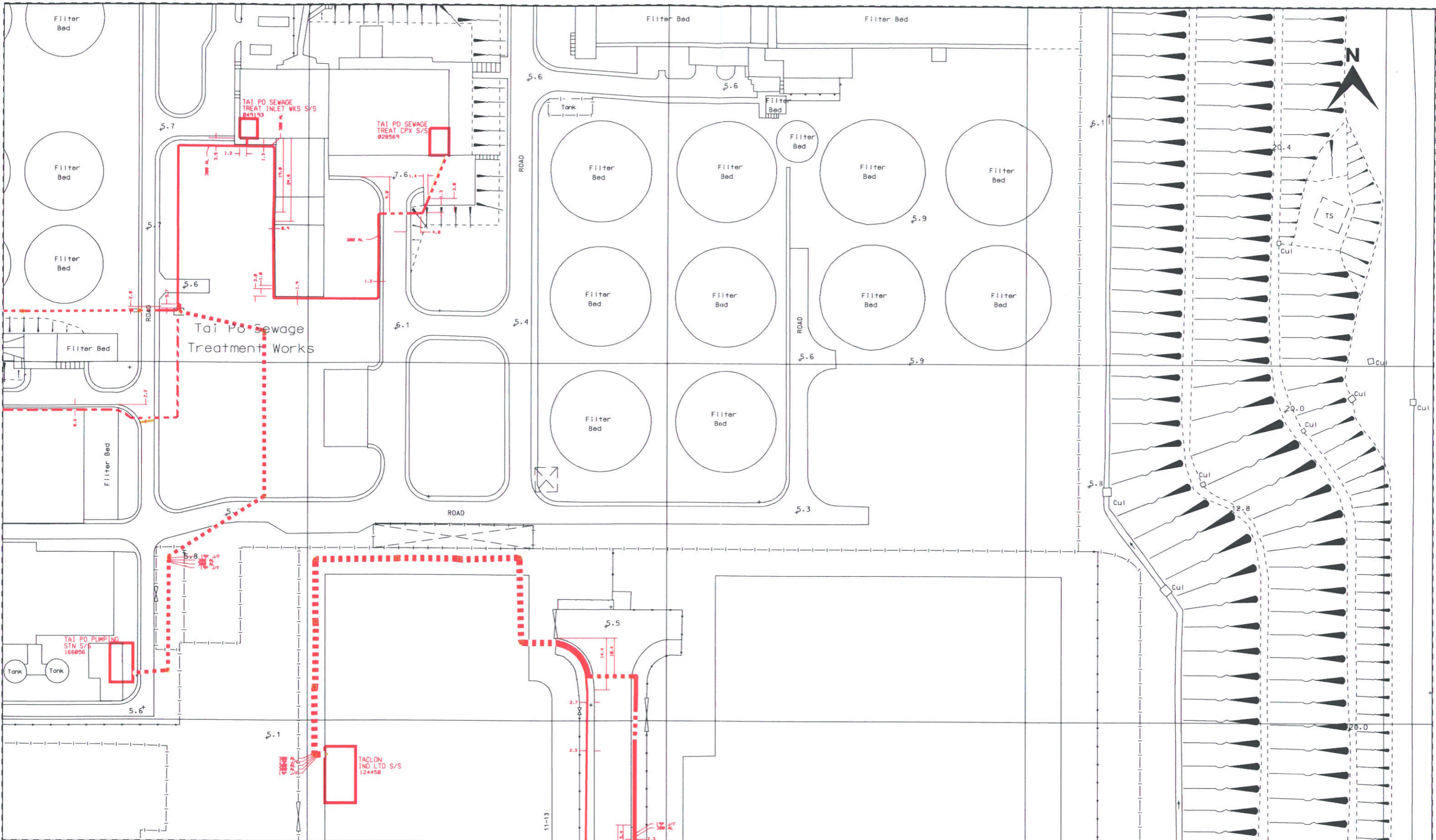

LEGEND			
	IN SERVICE UNDERGROUND TRANSMISSION CABLE, SUBMARINE CABLE		L.V. OVERHEAD LINE (1 PHASE)
	IN SERVICE UNDERGROUND 132kV CABLE		L.V. OVERHEAD LINE (3 PHASE)
	IN SERVICE UNDERGROUND 66kV CABLE		L.V. OVERHEAD LINE (ABC)
	IN SERVICE UNDERGROUND 33kV CABLE		L.V. OVERHEAD LINE (PVC)
	IN SERVICE UNDERGROUND 11kV CABLE		11kV OVERHEAD LINE
	IN SERVICE SUBMARINE 11kV CABLE		33kV OVERHEAD LINE
	IN SERVICE UNDERGROUND LV CABLE		DUCT LINE
	FIBRE OPTIC		TRANSMISSION OHL TOWER
	TRANSMISSION OVERHEAD LINE (OHL)		NOT IN SERVICE UNDERGROUND PILOT CABLE
	PILOT CABLE THROUGH DUCT		CABLE THROUGH DUCT
	CABLE THROUGH DUCT		SUBSTATION

ALL LOCATIONS, MEASUREMENTS, DIMENSIONS AND DISTANCES ARE FOR CLP POWER INTERNAL USE ONLY. THEY SHOULD NOT BE SCALED AND ASSUMED ACCURATE. CLP POWER ACCEPTS NO RESPONSIBILITY IN THE EVENT OF ANY INACCURACY. EXTREME CARE MUST BE EXERCISED WHEN WORKING IN CLOSE PROXIMITY TO OUR EQUIPMENT. PLEASE CONTACT OUR REGIONAL OFFICE AS SOON AS YOU ARE READ TO COMMENCE WORK.



中華電力  
CLP Power

MAP NO: **CLP Facility Records Map 07NE01C**

SCALE: 1:1000      PRINTED ON: 10-11-2002



**Towngas**

The Hong Kong and China Gas Company Limited

15 November 2002

Your Ref.: A04202/c/tchk/2

Our Ref.: UNE2002/20444/N

Maunsell Environmental Mgt Consultants Ltd  
Room 1213-1219 Grand Central Plaza  
Tower 2  
138 Shatin Rural Committee Road  
Shatin  
NT

Attn. : Mr Terence Kong

Maunsell Environmental Management Consultants Ltd.			
Received	20.11.02		
File No.	IC/F/Q		
TS	AYK	TJC	Sign Off
MKO	JLAM	TYUT	
Env. Consultant	TCHK		
Others			
Copied To			
Reply Date			

In view of safety, HKCG provides FREE service to assist the road opening parties to locate the approximate gas pipe alignment on site, Please call **29631811** before work starts.

Dear Sirs

**Re: Plan of Gas Pipeline Surrounding the Proposed Development Between Shuen Wan Landfill and Tai Po Sewage Treatment Work**

We received your letter of 06 November 2002 requesting drawings on the location of Towngas pipelines. We are attaching the drawings for the location of existing/proposed pipelines that you requested. These drawings are only approximate. The pipes may be located in different positions and depths due to continual road development, system alterations and underground obstructions. Therefore, the exact location may be altered from point to point. There is the possibility that some gas pipes particularly those laid long time ago or laid by other Registered Gas Contractors may not appear in our records. In the case of some unknown pipes being exposed during your construction work, please contact us immediately.

We suggest that you do not work too close to the pipes as any damage to them could create a hazardous accident. You should be very careful when excavating the area. You should locate the exact position and depth of the pipes by making a series of hand-dug trial holes. Heavy machinery such as drills or mechanical excavators cannot be used to do this. If your company damages our pipelines, you will be responsible for all resultant costs.

We would also like to remind you not to disturb any part of Towngas pipeline or their associated properties and not to temporarily or permanently encase part or all of our gas pipes in any form of concrete structures. Please provide steel gas pipes a clearance of 600mm and other gas pipes a clearance of 300mm. This space is necessary for future maintenance.

If you want to divert gas pipes, we must have at least two months and six months notice respectively for distribution and transmission networks before commencing our planning works. Your company will be responsible for the full cost of any diversion. A written agreement will be required before we begin any diversion.

**SAFETY:**

1. If a gas pipe is damaged or a leak is suspected, phone the Emergency Services Hotline, 28806999, immediately. Also, keep all ignition sources away from the site.
2. Cigarette smoking is prohibited when working near the pipelines.
3. In case of a leak, stop work, evacuate all employees and the public from the area.

Please contact Mr H P Ng on 2963 1811 to arrange for a joint site inspection regarding the pipe location. Further, you must notify us at least one week before beginning work on site. For enquiry of proposed pipeline, if any, or availability of gas supply, please contact Mr K W Lee on 2963 1120.

Yours faithfully



 Albert C K Leung  
System Operation Manager

AL/wtc

Encl. Get All Safe Leaflet

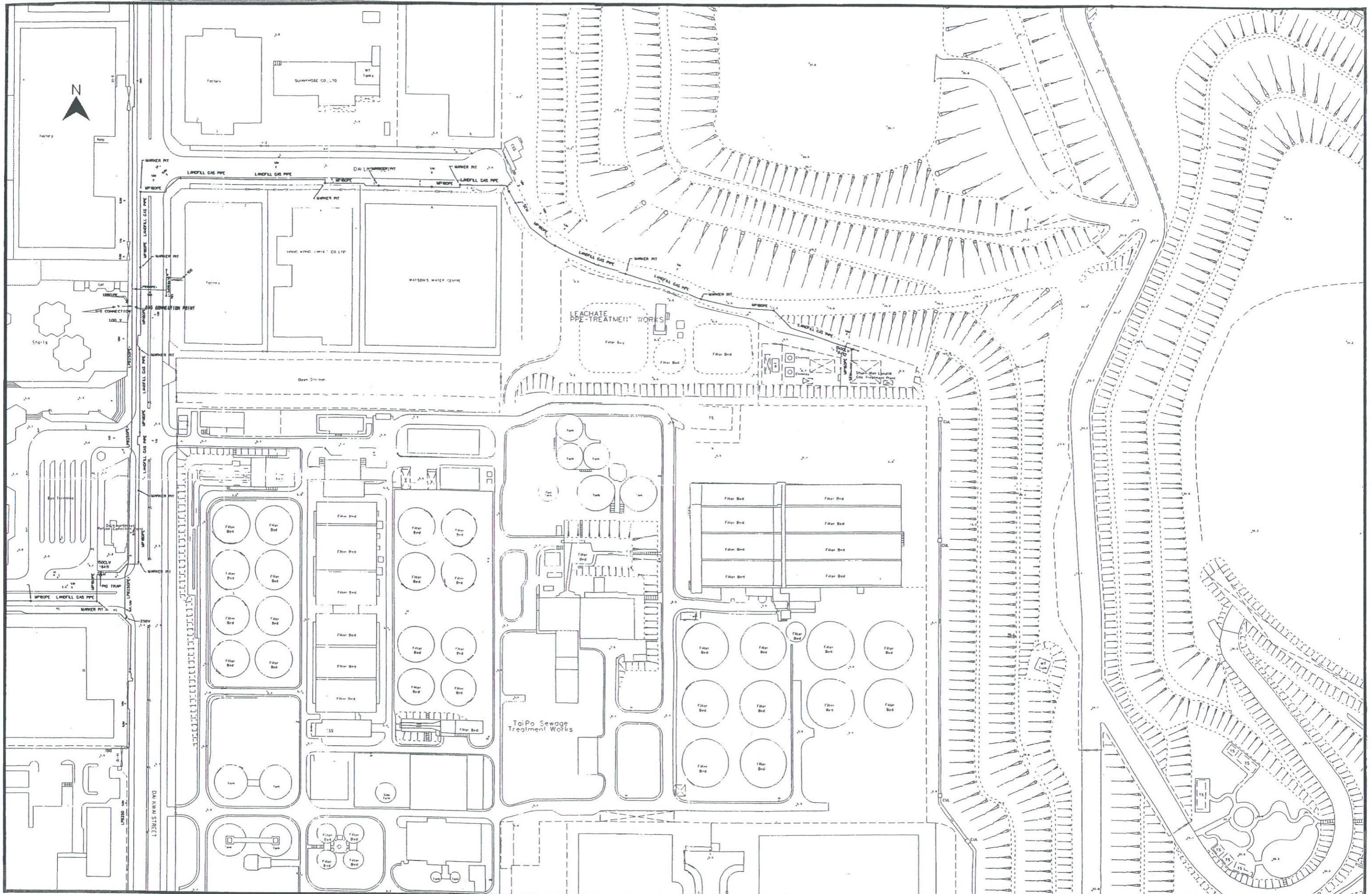

<p>Network Department          15:16:3          SCALE: 1:1000</p>	<p>THE POSITION OF GAS SIGNS SHOWN ARE APPROXIMATE ONLY. EXACT LOCATION AND DEPTH OF SIGNS SHOULD BE LOCATED BY WHO HAS THE NEAREST EXISTING GAS MUST BE CHECKED USING EXCAVATION IF THE PROXIMITY TO THESE SIGNS.</p>
	<p>DATE OF DESIGN: Nov 12 2002</p>
	<p>Map data reproduced with permission of the Director of Lands, (C) Hong Kong          No part of this drawing may be reproduced without the prior permission of HKCC</p>

1:1000

THE POSITION OF GAS SIGNS SHOWN ARE APPROXIMATE ONLY. EXACT LOCATION AND DEPTH OF SIGNS SHOULD BE LOCATED BY WHO HAS THE NEAREST EXISTING GAS MUST BE CHECKED USING EXCAVATION IF THE PROXIMITY TO THESE SIGNS.

DATE OF DESIGN: Nov 12 2002

Map data reproduced with permission of the Director of Lands, (C) Hong Kong  
 No part of this drawing may be reproduced without the prior permission of HKCC



水務署

Water Supplies Department



電子郵遞  
e-mail

電話  
Telephone 2399 4246

檔號  
Reference (9) in WSD/MNE 486/70/72/2001

圖文傳真  
Facsimile 2789 4680

Date: 23 December 2002

Your Ref: A04202/c/tchk/1

Maunsell Environmental Management Consultants Ltd.  
Room 1213-1219, Grand Central Plaza, Tower 2,  
138 Shatin Rural Committee Road,  
Sha Tin, N.T., Hong Kong.  
(Attn.: Mr. Terence Kong)

Maunsell Environmental Management Consultants Ltd.			
Received	27-12-02		
File No.	I/C/F/Q		
TS	AYK	TJC	Sign Off
MKO	JLAM	TYUT	
Env. Consultant	TCHK		
Others			
Copied To			
Reply Date			

Dear Sirs,

### Plan of Existing Water Mains and Waterworks Installations Surrounding the Proposed Development between Shuen Wan Landfill and Tai Po Sewage Treatment Work

We return herewith a copy of your/our plan(s) with the existing watermains and waterworks installations indicated. You are requested to note that the alignment of the watermains shown is indicative only and although it is our intention to provide you with the most up to date information, we cannot guarantee that all recently laid watermains have been incorporated in our central records and hence in the returned plan(s).

To ensure that the existing watermains will not be damaged or adversely affected by your works, you are requested to advise your contractor/site staff to exercise care and to take all necessary precautions to protect the watermains, the exact lines and levels of which should be ascertained by hand dug trial pits on site. Please also note that you should comply with the requirements as given in the attached "Conditions of Working in the Vicinity of Waterworks Installations" and take all necessary steps to avoid any damage to our watermains/waterworks installations, for which you will be held responsible.

If you require further information or assistance, please contact our Inspector of Works (Inspection Team), Mr. M Y Ma, at Tel. No. 2399 4151.

Yours faithfully,

( Y. M. CHING )

for Chief Engineer/New Territories East  
Water Supplies Department

Encl.

旺角辦事處  
Mong Kok Office  
九龍旺角洗衣街一二八號  
128 Sai Yee Street,  
Mong Kok, Kowloon

供水五十年 服務客為先

150 Years of Water Supply

We Care For You



## **Conditions of Working in the Vicinity of Waterworks Installations**

### **Water Mains**

1. No water mains or their support shall be interfered with or buried without the prior approval of W.S.D.
2. The Contractor shall check the location of water mains and cables and other services by hand dug trial holes and take precautionary measures to protect them.
3. Free access shall be maintained at all time for the staff of W.S.D., their contractors and vehicles to go into and/or through the site to carry out installation, inspection, operation, maintenance or repair works.
4. No additional filling material is to be deposited over a water main without the approval of W.S.D.
5. No structures shall be erected or materials stored within 3 metres from the centre line of mains of 900mm diameter or under, and 5 metres for mains exceeding 900mm in diameter.
6. Full details of any proposed temporary works affecting W.S.D. installations and of any temporary support or protective measure to mains shall be submitted to the Client Department for approval and to W.S.D. for information. Work shall not commence until approval is given by the Client Department.
7. Diversion of W.S.D. mains, other than those already shown on the contract drawings, shall only be considered when all other options such as protection of the mains or modification of design have been considered and found to be impracticable.
8. The programme for laying or diversions of all W.S.D. mains shall be agreed with W.S.D. in advance. A 14-day notice shall be served to W.S.D. to confirm site availability for the commencement of any agreed diversion. W.S.D. shall also be notified of any change required in the agreed programme as soon as possible.
9. All excavation works within 1.5m of water mains exceeding 900mm in diameter shall be carried out by hand. No excavation shall be carried out within lines 45 °C below the centre line of such mains of 45 °C below the edges of the foundation of their supports without approved ground support. If the support is in the form of steel sheets, they shall be left in place after works. Removal of support from underneath the mains is not permitted.
10. No earth fill ramps are to be used to form temporary crossings of the large diameter mains. Temporary ramps/bridges in steel, timber, or concrete shall be used with the deck and support piers clear of the mains so that no loading is imposed on the mains.
11. All temporary works near the large diameter water mains shall be kept at least 1 metre away from the edge of the mains and the length of mains affected shall be well protected by a temporary timber cover raised 250mm clear of the mains to ensure no impact damage.

### **Blasting, Drilling and Piling near Waterworks Installation**

12. No blasting, drilling or pile driving (including sheet piling) within a distance of 60m from waterworks tunnels will be carried out.
13. The maximum particle velocity and amplitude of ground movements due to blasting or pile driving as measured at the nearest waterworks tunnel or other water retaining structures shall not exceed 13mm/sec. and 0.1 mm respectively.
14. The maximum particle velocity and amplitude of ground movements due to blasting or pile driving as measured at the nearest water mains shall not exceed 25mm/sec. and 0.2mm respectively.
15. The size of charge, pattern and timing of detonation etc. will be decided by the Commissioner of Mines after carrying out test firing at site.
16. The movement of mains and structures shall be monitored by surveys jointly attended by W.S.D., the project Department and the Contractor. One week's notice shall be given to W.S.D. for any survey request.
17. Vibration from blasting, piling or other causing activities shall be monitored by means of agreed vibrograph reading. The vibrograph shall comply with the Specification below and shall be provided free by the Contractor.
18. The results of monitoring of the vibration and any movement of water mains and W.S.D. structures shall be submitted to W.S.D. for record purposes. If the vibration limits above are exceeded or movement in excess of 5mm is detected, works shall be proposed works shall be approved by W.S.D. before my work commences.

### **Specification for Vibrograph**

- (a) The machine shall be a direct reading type peak particle velocity vibrograph.
- (b) It shall have 3 channels, recording in 3 mutually perpendicular directions.
- (c) It must be able to record particle velocity and amplitude, although not necessarily at the same time.
- (d) It must produce a permanent trace on paper, preferably by using ultra-violet light.
- (e) The recording paper must be easily obtainable locally.
- (f) The instrument must be portable and battery operated (or else a generator must be supplied free).
- (g) Operating instructions must be in English.

### **Excavation near Waterworks Installation**

19. Excavation shall not be permitted within lines drawn at 45 ° downwards from a point 6m away from the foundation lines of any waterworks structure.
20. No excavation should be carried out within 60 metres, horizontally of any tunnel and no excavation or well driving shall be carried out above any tunnel.
21. No quarrying operations shall be carried out above and/or within 150 metres horizontally from any waterworks tunnel.

### **Prevention of Pollution of Waterworks Catchments**

22. Site formation plans shall be submitted to W.S.D. for approval prior to commencement of work.
23. The contractor shall exercise particular care not to cause pollution or siltation to any waterworks catchment area. Any bulk excavation within a waterworks entering streams or intakes. The details of silt trap shall be submitted to W.S.D. for approval. Silt traps shall be cleared out regularly and in particular after any rainstorm.
24. No oil, diesel or fuel shall be stored within waterworks catchment area.
25. No labour lines shall be allowed within waterworks catchment area.
26. Portable toilets of the closed chemical type shall be provided on site and the waste be cleared away daily and disposed of outside the Waterworks catchment area.
27. The Contractor shall be responsible for cleaning frequently any waterworks roads and associated drainage works of mud and debris.

### **Waterworks Installation (e.g. Treatment Works) nearby**

28. The Contractor will not be permitted access to any adjacent W.S.D. installations.
29. An unimpeded free vehicular access shall be maintained at all time to and from the adjacent Waterworks Installations in the vicinity

-END-

TYPE	CONVENTIONS	NOTES:
	LEGENDS	
<p><b>MAINS</b>            FRESH/SALT WATER MAINS(see Note 1)            RAW/UNTREATED WATER MAINS(see Note 1)            PROPOSED MAINS            BEING LAID MAINS            WASHOUT PIPE            SLUDGE PIPE            WATERMAINS REQUIRE REGULAR FLUSHING            PRIVATE MAINS(see Note 2)            MAINS OF OTHER DEPARTMENTS(see Note 3)</p> <p><b>FIRE SERVICES</b>            PEDESTAL FIRE HYDRANT            GROUND FIRE HYDRANT            HEAVY DRAW-OFF FIRE HYDRANT            SWAN NECK FIRE HYDRANT            TWIN OUTLET SWAN NECK FIRE HYDRANT            FIRE SERVICES CONNECTION</p> <p><b>VALVES</b>            BUTTERFLY VALVE            SLUICE VALVE            GATE VALVE            STOP COCK            SINGLE AIR VALVE            DOUBLE AIR VALVE            WASHOUT VALVE            NON RETURN/REFLUX VALVE            FLOW REGULATING VALVE            NORMALLY CLOSED VALVE            PRESSURE CONTROL/REDUCING/RELIEF VALVE</p> <p><b>OTHERS</b>            STANDPIPE            VENTURI TUBE            INSPECTION/MANHOLE TEE            AIR VALVE ON MANHOLE TEE            WATER TUNNEL            ESSENTIAL VALVE REFERENCE NUMBER            LEAKAGE COLLECTION CHAMBER            LEAK NOISE CORRELATION POINT            CHECK METER/FLOWMETER            WASTE DETECTION METER            DISTRICT METER WITH STRAINER            FLOW MEASUREMENT CHAMBER FOR            ULTRASONIC FLOW METER            SHALLOW COVERED WATERMAINS            INSPECTION MANHOLE            CHANGE IN PIPE            PIPES CONNECTED            PIPES CROSS OVER</p>		<p>1. WSD mains include:            (i) mains laid and maintained by WSD            (ii) mains laid by other departments and private parties but maintained by WSD at WSD's cost.</p> <p>2. Private mains include mains in private roads, private housing estates, etc. not maintained by WSD.</p> <p>3. Mains of other departments include mains laid by other government departments not maintained by WSD.</p> <p><b>ABBREVIATIONS</b>            AC - Asbestos Cement            CI - Cast Iron            CONC - Concrete            DI - Ductile Iron            GI - Galvanised Iron            GIL - Lined Galvanised Iron            GRP - Glass Fibre Reinforced Plastics            HDPE - High Density Polyethylene            MDPE - Medium Density Polyethylene            PE - Polyethylene            MS - Mild Steel            S - Steel            UPVC - Unplasticised Polyvinyl Chloride</p>
<b>PROVISIONAL COPY</b>		

**DESIGNATIONS**

'450 DI 99' designates 450 mm Dia. DI Pipe laid in 1999.  
 '900 S 02' designates 900 mm Dia. Steel Pipe laid in 2002.

TITLE MAINS RECORDS SIGN CONVENTIONS AND DESIGNATIONS	Drawn by	Date	DRAWING NO. SK3988 A
	Approved CE/RA	Date	
			Water Supplies Department

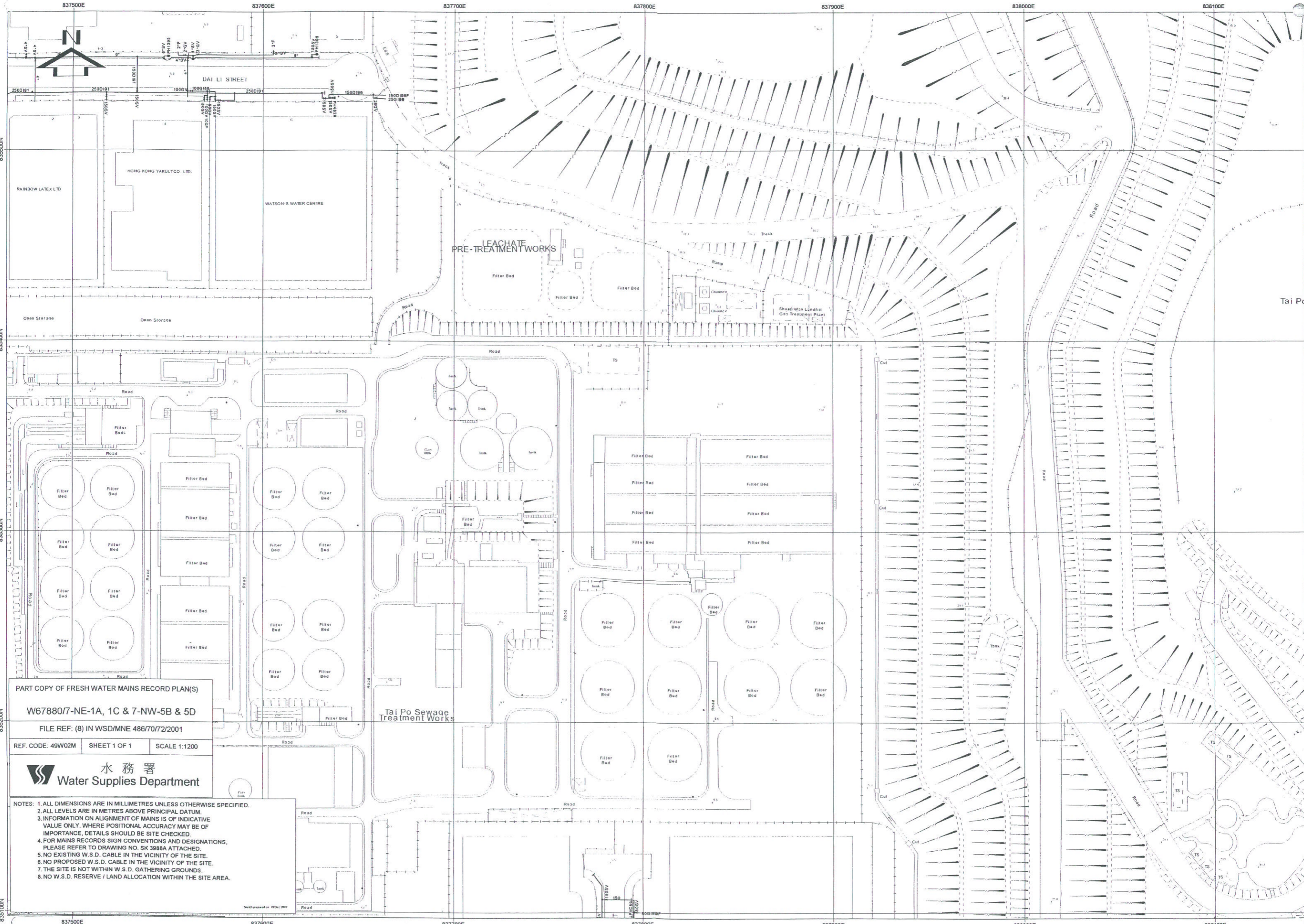

PART COPY OF FRESH WATER MAINS RECORD PLAN(S)

W67880/7-NE-1A, 1C & 7-NW-5B & 5D

FILE REF: (8) IN WSD/MNE 486/70/2/2001

REF. CODE: 49W02M SHEET 1 OF 1 SCALE 1:1200



- NOTES:
1. ALL DIMENSIONS ARE IN MILLIMETRES UNLESS OTHERWISE SPECIFIED.
  2. ALL LEVELS ARE IN METRES ABOVE PRINCIPAL DATUM.
  3. INFORMATION ON ALIGNMENT OF MAINS IS OF INDICATIVE VALUE ONLY. WHERE POSITIONAL ACCURACY MAY BE OF IMPORTANCE, DETAILS SHOULD BE SITE CHECKED.
  4. FOR MAINS RECORDS SIGN CONVENTIONS AND DESIGNATIONS, PLEASE REFER TO DRAWING NO. SK 3988A ATTACHED.
  5. NO EXISTING W.S.D. CABLE IN THE VICINITY OF THE SITE.
  6. NO PROPOSED W.S.D. CABLE IN THE VICINITY OF THE SITE.
  7. THE SITE IS NOT WITHIN W.S.D. GATHERING GROUNDS.
  8. NO W.S.D. RESERVE / LAND ALLOCATION WITHIN THE SITE AREA.

Sheet prepared on 18 Dec 2007