



832000 E 832250 E 832500 E 832750 E 833000 E

817000 N

816750 N

816500 N

816250 N

LEGEND:

- PROPOSED ROUTE OF 1200# FRESH WATER MAIN
- NOISE SENSITIVE RECEIVERS
- 300m NOISE ASSESSMENT BOUNDARY
- WORKS AREA BOUNDARY

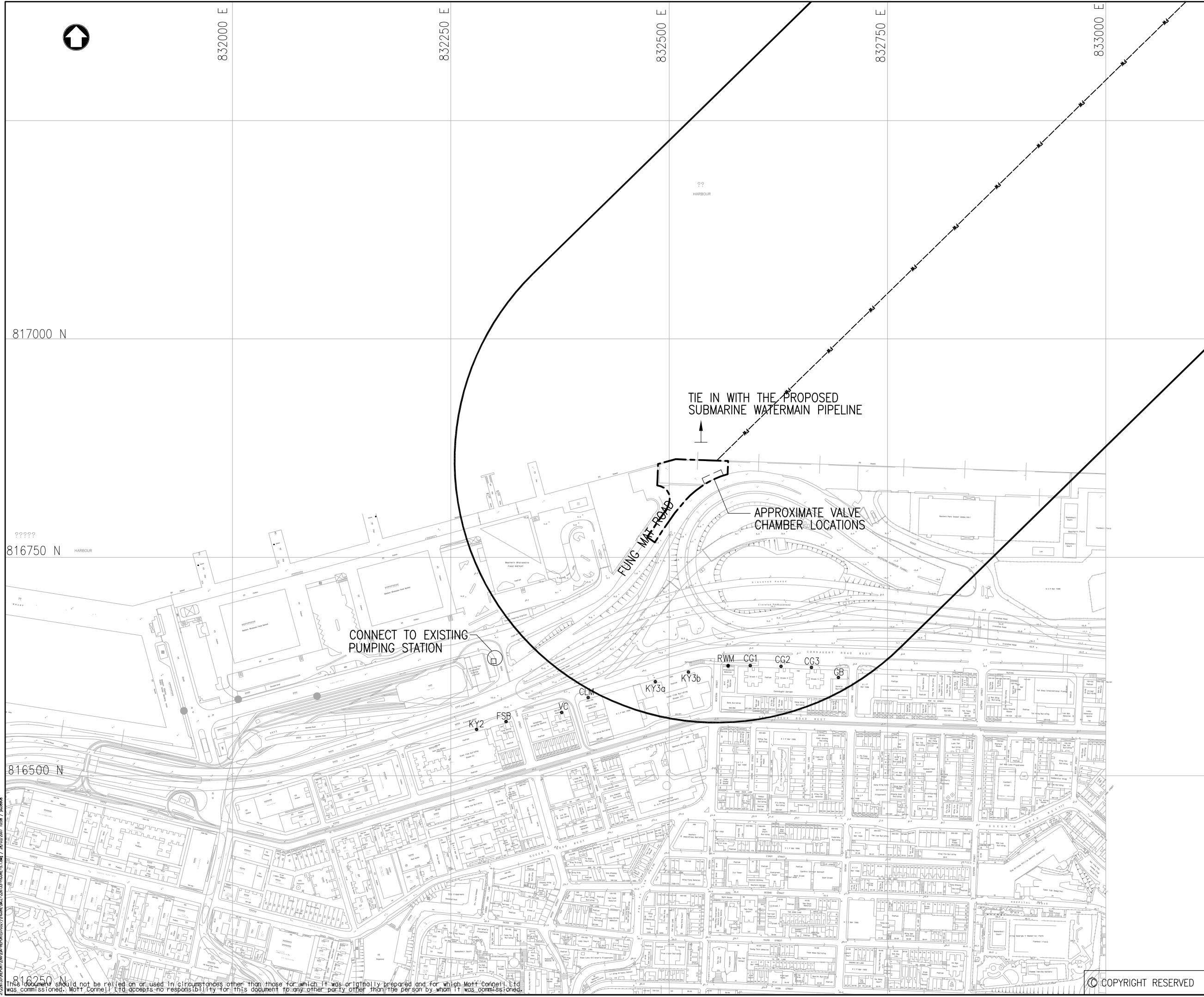

A	06/06	LYK	PRELIMINARY		
Rev	Date	Drawn	Description	Ch'k'd	App'd

Mott Connell
 Mott Connell Limited
 40/F Hopewell Centre
 183 Queen's Road East
 Hong Kong
 Tel 2828 5757
 Fax 2827 1823
 Wed www.mottmac.com

**THE GOVERNMENT OF THE HONG KONG
 SPECIAL ADMINISTRATIVE REGION
 WATER SUPPLIES DEPARTMENT**

Contract No. CE42/2005(W5)
 Project

LAYING OF WESTERN CROSS HARBOUR MAIN AND ASSOCIATED LAND MAINS FROM WEST KOWLOON TO SAI YING PUN – INVESTIGATION

LOCATIONS OF NOISE SENSITIVE RECEIVERS IN SAI YING PUN

Designed		Eng.Chk.	
Drawn	LYK	Coordination	
Dwg.Chk.		Approved	
Scale	Project	226133	Status
1 : 2000@A1	CAD File		
Drawing No.	J:\226133\REPORT\DWG\DWG-REPORT\070327\FIGURE\MCL-226133-FIGURE-5.1.dwg		Rev

This document should not be relied on or used in circumstances other than those for which it was originally prepared and for which Mott Connell Ltd was commissioned. Mott Connell Ltd accepts no responsibility for this document to any other party other than the person by whom it was commissioned.