

KEY FOR LANDSCAPE CHARACTER AREA

- LZ1 Fleet Arcade / Wan Chai West Sewage Screening Plant
- LZ2 The Hong Kong Academy for Performing Arts (HKAPA)
- LZ3 Fenwick Pier Street Public Open Space
- LZ4 The HKCEC Open Space
- LZ5 The HKCEC, Grand Hyatt / Renaissance Harbour View Hotels
- LZ5A Renaissance Harbour View Plaza
- LZ6 The Hong Kong Convention and Exhibition Centre Extension
- LZ6A The Hong Kong Convention and Exhibition Centre Extension Open Space
- LZ7 Government Towers / Shui On Centre
- LZ7A Government Tower Plaza
- LZ8 Central Plaza
- LZ8A Central Plaza Open Space
- LZ9 China Resources Building / Sun Hung Kai Centre
- LZ9A Harbour Road Garden
- LZ10 Great Eagle Centre / Harbour Centre
- LZ11 Public Transport Interchange (PTI)
- LZ12 Harbour Road Sports Centre and Swimming Complex
- LZ13 Wan Chai Ferry Pier
- LZ14 Wan Chai Sports Ground
- LZ15 Society for the Prevention of Cruelty to Animals (SPCA) Building and Utilities
- LZ16 Wanchai Interchange
- LZ16A Tunnel Approach Rest Garden
- LZ17 Ex - Wan Chai Public Cargo Working Area
- LZ18 The Royal Hong Kong Yacht Club (RHKYC)
- LZ19 The Police Officers' Club
- LZ20 The Noon Day Gun and Typhoon Shelter Edge
- LZ21 The Causeway Bay Typhoon Shelter
- LZ22 Shipyard and Fire Station
- LZ23 Gloucester Road / Victoria Park Road
- LZ24 Harbour Road
- LZ25 Convention Avenue
- LZ26 Fleming Road
- LZ27 Tonnochy Road
- LZ28 Marsh Road, Hung Hing Roads, Wan Shing Street
- LZ29 Victoria Harbour
- LZ30 Island Eastern Corridor
- LZ31 Victoria Park

LEGEND

- PLANNING AND ENGINEERING REVIEW STUDY AREA BOUNDARY
- LANDSCAPE IMPACT STUDY BOUNDARY
- LZ1 LANDSCAPE CHARACTER AREA
- DP1 CENTRAL-WANCHAI BYPASS (CWB) INCLUDING ITS ROAD TUNNEL AND SLIP ROADS
- DP2 ROAD P2 AND OTHER ROADS WHICH ARE CLASSIFIED AS PRIMARY/DISTRICT DISTRIBUTOR ROADS
- DP3 RECLAMATION WORKS INCLUDING ASSOCIATED DREDGING WORKS
- DP4 TEMPORARY TYPHOON SHELTER

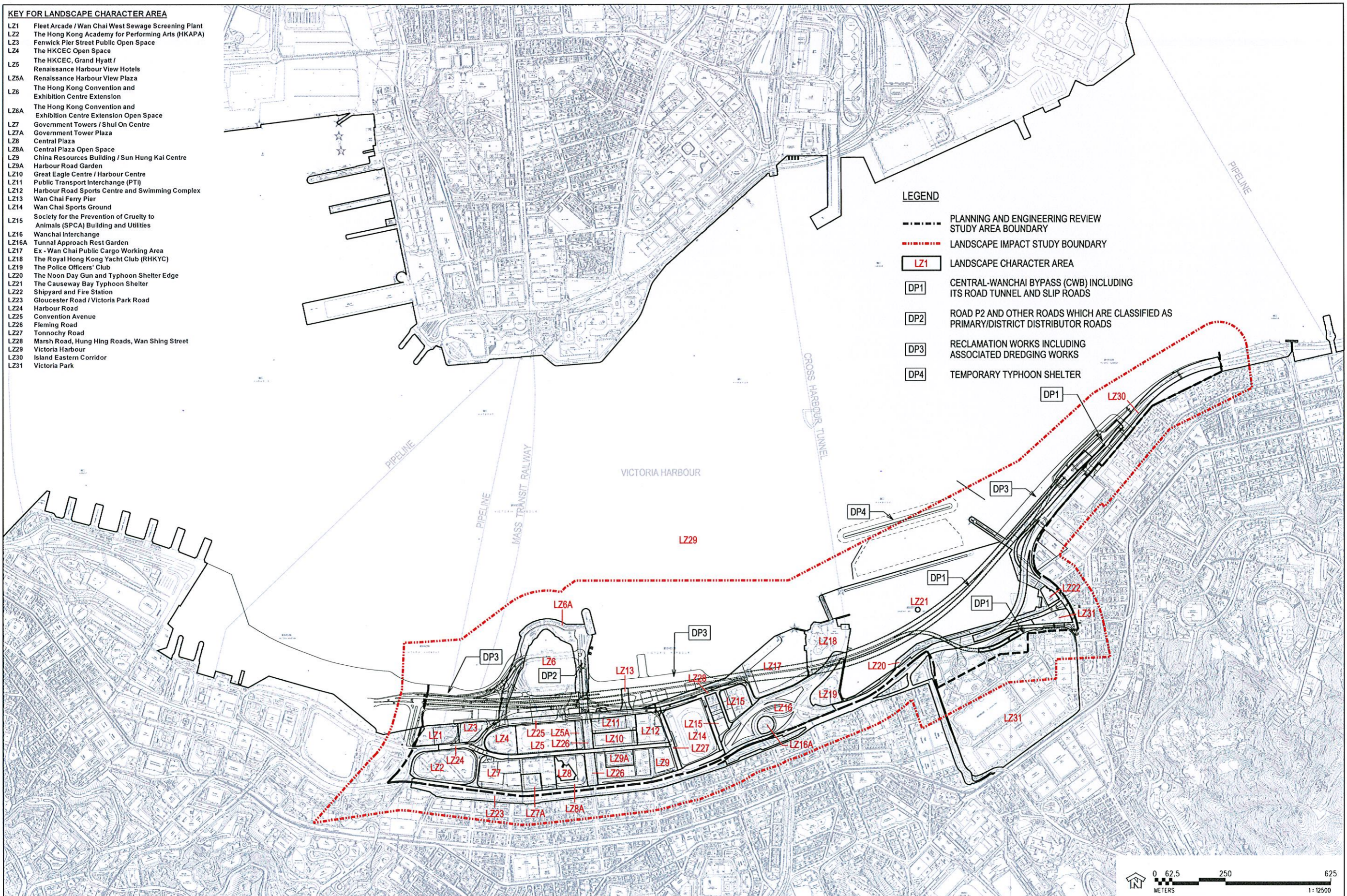

WAN CHAI DEVELOPMENT PHASE II - PLANNING AND ENGINEERING REVIEW

BASELINE LANDSCAPE CHARACTER AREAS DURING CONSTRUCTION

FIGURE 10.3