

**MAUNSELL** | **AECOM**  
Maunsell Consultants Asia Ltd

QUOTATION REF NO. HY(S)0/026/2006  
WIDENING OF TUEN MUN ROAD AT TSING TIN INTERCHANGE ENVIRONMENTAL IMPACT ASSESSMENT  
LOCATIONS OF "NEW" ROAD

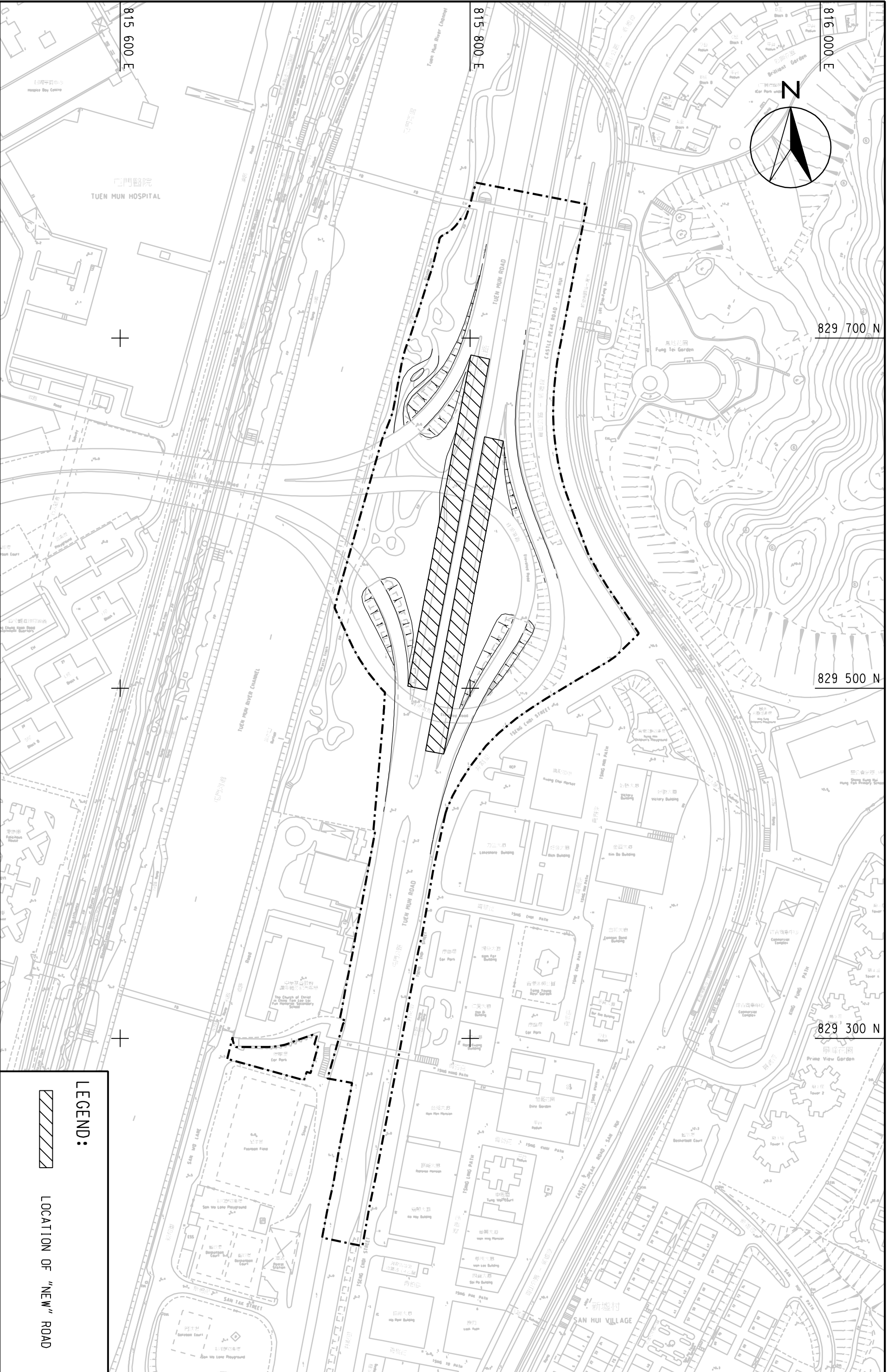

**LEGEND:**  
 LOCATION OF "NEW" ROAD

SCALE	A3 1:2000	DATE	JUL. 2007
CHECK	ACTM	DRAWN	CTM
JOB NO.	60022182	DRAWING NO.	APPENDIX 4.1
		REV	