

MAUNSELL | **AECOM**
Maunsell Consultants Asia Ltd

QUOTATION REF NO. HYS/J0/026/2006
WIDENING OF TUEN MUN ROAD AT TSING TIN INTERCHANGE ENVIRONMENTAL IMPACT ASSESSMENT
LOCATIONS OF PROPOSED NOISE MITIGATION MEASURES

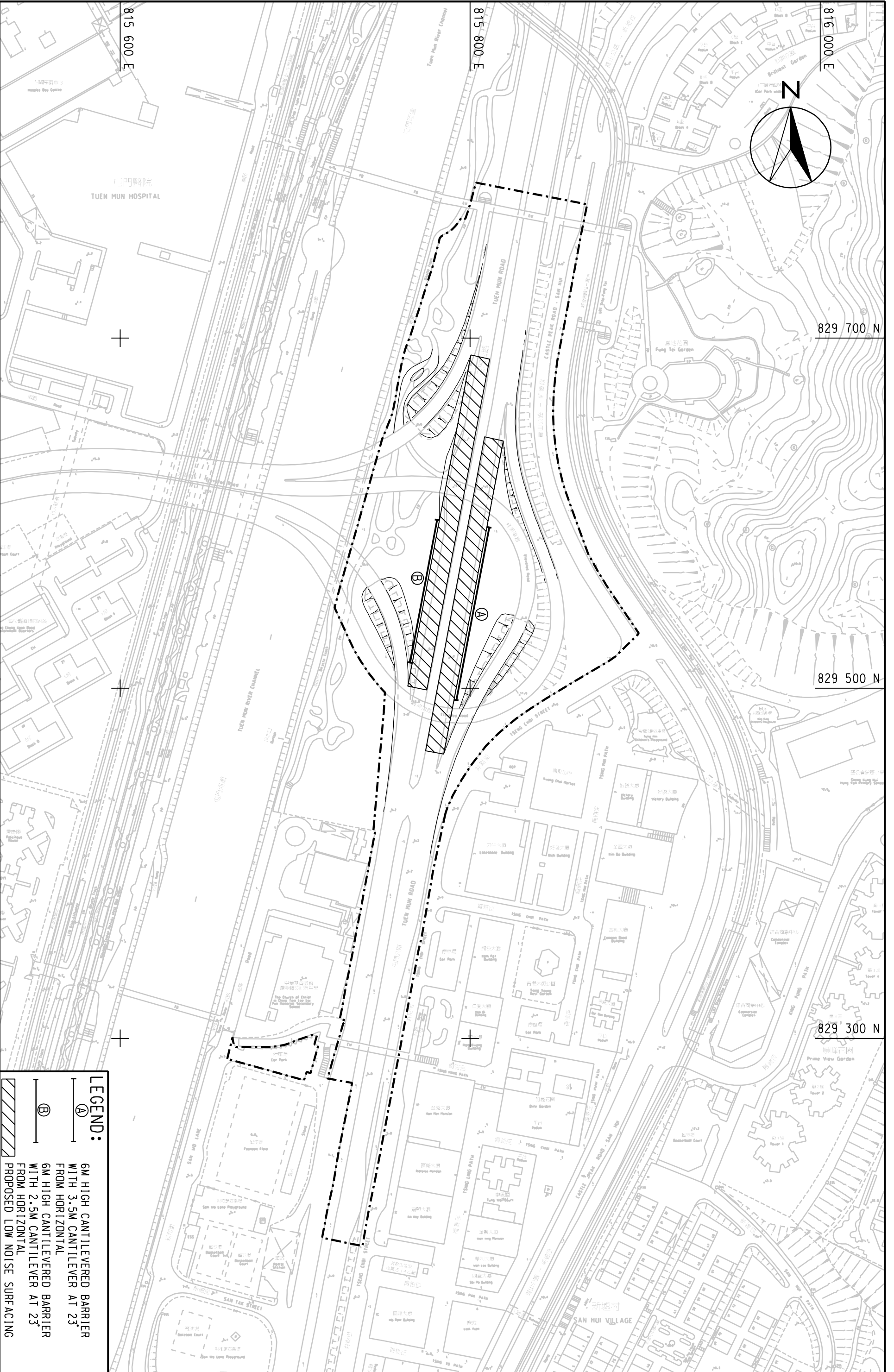

LEGEND:

	6M HIGH CANTILEVERED BARRIER WITH 3.5M CANTILEVER AT 23° FROM HORIZONTAL
	6M HIGH CANTILEVERED BARRIER WITH 2.5M CANTILEVER AT 23° FROM HORIZONTAL
	PROPOSED LOW NOISE SURFACING

SCALE	A3 1:2000	DATE	SEP. 2007
CHECK	ACTM	DRAWN	CTM
JOB NO.	60022182	DRAWING NO.	FIGURE 4.2
		REV	