

AGREEMENT NO. CE22/2005 (HY)
 TRAFFIC IMPROVEMENTS TO TUEN MAIN ROAD TOWN CENTRE SECTION
DETAILS FOR THE CALCULATIONS OF PORTALS

SCALE	N. T. S.	DATE	AUG 08
CHECK	AYMC	DRAWN	VCYL
JOB NO.	60025208	FIGURE NO.	APPENDIX 4.3
			REV
			-

MAUNSELL AECOM
 CONSULTANTS

FILES

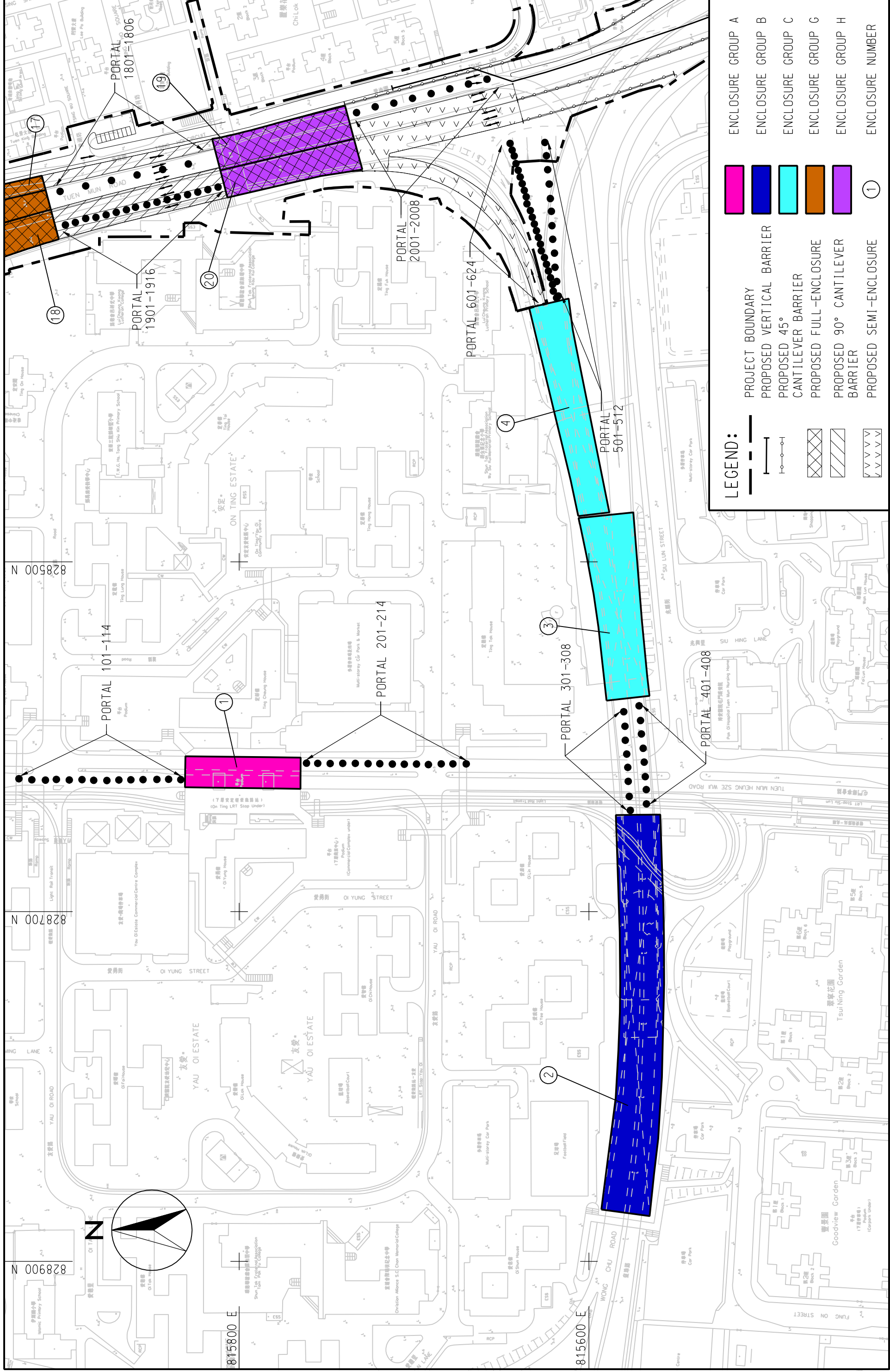

	ENCLOSURE GROUP A
	ENCLOSURE GROUP B
	ENCLOSURE GROUP C
	ENCLOSURE GROUP G
	ENCLOSURE GROUP H
	ENCLOSURE NUMBER

	PROJECT BOUNDARY
	PROPOSED VERTICAL BARRIER
	PROPOSED 45° CANTILEVER BARRIER
	PROPOSED FULL-ENCLOSURE
	PROPOSED 90° CANTILEVER BARRIER
	PROPOSED SEMI-ENCLOSURE

MAUNSELL AECOM		AGREEMENT NO. CE22/2005 (HY)	
茂盛 (亞洲) 工程顧問有限公司		TRAFFIC IMPROVEMENTS TO TUEN MUN ROAD TOWN CENTRE SECTION	
SCALE	A3 1:2000	DATE	AUG. 2007
CHECK	ETLM	DRAWN	LC
JOB NO.	60025208	FIGURE NO.	FIGURE A4.3
(SHEET 1 OF 4)		REV	—

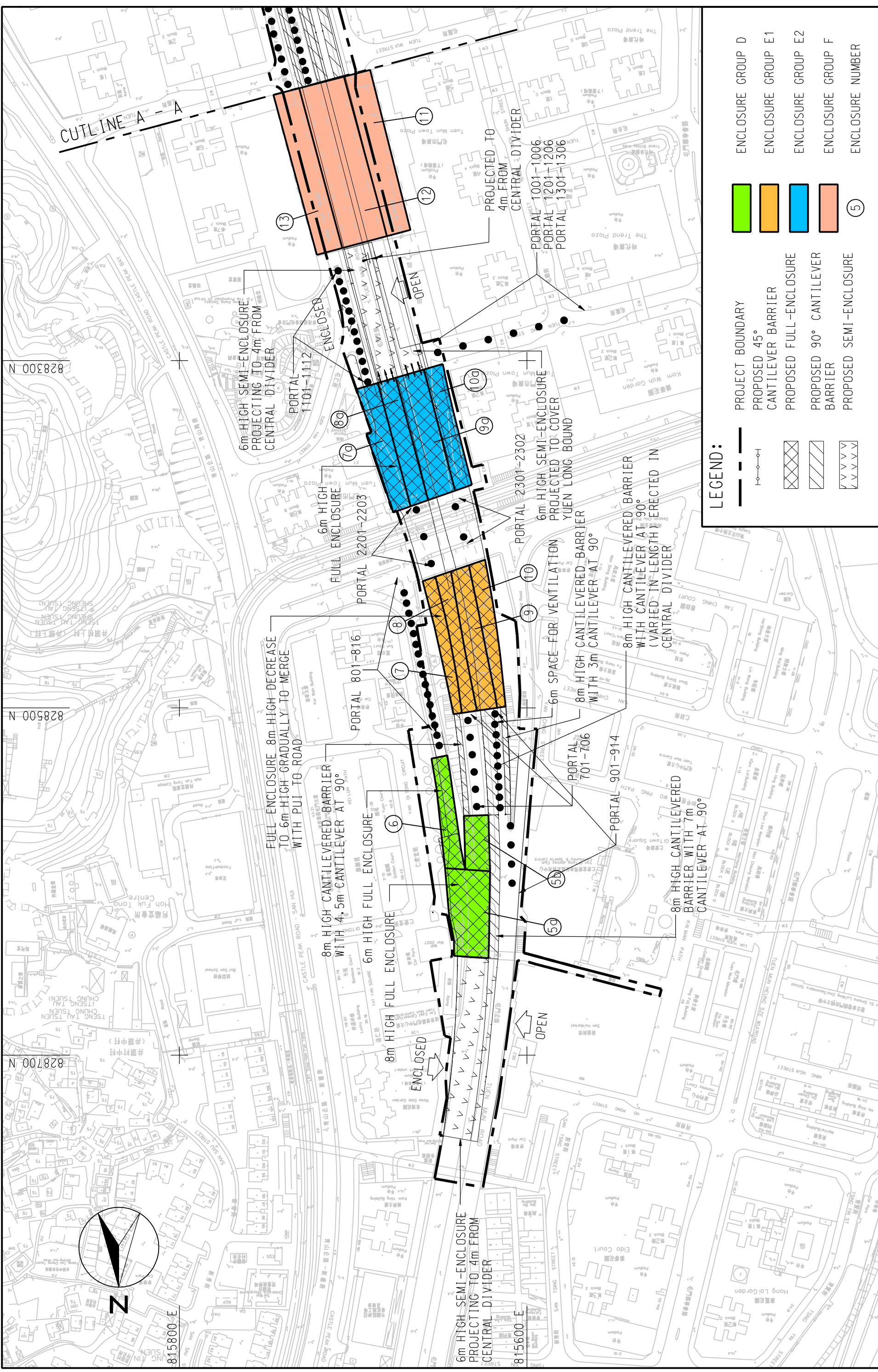

LEGEND:

	PROJECT BOUNDARY
	PROPOSED 45° CANTILEVER BARRIER
	PROPOSED FULL-ENCLOSURE BARRIER
	PROPOSED 90° CANTILEVER BARRIER
	PROPOSED SEMI-ENCLOSURE
	ENCLOSURE GROUP D
	ENCLOSURE GROUP E1
	ENCLOSURE GROUP E2
	ENCLOSURE GROUP F
	ENCLOSURE NUMBER

MAUNSELL AECOM 茂盛(亞洲)工程顧問有限公司	TRAFFIC IMPROVEMENTS TO TUEN MUN ROAD TOWN CENTRE SECTION	SCALE	A3 1:2000	DATE	AUG. 2007
	ISC3 PORTAL LOCATION	CHECK	ETLM	DRAWN	LC
	(SHEET 2 OF 4)	JOB NO.	60025208	FIGURE NO.	FIGURE A4.3
		REV			—

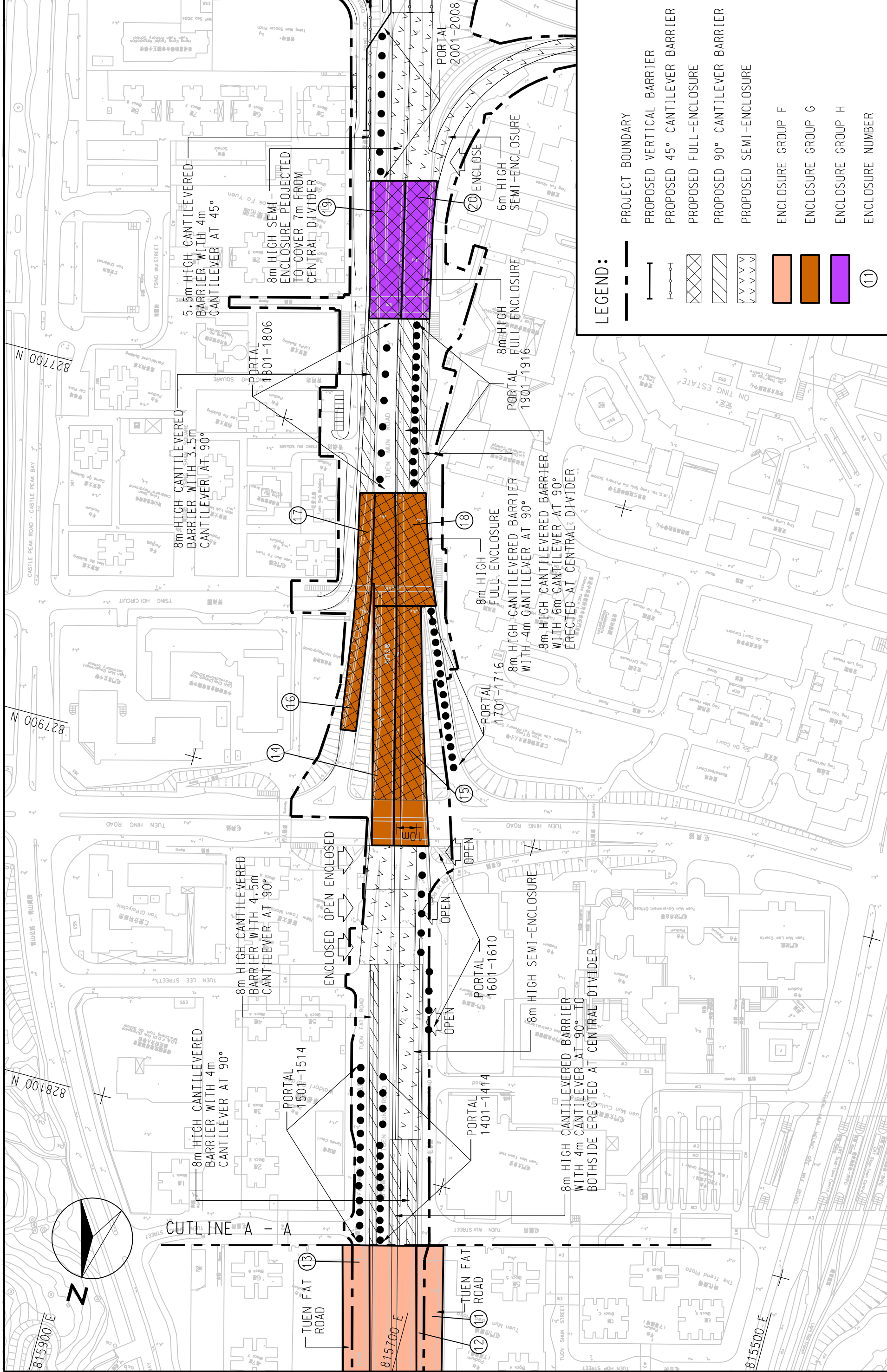

LEGEND:

- PROJECT BOUNDARY
- PROPOSED VERTICAL BARRIER
- PROPOSED 45° CANTILEVER BARRIER
- PROPOSED FULL-ENCLOSURE
- PROPOSED 90° CANTILEVER BARRIER
- PROPOSED SEMI-ENCLOSURE
- ENCLOSURE GROUP F
- ENCLOSURE GROUP G
- ENCLOSURE GROUP H
- (11) ENCLOSURE NUMBER

SCALE	A3 1:2000	DATE	AUG. 2007
CHECK	ETLM	DRAWN	LC
JOB NO.	60025208	FIGURE NO.	FIGURE A4.3
		REV	—

(SHEET 3 OF 4)

TRAFFIC IMPROVEMENTS TO TUEN MUN ROAD TOWN CENTRE SECTION

ISC3 PORTAL LOCATION

AGREEMENT NO. CE22/2005 (HY)

MAUNSELL AECOM
 茂盛 (亞洲) 工程顧問有限公司

\$FILE\$

\$DATE\$

\$TIMES\$

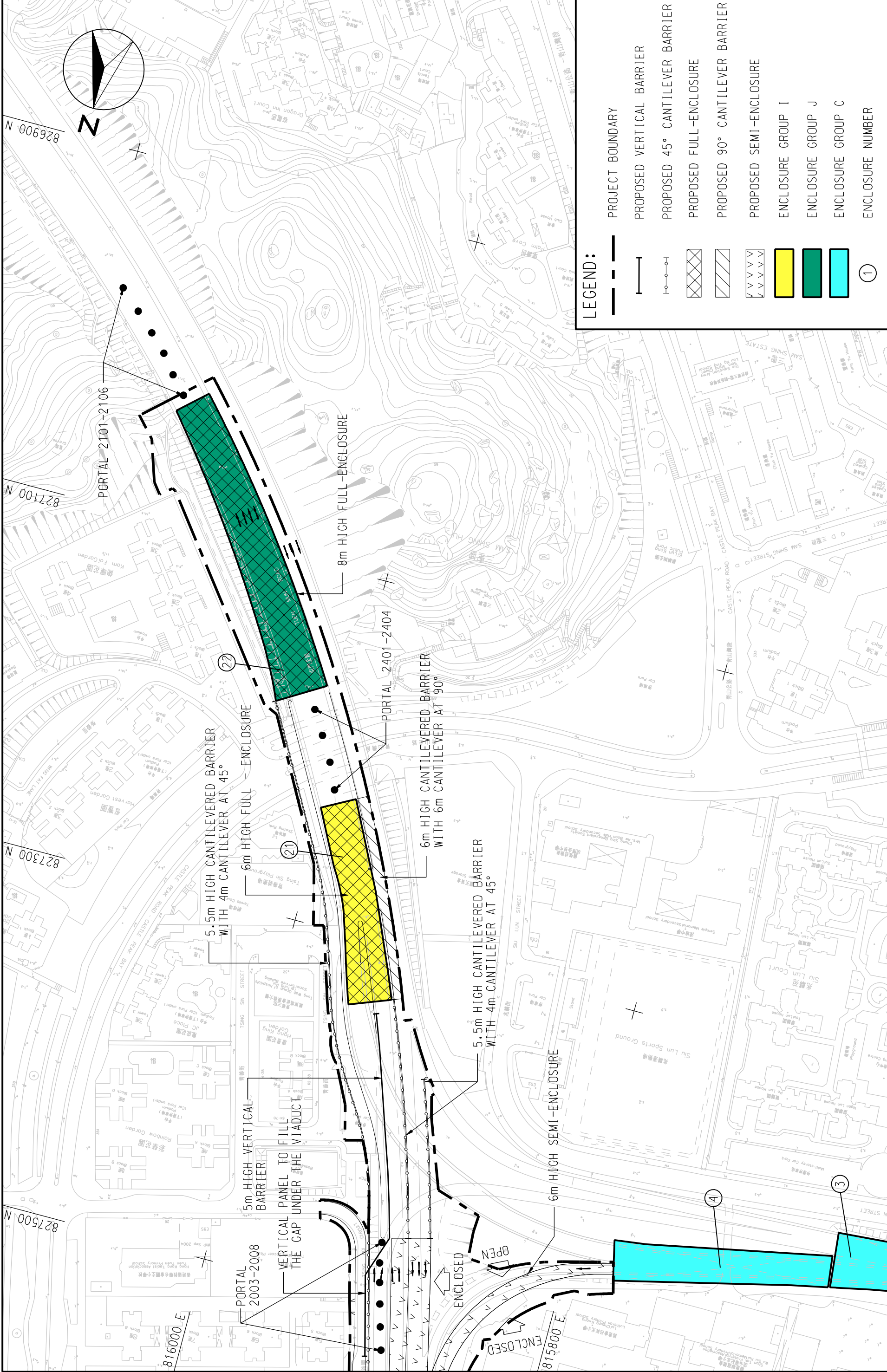

SCALE	A3 1:2000	DATE	JUL. 2008
CHECK	ETLM	DRAWN	LC
JOB No.	60025208	FIGURE No.	FIGURE A4.3
		REV	-

AGREEMENT NO. CE22/2005 (HY)
 TRAFFIC IMPROVEMENTS TO TUEN MUN ROAD TOWN CENTRE SECTION
 ISC3 PORTAL LOCATION
 (SHEET 4 OF 4)

MAUNSELL AECOM
 茂盛(亞洲)工程顧問有限公司