

CUT LINE 2 - 2

CHUKONG WAREHOUSE

CHUKONG WAREHOUSE

NOTE:
1. FOR NOTES AND LEGEND SEE DRAWING NO. 60044963/E1A/SK 2.

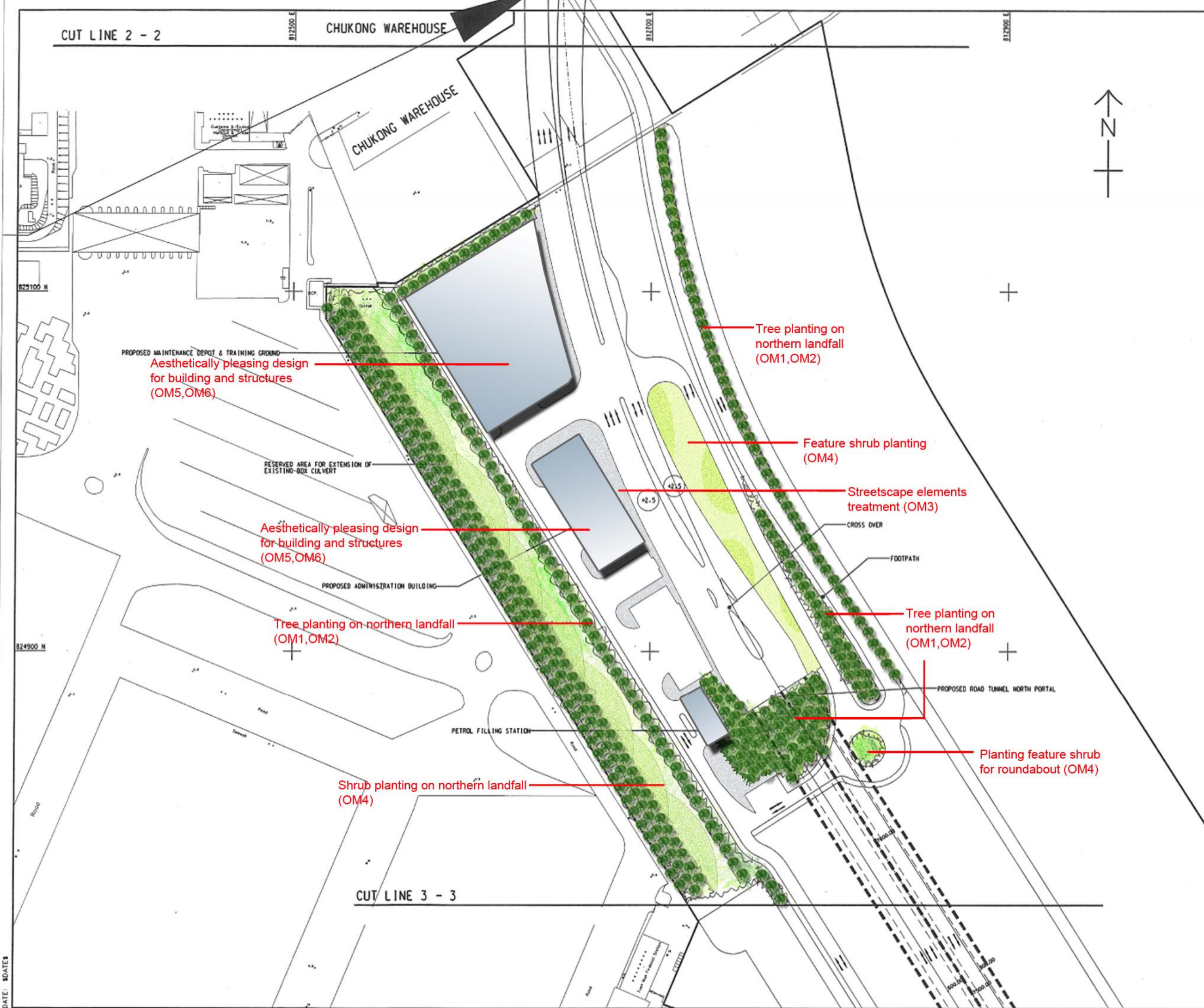

Aesthetically pleasing design for building and structures (OM5, OM6)

Tree planting on northern landfall (OM1, OM2)

Feature shrub planting (OM4)

Streetscape elements treatment (OM3)

Aesthetically pleasing design for building and structures (OM5, OM6)

Tree planting on northern landfall (OM1, OM2)

Tree planting on northern landfall (OM1, OM2)

Planting feature shrub for roundabout (OM4)

Shrub planting on northern landfall (OM4)

CUT LINE 3 - 3

NO.	DESCRIPTION	DATE	BY
1	ISSUED FOR TENDER		
HIGHWAYS DEPARTMENT HONG KONG - ZHUSHI - MACAO BRIDGE HONG KONG PROJECT MANAGEMENT OFFICE			
TUEN MUN - CHEK LAP KOK LINK - INVESTIGATION			
LANDSCAPE PLAN SHEET 3 OF 13			
MAUNSELL AECOM Maunsell Consultants Asia Ltd. 茂盛(亞洲)工程顧問有限公司			
DRGNO.	FIGURE 10.9.3		
DESIGNED BY	APPROVED BY	DATE	
---	---	02/2007 (HY)	
DRAWN BY	SCALE	DATE	
GXH	1:1000	PRELIMINARY	
© COPYRIGHT RESERVED 版權所有			

DATE: 30/01/07
SFILES