

11/6/2010 2:07:01  
 FILENAME: K:\9135 Kwun Tong Line Ext\drawing\Air Quality\_Contour\Rev\_20100604\6.13.dgn

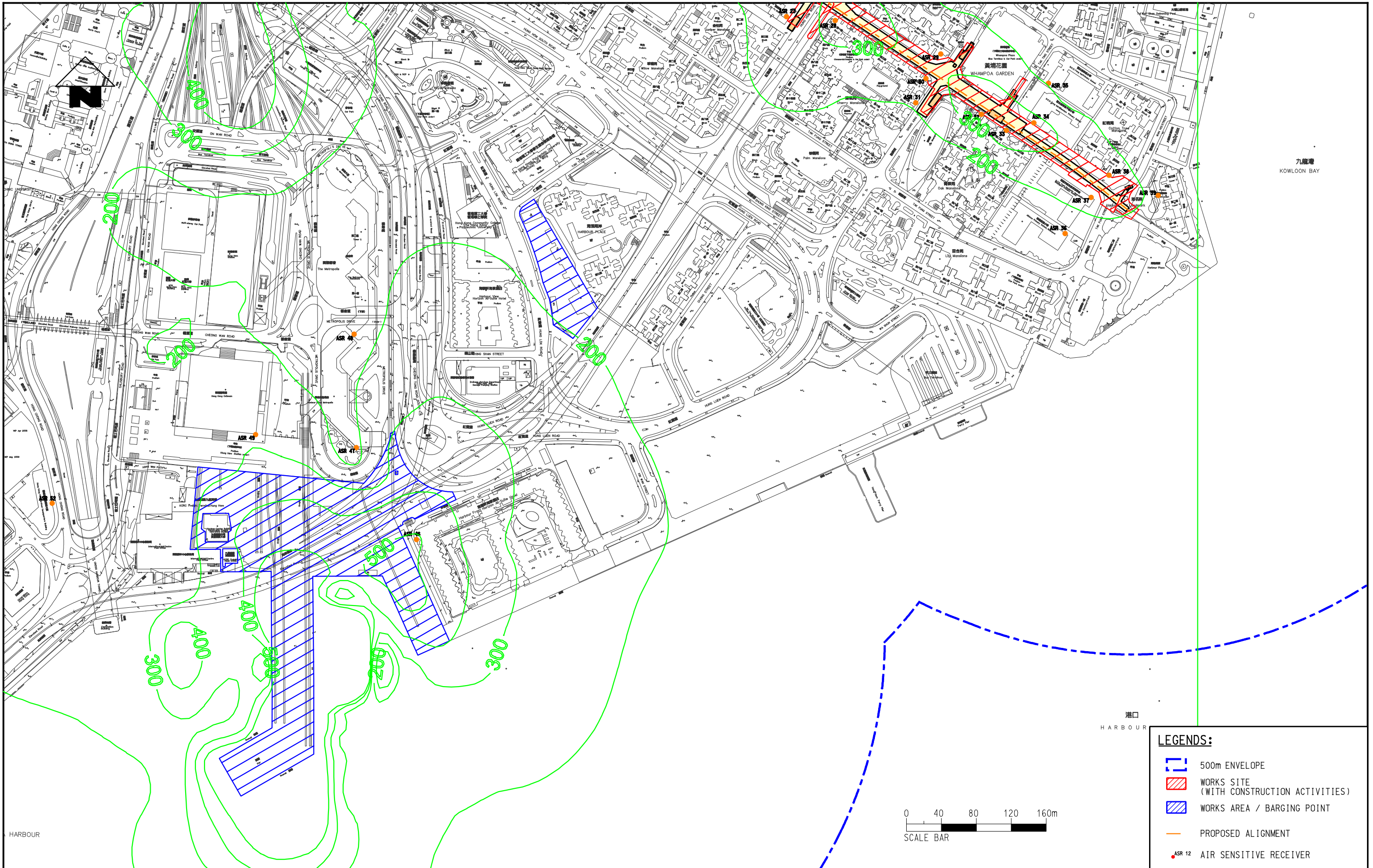

**LEGENDS:**

- 500m ENVELOPE
- WORKS SITE (WITH CONSTRUCTION ACTIVITIES)
- WORKS AREA / BARGING POINT
- PROPOSED ALIGNMENT
- ASR 12 AIR SENSITIVE RECEIVER

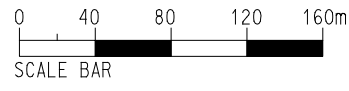

**HOURLY AVERAGED CUMULATIVE TSP CONCENTRATION IN  $\mu\text{g}\text{m}^{-3}$  OF TIER 1 AT 1.5M ABOVE GROUND LEVEL (AQO:  $500 \mu\text{g}\text{m}^{-3}$ ) SHEET 4 OF 4**



MTR Corporation Limited  
 Kwun Tong Line Extension  
 Contract No. NEX/2207  
 Environmental Impact Assessment

Figure:	6.13	Rev:	-
Scale:	1 : 4000 (A3)		