

11/6/2010 2:41:35 K:\9135 Kwon Tong Line Ext\drawing\Air Quality\_Contour\_Rev1\_20100604\6.19.dgn

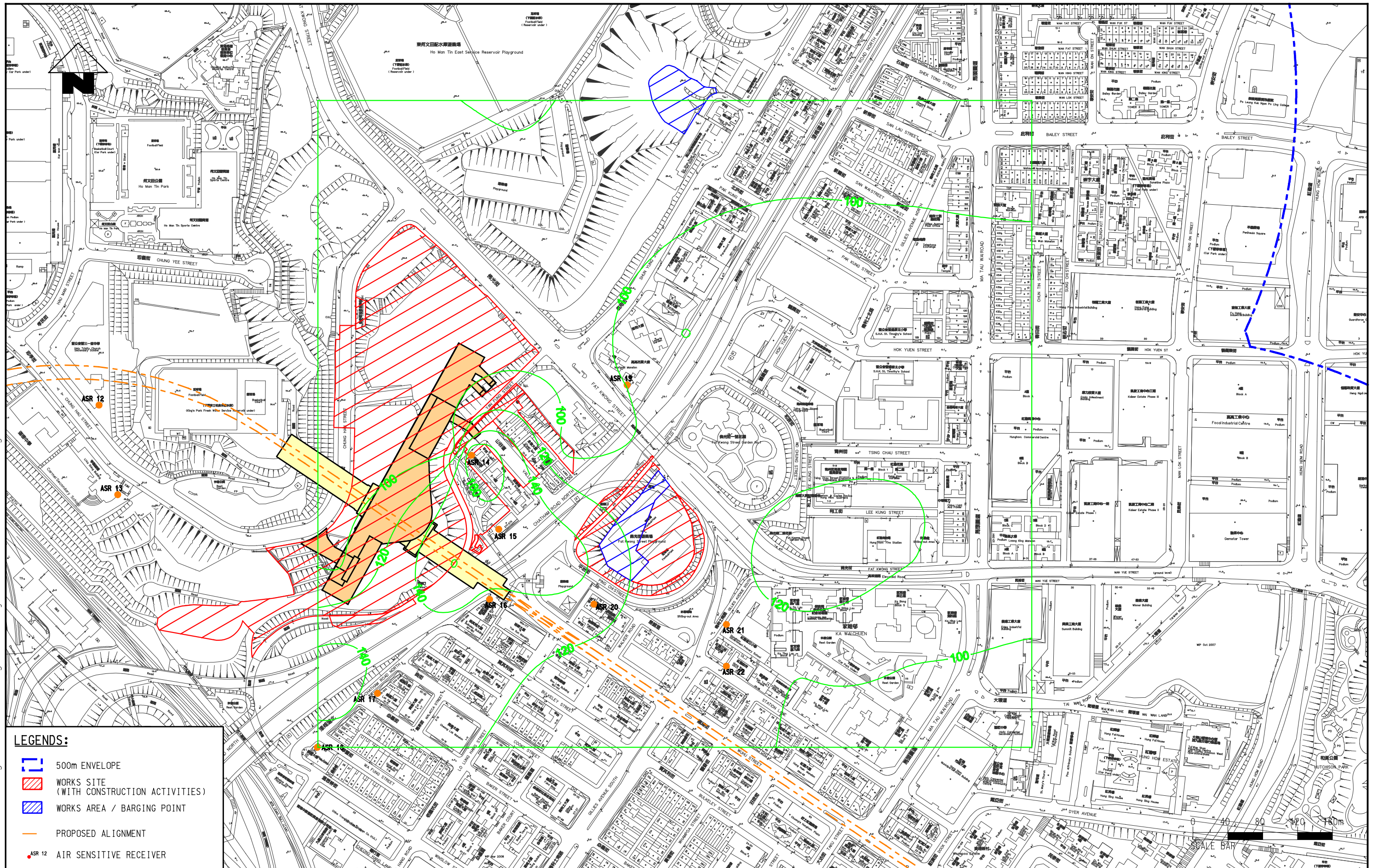

**LEGENDS:**

- 500m ENVELOPE
- WORKS SITE (WITH CONSTRUCTION ACTIVITIES)
- WORKS AREA / BARGING POINT
- PROPOSED ALIGNMENT
- ASR 12 AIR SENSITIVE RECEIVER

**MEINHARDT**  
 Meinhardt Infrastructure and Environment Limited  
 邁達基建環保工程顧問有限公司

**MTR**  
 MTR Corporation Limited  
 Kwon Tong Line Extension  
 Contract No. NEX/2207  
 Environmental Impact Assessment

**24 HOUR AVERAGED CUMULATIVE TSP CONCENTRATION IN  $\mu\text{g}/\text{m}^3$  OF TIER 1 AT 10M ABOVE GROUND LEVEL NEAR HOM STATION (AQO:  $260 \mu\text{g}/\text{m}^3$ )**

Figure:	6.19	Rev:	-
Scale:	1 : 3000 (A3)		