

4/28/2010 11:59:29 AM
K:\9135 Kwn Tong Line Ext\drawing\AB NOISE\NOISE MONITING LOCATION\5.2.dgn

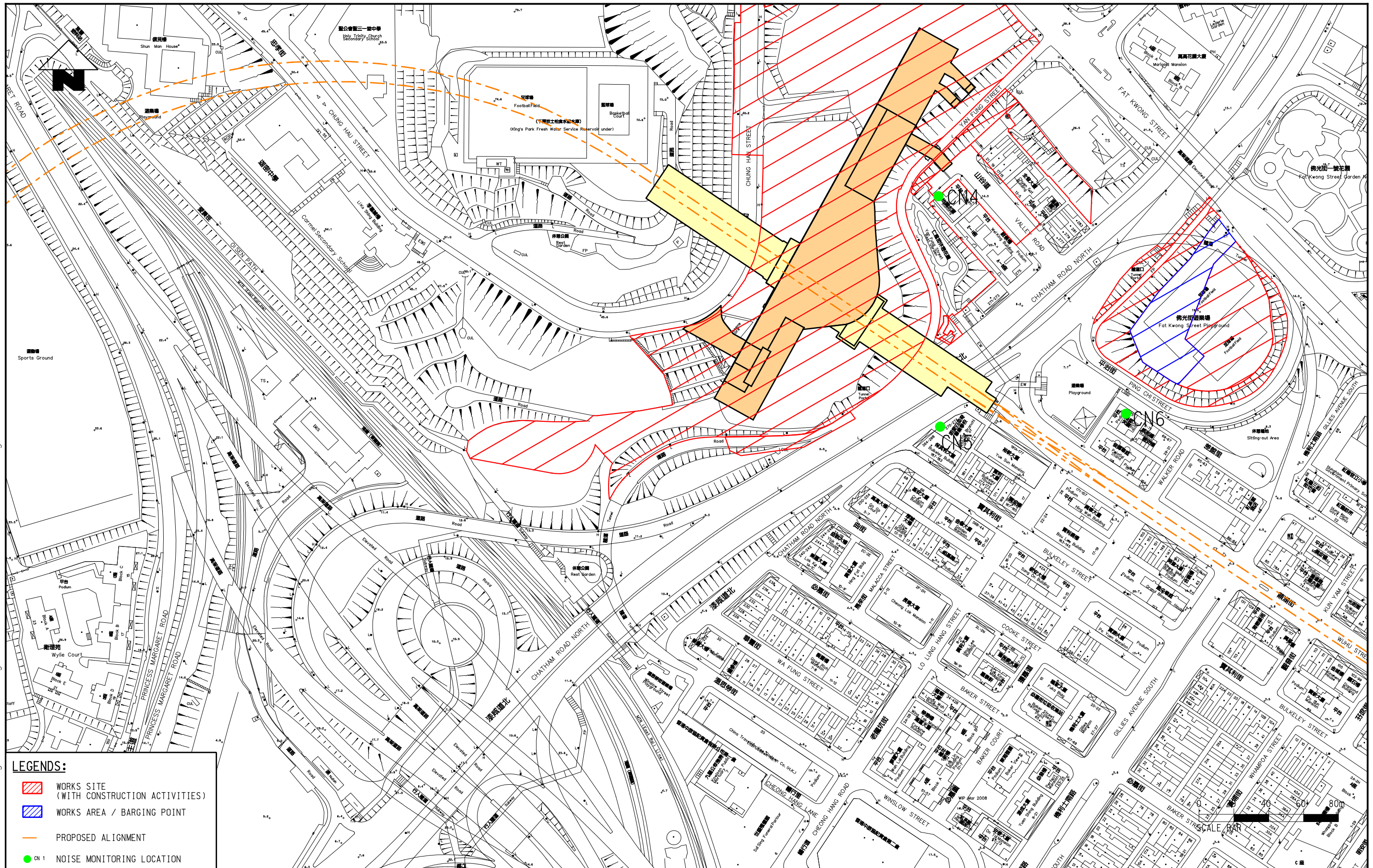

LEGENDS:

- WORKS SITE (WITH CONSTRUCTION ACTIVITIES)
- WORKS AREA / BARGING POINT
- PROPOSED ALIGNMENT
- CN 1 NOISE MONITORING LOCATION

Meinhardt Infrastructure and Environment Limited
邁達基建環保工程顧問有限公司

MTR Corporation Limited
Kwun Tong Line Extension
Contract No. NEX/2207
Environmental Impact Assessment

LOCATION OF AIR - BORNE NOISE MONITORING STATIONS
SHEET 2 OF 3

Figure: 5.2
Scale: 1:2000 (A3)

Rev: -