

**KEY PLAN**

**LEGEND:**

- PROPOSED SIL(E) ALIGNMENT
- PROPOSED WORKS SITE (GROUND LEVEL AND UNDERGROUND)
- PROPOSED WORKS SITE (UNDERGROUND)
- PROPOSED WORKS AREA (GROUND LEVEL)
- AIR SENSITIVE RECEIVER

P4	JUL 10	MM	ISSUE TO MTRC & EPD	FY	AFK
P3	MAY 10	MM	ISSUE TO MTRC & EPD	FY	AFK
P2	DEC 09	MM	ISSUE TO MTRC & EPD	FY	AFK
P1	NOV 09	AL	ISSUE TO MTRC & EPD	EH	AFK
Rev	Date	Drawn	Description	Ch'kd/App'd	

Client

20/F Two Landmark East  
100 How Ming Street  
Kwan Tong, Kowloon  
Hong Kong  
T +852 2828 5757  
F +852 2827 1823  
www.mottmac.com.hk

Project

**CONSULTANCY AGREEMENT NO. NEX/2301**  
**SOUTH ISLAND LINE (EAST)**  
**ENVIRONMENTAL IMPACT ASSESSMENT**

Title

**CUMULATIVE RESULT-  
CONTOURS OF ANNUAL TSP  
CONCENTRATION ( $\mu\text{g}/\text{m}^3$ ) AT 1.5m ABOVE GROUND  
DURING CONSTRUCTION PHASE (INCLUDE  
BACKGROUND CONCENTRATION =  $77.4\mu\text{g}/\text{m}^3$ ,  
AQO =  $80\mu\text{g}/\text{m}^3$ ) - ADMIRALTY**

Designed	EH	Eng.Chk.	FY
Drawn	MING	Coordination	FY
Dwg.Chk.	EH	Approved	AFK

Scale	Project	Status
1:3500@A3	248137	PRE
	CAD File	0-46.dgn
	\\1248137\rsport\env\velo\1002231\ch01\F16	Rev

Drawing No. **FIGURE 10.46** P4

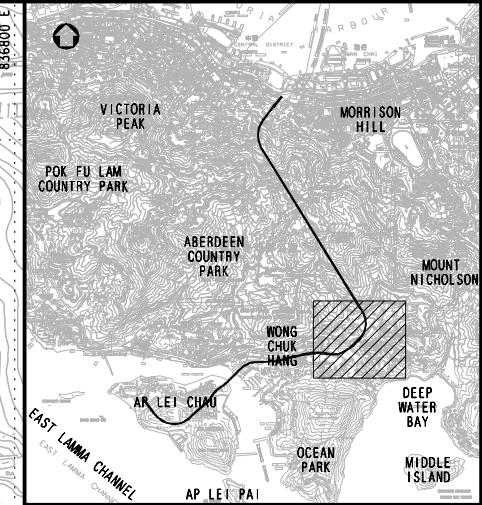
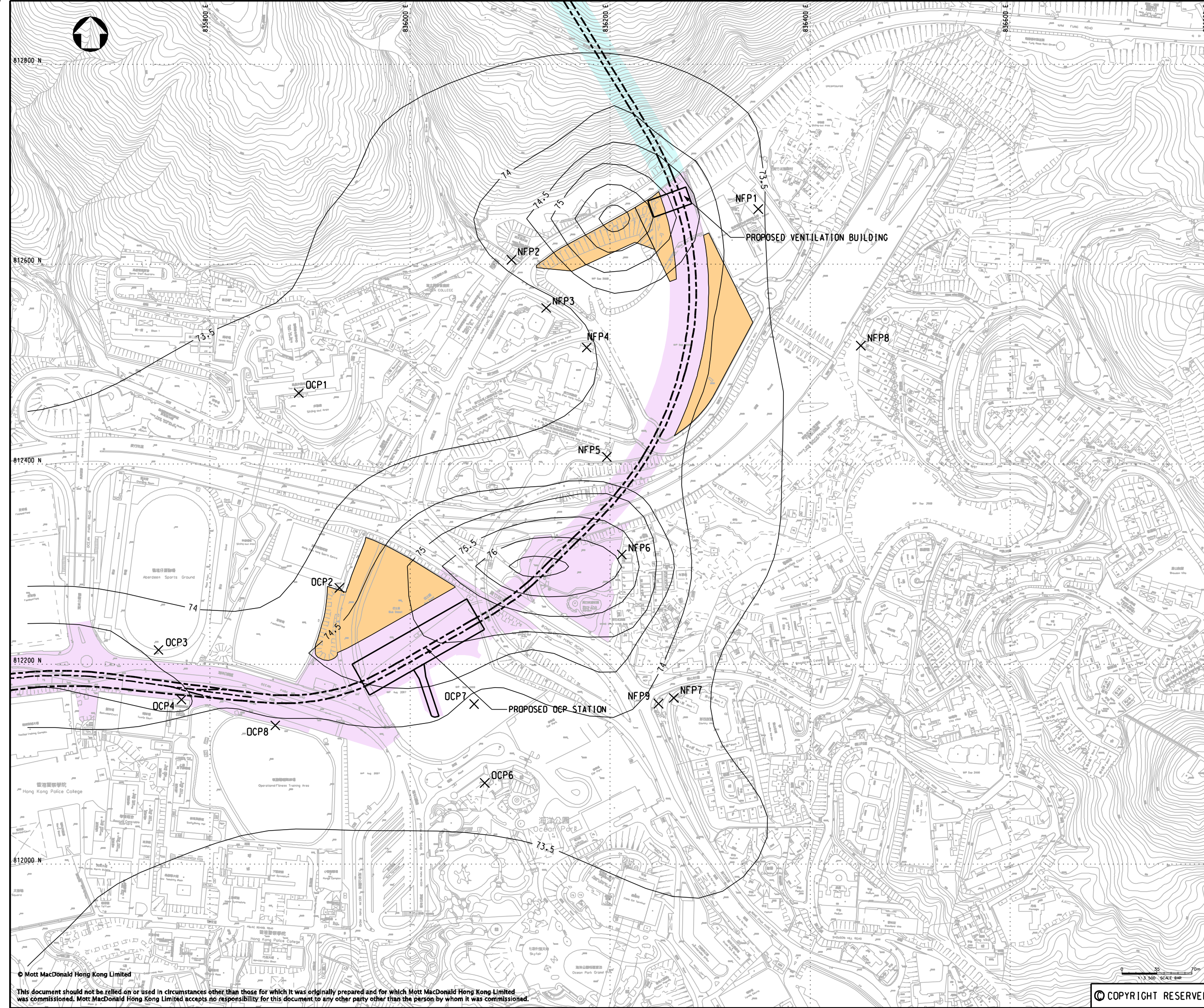

**KEY PLAN**

**LEGEND:**

- PROPOSED SIL(E) ALIGNMENT
- PROPOSED WORKS SITE (GROUND LEVEL AND UNDERGROUND)
- PROPOSED WORKS SITE (UNDERGROUND)
- PROPOSED WORKS AREA (GROUND LEVEL)
- X AIR SENSITIVE RECEIVER

P4	JUL 10	MM	ISSUE TO MTRC & EPD	FY	AFK
P3	MAY 10	MM	ISSUE TO MTRC & EPD	FY	AFK
P2	DEC 09	MM	ISSUE TO MTRC & EPD	FY	AFK
P1	NOV 09	AL	ISSUE TO MTRC & EPD	EH	AFK
Rev	Date	Drawn	Description	Ch'kd/App'd	

Client

20/F Two Landmark East  
100 How Ming Street  
Kwan Tong, Kowloon  
Hong Kong  
T +852 2828 5757  
F +852 2827 1823  
W www.mottmac.com.hk

Project

**CONSULTANCY AGREEMENT NO. NEX/2301**  
**SOUTH ISLAND LINE (EAST)**  
**ENVIRONMENTAL IMPACT ASSESSMENT**

Title

**CUMULATIVE RESULT-  
CONTOURS OF ANNUAL TSP CONCENTRATION  
( $\mu\text{g}/\text{m}^3$ ) AT 1.5m ABOVE GROUND DURING  
CONSTRUCTION PHASE (INCLUDE BACKGROUND  
CONCENTRATION =  $73.2\mu\text{g}/\text{m}^3$ , AOD =  $80\mu\text{g}/\text{m}^3$ )  
- NAM FUNG PORTAL AND OCEAN PARK**

Designed	EH	Eng.Chk.	FY
Drawn	MING	Coordination	FY
Dwg.Chk.	EH	Approved	AFK
Scale	1:3500@A3	Project	248137
Project	CAD File		Status
Drawing No.		FIGURE 10.47	PRE
Copyright		RESERVED	Rev
			P4

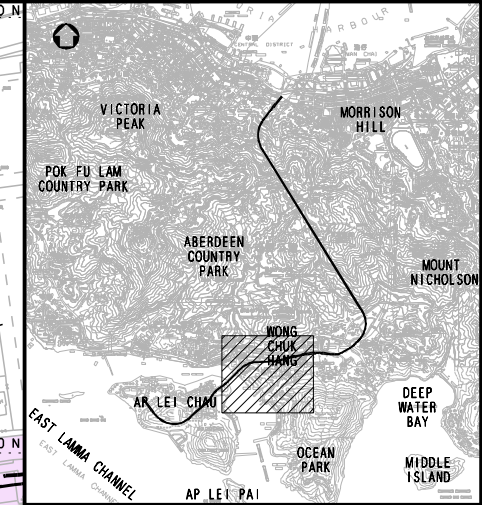
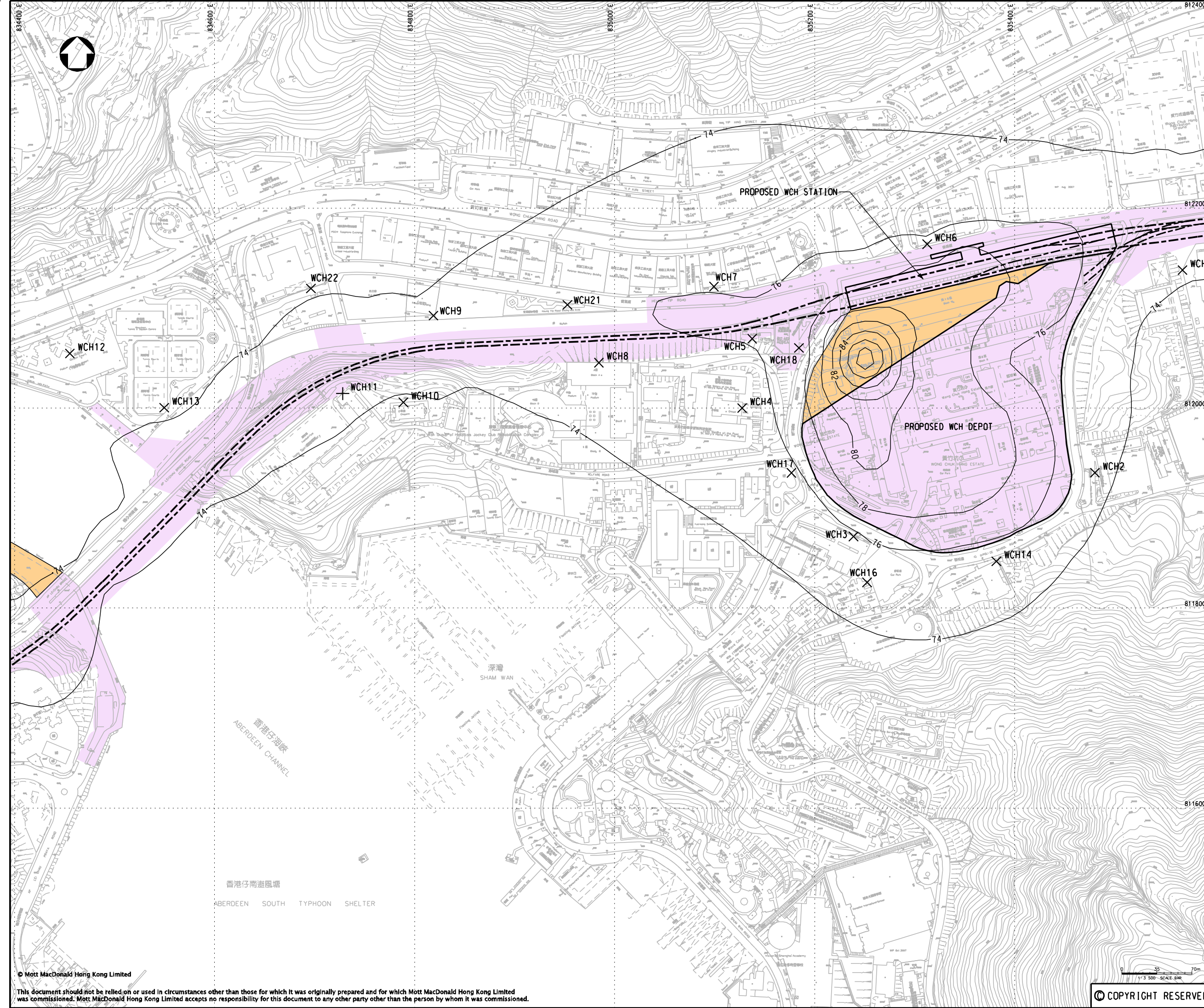

**KEY PLAN**

**LEGEND:**

- PROPOSED SIL(E) ALIGNMENT
- PROPOSED WORKS SITE (GROUND LEVEL AND UNDERGROUND)
- PROPOSED WORKS AREA (GROUND LEVEL)
- AIR SENSITIVE RECEIVER

P4	JUL 10	MM	ISSUE TO MTRC & EPD	FY	AFK
P3	MAY 10	MM	ISSUE TO MTRC & EPD	FY	AFK
P2	DEC 09	AL	ISSUE TO MTRC & EPD	FY	AFK
P1	NOV 09	AL	ISSUE TO MTRC & EPD	EH	AFK
Rev	Date	Drawn	Description		Ch'kd/App'd

Client

20/F Two Landmark East  
100 How Ming Street  
Kowloon, Hong Kong  
T +852 2828 5757  
F +852 2827 1823  
W www.mottmac.com.hk

Project

**CONSULTANCY AGREEMENT NO. NEX/2301**  
**SOUTH ISLAND LINE (EAST)**  
**ENVIRONMENTAL IMPACT ASSESSMENT**

Title

**CUMULATIVE RESULT-  
CONTOURS OF ANNUAL TSP  
CONCENTRATION ( $\mu\text{g}/\text{m}^3$ ) AT 1.5m ABOVE GROUND  
DURING CONSTRUCTION PHASE (INCLUDE  
BACKGROUND CONCENTRATION =  $73.2\mu\text{g}/\text{m}^3$ ,  
AQD =  $80\mu\text{g}/\text{m}^3$ ) - WONG CHUK HANG**

Designed	EH	Eng.Chk.	FY
Drawn	MING	Coordination	FY
Dwg.Chk.	EH	Approved	AFK

Scale	Project	Status
1:3500@A3	248137	PRE
Drawing No.	CAD File	Rev
	\\248137\rsport1\env\velo\1002231\ch10\F16	0-48.dgn

© COPYRIGHT RESERVED

FIGURE 10.48

P4

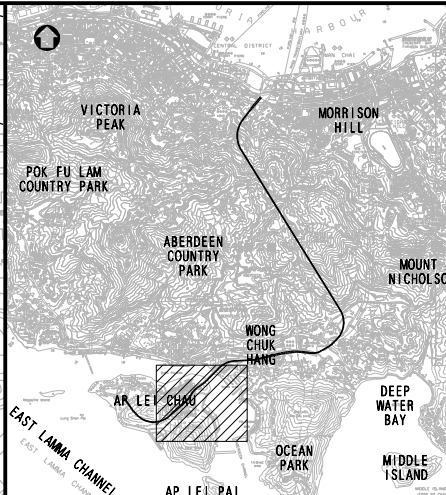
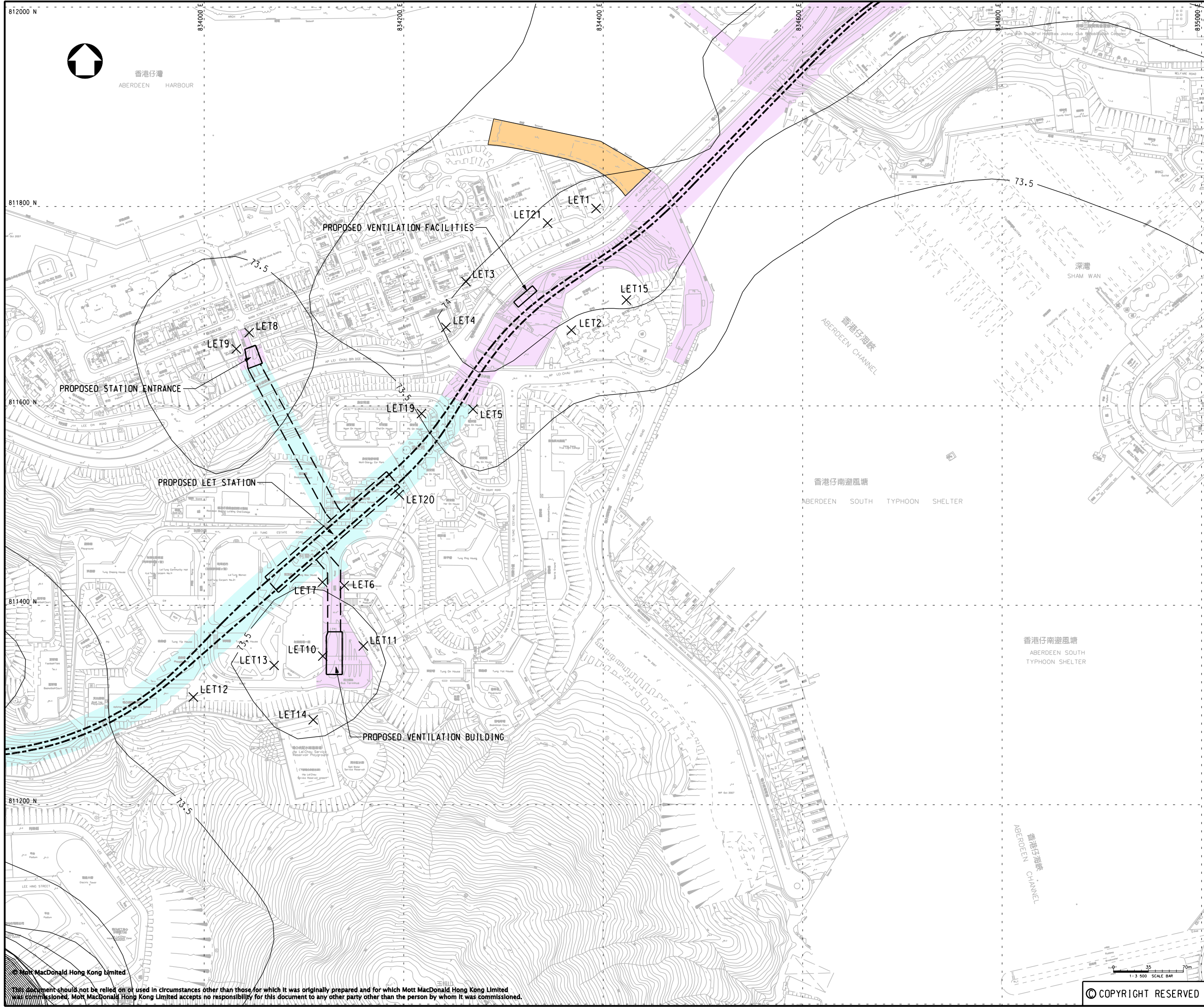

**KEY PLAN**

**LEGEND:**

- PROPOSED SIL(E) ALIGNMENT
- PROPOSED WORKS SITE (GROUND LEVEL AND UNDERGROUND)
- PROPOSED WORKS SITE (UNDERGROUND)
- PROPOSED WORKS AREA (GROUND LEVEL)
- AIR SENSITIVE RECEIVER

P4	MAY 10	MM	GENERAL REVISION	FY	AFK
P3	MAY 10	MM	GENERAL REVISION	FY	AFK
P2	DEC 09	MM	ISSUE TO MTRC & EPD	FY	AFK
P1	NOV 09	AL	ISSUE TO MTRC & EPD	EH	AFK
Rev	Date	Drawn	Description	Ch'kd	App'd



Project

**CONSULTANCY AGREEMENT NO. NEX/2301**  
**SOUTH ISLAND LINE (EAST)**  
**ENVIRONMENTAL IMPACT ASSESSMENT**

Title

**CUMULATIVE RESULT -**  
**CONTOURS OF ANNUAL TSP**  
**CONCENTRATION ( $\mu\text{g}/\text{m}^3$ ) AT 1.5m ABOVE GROUND**  
**DURING CONSTRUCTION PHASE (INCLUDE**  
**BACKGROUND CONCENTRATION =  $73.2 \mu\text{g}/\text{m}^3$ ,**  
**AOD =  $80 \mu\text{g}/\text{m}^3$ ) - LEI TUNG**

Designed	EH	Eng.Chk.	FY
Drawn	MING	Coordination	FY
Dwg.Chk.	EH	Approved	AFK
Scale	1:3500@A3	Project	248137
		CAD File	IFLET
Drawing No.	FIGURE 10.49	Status	PRE
		Rev	P4

© Mott MacDonald Hong Kong Limited

This document should not be relied on or used in circumstances other than those for which it was originally prepared and for which Mott MacDonald Hong Kong Limited was commissioned. Mott MacDonald Hong Kong Limited accepts no responsibility for this document to any other party other than the person by whom it was commissioned.

© COPYRIGHT RESERVED

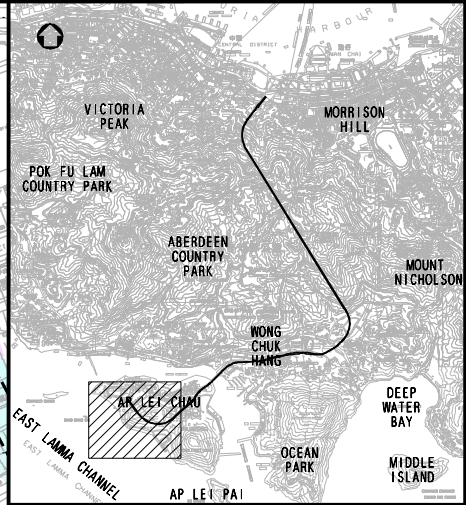

**KEY PLAN**

**LEGEND:**

- PROPOSED SIL(E) ALIGNMENT
- PROPOSED TEMPORARY OVERHEAD CONVEYANCE SYSTEM
- PROPOSED WORKS SITE (GROUND LEVEL AND UNDERGROUND)
- PROPOSED WORKS SITE (UNDERGROUND)
- PROPOSED WORKS AREA (GROUND LEVEL)
- AIR SENSITIVE RECEIVER

P5	JUL 10	MM	ISSUE TO MTRC & EPD	FY	AFK
P4	JUN 10	MM	ISSUE TO MTRC & EPD	FY	AFK
P3	MAY 10	MM	ISSUE TO MTRC & EPD	FY	AFK
P2	DEC 09	MM	ISSUE TO MTRC & EPD	FY	AFK
P1	NOV 09	MM	ISSUE TO MTRC & EPD	EH	AFK
Rev	Date	Drawn	Description	Ch'kd	App'd

Client

20/F Two Landmark East  
100 How Ming Street  
Kwan Tong, Kowloon  
Hong Kong  
T +852 2828 6767  
F +852 2827 1823  
www.mottmac.com.hk

Project  
**CONSULTANCY AGREEMENT NO. NEX/2301  
SOUTH ISLAND LINE (EAST)  
ENVIRONMENTAL IMPACT ASSESSMENT**

Title  
**CUMULATIVE RESULT-  
CONTOURS OF TIER 1 ANNUAL TSP  
CONCENTRATION ( $\mu\text{g}/\text{m}^3$ ) AT 1.5m ABOVE G/F  
DURING CONSTRUCTION PHASE (INCLUDE  
BACKGROUND CONCENTRATION= $73.2\mu\text{g}/\text{m}^3$  AOD= $80\mu\text{g}/\text{m}^3$ )  
- SOUTH HORIZONS AND LEE NAM BARGING POINT**

Designed	EH	Eng.Chk.	FY
Drawn	MING	Coordination	FY
Dwg.Chk.	EH	Approved	AFK
Scale	Project	Status	
1:3500@A3	248137	PRE	
Drawing No.	CAD File	Rev	
	\\248137\rsport\env\velo\002231\ch10\F16	0-50.dgn	

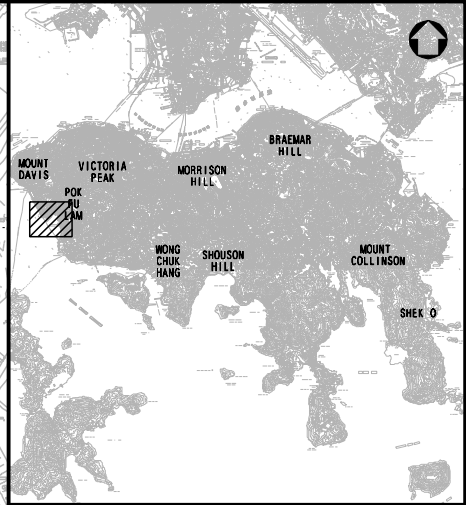

### KEY PLAN

**LEGEND:**

- PROPOSED WORKS AREA (GROUND LEVEL)
- ✕ AIR SENSITIVE RECEIVER

Rev	Date	Drawn	Description	Ch'kd	App'd
P4	JUL 10	MM	ISSUE TO MTRC & EPD	FY	AFK
P3	MAY 10	MM	ISSUE TO MTRC & EPD	FY	AFK
P2	DEC 09	MM	ISSUE TO MTRC & EPD	FY	AFK
P1	NOV 09	MING	ISSUE TO MTRC & EPD	EH	AFK

Client



20/F Two Landmark East  
100 How Ming Street  
Kwan Tong, Kowloon  
Hong Kong  
T +852 2828 5757  
F +852 2827 1823  
W www.mottmac.com.hk

Project  
**CONSULTANCY AGREEMENT NO. NEX/2301  
SOUTH ISLAND LINE (EAST)  
ENVIRONMENTAL IMPACT ASSESSMENT**

Title  
**CUMULATIVE RESULT-  
CONTOURS OF ANNUAL TSP  
CONCENTRATION ( $\mu\text{g}/\text{m}^3$ ) AT 1.5m ABOVE GROUND  
DURING CONSTRUCTION PHASE (INCLUDE  
BACKGROUND CONCENTRATION =  $73.2\mu\text{g}/\text{m}^3$ ,  
AQD =  $80\mu\text{g}/\text{m}^3$ ) - TELEGRAPH BAY**

Designed	EH	Eng.Chk.	FY
Drawn	MING	Coordination	FY
Dwg.Chk.	EH	Approved	AFK

Scale	Project	Status
1:4000@A3	248137	PRE
	CAD File	Rev
	\\1248137\rsport1\env\elo_002231\ch01616_0-51.dgn	P4

Drawing No. **FIGURE 10.51**

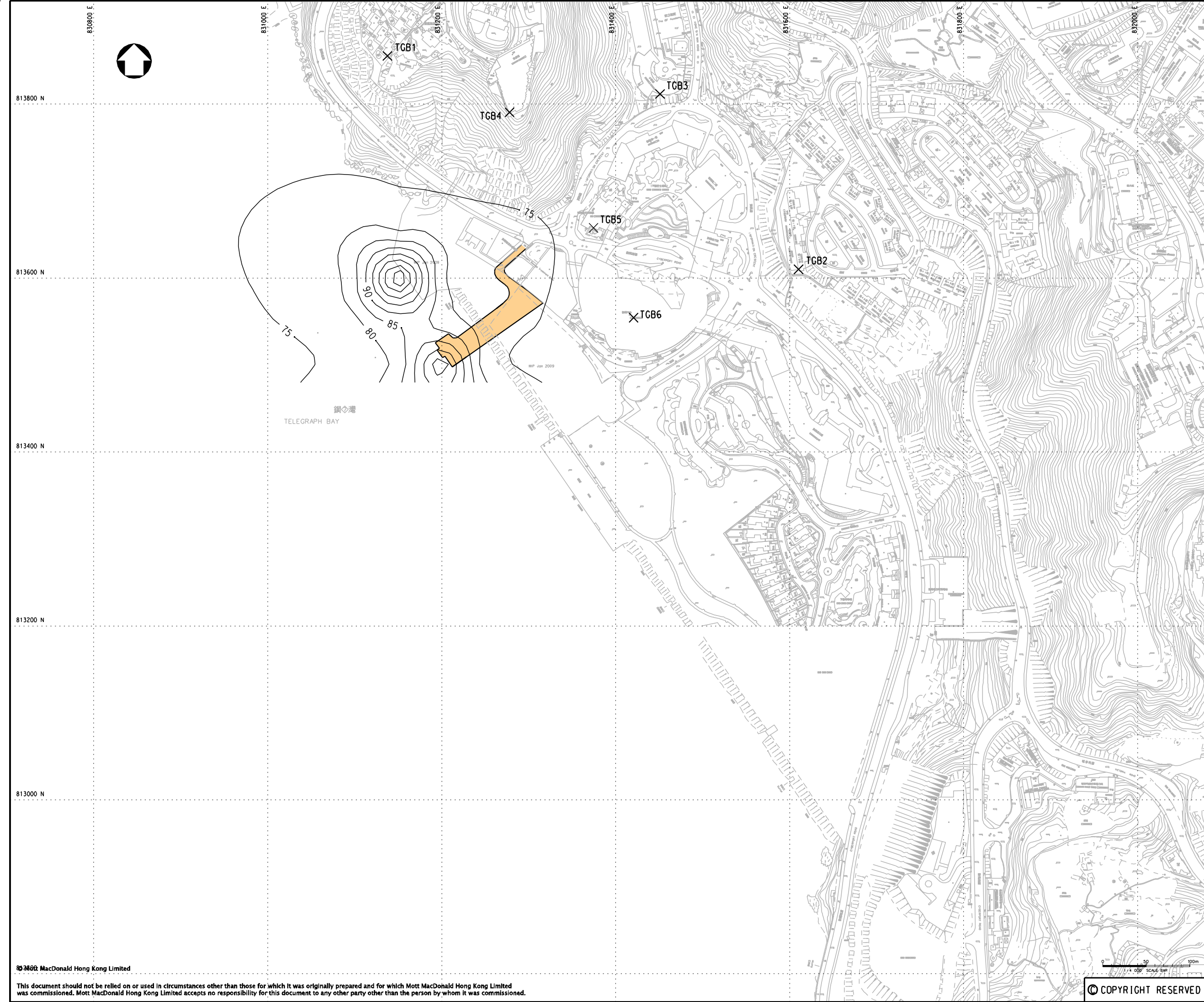

**© COPYRIGHT RESERVED**

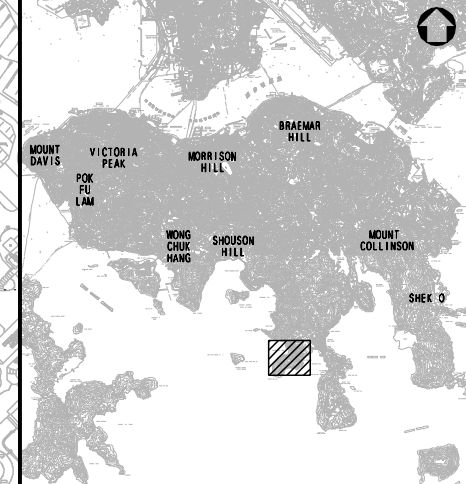
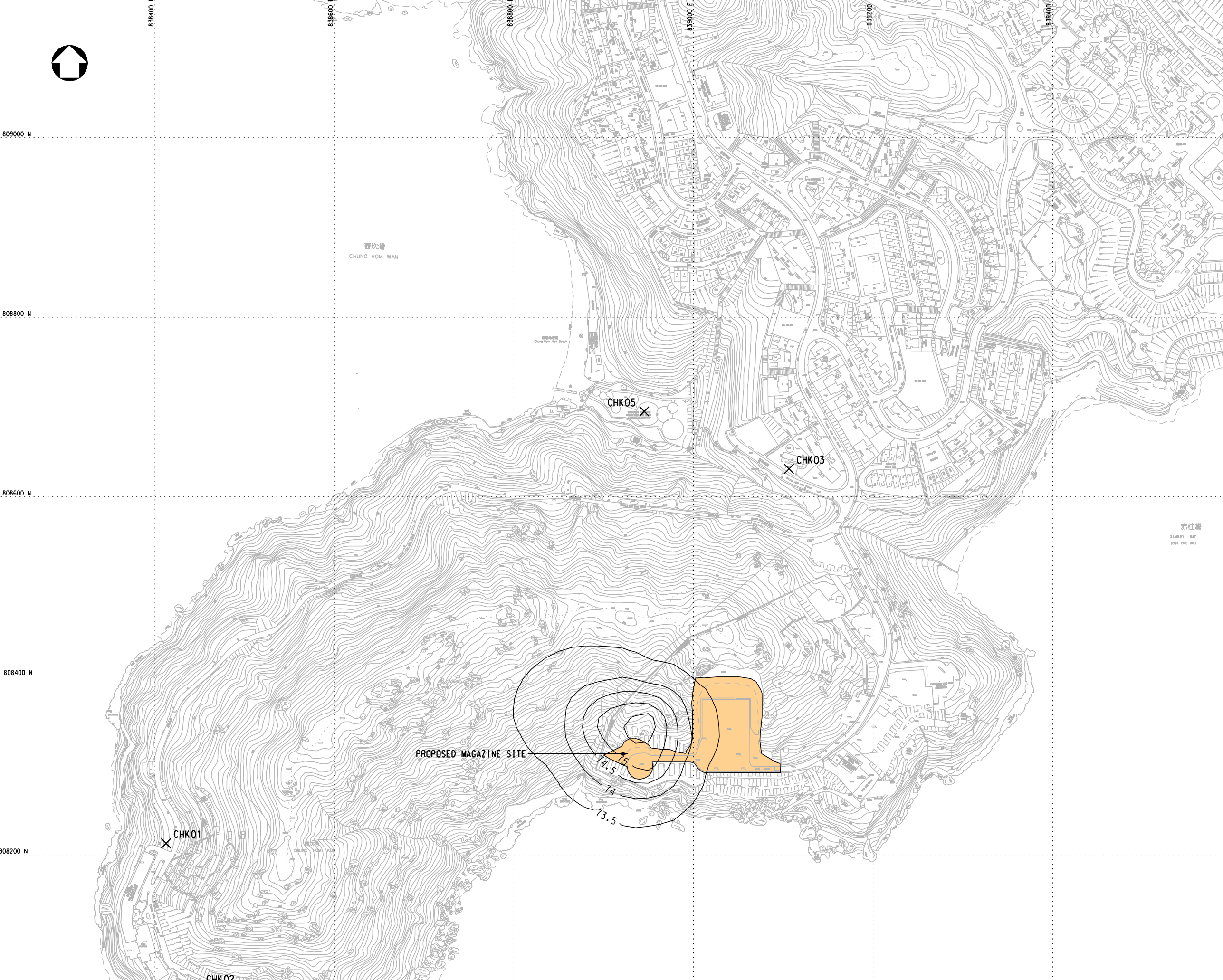

### KEY PLAN

- LEGEND:
- PROPOSED WORKS AREA (GROUND LEVEL)
  - X AIR SENSITIVE RECEIVER

P4	JUL 10	MM	ISSUE TO MTRC & EPD	FY	AFK
P3	MAY 10	MM	ISSUE TO MTRC & EPD	FY	AFK
P2	DEC 09	MM	ISSUE TO MTRC & EPD	FY	AFK
P1	NOV 09	MING	ISSUE TO MTRC & EPD	EH	AFK
Rev	Date	Drawn	Description	Ch'kd	App'd

Client



**Mott MacDonald**

20/F Two Landmark East  
100 How Ming Street  
Kowloon, Kowloon  
Hong Kong  
T +852 2828 6757  
F +852 2827 1823  
W www.mottmac.com.hk

Project

**CONSULTANCY AGREEMENT NO. NEX/2301  
SOUTH ISLAND LINE (EAST)  
ENVIRONMENTAL IMPACT ASSESSMENT**

Title

**CUMULATIVE RESULT-  
CONTOURS OF ANNUAL TSP  
CONCENTRATION ( $\mu\text{g}/\text{m}^3$ ) AT 1.5m ABOVE GROUND  
DURING CONSTRUCTION PHASE (INCLUDE  
BACKGROUND CONCENTRATION =  $73.2\mu\text{g}/\text{m}^3$ ,  
ADD =  $80\mu\text{g}/\text{m}^3$ ) - CHUNG HOM SHAN**

Designed	EH	Eng.Chk.	FY
Drawn	MING	Coordination	FY
Dwg.Chk.	EH	Approved	AFK

Scale	Project	Status
1:4000@A3	248137	PRE
CAD File	J:\248137\REPORT\ENV\EA_000223\CH0\FIG 10-52.dgn	

Drawing No.	Figure	Rev
FIGURE 10.52	P4	