

KEY PLAN

LEGEND:

- ASSESSMENT AREA OF CONSTRUCTION PHASE
- ASSESSMENT AREA OF OPERATIONAL PHASE
- W8b** WORKS AREA
- PROPOSED WORKS SITE (GROUND LEVEL AND UNDERGROUND)
- PROPOSED WORKS SITE (UNDERGROUND)
- PROPOSED WORKS AREA (GROUND LEVEL)
- THE FIRST LAYER OF AFFECTED NOISE SENSITIVE USES

P5	MAY 10	MING	ISSUE TO MTRC & EPD	HC	AFK
P4	DEC 09	MING	ISSUE TO MTRC & EPD	CWK	AFK
P3	NOV 09	MING	ISSUE TO MTRC & EPD	CWK	AFK
P2	SEP 09	MING	ISSUE TO MTRC	CWK	AFK
P1	APR 09	MING	ISSUE TO MTRC	CWK	AFK
Rev	Date	Drawn	Description		Ch'kd/App'd



Project
**CONSULTANCY AGREEMENT NO. NEX/2301
SOUTH ISLAND LINE (EAST)
ENVIRONMENTAL IMPACT ASSESSMENT**

Title
**THE FIRST LAYER OF AFFECTED
NOISE SENSITIVE USES
(SHEET 1 OF 9)**

Designed	CWK	Eng.Chk.	FY
Drawn	MING	Coordination	FY
Dwg.Chk.	CWK	Approved	AFK
Scale	Project	Status	
1:1500@A1	248137	PRE	
	CAD File	Rev	
	\\1248137\report\env\velo\100223\Figure 3-2.dgn		
Drawing No.			
	FIGURE 3.2		P5

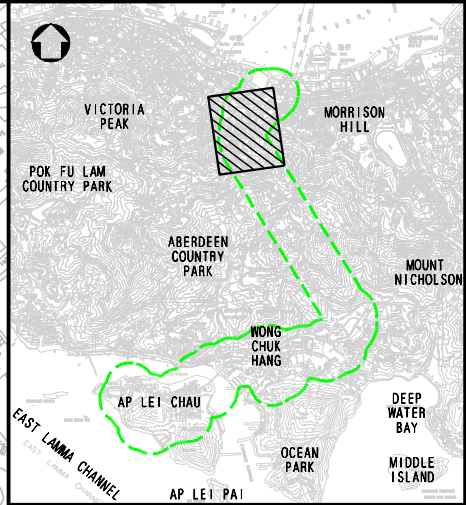
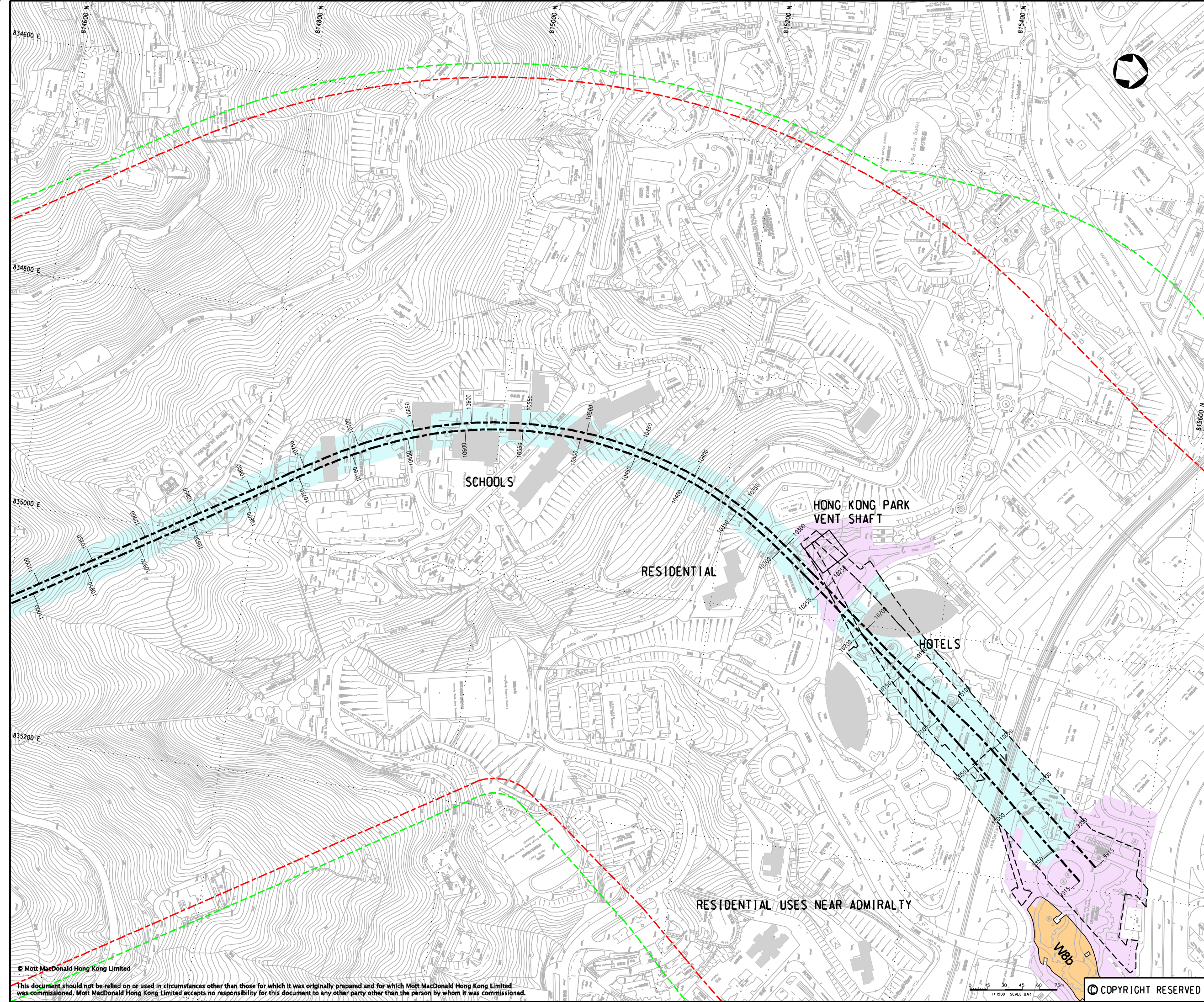

KEY PLAN

LEGEND:

- ASSESSMENT AREA OF CONSTRUCTION PHASE
- ASSESSMENT AREA OF OPERATIONAL PHASE
- W8b** WORKS AREA
- PROPOSED WORKS SITE (GROUND LEVEL AND UNDERGROUND)
- PROPOSED WORKS SITE (UNDERGROUND)
- THE FIRST LAYER OF AFFECTED NOISE SENSITIVE USES

P5	MAY 10	MING	ISSUE TO MTRC & EPD	HC	AFK
P4	DEC 09	MING	ISSUE TO MTRC & EPD	CWK	AFK
P3	NOV 09	MING	ISSUE TO MTRC & EPD	CWK	AFK
P2	SEP 09	MING	ISSUE TO MTRC	CWK	AFK
P1	APR 09	MING	ISSUE TO MTRC	CWK	AFK
Rev	Date	Drawn	Description	Ch'kd	App'd



Project
**CONSULTANCY AGREEMENT NO. NEX/2301
SOUTH ISLAND LINE (EAST)
ENVIRONMENTAL IMPACT ASSESSMENT**

Title
**THE FIRST LAYER OF AFFECTED
NOISE SENSITIVE USES
(SHEET 2 OF 9)**

Designed	CWK	Eng.Chk.	FY
Drawn	MING	Coordination	FY
Dwg.Chk.	CWK	Approved	AFK
Scale	Project	Status	
1:1500@A1	248137	PRE	
Drawing No.	CAD File	Rev	
	\\248137\report\env\elo_100223\FIGURE 3-5.dgn		

© Mott MacDonald Hong Kong Limited
This document should not be relied on or used in circumstances other than those for which it was originally prepared and for which Mott MacDonald Hong Kong Limited was commissioned. Mott MacDonald Hong Kong Limited accepts no responsibility for this document to any other party other than the person by whom it was commissioned.

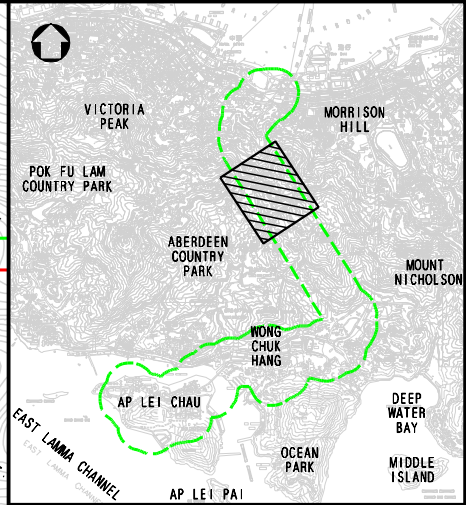
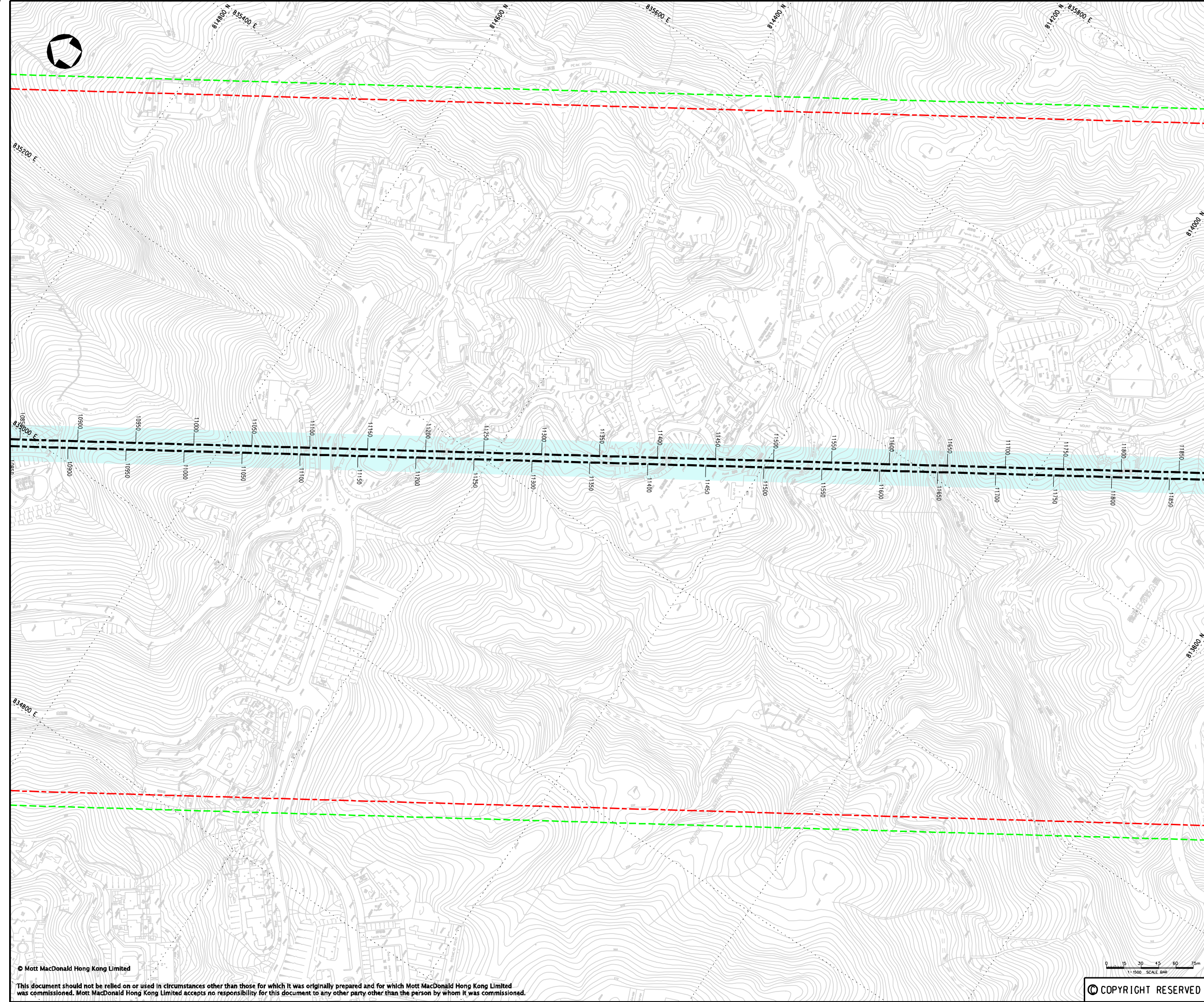

KEY PLAN

LEGEND:

- ASSESSMENT AREA OF CONSTRUCTION PHASE
- ASSESSMENT AREA OF OPERATIONAL PHASE
- PROPOSED WORKS SITE (UNDERGROUND)

Rev	Date	Drawn	Description	Ch'kd	App'd
P5	MAY 10	MING	ISSUE TO MTRC & EPD	HC	AFK
P4	DEC 09	MING	ISSUE TO MTRC & EPD	CWK	AFK
P3	NOV 09	MING	ISSUE TO MTRC & EPD	CWK	AFK
P2	SEP 09	MING	ISSUE TO MTRC	CWK	AFK
P1	APR 09	MING	ISSUE TO MTRC	CWK	AFK

Client

20/F Two Landmark East
100 How Ming Street
Kowloon, Hong Kong
T +852 2828 5757
F +852 2827 1823
www.mottmac.com.hk

Project

CONSULTANCY AGREEMENT NO. NEX/2301
SOUTH ISLAND LINE (EAST)
ENVIRONMENTAL IMPACT ASSESSMENT

Title

THE FIRST LAYER OF AFFECTED
NOISE SENSITIVE USES
(SHEET 3 OF 9)

Designed	CWK	Eng.Chk.	FY	Status	PRE
Drawn	MING	Coordination	FY	Rev	
Dwg.Chk.	CWK	Approved	AFK		
Scale	1:1500@A1	Project	248137		
		CAD File	K:\248137\report\env\elo\100223\Figure 3-4.dgn		
Drawing No.					P5

© COPYRIGHT RESERVED

FIGURE 3.4

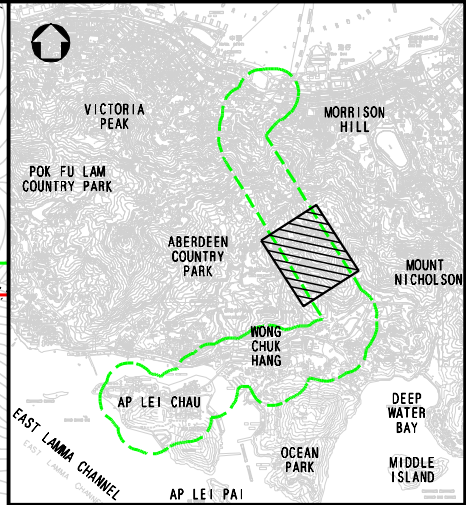
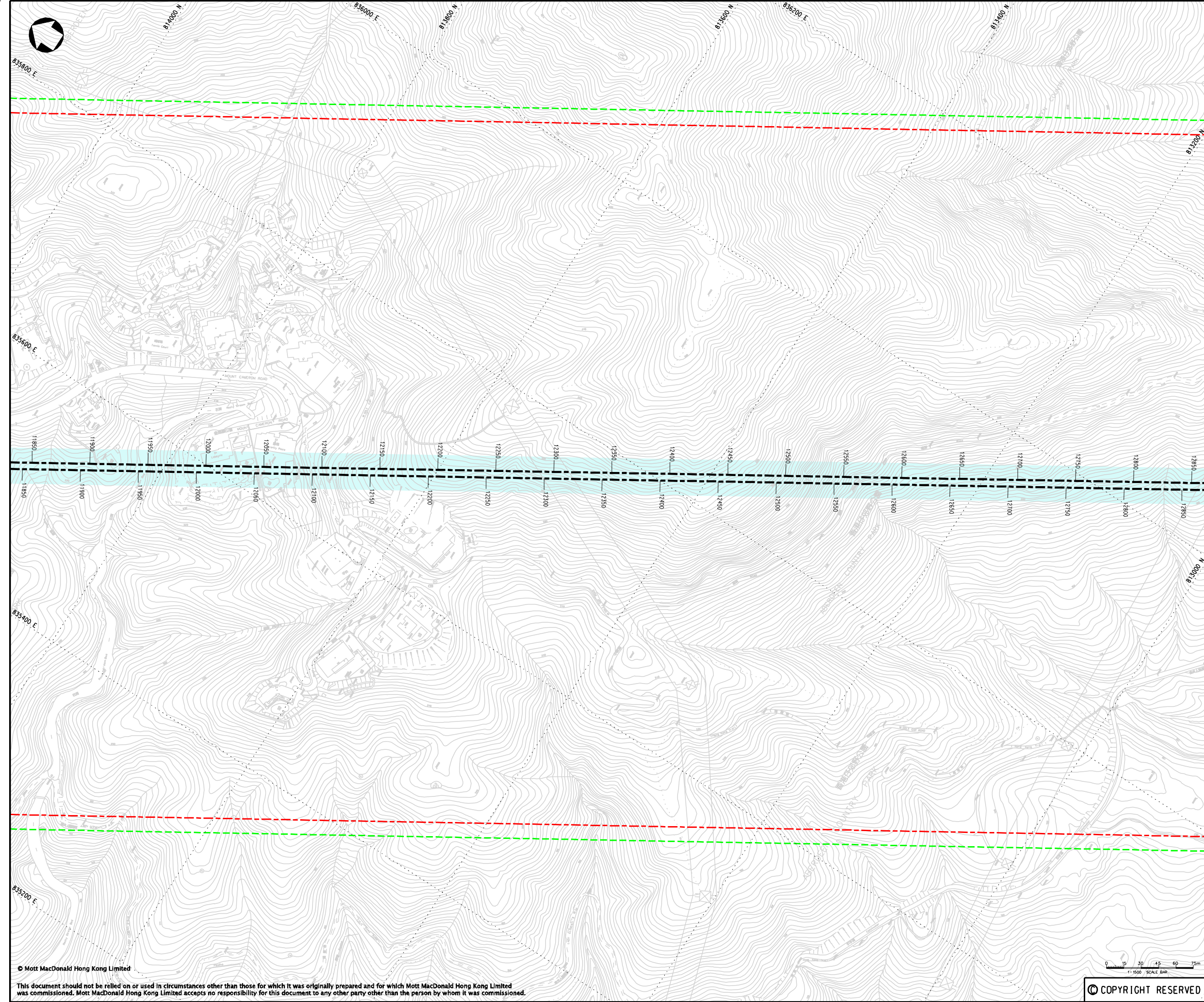

KEY PLAN

LEGEND:

- ASSESSMENT AREA OF CONSTRUCTION PHASE
- ASSESSMENT AREA OF OPERATIONAL PHASE
- PROPOSED WORKS SITE (UNDERGROUND)

Rev	Date	Drawn	Description	Ch'kd	App'd
P5	MAY 10	MING	ISSUE TO MTRC & EPD	HC	AFK
P4	DEC 09	MING	ISSUE TO MTRC & EPD	CWK	AFK
P3	NOV 09	MING	ISSUE TO MTRC & EPD	CWK	AFK
P2	SEP 09	MING	ISSUE TO MTRC	CWK	AFK
P1	APR 09	MING	ISSUE TO MTRC	CWK	AFK

Client

20/F Two Landmark East
100 How Ming Street
Kwan Tong, Kowloon
Hong Kong
T +852 2828 6767
F +852 2827 1823
W www.mottmac.com.hk

Project

**CONSULTANCY AGREEMENT NO. NEX/2301
SOUTH ISLAND LINE (EAST)
ENVIRONMENTAL IMPACT ASSESSMENT**

Title

**THE FIRST LAYER OF AFFECTED
NOISE SENSITIVE USES
(SHEET 4 OF 9)**

Designed	CWK	Eng.Chk.	FY	Status	PRE
Drawn	MING	Coordination	FY	Project	248137
Dwg.Chk.	CWK	Approved	AFK	CAD File	1\248137\report\env\elo_00223\FIGURE 3-5.dgn
Scale	1:1500@A1	Project	248137	Status	PRE
Drawing No.	FIGURE 3.5	Rev	P5		

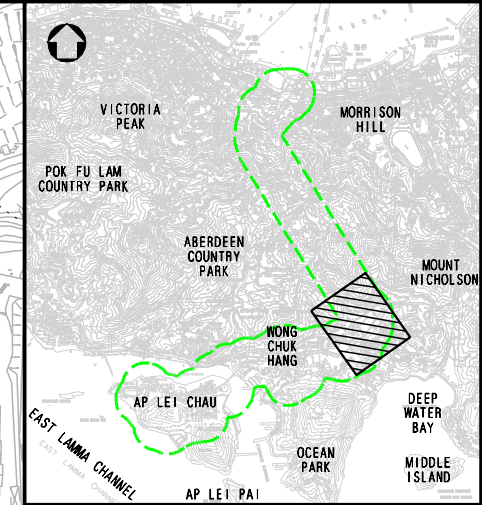
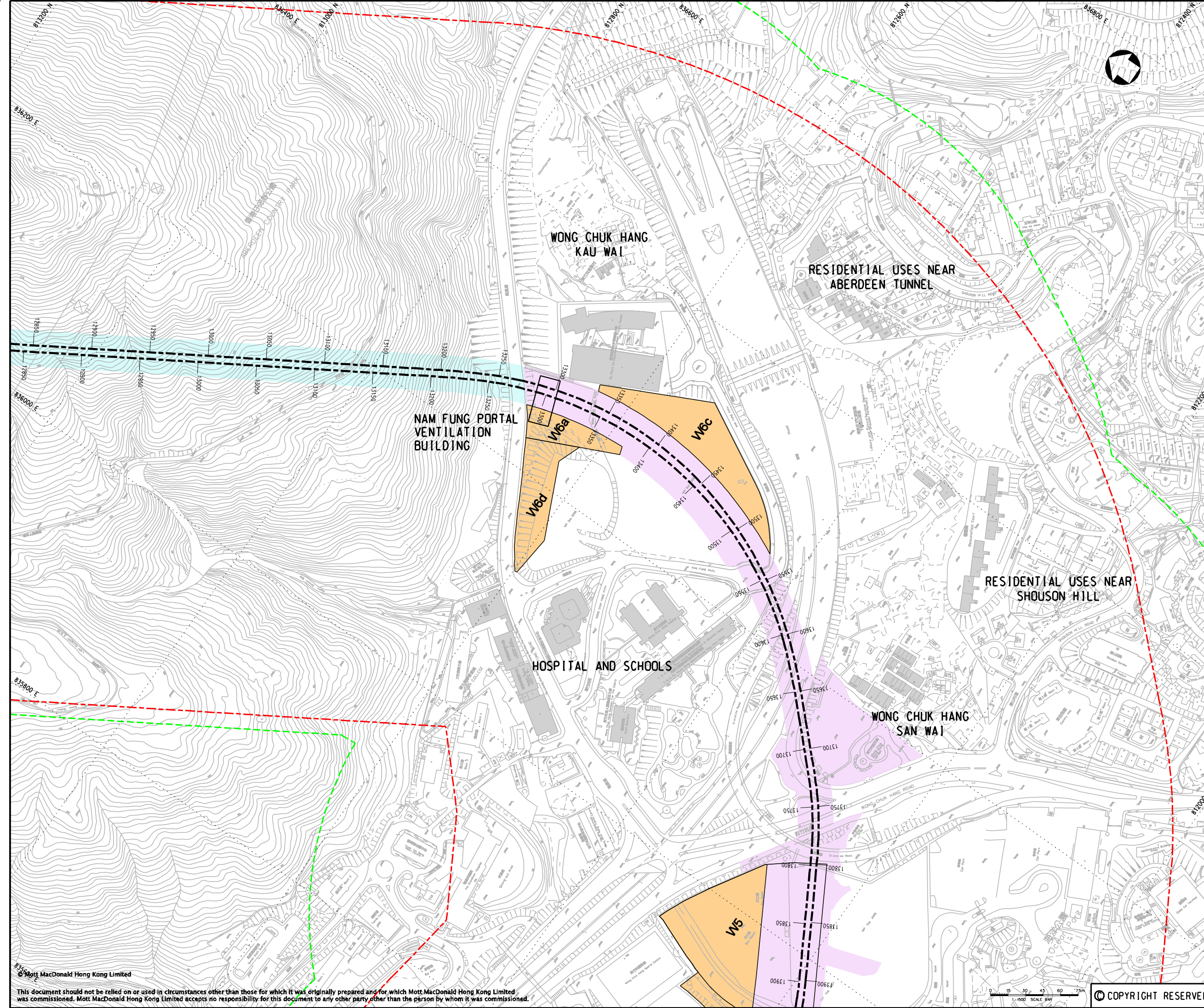

KEY PLAN

LEGEND:

- ASSESSMENT AREA OF CONSTRUCTION PHASE
- ASSESSMENT AREA OF OPERATIONAL PHASE
- W5** WORKS AREA
- PROPOSED WORKS SITE (GROUND LEVEL AND UNDERGROUND)
- PROPOSED WORKS SITE (UNDERGROUND)
- PROPOSED WORKS AREA (GROUND LEVEL)
- THE FIRST LAYER OF AFFECTED NOISE SENSITIVE USES

P5	MAY 10	MING	ISSUE TO MTRC & EPD	HC	AFK
P4	DEC 09	MING	ISSUE TO MTRC & EPD	CWK	AFK
P3	NOV 09	MING	ISSUE TO MTRC & EPD	CWK	AFK
P2	SEP 09	MING	ISSUE TO MTRC	CWK	AFK
P1	APR 09	MING	ISSUE TO MTRC	CWK	AFK
Rev	Date	Drawn	Description		Ch'kd/App'd



Project
**CONSULTANCY AGREEMENT NO. NEX/2301
SOUTH ISLAND LINE (EAST)
ENVIRONMENTAL IMPACT ASSESSMENT**

Title
**THE FIRST LAYER OF AFFECTED
NOISE SENSITIVE USES
(SHEET 5 OF 9)**

Designed	CWK	Eng.Chk.	FY
Drawn	MING	Coordination	FY
Dwg.Chk.	CWK	Approved	AFK
Scale	1:1500@A1	Project	248137
Drawing No.		CAD File	1\248137\report\env\elo_000223\FIGURE 3-5.dgn
		Status	PRE
		Rev	P5

© Mott MacDonald Hong Kong Limited
This document should not be relied on or used in circumstances other than those for which it was originally prepared and for which Mott MacDonald Hong Kong Limited was commissioned. Mott MacDonald Hong Kong Limited accepts no responsibility for this document to any other party other than the person by whom it was commissioned.



COPYRIGHT RESERVED

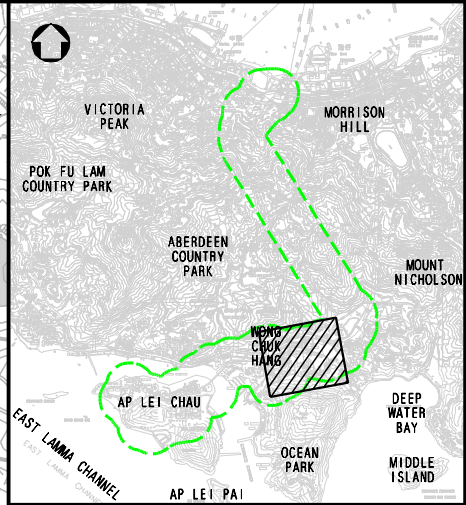
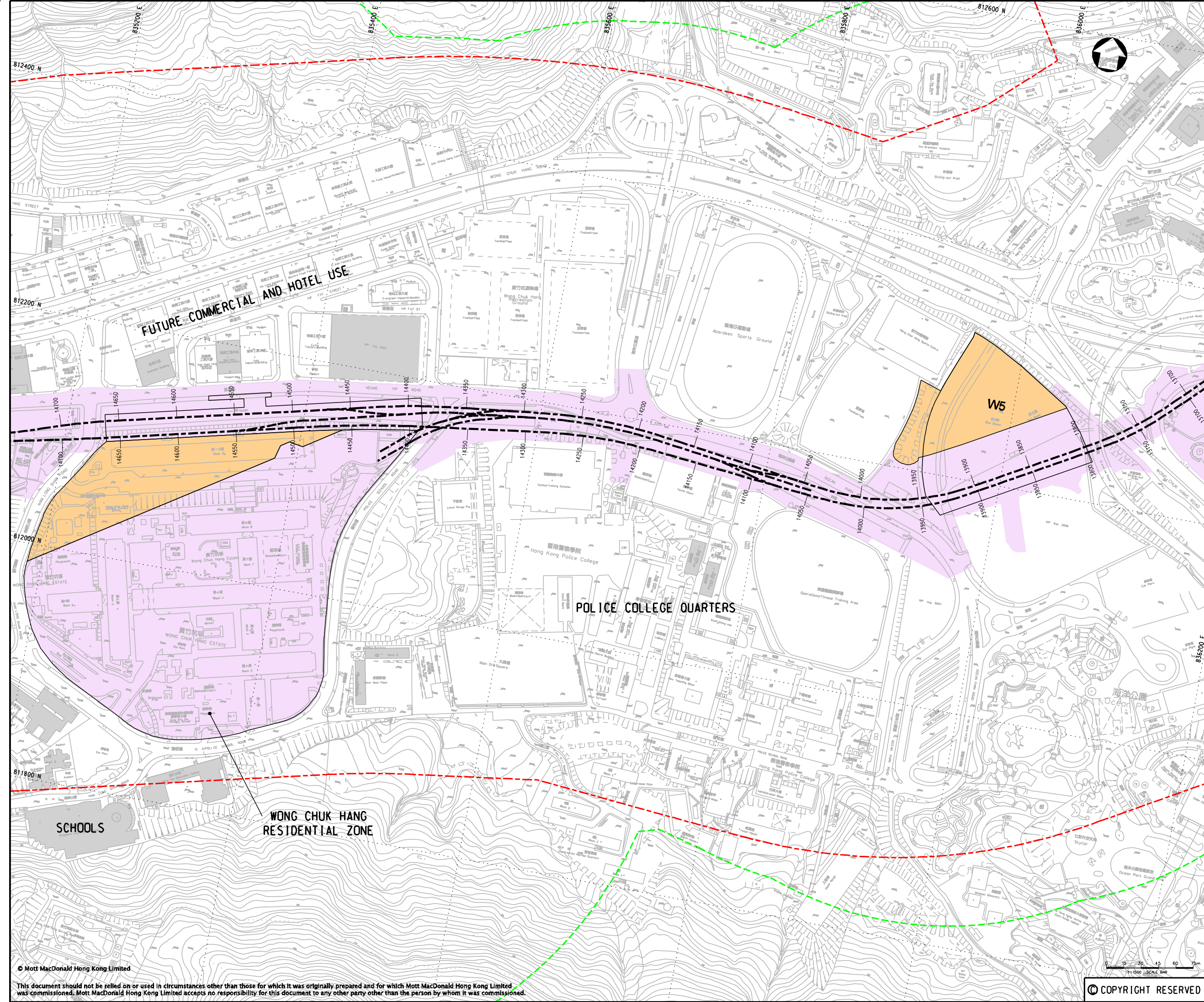

KEY PLAN

LEGEND:

- ASSESSMENT AREA OF CONSTRUCTION PHASE
- ASSESSMENT AREA OF OPERATIONAL PHASE
- W5** WORKS AREA
- PROPOSED WORKS SITE (GROUND LEVEL AND UNDERGROUND)
- PROPOSED WORKS AREA (GROUND LEVEL)
- THE FIRST LAYER OF AFFECTED NOISE SENSITIVE USES

P5	MAY 10	MING	ISSUE TO MTRC & EPD	HC	AFK
P4	DEC 09	MING	ISSUE TO MTRC & EPD	CWK	AFK
P3	NOV 09	MING	ISSUE TO MTRC & EPD	CWK	AFK
P2	SEP 09	MING	ISSUE TO MTRC	CWK	AFK
P1	APR 09	MING	ISSUE TO MTRC	CWK	AFK
Rev	Date	Drawn	Description		Ch'kd/ App'd



Project

**CONSULTANCY AGREEMENT NO. NEX/2301
SOUTH ISLAND LINE (EAST)
ENVIRONMENTAL IMPACT ASSESSMENT**

Title

**THE FIRST LAYER OF AFFECTED
NOISE SENSITIVE USES
(SHEET 6 OF 9)**

Designed	CWK	Eng.Chk.	FY
Drawn	MING	Coordination	FY
Dwg.Chk.	CWK	Approved	AFK
Scale	Project	Status	
1:1500@A1	248137	PRE	
	CAD File	Rev	
	\\1248137\report\env\elo\100223\FIGURE 3-7.dgn		
Drawing No.	FIGURE 3.7		

© COPYRIGHT RESERVED

© Mott MacDonald Hong Kong Limited

This document should not be relied on or used in circumstances other than those for which it was originally prepared and for which Mott MacDonald Hong Kong Limited was commissioned. Mott MacDonald Hong Kong Limited accepts no responsibility for this document to any other party other than the person by whom it was commissioned.

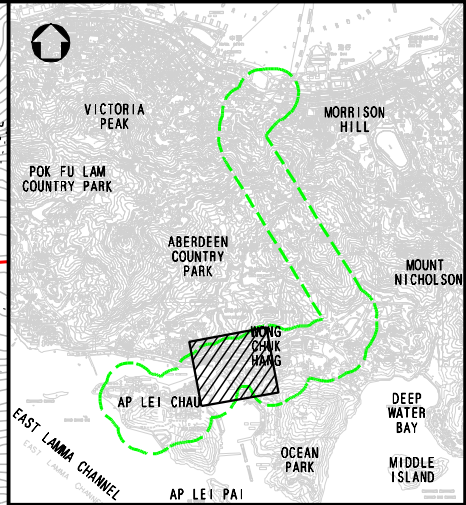
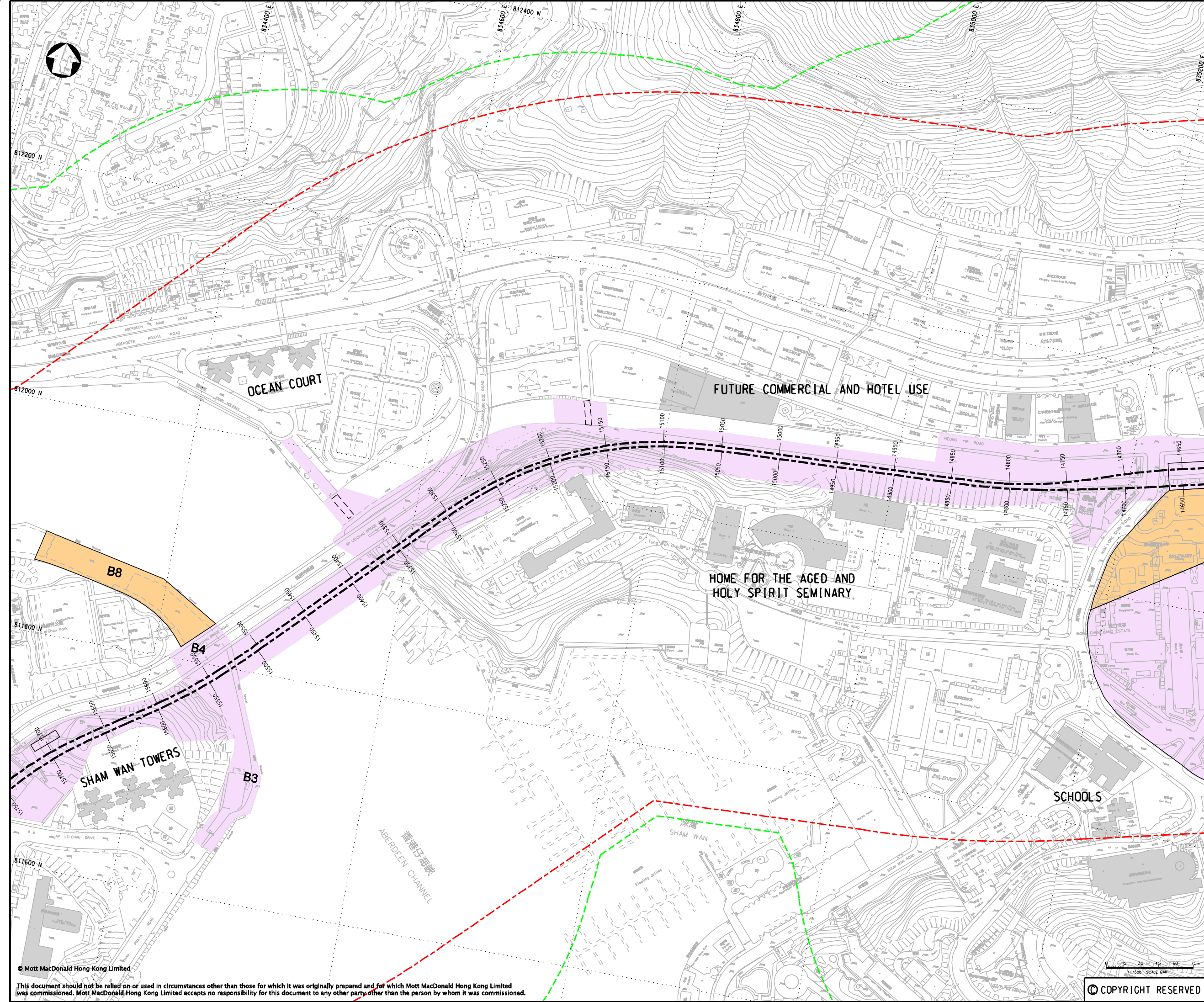

KEY PLAN

LEGEND:

- ASSESSMENT AREA OF CONSTRUCTION PHASE
- ASSESSMENT AREA OF OPERATIONAL PHASE
- B3** BARGING AREA
- PROPOSED WORKS SITE (GROUND LEVEL AND UNDERGROUND)
- PROPOSED WORKS AREA (GROUND LEVEL)
- THE FIRST LAYER OF AFFECTED NOISE SENSITIVE USES

P5	MAY 10	MING	ISSUE TO MTRC & EPD	HC	AFK
P4	DEC 09	MING	ISSUE TO MTRC & EPD	CWK	AFK
P3	NOV 09	MING	ISSUE TO MTRC & EPD	CWK	AFK
P2	SEP 09	MING	ISSUE TO MTRC	CWK	AFK
P1	APR 09	MING	ISSUE TO MTRC	CWK	AFK
Rev	Date	Drawn	Description	Ch'kd	App'd

Client

20/F Two Landmark East
100 How Ming Street
Kwan Tong, Kowloon
Hong Kong
T +852 2828 5757
F +852 2827 1823
www.mottmac.com.hk

Project
**CONSULTANCY AGREEMENT NO. NEX/2301
SOUTH ISLAND LINE (EAST)
ENVIRONMENTAL IMPACT ASSESSMENT**

Title
**THE FIRST LAYER OF AFFECTED
NOISE SENSITIVE USES
(SHEET 7 OF 9)**

Designed	CWK	Eng.Chk.	FY
Drawn	MING	Coordination	FY
Dwg.Chk.	CWK	Approved	AFK
Scale	1:1500@A1	Project	248137
Scale	1:1500@A1	CAD File	1\248137\report\env\elo_000223\Figure 3.dgn
Drawing No.	FIGURE 3.8	Status	PRE
Copyright	RESERVED	Rev	P5

© Mott MacDonald Hong Kong Limited
This document should not be relied on or used in circumstances other than those for which it was originally prepared and for which Mott MacDonald Hong Kong Limited was commissioned. Mott MacDonald Hong Kong Limited accepts no responsibility for this document to any other party other than the person by whom it was commissioned.

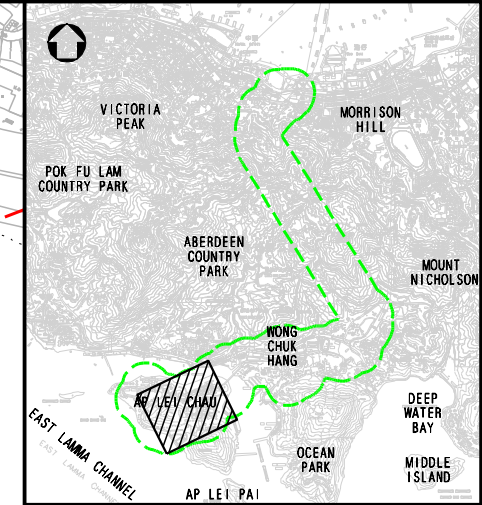
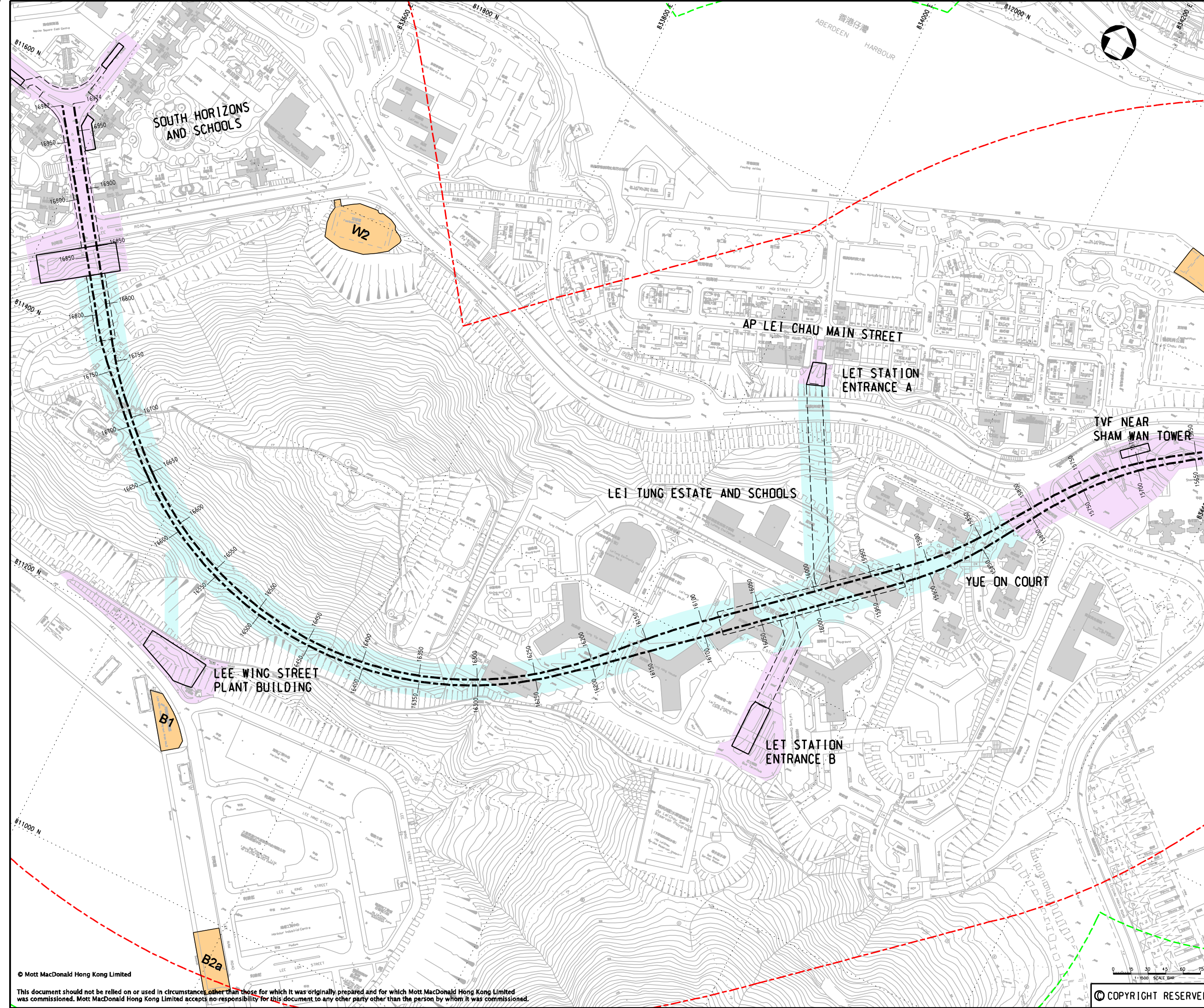

KEY PLAN

LEGEND:

- ASSESSMENT AREA OF CONSTRUCTION PHASE
- ASSESSMENT AREA OF OPERATIONAL PHASE
- B1** BARGING AREA
- W2** WORKS AREA
- PROPOSED WORKS SITE (GROUND LEVEL AND UNDERGROUND)
- PROPOSED WORKS SITE (UNDERGROUND)
- PROPOSED WORKS AREA (GROUND LEVEL)
- THE FIRST LAYER OF AFFECTED NOISE SENSITIVE USES

P5	MAY 10	MING	ISSUE TO MTRC & EPD	HC	AFK
P4	DEC 09	MING	ISSUE TO MTRC & EPD	CWK	AFK
P3	NOV 09	MING	ISSUE TO MTRC & EPD	CWK	AFK
P2	SEP 09	MING	ISSUE TO MTRC	CWK	AFK
P1	APR 09	MING	ISSUE TO MTRC	CWK	AFK
Rev	Date	Drawn	Description	Ch'kd	App'd



Project
**CONSULTANCY AGREEMENT NO. NEX/2301
SOUTH ISLAND LINE (EAST)
ENVIRONMENTAL IMPACT ASSESSMENT**

Title
**THE FIRST LAYER OF AFFECTED
NOISE SENSITIVE USES
(SHEET 8 OF 9)**

Designed	CWK	Eng.Chk.	FY	Status	PRE
Drawn	MING	Coordination	FY	Rev	P5
Dwg.Chk.	CWK	Approved	AFK		
Scale	1:1500@A1	Project	248137		
Drawing No.	FIGURE 3.9	CAD File	1\248137\report\env\elo_00223\FIGURE 3.9.dgn		

© Mott MacDonald Hong Kong Limited
This document should not be relied on or used in circumstances other than those for which it was originally prepared and for which Mott MacDonald Hong Kong Limited was commissioned. Mott MacDonald Hong Kong Limited accepts no responsibility for this document to any other party other than the person by whom it was commissioned.

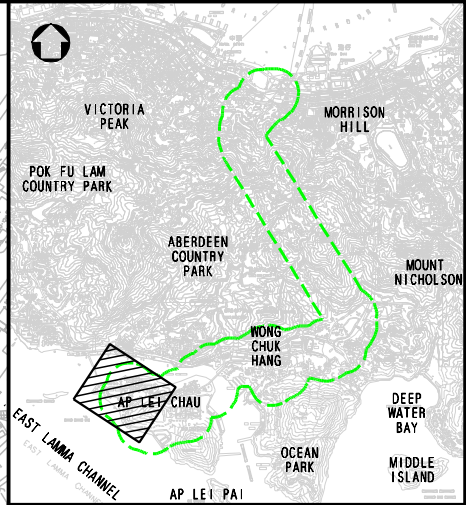
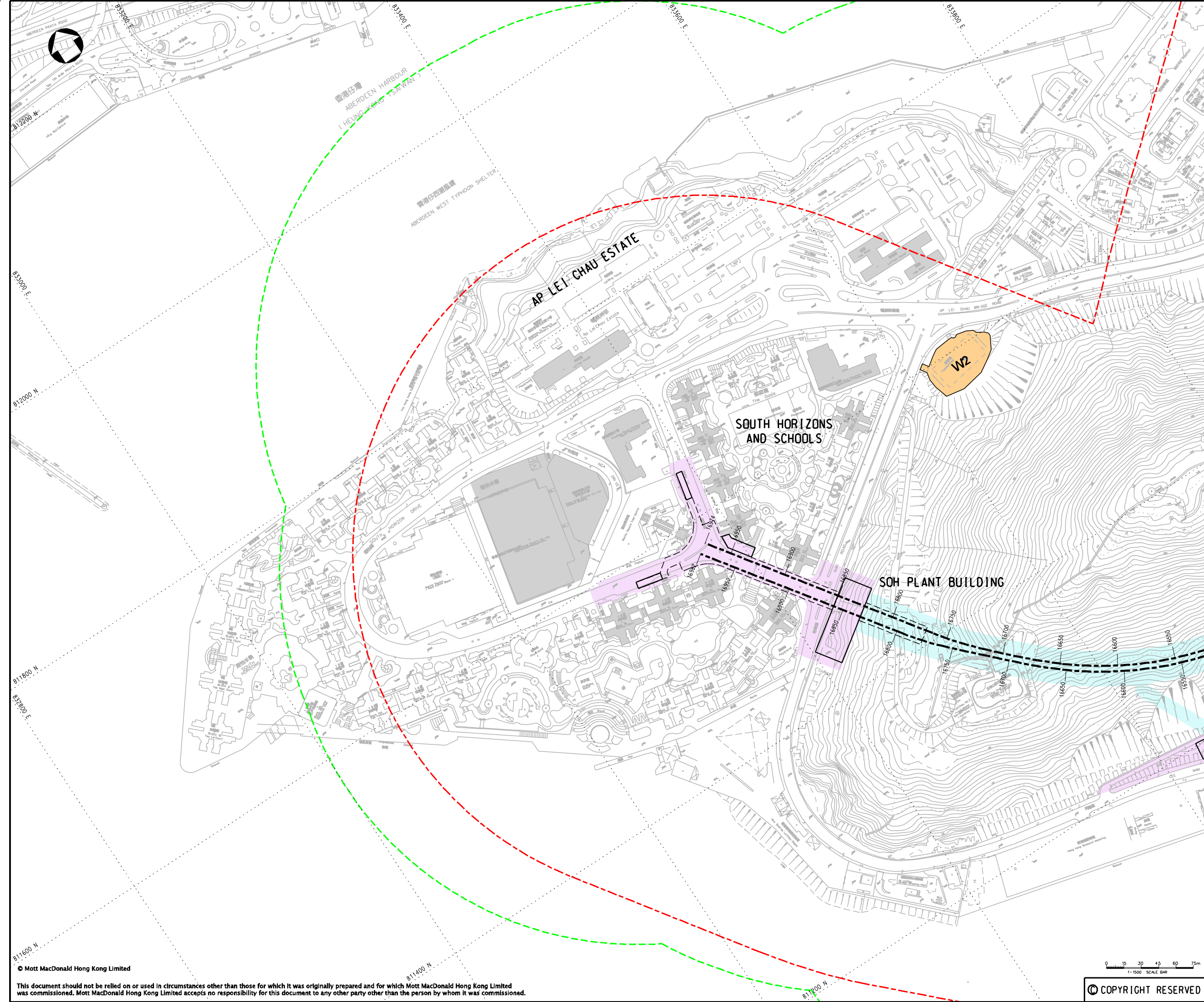

KEY PLAN

LEGEND:

- ASSESSMENT AREA OF CONSTRUCTION PHASE
- ASSESSMENT AREA OF OPERATIONAL PHASE
- W2** WORKS AREA
- PROPOSED WORKS SITE (GROUND LEVEL AND UNDERGROUND)
- PROPOSED WORKS SITE (UNDERGROUND)
- PROPOSED WORKS AREA (GROUND LEVEL)
- THE FIRST LAYER OF AFFECTED NOISE SENSITIVE USES

P5	MAY 10	MING	ISSUE TO MTRC & EPD	HC	AFK
P4	DEC 09	MING	ISSUE TO MTRC & EPD	CWK	AFK
P3	NOV 09	MING	ISSUE TO MTRC & EPD	CWK	AFK
P2	SEP 09	MING	ISSUE TO MTRC	CWK	AFK
P1	APR 09	MING	ISSUE TO MTRC	CWK	AFK
Rev	Date	Drawn	Description	Ch'kd	App'd



Project

**CONSULTANCY AGREEMENT NO. NEX/2301
SOUTH ISLAND LINE (EAST)
ENVIRONMENTAL IMPACT ASSESSMENT**

Title

**THE FIRST LAYER OF AFFECTED
NOISE SENSITIVE USES**
(SHEET 9 OF 9)

Designed	CWK	Eng.Chk.	FY	Status	PRE
Drawn	MING	Coordination	FY	Rev	
Dwg.Chk.	CWK	Approved	AFK		
Scale	1:1500@A1	Project	248137		
		CAD File	1\248137\report\env\elo_000223\Figure_3.10.dgn		
Drawing No.					

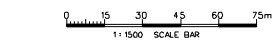

© COPYRIGHT RESERVED

FIGURE 3.10

P5