

KEY PLAN

LEGEND:

- ASSESSMENT AREA OF CONSTRUCTION PHASE
- ASSESSMENT AREA OF OPERATIONAL PHASE
- W5** WORKS AREA
- PROPOSED WORKS SITE (GROUND LEVEL AND UNDERGROUND)
- PROPOSED WORKS SITE (UNDERGROUND)
- PROPOSED WORKS AREA (GROUND LEVEL)
- THE FIRST LAYER OF AFFECTED NOISE SENSITIVE USES

| | | | | | |
|-----|--------|-------|---------------------|-------|-------|
| P5 | MAY 10 | MING | ISSUE TO MTRC & EPD | HC | AFK |
| P4 | DEC 09 | MING | ISSUE TO MTRC & EPD | CWK | AFK |
| P3 | NOV 09 | MING | ISSUE TO MTRC & EPD | CWK | AFK |
| P2 | SEP 09 | MING | ISSUE TO MTRC | CWK | AFK |
| P1 | APR 09 | MING | ISSUE TO MTRC | CWK | AFK |
| Rev | Date | Drawn | Description | Ch'kd | App'd |



Project
**CONSULTANCY AGREEMENT NO. NEX/2301
SOUTH ISLAND LINE (EAST)
ENVIRONMENTAL IMPACT ASSESSMENT**

Title
**THE FIRST LAYER OF AFFECTED
NOISE SENSITIVE USES
(SHEET 5 OF 9)**

| | | | |
|-------------|--|--------------|-----|
| Designed | CWK | Eng.Chk. | FY |
| Drawn | MING | Coordination | FY |
| Dwg.Chk. | CWK | Approved | AFK |
| Scale | Project | Status | |
| 1:1500@A1 | 248137 | PRE | |
| Drawing No. | CAD File | Rev | |
| | \\248137\report\env\elo_00223\FIGURE 3-5.dgn | | |

© Mott MacDonald Hong Kong Limited
This document should not be relied on or used in circumstances other than those for which it was originally prepared and for which Mott MacDonald Hong Kong Limited was commissioned. Mott MacDonald Hong Kong Limited accepts no responsibility for this document to any other party other than the person by whom it was commissioned.



© COPYRIGHT RESERVED

FIGURE 3.6

P5

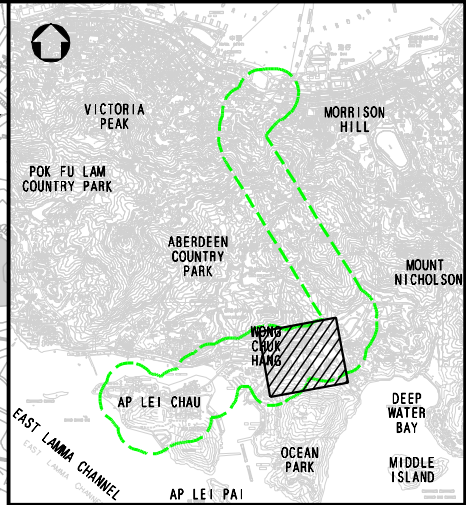
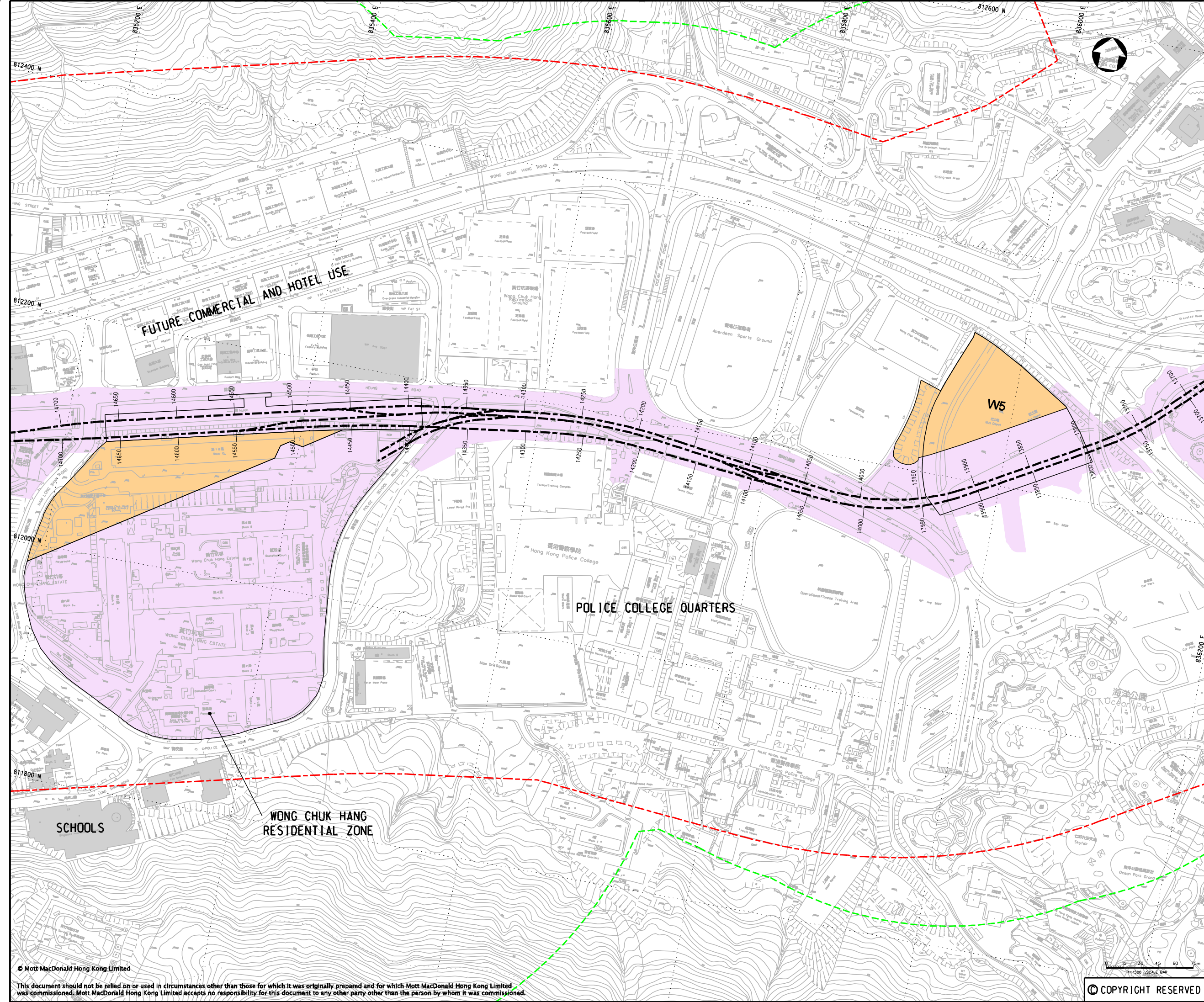

KEY PLAN

LEGEND:

- ASSESSMENT AREA OF CONSTRUCTION PHASE
- ASSESSMENT AREA OF OPERATIONAL PHASE
- W5** WORKS AREA
- PROPOSED WORKS SITE (GROUND LEVEL AND UNDERGROUND)
- PROPOSED WORKS AREA (GROUND LEVEL)
- THE FIRST LAYER OF AFFECTED NOISE SENSITIVE USES

| | | | | | |
|-----|--------|-------|---------------------|-----|-------------|
| P5 | MAY 10 | MING | ISSUE TO MTRC & EPD | HC | AFK |
| P4 | DEC 09 | MING | ISSUE TO MTRC & EPD | CWK | AFK |
| P3 | NOV 09 | MING | ISSUE TO MTRC & EPD | CWK | AFK |
| P2 | SEP 09 | MING | ISSUE TO MTRC | CWK | AFK |
| P1 | APR 09 | MING | ISSUE TO MTRC | CWK | AFK |
| Rev | Date | Drawn | Description | | Ch'kd/App'd |

Client

20/F Two Landmark East
100 How Ming Street
Kwan Tong, Kowloon
Hong Kong
T +852 2828 5757
F +852 2827 1823
www.mottmac.com.hk

Project

**CONSULTANCY AGREEMENT NO. NEX/2301
SOUTH ISLAND LINE (EAST)
ENVIRONMENTAL IMPACT ASSESSMENT**

Title

**THE FIRST LAYER OF AFFECTED
NOISE SENSITIVE USES
(SHEET 6 OF 9)**

| | | | |
|-------------|--|--------------|-----|
| Designed | CWK | Eng.Chk. | FY |
| Drawn | MING | Coordination | FY |
| Dwg.Chk. | CWK | Approved | AFK |
| Scale | Project | Status | |
| 1:1500@A1 | 248137 | PRE | |
| Drawing No. | CAD File | Rev | |
| | \\248137\report\env\elo_1100223\FIGURE 3-7.dgn | | |

© Mott MacDonald Hong Kong Limited
This document should not be relied on or used in circumstances other than those for which it was originally prepared and for which Mott MacDonald Hong Kong Limited was commissioned. Mott MacDonald Hong Kong Limited accepts no responsibility for this document to any other party other than the person by whom it was commissioned.

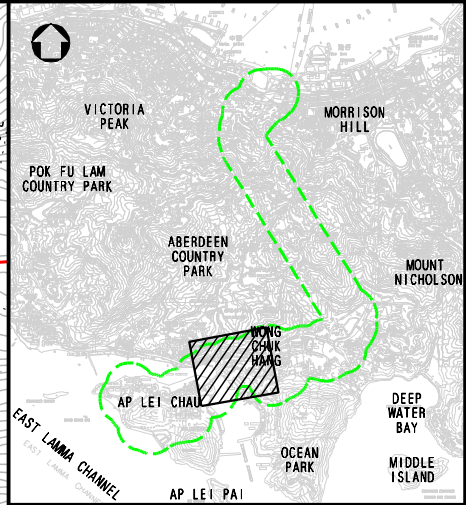
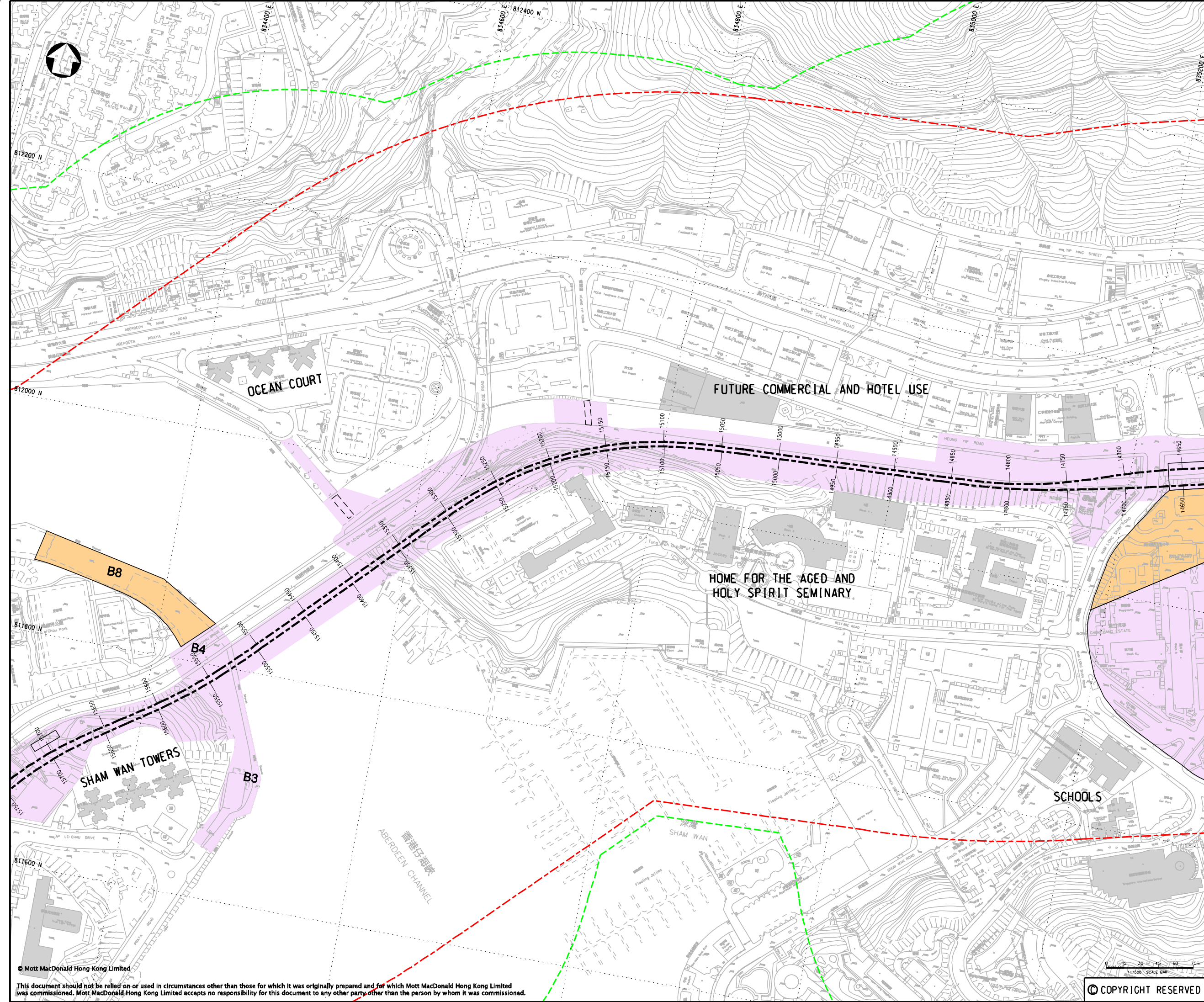

KEY PLAN

LEGEND:

- ASSESSMENT AREA OF CONSTRUCTION PHASE
- ASSESSMENT AREA OF OPERATIONAL PHASE
- B3** BARGING AREA
- PROPOSED WORKS SITE (GROUND LEVEL AND UNDERGROUND)
- PROPOSED WORKS AREA (GROUND LEVEL)
- THE FIRST LAYER OF AFFECTED NOISE SENSITIVE USES

| | | | | | |
|-----|--------|-------|---------------------|-------|-------|
| P5 | MAY 10 | MING | ISSUE TO MTRC & EPD | HC | AFK |
| P4 | DEC 09 | MING | ISSUE TO MTRC & EPD | CWK | AFK |
| P3 | NOV 09 | MING | ISSUE TO MTRC & EPD | CWK | AFK |
| P2 | SEP 09 | MING | ISSUE TO MTRC | CWK | AFK |
| P1 | APR 09 | MING | ISSUE TO MTRC | CWK | AFK |
| Rev | Date | Drawn | Description | Ch'kd | App'd |

Client

20/F Two Landmark East
100 How Ming Street
Kwan Tong, Kowloon
Hong Kong
T +852 2828 5757
F +852 2827 1823
www.mottmac.com.hk

Project
CONSULTANCY AGREEMENT NO. NEX/2301
SOUTH ISLAND LINE (EAST)
ENVIRONMENTAL IMPACT ASSESSMENT

Title
THE FIRST LAYER OF AFFECTED NOISE SENSITIVE USES
(SHEET 7 OF 9)

| | | | |
|-------------|------------------|--------------|--------|
| Designed | CWK | Eng.Chk. | FY |
| Drawn | MING | Coordination | FY |
| Dwg.Chk. | CWK | Approved | AFK |
| Scale | 1:1500@A1 | Project | 248137 |
| Scale | 1:1500 SCALE BAR | Status | PRE |
| Drawing No. | FIGURE 3.8 | Rev | P5 |

© Mott MacDonald Hong Kong Limited
This document should not be relied on or used in circumstances other than those for which it was originally prepared and for which Mott MacDonald Hong Kong Limited was commissioned. Mott MacDonald Hong Kong Limited accepts no responsibility for this document to any other party other than the person by whom it was commissioned.