

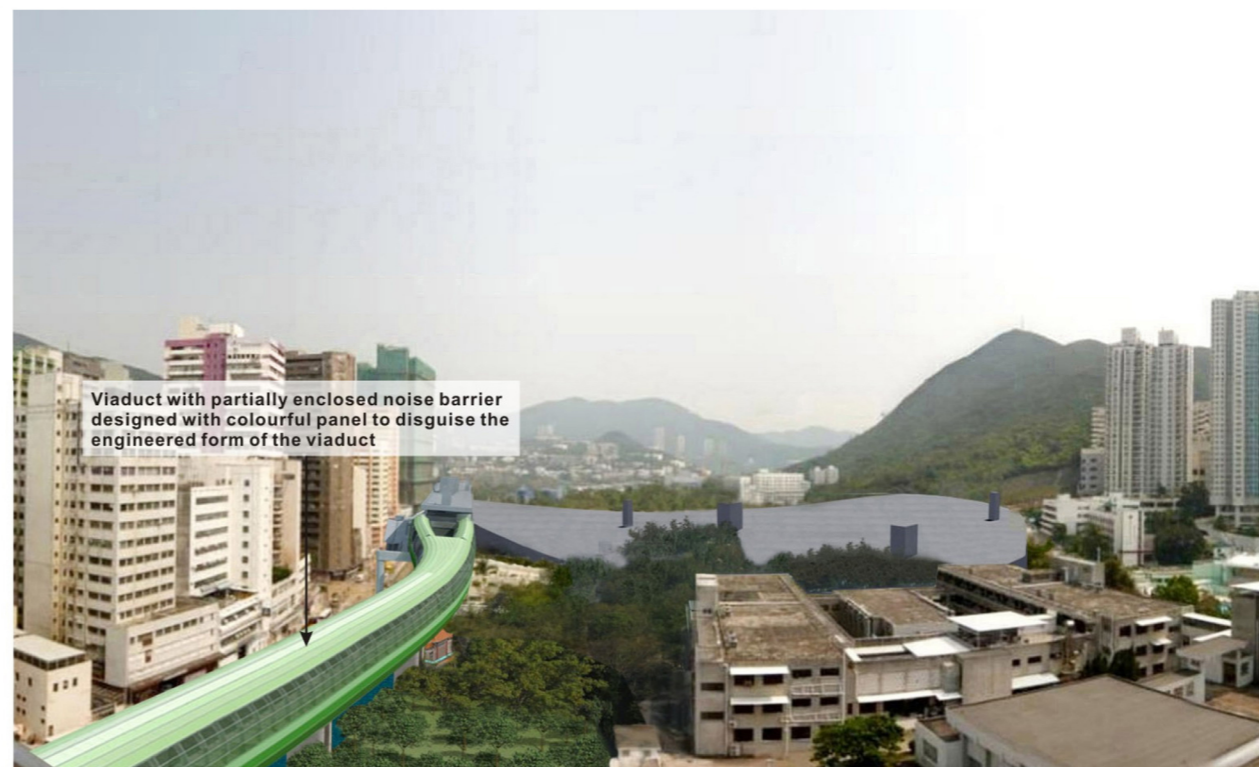

Existing Condition
Vantage Point I - View east at elevated levels within the Rehabilitation Complex looking towards proposed viaduct from WCH Station



Day 1 of Operation Phase with landscape mitigation measures



Day 1 of Operation Phase without landscape mitigation measures



Year 10 of Operation Phase with landscape mitigation measures fully established

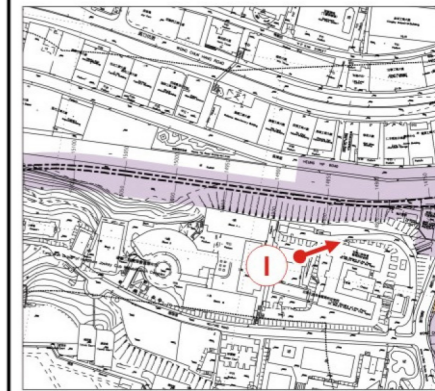

Key Plan

(Represents VSRs including workers in Wong Chuk Hang Industrial Building (VSRO3) and Residents of community facilities to the east of Ap Lei Chau Bridge (VSRR6) having views looking towards the proposed elevated viaduct leading from the WCH Station)

Note:

1. Indicative design of built structure and landscape proposals provided by Detailed Design Consultants.
2. The final details will be subject to detailed design development.
3. The extent of noise barrier / enclosure is indicative only.

Rev	Date	Drawn/Description	Ch'kd/App'd

Client



Mott MacDonald Hong Kong Ltd
7th Floor
West Wing Office Building
New World Centre
20 Salisbury Road
Tsim Sha Tsui, Kowloon
Hong Kong
Tel: 2828 5757
Fax: 2827 1829
Web: www.mottmac.com.hk

Project

CONSULTANCY AGREEMENT NO. NEX/2301
SOUTH ISLAND LINE (EAST)
ENVIRONMENTAL IMPACT ASSESSMENT

Title

Photomontage - Vantage Points I

Designed	Eng.Chk.			
Drawn	SOP	06/10	Coordination	
Dwg.Chk.	ELK	06/10	Approved	CJF 06/10
Scale	N.T.S.	Project	CAD File	Status

Drawing No. Figure 6.10.14 Rev