

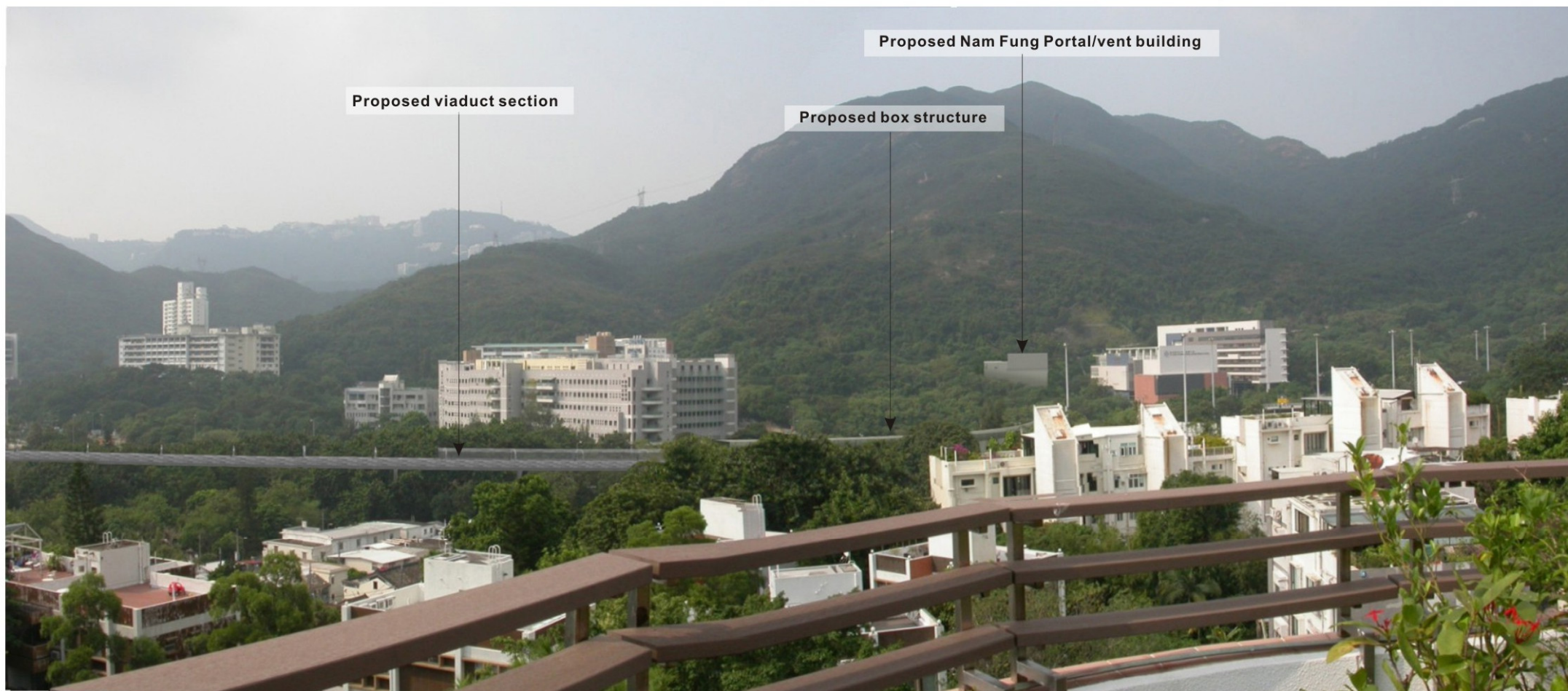

**Existing Condition**

Vantage Point N - A private viewpoint at 6A Shouson Hill Road to represent view of Shouson Hill VSR towards Nam Fung Portal



**Day 1 of Operation Phase without landscape mitigation measures**

© Mott MacDonald Hong Kong Limited

This document should not be relied on or used in circumstances other than those for which it was originally prepared and for which Mott MacDonald Hong Kong Limited was commissioned. Mott MacDonald Hong Kong Limited accepts no responsibility for this document to any other party other than the person by whom it was commissioned.

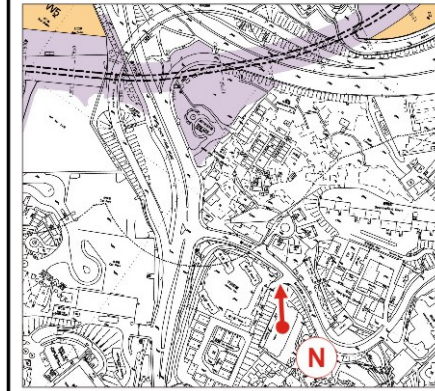

**Key Plan**

(Represents VSRs having views looking towards proposed the box structure and viaduct leading to OCP Station including Residents of developments on Shouson Hill (VSRR9), Residents of Wong Chuk Hang Hospital and Complex for the Elderly (VSR R8) and Staff and Students of the St. Paul Co-educational College Primary School (VSR O10))

**Note:**

1. Indicative design of built structure and landscape proposals provided by Detailed Design Consultants.
2. The final details will be subject to detailed design development.
3. The extent of noise barrier / enclosure is indicative only.

Rev	Date	Drawn/Description	Ch'kd/App'd
-----	------	-------------------	-------------

Client



Mott MacDonald Hong Kong Ltd  
7th Floor  
West Wing Office Building  
New World Centre  
20 Salisbury Road  
Tsim Sha Tsui, Kowloon  
Hong Kong  
Tel 2828 5757  
Fax 2827 1823  
Web www.mottmac.com.hk

Project

CONSULTANCY AGREEMENT NO. NEX/2301  
SOUTH ISLAND LINE (EAST)  
ENVIRONMENTAL IMPACT ASSESSMENT

Title

Photomontage - Vantage Points N

Designed	SOP	06/10	Eng.Chk.		
Drawn	ELK	06/10	Coordination	CJF	06/10
Dwg.Chk.			Approved		

Scale	N.T.S.	Project		Status	
		CAD File			

Drawing No.		Rev	
-------------	--	-----	--

© COPYRIGHT RESERVED

Figure 6.10.21