

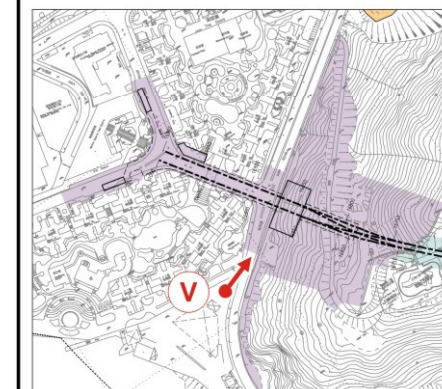

Existing Condition
Vantage Point V - View north at street level from Lee Nam Road looking towards SOH Station Vent Building



Day 1 of Operation Phase without landscape mitigation measures



Key Plan

(Represents views for Residents of South Horizons (VSR R2.2) looking towards the proposed vent building of SOH Station at Lee Nam Road)

Note:

1. Indicative design of built structure and landscape proposals provided by Detailed Design Consultants.
2. The final details will be subject to detailed design development.

Rev	Date	Drawn/Description	Ch'kd/App'd
-----	------	-------------------	-------------

Client



Mott MacDonald Hong Kong Ltd
7th Floor
West Wing Office Building
New World Centre
20 Salisbury Road
Tsim Sha Tsui, Kowloon
Hong Kong
Tel: 2828 5757
Fax: 2827 1825
Web: www.mottmac.com.hk

Project

CONSULTANCY AGREEMENT NO. NEX/2301
SOUTH ISLAND LINE (EAST)
ENVIRONMENTAL IMPACT ASSESSMENT

Title

Photomontage - Vantage Points V

Designed	SOP		Eng.Chk.	Coordination	
Drawn	SOP	04/10	Coordination		
Dwg.Chk.	ELK	04/10	Approved	CJF	04/10
Scale	N.T.S.		Project	Status	
			CAD File		
Drawing No.	Figure 6.10.34				Rev