

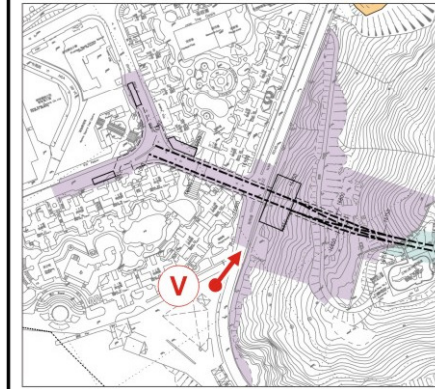

Day 1 of Operation Phase with landscape mitigation measures



Year 10 of Operation Phase with landscape mitigation measures fully established



Key Plan

(Represents views for Residents of South Horizons (VSR R2.2) looking towards the proposed vent building of SOH Station at Lee Nam Road)

Note:

1. Indicative design of built structure and landscape proposals provided by Detailed Design Consultants.
2. The final details will be subject to detailed design development.

Rev	Date	Drawn/Description	Ch'kd/App'd
Client			



Mott MacDonald Hong Kong Ltd
7th Floor
West Wing Office Building
New World Centre
20 Salisbury Road
Tsim Sha Tsui, Kowloon
Hong Kong
Tel: 2828 5757
Fax: 2827 1825
Web: www.mottmac.com.hk

Project
CONSULTANCY AGREEMENT NO. NEX/2301
SOUTH ISLAND LINE (EAST)
ENVIRONMENTAL IMPACT ASSESSMENT

Title
Photomontage - Vantage Points V

Designed		Eng.Chk.	
Drawn	SOP	04/10	Coordination
Dwg.Chk.	ELK	04/10	Approved C/JF
Scale	N.T.S.	Project	Status
		CAD File	
Drawing No.			Rev

© COPYRIGHT RESERVED

Figure 6.10.35