



Station entrance is designed in form of landscape plaza to integrated with Ocean Park entrance threshold

Disturbed areas will be reinstated with roadside planting to soften the engineering from views at street level.

Day 1 of Operation Phase with landscape mitigation measures



Indicative GIC development to be designed by others (For illustrative purpose only, subject to change / agreement and not for approval under EIAO)

Indicative GIC development to be designed by others (For illustrative purpose only, subject to change / agreement and not for approval under EIAO)

Year 10 of Operation Phase with landscape mitigation measures fully established

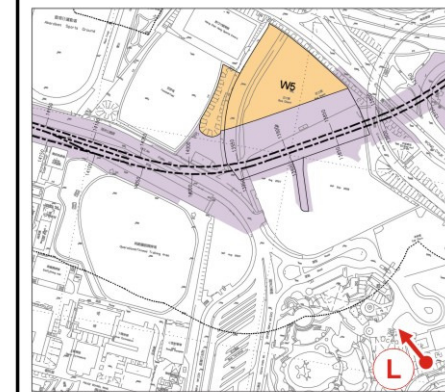

Key Plan

(Represents VSRs having views looking towards the proposed Nam Fung portal / vent building, the box structure and viaduct leading to the OCP Station including Residents of Wong Chuk Hang Hospital and Complex for the Elderly (VSR R8), Residents of developments on Shouson Hill (VSR R9), Visitors to Ocean Park (VSR C5), Staff and Students of the St. Paul Co-educational College Primary School (VSR O10) and Staff and Patients of Grantham Hospital (VSR R13)

Note:

1. Indicative design of built structure and landscape proposals provided by Detailed Design Consultants.
2. The final details will be subject to detailed design development.
3. The extent of noise barrier / enclosure is indicative only.

Rev	Date	Drawn/Description	Chk'd	App'd
Client				



Mott MacDonald Hong Kong Ltd
7th Floor
West Wing Office Building
New World Centre
20 Salisbury Road
Tsim Sha Tsui, Kowloon
Hong Kong
Tel 2828 5757
Fax 2827 1823
Web www.mottmac.com.hk

Project
CONSULTANCY AGREEMENT NO. NEX/2301
SOUTH ISLAND LINE (EAST)
ENVIRONMENTAL IMPACT ASSESSMENT

Title
Photomontage - Vantage Points L

Designed	SOP	07/10	Eng.Chk.		
Drawn	ELK	07/10	Coordination	CJF	07/10
Dwg.Chk.			Approved		

Scale	N.T.S.	Project	Status
		CAD File	

Drawing No.	Figure 6.10.19	Rev	
-------------	----------------	-----	--