

Telegraph Bay Barging Point

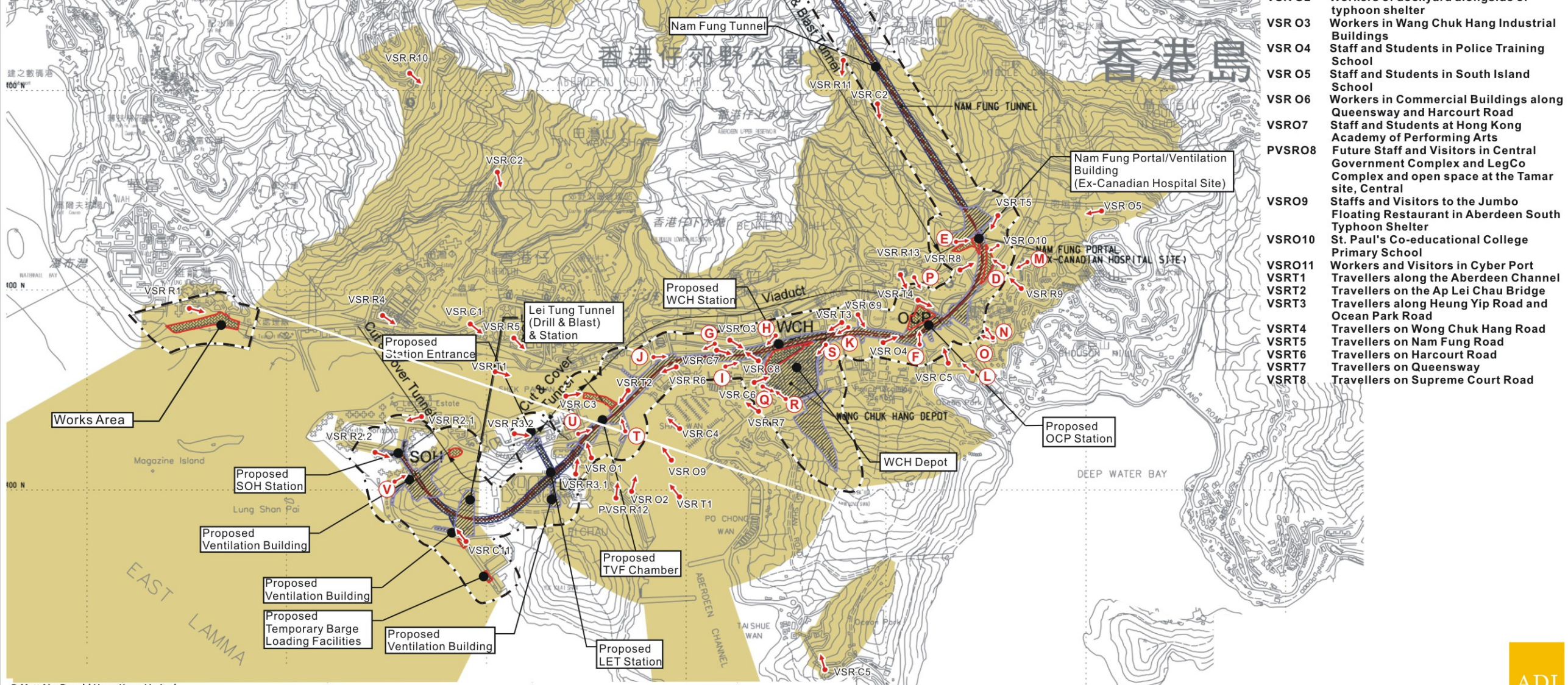

- VSR R1 Residents of Wah Kwai Estate
- VSR R2.1 Residents of Ap Lei Chau Estate
- VSR R2.2 Residents of South Horizons
- VSR R3.1 Residents of estates in eastern Ap Lei Chau
- VSR R3.2 Residents of mansions at Ap Lei Chau Main Street
- VSR R4 Residents of estates in western Aberdeen
- VSR R5 Residents of estates in eastern Aberdeen
- VSR R6 Residents of community facilities to the east of Ap Lei Chau Bridge
- VSR R7 Residents of estates in Wang Chuk Hang
- VSR R8 Residents of Wang Chuk Hang Hospital and Complex for the Elderly
- VSR R9 Residents of developments on Shouson Hill
- VSR R10 Residents of developments at the Peak on Mount Kellett
- VSR R11 Residents of developments on Mount Cameron
- PVSR R12 Future residential developments in the area zoned "R(E)I" abutting Ap Lei Chau Praya Road
- VSR R13 Staff and Patients of Grantham Hospital
- VSR C1 Visitors of Permanent Chinese Cemetery, Aberdeen
- VSR C2 Hikers in Aberdeen Country park
- VSR C3 Recreational users of Ap Lei Chau waterfront promenade and park
- VSR C4 Recreational users in Sham Wan Marina
- VSR C5 Visitors to Ocean Park
- VSR C6 Users of Pao Yue Kong Swimming Pool Complex
- VSR C7 Users of sitting-out areas and playground at Heung Yip Road adjacent to the Nullah
- VSR C8 Visitors to Tai Wang Ye Temple
- VSR C9 Users of Aberdeen Sport Ground
- VSR C10 Visitors to Hong Kong Park
- VSR C11 Users of Lee Nam Road Sitting Out Areas
- VSR O1 Staff and Students of Hong Kong True Light College
- VSR O2 Workers of dockyard alongside of typhoon shelter
- VSR O3 Workers in Wang Chuk Hang Industrial Buildings
- VSR O4 Staff and Students in Police Training School
- VSR O5 Staff and Students in South Island School
- VSR O6 Workers in Commercial Buildings along Queensway and Harcourt Road
- VSR O7 Staff and Students at Hong Kong Academy of Performing Arts
- PVSR O8 Future Staff and Visitors in Central Government Complex and LegCo Complex and open space at the Tamar site, Central
- VSR O9 Staffs and Visitors to the Jumbo Floating Restaurant in Aberdeen South Typhoon Shelter
- VSR O10 St. Paul's Co-educational College Primary School
- VSR O11 Workers and Visitors in Cyber Port
- VSRT1 Travellers along the Aberdeen Channel
- VSRT2 Travellers on the Ap Lei Chau Bridge
- VSRT3 Travellers along Heung Yip Road and Ocean Park Road
- VSRT4 Travellers on Wong Chuk Hang Road
- VSRT5 Travellers on Nam Fung Road
- VSRT6 Travellers on Harcourt Road
- VSRT7 Travellers on Queensway
- VSRT8 Travellers on Supreme Court Road

- ### Legend
- Proposed SIL(E)
 - 100M Study Boundary for Landscape Impact Assessment
 - Proposed SIL(E) Station
 - Proposed Works Site (Ground Level and Underground)
 - Proposed Works Site
 - Proposed Works Area
 - Zone of Visual Influence
 - Visually Sensitive Receiver (VSR) and Angle of Main View
 - Photomontage

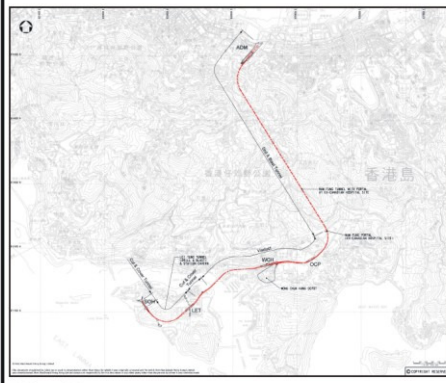

Key Plan

Rev	Date	Drawn	Description	Ch'kd	App'd



Project
CONSULTANCY AGREEMENT NO. NEX/2301
SOUTH ISLAND LINE (EAST)
ENVIRONMENTAL IMPACT ASSESSMENT

Title
Visual Envelope and Zone of Visual Influence
Sheet 1 of 5

Designed	Eng.Chk.	Coordination	Approved	Status
Drawn EIK	07/10		CJF	07/10
Dwg.Chk. ELK	07/10	Approved	CJF	07/10
Scale As Shown	Project CAD File			
Drawing No.				



Figure 6.6.1