

STAGE 6

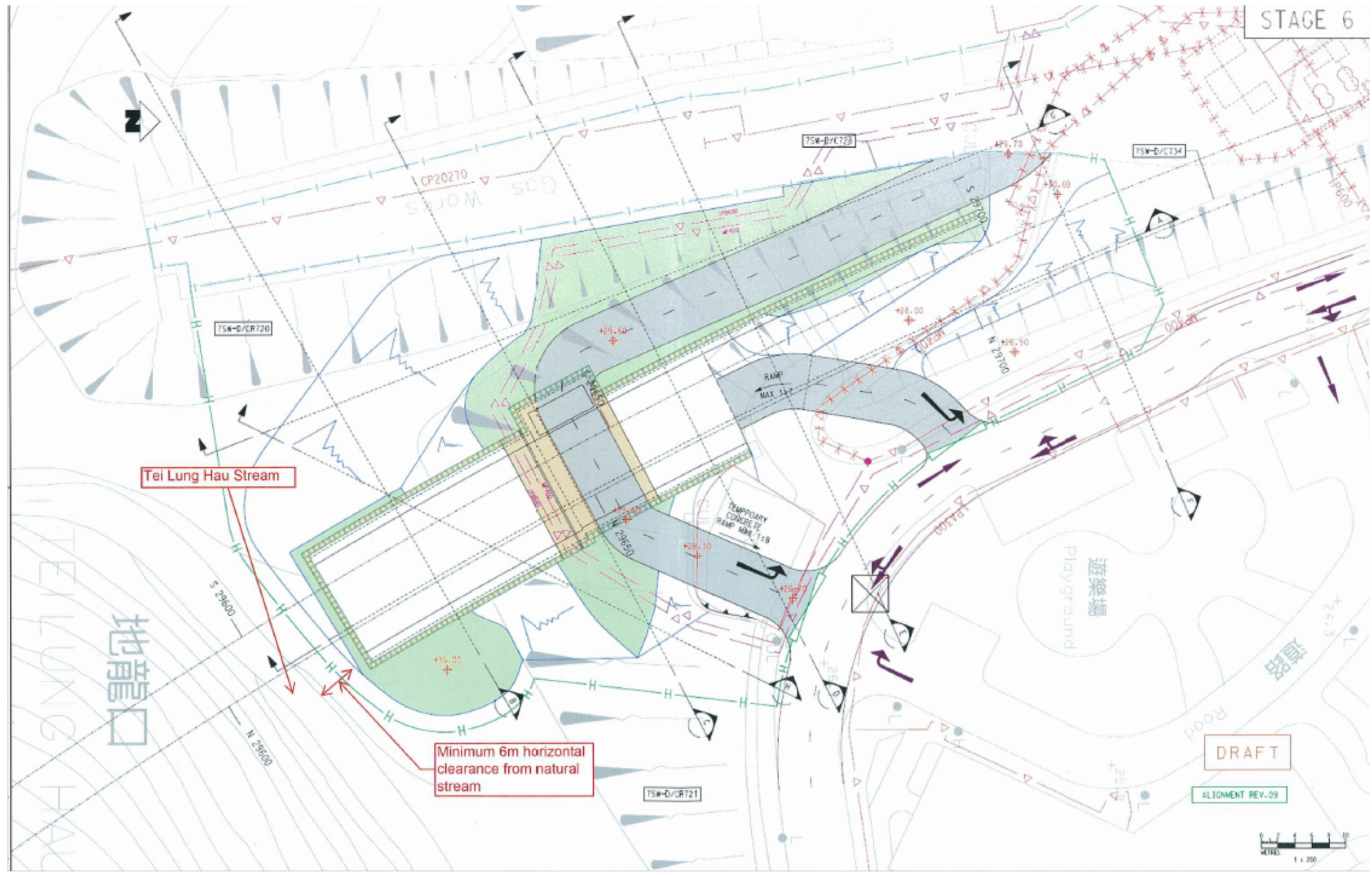

#PLOTDRWLS\* #MODELS\* #FILES\*  
 #REV #DATE #USER\* #TIMES\*  
 PLOT DRW: #MODELNAME\* #FILENAME\*

REV	DESCRIPTION	BY	DATE	APPROVED	REV	DESCRIPTION	BY	DATE	APPROVED
A	FIRST ISSUE	LK	09/10	FC					

DRAWN	LK
DESIGNED	LK
CHECKED	SC
APPROVED	FC
DATE	09/10

DO NOT SCALE DRAWINGS. ALL DIMENSIONS SHALL BE VERIFIED ON SITE.  
 © MTR CORPORATION LIMITED 2008. COPYRIGHT IN RESPECT OF THIS DRAWING / DOCUMENT IS OWNED BY THE MTR CORPORATION LIMITED OF HONG KONG. NO REPRODUCTION OF THE DRAWING / DOCUMENT OR ANY PART BY WHATEVER MEANS IS PERMITTED WITHOUT THE PRIOR WRITTEN CONSENT OF THE MTR CORPORATION LIMITED.

**MTR**

SHATIN TO CENTRAL LINK

ORIGINATOR

**ARUP** Ove Arup & Partners  
 Hong Kong Limited

CADD REF. -

TITLE		NEX/2206 - TAW TO HUH SECTION	
		At-grade Works Sites	
		near HIK Portal (Sheet 1 of 2)	
SCALE	DRAWING NO.	REV.	
As shown	Figure 3.1A	A	