



VIEW A
LUNG TSUN STONE BRIDGE PIER



VIEW B
PIER END STRUCTURE (PES)



VIEW C
SUPPORTING PILLARS OF FORMER KOWLOON CITY PIER



VIEW D
1924 SEAWALL LANDING STEPS

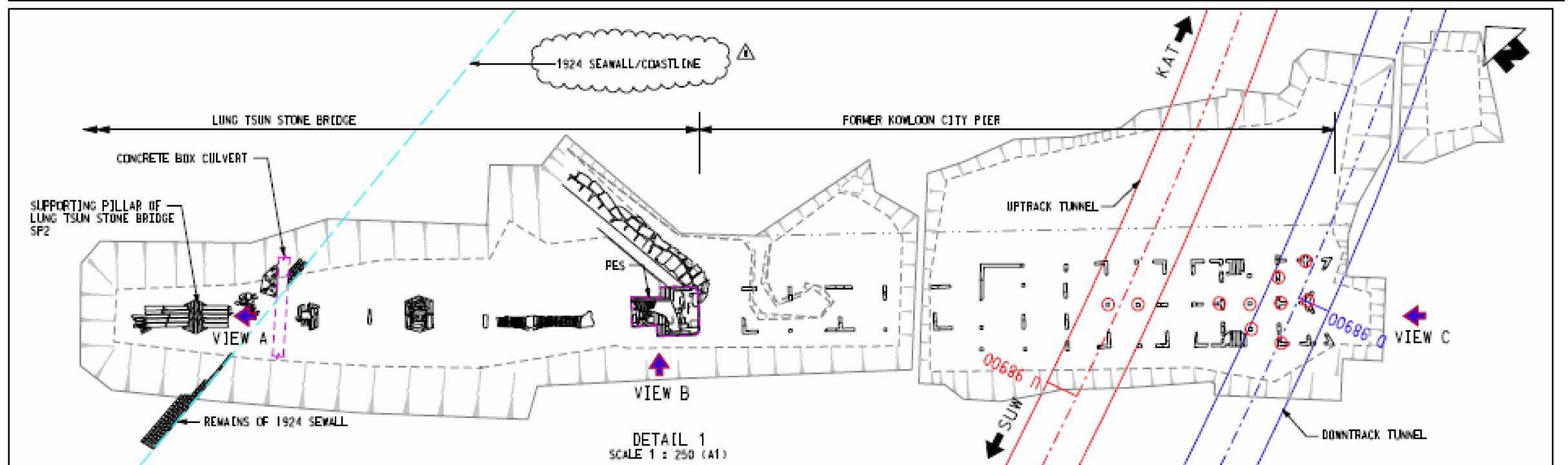
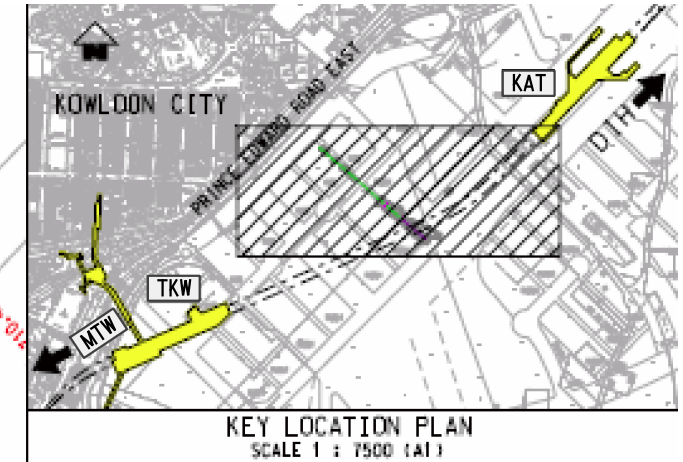
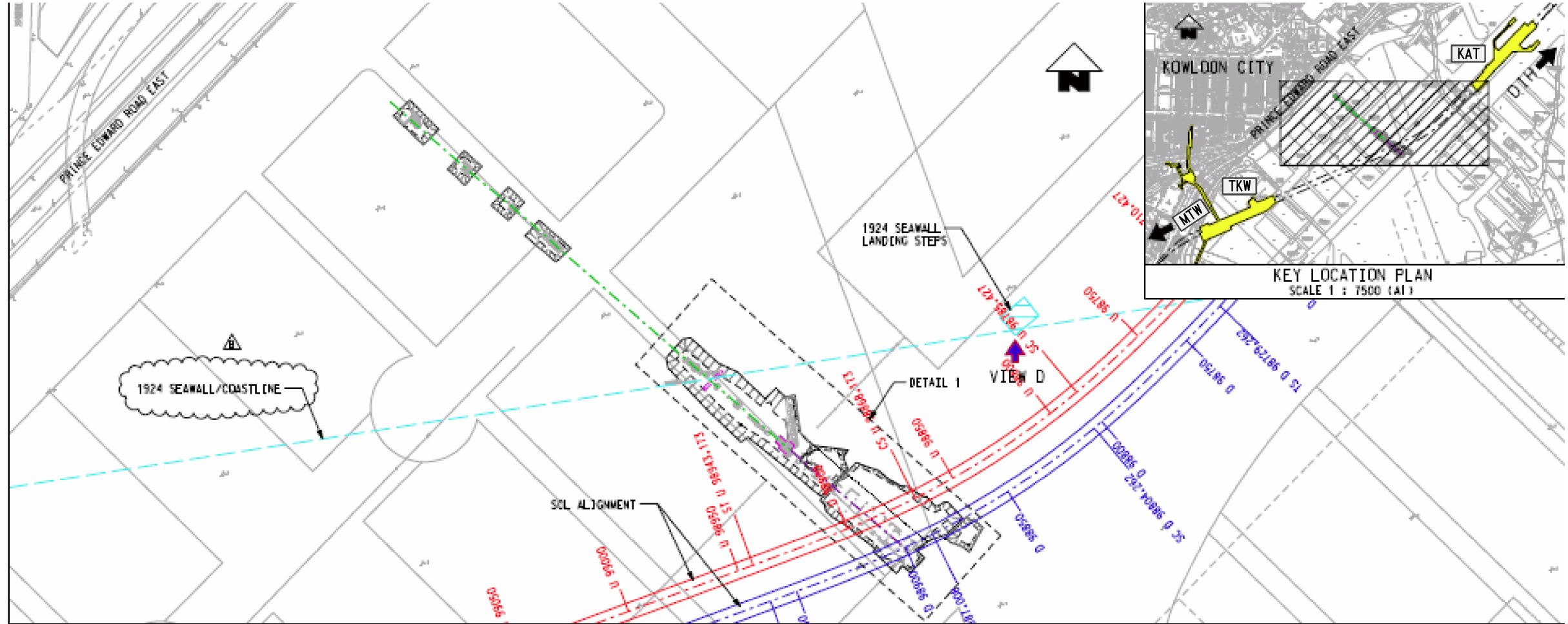

LEGEND:

- LUNG TSUN STONE BRIDGE
- FORMER KOWLOON CITY PIER
- 1924 SEAWALL/COASTLINE

○ Concrete Pillars successfully tested on 4 Nov 2010

#PLOTDRVL\$ #MODELS\$ #FILES\$
 #REV\$ #DATE\$ #TIMES\$
 #USER\$ #DATE\$ #TIMES\$
 #PLOTDRVL\$ #MODELS\$ #FILES\$

REV	DESCRIPTION	BY	DATE	APPROVED
A	FIRST ISSUE	LK	02/11	FC

DRAWN	LK
DESIGNED	LK
CHECKED	SC
APPROVED	FC
DATE	02/11

SHATIN TO CENTRAL LINK

ARUP Ove Arup & Partners
 Hong Kong Limited

DO NOT SCALE DRAWINGS. ALL DIMENSIONS SHALL BE VERIFIED ON SITE.
 © MTR CORPORATION LIMITED 2008. COPYRIGHT IN RESPECT OF THIS DRAWING / DOCUMENT IS OWNED BY THE MTR CORPORATION LIMITED OF HONG KONG. NO REPRODUCTION OF THE DRAWING / DOCUMENT OR ANY PART BY WHATEVER MEANS IS PERMITTED WITHOUT THE PRIOR WRITTEN CONSENT OF THE MTR CORPORATION LIMITED.

CADD REF. NEX2206_C_SCL_OAP_ENV_015B

TITLE
 NEX 2206 – TAW TO HUH SECTION
 Interface between Lung Tsun Stone Bridge
 and Tunnel Alignment Layout Plan

SCALE N.T.S. DRAWING NO. Figure 4.1.2A REV. A