

MATCH LINE
FOR CONTINUATION
SEE DWG FIG. 6.8.16

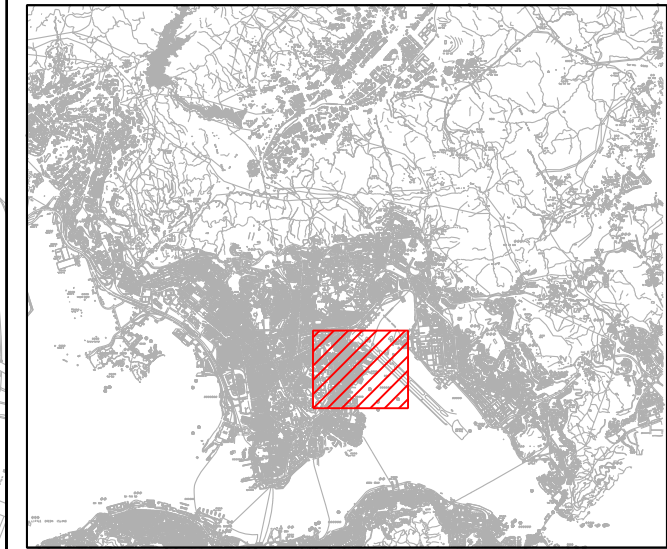
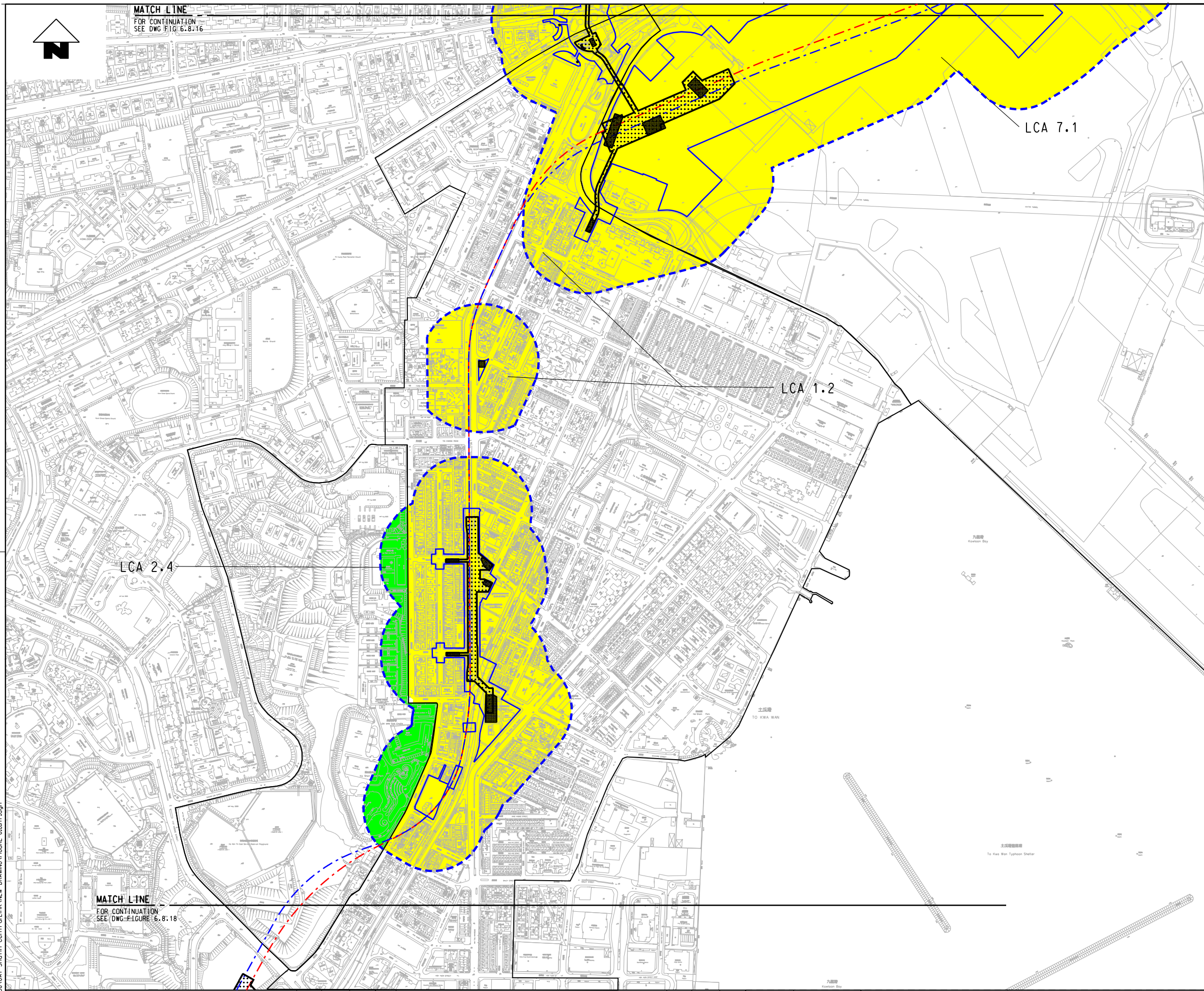

KEY PLAN

LEGEND:		IMPACT SIGNIFICANCE:	
	LANDSCAPE IMPACT STUDY BOUNDARY (100M FROM WORKS AREA)		INSUBSTANTIAL
	PROPOSED WORKS SITE		SLIGHT
	SCL ALIGNMENT		MODERATE
	PROPOSED STATION (UNDERGROUND)		SUBSTANTIAL
	PROPOSED ABOVE GROUND STRUCTURE		

LANDSCAPE CHARACTER

- LCA1.2 - To Kwa Wan Urban Area (Mixed Urban Landscape)
- LCA2.4 - Ho Man Tin Urban Fringe (Urban Fringe Landscape)
- LCA7.1 - South East Kowloon On-going Development (Ongoing Major Development Landscape)

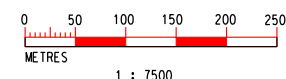

PLOT DRW: K:\Microstation Standard\Printer Driver\A3 COLOUR.ppt
 MODELNAME: K:\Project\HK PROJ\047 Shatin CentralLink\NEW DRAWING\FIGURE 6.8.17F.dgn
 FILENAME: K:\Project\HK PROJ\047 Shatin CentralLink\NEW DRAWING\FIGURE 6.8.17F.dgn
 PRINTED BY: designer3 2011/3/21 14:03:33
 Standard\Printer Driver\A3 COLOUR.ppt

MATCH LINE
FOR CONTINUATION
SEE DWG FIGURE 6.8.18

DRAWN	CC
DESIGNED	EL
CHECKED	ALC
APPROVED	KN
DATE	25/MAR/2011

SHATIN TO CENTRAL LINK
 ORIGINATOR

 Ove Arup & Partners
 Hong Kong Limited
 CADD REF. FIGURE 6.8.17F.DGN

TITLE		NEX 2206 - TAW TO HUH SECTION LANDSCAPE AND VISUAL IMPACT ASSESSMENT RESIDUAL LANDSCAPE CHARACTER IMPACT IN CONSTRUCTION PHASE TO KWA WAN STATION, MA TAU WAI STATION AND TAM KUNG ROAD EEP	
SCALE	DRAWING NO.	REV.	
1 : 7500 (A1)	FIGURE 6.8.17	F	