

LEGEND:

- 300m NOISE STUDY BOUNDARY
- PROPOSED TKO-LTT ALIGNMENT
- OM4
- TRAFFIC NOISE MONITORING STATION

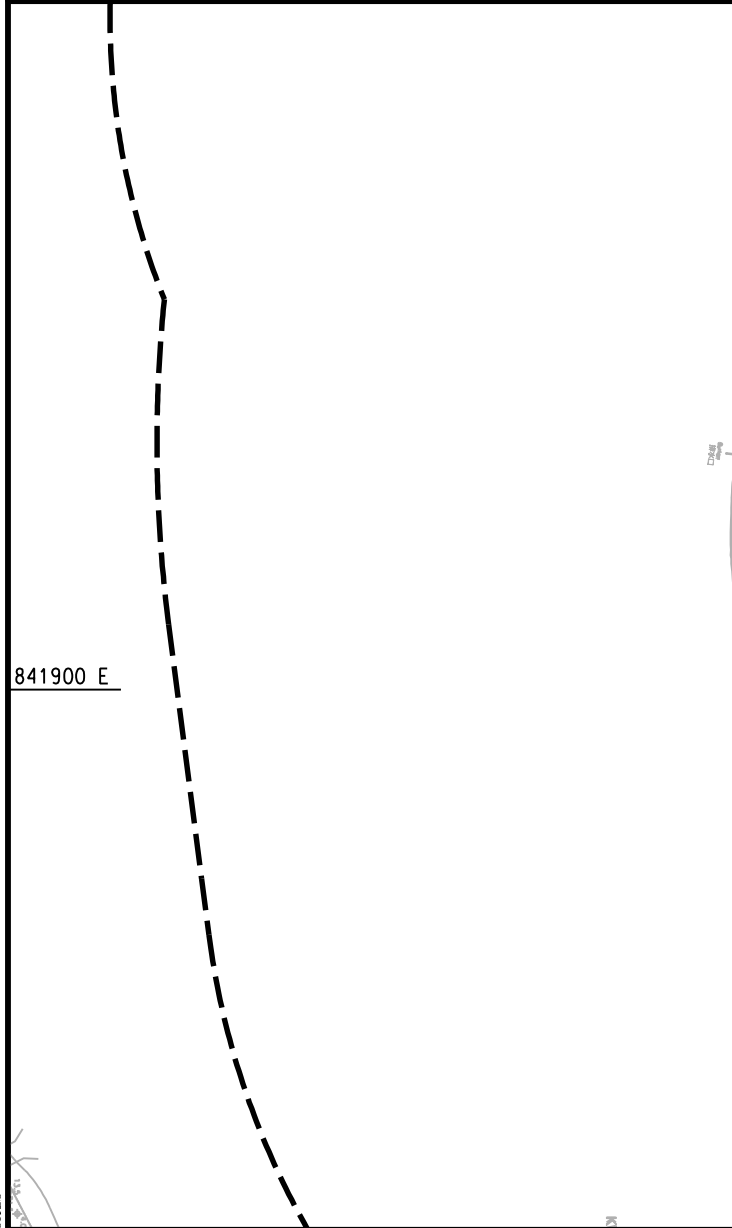

AGREEMENT NO. CE 42/2008 (CE)
TSEUNG KWAN O - LAM TIN TUNNEL AND ASSOCIATED WORKS - INVESTIGATION
LOCATIONS OF TRAFFIC NOISE MONITORING STATIONS

SCALE	A3 1 : 3000	DATE	NOV. 2012
CHECK	--	DRAWN	HLL
JOB No.	60097677	DRAWING No.	FIGURE 3.2a
		REV	-

Plot File by : 1/22/2013 QIUAM

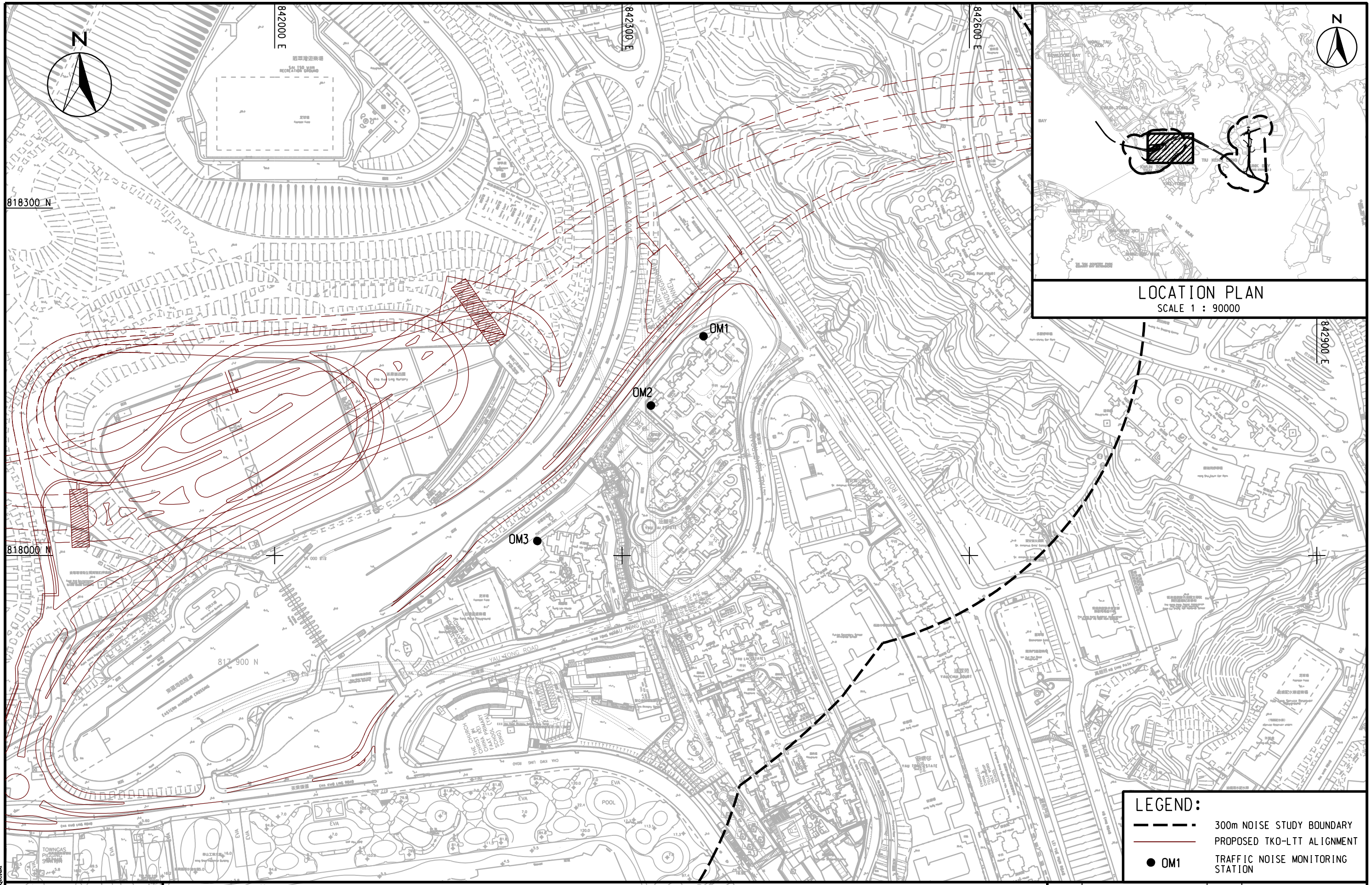

LEGEND:

- 300m NOISE STUDY BOUNDARY
- PROPOSED TKO-LTT ALIGNMENT
- OM1 TRAFFIC NOISE MONITORING STATION



AGREEMENT NO. CE 42/2008 (CE)
 TSEUNG KWAN O - LAM TIN TUNNEL AND ASSOCIATED WORKS - INVESTIGATION
LOCATIONS OF TRAFFIC NOISE MONITORING STATIONS

SCALE	A3 1 : 3000	DATE	NOV. 2012
CHECK	--	DRAWN	HLL
JOB No.	60097677	DRAWING No.	FIGURE 3.2b
		REV	-

Plot File by : 1122/2013 Q10VAM

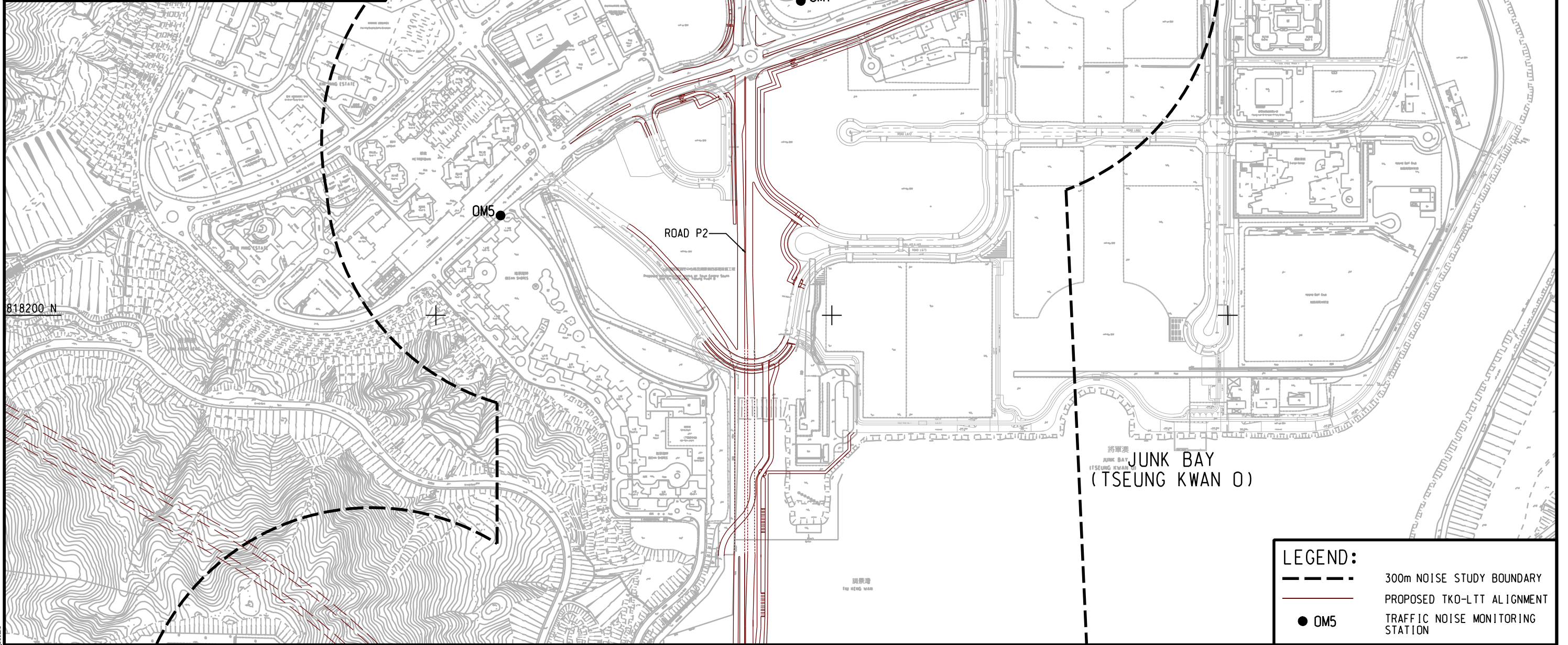
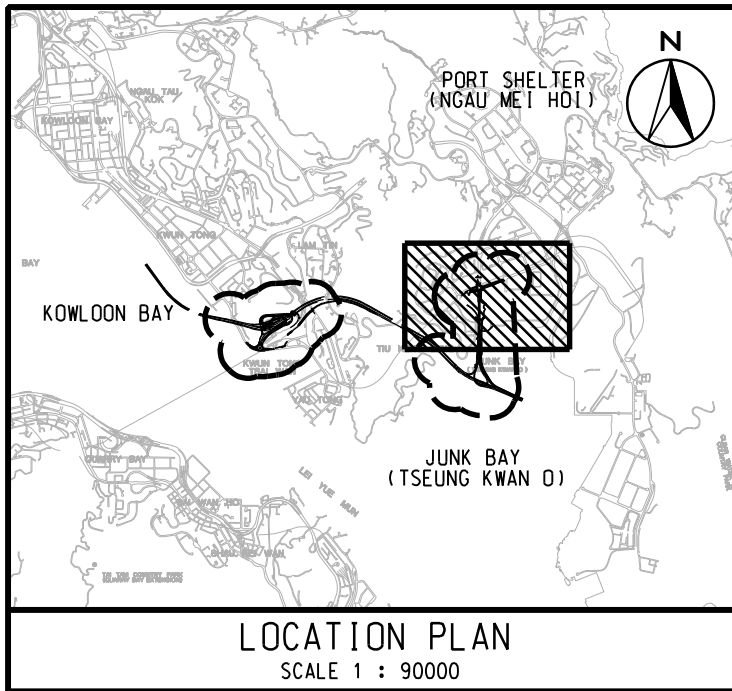

LEGEND:

- 300m NOISE STUDY BOUNDARY
- PROPOSED TKO-LTT ALIGNMENT
- OM5
TRAFFIC NOISE MONITORING STATION

Plot File by: 1/22/2013 QTCAM



AGREEMENT NO. CE 42/2008 (CE)
TSEUNG KWAN O - LAM TIN TUNNEL AND ASSOCIATED WORKS - INVESTIGATION

LOCATIONS OF TRAFFIC NOISE MONITORING STATIONS

SCALE	A3 1 : 5000	DATE	NOV. 2011
CHECK	--	DRAWN	HLL
JOB No.	60097677	DRAWING No.	FIGURE 3.2c
		REV	-