

Pld File by: ANHL
 PATH: P:\projects\60222570\drawing\center\0a1TR19A_042.dgn
 ISO A1 594mm x 841mm
 Approved:
 Checked:
 Designer:
 Project Management Initials:

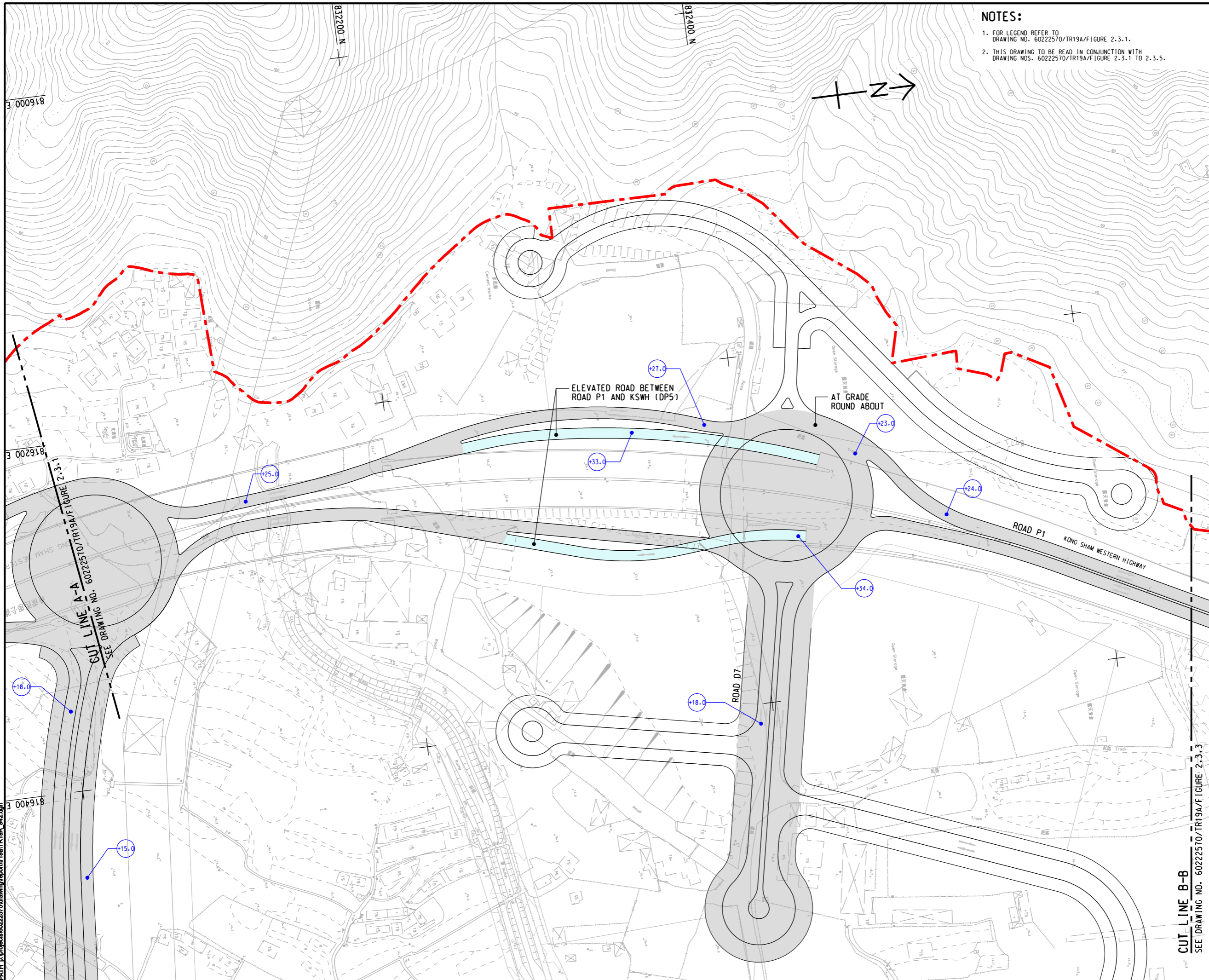

- NOTES:**
1. FOR LEGEND REFER TO DRAWING NO. 60222570/TR19A/FIGURE 2.3.1.
 2. THIS DRAWING TO BE READ IN CONJUNCTION WITH DRAWING NOS. 60222570/TR19A/FIGURE 2.3.1 TO 2.3.5.

AECOM

PROJECT
 項目
HUNG SHUI KIU NEW DEVELOPMENT AREA PLANNING AND ENGINEERING STUDY - INVESTIGATION

CLIENT
 業主
CEDD
 土木工程拓展署
 Civil Engineering and Development Department

CONSULTANT
 工程顧問公司
AECOM Asia Company Ltd.
 www.aecom.com

SUB-CONSULTANTS
 分判工程顧問公司
Planning Department

ISSUE/REVISION
 修訂

IR	DATE	DESCRIPTION	CHK
修訂	日期	內容描述	校核

STATUS
 階段

SCALE
 比例
 A3 1:2000

DIMENSION UNIT
 尺寸單位
 METRES

KEY PLAN A3 1:20000

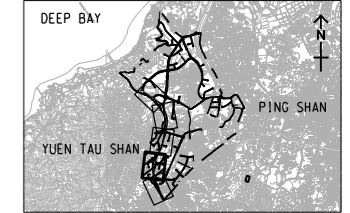

PROJECT NO.
 項目編號
 60222570

AGREEMENT NO.
 協議編號
 CE2/2011 (CE)

SHEET TITLE
 圖紙名稱
GENERAL LAYOUT OF NEW DISTRIBUTOR ROAD (ROAD P1)

SHEET NUMBER
 圖紙編號
 60222570/TR19A/FIGURE 2.3.2

SHEET 2 OF 5

CUT LINE B-B
 SEE DRAWING NO. 60222570/TR19A/FIGURE 2.3.3

This drawing has been prepared for the use of AECOM's client. It may not be used, modified, reproduced or relied upon by third parties, except as agreed by AECOM or as required by law. AECOM accepts no responsibility, and denies any liability whatsoever, for any party that uses or relies on this drawing without AECOM's express written consent. Do not scale this document. All measurements must be obtained from the stated dimensions.