

Pld File by: zengfx
 PATH: E:\projects\60222570\drawing\center\0a\TR19A_902.dgn
 Project Management Initials: Designer: Checked: Approved: ISO A1 594mm x 841mm

NOTES:

- FOR LEGEND REFER TO DRAWING NO. 60222570/TR19A/FIGURE 4.4.32.
- THIS DRAWING TO BE READ IN CONJUNCTION WITH DRAWING NOS. 60222570/TR19A/FIGURE 4.4.32 AND 4.4.33.

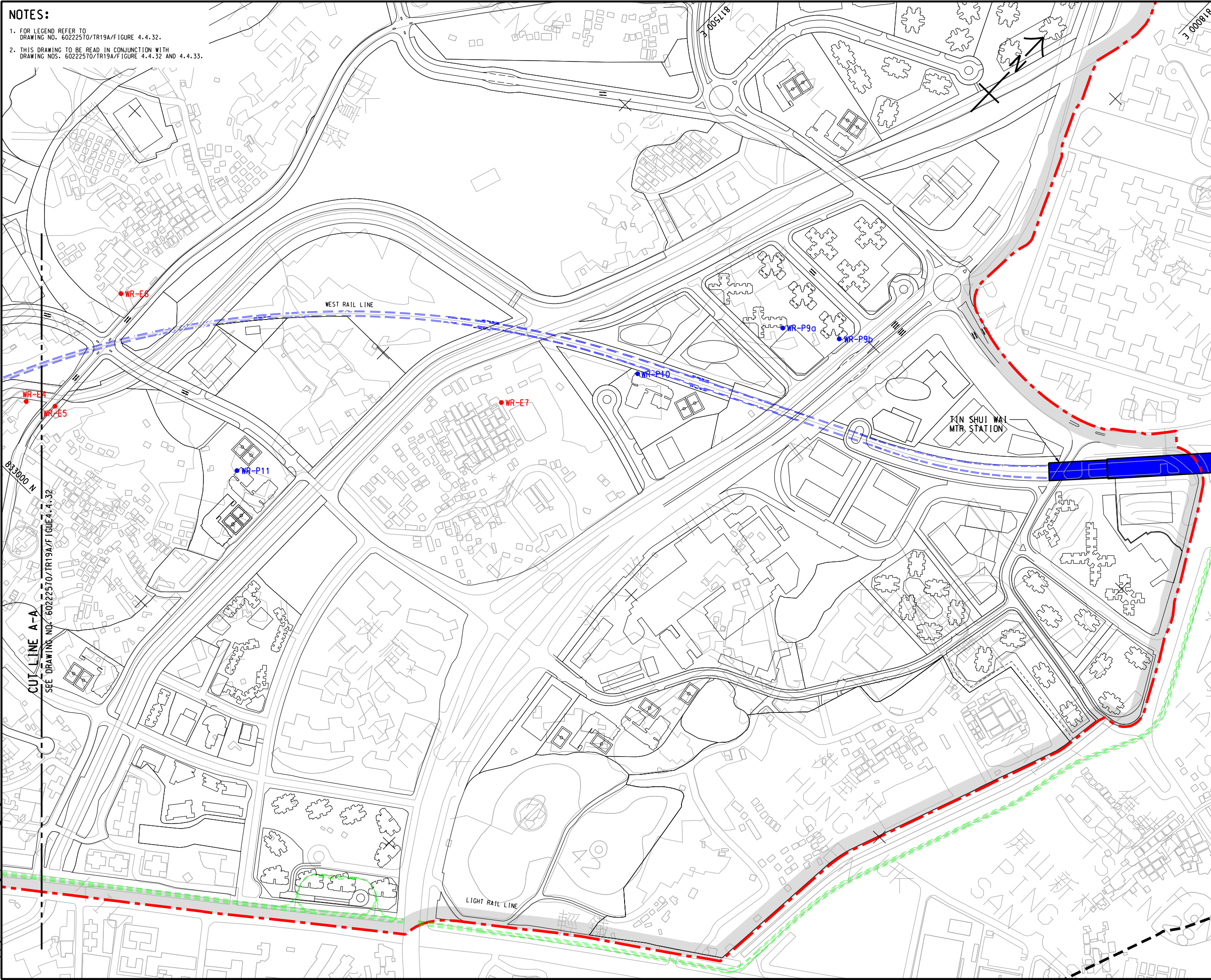

AECOM

PROJECT
 HUNG SHUI KIU NEW DEVELOPMENT AREA
 PLANNING AND
 ENGINEERING STUDY
 - INVESTIGATION

CLIENT
 業主

CEDD
 土木工程拓展署
 Civil Engineering and
 Development Department

Planning Department

CONSULTANT
 工程顧問公司

AECOM Asia Company Ltd.
 www.aecom.com

SUB-CONSULTANTS
 分判工程顧問公司

ISSUE/REVISION
 修訂

IR	DATE	DESCRIPTION	CHK

STATUS
 圖況

SCALE
 比例

A3 1 : 5000

KEY PLAN A3 1 : 300000

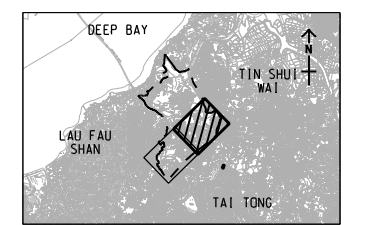

PROJECT NO.
 項目編號

60222570

AGREEMENT NO.
 協議編號

CE2/2011 (CE)

SHEET TITLE
 圖名

LOCATIONS OF REPRESENTATIVE
 NOISE SENSITIVE RECEIVERS FOR
 RAIL NOISE (WEST RAIL)

SHEET 2 OF 2

SHEET NUMBER
 圖號

60222570/TR19A/FIGURE 4.4.33

This drawing has been prepared for the use of AECOM's client. It may not be used, modified, reproduced or relied upon by third parties, except as agreed by AECOM or as required by law. AECOM accepts no responsibility, and denies any liability whatsoever, for any party that uses or relies on this drawing without AECOM's express written consent. Do not scale this document. All measurements must be obtained from the related dimensions.