

Pld File by: zhaocit  
 PATH: E:\projects\60222570\drawing\paper\ca\TR19A\_466.dgn  
 Project Management Initials: Designer: Checked: Approved: ISO A1 594mm x 841mm

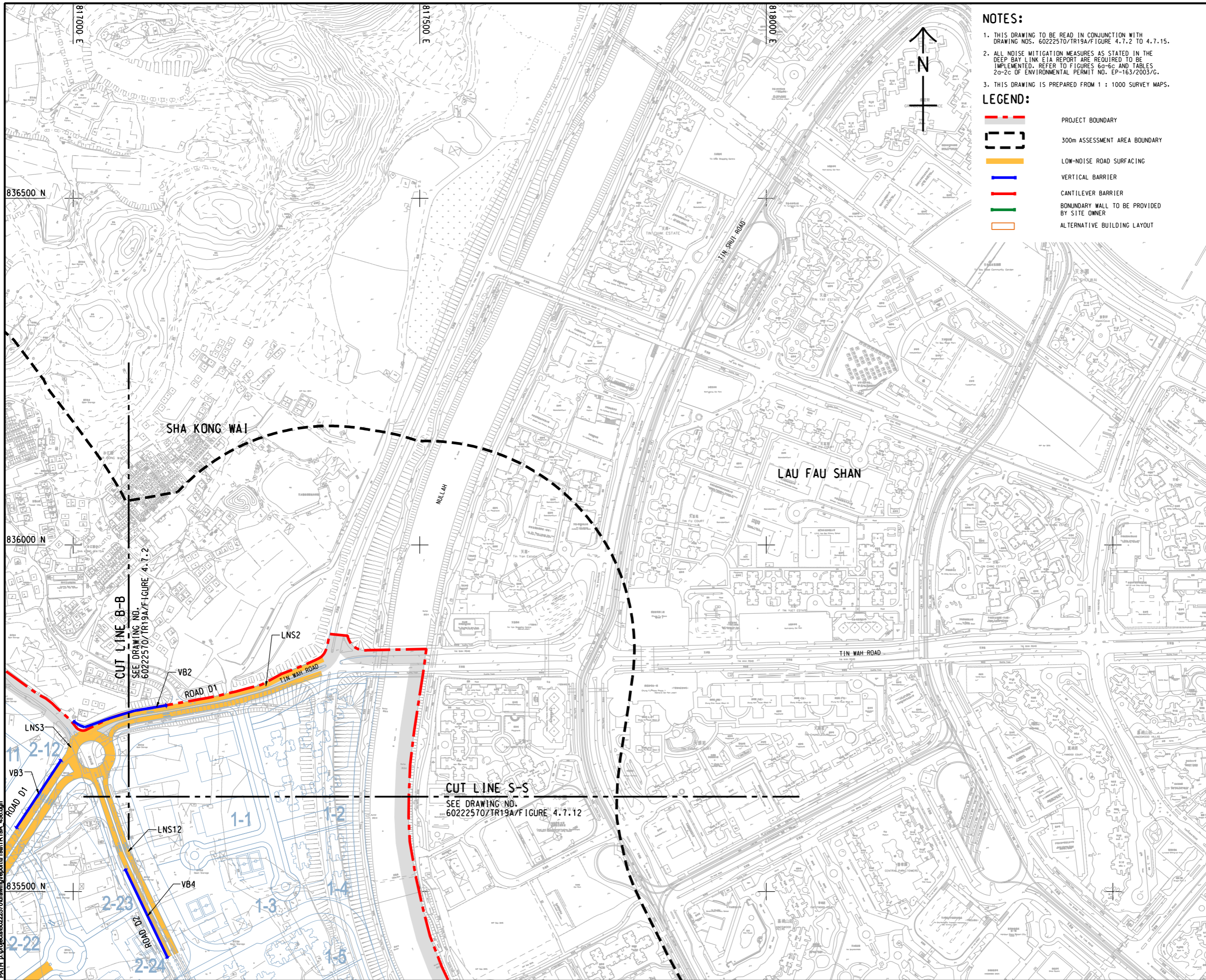

**NOTES:**

1. THIS DRAWING TO BE READ IN CONJUNCTION WITH DRAWING NOS. 60222570/TR19A/FIGURE 4.7.2 TO 4.7.15.
2. ALL NOISE MITIGATION MEASURES AS STATED IN THE DEEP BAY LINK EIA REPORT ARE REQUIRED TO BE IMPLEMENTED. REFER TO FIGURES 6a-6c AND TABLES 2a-2c OF ENVIRONMENTAL PERMIT NO. EP-163/2003/G.
3. THIS DRAWING IS PREPARED FROM 1 : 1000 SURVEY MAPS.

**LEGEND:**

- PROJECT BOUNDARY
- 300m ASSESSMENT AREA BOUNDARY
- LOW-NOISE ROAD SURFACING
- VERTICAL BARRIER
- CANTILEVER BARRIER
- BOUNDARY WALL TO BE PROVIDED BY SITE OWNER
- ALTERNATIVE BUILDING LAYOUT



**PROJECT**

**HUNG SHUI KIU NEW DEVELOPMENT AREA PLANNING AND ENGINEERING STUDY - INVESTIGATION**

**CLIENT**



**CONSULTANT**

AECOM Asia Company Ltd.  
www.aecom.com

**SUB-CONSULTANTS**

分列工程顧問公司

**ISSUE/REVISION**

IR	DATE	DESCRIPTION	CHK

**STATUS**

**SCALE**

A3 1 : 5000

**DIMENSION UNIT**

METRES

**KEY PLAN** A3 1 : 300000

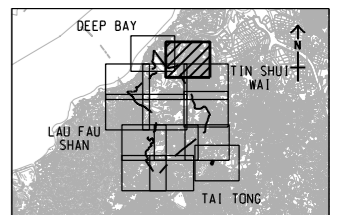

**PROJECT NO.**

60222570

**AGREEMENT NO.**

CE2/2011 (CE)

**SHEET TITLE**

LOCATIONS OF PROPOSED ROAD TRAFFIC NOISE MITIGATION MEASURES

SHEET 6 OF 14

**SHEET NUMBER**

60222570/TR19A/FIGURE 4.7.7

This drawing has been prepared for the use of AECOM's client. It may not be used, modified, reproduced or relied upon by third parties, except as required by law. AECOM accepts no responsibility, and denies any liability whatsoever, to any party that uses or relies on this drawing without AECOM's express written consent. Do not scale this document. All measurements must be obtained from the related dimensions.