

24-hour RSP Criterion: 100 $\mu\text{g}/\text{m}^3$

ARUP

Proposed Comprehensive Residential and Commercial Development atop Siu Ho Wan Depot
 CONTOURS OF CUMULATIVE 10TH HIGHEST 24-HOUR RSP CONCENTRATION AT 1.5m ABOVE GROUND
 (OPERATIONAL PHASE)



SCALE:	AS SHOWN	FIGURE No.
DATE:	MAY 2017	3.10a

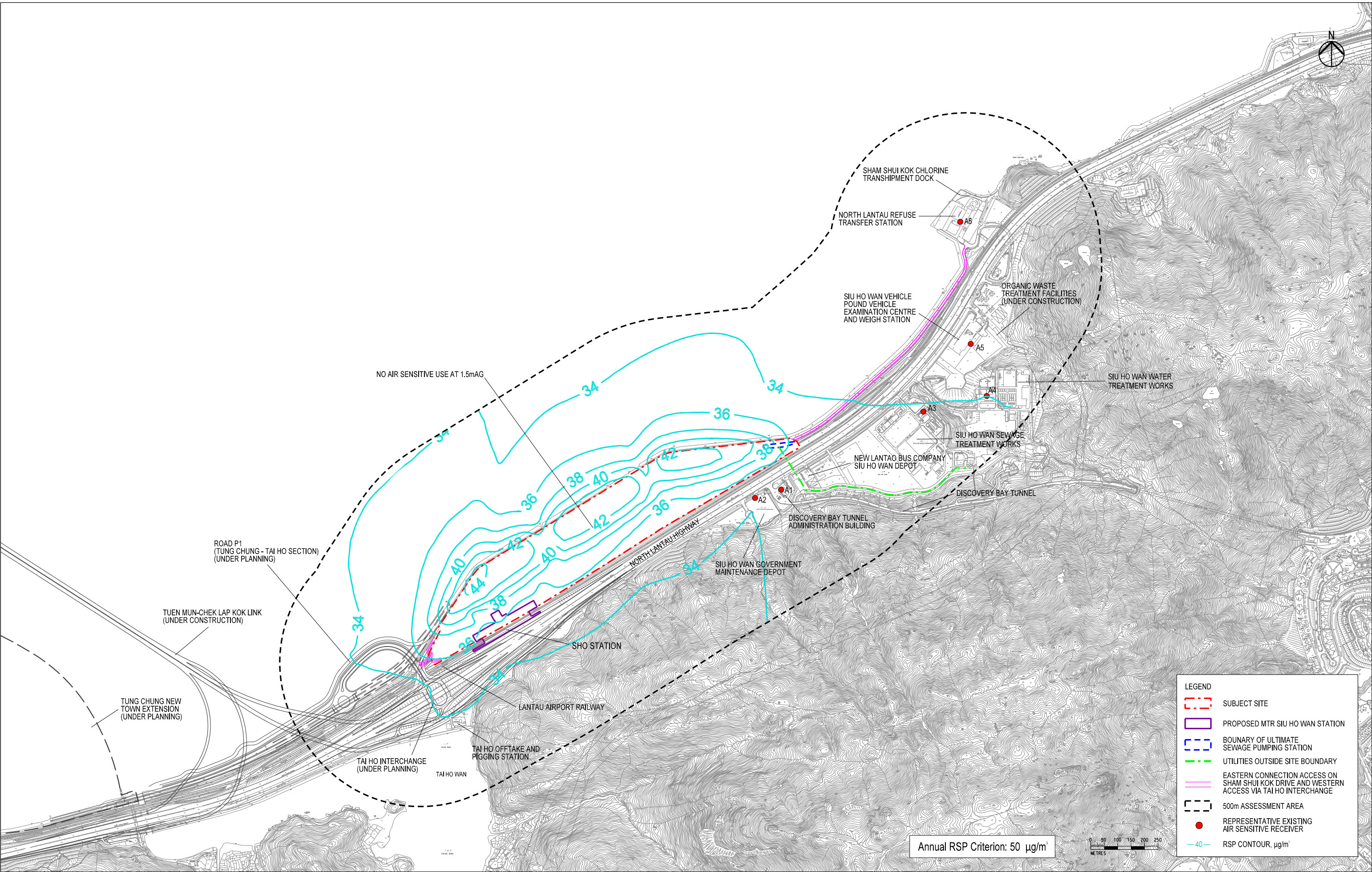

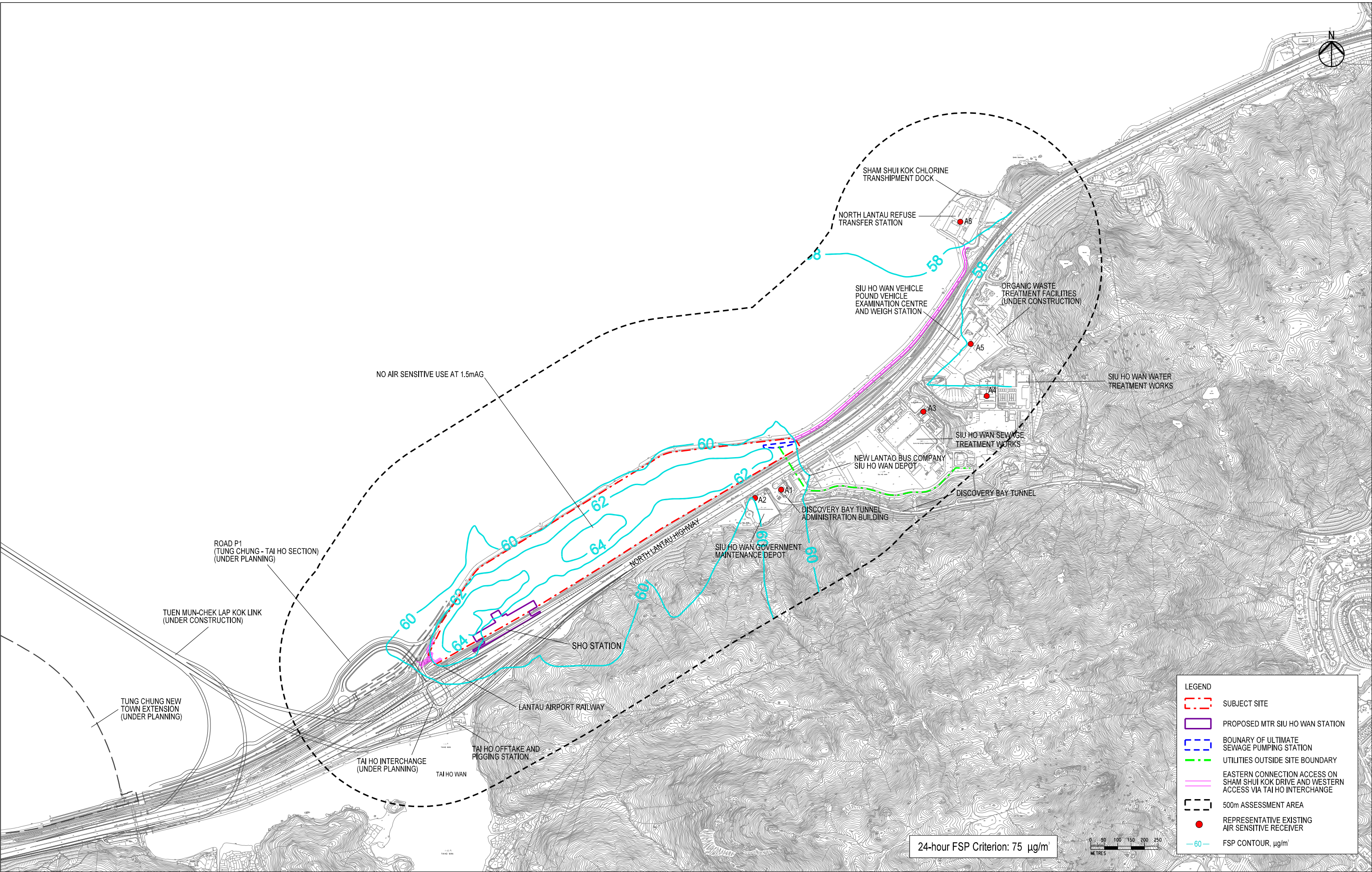

Proposed Comprehensive Residential and Commercial Development atop Siu Ho Wan Depot
 CONTOURS OF CUMULATIVE 10TH HIGHEST 24-HOUR FSP CONCENTRATION AT 1.5m ABOVE GROUND
 (OPERATIONAL PHASE)

ARUP



SCALE:	AS SHOWN	FIGURE No.
DATE:	MAY 2017	3.11a

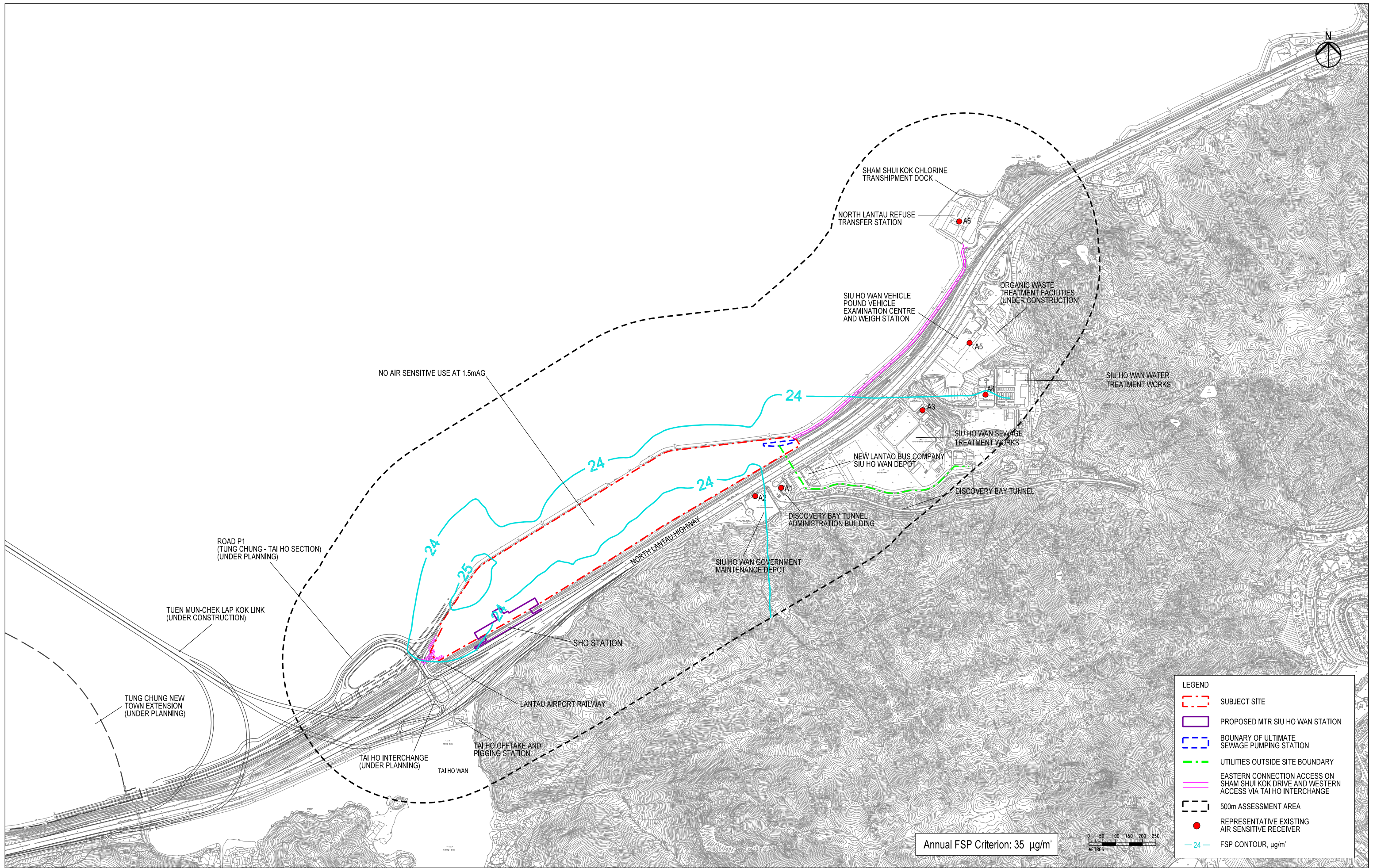

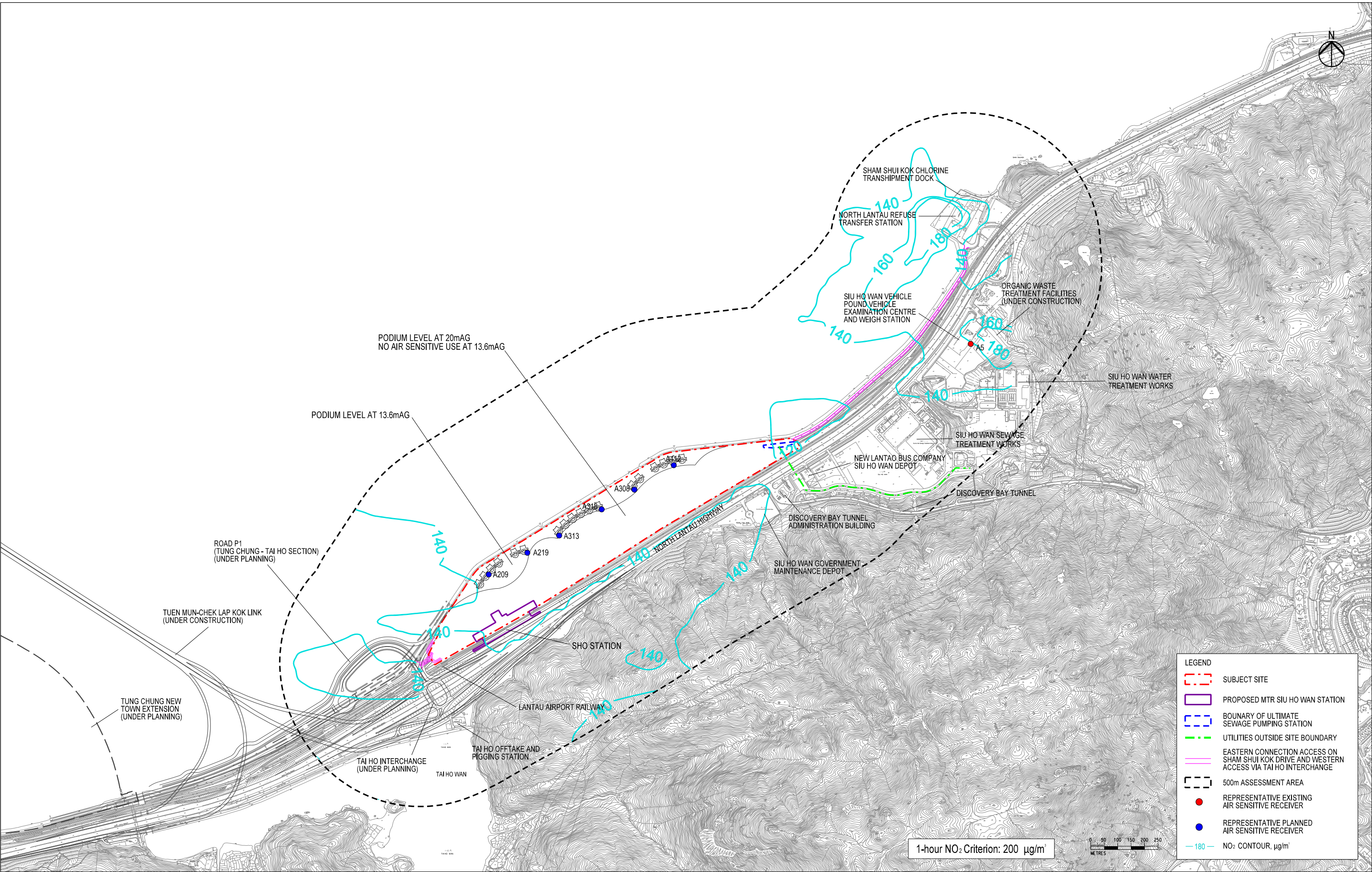

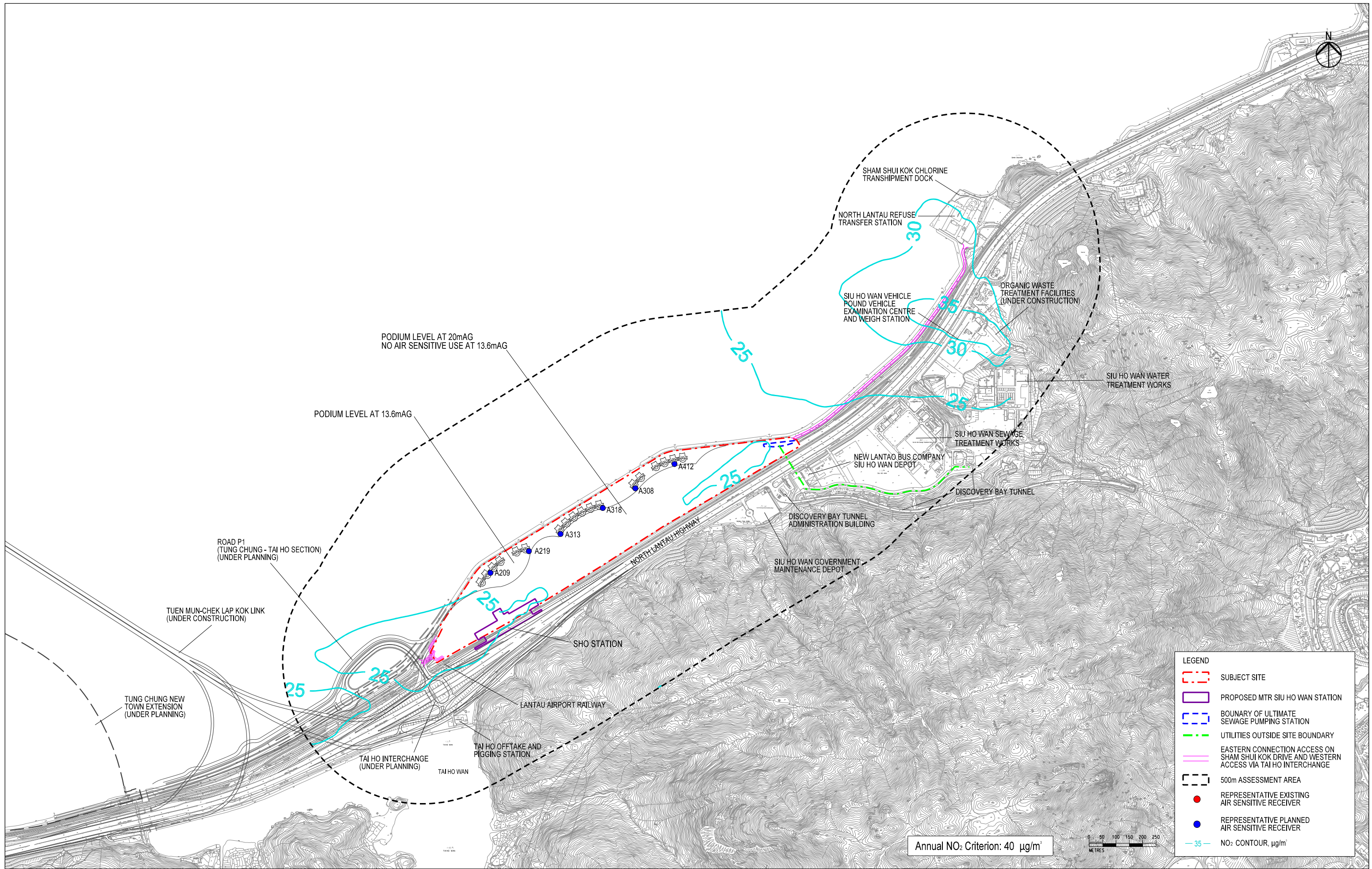

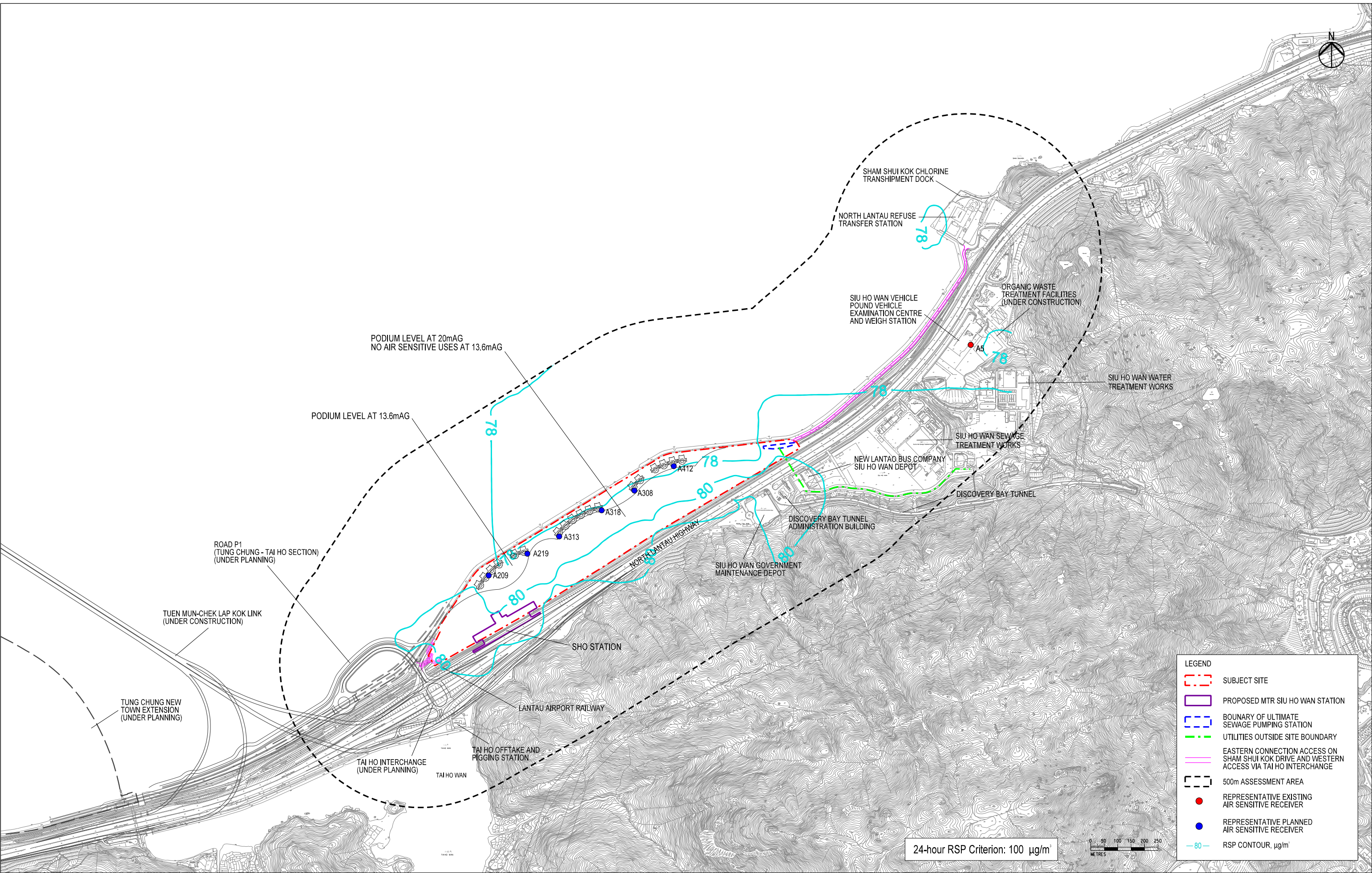

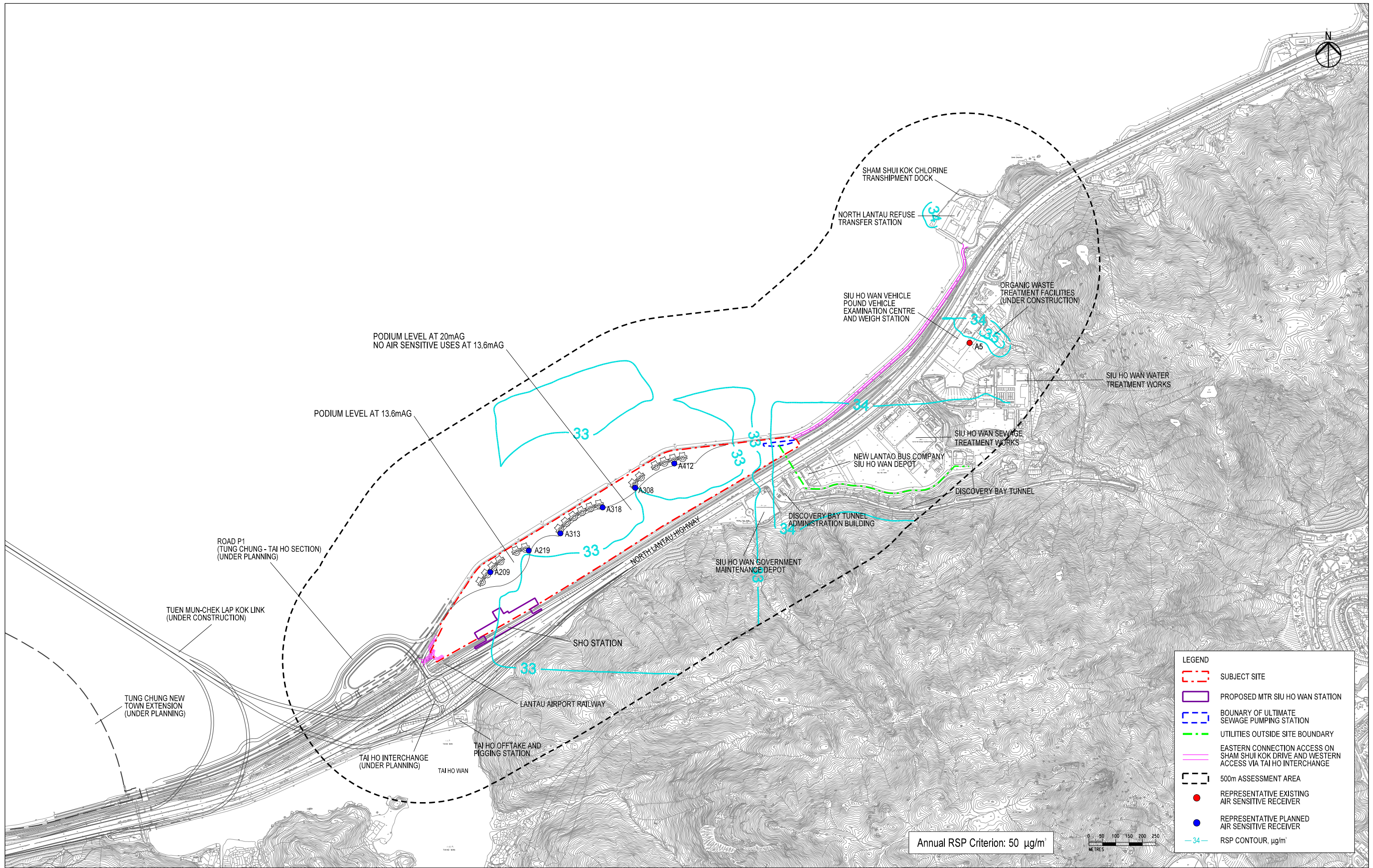

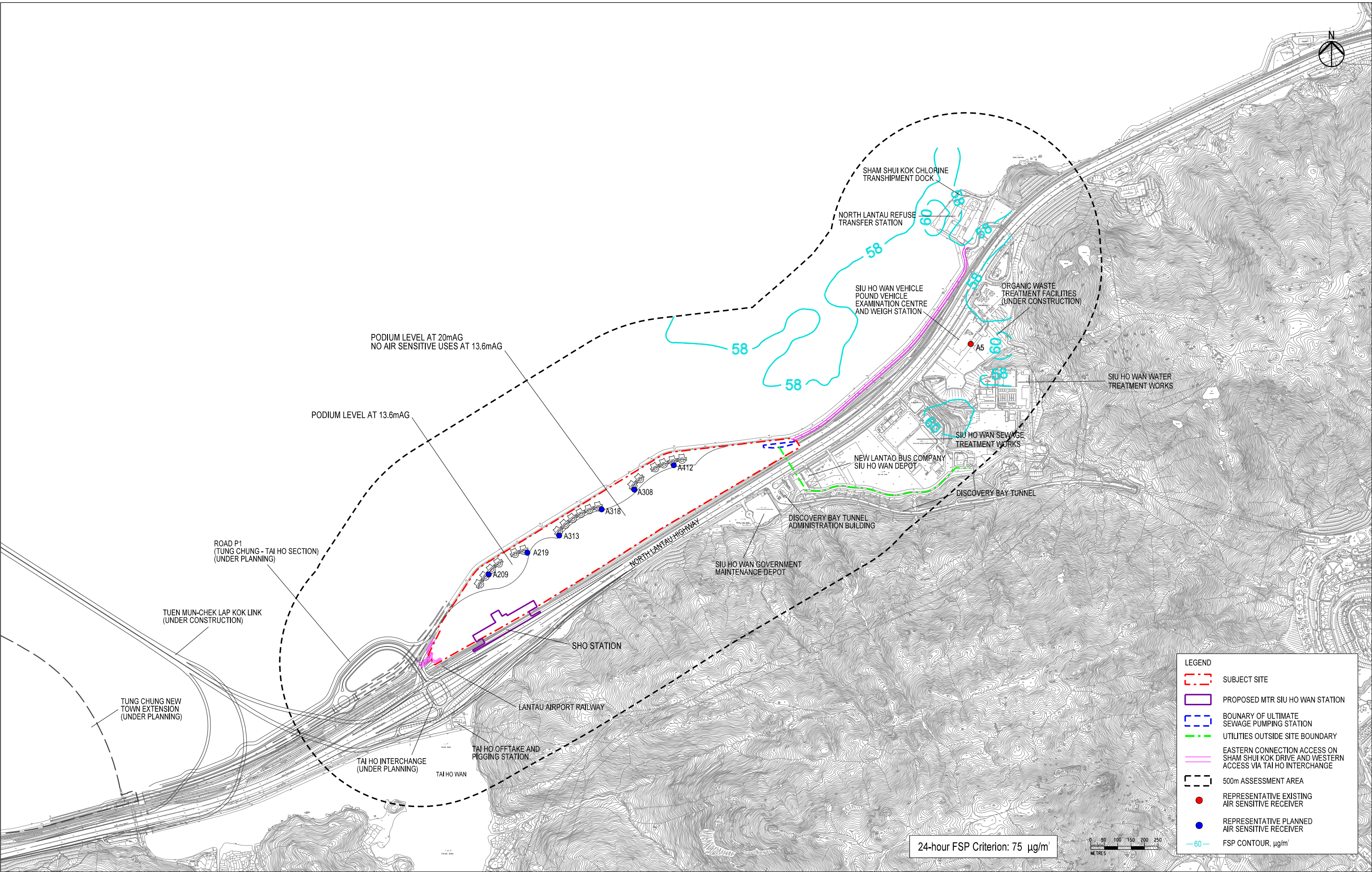

LEGEND

- SUBJECT SITE
- PROPOSED MTR SIU HO WAN STATION
- BOUNDARY OF ULTIMATE SEWAGE PUMPING STATION
- UTILITIES OUTSIDE SITE BOUNDARY
- EASTERN CONNECTION ACCESS ON SHAM SHUI KOK DRIVE AND WESTERN ACCESS VIA TAI HO INTERCHANGE
- 500m ASSESSMENT AREA
- REPRESENTATIVE EXISTING AIR SENSITIVE RECEIVER
- REPRESENTATIVE PLANNED AIR SENSITIVE RECEIVER
- FSP CONTOUR, $\mu\text{g}/\text{m}^3$

