

Printed by : 7/26/2017
 Filename : \\HKGNTS22\acoustic\env\project\228228\13 Drawing Deliverables\Report\Stage 3 EIA Report\Final\Ch 3 - Project Description and Construction Methodologies\Figure 3.1c - Recommended Outline Development Plan (Sheet 4 of 4)

DO NOT SCALE DRAWING. CHECK ALL DIMENSIONS ON SITE.
 ALL RIGHTS RESERVED.
 © DVE ARUP & PARTNERS HONG KONG LIMITED.

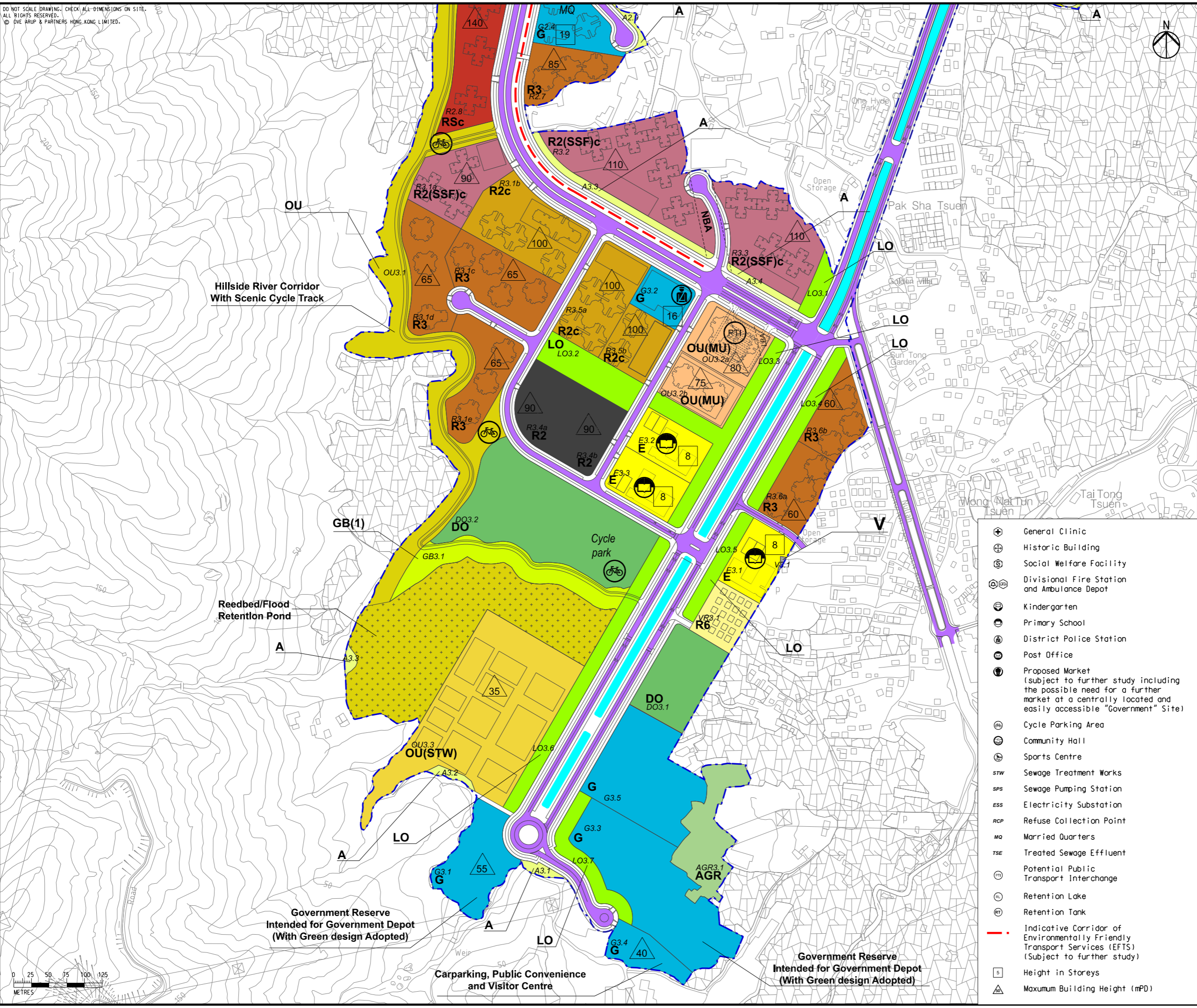

- Legend**
- Development Area
 - Land Use Zoning
 - Special Residential - Public Rental Housing (with commercial) (RSc)
 - Residential - Zone 1 (Subsidised Sale Flats) (with commercial) (R1(SSF)c)
 - Residential - Zone 1 (with commercial) (R1c)
 - Residential - Zone 2 (Subsidised Sale Flats) (with commercial) (R2(SSF)c)
 - Residential - Zone 2 (with commercial) (R2c)
 - Residential - Zone 2 (R2)
 - Residential - Zone 3 (R3)
 - Residential - Zone 4 (R4)
 - Residential - Zone 5 (R5)
 - Residential - Zone 5 (Existing Development Area) (R5(EDA))
 - Residential - Zone 6 (R6)
 - Village Type Development (V)
 - Other Specified Uses (Storage Use) 1 (OU(SU)1)
 - Other Specified Uses (Storage Use) 2 (OU(SU)2)
 - Other Specified Uses (Storage and Workshop) (OU(S+W))
 - Other Specified Uses (Open Storage) (OU(OS))
 - Other Specified Uses (Sewage Treatment Works) (OU(STW))
 - Other Specified Uses (Refuse Collection Point and Sewage Pumping Station) (OU(RCP&SPS))
 - Other Specified Uses (Electricity Substation) (OU(ESS))
 - Other Specified Uses (Service Reservoir) (OU(Service Reservoir))
 - Other Specified Uses (Mixed Use) (OU(MU))
 - Other Specified Uses (Retention Tank)
 - Other Specified Uses (Hillside River Corridor with Scenic Cycle Track)
 - Government (G)
 - Institution or Community (IC)
 - Education (E)
 - District Open Space (DO)
 - Local Open Space (LO)
 - Local Open Space (1) (LO(1))
 - Amenity (A)
 - Agriculture (AGR)
 - Green Belt (GB)
 - Green Belt (1) (GB(1))
 - River Channels
 - Road

- General Clinic
- Historic Building
- Social Welfare Facility
- Divisional Fire Station and Ambulance Depot
- Kindergarten
- Primary School
- District Police Station
- Post Office
- Proposed Market (subject to further study including the possible need for a further market at a centrally located and easily accessible "Government" Site)
- Cycle Parking Area
- Community Hall
- Sports Centre
- Sewage Treatment Works
- Sewage Pumping Station
- Electricity Substation
- Refuse Collection Point
- Married Quarters
- Treated Sewage Effluent
- Potential Public Transport Interchange
- Retention Lake
- Retention Tank
- Indicative Corridor of Environmentally Friendly Transport Services (EFTS) (Subject to further study)
- Height in Storeys
- Maximum Building Height (mPD)

B	THIRD ISSUE	GL	07/17
B	SECOND ISSUE	GL	05/17
A	FIRST ISSUE	GL	02/17
Rev	Description	By	Date

Consultant
ARUP

Contract No. and Title
 Agreement No. CE 35/2012(CE)
 Planning and Engineering Study for Housing Sites in Yuen Long South - Investigation

Drawing title
 Recommended Outline Development Plan (Sheet 4 of 4)

Drawing no. Figure 3.1c		Rev. C	
Drawn GL	Date 07/17	Checked FC	Approved FC
Scale 1:5000 @A3		Status PRELIMINARY	

COPYRIGHT RESERVED

土木工程拓展署
Civil Engineering and Development Department

規劃署
Planning Department