

Borehole ID	Co-ordinates	
	Easting	Northing
PBH7	837924.57	819964.23
EBH1	837931.64	819957.16
EBH2	837964.11	819943.07
EBH3	837967.50	819757.14

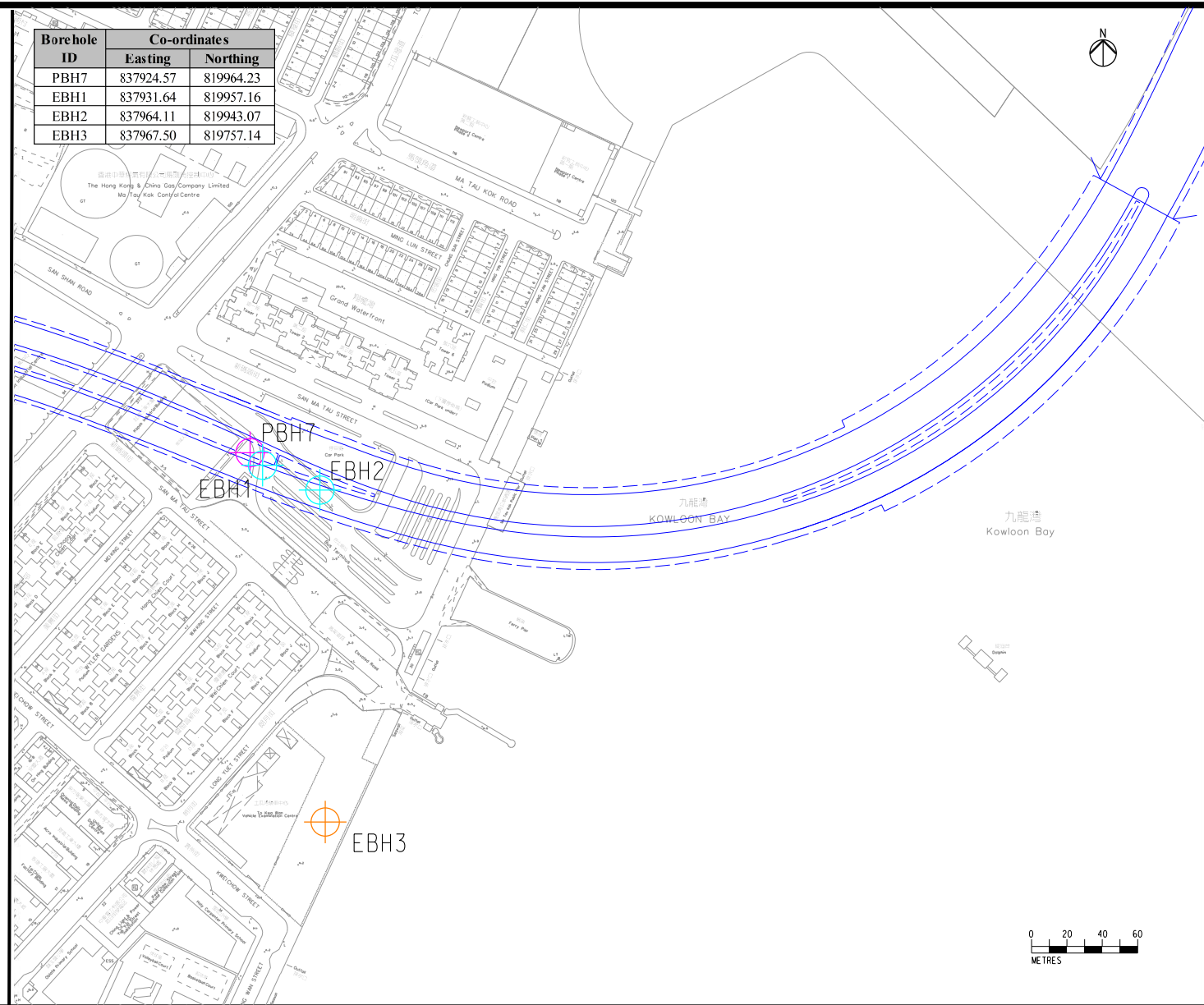

- Legend**
- PBH1** Borehole Locations of the SI Works Conducted in 2009 with RBRGs Exceedance
 - EBH1** Borehole Locations of the SI Works Conducted in 2011 & 2012 (Confirmatory Investigation)
 - EBH3** Borehole Locations for Additional Works Area

Project Title - Central Kowloon Route
 工程名稱 - 中九龍幹線

Environmental Permit No. : EP-457/2013
 環境許可證編號： EP-457/2013

Figure 3 – Location of Contaminated Borehole and Confirmatory Investigation (East Portion)
 圖 3 - 受污染鑽孔及確定研究的地點（東段）

