

- Key 圖例**
- Barging Point B3
趸船位置B3
 - 5m Vertical Barrier
5米高的垂直屏障
 - Enclosed Conveyor Belt System
封閉式輸送帶系統
 - Main Haul Road With Surface Wet At All Time
主要運輸道路路面保持濕潤
 - Stockpile Area Covered by No Less Than 50mm Thick Gravel (Except Haul Road)
不少於50毫米厚的礫石層覆蓋的區域(運輸道路除外)
 - Truckload Control Zone
車輛流量控制區
 - TMFB New Boundary
建議的屯門第38區填料庫範圍
 - Proposed Construction and Demolition Material Sorting Facility
擬建的拆建物料篩選分類設施

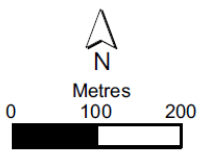
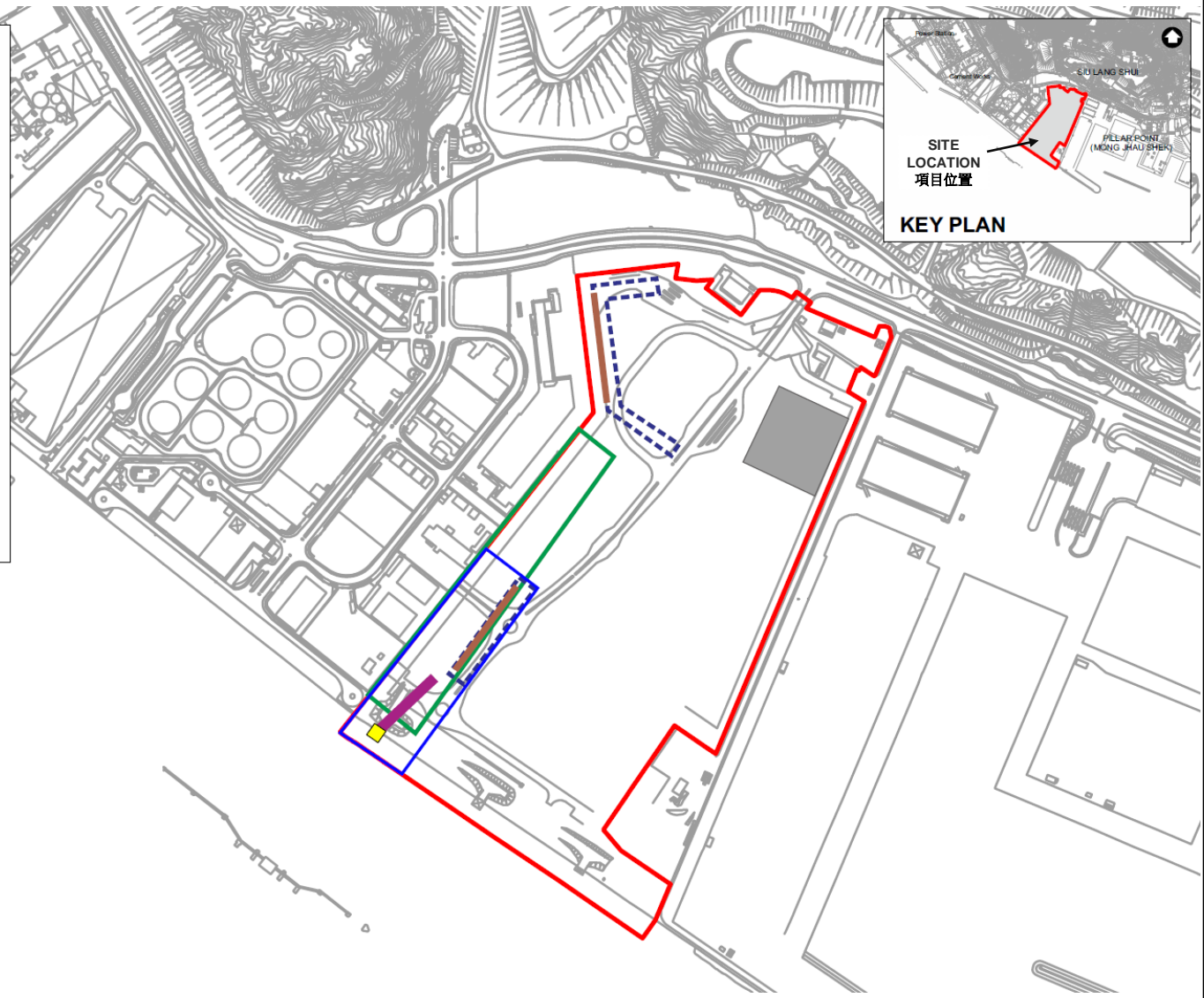

Expansion and Extension of Fill Bank at Tuen Mun Area 38 – Dust Control Mitigation Measures

屯門第38區填料庫擴展及延長運作期 – 減少塵埃控制措施

Environmental Permit No.: **EP-210/2005/C**
環境許可證編號：

Figure 2 圖 2

