

LEGEND

	FEATURE BOUNDARY
	PROPOSED CATCHPIT (STD. DRG. NO. C2405D)
	PROPOSED 300mm U-CHANNEL (STD. DRG. NO. C2409G)
	PROPOSED U-CHANNEL WITH UPSTAND (STD. DRG. NO. C2509)
	PROPOSED 300mm STEPPED CHANNEL (STD. DRG. NO. C2411E)
	PROPOSED SOIL NAIL ON HYDROSEDED SLOPE SURFACE (STD. DRG. NO. C2106/2D)
	PROPOSED HOARDING TYPE 1 (STD. DRG. NO. R1047)
	PROPOSED PLAIN TUBULAR RAILING (STD. DRG. NO. H2135B)
	PROPOSED SITE ENTRANCE
	PROPOSED LOCKABLE GATE (STD. DRG. NO. C2508)
	PROPOSED 600mm CONCRETE MAINTENANCE STAIRWAY (STD. DRG. C2101B)
	SECTION MARK
	THE FINAL SURFACE TO BE HYDROSEDED WITH EROSION CONTROL MAT (200mm THICK POLYAMIDE TYPE) AND WIRE MESH
	THE FINAL SURFACE TO BE HYDROSEDED WITH SHRUB MIX WITH EROSION CONTROL MAT (200mm THICK POLYAMIDE TYPE) AND WIRE MESH
	PROPOSED WORKS SITE

GENERAL REVISION		SOSL	Initial
No	Date	Description	
A	06/04		

REVISION		Name	Date
Designed	SOSL	SOSL	11/03
Drawn	TAN	TAN	11/03
Checked	KSL	KSL	11/03
Approved	HYN	HYN	11/03
Contract No.	GE/2004/11		
Figure No.	5.4 (REV. A)		11/03
Drawing Title			

**LANDSCAPING PROPOSAL PLAN
FOR FEATURE NO. 3SE-B/C67**

(SHEET 1 OF 2)

**GEOTECHNICAL ENGINEERING
OFFICE**

**CIVIL ENGINEERING
DEPARTMENT**

Mausnell
MAUSNELL ENVIRONMENTAL
MANAGEMENT CONSULTANTS LTD

PART PRINT OF SURVEY SHEET NO. :



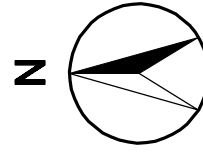

DISCHARGE TO THE EXISTING DRAINAGE SYSTEM

Code	Description	Height	Spread	Spacing	Quantity
SHRUB MIX					
20%	Rhodomyrtus tomentosa	Seeding shrub	1000mm	1000mm	567
20%	Ligustrum sinense	Seeding shrub	1000mm	1000mm	567
20%	Ardisia crispa	Seeding shrub	1000mm	1000mm	567
20%	Calliandra haematacephala	Seeding shrub	1000mm	1000mm	567
20%	Rhaphiolepis indica	Seeding shrub	1000mm	1000mm	567
Hydroseeding					3265m ²

Notes:
 1. Weeds, rubbish, litter, stones exceeding 50mm diameter and all deleterious material shall be removed.
 2. Shrubs to be planted in stagger pattern.
 3. Shrubs mix to be planted randomly in groups of 3-7 no. of the same species in stagger pattern.

PROPOSED 300UC WITH PRECAST CONCRETE COVER CONNECTING 300U TO CATCHPIT

LEGEND

- CP
- 300U
- 300U U-CHANNEL (STD. DRG. NO. C2405D)
- 300U U-CHANNEL (STD. DRG. NO. C2409G)
- UPSTAND U-CHANNEL WITH 300S (STD. DRG. NO. C2509)
- PROPOSED 300mm STEPPED CHANNEL (STD. DRG. NO. C241E)
- PROPOSED HOARDING TYPE 1 (STD. DRG. NO. R1047)
- PROPOSED PLAIN TUBULAR RAILING (STD. DRG. NO. H2135B)
- PROPOSED SITE ENTRANCE
- PROPOSED LOCKABLE GATE (STD. DRG. NO. C2508)
- PROPOSED 600mm CONCRETE MAINTENANCE STAIRWAY (STD. DRG. C210B)
- THE FINAL SURFACE TO BE HYDROSEEDED WITH EROSION CONTROL MAT (20mm THICK POLYAMIDE TYPE) AND WIRE MESH
- THE FINAL SLOPE SURFACE TO BE HYDROSEEDED WITH SHRUB MIX AND EROSION CONTROL MAT (20mm THICK POLYAMIDE TYPE) AND WIRE MESH
- PROPOSED WORKS SITE

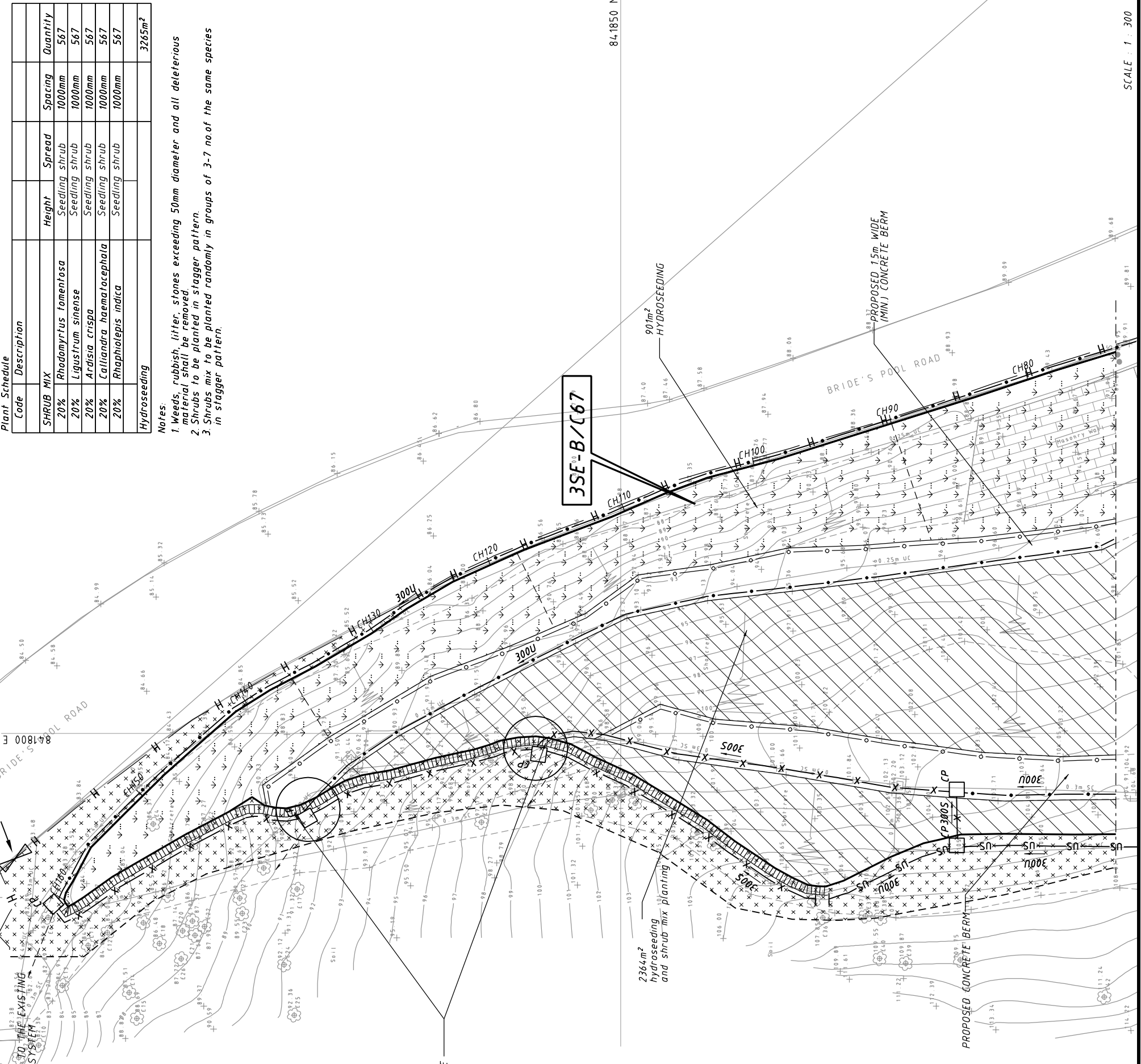

3SE-B/C67

90m² HYDROSEEDING

PROPOSED 15m WIDE (MIN.) CONCRETE BERM

2364m² hydroseeding and shrub mix planting

PROPOSED CONCRETE BERM

84.1850 N

SCALE : 1 : 300

GENERAL REVISION		SOSL	
No	Date	Description	Initial
A	06/04		

REVISION		SOSL	
Name	Date		
SOSL	11/03	Designed	SOSL
XIL	11/03	Drawn	XIL
KSL	11/03	Checked	KSL
HYN	11/03	Approved	HYN
GE/2004/11		Contract No.	GE/2004/11
5.4 (REV. A)		Figure No.	5.4 (REV. A)
		Drawing Title	

LANDSCAPING PROPOSAL PLAN FOR FEATURE NO. 3SE-B/C67

(SHEET 2 OF 2)

GEO TECHNICAL ENGINEERING OFFICE



CIVIL ENGINEERING DEPARTMENT

Maunsell
 MAUNSELL ENVIRONMENTAL MANAGEMENT CONSULTANTS LTD