

## **ATTACHMENT C**

### **附件 C**

## **Landscaping Details for the Designated Features**

### **景觀緩解工程詳情**

<b><u>Feature No.</u></b>	<b><u>Drawing No.</u></b>
<b>斜坡編號</b>	<b>繪圖編號</b>
13NW-B/C80	LPM 0217/L3211
13NW-B/C82	LPM 0217/L3221
13NE-A/C98	LPM 0217/L3411
13NE-A/C99	LPM 0217/L3421
13NE-A/C100	LPM 0217/L3511
13NE-A/C101	LPM 0217/L3521
13NE-A/C102	LPM 0217/L3431
13NE-A/C108	LPM 0217/L3441.1 and L3441.2 LPM 0217/L3442.1 and L3442.2
13NE-A/C133	LPM 0217/L3531

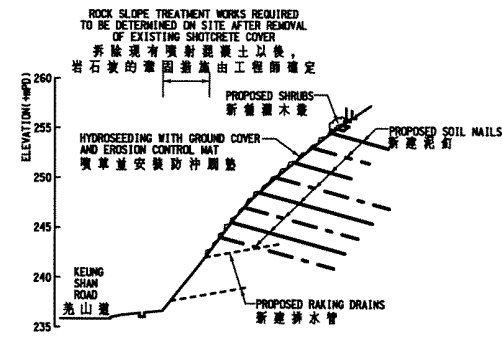

SECTION 1-1  
圖 1-1  
SCALE 1:300

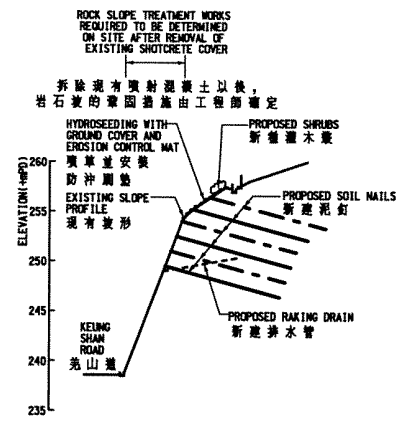

SECTION 2-2  
圖 2-2  
SCALE 1:300

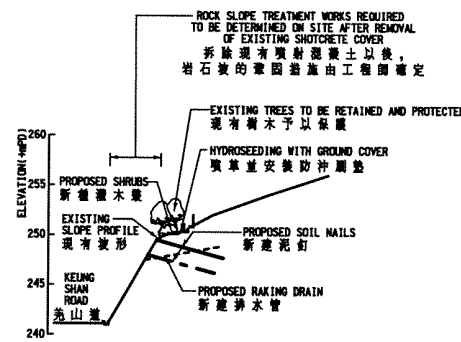

SECTION 3-3  
圖 3-3  
SCALE 1:300

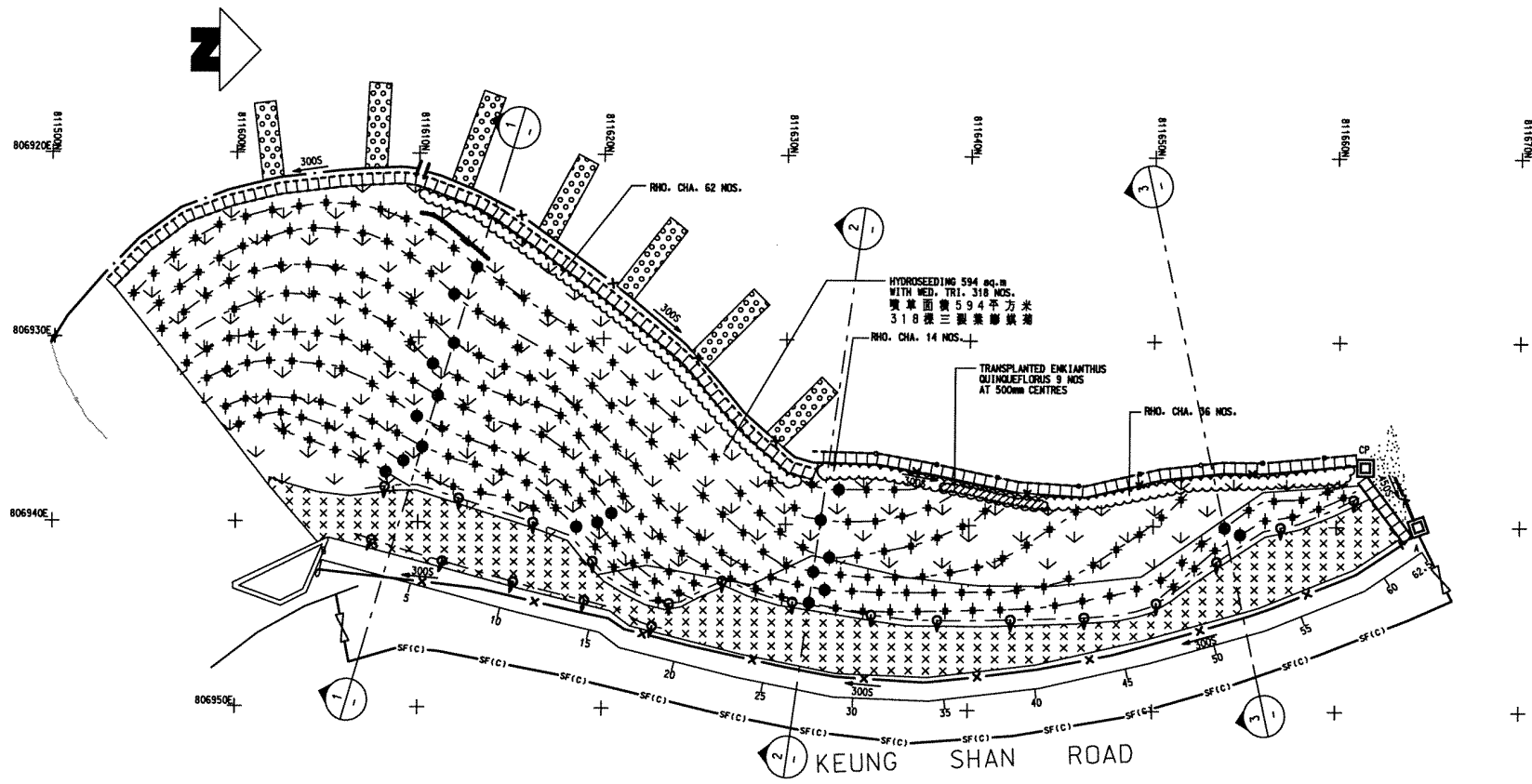

DETAILED LANDSCAPE PLAN  
綠化詳圖  
SCALE 1:150

LEGENDS

- CROSS SECTION
- EXISTING TREE & SHRUBS
- HYDROSEEDING WITH GROUND COVER AND EROSION CONTROL MAT
- ROCK SCALING AND ADDITIONAL ROCK SLOPE STABILIZATION MEASURES
- PROPOSED SHRUBS
- EXISTING PROTECTIVE SPECIES

PLANTING SCHEDULE  
綠化表

ABB.	SCIENTIFIC NAME 學名	SPACING (MM) 間距	SIZE (MM) 尺寸	QTY 數量
<b>SHRUBS</b> 灌木類				
RHO. CHA.	RHODODENDRON CHAMPIONAE 毛葉杜鵑	500	600 X 400	112
<b>GROUND COVER</b> 地被				
MED. CHI.	MEDELIA CHINENSIS 三裂葉蜆蝶菊	1500	250 X 200	318
<b>HYDROSEEDING AREA</b> 噴草面積				594 sq.m 594平方米

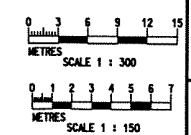

- GENERAL NOTES
- THIS DRAWING IS TO BE READ IN CONJUNCTION WITH DRAWING NOS. LPM0217/002, 3211, 3212, 3213, STANDARD DRAWINGS AND ALL OTHER RELEVANT DRAWINGS. THE SPECIFICATION AND INSTRUCTIONS ISSUED BY THE ENGINEER.
  - ALL DIMENSIONS ARE IN MILLIMETRES UNLESS OTHERWISE SPECIFIED.
  - ALL LEVELS ARE IN MILLIMETRES ABOVE PRINCIPAL DATUM.
- NOTES FOR CARE AND PROTECTION OF EXISTING TREES
- NO TREE FELLING IS PERMITTED DURING THE WORKS BY THE CONTRACTOR OR OTHER PARTIES ON SITE. THEREFORE, THE CONTRACTOR SHALL EXERCISE DUE CARE ON SITE TO AVOID DAMAGES TO ALL EXISTING TREES AT THE CREST.
  - PRIOR TO COMMENCEMENT OF WORKS, THE CONTRACTOR SHALL CONFIRM THE EXACT LOCATIONS OF THE EXISTING TREES.
  - SPECIAL CARE SHOULD BE TAKEN DURING CONSTRUCTION IN ORDER TO PROTECT ALL EXISTING TREES.
  - THE ALIGNMENT OF HARDING, ACCESS ROUTES, WORKING PLATFORMS AND STORAGE AREAS SHALL BE ADJUSTED LOCALLY ON SITE TO AVOID DAMAGE TO EXISTING TREES.
  - THE FORM AND ALIGNMENT OF DRAINAGE CHANNELS, ACCESS STEPS ETC. SHALL BE ADJUSTED LOCALLY ON SITE TO AVOID DAMAGE TO EXISTING TREES.

no.	date	description	initial
REVISION			
1			
2			

P2 300/02 AS PER ENGR'S COMMENT  
 JUN.02 ISSUE FOR COMMENT AD  
 drawn  
 traced  
 checked  
 approved  
 AD /LC JUN.02  
 CN Director, Halcrow China Ltd. JUN.02  
 LC JUN.02

project no. AGREEMENT NO. CE402000  
 10-YEAR EXTENDED LPM PROJECT - PHASE 2, PACKAGE G  
 合約編號CE40/2000  
 延緩十年的防止山泥傾瀉計劃第二期第G組  
 contract CONTRACT NO. GE/2002/17  
 10-YEAR EXTENDED LPM PROJECT PHASE 2, PACKAGE G - LANDSLIP PREVENTIVE WORKS FOR SLOPES AND RETAINING WALLS  
 合約編號GE/2002/17  
 延緩十年的防止山泥傾瀉計劃第二期第G組  
 斜坡和牆土牆防止山泥傾瀉工程

drawing title FEATURE No.  
 綠化詳圖 13NW-BC80  
 Keung Shan Road, Lantau  
 大嶼山麓山道  
 DETAILED LANDSCAPE PLAN  
 綠化詳圖  
 drawing no. LPM 0217 / L3211 revision P2 scale 1:150

**Halcrow**  
 Halcrow China Ltd.  
 Suite 301, 3/F  
 Chiuachem Golden Plaza  
 77 Mody Road, Tsimshatsui East  
 Kowloon  
 合榮中國有限公司  
 office  
 WORKS DIVISION  
 GEOTECHNICAL ENGINEERING OFFICE  
 土力工程處工程務部  
 CIVIL ENGINEERING DEPARTMENT  
 HONG KONG  
 土木工程署

PLANTING SCHEDULE

Abb. 縮寫	SCIENTIFIC NAME 學名	SPACING (MM) 間距	SIZE (MM) 尺寸	QTY 數量
WHIP TREE 用鞭樹的樹木	CALLITANDRA HAEMATOCEPHALA 紅絲線	1500	1000 HT.	131
CAL. HAE.	CALLITANDRA HAEMATOCEPHALA 紅絲線	1500	1000 HT.	132
HIB. TIL.	HIBISCUS TILIACEUS 芙蓉	1500	1000 HT.	132
MAC. BRE.	MACRANTHUS BREVIPLORA 板藍根	1500	1000 HT.	132
AREA 面積				
HYDROSEEDING AREA 噴草				1156 sq.m

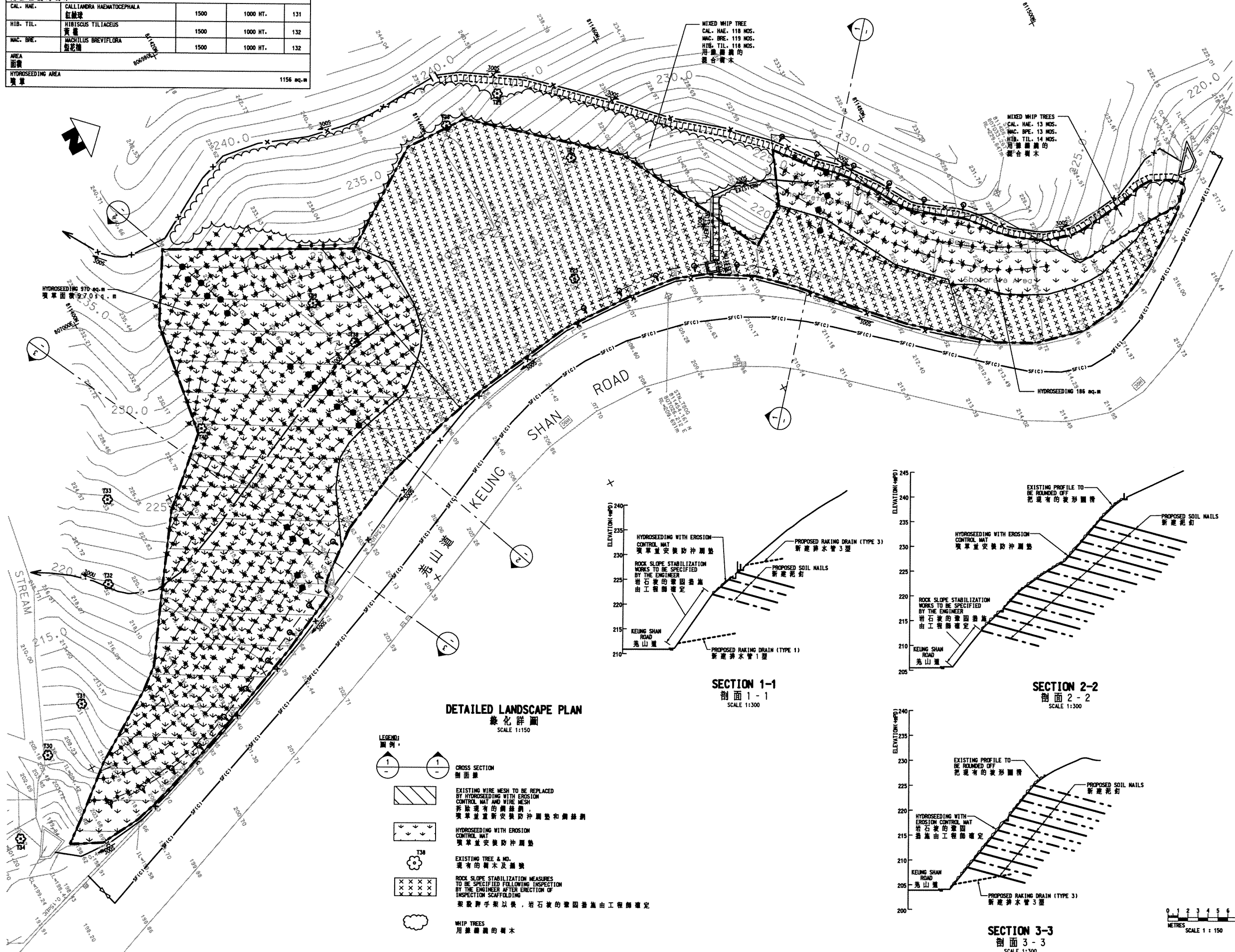

- GENERAL NOTES
- THIS DRAWING IS TO BE READ IN CONJUNCTION WITH DRAWING NOS. LPM0217/002/3221, 3222, 3223, STANDARD DRAWINGS AND ALL OTHER RELEVANT DRAWINGS, THE SPECIFICATION AND INSTRUCTIONS ISSUED BY THE ENGINEER.
  - ALL DIMENSIONS ARE IN MILLIMETRES UNLESS OTHERWISE SPECIFIED.
  - ALL LEVELS ARE IN METRES ABOVE PRINCIPAL DATUM.
- NOTE FOR CARE AND PROTECTION OF EXISTING TREES
- NO TREES SHALL BE FELLED WITHOUT THE APPROVAL OF THE ENGINEER IN WRITING. THE CONTRACTOR SHALL EXERCISE DUE CARE ON SITE TO AVOID DAMAGES TO ALL EXISTING TREES AT THE CREST.
  - PRIOR TO COMMENCEMENT OF WORKS, THE CONTRACTOR SHALL CONFIRM THE EXACT LOCATIONS OF THE EXISTING TREES.
  - SPECIAL CARE SHOULD BE TAKEN DURING CONSTRUCTION IN ORDER TO PROTECT ALL EXISTING TREES.
  - THE ALIGNMENT OF HOARDING, ACCESS ROUTES, WORKING PLATFORMS AND STORAGE AREAS SHALL BE ADJUSTED LOCALLY ON SITE TO AVOID DAMAGE TO EXISTING TREES.
  - THE FORM AND ALIGNMENT OF DRAINAGE CHANNELS, ACCESS STEPS ETC. SHALL BE ADJUSTED LOCALLY ON SITE TO AVOID DAMAGE TO EXISTING TREES.

no.	date	description	initial
P2	JUL.02	DRAFT FOR GEO'S COMMENT	EL
P1	JUN.02	ISSUE FOR COMMENT	AD

no.	name	date
surveyed	LEUNG SHOU CHUN SURVEYING CONSULTANTS LTD.	MAR.02
designed	AD / J.C.	JUN.02
drawn	CN	JUN.02
traced	LC	JUN.02
checked	AD	JUN.02
approved		

file no. E:\geog\p\TRANSLATION\3221P2-CH.dgn

project no. AGREEMENT NO. GE402000  
10-YEAR EXTENDED LPM PROJECT - PHASE 2, PACKAGE G  
合約編號: GE402000  
延建十年的防止山泥傾瀉計劃第二階段

contract CONTRACT NO. GE200217  
10-YEAR EXTENDED LPM PROJECT PHASE 2, PACKAGE G - LANDSLIP PREVENTIVE WORKS FOR SLOPES AND RETAINING WALLS  
合約編號: GE200217  
延建十年的防止山泥傾瀉計劃第二階段  
斜坡和圍土牆防止山泥傾瀉工程

drawing title  
FEATURE No. 13NW-BC82  
噴草護坡  
Keung Shan Road, Lantau  
大嶼山羌山道

DETAILED LANDSCAPE PLAN  
綠化詳圖

drawing no.	revision	scale
LPM 0217 / L3221	P2	1:150

**Halcrow**  
合眾中國有限公司

Halcrow China Ltd.  
Suite 301 JF  
Chinachem Golden Plaza  
77 Mody Road, Tsimshatsui East  
Kowloon

office  
WORKS DIVISION  
GEOTECHNICAL ENGINEERING OFFICE  
土力工程處工程

**CIVIL ENGINEERING DEPARTMENT HONG KONG 土木工程署**

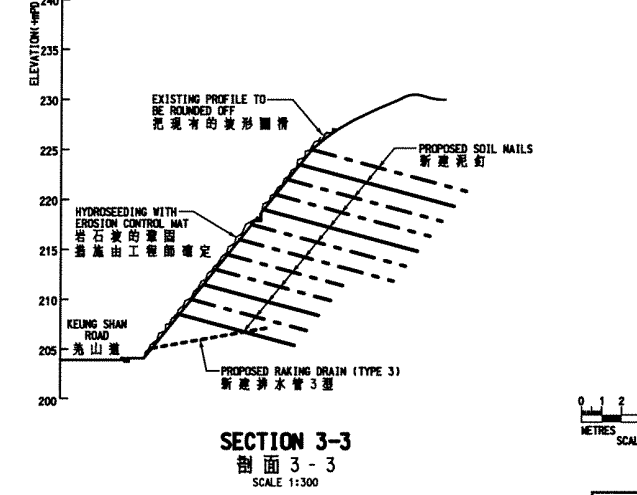
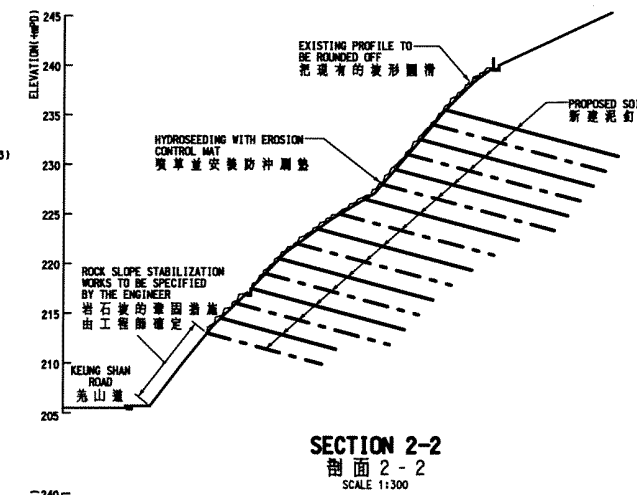
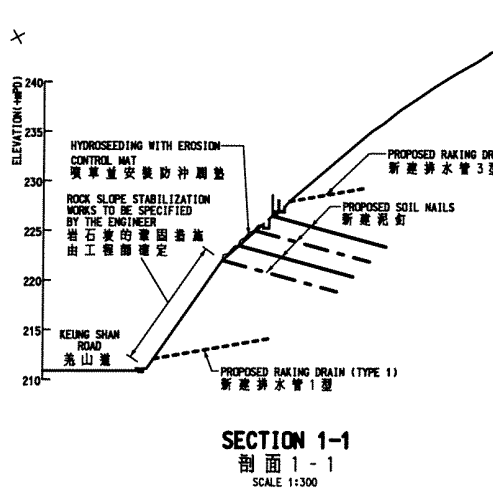

- LEGEND 圖例
- CROSS SECTION 剖面線
  - EXISTING WIRE MESH TO BE REPLACED BY HYDROSEEDING WITH EROSION CONTROL MAT AND WIRE MESH 拆去現有的鋼絲網，噴草並重新安裝防沖網墊和鋼絲網
  - HYDROSEEDING WITH EROSION CONTROL MAT 噴草並安裝防沖網墊
  - T38 EXISTING TREE & MD. 現有的樹木及樹墩
  - ROCK SLOPE STABILIZATION MEASURES TO BE SPECIFIED FOLLOWING INSPECTION BY THE ENGINEER AFTER ERECTION OF INSPECTION SCAFFOLDING 架設腳手架以後，岩石坡的加固措施由工程師確定
  - WHIP TREES 用鞭樹的樹木

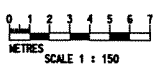

COPYRIGHT RESERVED

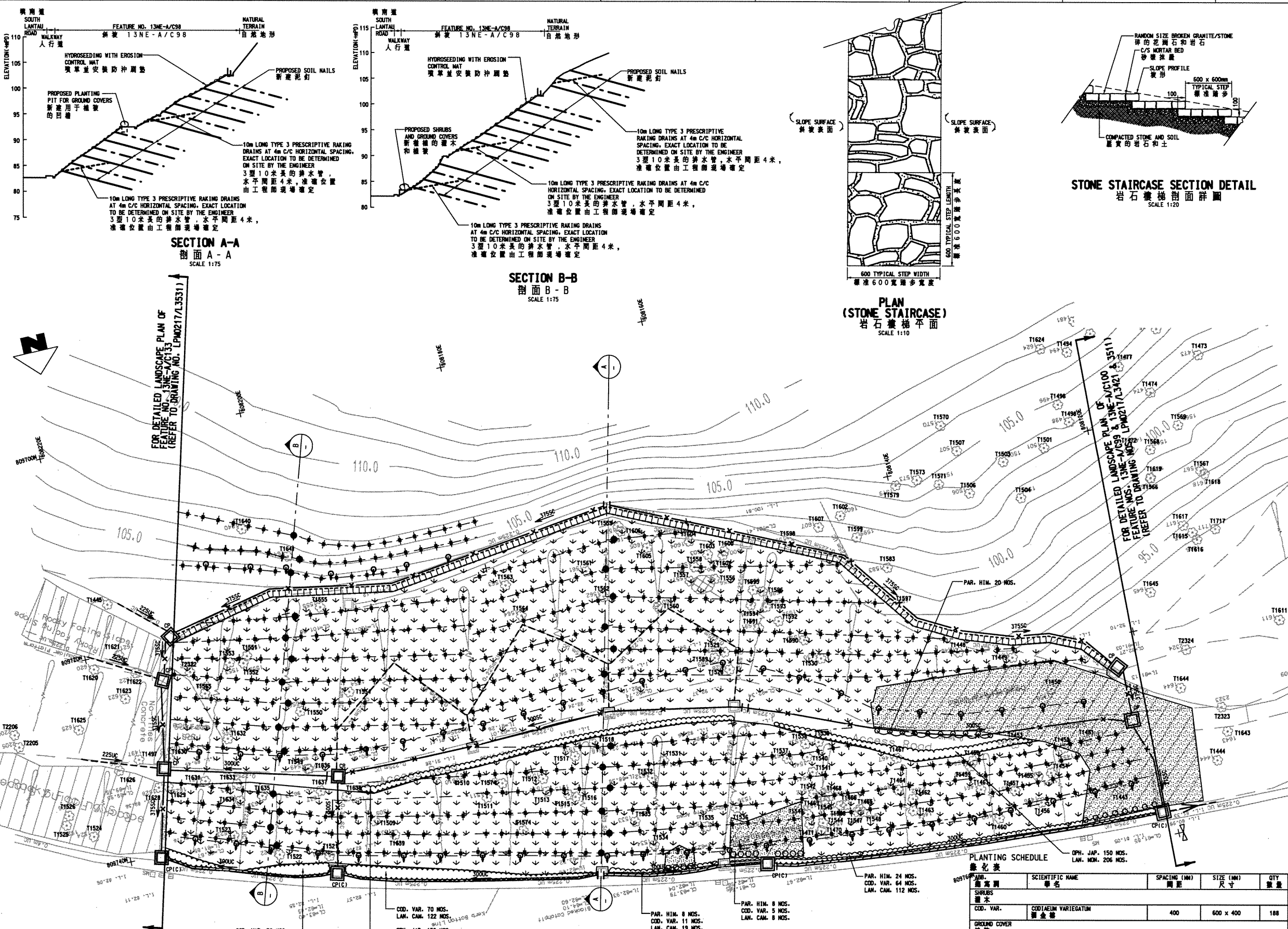

**GENERAL NOTES**

- THIS DRAWING IS TO BE READ IN CONJUNCTION WITH DRAWING NOS. LPM0217/L3411, L3413, L3411/L3412, STANDARD DRAWINGS AND ALL OTHER RELEVANT DRAWINGS, THE SPECIFICATIONS AND INSTRUCTIONS ISSUED BY THE ENGINEER.
- ALL DIMENSIONS ARE IN MILLIMETRES UNLESS OTHERWISE SPECIFIED.
- ALL LEVELS ARE IN METRES ABOVE PRINCIPAL DATUM.

**NOTES FOR CARE AND PROTECTION OF EXISTING TREES**

- NO TREE FELLING IS PERMITTED DURING THE WORKS BY THE CONTRACTOR OR OTHER PARTIES ON SITE. TREE FELLING SHALL ONLY BE CARRIED OUT IN ACCORDANCE WITH TREE FELLING PLAN AS SHOWN IN DRAWING NO. LPM0217/L3321. THEREFORE, THE CONTRACTOR SHALL EXERCISE DUE CARE ON SITE TO AVOID DAMAGE TO ALL EXISTING TREES.
- PRIOR TO COMMENCEMENT OF WORKS, THE CONTRACTOR SHALL CONFIRM THE EXACT LOCATIONS OF THE EXISTING TREES.
- SPECIAL CARE SHOULD BE TAKEN DURING CONSTRUCTION IN ORDER TO PROTECT ALL EXISTING TREES.
- THE ALIGNMENT OF HOARDING, ACCESS ROUTES, WORKING PLATFORMS AND STORAGE AREAS SHALL BE ADJUSTED LOCALLY ON SITE TO AVOID DAMAGE TO EXISTING TREES.
- THE FORM AND ALIGNMENT OF DRAINAGE CHANNELS, ACCESS STEPS ETC. SHALL BE ADJUSTED LOCALLY ON SITE TO AVOID DAMAGE TO EXISTING TREES.

no.	date	description	initial																		
REVISION																					
1	JUL.02	ISSUE FOR COMMENT																			
<table border="1"> <thead> <tr> <th>no.</th> <th>name</th> <th>date</th> </tr> </thead> <tbody> <tr> <td>1</td> <td>LEUNG SHOU CHUN</td> <td>MAR.02</td> </tr> <tr> <td>2</td> <td>AD/LC (URBIS)</td> <td>JUL.02</td> </tr> <tr> <td>3</td> <td>DN (URBIS)</td> <td>JUL.02</td> </tr> <tr> <td>4</td> <td>LC (URBIS)</td> <td>JUL.02</td> </tr> <tr> <td>5</td> <td>AD (URBIS)</td> <td>JUL.02</td> </tr> </tbody> </table>				no.	name	date	1	LEUNG SHOU CHUN	MAR.02	2	AD/LC (URBIS)	JUL.02	3	DN (URBIS)	JUL.02	4	LC (URBIS)	JUL.02	5	AD (URBIS)	JUL.02
no.	name	date																			
1	LEUNG SHOU CHUN	MAR.02																			
2	AD/LC (URBIS)	JUL.02																			
3	DN (URBIS)	JUL.02																			
4	LC (URBIS)	JUL.02																			
5	AD (URBIS)	JUL.02																			
approved _____ Director, Halcrow China Ltd. Date: _____																					

file no. E:\gao\p\m\TRANSLATION\4111p1-dh.dgn

project no. AGREEMENT NO. GE402000  
10-YEAR EXTENDED LPM PROJECT - PHASE 2, PACKAGE G  
合約編號: GE402000  
延齡十年的防止山泥傾瀉計劃第二階段工程

contract no. CONTRACT NO. GE2002/17  
10-YEAR EXTENDED LPM PROJECT PHASE 2, PACKAGE G - LANDSLIP PREVENTIVE WORKS FOR SLOPES AND RETAINING WALLS  
合約編號: GE2002/17  
延齡十年的防止山泥傾瀉計劃第二階段工程  
斜坡和牆土牆防止山泥傾瀉工程

drawing title: **FEATURE No. 13NE-AC/98 斜坡綠化**  
Sheik Pik Reservoir, Lantau Island 大嶼山石壙水塘

DETAILED LANDSCAPE PLAN 綠化詳圖

drawing no.	revision	scale
LPM 0217 / L3411	P1	AS SHOWN

**Halcrow**  
合眾中國有限公司

Halcrow China Ltd.  
Suite 301, 3F  
Chinachem Golden Plaza  
77 Mody Road, Tsimshatsui East  
Kowloon

office: **WORKS DIVISION**  
GEOTECHNICAL ENGINEERING OFFICE  
土力工程處工程組

**CIVIL ENGINEERING DEPARTMENT HONG KONG**  
土木工程署

**PLANTING SCHEDULE**  
綠化表

ABB.	SCIENTIFIC NAME	SPACING (MM)	SIZE (MM)	QTY
SHRUBS				
SHRUBS	CODIAEUM VARIEGATUM	400	600 x 400	188
GROUND COVER				
LAN. MON.	LANTANA MONTEVIDENSIS	300	200 x 250	424
OPH. JAP.	OPHILOPOSON JAPONICUS	350	300 x 300	308
LAN. CAM.	LANTANA CAMARA	300	200 x 250	325
CLIMBER				
PAR. HIM.	PARTHENOCISSUS HIMALAYANA	1500	1500 LONG	60
HYDROSEEDING AREA				2086 sq.m
A/C				
LAN.				

**LEGEND**  
圖例

	CROSS SECTION 剖面圖		HYDROSEEDING WITH EROSION CONTROL MAT 噴草並安裝防沖刷墊		CONCRETE AREA 預製土範圍
	EXISTING TREE & NO. 現有的樹木及編號		TIE WALL 圍牆		SHRUBS / GROUND COVER 灌木 / 綠化
	CLIMBER 攀援植物				

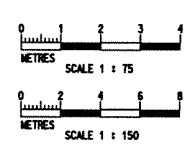

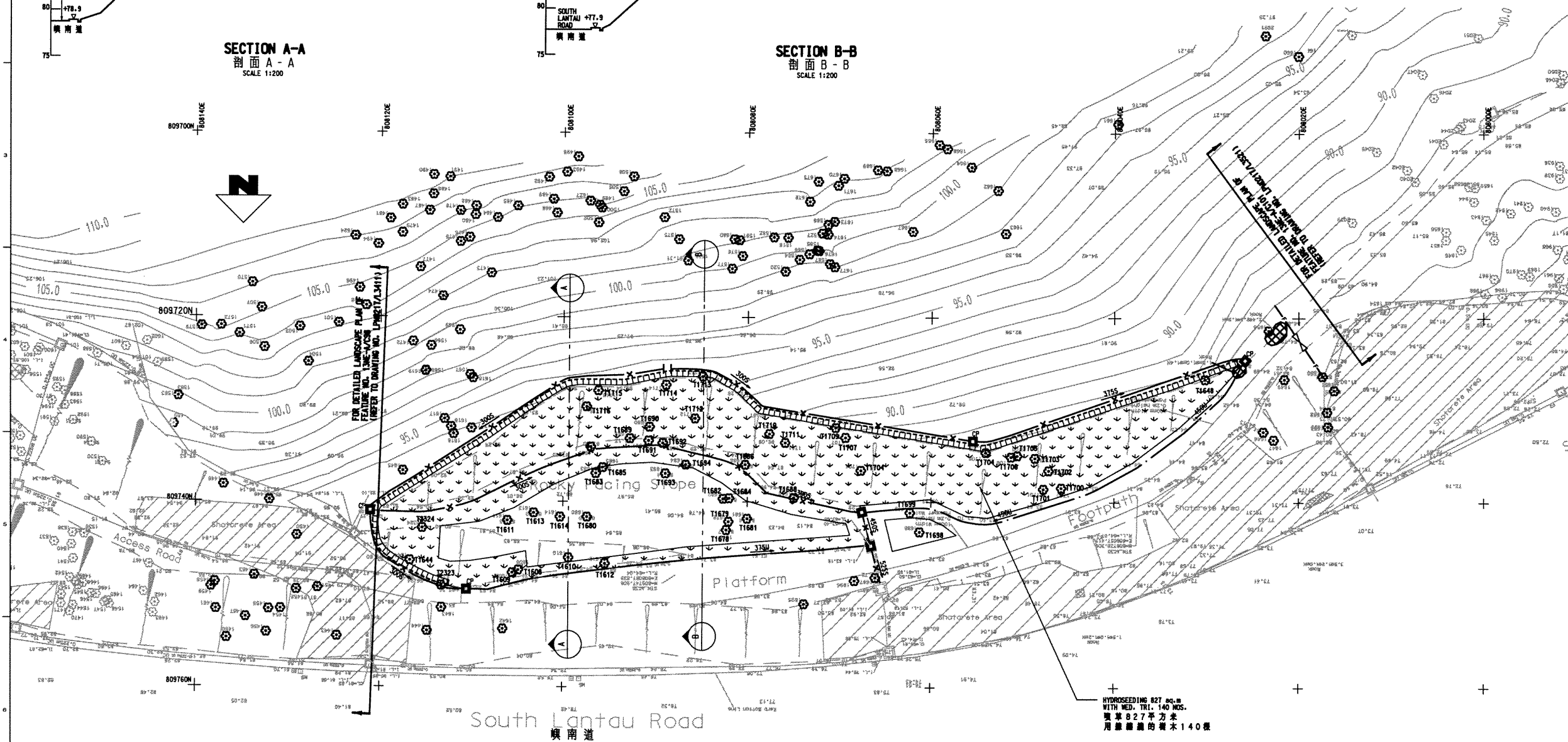
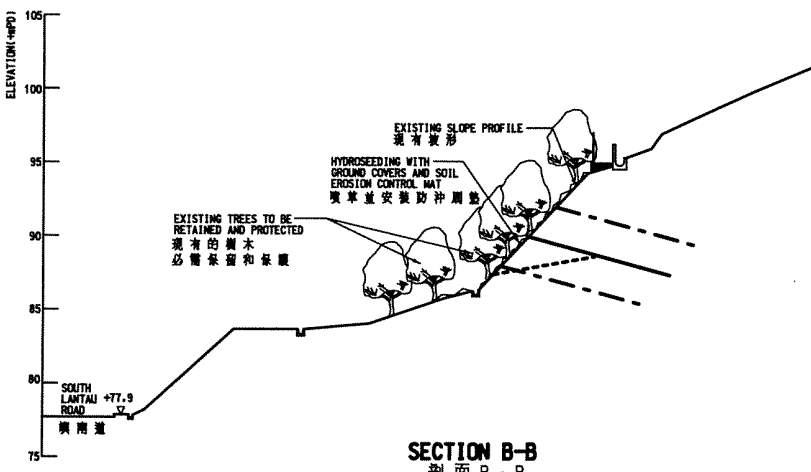
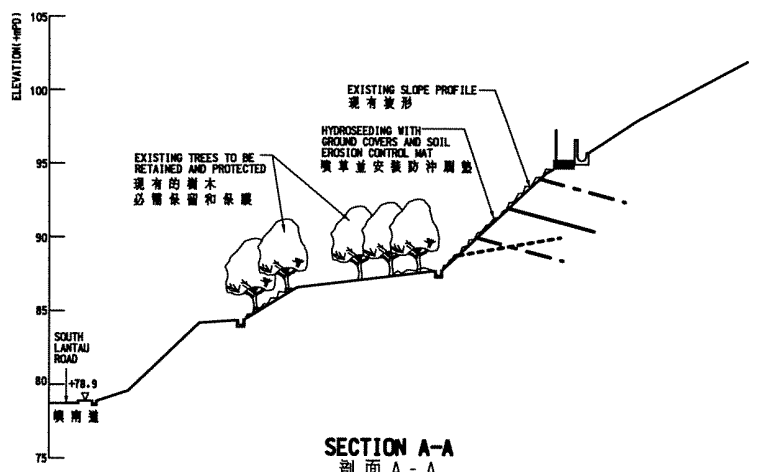

**LEGEND 圖例**

CROSS SECTION 剖面圖

HYDROSEEDING WITH SOIL EROSION CONTROL MAT 噴草並安裝防沖刷墊

EXISTING TREES 現有的樹木

**PLANTING SCHEDULE 綠化表**

ARB.	SCIENTIFIC NAME	SPACING (MM)	SIZE (MM)	QTY
GROUND COVER 綠草				
MED. TRI.	MEDELIA TRILOBATA	1500	200 X 200	140
AREA 面積				
HYDROSEEDING AREA 噴草				827 sq.m

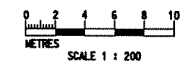

- GENERAL NOTES**
- THIS DRAWING IS TO BE READ IN CONJUNCTION WITH DRAWING NOS. LPM0217/002-3421-3422-3423. STANDARD DRAWINGS AND ALL OTHER RELEVANT DRAWINGS, THE SPECIFICATIONS AND INSTRUCTIONS ISSUED BY THE ENGINEER.
  - ALL DIMENSIONS ARE IN MILLIMETRES UNLESS OTHERWISE SPECIFIED.
  - ALL LEVELS ARE IN MILLIMETRES ABOVE PRINCIPAL DATUM.
- NOTES FOR CARE AND PROTECTION OF EXISTING TREES**
- NO TREES AND FERNS SHALL BE FELLED WITHOUT THE APPROVAL OF THE ENGINEER IN WRITING.
  - PRIOR TO COMMENCEMENT OF WORKS, THE CONTRACTOR SHALL CONFIRM THE EXACT LOCATIONS OF THE EXISTING TREES.
  - SPECIAL CARE SHOULD BE TAKEN DURING CONSTRUCTION IN ORDER TO PROTECT ALL EXISTING TREES.
  - THE ALIGNMENT OF HOARDING, ACCESS ROADS, WORKING PLATFORMS, DRAINAGE CHANNELS AND STORAGE AREAS SHALL BE ADJUSTED LOCALLY ON SITE TO AVOID DAMAGE TO ALL EXISTING TREES.
  - THE FORM AND ALIGNMENT OF DRAINAGE CHANNELS, ON STEPS ETC., SHALL BE ADJUSTED LOCALLY ON SITE TO AVOID DAMAGE TO EXISTING TREES.

REV.	DATE	DESCRIPTION	BY	CHKD.
P3	JUL.02	AS PER ENGR'S COMMENT	AD	
P2	JUN.02	ADDITIONAL DETAIL	AD	
P1	MAY.02	ISSUE FOR COMMENT	AD	

**REVISION**

no.	date	description	initial

approved: \_\_\_\_\_  
Director, Halcrow China Ltd. Date: \_\_\_\_\_

file no: E:\geopl\pmg\TRANSLATION\L3421P3-CH.dgn

project no: AGREEMENT NO. CE402000  
10-YEAR EXTENDED LPM PROJECT - PHASE 2, PACKAGE G  
合約編號 CE402000  
延緩十年的防止山泥傾瀉  
計劃第二階段 G 組

contract: CONTRACT NO. GE200247  
10-YEAR EXTENDED LPM PROJECT PHASE 2, PACKAGE G  
LANDSLIP PREVENTIVE WORKS FOR SLOPES AND RETAINING WALLS  
合約編號 GE/2002/17  
延緩十年的防止山泥傾瀉  
計劃第二階段 G 組  
斜坡和擋土牆  
防止山泥傾瀉工程

drawing title: FEATURE No. 13NE-AC99  
斜坡編號 13NE-AC99  
Shek Pik Reservoir, Lantau Island  
大嶼山石壁水塘

**DETAILED LANDSCAPE PLAN 綠化詳圖**

drawing no. LPM 0217 / L3421 P3  
revision P3  
scale 1:200

**Halcrow**  
Halcrow China Ltd.  
Suite 201, 3/F  
Chunshun, Golden Plaza  
77 Moody Road, Tsimshatzai East  
Kowloon

office: WORKS DIVISION  
GEOTECHNICAL ENGINEERING OFFICE  
土木工程處工程師

CIVIL ENGINEERING DEPARTMENT  
HONG KONG  
土木工程署

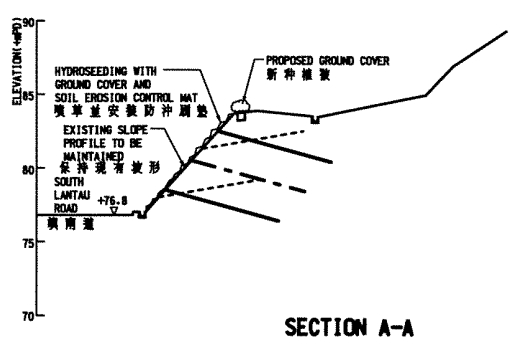

SECTION A-A  
剖面 A-A  
SCALE 1:200

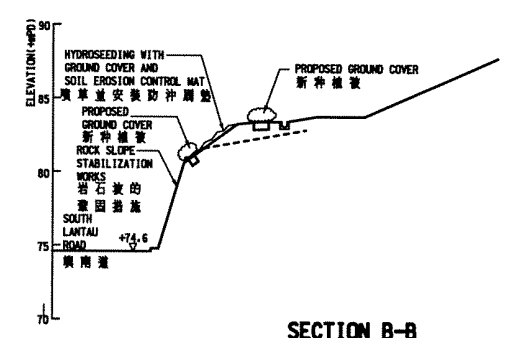

SECTION B-B  
剖面 B-B  
SCALE 1:200

PLANTING SCHEDULE  
綠化表

Abb.	SCIENTIFIC NAME 學名	SPACING (MM) 間距	SIZE (MM) 尺寸	QTY 數量
<b>TREE 樹</b>				
MAC. BRE.	MACHILUS BREVIFLORA 盤花樹	3000	STANDARD	6
<b>GROUND COVER</b>				
MD. CHI.	MEDELLA CHINENSIS 三裂葉蛇根草	1500	200 X 250	138
LAM. TRI.	LANTANA TRIFOLIA 三葉黃金蕒	500	250 X 250	222
<b>SHRUBS 灌木</b>				
MEL. CAN.	MELASTOMA CANDIDUM 野牡丹	400	600 X 400	56
<b>HYDROSEEDING AREA 噴草</b>				AREA 面積
				446 sq.m

GENERAL NOTES  
1. THIS DRAWING IS TO BE READ IN CONJUNCTION WITH DRAWING NOS. LPM0217/002.3511.3512.3513. STANDARD DRAWINGS AND ALL OTHER RELEVANT DRAWINGS. THE SPECIFICATION AND INSTRUCTIONS ISSUED BY THE ENGINEER.

2. ALL DIMENSIONS ARE IN MILLIMETRES UNLESS OTHERWISE SPECIFIED.

3. ALL LEVELS ARE IN MILLIMETRES ABOVE PRINCIPAL DATUM.

NOTES FOR CARE AND PROTECTION OF EXISTING TREES  
1. NO TREE SHALL BE FELLED WITHOUT APPROVAL OF THE ENGINEER IN WRITING. THE CONTRACTOR SHALL EXERCISE DUE CARE ON SITE TO AVOID DAMAGE TO ALL EXISTING TREES AT THE CREST.

2. PRIOR TO COMMENCEMENT OF WORKS, THE CONTRACTOR SHALL CONFIRM THE EXACT LOCATIONS OF THE EXISTING TREES.

3. SPECIAL CARE SHOULD BE TAKEN DURING CONSTRUCTION IN ORDER TO PROTECT ALL EXISTING TREES.

4. THE ALIGNMENT OF HOARDING, ACCESS ROADS, WORKING PLATFORMS, DRAINAGE CHANNEL AND STORAGE AREAS SHALL BE ADJUSTED LOCALLY ON SITE TO AVOID DAMAGE TO ALL EXISTING TREES.

5. THE FORM AND ALIGNMENT OF DRAINAGE CHANNELS, ACCESS STEPS ETC. SHALL BE ADJUSTED LOCALLY ON SITE TO AVOID DAMAGE TO EXISTING TREES.

no.	date	description	initial
P3	JUL.02	AS PER ENGR'S COMMENT	AD
P2	JUN.02	ADDITIONAL DETAIL	AD
P1	MAY.02	ISSUE FOR COMMENT	AD

REVISION	name	date
surveyed	LEUNG SHUK CHUN SURVEYING CONSULTANTS LTD.	MAR.02
designed	MP (URBIS)	MAY.02
drawn	CN (URBIS)	MAY.02
traced	LC (URBIS)	MAY.02
checked	AD (URBIS)	MAY.02

file no: E:\geo\lpm\TRANSLATION\3511P4-CH.dgn  
project no: AGREEMENT NO. CE402000  
10-YEAR EXTENDED LPM PROJECT - PHASE 2, PACKAGE G  
合約編號CE402000  
延後十年的防止山泥傾瀉計劃第二期工程

contract: CONTRACT NO. GE2002/17  
10-YEAR EXTENDED LPM PROJECT PHASE 2, PACKAGE G - LANDSLIP PREVENTIVE WORKS FOR SLOPES AND RETAINING WALLS  
合約編號GE/2002/17  
延後十年的防止山泥傾瀉計劃第二期工程  
斜坡和牆土牆  
防止山泥傾瀉工程

drawing title: FEATURE No. 13NE-AC100  
斜坡編號 13NE-AC100  
Shek Pik Reservoir, Lantau Island  
大嶼山石壘水塘

DETAILED LANDSCAPE PLAN  
綠化詳圖  
drawing no. LPM 0217 / L3511  
revision P3  
scale 1:200

**Halcrow**  
Halcrow China Ltd.  
Suite 301, 3/F  
Chinachem Golden Plaza  
77 Mody Road, Tsimshatsui East  
Kowloon  
合眾中國有限公司

office: WORKS DIVISION  
GEOTECHNICAL ENGINEERING OFFICE  
土力工程處工程室

CIVIL ENGINEERING DEPARTMENT  
HONG KONG  
土木工程署

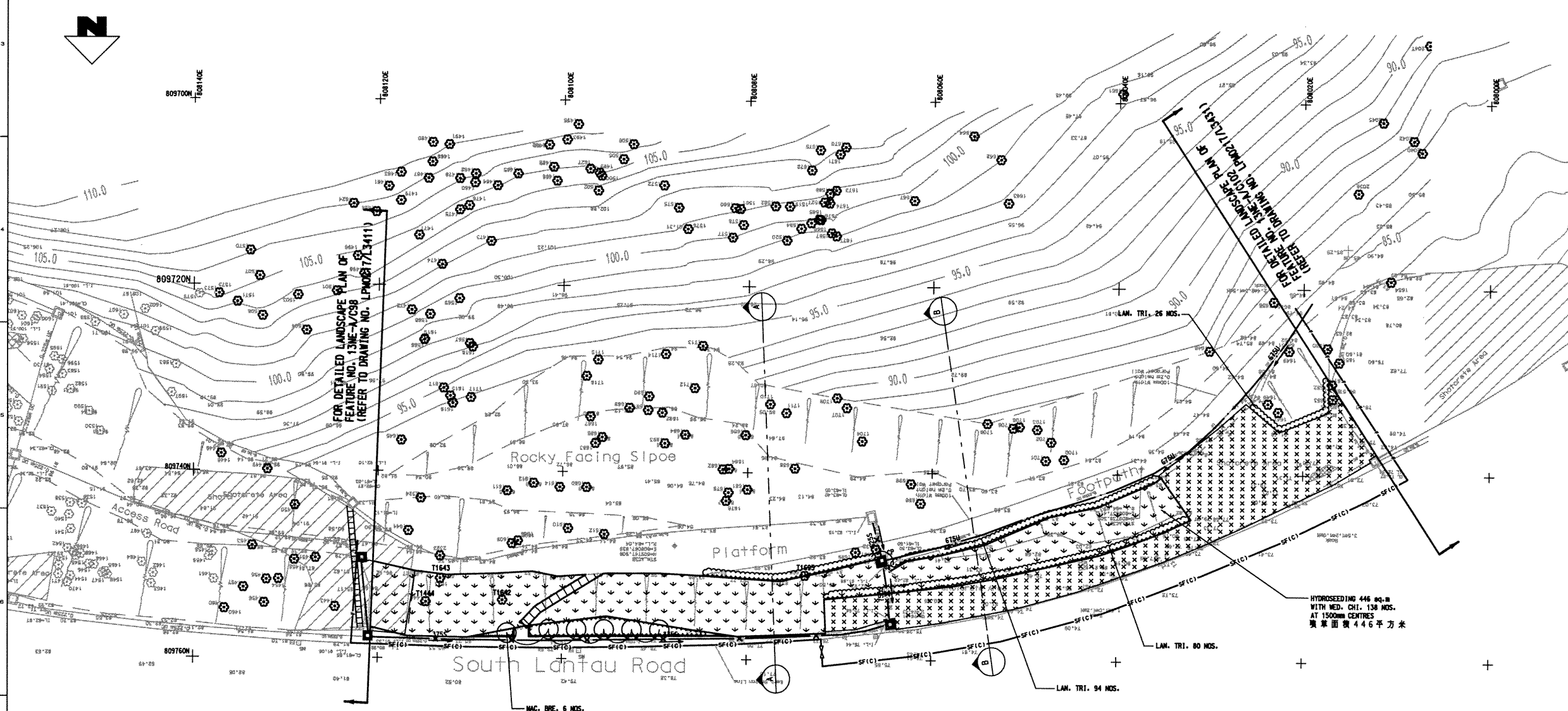

LEGEND  
圖例

	CROSS SECTION 剖面線		HYDROSEEDING W/ GROUND COVER AND SOIL EROSION CONTROL MAT 噴草並安裝防沖刷墊		TOE WALL PLANTER 牆底花槽
	EXISTING TREES 現有的樹木		ROCK SLOPE STABILIZATION 岩石的加固措施		

DETAILED LANDSCAPE PLAN  
綠化詳圖  
SCALE 1:200

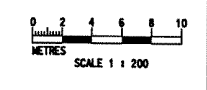

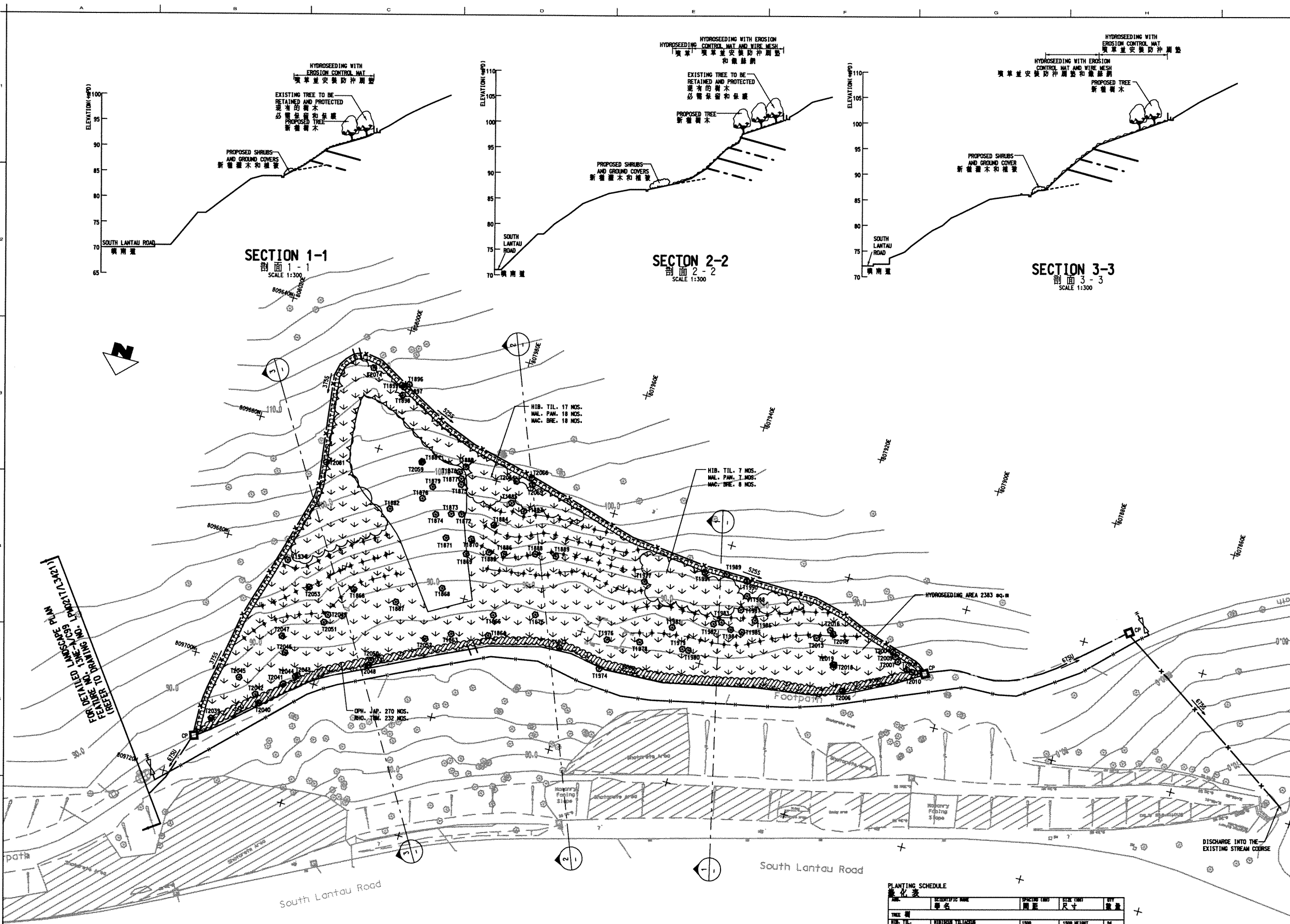

- GENERAL NOTES
- THIS DRAWING IS TO BE READ IN CONJUNCTION WITH DRAWING NOS. LPM0217/3521-3523 & L3521, STANDARD DRAWINGS AND ALL OTHER RELEVANT DRAWINGS, THE SPECIFICATION AND INSTRUCTIONS ISSUED BY THE ENGINEER.
  - ALL DIMENSIONS ARE IN MILLIMETRES UNLESS OTHERWISE SPECIFIED.
  - ALL LEVELS ARE IN METRES ABOVE PRINCIPAL DATUM.
- CARE AND PROTECTION OF EXISTING TREES
- PRIOR TO COMMENCEMENT OF WORKS, THE CONTRACTOR SHALL CONFIRM THE EXACT LOCATIONS OF THE EXISTING TREES.
  - NO TREE FELLING IS PERMITTED DURING THE WORKS BY THE CONTRACTOR OR OTHER PARTIES ON SITE. TREE FELLING SHALL ONLY BE CARRIED OUT IN ACCORDANCE WITH TREE FELLING PLAN AS SHOWN IN DRAWING NO. LPM0217/3521. THEREFORE, THE CONTRACTOR SHALL EXERCISE DUE CARE ON SITE TO AVOID DAMAGE TO ALL EXISTING TREES.
  - SPECIAL CARE SHOULD BE TAKEN DURING CONSTRUCTION IN ORDER TO PROTECT ALL EXISTING TREES.
  - WHERE EXISTING SPRAY CONCRETE IS TO BE REMOVED CARE SHALL BE TAKEN NOT TO DISTURB TREE ROOTS LYING IMMEDIATELY UNDER THE SURFACE.
  - THE ALIGNMENT OF HOARDING, ACCESS ROUTES, WORKING PLATFORMS AND STORAGE AREAS SHALL BE ADJUSTED LOCALLY ON SITE TO AVOID DAMAGE TO EXISTING TREES.
  - THE FORM AND ALIGNMENT OF DRAINAGE CHANNELS, ACCESS STEP ETC. SHALL BE ADJUSTED LOCALLY ON SITE TO AVOID DAMAGE TO EXISTING TREES.

no.	date	description	initial
P1	AUG. 02	ISSUE FOR COMMENT	

no.	date	description	initial
revised			
checked			
approved			

Director, Harbour Office Ltd.

file no. E:\4\geotech\TRANSLATION\3521P1-CH.dgn

project no. AGREEMENT NO. CE402000  
10-YEAR EXTENDED LPM PROJECT - PHASE 2, PACKAGE G  
合約編號CE402000  
第十年的防止山泥傾瀉計劃第二階段工程

contract CONTRACT NO. GE200217  
10-YEAR EXTENDED LPM PROJECT PHASE 2, PACKAGE G - LANDSLIP PREVENTIVE WORKS FOR SLOPES AND RETAINING WALLS  
合約編號GE200217  
第十年的防止山泥傾瀉計劃第二階段工程  
斜坡和擋土牆防止山泥傾瀉工程

drawing title  
FEATURE No. 13NE-AC101  
斜坡編號 13NE-AC101  
South Lantau Road,  
Near Shek Pik Reservoir, Lantau  
大嶼山石壁水塘  
嶼南道  
DETAILED LANDSCAPE PLAN  
綠化詳圖

drawing no. LPM 0217 / L3521 P1  
revision  
scale 1:250

PLANTING SCHEDULE  
綠化表

樹種	SCIENTIFIC NAME	SPACING (mm)	SIZE (mm)	QTY
樹種				
HIB. TIL.	HIBISCUS TILLOSIUS	1000	1000 HEIGHT	24
MAC. PAK.	MACLEODIA PAVOLATA	1000	1000 HEIGHT	34
MAC. BRE.	MACLEODIA BREVIFLORA	1000	1000 HEIGHT	34
SHRUBS AND GROUND COVERS				
HIB. TIL.	HIBISCUS TILLOSIUS	800	800 x 800	232
SHRUBS AND GROUND COVERS				
OPH. JAP.	OPHIOPOSSON JAPONICUS	300	250 x 250	270
HYDROSEEDING AREA				2383 sq.m

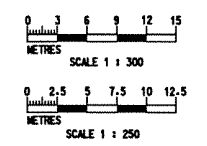

DETAILED LANDSCAPE PLAN  
綠化詳圖  
SCALE 1:250

LEGEND  
圖例

CROSS SECTION  
剖面線

EXISTING TREE & NO.  
現有的樹木及編號

PROPOSED TREE  
新種樹木

PROPOSED SHRUBS AND GROUND COVER  
新種灌木和植被

HYDROSEEDING AREA  
噴草面積

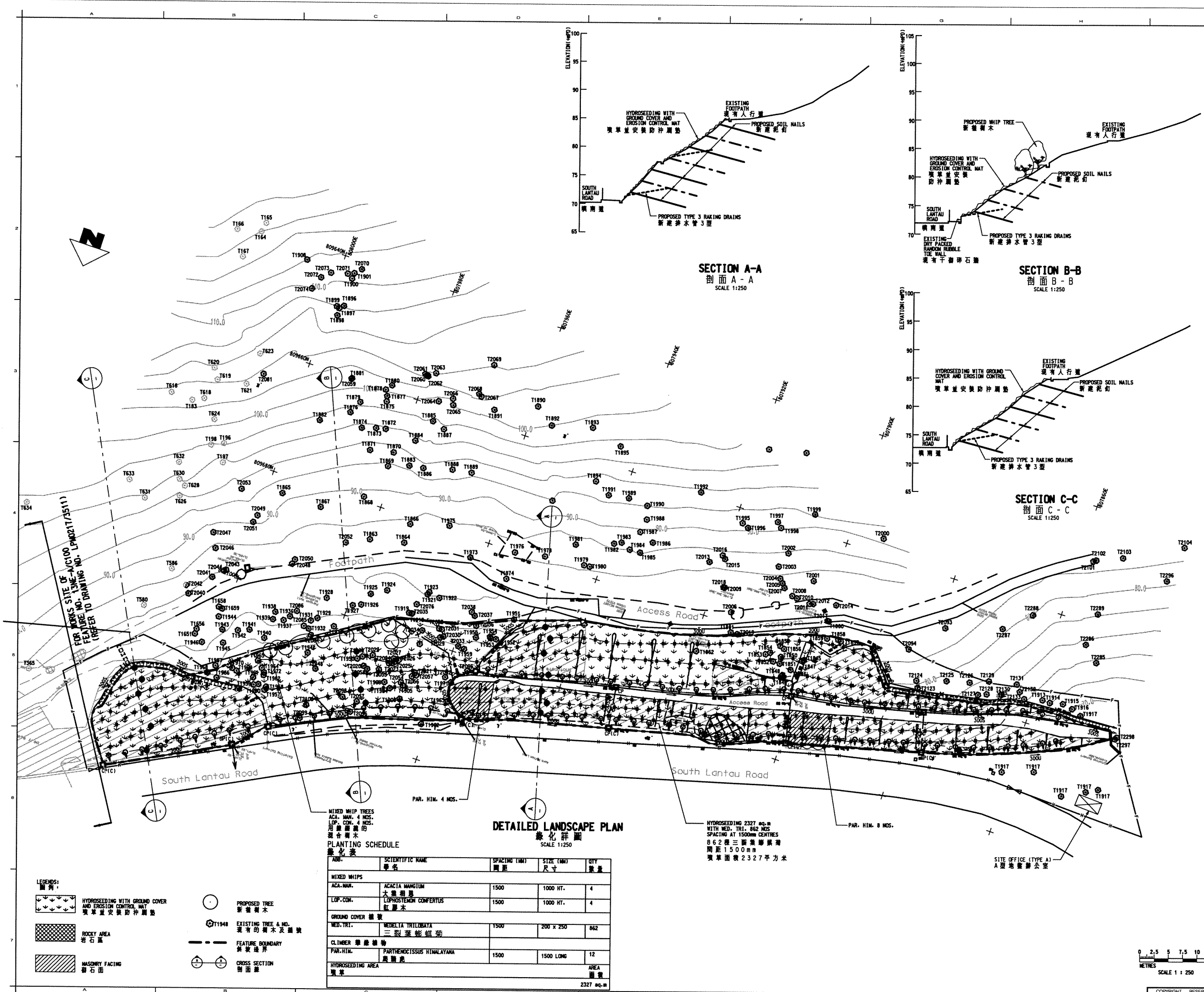

- GENERAL NOTES
- THIS DRAWING IS TO BE READ IN CONJUNCTION WITH DRAWING NOS. LPM0217/3431, 3432, 3433, STANDARD DRAWINGS AND ALL OTHER RELEVANT DRAWINGS, THE SPECIFICATIONS AND INSTRUCTIONS ISSUED BY THE ENGINEER.
  - ALL DIMENSIONS ARE IN METRES UNLESS OTHERWISE SPECIFIED.
  - ALL LEVELS ARE IN METRES ABOVE PRINCIPAL DATUM.
- CARE & PROTECTION OF EXISTING TREE
- NO TREES AND FERNS SHALL BE FELLED WITHOUT APPROVAL OF THE ENGINEER IN WRITING. THE CONTRACTOR SHALL EXERCISE DUE CARE ON SITE TO AVOID DAMAGE TO ALL EXISTING TREES.
  - PRIOR TO COMMENCEMENT OF WORKS, THE CONTRACTOR SHALL CONFIRM THE EXACT LOCATIONS OF THE EXISTING TREES.
  - SPECIAL CARE SHOULD BE TAKEN DURING CONSTRUCTION IN ORDER TO PROTECT ALL EXISTING TREES.
  - WHERE EXISTING SPRAY CONCRETE IS TO BE REMOVED CARE SHALL BE TAKEN NOT TO DISTURB TREE ROOTS LYING IMMEDIATELY UNDER THE SURFACE.
  - THE ALIGNMENT OF HOARDING, ACCESS ROUTES, WORKING PLATFORMS AND STORAGE AREAS SHALL BE ADJUSTED LOCALLY ON SITE TO AVOID DAMAGE TO EXISTING TREES.
  - THE FORM AND ALIGNMENT OF DRAINAGE CHANNELS, ACCESS STEP ETC. SHALL BE ADJUSTED LOCALLY ON SITE TO AVOID DAMAGE TO EXISTING TREES.

P2	JUL.02	DRAFT FOR GEO'S COMMENT	EL
P1	JUN.02	ISSUE FOR COMMENT	FN
no.	date	description	initial

REVISION

no.	name	date
1	LEUNG SHU CHUN	MAR.02
2	AD/C (URBIS)	JUN.02
3	DN (URBIS)	JUN.02
4	LC (URBIS)	JUN.02
5	AD (URBIS)	JUN.02

File no: E:\gao\lpm\TRANSLATION\3431P2-CH.dgn

Project no: AGREEMENT NO. CE402000  
10-YEAR EXTENDED LPM PROJECT - PHASE 2, PACKAGE G  
合約編號CE402000  
第十年的防止山泥傾瀉計劃第二期工程

Contract no: CONTRACT NO. GE200217  
10-YEAR EXTENDED LPM PROJECT PHASE 2, PACKAGE G - LANDSLIP PREVENTIVE WORKS FOR SLOPES AND RETAINING WALLS  
合約編號GE200217  
第十年的防止山泥傾瀉計劃第二期工程  
斜坡及護土牆  
防止山泥傾瀉工程

Drawing title: FEATURE No. 13NE-AC102  
斜坡編號 13NE-AC102  
South Lantau Road,  
Near Shek Pik Reservoir, Lantau  
大嶼山石壁水塘附近, 嶼南道

DETAILED LANDSCAPE PLAN  
綠化詳圖

drawing no. LPM 0217/L3431 P2  
revision P2  
scale 1:250

**Halcrow**  
合榮中國有限公司

Halcrow China Ltd  
Suite 301, 3F  
Chinachem Golden Plaza  
77 Mody Road, Tsimshatsui East  
Kowloon

office: WORKS DIVISION  
GEOTECHNICAL ENGINEERING OFFICE  
土力工程處工程部

CIVIL ENGINEERING DEPARTMENT  
HONG KONG  
土木工程署

PLANTING SCHEDULE  
綠化表

ABS.	SCIENTIFIC NAME 學名	SPACING (MM) 間距	SIZE (MM) 尺寸	QTY 數量
MIXED WHIPS				
ACA.WAN.	ACACIA WANGIUM 大葉相思	1500	1000 HT.	4
LOP.CON.	LOPHOSTEMON CONFERTUS 紅膠木	1500	1000 HT.	4
GROUND COVER 鋪蓋				
MED.TRI.	MEIBELIA THILANDIA 三裂蓬萊組菊	1500	200 x 250	862
CLIMBER 攀援植物				
PAR.HIL.	PARTHENOCISSUS HIMALAYANA 騰龍藤	1500	1500 LONG	12
HYDROSEEDING AREA 噴草				2327 sq.m

- LEGENDS:  
圖例:
- HYDROSEEDING WITH GROUND COVER AND EROSION CONTROL MAT  
噴草並安裝防沖刷墊
  - ROCKY AREA  
岩石區
  - MASONRY FACING  
砌石面
  - PROPOSED TREE  
新植樹木
  - EXISTING TREE & NO.  
現有的樹木及編號
  - FEATURE BOUNDARY  
特徵邊界
  - CROSS SECTION  
剖面圖

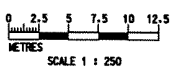



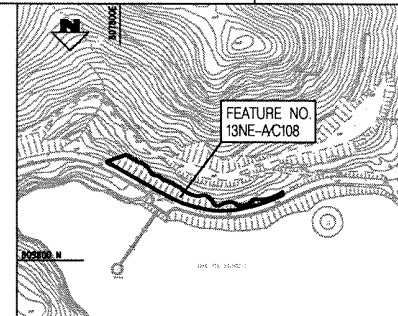

GENERAL NOTES  
 1. THIS DRAWING IS TO BE READ IN CONJUNCTION WITH DRAWING NOS. LPM0217/022-3441, 3442, 3443, STANDARD DRAWINGS AND ALL OTHER RELEVANT DRAWINGS, THE SPECIFICATIONS AND INSTRUCTIONS ISSUED BY THE ENGINEER.  
 2. ALL DIMENSIONS ARE IN METRES UNLESS OTHERWISE SPECIFIED.  
 3. ALL LEVELS ARE IN METRES ABOVE PRINCIPAL DATUM.  
 4. THE EXACT BOUNDARY OF THE WORKS SITE AND THE WORKS AREA SHALL BE CONFIRMED BY THE ENGINEER ON SITE.

LEGENDS:  
 圖例:  
 (T1740(R)) EXISTING TREE TO BE RETAINED  
 需保留的現有樹木  
 (T1833(F)) EXISTING TREE TO BE FELLED  
 需採伐的現有樹木

no.	date	description	initial
P2	07.02	AS PER ENGR'S COMMENT	
P1	05.02	ISSUE FOR COMMENT	AD

no.	date	description	initial
REVISION			
		name	date
surveyed		LEUNG SHOU CHUN SURVEYING CONSULTANTS LTD.	MAR.02
designed		MP (URBIS)	MAY.02
drawn		CH (URBIS)	MAY.02
traced		LC (URBIS)	MAY.02
checked		AD (URBIS)	MAY.02
approved			

Director, Halcrow China Ltd.  
 Des: \_\_\_\_\_  
 file no: E:\geotech\pmt\TRANSLATION\3441-1p3-CH.dgn  
 project no: AGREEMENT NO. CE402000  
 10-YEAR EXTENDED LPM PROJECT - PHASE 2, PACKAGE G  
 合約編號CE40/2000  
 延續十年的防止山泥傾瀉計劃第二期第G組  
 contract: CONTRACT NO. GE200217  
 10-YEAR EXTENDED LPM PROJECT PHASE 2 PACKAGE G LANDSLIP PREVENTIVE WORKS FOR SLOPES AND RETAINING WALLS  
 合約編號GE/2002/17  
 延續十年的防止山泥傾瀉計劃第二期第G組  
 斜坡和牆土牆  
 防止山泥傾瀉工程

drawing title: FEATURE No. 13NE-AC108  
 斜坡編號  
 Shek Pik Reservoir, Lantau Island  
 大嶼山石壁水塘  
 TREE FELLING PLAN (SHEET 1 OF 2)  
 採伐樹木圖 (第一張)  
 drawing no. LPM 0217 / L3441.1  
 revision P3  
 scale AS SHOWN

**Halcrow**  
 合眾中國有限公司  
 Halcrow China Ltd  
 Suite 301, 3F  
 Citispace, Golden Plaza  
 77 Mody Road, Tsimshatsui East  
 Kowloon

office: WORKS DIVISION  
 GEOTECHNICAL ENGINEERING OFFICE  
 土力工程處工程室

CIVIL ENGINEERING DEPARTMENT  
 HONG KONG  
 土木工程署

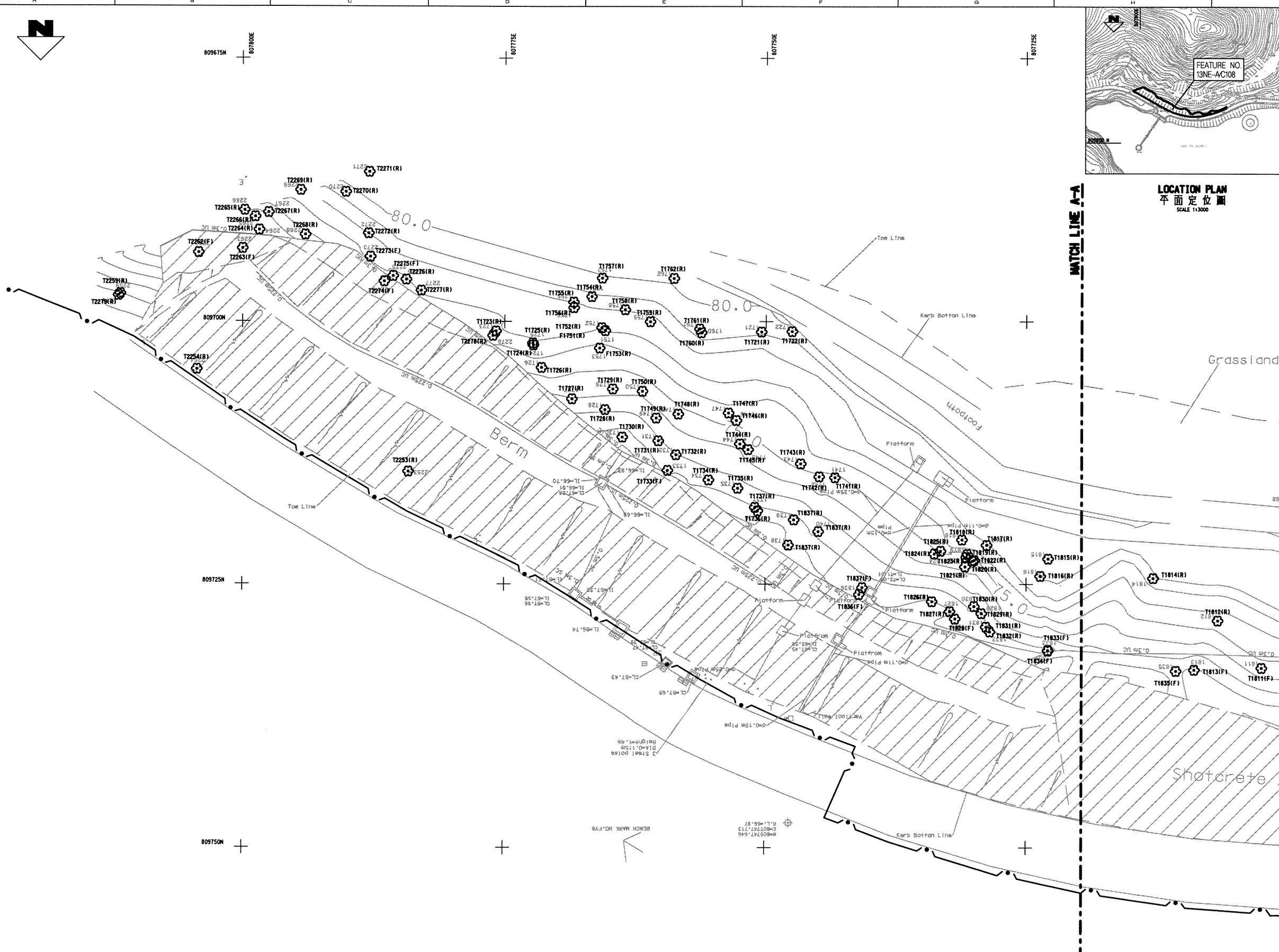

TREE FELLING PLAN  
 採伐樹木圖  
 SCALE 1:150

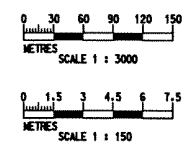

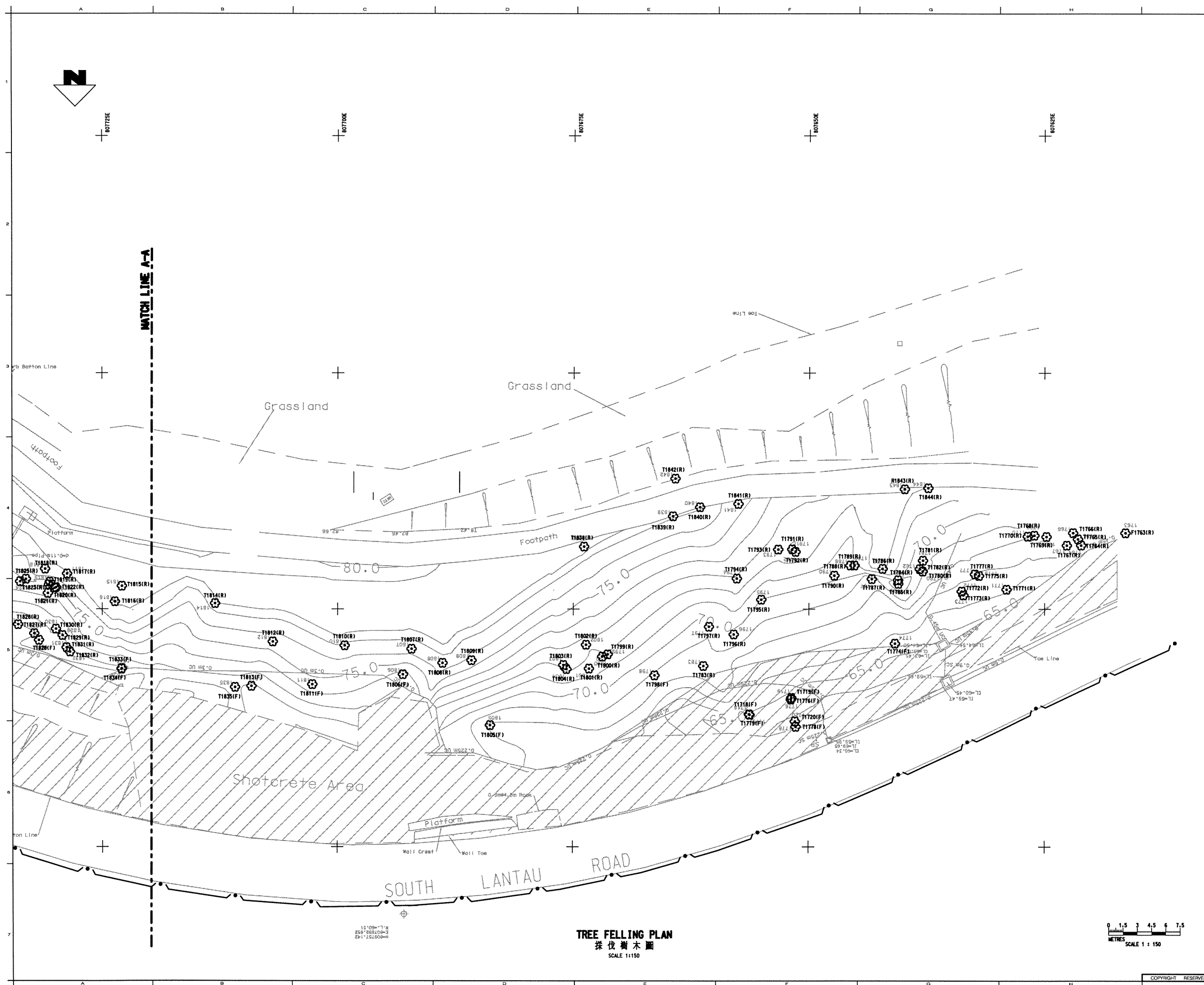

- GENERAL NOTES
- THIS DRAWING IS TO BE READ IN CONJUNCTION WITH DRAWING NOS. LPM0217/002-3441-3442-3443, STANDARD DRAWINGS AND ALL OTHER RELEVANT DRAWINGS, THE SPECIFICATIONS AND INSTRUCTIONS ISSUED BY THE ENGINEER.
  - ALL DIMENSIONS ARE IN METRES UNLESS OTHERWISE SPECIFIED.
  - ALL LEVELS ARE 1M METRES ABOVE PRINCIPAL DATUM.
  - THE EXACT BOUNDARY OF THE WORKS SITE AND THE WORKS AREA SHALL BE CONFIRMED BY THE ENGINEER ON SITE.

- LEGENDS:
- 圖例:
- T1740(R) EXISTING TREE TO BE RETAINED  
需保留的現有樹木
  - T1833(F) EXISTING TREE TO BE FELLED  
需採伐的現有樹木

P2	07.02	AS PER ENGR'S COMMENT	
P1	05.02	ISSUE FOR COMMENT	AD
no.	date	description	initial
REVISION			
surveyed	LEUNG SHOU CHUN SURVEYING CONSULTANTS LTD.		MAR.02
designed	MP (URBIS)		MAY.02
drawn	CH (URBIS)		MAY.02
checked	LC (URBIS)		MAY.02
approved	AD (URBIS)		MAY.02

file no: E:\geog\lpm\TRANSLATION\3441-2p3-Ch.dgn

project no: AGREEMENT NO. CE402000  
10-YEAR EXTENDED LPM PROJECT - PHASE 2, PACKAGE G  
合約編號CE402000  
延緩十年的防止山泥傾瀉計劃第二期工程

contract: CONTRACT NO. GE200217  
10-YEAR EXTENDED LPM PROJECT PHASE 2, PACKAGE G - LANDSLIP PREVENTIVE WORKS FOR SLOPES AND RETAINING WALLS  
合約編號GE200217  
延緩十年的防止山泥傾瀉計劃第二期工程  
斜坡和擋土牆防止山泥傾瀉工程

drawing title: FEATURE No. 13NE-AC108  
斜坡編號  
Shek Pik Reservoir, Lantau Island  
大嶼山石壩水壩

TREE FELLING PLAN  
(SHEET 2 OF 2)  
採伐樹木圖(第二張)

drawing no.	revision	scale
LPM 0217 /L3441.2	P3	AS SHOWN

**Halcrow**  
合豐中國有限公司

Halcrow China Ltd.  
Suite 301, 4/F  
Chinachem Golden Plaza  
77 Mody Road, Tsimshatsui East  
Kowloon

office: WORKS DIVISION  
GEOTECHNICAL ENGINEERING OFFICE  
土力工程處工程課

CIVIL ENGINEERING DEPARTMENT  
HONG KONG  
土木工程署

TREE FELLING PLAN  
採伐樹木圖  
SCALE 1:150

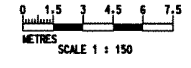

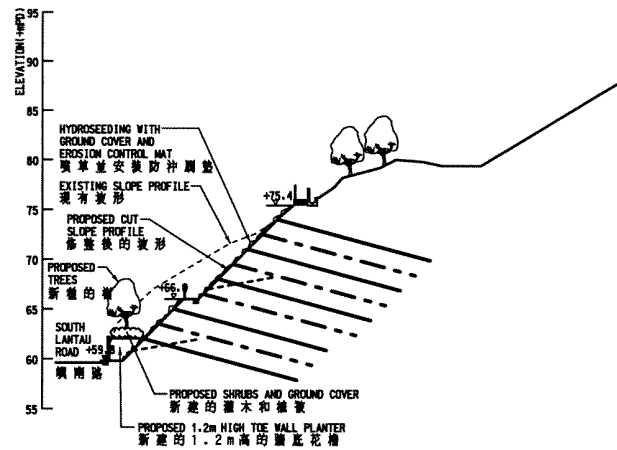

SECTION A-A  
剖面 A-A  
SCALE 1:300

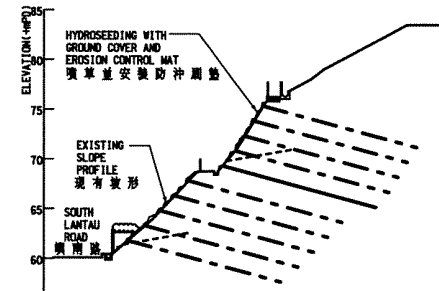

SECTION B-B  
剖面 B-B  
SCALE 1:300

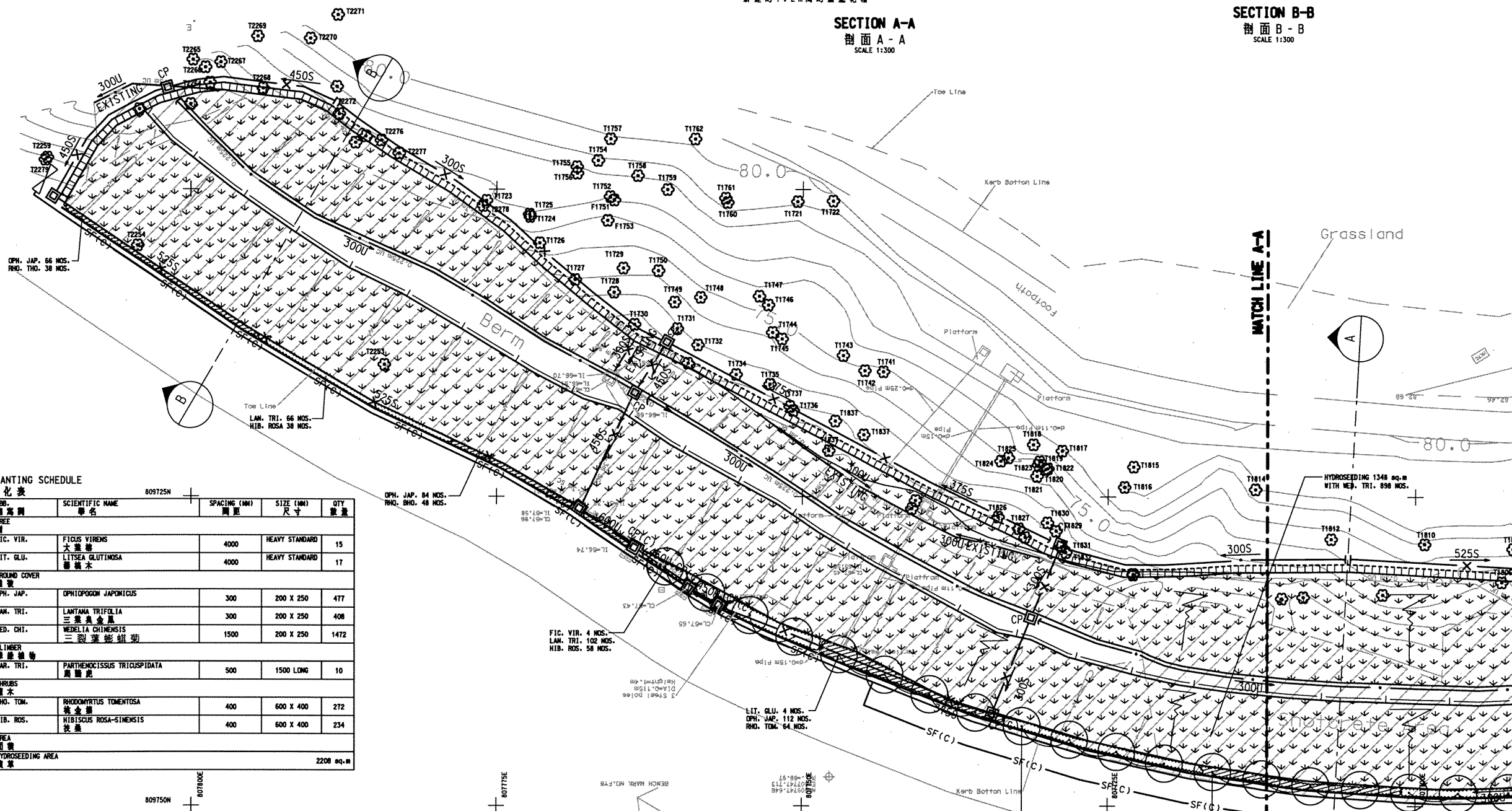

PLANTING SCHEDULE  
植化表

樹種	SCIENTIFIC NAME	SPACING (MM)	SIZE (MM)	QTY
<b>TREE</b>				
FIG. VIR.	FIGUS VIRENS 大葉榕	4000	HEAVY STANDARD	15
LIT. GLU.	LITSEA GLUTINOSA 鹽樹木	4000	HEAVY STANDARD	17
<b>GROUND COVER</b>				
OPH. JAP.	OPHIPOGON JAPONICUS	300	200 X 250	417
LAN. TRI.	LANTANA TRIFOLIA 三葉奧金蓮	300	200 X 250	408
MED. CHI.	MEDELLA CHINENSIS 三裂葉蛇蠍菊	1500	200 X 250	1472
<b>CLIMBER</b>				
PAR. TRI.	PARTHENOCISSUS TRICUSPIDATA 馬蹄虎	500	1500 LONG	10
<b>SHRUBS</b>				
RHO. TOM.	RHODOMYRTUS TOMENTOSA 桃金娘	400	600 X 400	272
HIB. ROS.	HIBISCUS ROSA-SINENSIS 扶桑	400	600 X 400	234
<b>AREA</b>				
HYDROSEEDING AREA				2208 sq.m

LEGEND  
圖例



DETAILED LANDSCAPE AND COMPENSATORY PLAN  
補償和綠化詳圖  
SCALE 1:150

**GENERAL NOTES**

- THIS DRAWING IS TO BE READ IN CONJUNCTION WITH DRAWING NOS. LPM0217/002, 3442, 3443, L3441, STANDARD DRAWINGS AND ALL OTHER RELEVANT DRAWINGS, THE SPECIFICATION AND INSTRUCTIONS ISSUED BY THE ENGINEER.
- ALL DIMENSIONS ARE IN MILLIMETRES UNLESS OTHERWISE SPECIFIED.
- ALL LEVELS ARE IN MILLIMETRES ABOVE PRINCIPAL DATUM.
- THE EXACT BOUNDARY OF THE WORK SITE AND WORKS AREA SHALL BE CONFIRMED BY THE ENGINEER ON SITE.

**NOTES FOR CARE AND PROTECTION OF EXISTING TREES**

- NO TREES SHALL BE FELLED WITHOUT APPROVAL OF THE ENGINEER IN WRITING.
- PRIOR TO COMMENCEMENT OF WORKS, THE CONTRACTOR SHALL CONFIRM THE EXACT LOCATIONS OF THE EXISTING TREES.
- SPECIAL CARE SHOULD BE TAKEN DURING CONSTRUCTION IN ORDER TO PROTECT ALL EXISTING TREES.
- THE ALIGNMENT OF HOARDING, ACCESS ROADS, WORKING PLATFORMS, DRAINAGE CHANNEL AND STORAGE AREAS SHALL BE ADJUSTED LOCALLY ON SITE TO AVOID DAMAGE TO ALL EXISTING TREES.
- THE FORM AND ALIGNMENT OF DRAINAGE CHANNELS, ACCESS STEP ETC. SHALL BE ADJUSTED LOCALLY ON SITE TO AVOID DAMAGE TO EXISTING TREES.

P3	JUL. 02	AS PER ENGR'S COMMENT	
P2	JUN. 02	ADDITIONAL DETAIL	AD
	MAY. 02	ISSUE FOR COMMENT	AD

no.	date	description	initial

REVISION

no.	date	description	initial

Director, Halcrow China Ltd.  
Date: \_\_\_\_\_

File no. E:\geo\1\p02\TRANSLATION\3442-1p4-CH.dgn

project no. AGREEMENT NO. CE402000  
10-YEAR EXTENDED LPM PROJECT - PHASE 2, PACKAGE G - LANDSLIP PREVENTIVE WORKS FOR SLOPES AND RETAINING WALLS  
合約編號: 40/2000  
延緩十年的防止山泥傾瀉計劃第二階段工程

contract CONTRACT NO. GE200217  
10-YEAR EXTENDED LPM PROJECT PHASE 2, PACKAGE G - LANDSLIP PREVENTIVE WORKS FOR SLOPES AND RETAINING WALLS  
合約編號: 40/2000  
延緩十年的防止山泥傾瀉計劃第二階段工程  
斜坡和牆土牆防止山泥傾瀉工程

drawing title  
FEATURE No. 13NE-AC108  
新渡橋  
Shek Pik Reservoir, Lantau Island  
大嶼山石壙水塘  
DETAILED LANDSCAPE AND COMPENSATORY PLAN  
(SHEET 1 OF 2)  
補償和綠化詳圖 (第一張)

drawing no.	revision	scale
LPM 0217 / L3442.1	P4	AS SHOWN

**Halcrow**  
Halcrow China Ltd.  
Suite 301 3F  
Charterhouse Golden Plaza  
77 Mody Road, Tsimshatsui East  
Kowloon  
合榮中國有限公司

office  
WORKS DIVISION  
GEOTECHNICAL ENGINEERING OFFICE  
土力工程處工程科

CIVIL ENGINEERING  
DEPARTMENT  
HONG KONG  
土木工程署

SCALE 1:300  
SCALE 1:150

COPYRIGHT RESERVED

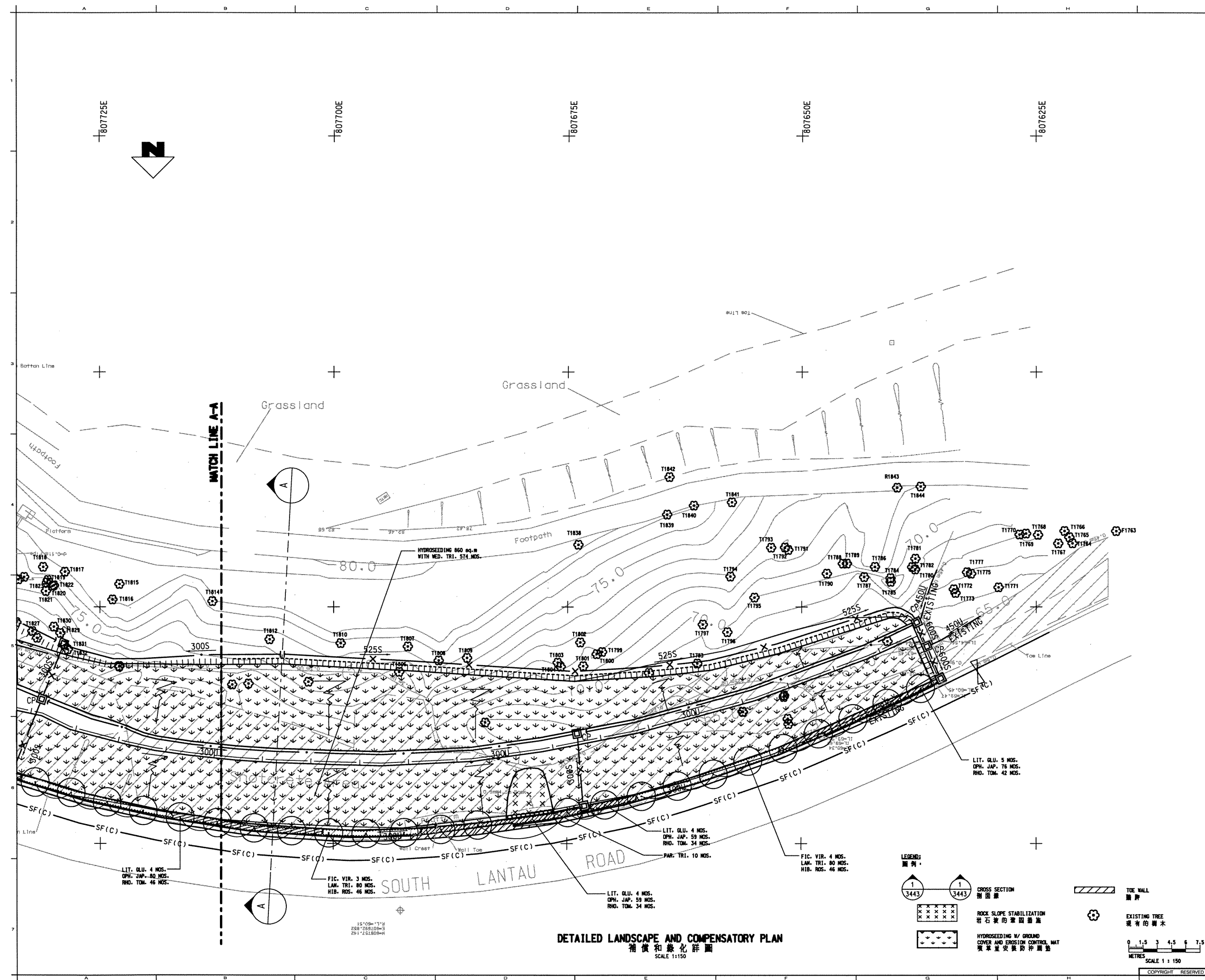

NOTES FOR CARE AND PROTECTION OF EXISTING TREES  
 1. NO TREES SHALL BE FELLED WITHOUT APPROVAL OF THE ENGINEER IN WRITING.  
 2. PRIOR TO COMMENCEMENT OF WORKS, THE CONTRACTOR SHALL CONFIRM THE EXACT LOCATIONS OF THE EXISTING TREES.  
 3. SPECIAL CARE SHOULD BE TAKEN DURING CONSTRUCTION IN ORDER TO PROTECT ALL EXISTING TREES.  
 4. THE ALIGNMENT OF HOARDING, ACCESS ROADS, WORKING PLATFORMS, DRAINAGE CHANNEL AND STORAGE AREAS SHALL BE ADJUSTED LOCALLY ON SITE TO AVOID DAMAGE TO ALL EXISTING TREES.  
 5. THE FORM AND ALIGNMENT OF DRAINAGE CHANNELS, ACCESS STEP ETC. SHALL BE ADJUSTED LOCALLY ON SITE TO AVOID DAMAGE TO EXISTING TREES.

no.	date	description	initial
P3	JUL. 02	AS PER EMGR'S COMMENT	AD
P2	JUN. 02	ADDITIONAL DETAIL	AD
	MAY. 02	ISSUE FOR COMMENT	AD

no.	date	description	initial
1			
2			
3			
4			
5			

name	date
LEUNG SHOU CHUN SURVEYING CONSULTANTS LTD.	MAR. 02
MP (URBIS)	MAY. 02
DN (URBIS)	MAY. 02
LC (URBIS)	MAY. 02

file no. E:\000\000\TRANSLATION\3442-2p4-01.vxd  
 project no. AGREEMENT NO. CE402000  
 10-YEAR EXTENDED LPM PROJECT - PHASE 2, PACKAGE G  
 合約編號CE402000  
 延緩十年的防止山泥傾瀉計劃第二期第6組  
 contract CONTRACT NO. GE200217  
 10-YEAR EXTENDED LPM PROJECT PHASE 2, PACKAGE G LANDSLIP PREVENTIVE WORKS FOR SLOPES AND RETAINING WALLS  
 合約編號GE/2002/17  
 延緩十年的防止山泥傾瀉計劃第二期第6組  
 綠化和補土工程  
 防止山泥傾瀉工程

drawing title  
**FEATURE No. 13NE-AC108**  
 綠化補土  
 Shek Pik Reservoir, Lantau Island  
 大嶼山石壙水塘  
 DETAILED LANDSCAPE AND COMPENSATORY PLAN  
 (SHEET 2 OF 2)  
 補償和綠化詳圖 (第二張)

drawing no.	revision	scale
LPM 0217 / L3442	P4	AS SHOWN

**Halcrow**  
 合眾中國有限公司  
 Halcrow China Ltd.  
 Suite 301 3F  
 Citicorham Golden Plaza  
 77 Mody Road, Tsimshatsui East  
 Kowloon

office  
 WORKS DIVISION  
 GEOTECHNICAL ENGINEERING OFFICE  
 土力工程處工程部

CIVIL ENGINEERING DEPARTMENT  
 HONG KONG  
 土力工程處

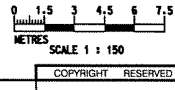

- LEGEND  
 圖例
- 1 3443 CROSS SECTION 剖面圖
  - XXXXXX ROCK SLOPE STABILIZATION 岩石裝的草四邊
  - HYDROSEEDING W/ GROUND COVER AND EROSION CONTROL MAT 噴草並安裝防沖網墊
  - TOE WALL 腳碑
  - EXISTING TREE 現有的樹木

DETAILED LANDSCAPE AND COMPENSATORY PLAN  
 補償和綠化詳圖  
 SCALE 1:150

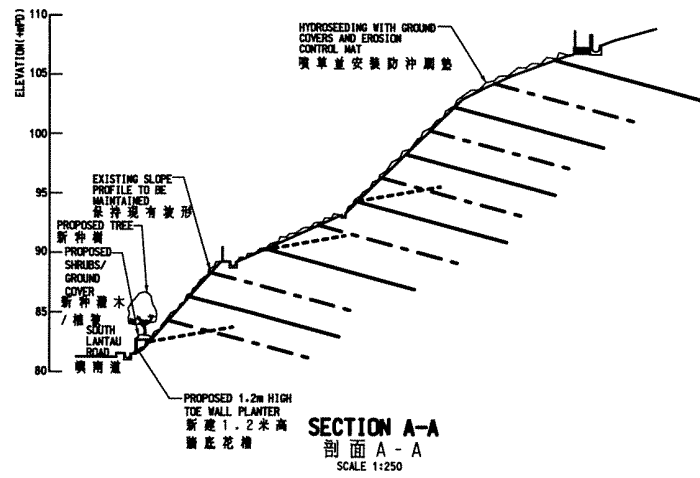

**SECTION A-A**  
剖面 A-A  
SCALE 1:250

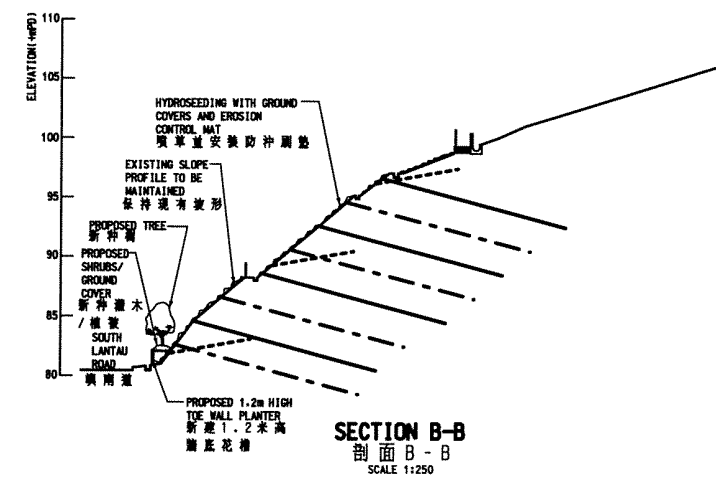

**SECTION B-B**  
剖面 B-B  
SCALE 1:250

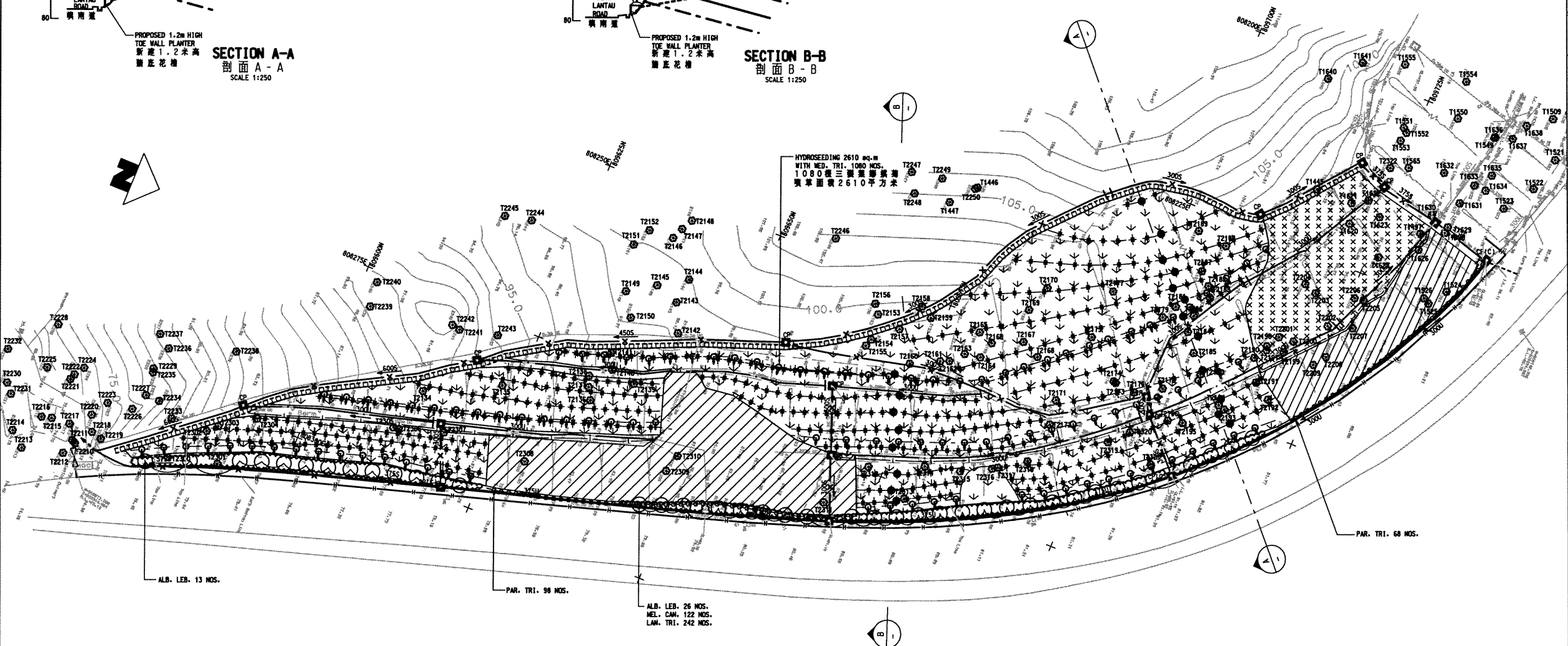

**DETAILED LANDSCAPE PLAN**  
綠化詳圖  
SCALE 1:250

**PLANTING SCHEDULE**  
綠化表

ABB.	SCIENTIFIC NAME 學名	SPACING (MM) 間距	SIZE (MM) 尺寸	QTY 數量
<b>TREE</b>				
ALB. LEB.	ALBIRIA LEBREK 大葉合歡	3000	STANDARD	39
<b>GROUND COVER</b>				
MED. CHI.	MEDELIA CHINENSIS 三鞭葉腳葉菊	1500	250 X 200	1080
<b>SHRUBS</b>				
MEL. CAN.	MELASTOMA CANDIDUM 野牡丹	400	600 X 400	406
LAN. TRI.	LANTANA TRIFOLIA	300	250 X 250	398
<b>CLIMBER</b>				
PAR. TRI.	PARTHENOCLISSUS TRICUSPIDATA	500	1500 LONG	166
HYDROSEEDING AREA 噴草				AREA 面積 2610 sq.m

**LEGEND**

	CROSS SECTION 剖面線		ROCK STABILIZATION MEASURES 岩石固齒基		SHRUBS/GROUND COVER 灌木/噴草
	EXISTING TREE & NO. 現有的樹木及編號		EXPOSED ROCK SURFACE 現有岩石表面		CLIMBER 攀援植物
	TOE WALL PLANTER 腳底花槽		HYDROSEEDING WITH GROUND COVERS AND EROSION CONTROL MAT 噴草並安裝防沖刷墊		

- GENERAL NOTES**
- THIS DRAWING IS TO BE READ IN CONJUNCTION WITH DRAWING NOS. LPM0217/3531, L3531, L3531, STANDARD DRAWINGS AND ALL OTHER RELEVANT DRAWINGS. THE SPECIFICATIONS AND INSTRUCTIONS ISSUED BY THE ENGINEER.
  - ALL DIMENSIONS ARE IN MILLIMETRES UNLESS OTHERWISE SPECIFIED.
  - ALL LEVELS ARE IN MILLIMETRES ABOVE PRINCIPAL DATUM.
  - THE EXACT BOUNDARY OF THE WORKS SITE AND WORKS AREA SHALL BE CONFIRMED BY THE ENGINEER ON SITE.
- NOTES FOR CARE AND PROTECTION OF EXISTING TREES**
- NO TREES AND FERNS SHALL BE FELLED WITHOUT APPROVED OF THE ENGINEER IN WRITING. THE CONTRACTOR SHALL EXERCISE DUE CARE ON SITE TO AVOID DAMAGE TO ALL EXISTING TREES.
  - PRIOR TO COMMENCEMENT OF WORKS, THE CONTRACTOR SHALL CONFIRM THE EXACT LOCATIONS OF THE EXISTING TREES.
  - SPECIAL CARE SHOULD BE TAKEN DURING CONSTRUCTION IN ORDER TO PROTECT ALL EXISTING TREES.
  - WHERE EXISTING SPRAY CONCRETE IS TO BE REMOVED CARE SHALL BE TAKEN NOT TO DISTURB TREE ROOTS LYING IMMEDIATELY UNDER THE SURFACE.
  - THE ALIGNMENT OF HOARDING, ACCESS ROUTES, WORKING PLATFORMS AND STORAGE AREAS SHALL BE ADJUSTED LOCALLY ON SITE TO AVOID DAMAGE TO EXISTING TREES.
  - THE FORM AND ALIGNMENT OF DRAINAGE CHANNELS, ACCESS STEP ETC. SHALL BE ADJUSTED LOCALLY ON SITE TO AVOID DAMAGE TO EXISTING TREES.

no.	date	description	initial
P2	JUL-02	AS PER ENGR'S COMMENT	AD
P1	JUN-02	ISSUE FOR COMMENT	AD

**REVISION**

name	date
LEUNG SHOU CHUN SURVEYING CONSULTANTS LTD.	APR. 02
AD/LC (URB15)	JUN. 02
CD (URB15)	JUN. 02
LC (URB15)	JUN. 02
AD (URB15)	JUN. 02

file no. E:\gpc\p\TRANSLATION\13531\F3-CH.dgn

project no. AGREEMENT NO. CE402000  
10-YEAR EXTENDED  
LPM PROJECT -  
PHASE 2, PACKAGE G  
合約編號 CE40/2000  
延緩十年的防止山泥傾瀉  
計劃第二期綠化

contract CONTRACT NO. GE200217  
10-YEAR EXTENDED LPM PROJECT  
PHASE 2, PACKAGE G  
LANDSLIP PREVENTIVE WORKS  
FOR SLOPES AND RETAINING WALLS  
合約編號 GE/2002/17  
延緩十年的防止山泥傾瀉  
計劃第二期綠化  
噴草和植土  
防止山泥傾瀉工程

drawing title  
**FEATURE No. 13NE-AC133**  
**綠化編號 13NE-AC133**  
Shek Pik Reservoir, Lantau Island  
大嶼山石壩水塘

**DETAILED LANDSCAPE PLAN**  
綠化詳圖

drawing no.	revision	scale
LPM 0217 / L3531	P2	1 : 250

**Halcrow**  
合榮中國有限公司

Halcrow China Ltd.  
Suite 301, 3F  
Chinachem Golden Plaza  
77 Mody Road, Tsimshatsui East  
Kowloon

office  
WORKS DIVISION  
GEOTECHNICAL ENGINEERING OFFICE  
土木工程處工程部

CIVIL ENGINEERING  
DEPARTMENT  
HONG KONG  
土木工程署

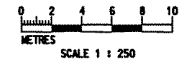

SCALE 1 : 250

COPYRIGHT RESERVED