

MTR Corporation Limited

West Island Line Project

Audit Report – Part 4
(On-site and Off-site Compensatory Trees of Sai Ying Pun &
HKU Stations)

Verified by:  _____

Position: Independent Environmental Checker

Date: 17 March 2017

MTR Corporation Limited

West Island Line Project

Audit Report – Part 4 (On-site and Off-site Compensatory Trees of Sai Ying Pun & HKU Stations)

Certified by:  _____

Position: Environmental Team Leader

Date: 17 March 2017

West Island Line
Consultancy Agreement No. C735F
Arborist for Tree Protection

**Audit Report for the On-site and Off-site
Compensatory Trees of Sai Ying Pun & HKU
Stations**



Prepared by:	Reviewed by:	Approved by:
Patty Chu	Rachel Siu	Wen Wong
		
Date: 24 Feb 2017	Date : 24 Feb 2017	Date: 24 Feb 2017

Table of Contents

1	Introduction	2
2	Tree Audit and Findings	3
3	Conclusion	5

Appendix A – Compensatory Planting Proposal of Ki Ling Lane Playground (SYP Entrance B3) and Off-site Areas for SYP and HKU Stations in the TPP (Rev. F)

Appendix B – Landscape As-built Drawings for the Compensatory Trees at Ki Ling Lane Playground (SYP Entrance B3) and Off-site Areas for SYP and HKU Stations

Appendix C – Photographic Record of the Compensatory during Inspection

1 Introduction

Muni Arborist Ltd (MAL) was commissioned by MTR Corporation (MTR) to conduct audit inspections and to prepare the Audit Report, as required by the Environmental Permit No. EP-313/2008/J. The Audit Report is to present findings of tree audit inspections for the implementation of recommendations in the Tree Protection Plan (TPP), which was submitted under the EP Condition 2.7.

As the program of completing the construction works and landscaping works (as well as compensatory trees planting) vary in different locations, audit inspections have been carried out in different time periods when the landscaping works were completed. Audit Report – Part 1 for compensatory trees for the Magazine site was submitted on 14 November 2014, and was approved on 15 January 2015. Audit Report – Part 2 for compensatory trees for the construction of Kennedy Town Station (KET) was submitted on 4 February 2015, and was approved on 17 June 2015. Audit Report – Part 3 for compensatory trees for the construction of Sai Ying Pun Station (SYP) and HKU Station (HKU) was submitted on 25 June 2016.

This report is Part 4 of the Audit Report; it is the last part of the Audit Report for the West Island Line. This report presents the findings of the audit inspection for the compensatory trees planted in Ki Ling Lane Playground (SYP Entrance B3) and the off-site planting of compensatory trees for SYP and HKU. The audit inspection was conducted on 13 February 2017.

2 Tree Audit and Findings

An audit inspection was carried on 13 February 2017. The compensatory trees were planted at the following on-site and off-site locations:

- Ki Ling Lane Playground (SYP Entrance B3)
- Western District near Fung Mat Road
- Central and Western District Promenade – Sheung Wan Section
- Sun Yat Sen Memorial Park

The tree species proposed in the compensatory planting proposal in TPP (Rev. F) are as follows:

Ki Ling Lane Playground (SYP Entrance B3)

Type	Botanical Name	Chinese Common Name	No(s).
Tree	<i>Ficus benjamina</i>	垂葉榕	10
Tree	<i>Hibiscus tiliaceus</i>	黃槿	9
Tree	<i>Jacaranda mimosifolia</i>	藍花楹	4
Tree	<i>Michelia x alba</i>	白蘭	5

Western District near Fung Mat Road

Type	Botanical Name	Chinese Common Name	No(s).
Tree	<i>Bauhinia variegata</i>	宮粉羊蹄甲	1
Tree	<i>Syzygium jambos</i>	蒲桃	1
Tree	<i>Melaleuca cajuputi</i> subsp. <i>cumingiana</i>	白千層	6
Tree	<i>Phoenix roebelenii</i>	日本葵	37

Central and Western District Promenade – Sheung Wan Section

Type	Botanical Name	Chinese Common Name	No(s).
Tree	<i>Tabebuia chrysantha</i> (syn. <i>Tabebuia chrysotricha</i>)	風鈴木	19

Sun Yat Sen Memorial Park

Type	Botanical Name	Chinese Common Name	No(s).
Tree	<i>Magnolia grandiflora</i>	荷花玉蘭	1

Among these 93 trees in the TPP (Rev. F), the inspection findings are 80 trees differ from the compensatory planting proposal in size (9 trees), in tree location (27 trees), in tree species (14 trees), in both size and species (8 trees), in both location and species (8 trees) and in both size and location (6 trees); and 8 trees are not found; and the other 13 trees are the same as recommended in the TPP (Rev. F). In addition, 33 additional trees are found for off-site tree compensation of SYP and HKU.

The differences between the proposal in TPP (Rev. F) and the actual plantings include variations of tree sizes, species and locations, relocation of the 8 “not found” trees, and 33 additional trees. According to MTR, all these differences have been agreed with the representatives of maintenance party on site. These variations are included in the subsequent updates of the Tree Removal Applications (TRA); and are reflected in the landscape as-built drawings in Appendix B. As informed by MTR, all these compensatory trees have been handed over to Leisure and Cultural Services Department (LCSD).

Details of inspection findings are as follows:

Ki Ling Lane Playground (SYP Entrance B3)

- 6 *Ficus benjamina* proposed in the compensatory planting proposal are not found.
- 4 *Ficus benjamina* in the compensatory planting proposal are replaced with 4 *Bauhinia variegata*.
- 5 *Michelia x alba* in the compensatory planting proposal are replaced with 3 *Magnolia grandiflora* and 2 *Bauhinia variegata*.
- 5 *Hibiscus tiliaceus* in the compensatory planting proposal are replaced with 5 *Tabebuia chrysotricha*.
- 8 undersized *Garcinia subelliptica* are found on site to replace the 4 *Hibiscus tiliaceus* and 4 *Jacaranda mimosifolia* in the compensatory planting proposal.
- Overall trees health and form are in fair condition.

Western District near Fung Mat Road

- 8 trees (6 *Melaleuca cajuputi* subsp. *Cumingiana*, 1 *Syzygium jambos* and 1 *Bauhinia variegata*) are replaced with *Phoenix roebelenii* and have been located differently from the TPP (Rev.F).
- 26 trees *Phoenix roebelenii* differ from the compensatory planting proposal in tree location.
- Overall trees health and form are in fair condition.

Central and Western District Promenade – Sheung Wan Section

- 2 *Tabebuia chrysotricha* are not found.
- 9 trees (Tree ID: T35, T36, T37, T43, T44, T45, T46, T47 and T48 in Appendix B) differ from the compensatory planting proposal in size.
- 1 tree (Tree ID: T38 in Appendix B) differ from the compensatory planting proposal in tree location.
- 6 trees (Tree ID: T39, T40, T41, T42, T50 and T51 in Appendix B) differ from the compensatory planting proposal in both size and location.
- Overall trees health and form are in fair condition.

Sun Yat Sen Memorial Park

- 24 additional *Garcinia subelliptica*, 6 additional *Brachychiton acerifolius*, and 3 additional *Magnolia grandiflora* are found on site.
- Overall trees health and form are in fair condition.

Appendix A is the compensatory planting proposal of Ki Ling Lane Playground (SYP Entrance B3) and off-site areas of compensatory trees for SYP and HKU in the TPP (Rev. F), Appendix B is the landscape as-built drawings of compensatory trees, and Appendix C is the photographic record of the trees during inspection.

3 Conclusion

Among the 118 compensatory trees in the inspection, some on-site findings vary from the compensatory trees proposal in the TPP (Rev. F). The variations include: tree sizes, tree species and tree locations, due to site constraints, site availability for off-site planting, and preferences of maintenance party. All variations have been agreed by the maintenance

party; and all compensatory trees are handed over. The variations are addressed in the subsequent updates of TRA as well as the as-built drawings in Appendix B.

**Appendix A – Compensatory Planting Proposal of Ki Ling Lane Playground
(SYP EntranceB3) and Off-site Areas for SYP and HKU Stations in the TPP
(Rev. F)**

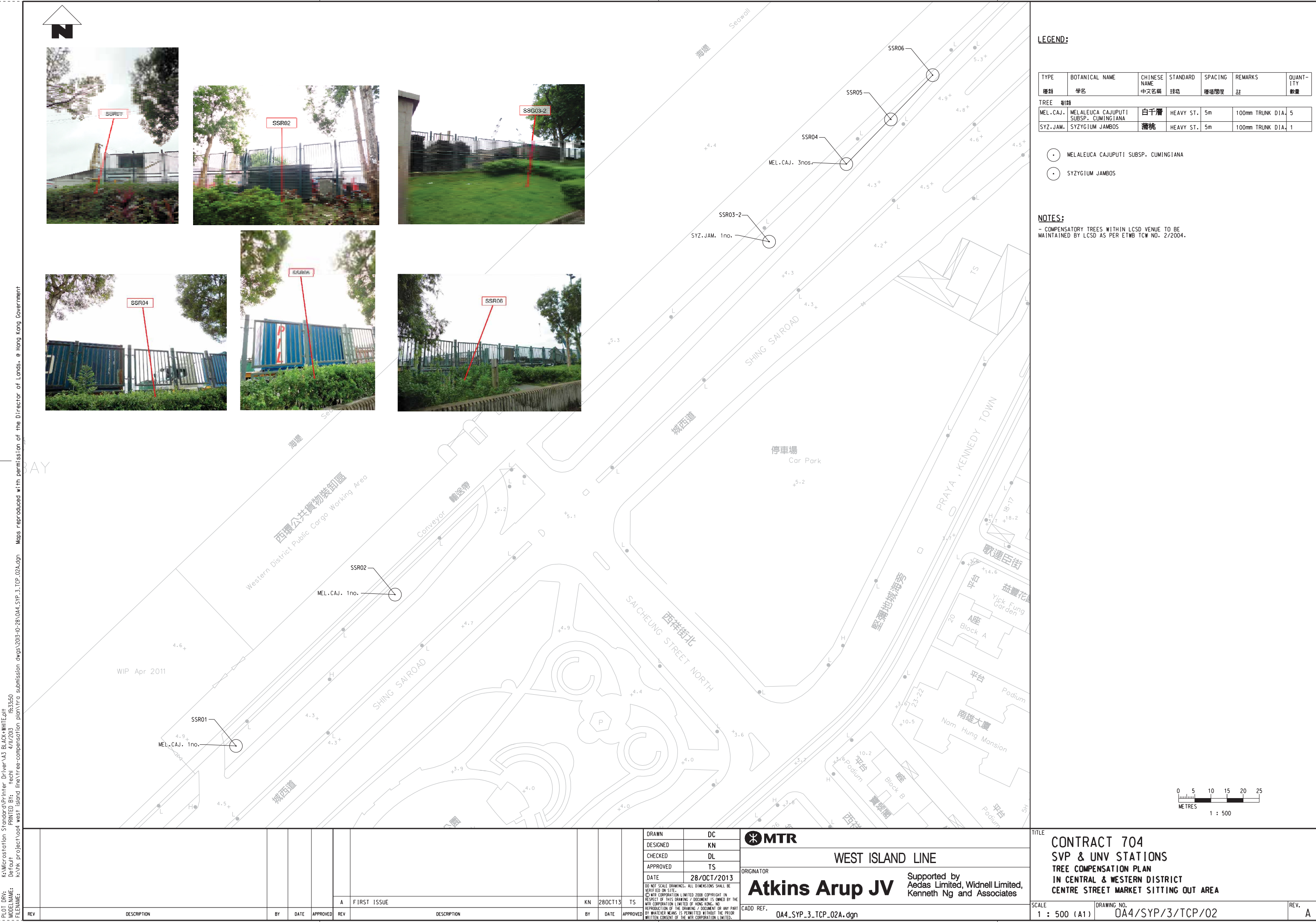

PLOT DRW: K:\Microstation Standard\Printer Driver\A3 BLACK+WHITE.plt 1933550
MODELNAME: Default PRINTED BY: Tech 4/11/2013
FILENAME: K:\HK project\road west\free-compensation plan\tra submission dwgs\2013-10-28\04_SVP_3_TCP_02A.dgn Maps reproduced with permission of the Director of Lands, © Hong Kong Government

DRAWN	DC
DESIGNED	KN
CHECKED	DL
APPROVED	TS
DATE	28/OCT/2013
DO NOT SCALE DRAWINGS. ALL DIMENSIONS SHALL BE VERIFIED ON SITE. © MTR CORPORATION LIMITED 2008 COPYRIGHT IN RESPECT OF THIS DRAWING / DOCUMENT IS OWNED BY THE MTR CORPORATION LIMITED OF HONG KONG. NO REPRODUCTION OF THE DRAWING / DOCUMENT OR ANY PART BY WHATEVER MEANS IS PERMITTED WITHOUT THE PRIOR WRITTEN CONSENT OF THE MTR CORPORATION LIMITED.	

WEST ISLAND LINE

Atkins Arup JV
Supported by
Aedas Limited, Widnell Limited,
Kenneth Ng and Associates

CADD REF. OA4_SYP_3_TCP_02A.dgn

TITLE		CONTRACT 704 SVP & UNV STATIONS TREE COMPENSATION PLAN IN CENTRAL & WESTERN DISTRICT CENTRE STREET MARKET SITTING OUT AREA	
SCALE	1 : 500 (A1)	DRAWING NO.	OA4/SYP/3/TCP/02
REV.	A		



LEGEND:

TYPE	BOTANICAL NAME	CHINESE NAME	STANDARD	SPACING	REMARKS	QUANTITY
樹種	學名	中文名稱	規格	種植間距	註	數量
TREE 樹種						
PHO.ROE.	PHOENIX ROEBELENI	日本葵	HEAVY ST.	5m	100mm TRUNK DIA.	5

● PHOENIX ROEBELENI

NOTES:
- COMPENSATORY TREES WITHIN LCSD VENUE TO BE MAINTAINED BY LCSD AS PER ETWB TCW NO. 2/2004.

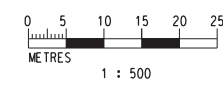
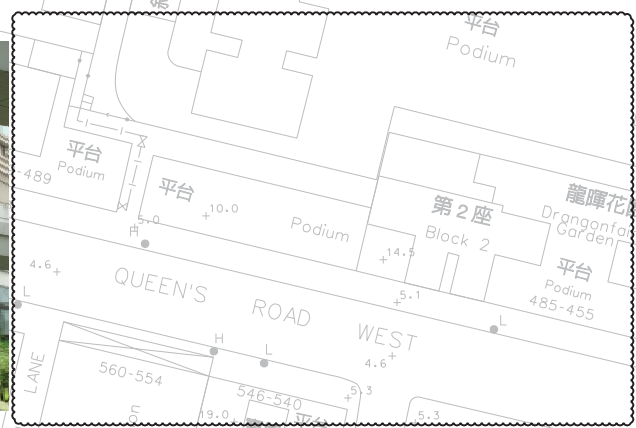
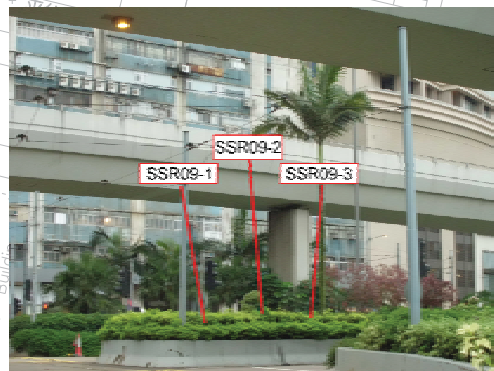

Maps reproduced with permission of the Director of Lands, © Hong Kong Government

PLOT DRY: K:\Microstation Standard\Printer Driver\A3 BLACK+WHITE.ctb 102435
MODELNAME: PRINTED BY: Tech 4/6/2014
FILENAME: K:\HK project\road west island line\tra submission drawing\tra revd - 2004\04_SYP_3_TCP_03B.dgn

																																																																																																																																																																																																																																																																																																																																																																																																																																																																																																																																																																																																																																																																																																																																																																																																																																																																																																																																																																																																																																																																																																																																																																																																																																																																																																																																																																																																																										</
--	--	--	--	--	--	--	--	--	--	--	--	--	--	--	--	--	--	--	--	--	--	--	--	--	--	--	--	--	--	--	--	--	--	--	--	--	--	--	--	--	--	--	--	--	--	--	--	--	--	--	--	--	--	--	--	--	--	--	--	--	--	--	--	--	--	--	--	--	--	--	--	--	--	--	--	--	--	--	--	--	--	--	--	--	--	--	--	--	--	--	--	--	--	--	--	--	--	--	--	--	--	--	--	--	--	--	--	--	--	--	--	--	--	--	--	--	--	--	--	--	--	--	--	--	--	--	--	--	--	--	--	--	--	--	--	--	--	--	--	--	--	--	--	--	--	--	--	--	--	--	--	--	--	--	--	--	--	--	--	--	--	--	--	--	--	--	--	--	--	--	--	--	--	--	--	--	--	--	--	--	--	--	--	--	--	--	--	--	--	--	--	--	--	--	--	--	--	--	--	--	--	--	--	--	--	--	--	--	--	--	--	--	--	--	--	--	--	--	--	--	--	--	--	--	--	--	--	--	--	--	--	--	--	--	--	--	--	--	--	--	--	--	--	--	--	--	--	--	--	--	--	--	--	--	--	--	--	--	--	--	--	--	--	--	--	--	--	--	--	--	--	--	--	--	--	--	--	--	--	--	--	--	--	--	--	--	--	--	--	--	--	--	--	--	--	--	--	--	--	--	--	--	--	--	--	--	--	--	--	--	--	--	--	--	--	--	--	--	--	--	--	--	--	--	--	--	--	--	--	--	--	--	--	--	--	--	--	--	--	--	--	--	--	--	--	--	--	--	--	--	--	--	--	--	--	--	--	--	--	--	--	--	--	--	--	--	--	--	--	--	--	--	--	--	--	--	--	--	--	--	--	--	--	--	--	--	--	--	--	--	--	--	--	--	--	--	--	--	--	--	--	--	--	--	--	--	--	--	--	--	--	--	--	--	--	--	--	--	--	--	--	--	--	--	--	--	--	--	--	--	--	--	--	--	--	--	--	--	--	--	--	--	--	--	--	--	--	--	--	--	--	--	--	--	--	--	--	--	--	--	--	--	--	--	--	--	--	--	--	--	--	--	--	--	--	--	--	--	--	--	--	--	--	--	--	--	--	--	--	--	--	--	--	--	--	--	--	--	--	--	--	--	--	--	--	--	--	--	--	--	--	--	--	--	--	--	--	--	--	--	--	--	--	--	--	--	--	--	--	--	--	--	--	--	--	--	--	--	--	--	--	--	--	--	--	--	--	--	--	--	--	--	--	--	--	--	--	--	--	--	--	--	--	--	--	--	--	--	--	--	--	--	--	--	--	--	--	--	--	--	--	--	--	--	--	--	--	--	--	--	--	--	--	--	--	--	--	--	--	--	--	--	--	--	--	--	--	--	--	--	--	--	--	--	--	--	--	--	--	--	--	--	--	--	--	--	--	--	--	--	--	--	--	--	--	--	--	--	--	--	--	--	--	--	--	--	--	--	--	--	--	--	--	--	--	--	--	--	--	--	--	--	--	--	--	--	--	--	--	--	--	--	--	--	--	--	--	--	--	--	--	--	--	--	--	--	--	--	--	--	--	--	--	--	--	--	--	--	--	--	--	--	--	--	--	--	--	--	--	--	--	--	--	--	--	--	--	--	--	--	--	--	--	--	--	--	--	--	--	--	--	--	--	--	--	--	--	--	--	--	--	--	--	--	--	--	--	--	--	--	--	--	--	--	--	--	--	--	--	--	--	--	--	--	--	--	--	--	--	--	--	--	--	--	--	--	--	--	--	--	--	--	--	--	--	--	--	--	--	--	--	--	--	--	--	--	--	--	--	--	--	--	--	--	--	--	--	--	--	--	--	--	--	--	--	--	--	--	--	--	--	--	--	--	--	--	--	--	--	--	--	--	--	--	--	--	--	--	--	--	--	--	--	--	--	--	--	--	--	--	--	--	--	--	--	--	--	--	--	--	--	--	--	--	--	--	--	--	--	--	--	--	--	--	--	--	--	--	--	--	--	--	--	--	--	--	--	--	--	--	--	--	--	--	--	--	--	--	--	--	--	--	--	--	--	--	--	--	--	--	--	--	--	--	--	--	--	--	--	--	--	--	--	--	--	--	--	--	--	--	--	--	--	--	--	--	--	--	--	--	--	--	--	--	--	--	--	--	--	--	--	--	--	--	--	--	--	--	--	--	--	--	--	--	--	--	--	--	--	--	--	--	--	--	--	--	--	--	--	--	--	--	--	--	--	--	--	--	--	--	--	--	--	--	--	--	--	--	--	--	--	--	--	--	--	--	--	--	--	--	--	--	--	--	--	--	--	--	--	--	--	--	--	--	--	--	--	--	--	--	--	--	--	--	--	--	--	--	--	--	--	--	--	--	--	--	--	--	--	--	--	--	--	--	--	--	--	--	--	--	--	--	--	--	--	--	--	--	--	--	--	--	--	--	--	--	--	--	--	--	--	--	--	--	--	--	--	--	--	--	--	--	--	--	--	--	--	--	--	--	--	--	--	--	--	--	--	--	--	--	--	--	--	--	--	--	--	--	--	--	--	--	--	--	--	--	--	--	--	--	--	--	--	--	--	--	--	--	--	--	--	--	--	--	--	--	--	--	--	--	--	--	--	--	--	--	--	--	--	--	--	--	--	--	--	--	--	--	--	--	--	--	--	--	--	--	--	--	--	--	--	--	--	--	--	--	--	--	--	--	--	--	--	--	--	--	--	--	--	--	--	--	--	--	--	--	--	--	--	--	--	--	--	--	--	--	--	--	--	--	--	--	--	--	--	--	--	--	--	--	--	--	--	--	--	--	--	--	--	--	--	--	--	--	--	--	--	--	--	--	--	--	--	--	--	--	--	--	--	--	--	--	--	--	--	--	--	--	--	--	--	--	--	--	--	--	--	--	--	--	--	--	--	--	--	--	--	--	--	--	--	--	--	--	--	--	--	--	--	--	--	--	--	--	--	--	--	--	--	--	--	--	--	--	--	--	--	--	--	--	--	--	--	--	--	--	--	--	--	--	--	--	--	--	--	--	--	--	--	--	--	--	--	--	--	--	--	--	--	--	--	--	--	--	--	--	--	--	--	--	--	--	--	--	--	--	--	--	--	----

Map reproduced with permission of the Director of Lands, © Hong Kong Government
K:\Microstation Standard\Printer Driver\A1 BLACK-WHITE.dwt 03/21/15
MODELNAME: PRINTED R15 Tech 6/6/2004
FILENAME: kshk project\work west island metro\submission drawing\tra revd -20140404_SYP_4_TCP_01.dgn



LEGEND:

TYPE	BOTANICAL NAME	CHINESE NAME	STANDARD	SPACING	REMARKS	QUANTITY
樹種	樹名	中文名稱	規格	種植間距	註	數量
TREE 樹種						
PHO.ROE.	PHOENIX ROEBELENI	日本葵	ST.	3m	100mm TRUNK DIA. 9	

○ PHOENIX ROEBELENI

NOTES:

- COMPENSATORY TREES WITHIN LCSD VENUE TO BE MAINTAINED BY LCSD AS PER ETWB TCW NO. 2/2004.

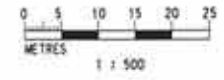

DRAWN MK				DESIGNED KN				CHECKED DL				APPROVED GR				DATE 03/JUNE/2014			
A				FIRST ISSUE				KN				03/JUN/14				GR			
REV	DESCRIPTION				BY	DATE				APPROVED	DESCRIPTION				BY	DATE			

**WEST ISLAND LINE**

Atkins Arup JV
Supported by
Aedas Limited, Widnell Limited,
Kenneth Ng and Associates

CADD REF.
OA4_SYP_4_TCP_01.3A.dgn

TITLE			CONTRACT 704			SVP & UNV STATIONS			TREE COMPENSATION PLAN			IN CENTRAL & WESTERN DISTRICT			SAI WOO LANE		
SCALE			DRAWING NO.			REV.			A								
1 : 500 (A1)			OA4/SYP/4/TCP/01.3														

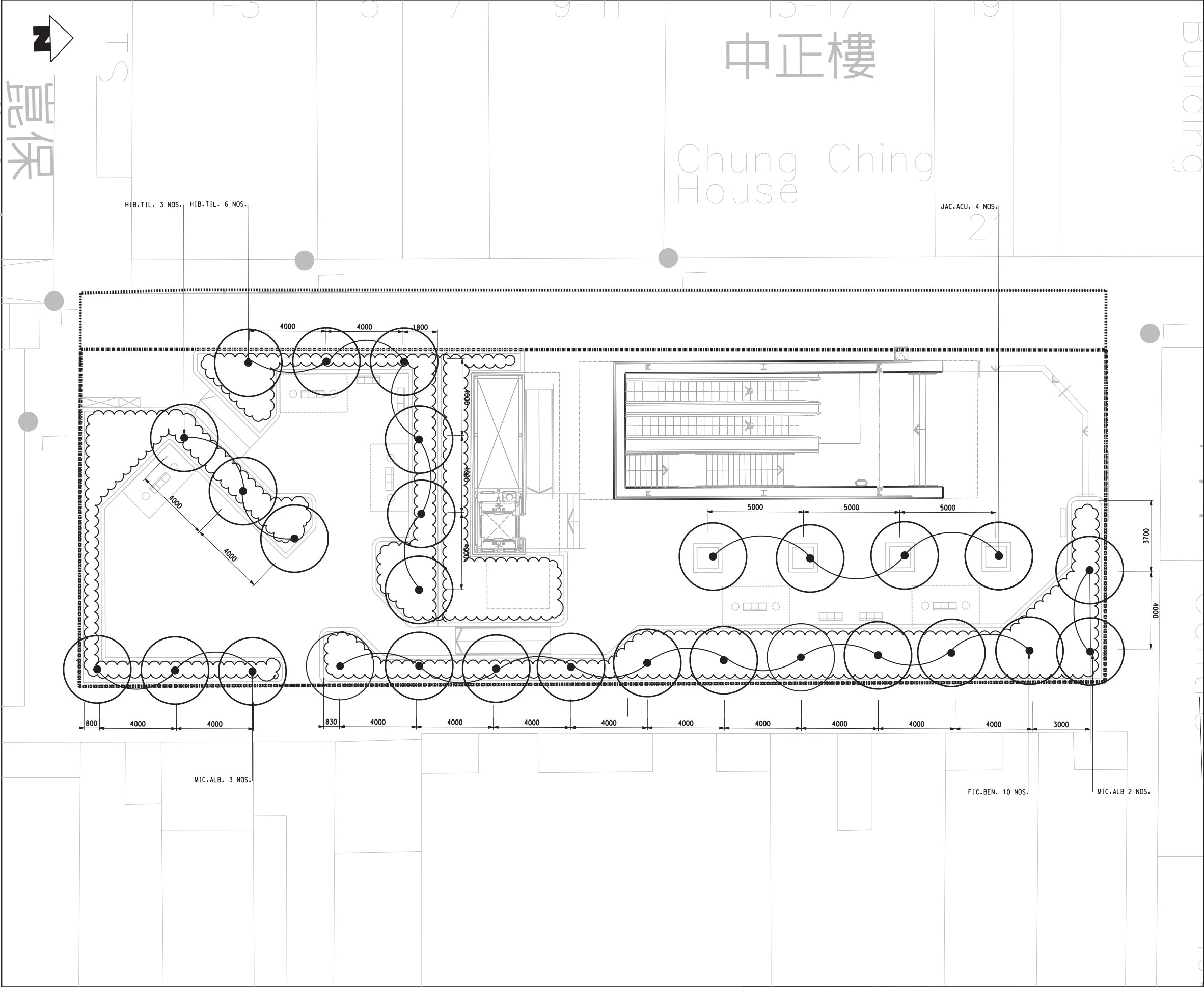

LEGEND:

BOUNDARY LINE

COMPENSATION TREE

SHRUB PLANTING

TYPE	BOTANICAL NAME	CHINESE NAME	STAND-ARD	SPACING	REMARKS	QUANT-ITY
種類	學名	中文名稱	規格	種植間度	註	數量
TREE 樹類						
FIC.BEN.	FICUS BENJAMINA	垂葉榕	HE.ST.	AS SHOWN	100 mm TRUNK DIA.	10
HIB.TIL.	HIBISCUS TILIACEUS	黃槿	HE.ST.	AS SHOWN	100 mm TRUNK DIA.	9
JAC.ACU.	JACARANDA ACUTIFOLIA	藍花楸	HE.ST.	AS SHOWN	100 mm TRUNK DIA.	4
MIC.ALB.	MICHELIA ALBA	白蘭	HE.ST.	AS SHOWN	100 mm TRUNK DIA.	5

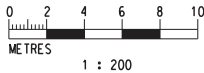

--	--	--	--	--	--	--	--	--	--	--	--	--	--	--	--	--	--	--	--	--	--	--	--	--	--	--	--	--	--	--	--	--	--	--	--	--	--	--	--	--	--	--	--	--	--	--	--	--	--	--	--	--	--	--	--	--	--	--	--	--	--	--	--	--	--	--	--	--	--	--	--	--	--	--	--	--	--	--	--	--	--	--	--	--	--	--	--	--	--	--	--	--	--	--	--	--	--	--	--	--	--	--	--	--	--	--	--	--	--	--	--	--	--	--	--	--	--	--	--	--	--	--	--	--	--	--	--	--	--	--	--	--	--	--	--	--	--	--	--	--	--	--	--	--	--	--	--	--	--	--	--	--	--	--	--	--	--	--	--	--	--	--	--	--	--	--	--	--	--	--	--	--	--	--	--	--	--	--	--	--	--	--	--	--	--	--	--	--	--	--	--	--	--	--	--	--	--	--	--	--	--	--	--	--	--	--	--	--	--	--	--	--	--	--	--	--	--	--	--	--	--	--	--	--	--	--	--	--	--	--	--	--	--	--	--	--	--	--	--	--	--	--	--	--	--	--	--	--	--	--	--	--	--	--	--	--	--	--	--	--	--	--	--	--	--	--	--	--	--	--	--	--	--	--	--	--	--	--	--	--	--	--	--	--	--	--	--	--	--	--	--	--	--	--	--	--	--	--	--	--	--	--	--	--	--	--	--	--	--	--	--	--	--	--	--	--	--	--	--	--	--	--	--	--	--	--	--	--	--	--	--	--	--	--	--	--	--	--	--	--	--	--	--	--	--	--	--	--	--	--	--	--	--	--	--	--	--	--	--	--	--	--	--	--	--	--	--	--	--	--	--	--	--	--	--	--	--	--	--	--	--	--	--	--	--	--	--	--	--	--	--	--	--	--	--	--	--	--	--	--	--	--	--	--	--	--	--	--	--	--	--	--	--	--	--	--	--	--	--	--	--	--	--	--	--	--	--	--	--	--	--	--	--	--	--	--	--	--	--	--	--	--	--	--	--	--	--	--	--	--	--	--	--	--	--	--	--	--	--	--	--	--	--	--	--	--	--	--	--	--	--	--	--	--	--	--	--	--	--	--	--	--	--	--	--	--	--	--	--	--	--	--	--	--	--	--	--	--	--	--	--	--	--	--	--	--	--	--	--	--	--	--	--	--	--	--	--	--	--	--	--	--	--	--	--	--	--	--	--	--	--	--	--	--	--	--	--	--	--	--	--	--	--	--	--	--	--	--	--	--	--	--	--	--	--	--	--	--	--	--	--	--	--	--	--	--	--	--	--	--	--	--	--	--	--	--	--	--	--	--	--	--	--	--	--	--	--	--	--	--	--	--	--	--	--	--	--	--	--	--	--	--	--	--	--	--	--	--	--	--	--	--	--	--	--	--	--	--	--	--	--	--	--	--	--	--	--	--	--	--	--	--	--	--	--	--	--	--	--	--	--	--	--	--	--	--	--	--	--	--	--	--	--	--	--	--	--	--	--	--	--	--	--	--	--	--	--	--	--	--	--	--	--	--	--	--	--	--	--	--	--	--	--	--	--	--	--	--	--	--	--	--	--	--	--	--	--	--	--	--	--	--	--	--	--	--	--	--	--	--	--	--	--	--	--	--	--	--	--	--	--	--	--	--	--	--	--	--	--	--	--	--	--	--	--	--	--	--	--	--	--	--	--	--	--	--	--	--	--	--	--	--	--	--	--	--	--	--	--	--	--	--	--	--	--	--	--	--	--	--	--	--	--	--	--	--	--	--	--	--	--	--	--	--	--	--	--	--	--	--	--	--	--	--	--	--	--	--	--	--	--	--	--	--	--	--	--	--	--	--	--	--	--	--	--	--	--	--	--	--	--	--	--	--	--	--	--	--	--	--	--	--	--	--	--	--	--	--	--	--	--	--	--	--	--	--	--	--	--	--	--	--	--	--	--	--	--	--	--	--	--	--	--	--	--	--	--	--	--	--	--	--	--	--	--	--	--	--	--	--	--	--	--	--	--	--	--	--	--	--	--	--	--	--	--	--	--	--	--	--	--	--	--	--	--	--	--	--	--	--	--	--	--	--	--	--	--	--	--	--	--	--	--	--	--	--	--	--	--	--	--	--	--	--	--	--	--	--	--	--	--	--	--	--	--	--	--	--	--	--	--	--	--	--	--	--	--	--	--	--	--	--	--	--	--	--	--	--	--	--	--	--	--	--	--	--	--	--	--	--	--	--	--	--	--	--	--	--	--	--	--	--	--	--	--	--	--	--	--	--	--	--	--	--	--	--	--	--	--	--	--	--	--	--	--	--	--	--	--	--	--	--	--	--	--	--	--	--	--	--	--	--	--	--	--	--	--	--	--	--	--	--	--	--	--	--	--	--	--	--	--	--	--	--	--	--	--	--	--	--	--	--	--	--	--	--	--	--	--	--	--	--	--	--	--	--	--	--	--	--	--	--	--	--	--	--	--	--	--	--	--	--	--	--	--	--	--	--	--	--	--	--	--	--	--	--	--	--	--	--	--	--	--	--	--	--	--	--	--	--	--	--	--	--	--	--	--	--	--	--	--	--	--	--	--	--	--	--	--	--	--	--	--	--	--	--	--	--	--	--	--	--	--	--	--	--	--	--	--	--	--	--	--	--	--	--	--	--	--	--	--	--	--	--	--	--	--	--	--	--	--	--	--	--	--	--	--	--	--	--	--	--	--	--	--	--	--	--	--	--	--	--	--	--	--	--	--	--	--	--	--	--	--	--	--	--	--	--	--	--	--	--	--	--	--	--	--	--	--	--	--	--	--	--	--	--	--	--	--	--	--	--	--	--	--	--	--	--	--	--	--	--	--	--	--	--	--	--	--

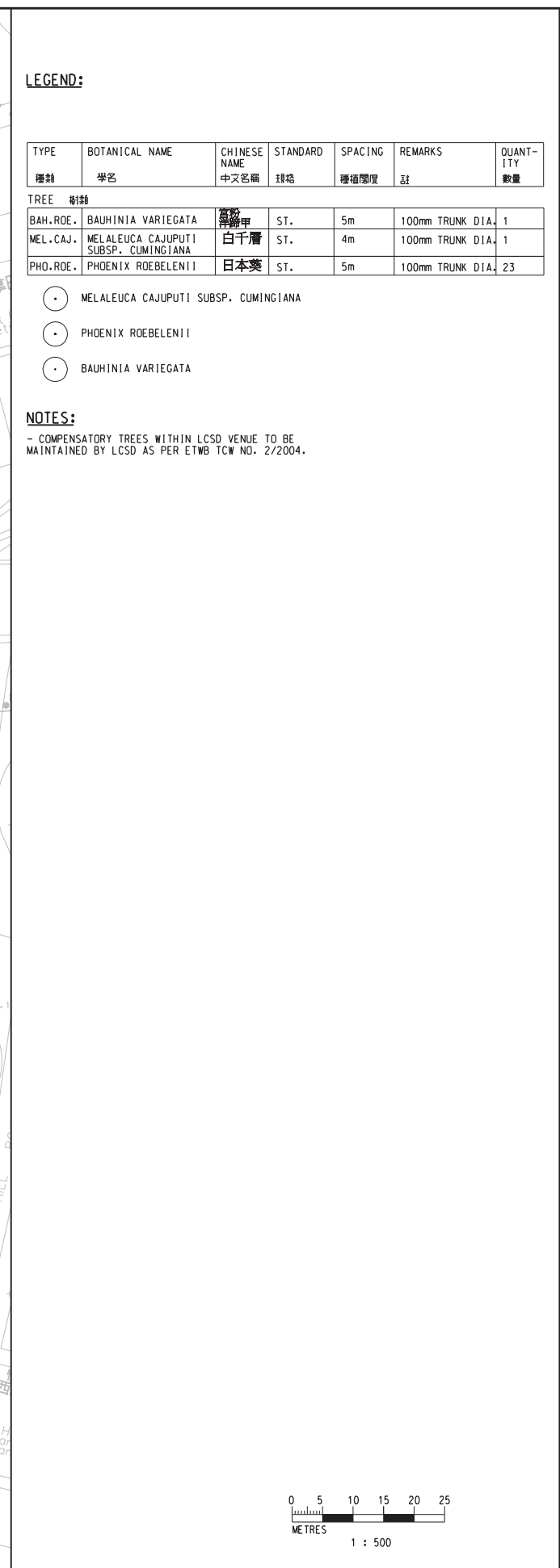

TITLE	CONTRACT 704 SVP & UNV STATIONS TREE COMPENSATION PLAN IN CENTRAL & WESTERN DISTRICT POK FU LAM ROAD (PRIVATE LOT)		
SCALE	DRAWING NO.	REV.	
1 : 500 (A1)	OA4/UN1/1/TCP/01.3	A	



TYPE	BOTANICAL NAME	CHINESE NAME	STANDARD	SPACING	REMARKS	QUANTITY
種類	學名	中文名稱	規格	種植密度	註	數量
TREE 樹類						
TAB.CHIL.	TABEBUIA CHRYSOTRICH	風鈴木	ST.	4m	100mm TRUNK DIA.	19

○ TABEUIA CHRYSOTRICHIA

NOTES:

- COMPENSATORY TREES WITHIN LCSD VENUE TO BE MAINTAINED BY LCSD AS PER ETWB TCN NO. 2/2004.

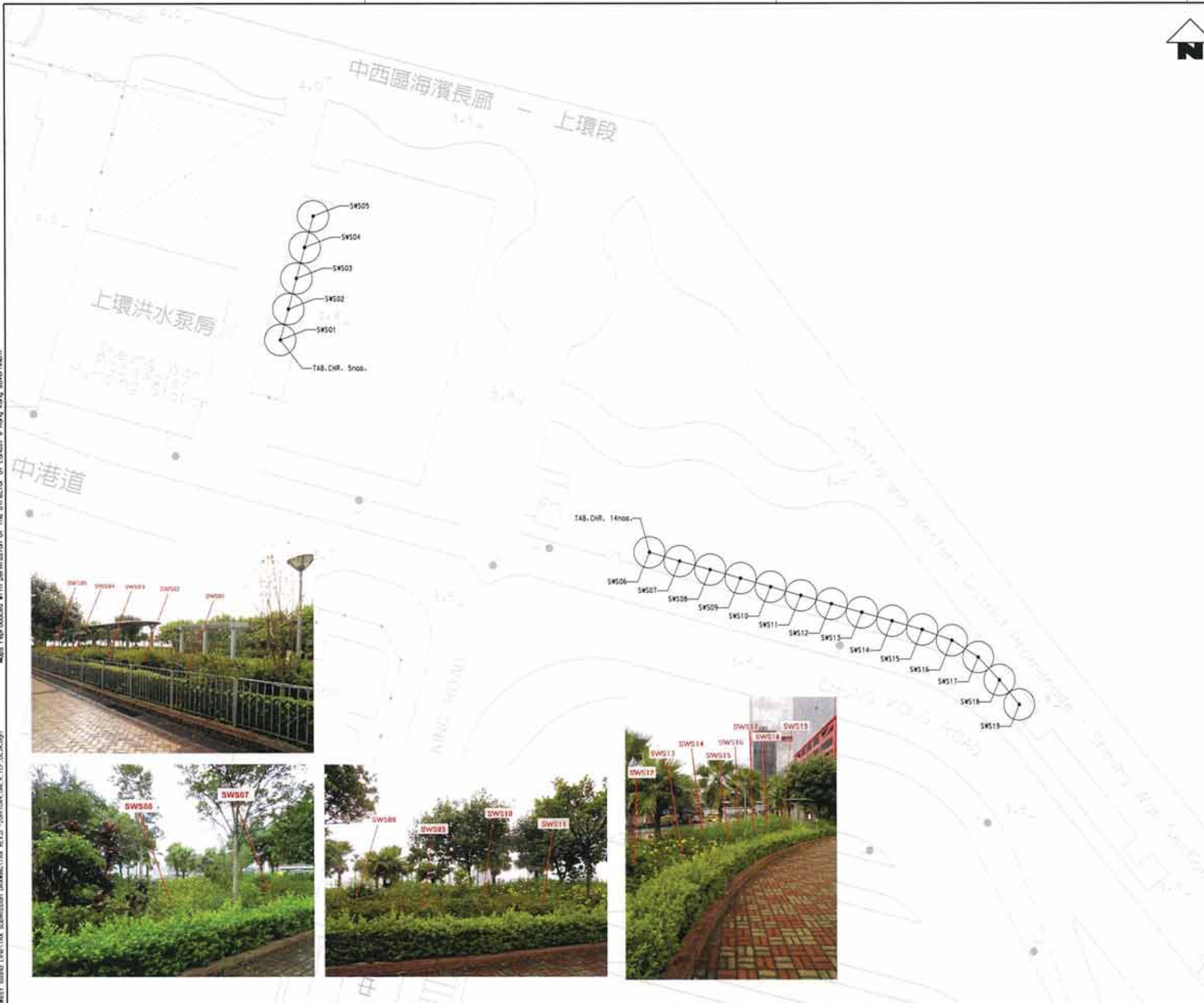

DRAWN DESIGNED CHECKED APPROVED DATE	MK AS KN GR 04/AUG/2014	 MTR WEST ISLAND LINE ORIGINATOR Atkins Arup JV Supported by Aedas Limited, Widnell Limited, Kenneth Ng and Associates	TITLE		CONTRACT 704 SYP & UNV STATIONS TREE COMPENSATION PLAN FOR HKU. ADJACENT TO MAKING WONG BUILDING (PRIVATE LOT)	
			SCALE		DRAWING NO.	
			1 : 250 (A1)		04/UNI/4/TCP/01.3	
			CADD REF.		04_UNI_4_TCP_01.3A.dgn	
			REV.		A	

Maps reproduced with permission of the Director of Lands, © Hong Kong Government.

```

PL01: Drive:
MODEL NAME:
NAME:
KVM: Project:044 West Island Live:Virta submission (DMMING:Virta REV.D -2004:04:100-4: 100-00:3A:dg9)
PRINTED BY: tech@ 6/8/2004 16:34:37
KVM:Installation: Standard:SP:Inter-Drive:V33 BLACK+WHITE:ph

```

PL01 (DW) K:\Microstation Standard\Printer Driver\AS BLACK\HKT.dgn
MODELNAME: K:\project\work\west island line\submission drawing\01.4 TCP_01.4A.dgn
PRINTED BY: TECH 6/2/2014 10:55
K:\project\work\west island line\submission drawing\01.4 TCP_01.4A.dgn

Maps reproduced with permission of the Director of Lands, e Hong Kong Government



LEGEND:

TYPE	BOTANICAL NAME	CHINESE NAME	STANDARD	SPACING	REMARKS	QUANTITY
樹種	學名	中文名稱	規格	種植間距	註	數量
TREE	樹種	學名	規格	種植間距	註	數量
MAG. GRA.	MAGNOLIA GRANDIFLORA	荷花玉蕊	ST.	4m	100mm TRUNK DIA.	1

○ MAGNOLIA GRANDIFLORA

NOTES:

- COMPENSATORY TREES WITHIN LCSD VENUE TO BE MAINTAINED BY LCSD AS PER ETWB TCM NO. 2/2004.

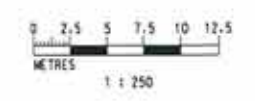

Appendix B – Landscape As-built Drawings of the Compensatory Trees at Ki Ling Lane Playground (SYP Entrance B3) and Off-site Areas for SYP and HKU Stations

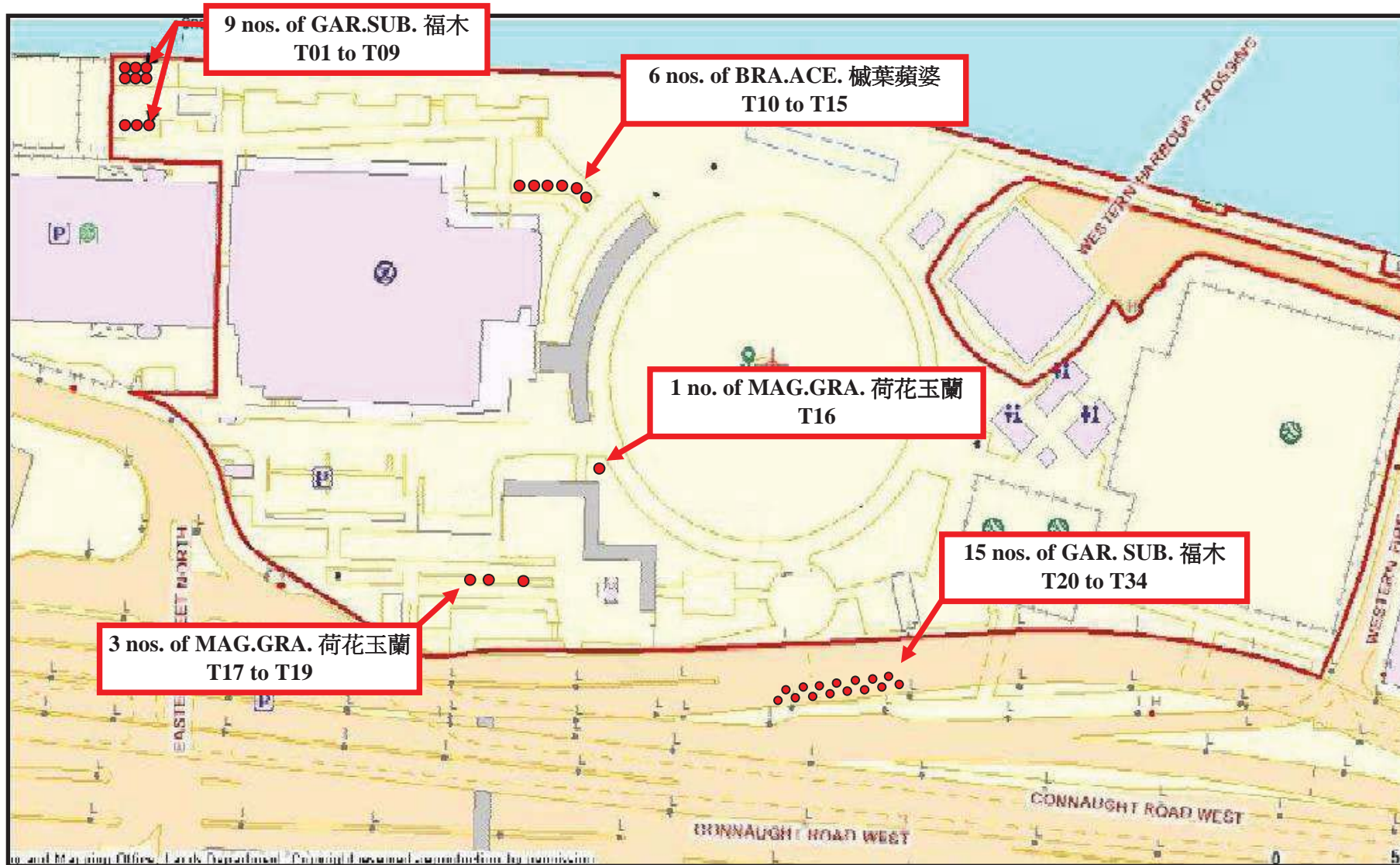

Layout Plan A - New Trees Location at Sun Yat Sen Memorial Park

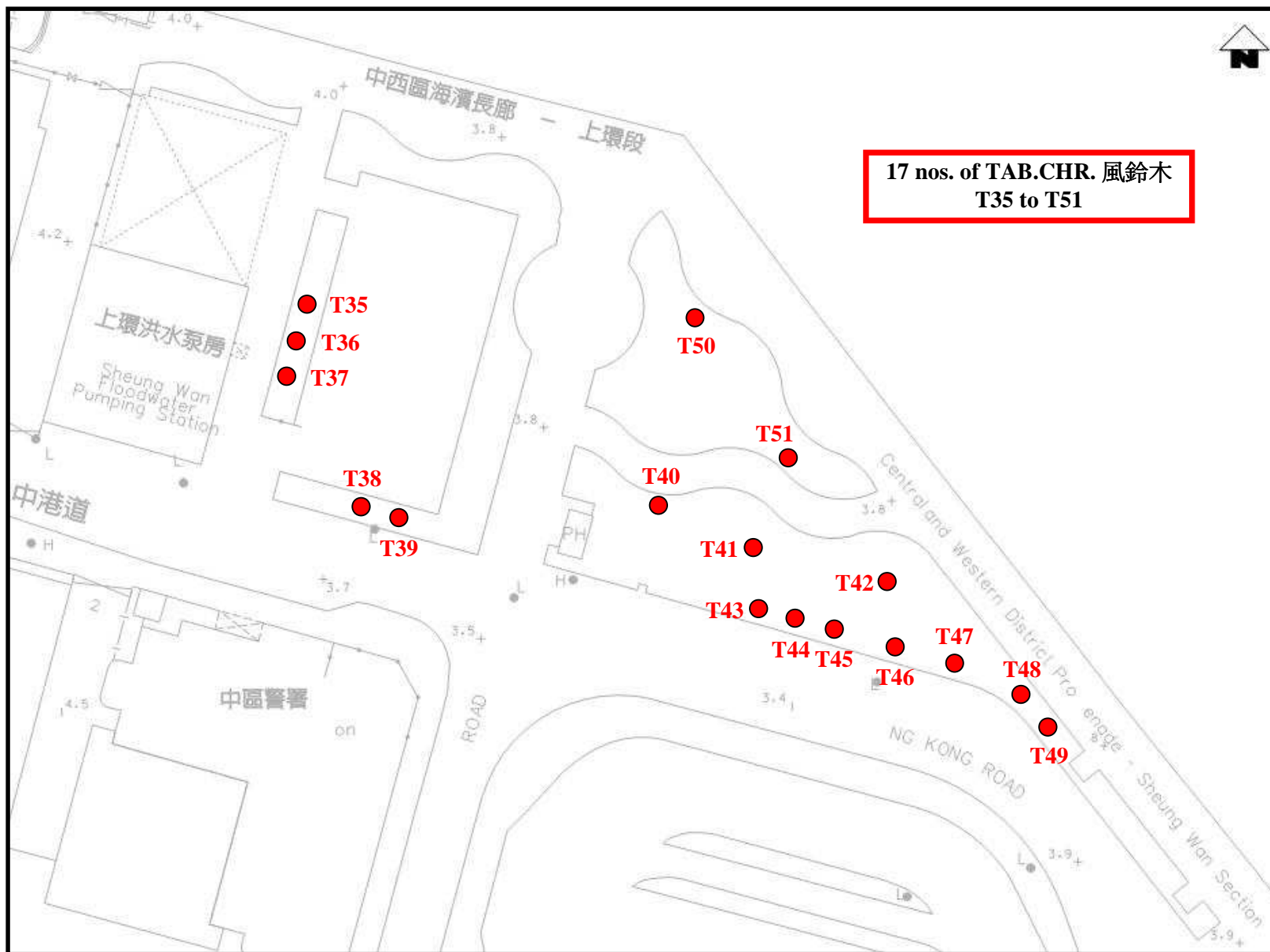

Layout Plan B - New Trees Location at Central and Western District Promenade – Sheung Wan Section

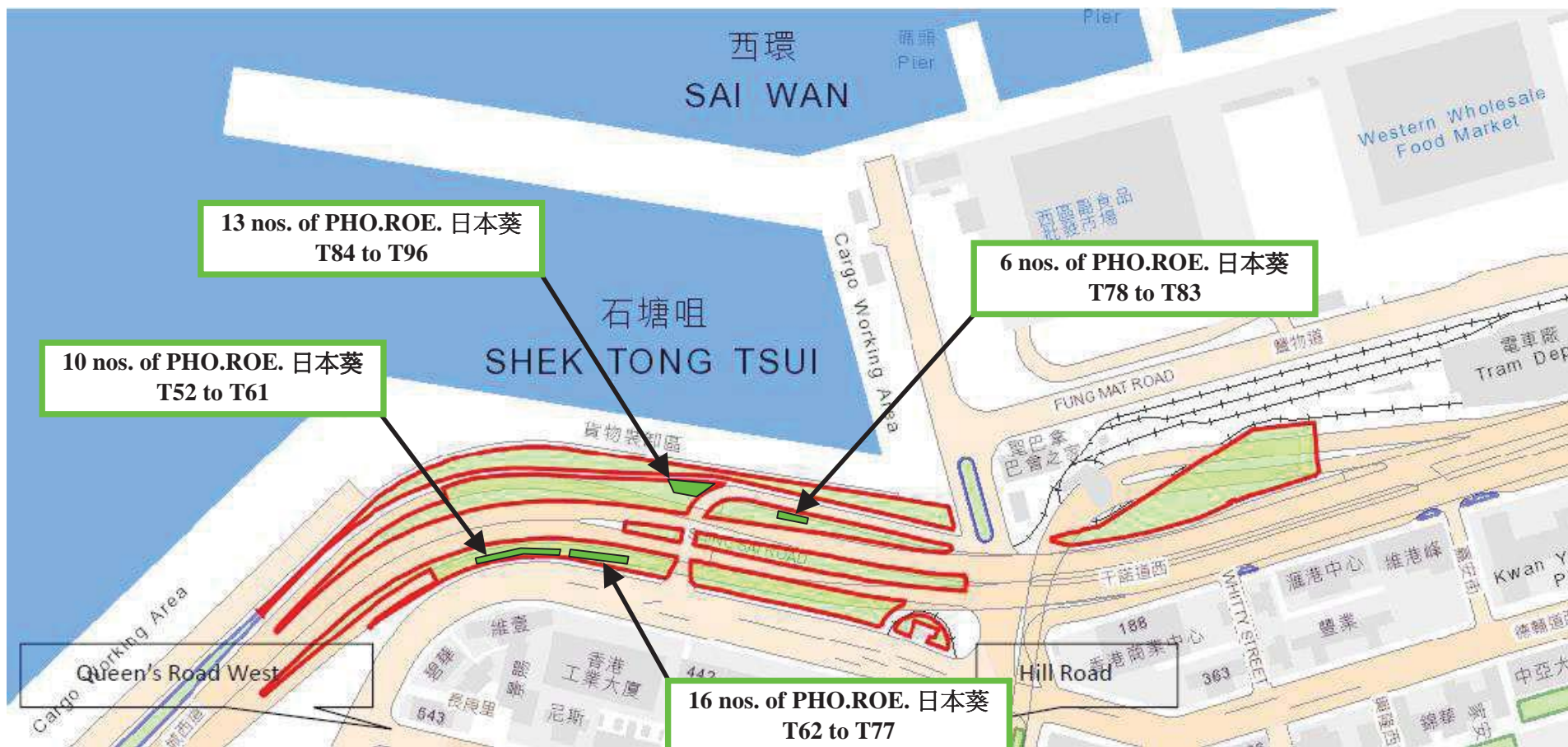

Layout Plan C - New Trees Location at Western District near Fung Mat Road

Microstation StandardPrinter Driver V3 BLACK/WHITE
KILNG Project\04 West Island Line\TRA submission\DRAWING\TCP-01.dgn
PLOT DATE: 06/04/2009 14:00:00
FILENAME: KILNG Project\04 West Island Line\TRA submission\DRAWING\TCP-01.dgn

Maps reproduced with permission of the Director of Land & Hong Kong Government

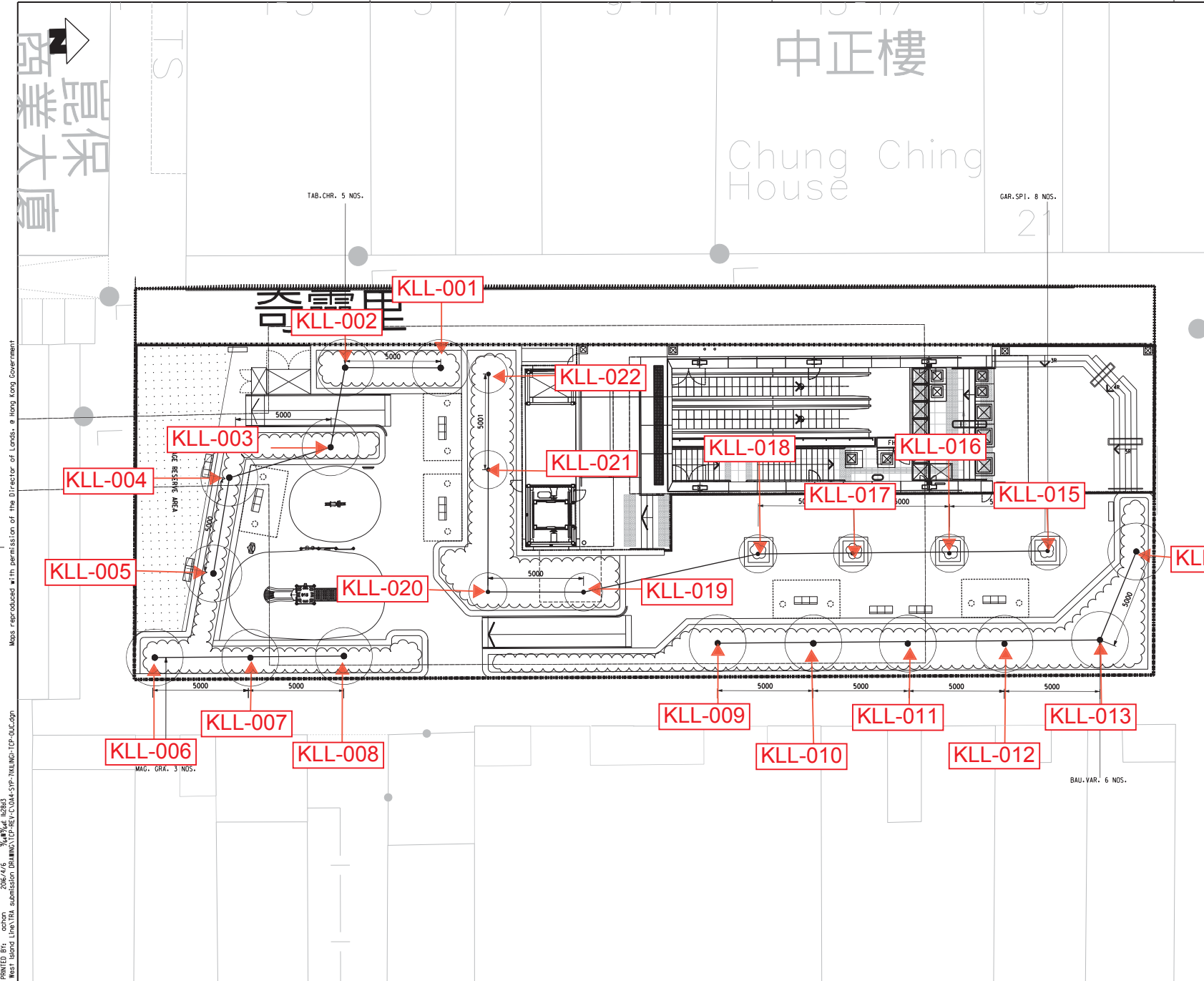

LEGEND:

	BOUNDARY LINE
	COMPENSATION TREE
	SHRUB / GROUND COVER PLANTING
	PROPOSED LEVEL

TYPE	BOTANICAL NAME	CHINESE NAME	STANDARD	SPACING	REMARKS	QUANTITY
樹種	學名	中文名稱	規格	種植間距	註	數量
TREE						
BAU.VAR.	BAUHINIA VARIEGATA	豔紅洋紫荊	HE.ST.	AS SHOWN	100 mm TRUNK DIA.	6
TAB.CHR.	TABELLUA CHRYSOTRICH	鳳凰木	HE.ST.	AS SHOWN	100 mm TRUNK DIA.	5
GAR.SPI.	GARCINIA SPICATA	鹽木	HE.ST.	AS SHOWN	100 mm TRUNK DIA.	8
MAG.GRA.	MAGNOLIA GRANDIFLORA	荷花玉蘭	HE.ST.	AS SHOWN	100 mm TRUNK DIA.	3

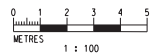

DRAWN: BEN				DESIGNED: AC			
CHECKED: KN				APPROVED: GR			
DATE: 27/APR/2009				DO NOT SCALE DRAWINGS. ALL DIMENSIONS SHALL BE VERIFIED ON SITE.			
C GENERAL REVISION				BY: 06/APR/16 GR			
B INCORPORATING GOVERNMENT DEPARTMENT'S COMMENT				AC 31/JUL/09 GR			
A C703 TREE REMOVAL APPLICATION				AC 06/MAY/09 GR			
REV				BY: DATE: APPROVED			
DESCRIPTION				DESCRIPTION			



WEST ISLAND LINE

ORIGINATOR

Atkins Arup JV

Supported by
Aedas Limited, Widnell Limited,
Kenneth Ng and Associates

CADD REF.

QA4-SYP-7(KILNG)-TCP-01.1C.dgn

TITLE

CONTRACT 704
SYP & UNV STATIONS
TREE COMPENSATION PLAN
SAI YING PUN STATION ENTRANCE B3
KI LING LANE PLAY GROUND

SCALE

1 : 100 (A1)

DRAWING NO.

QA4/SYP7/TCP/01.2

REV.

C

Appendix C – Photographic Record of Compensatory Trees during Inspection



T01



T02



T03



T04



T05



T06



T07



T08



T09



T10



T11



T12



T13



T14



T15



T16



T17



T18



T19



T20



T21

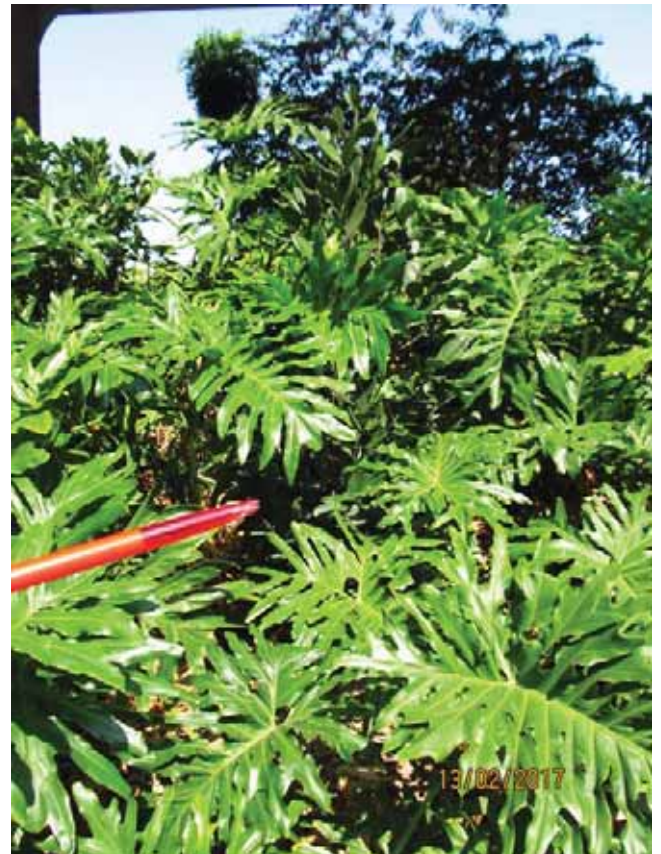

T22



T23



T24



T25



T26



T27



T28



T29



T30

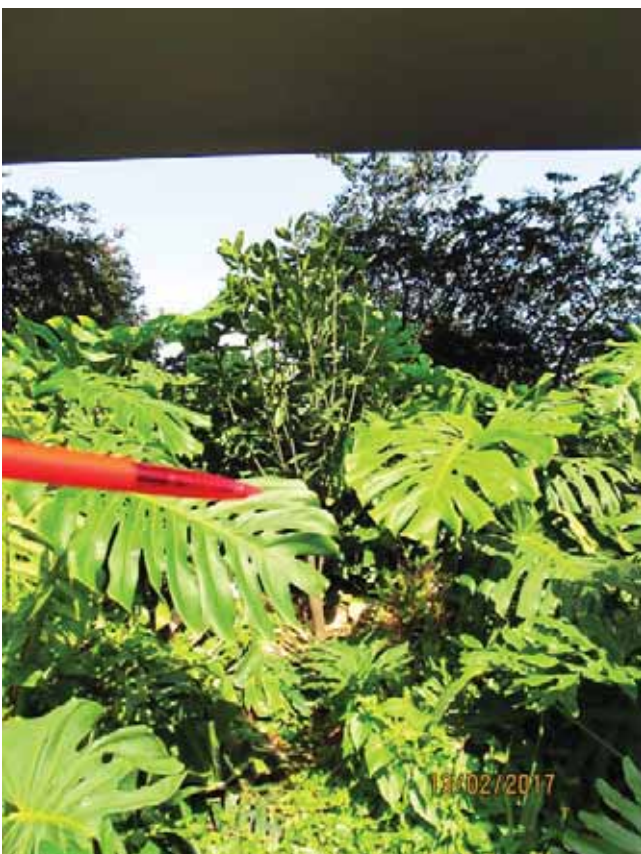

T31



T32



T33



T34



T35



T36



T37



T38



T39



T40



T41



T42



T43



T44



T45



T46



T47



T48



T49



T50



T51



T52



T53



T54



T55



T56



T57



T58



T59



T60



T61



T62



T63



T64



T65



T66



T67



T68



T69



T70



T71



T72



T73



T74



T75



T76



T77



T78



T79



T80



T81



T82



T83



T84



T85



T86



T87



T88



T89



T90



T91



T92



T93



T94



T95



T96



KLL-001



KLL-002



KLL-003



KLL-004



KLL-005



KLL-006



KLL-007



KLL-008



KLL-009



KLL-010



KLL-011



KLL-012



KLL-013



KLL-014



KLL-015



KLL-016



KLL-017



KLL-018



KLL-019



KLL-020



KLL-021



KLL-022