

## West Island Line

### Audit Report for Compensatory Trees – supplementary paper

---

#### Introduction

The operation of West Island Line (WIL) has commenced in December 2014. Under its Environmental Permit (No. EP-313/2008/K) Condition 4.2.2, the Audit Reports on the implementation of recommendations in the Tree Protection Plan and detailed landscape as-built drawings were deposited. The Audit Report were submitted with four parts, depending on the construction program of WIL and the relevant compensatory trees planting program.

As the program of completing the construction works and landscaping works (as well as compensatory trees planting) vary in different locations, audit inspections were carried out in different time period upon the completion of landscaping works. All compensatory trees planted before 2017 were reported in four parts of the Audit Part: Audit Report (Part 1) for the Magazine site, Audit Report (Part 2) for Kennedy Town Station (KET), Audit Report (Part 3) for Sai Ying Pun Station (SYP) and HKU Station (HKU), and Audit Report (Part 4) for SYP Entrance B3 and the off-site planting of compensatory trees for SYP and HKU.

This supplementary paper presents the findings of the audit inspection for the compensatory trees in David Lane Sitting Out Area, this area falls within the works area of WIL. The re-provisioning of this area was completed in mid 2019 and handed over to Leisure and Cultural Services Departments (LCSD) in October 2019.

#### Tree Audit and Findings

According to the Tree Protection Plan (TPP) (Rev.F) in **Appendix A**, ten numbers of compensatory trees was proposed to be planted in David Lane Sitting Out Area, the proposed planting species in the compensatory planting proposal are listed in **Table 1.1**.

**Table 1.1** Proposed compensatory tree species in TPP (Rev.F)

Species Name	Size	Quantity
<i>Cassia Surattensis</i> 黃槐	Heavy standard*	4 nos.
<i>Lagerstroemia speciosa</i> 大花紫薇	Heavy standard	6 nos.

\* Heavy standard size is between 75mm and 150mm DBH

An audit inspection for the compensatory trees in David Lane Sitting Out Area was carried out on 9 January 2020. Compared with the proposal in **Appendix A**, the overall quantity of the compensatory trees planted has remained the same, the species of the trees planted are listed in **Table 1.2**.

**Table 1.2** Species of the trees planted in David Lane Sitting Out Area

Species Name	Size (DBH)	Quantity
<i>Lagerstroemia speciosa</i> 大花紫薇	95.5mm – 102mm	3 nos.
<i>Xanthostemon chrysanthus</i> 金蒲桃	76mm – 86mm	3 nos.
<i>Phoenix roebelenii</i> 日本葵	78mm – 94mm	4 nos.

Refer to the Landscape as-built drawing in **Appendix B** and photo records in **Appendix C**, the key changes are as follows:

- 1) *Cassia surattensis* has been deleted.
- 2) The quantity of *Lagerstromia speciosa* has been changed from 6 to 3.
- 3) 2 new species *Xanthostemon chrysanthus* and *Phoenix roebelenii* are proposed in the updated scheme.

The change of tree species is based on the principle agreement with the maintenance party (i.e. LCSD).

Size of the trees are measured during the inspection, all planted trees are the heavy standard size as proposed in TPP (Rev.F). Overall tree health and tree form are in good condition, except for T01 and T04 are in fair condition.

## Conclusion

Of the ten compensatory trees planted in David Lane Sitting Out Area, the quantity and size are the same as proposed in TPP (Rev. F), only tree species differs, and the change of tree species are agreed with LCSD.

## **Appendix A**

### **Compensatory Tree Proposal of David Lane Sitting Out Area in TPP (Rev. F)**

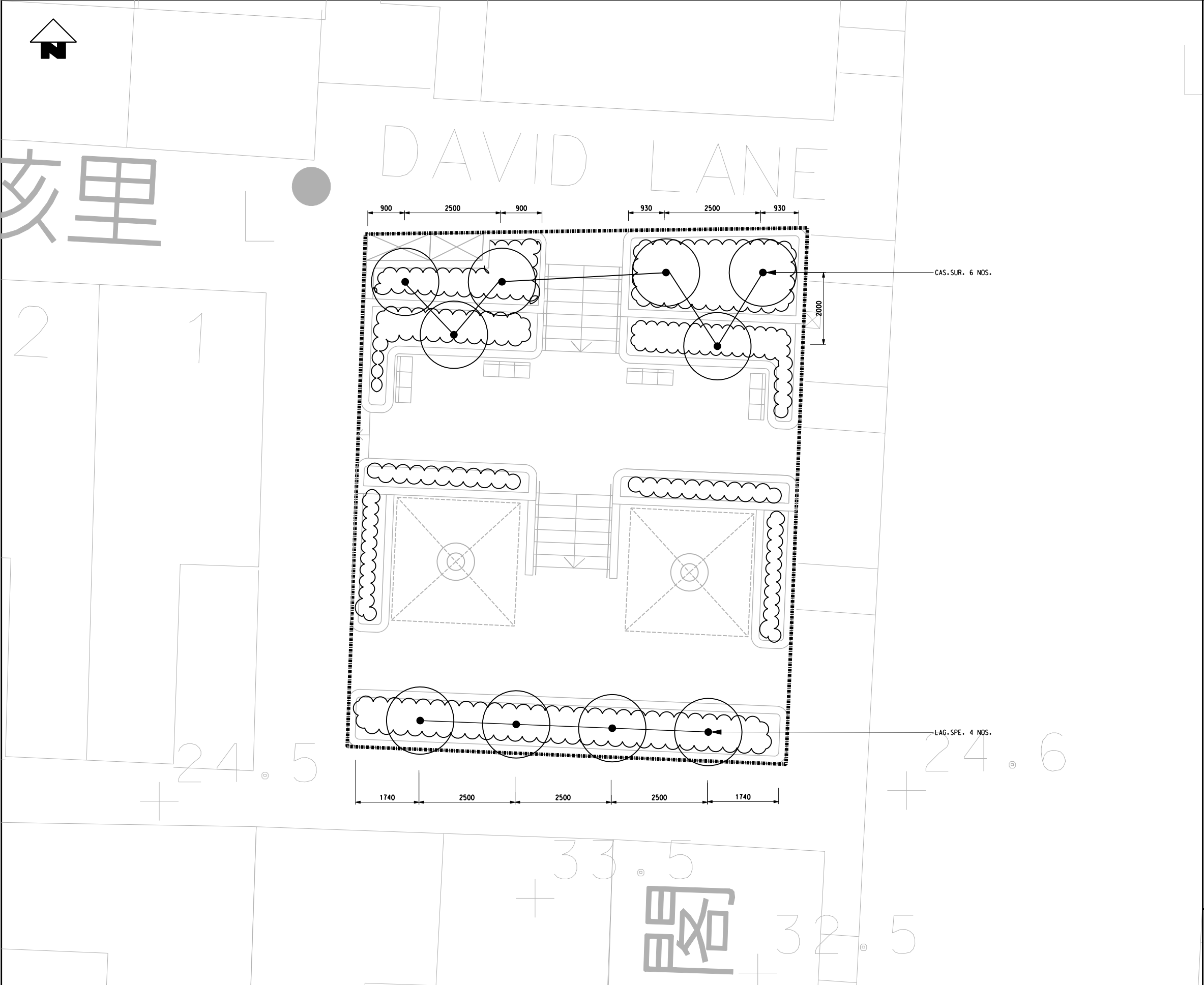

LEGEND:



BOUNDARY LINE



COMPENSATION TREE



SHRUB PLANTING

TYPE	BOTANICAL NAME	CHINESE NAME	STANDARD	SPACING	REMARKS	QUANT-ITY
種類	學名	中文名稱	規格	種植間距	註	數量
TREE 樹類						
LAG.SPE.	LAGERSTROEMIA SPECIOSA	大葉紫薇	HE.ST.	AS SHOWN	100 mm TRUNK DIA.	4
CAS.SUR.	CASSIA SURRATTENSIS	黃槐	HE.ST.	AS SHOWN	75 mm TRUNK DIA.	6

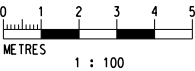

												DRAWN BEN DESIGNED AC CHECKED KN APPROVED GR DATE 01/JAN/2009				MTR WEST ISLAND LINE				TITLE CONTRACT 704 SYP & UNV STATIONS TREE COMPENSATION PLAN SAI YING PUN STATION DAVID LANE SITING OUT AREA			
												ORIGINATOR Atkins Arup JV Supported by Aedas Limited, Widnell Limited, Kenneth Ng and Associates											
				B INCORPORATING GOVERNMENT'S COMMENT				AC 25MAY09 GR				DO NOT SCALE DRAWINGS. ALL DIMENSIONS SHALL BE VERIFIED ON SITE. © MTR CORPORATION LIMITED 2008. COPYRIGHT IN RESPECT OF THIS DRAWING / DOCUMENT IS OWNED BY THE MTR CORPORATION LIMITED OF HONG KONG. NO REPRODUCTION OF THE DRAWING / DOCUMENT OR ANY PART BY WHATEVER MEANS IS PERMITTED WITHOUT THE PRIOR WRITTEN CONSENT OF THE MTR CORPORATION LIMITED.				CADD REF. 0A4_SYP_ _TCP-01B.DGN							
				A C703 TREE REMOVAL APPLICATION				AC JAN09 GR															
REV	DESCRIPTION			BY	DATE	APPROVED	REV	DESCRIPTION			BY	DATE	APPROVED				SCALE 1 : 100 (A3)		DRAWING NO. 0A4/SYP//TCP/01		REV.	B	

## **Appendix B**

### **Landscape As-built Drawing of Compensatory Trees in David Lane Sitting Out Area**



## **Appendix C**

### **Photographic Records of Compensatory Trees during Inspection**





T01



T02



T03



T04





T05



T06



T07



T08





T09



T10