

LEGEND:

- PROJECT BOUNDARY
- STUDY BOUNDARY
- A1/PA1 AIR SENSITIVE RECEIVERS

MAUNSELL | AECOM
Maunsell Consultants Asia Ltd

AGREEMENT NO. CE 35/2006 (CE)
KAI TAK DEVELOPMENT ENGINEERING STUDY CUM DESIGN AND
CONSTRUCTION OF ADVANCE WORKS-INVESTIGATION, DESIGN AND CONSTRUCTION

LOCATIONS OF AIR SENSITIVE RECEIVERS

(SHEET 2 OF 14)

SCALE	A3 1:4000	DATE	JAN. 2008
CHECK	—	DRAWN	ZQQ
JOB No.	60022503	DRAWING No.	3.1
		REV	

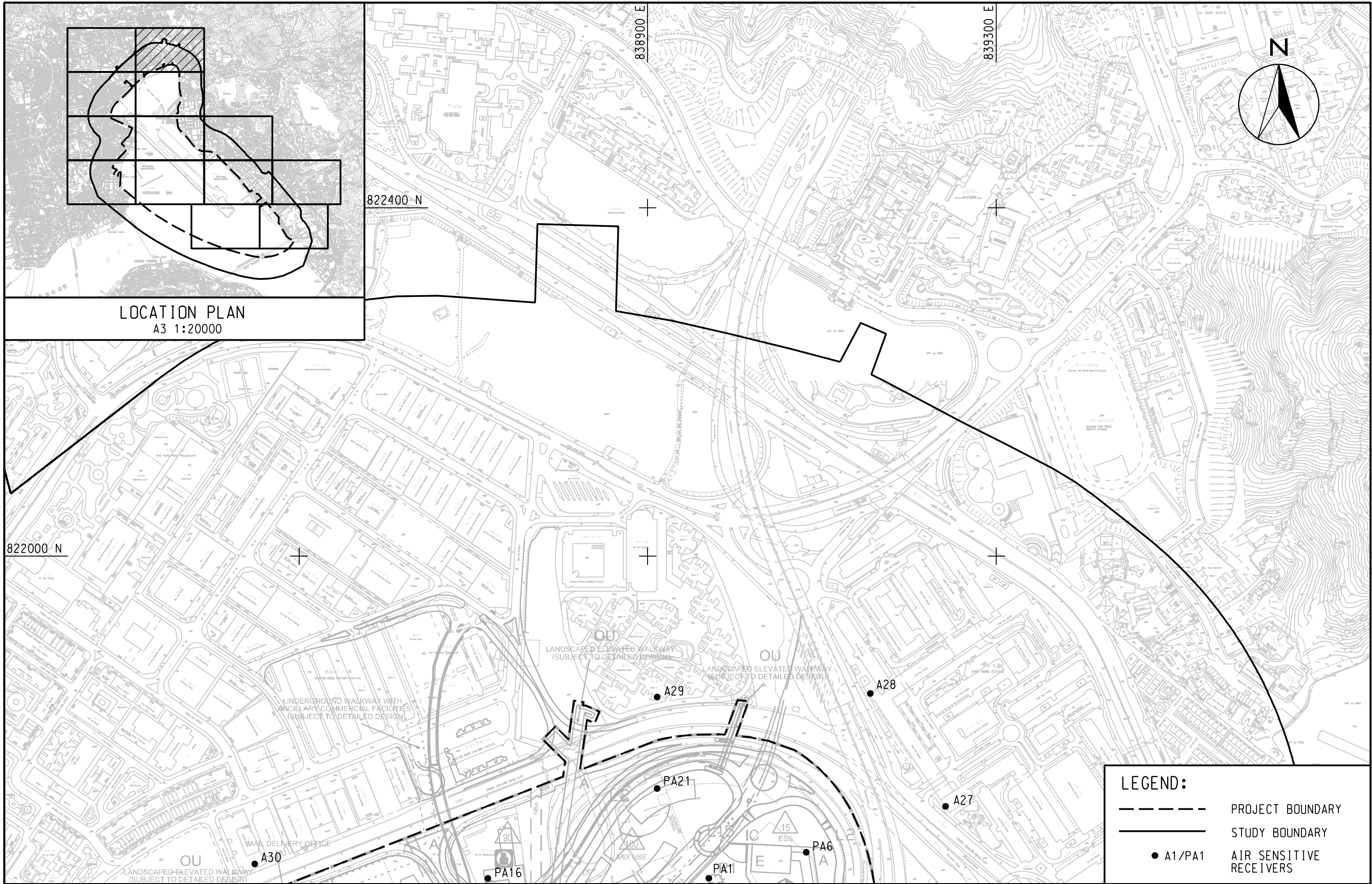

LOCATION PLAN
A3 1:20000

LEGEND:

- PROJECT BOUNDARY
- STUDY BOUNDARY
- A1/PA1 AIR SENSITIVE RECEIVERS

<div>MAUNSELL AECOM</div> <div>Maunsell Consultants Asia Ltd</div>	AGREEMENT NO. CE 35/2006 (CE)		SCALE	A3 1:4000	DATE	JAN. 2008	
	KAI TAK DEVELOPMENT ENGINEERING STUDY CUM DESIGN AND		CHECK	—	DRAWN	LCR	
	CONSTRUCTION OF ADVANCE WORKS-INVESTIGATION, DESIGN AND CONSTRUCTION		JOB No.	60022503	DRAWING No.	3.1	REV
	LOCATIONS OF AIR SENSITIVE RECEIVERS		(SHEET 3 OF 14)				

DATE 2008-10-14 10:36:39 DAIXL

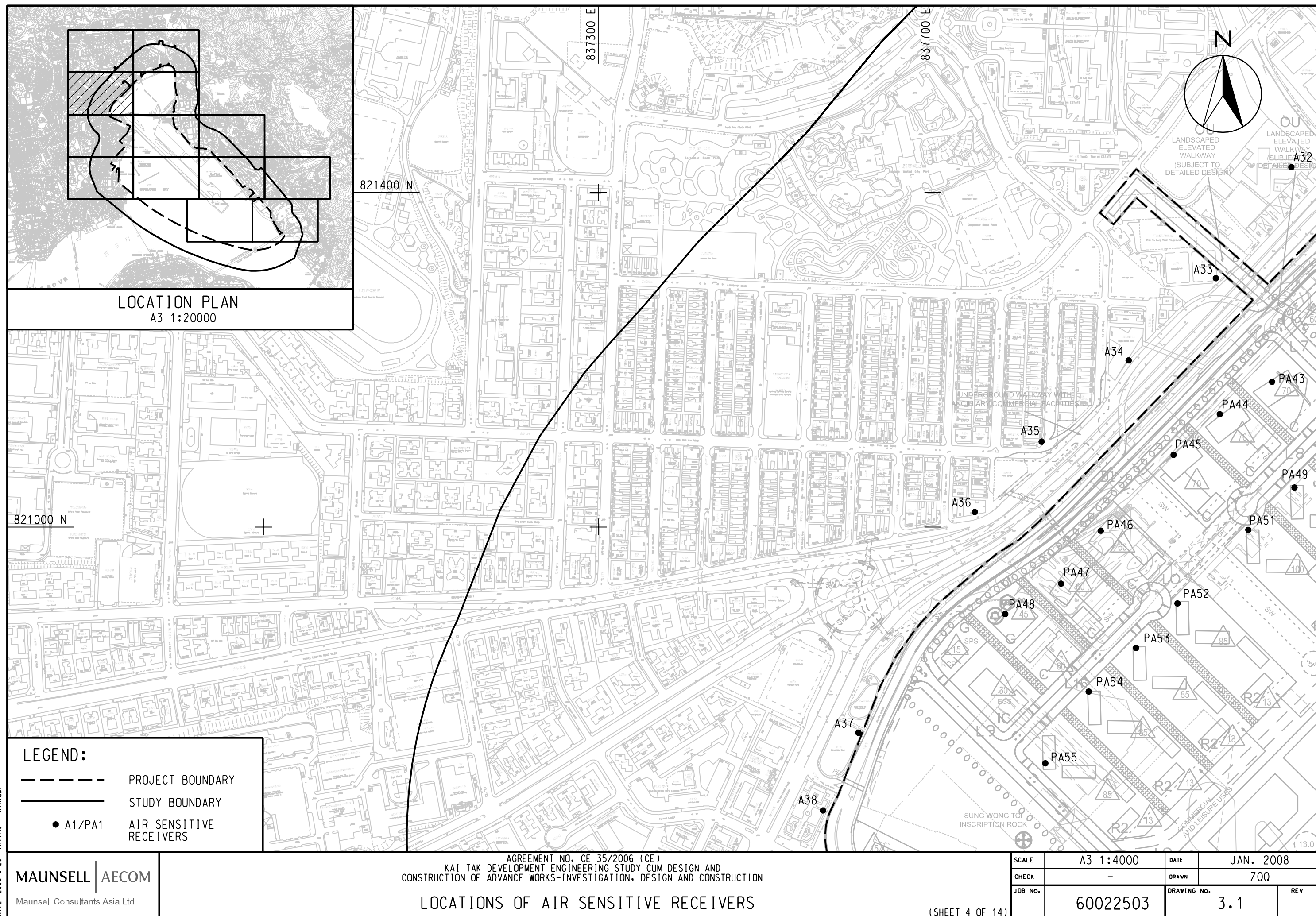

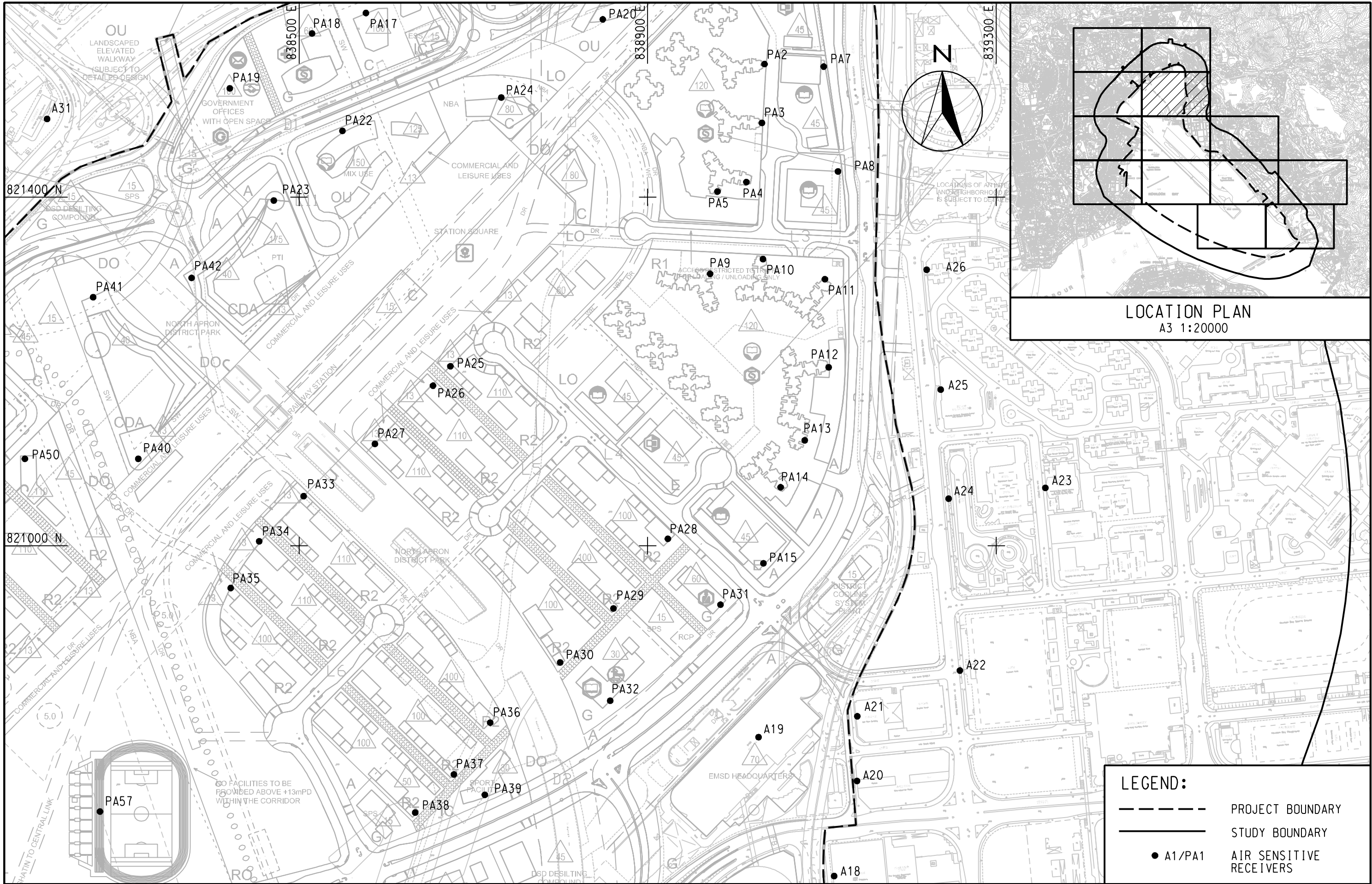

DATE 2008-10-14 10:23:59 DAIXL

MAUNSELL | AECOM

Maunsell Consultants Asia Ltd

AGREEMENT NO. CE 35/2006 (CE)
KAI TAK DEVELOPMENT ENGINEERING STUDY CUM DESIGN AND
CONSTRUCTION OF ADVANCE WORKS-INVESTIGATION, DESIGN AND CONSTRUCTION

LOCATIONS OF AIR SENSITIVE RECEIVERS

(SHEET 5 OF 14)

SCALE	A3 1:4000	DATE	JAN. 2008
CHECK	-	DRAWN	LCR
JOB No.	60022503	DRAWING No.	3.1
		REV	

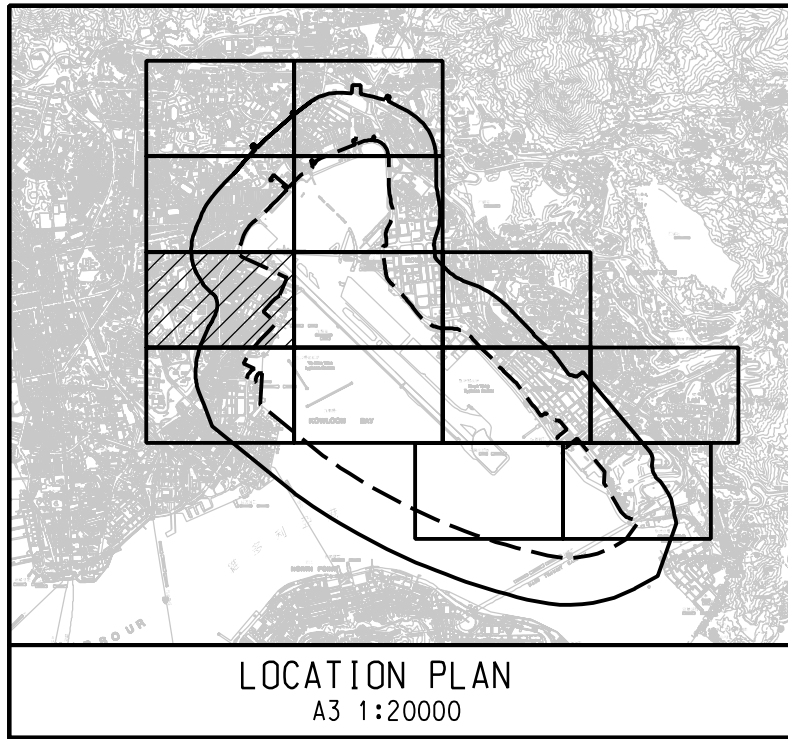
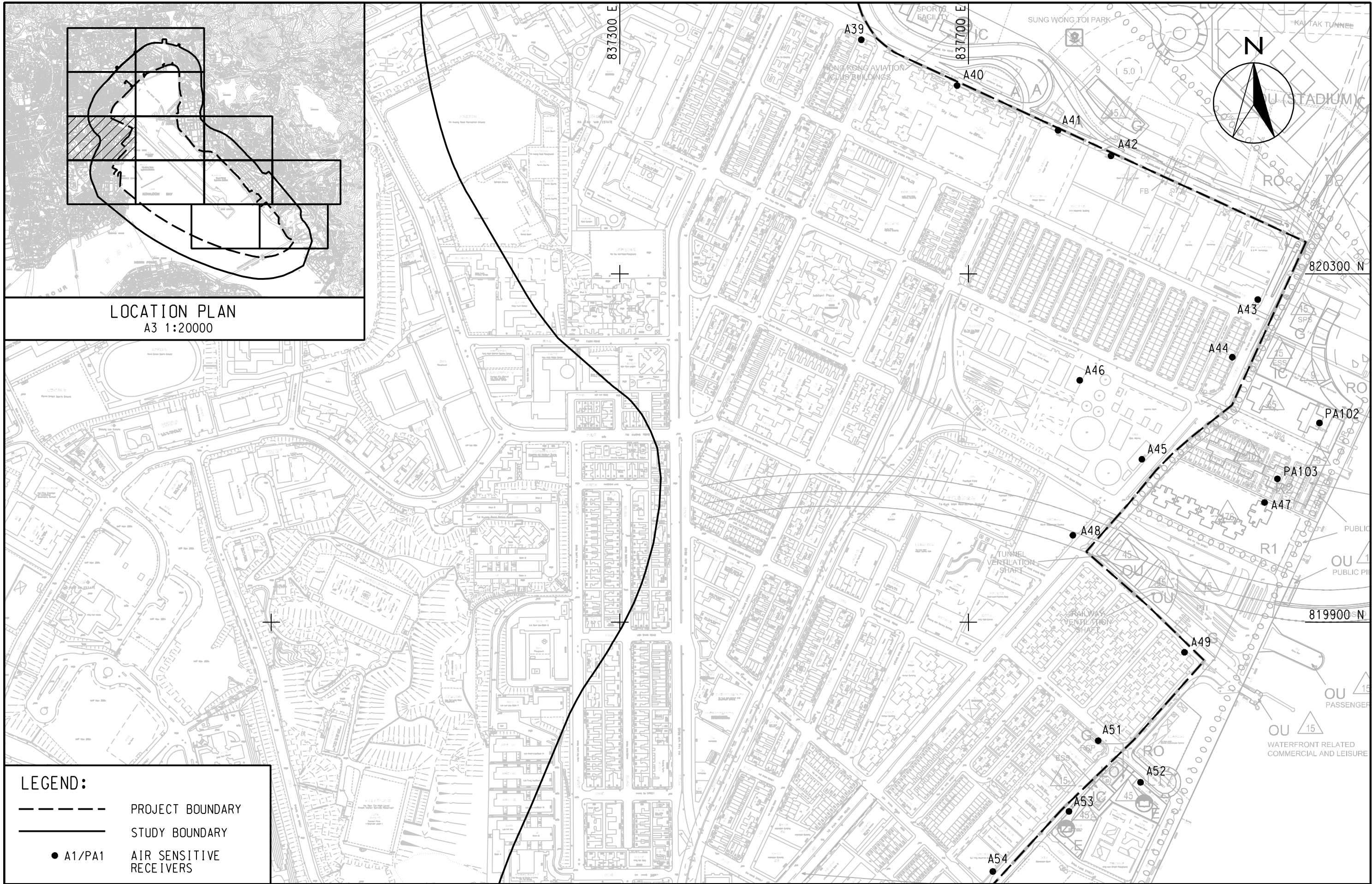

LEGEND:

- PROJECT BOUNDARY
- STUDY BOUNDARY
- A1/PA1 AIR SENSITIVE RECEIVERS

MAUNSELL | AECOM
Maunsell Consultants Asia Ltd

AGREEMENT NO. CE 35/2006 (CE)
KAI TAK DEVELOPMENT ENGINEERING STUDY CUM DESIGN AND
CONSTRUCTION OF ADVANCE WORKS-INVESTIGATION, DESIGN AND CONSTRUCTION

LOCATIONS OF AIR SENSITIVE RECEIVERS

SCALE	A3 1:4000	DATE	JAN. 2008
CHECK	—	DRAWN	ZOO
JOB No.	60022503	DRAWING No.	3.1
		REV	

DATE 2008-6-20 11:52:28 WANGDF

DATE 2008-6-20 11:53:45 WANGDF

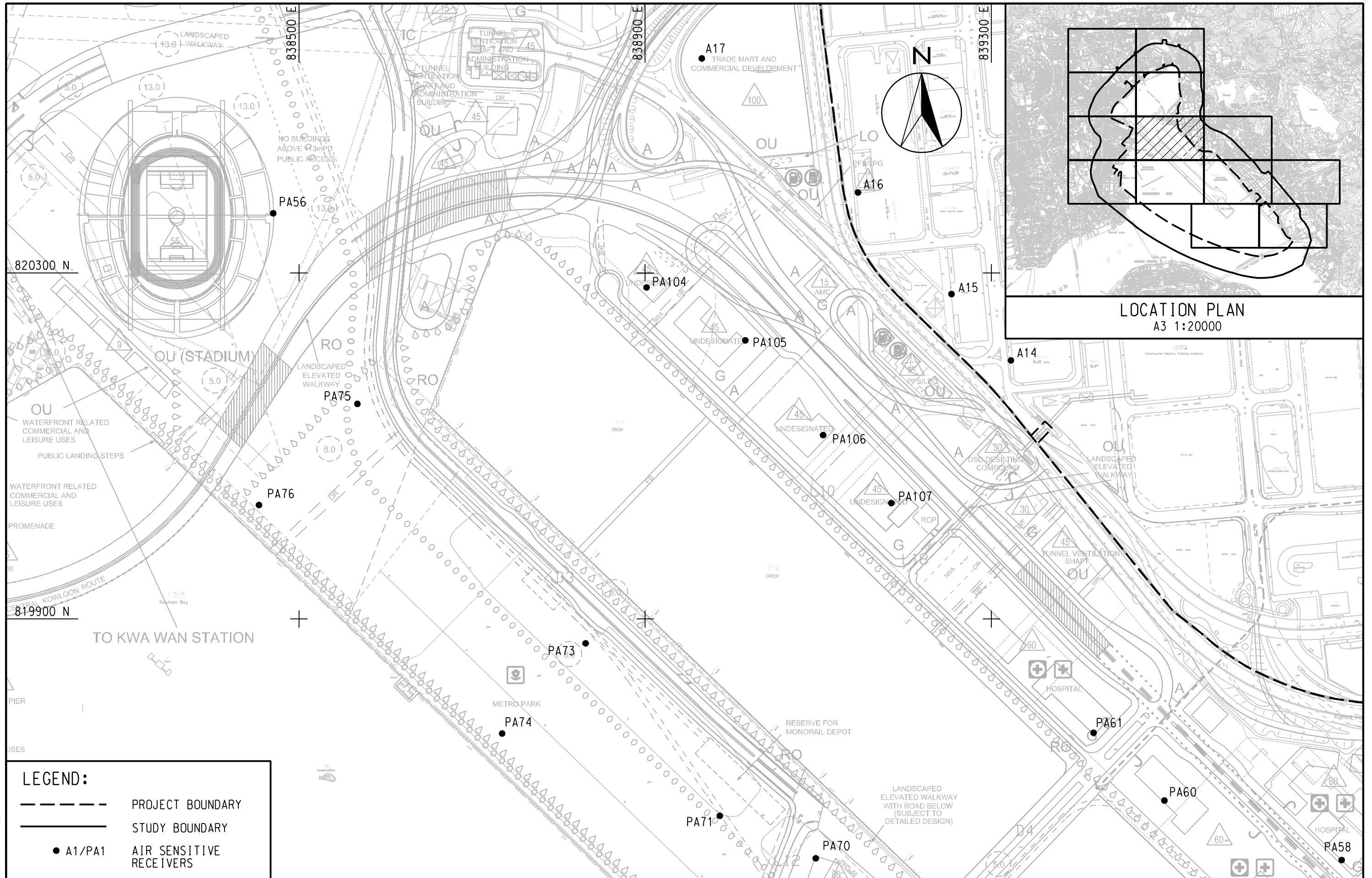

AGREEMENT NO. CE 35/2006 (CE)
KAI TAK DEVELOPMENT ENGINEERING STUDY CUM DESIGN AND
CONSTRUCTION OF ADVANCE WORKS-INVESTIGATION, DESIGN AND CONSTRUCTION

LOCATIONS OF AIR SENSITIVE RECEIVERS

(SHEET 7 OF 14)

SCALE	A3 1:4000	DATE	JAN. 2008
CHECK	—	DRAWN	ZOO
JOB No.	60022503	DRAWING No.	3.1
		REV	

MAUNSELL | AECOM
Maunsell Consultants Asia Ltd



LOCATION PLAN
A3 1:20000

LEGEND:

- PROJECT BOUNDARY
- STUDY BOUNDARY
- A1/PA1 AIR SENSITIVE RECEIVERS

MAUNSELL | AECOM

Maunsell Consultants Asia Ltd

AGREEMENT NO. CE 35/2006 (CE)
KAI TAK DEVELOPMENT ENGINEERING STUDY CUM DESIGN AND
CONSTRUCTION OF ADVANCE WORKS-INVESTIGATION, DESIGN AND CONSTRUCTION

LOCATIONS OF AIR SENSITIVE RECEIVERS

(SHEET 8 OF 14)

SCALE	A3 1:4000	DATE	JAN. 2008
CHECK	—	DRAWN	ZOO
JOB No.	60022503	DRAWING No.	3.1
		REV	

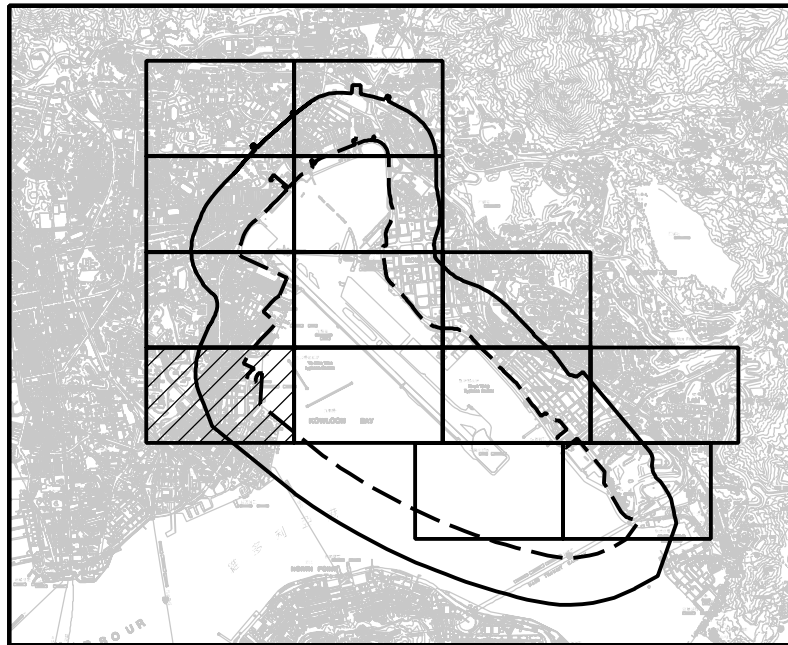
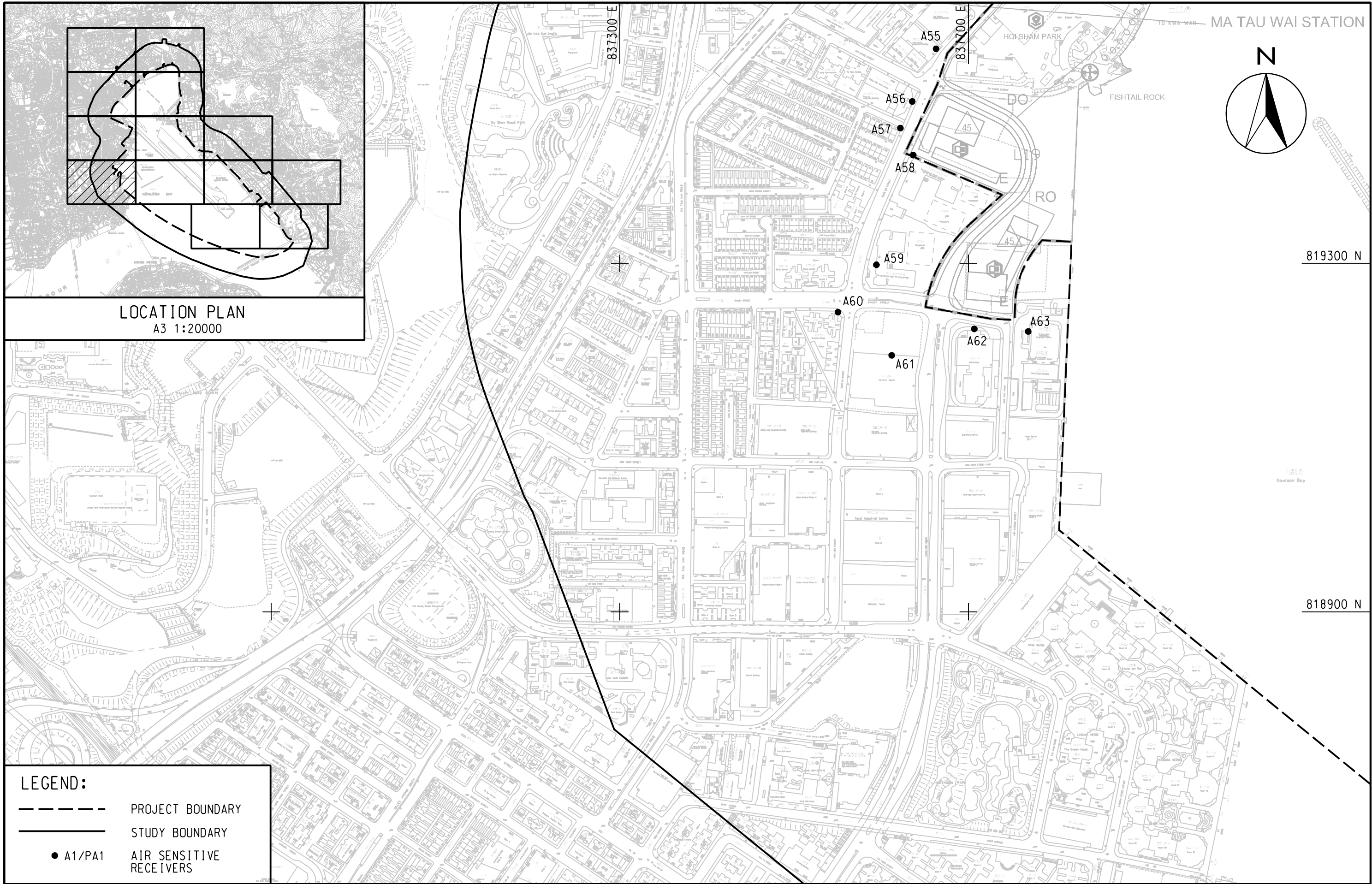

LEGEND:

- PROJECT BOUNDARY
- STUDY BOUNDARY
- A1/PA1 AIR SENSITIVE RECEIVERS

MAUNSELL | AECOM

Maunsell Consultants Asia Ltd

AGREEMENT NO. CE 35/2006 (CE)
KAI TAK DEVELOPMENT ENGINEERING STUDY CUM DESIGN AND
CONSTRUCTION OF ADVANCE WORKS-INVESTIGATION, DESIGN AND CONSTRUCTION

LOCATIONS OF AIR SENSITIVE RECEIVERS

(SHEET 9 OF 14)

SCALE	A3 1:4000	DATE	JAN. 2008
CHECK	—	DRAWN	LCR
JOB No.	60022503	DRAWING No.	3.1
		REV	

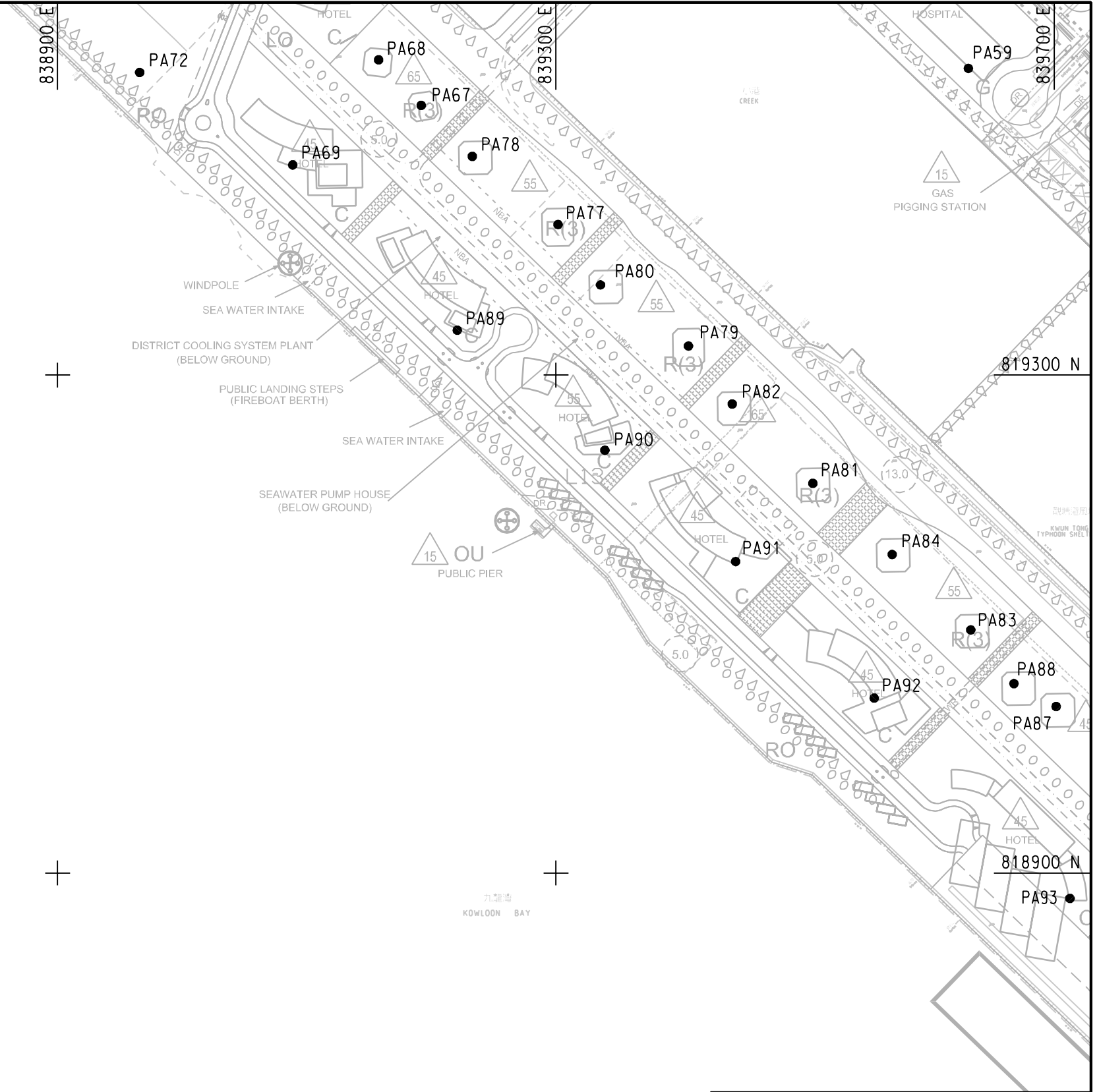
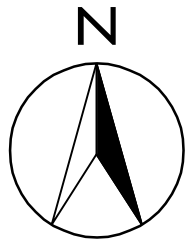
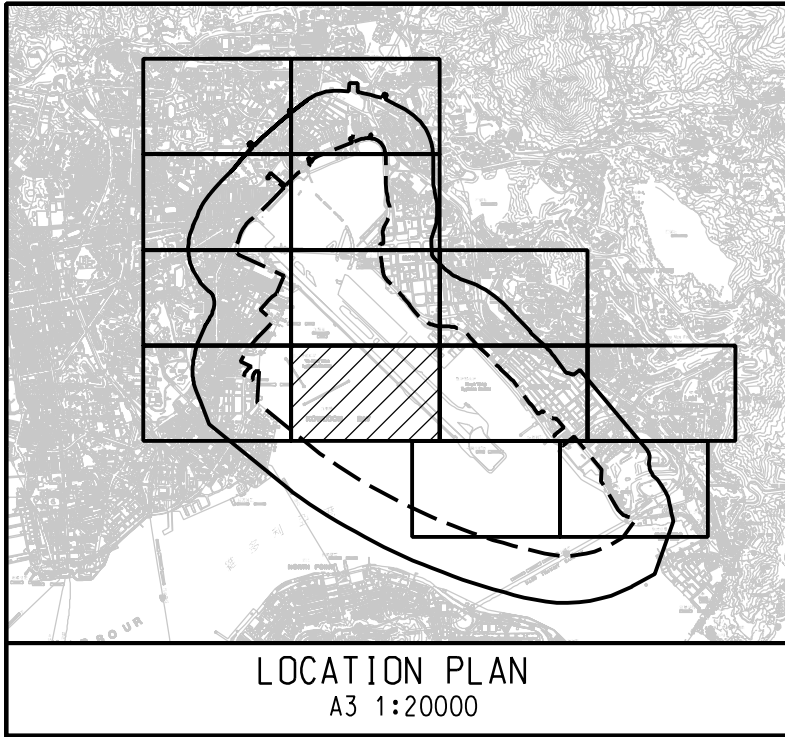

LEGEND:

- PROJECT BOUNDARY
- STUDY BOUNDARY
- A1/PA1 AIR SENSITIVE RECEIVERS

DATE 2008-6-20 11:59:08 WANGDF

MAUNSELL | AECOM
Maunsell Consultants Asia Ltd

AGREEMENT NO. CE 35/2006 (CE)
KAI TAK DEVELOPMENT ENGINEERING STUDY CUM DESIGN AND
CONSTRUCTION OF ADVANCE WORKS-INVESTIGATION, DESIGN AND CONSTRUCTION

LOCATIONS OF AIR SENSITIVE RECEIVERS

(SHEET 10 OF 14)

SCALE	A3 1:4000	DATE	JAN. 2008
CHECK	—	DRAWN	LCR
JOB No.	60022503	DRAWING No.	3.1
		REV	

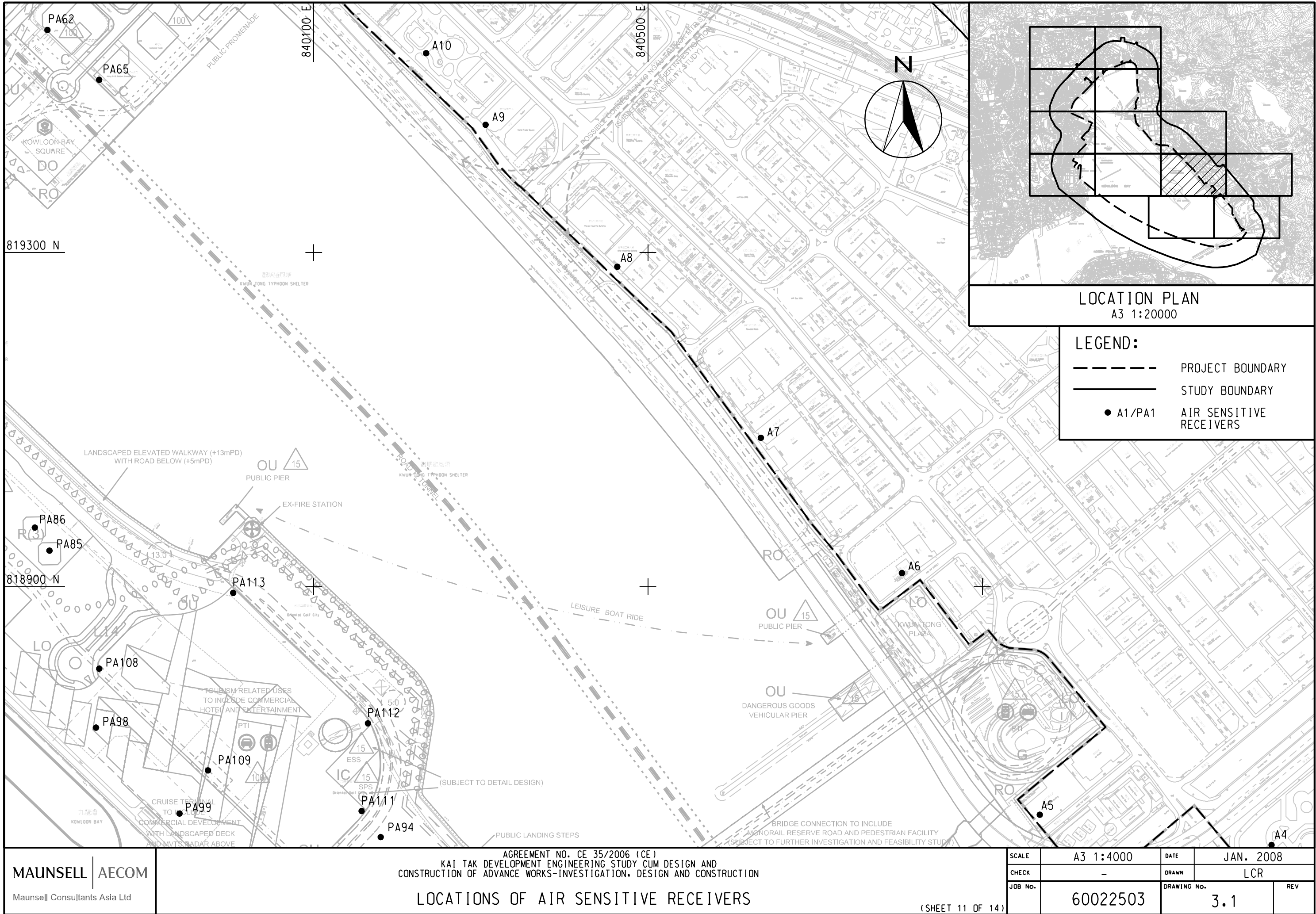

DATE 2008-6-20 12:00:37 WANGDF

P:\PROJECTS\60022503\DRAWING\FIGURE\3.1.10.dgn

DATE 2008-6-20 12:03:49 WANGDF

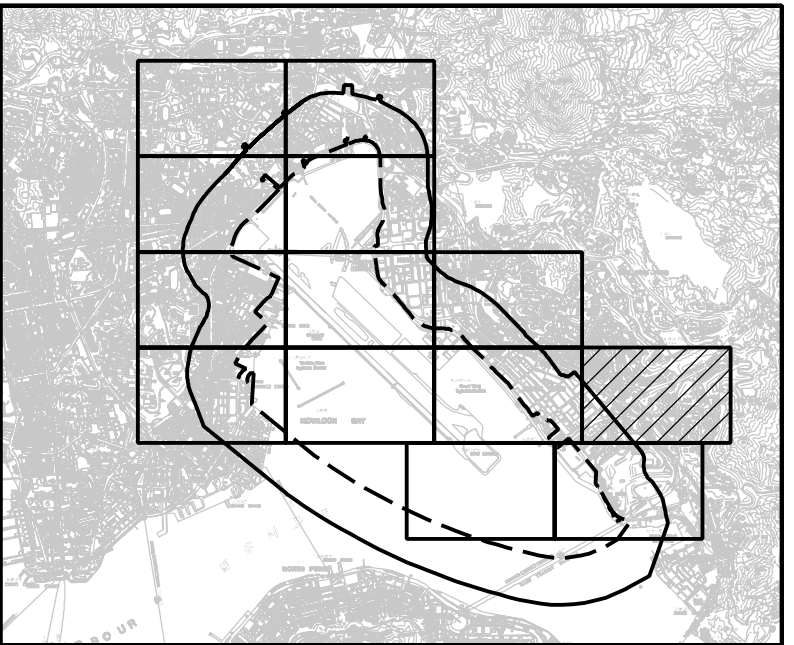
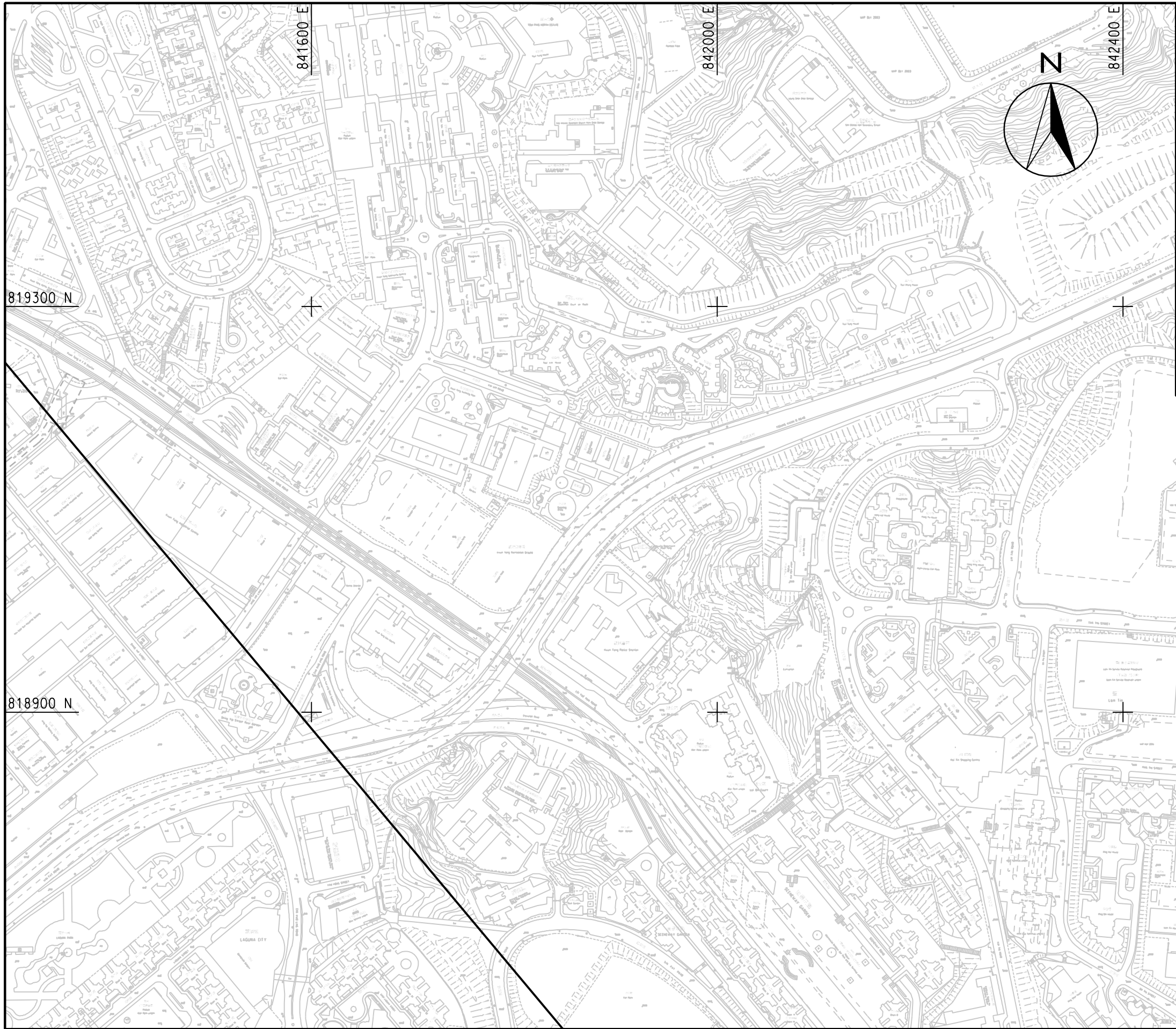

- LEGEND:**
- PROJECT BOUNDARY
 - STUDY BOUNDARY
 - A1/PA1 AIR SENSITIVE RECEIVERS

MAUNSELL AECOM Maunsell Consultants Asia Ltd	AGREEMENT NO. CE 35/2006 (CE) KAI TAK DEVELOPMENT ENGINEERING STUDY CUM DESIGN AND CONSTRUCTION OF ADVANCE WORKS-INVESTIGATION, DESIGN AND CONSTRUCTION				SCALE	A3 1:4000	DATE	JAN. 2008
	LOCATIONS OF AIR SENSITIVE RECEIVERS (SHEET 12 OF 14)				CHECK	—	DRAWN	LCR
					JOB No.	60022503	DRAWING No.	3.1
							REV	

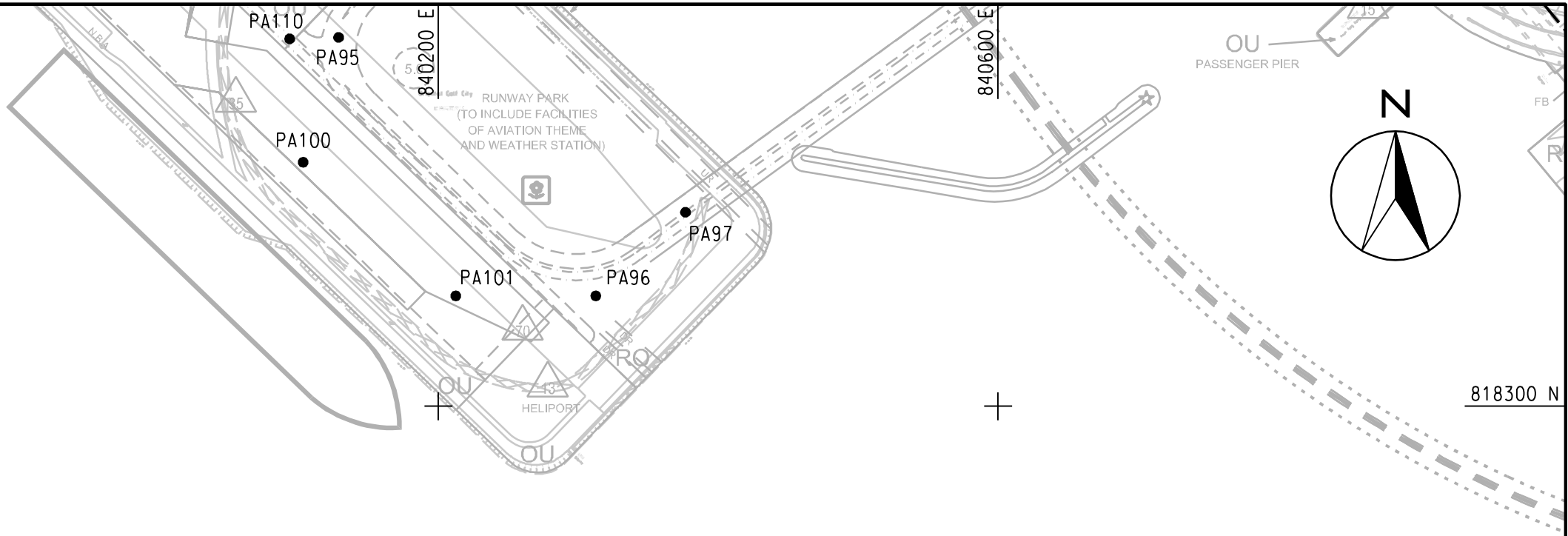
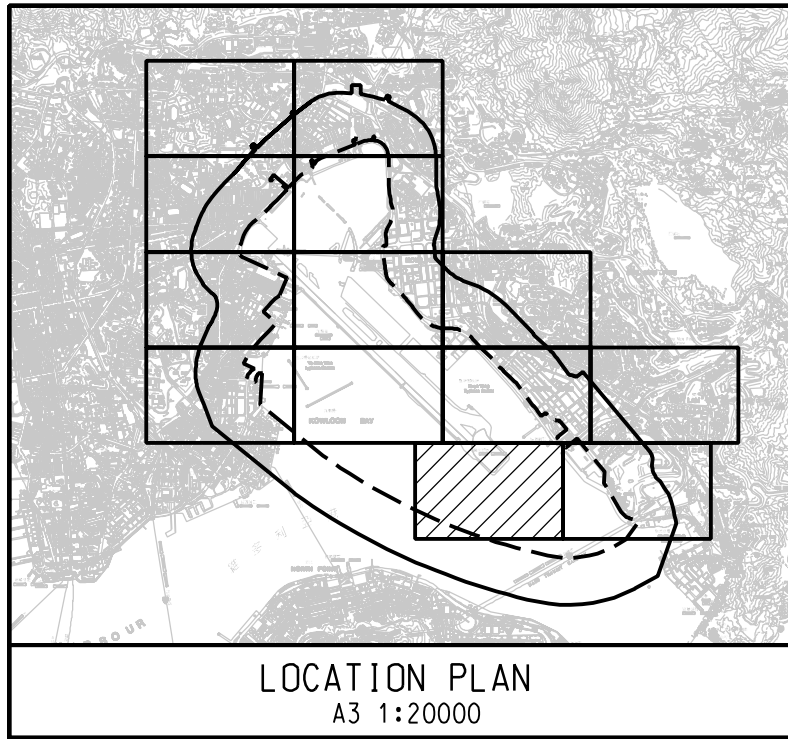

LEGEND:

- PROJECT BOUNDARY
- STUDY BOUNDARY
- A1/PA1 AIR SENSITIVE RECEIVERS

AGREEMENT NO. CE 35/2006 (CE)
KAI TAK DEVELOPMENT ENGINEERING STUDY CUM DESIGN AND
CONSTRUCTION OF ADVANCE WORKS-INVESTIGATION, DESIGN AND CONSTRUCTION

LOCATIONS OF AIR SENSITIVE RECEIVERS

(SHEET 13 OF 14)

SCALE	A3 1:4000	DATE	JAN. 2008
CHECK	—	DRAWN	LCR
JOB No.	60022503	DRAWING No.	3.1
		REV	

DATE 2008-6-20 12:05:57 WANGDF

MAUNSELL | AECOM
Maunsell Consultants Asia Ltd

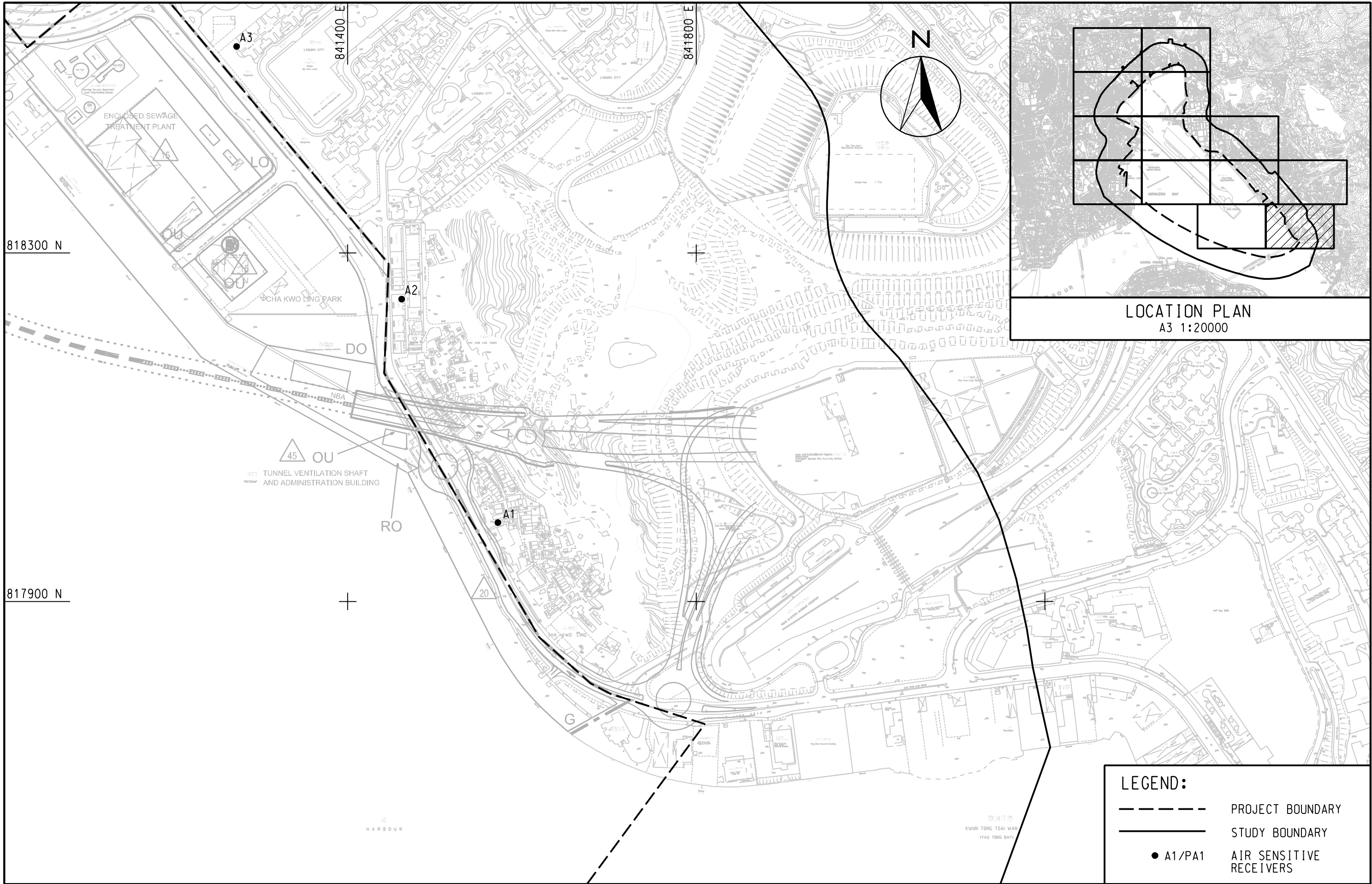

LOCATION PLAN
A3 1:20000

LEGEND:

- PROJECT BOUNDARY
- STUDY BOUNDARY
- A1/PA1 AIR SENSITIVE RECEIVERS

MAUNSELL AECOM Maunsell Consultants Asia Ltd	AGREEMENT NO. CE 35/2006 (CE) KAI TAK DEVELOPMENT ENGINEERING STUDY CUM DESIGN AND CONSTRUCTION OF ADVANCE WORKS-INVESTIGATION, DESIGN AND CONSTRUCTION				SCALE	A3 1:4000	DATE	JAN. 2008
	LOCATIONS OF AIR SENSITIVE RECEIVERS (SHEET 14 OF 14)				CHECK	—	DRAWN	LCR
					JOB No.	60022503	DRAWING No.	3.1