

**Vol. 2 of 5**

**FEP-01/457/2013/C**

**Central Kowloon Route**

**Kai Tak West**

**Contract No. HY/2014/07**

**May 2020**





## Environmental Permit No. EP-457/2013/C

### Central Kowloon Route

### Independent Environmental Checker Verification

Works Contract:	Kai Tak West (HY/2014/07)
-----------------	---------------------------

#### Reference Document/Plan

Document/ <del>Plan</del> to be <del>Certified</del> / Verified:	Monthly EM&A Report No.26 (May 2020)
Date of Report:	June 2020 (Rev. 0)
Date received by IEC:	5 June 2020

#### Reference EP Condition

Environmental Permit Condition:	3.4
Submission of Monthly EM&A Report of the Project	
3.4 Four hard copies and one electronic copy of monthly EM&A Report shall be submitted to the Director within 2 weeks after the end of each reporting month throughout the entire construction period. The EM&A Reports shall include a summary of all non-compliance. The submissions shall be certified by the ET Leader and verified by the IEC as complying with the requirements as set out in the EM&A Manual before submission to the Director. Additional copies of the submission shall be provided to the Director upon request by the Director.	

#### IEC Verification

I hereby verify that the above referenced document/ <del>plan</del> complies with the above referenced condition of EP-457/2013/C and FEP-01/457/2013/C.	
	
Ms Mandy To	Date: 10 June 2020
Independent Environmental Checker	

Our ref: 0436942\_IEC Verification Cert\_KTW\_Monthly EM&A Rpt No.26.docx



**Gammon Construction Limited**

**Central Kowloon Route**  
**Works Contract HY/2014/07 –**  
**Central Kowloon Route – Kai Tak West**  
**Monthly EM&A Report for May 2020**

[June 2020]

	Name	Signature
Prepared & Checked:	Ray Cheng	
Reviewed, Approved & Certified:	Y T Tang	

Version: 0

Date: 10 June 2020

**Disclaimer**

This Environmental Monitoring and Audit Report is prepared for Gammon Construction Limited and is given for its sole benefit in relation to and pursuant to Contract HY/2014/07 and may not be disclosed to, quoted to or relied upon by any person other than Gammon Construction Limited without our prior written consent. No person (other than Gammon Construction Limited into whose possession a copy of this report comes may rely on this plan without our express written consent and Gammon Construction Limited may not rely on it for any purpose other than as described above.

AECOM Asia Co. Ltd.  
15/F, Grand Central Plaza, Tower 1, 138 Shatin Rural Committee Road, Shatin, NT, Hong Kong  
Tel: (852) 3922 9000 Fax: (852) 2317 7609 [www.aecom.com](http://www.aecom.com)



**Table of Contents**

	Page
<b>EXECUTIVE SUMMARY .....</b>	<b>1</b>
<b>1 INTRODUCTION.....</b>	<b>3</b>
1.1 Purpose of the Report .....	3
1.2 Report Structure.....	3
<b>2 PROJECT INFORMATION.....</b>	<b>4</b>
2.1 Background .....	4
2.2 Site Description .....	4
2.3 Construction Programme and Activities .....	5
2.4 Project Organization .....	6
2.5 Status of Environmental Licences, Notification and Permits .....	7
<b>3 ENVIRONMENTAL MONITORING REQUIREMENTS .....</b>	<b>8</b>
3.1 Construction Dust Monitoring .....	8
3.2 Construction Noise Monitoring .....	11
3.3 Landscape and Visual .....	13
<b>4 IMPLEMENTATION STATUS OF ENVIRONMENTAL MITIGATION MEASURES.....</b>	<b>13</b>
<b>5 MONITORING RESULTS .....</b>	<b>14</b>
5.1 Construction Dust Monitoring .....	14
5.2 Regular Construction Noise Monitoring.....	14
5.3 Waste Management.....	15
5.4 Landscape and Visual .....	15
<b>6 ENVIRONMENTAL SITE INSPECTION AND AUDIT.....</b>	<b>16</b>
6.2 Summary of Monitoring Exceedances .....	17
6.3 Summary of Environmental Non-Compliance .....	17
6.4 Summary of Environmental Complaints.....	17
6.5 Summary of Environmental Summon and Successful Prosecutions .....	17
<b>7 FUTURE KEY ISSUES.....</b>	<b>18</b>
7.1 Construction Programme for the Next Three Month.....	18
7.2 Key Issues for the Coming Month.....	18
7.3 Monitoring Schedule for the Coming Month .....	18
<b>8 CONCLUSIONS AND RECOMMENDATIONS.....</b>	<b>19</b>
8.1 Conclusions.....	19
8.2 Recommendations .....	19

**List of Tables**

Table 2.1	Construction Activities in the reporting month .....	5
Table 2.2	Contact Information of Key Personnel .....	6
Table 2.3	Status of Environmental Licenses, Notifications and Permits .....	7
Table 3.1	Air Quality Monitoring Equipment .....	8
Table 3.2	Location of Construction Dust Monitoring Station.....	8
Table 3.3	Noise Monitoring Parameters, Frequency and Duration.....	11
Table 3.4	Noise Monitoring Equipment for Regular Noise Monitoring.....	11
Table 3.5	Noise Monitoring Stations during Construction Phase .....	11
Table 3.6	Noise Monitoring Parameters, Frequency and Duration.....	12
Table 4.1	Status of Required Submission under Environmental Permit.....	13
Table 5.1	Summary of 24-hour TSP Monitoring Result in the Reporting Period .....	14
Table 5.2	Summary of 1-hour TSP Monitoring Result in the Reporting Period .....	14
Table 5.3	Summary of Construction Noise Monitoring Results in the Reporting Period .....	14
Table 6.1	Observations and Recommendations of Site Audit .....	16
Table 7.1	Construction Activities in the coming three month.....	18

**List of Figures**

Figure 1.1	Site Layout Plan
Figure 3.1	Location of Air Quality Monitoring Station
Figure 3.2	Locations of Noise Monitoring Station

**List of Appendices**

Appendix A	Construction Programme
Appendix B	Project Organization Structure
Appendix C	Implementation Schedule of Environmental Mitigation Measures
Appendix D	Summary of Action and Limit Levels
Appendix E	Calibration Certificates of Equipment
Appendix F	EM&A Monitoring Schedules
Appendix G	Air Quality Monitoring Results and their Graphical Presentations
Appendix H	Noise Monitoring Results and their Graphical Presentations
Appendix I	Event and Action Plan
Appendix J	Cumulative Statistics on Complaints, Notification of Summons and Successful Prosecutions
Appendix K	Monthly Summary Waste Flow Table

## EXECUTIVE SUMMARY

Central Kowloon Route – Kai Tak West (CKR-KTW; Contract No. HY/2014/07) (hereafter called “the Project”) covers part of the construction of the Central Kowloon Route (CKR).

The Project comprises the follow works:

- 50x30m access shaft with noise enclosure at Ma Tau Kok (MTK);
- 100m long cut-and-cover (C&C) tunnel at MTK;
- Demolition and re-provisioning of MTK Public Pier;
- 160m long underwater tunnel (UWT) (Stage 1);
- 210m long UWT (Stage 2);
- 60m long C&C tunnel at Kai Tak;
- 130m long depressed road and 200m long underpass at Kai Tak;
- 390m long underground tunnel ventilation adit at Kai Tak;
- Seawall demolition and construction of new landing steps; and
- Barging Point enclosure and conveyor system.

The EM&A programme commenced on 4 April 2018. The impact EM&A for the Project includes air quality and noise monitoring.

This is the twenty-sixth monthly EM&A Report presenting the EM&A works carried out during the period between 1 and 31 May 2020. As informed by the Contractor, major activities in the reporting period were:

Locations	Site Activities
Kai Tak	<ul style="list-style-type: none"> <li>• Excavation and ELS installation at cut &amp; cover tunnel, depressed road and underpass;</li> <li>• Construction of New Right of Way;</li> <li>• Temporary Grouting;</li> <li>• Casting tunnel base slab and wall at Underpass and ventilation adit;</li> <li>• Backfilling at Underpass</li> </ul>
Ma Tau Kok	<ul style="list-style-type: none"> <li>• TTM implementation;</li> <li>• Pipe piling works for cut and cover tunnel;</li> <li>• Rock Excavation;</li> <li>• Shotcreting at the Access Shaft;</li> <li>• Existing drainage diversion works;</li> <li>• Laying of lighting ducts;</li> <li>• Excavation at Covered Walkway</li> </ul>
Kowloon Bay	<ul style="list-style-type: none"> <li>• Excavation for Stage 1 underwater tunnel;</li> <li>• S3 - S4 Truss fabrication and installation;</li> <li>• Temporary Grouting;</li> <li>• Concrete packing between wailing and CPP Wall</li> </ul>
Barging Point	<ul style="list-style-type: none"> <li>• Barging point operation (Spoil Disposal)</li> </ul>

### Breaches of Action and Limit Levels for Air Quality

All 24-hour TSP result was below the Action and Limit Levels at all monitoring locations in the reporting month.

All 1-hour TSP result was below the Action and Limit Levels at all monitoring locations in the reporting month.



**Breaches of Action and Limit Levels for Noise**Regular Noise Monitoring

One (1) noise related complaint was received in the reporting month. Based on the investigation result, the noise nuisance from the construction site was minimized with the proper implementation of mitigation measures. Therefore, one action level of construction noise was triggered, and the investigation report was finalized on 22 May 2020.

No exceedance of Limit Level of noise was recorded in the reporting month.

**Complaint, Notification of Summons and Successful Prosecution**

One (1) complaint received by Environmental Protection Department on 7 February 2020 for noise and referred by the Contractor on 16 May 2020, the investigation report was finalized on 22 May 2020.

No notification of summons and successful prosecution were received in the reporting month.

**Reporting Changes**

There was no reporting change in the reporting month.

**Future Key Issues**

Key issues to be considered in the next three months included:

<b>Locations</b>	<b>Site Activities</b>
Kai Tak	<ul style="list-style-type: none"> <li>• Base slab and wall, roof slab construction at underpass and depressed road;</li> <li>• Excavation and ELS installation at cut &amp; cover tunnel, depressed road and underpass;</li> <li>• Backfilling works and ELS removal at Underpass.</li> </ul>
Ma Tau Kok	<ul style="list-style-type: none"> <li>• TTM implementation;</li> <li>• Rock excavation;</li> <li>• Pipe piling works for cut and cover tunnel;</li> <li>• Laying of lighting ducts at Metered Carpark area;</li> <li>• Fresh water pipe installation works;</li> <li>• Covered walkway construction.</li> </ul>
Kowloon Bay	<ul style="list-style-type: none"> <li>• Excavation for stage 1 underwater tunnel;</li> <li>• S4 - S6 ELS installation;</li> <li>• Temporary Grouting;</li> <li>• Backfilling and ELS removal works;</li> <li>• Blinding layer, base slab and wall construction.</li> </ul>
Barging Point	<ul style="list-style-type: none"> <li>• Barging point operation (Spoil Disposal)</li> </ul>

Potential environmental impacts arising from the above construction activities are mainly associated with construction dust, construction noise, water pollution control, and waste management.

## **1 INTRODUCTION**

Gammon Construction Limited was commissioned by the Highways Department as the Civil Contractor for Works Contract HY/2014/07. AECOM Asia Company Limited (AECOM) was appointed by Gammon Construction Limited as the Environmental Team (ET) to undertake the Environmental Monitoring and Audit (EM&A) programme during construction phase of the Project.

### **1.1 Purpose of the Report**

- 1.1.1 This is the twenty-sixth monthly EM&A Report which summarizes the impact monitoring results and audit findings for the Project during the reporting period between 1 and 31 May 2020.

### **1.2 Report Structure**

- 1.2.1 This monthly EM&A Report is organized as follows:

- Section 1: Introduction
- Section 2: Project Information
- Section 3: Environmental Monitoring Requirement
- Section 4: Implementation Status of Environmental Mitigation Measures
- Section 5: Monitoring Results
- Section 6: Environmental Site Inspection and Audit
- Section 7: Environmental Non-conformance
- Section 8: Future Key Issues
- Section 9: Conclusions and Recommendations

## 2 PROJECT INFORMATION

### 2.1 Background

- 2.1.1 CKR is a dual 3-lane trunk road across central Kowloon linking the West Kowloon in the west and the Kai Tak Development (KTD) in the east. The CKR will be about 4.7 km long with an underground tunnel section of about 3.9 km long, in particular, there will be an underwater tunnel of about 370 m long in Kowloon Bay to the north of the To Kwa Wan Typhoon Shelter. It will connect the West Kowloon Highway at Yau Ma Tei Interchange with the road network at Kowloon Bay and the future Trunk Road T2 at KTD which will connect to the future Tseung Kwan O – Lam Tin Tunnel (TKO-LTT) and Cross Bay Link (CBL). CKR, Trunk Road T2 and TKO-LTT will form a strategic highway link, namely Route 6, connecting West Kowloon and Tseung Kwan O. In addition, 3 ventilation buildings, which will be located in Ya Ma Tei, Ho Man Tin and ex-Kai Tak airport area, are proposed to ensure acceptable air quality within the tunnel.
- 2.1.2 The Environmental Impact Assessment (EIA) Report for Central Kowloon Route (Register No.: AEIAR-171/2013) was approved on 11 July 2013 under the Environmental Impact Assessment Ordinance (EIAO). Following the approval of the EIA Report, an Environmental Permit (EP) for CKR was granted on 9 August 2013 (EP No.: EP- 457/2013) for the construction and operation. Variation of EP (VEP) was subsequently applied and the latest EP (EP No. EP-457/2013/C) was issued by the Director of Environmental Protection (DEP) on 16 January 2017. Further Environmental Permit (EP No. FEP-01/457/2013/C) for CKR – Kai Tak West was issued on 28 February 2018.
- 2.1.3 The construction of the CKR had been divided into different sections. This Work Contract HY/2014/07 – Kai Tak West (KTW) (“The Project”) will include a road which is a trunk road, including new roads, and major extensions or improvements to existing roads; a road fully enclosed by decking above and by structure on the sides for more than 100 m; and reclamation works (including associated dredging works) more than 1 ha in size and a boundary of which is less than 100 m from an existing residential area.
- 2.1.4 The site layout plan of the Project is shown in **Figure 1.1**.

### 2.2 Site Description

- 2.2.1 The major construction activities under this Project include:
- (a) construction of approximately 160m long cut-and-cover tunnel and 370m long underwater tunnel between the tunnel section at Ma Tau Kok and the depressed road of the CKR within Kai Tak Development;
  - (b) reconstruction of the seawall at Ma Tau Kok public pier, and the sloping seawall at the Former Kai Tak Airport Runway;
  - (c) construction of approximately 125m long depressed road and 200m long underpass of the CKR within Kai Tak Development;
  - (d) construction of approximately 360m long underground tunnel ventilation adit of the CKR;
  - (e) reconstruction of Kowloon City Ferry Pier Public Transport Interchange; and
  - (f) other associated works.



**2.3 Construction Programme and Activities**

2.3.1 The major construction activities undertaken in the reporting month are summarized in **Table 2.1**.

**Table 2.1 Construction Activities in the reporting month**

<b>Locations</b>	<b>Site Activities</b>
Kai Tak	<ul style="list-style-type: none"> <li>• Excavation and ELS installation at cut &amp; cover tunnel, depressed road and underpass;</li> <li>• Construction of New Right of Way;</li> <li>• Temporary Grouting;</li> <li>• Casting tunnel base slab and wall at Underpass and ventilation adit;</li> <li>• Backfilling at Underpass</li> </ul>
Ma Tau Kok	<ul style="list-style-type: none"> <li>• TTM implementation;</li> <li>• Pipe piling works for cut and cover tunnel;</li> <li>• Rock Excavation;</li> <li>• Shotcreting at the Access Shaft;</li> <li>• Existing drainage diversion works;</li> <li>• Laying of lighting ducts;</li> <li>• Excavation at Covered Walkway</li> </ul>
Kowloon Bay	<ul style="list-style-type: none"> <li>• Excavation for Stage 1 underwater tunnel;</li> <li>• S3 - S4 Truss fabrication and installation;</li> <li>• Temporary Grouting;</li> <li>• Concrete packing between wailing and CPP Wall</li> </ul>
Barging Point	<ul style="list-style-type: none"> <li>• Barging point operation (Spoil Disposal)</li> </ul>

2.3.2 The construction programme is presented in **Appendix A**.

**2.4 Project Organization**

- 2.4.1 The project organization structure is shown in **Appendix B**. The key personnel contact names and numbers for the Project are summarized in **Table 2.2**.

**Table 2.2 Contact Information of Key Personnel**

Party	Role	Position	Name	Telephone	Fax
Arup-Mott MacDonald Joint Venture	Residential Engineer (ER)	Engineer's Representative	Mr. Jeffrey Lau	2268 3640	2268 3954
ERM	Independent Environmental Checker (IEC)	Independent Environmental Checker	Ms. Mandy To	2271 3313	2723 5660
Gammon	Contractor	Contracts Manager	Mr. Alan Yan	2516 8823	2516 6260
		Environmental Manager	Ms Michelle Tang	9267 8866	
AECOM	Contractor's Environmental Team (ET)	ET Leader	Mr. Y T Tang	3922 9392	2317 7609

**2.5 Status of Environmental Licences, Notification and Permits**

2.5.1 Relevant environmental licenses, permits and/or notifications on environmental protection for this Project and valid in the reporting month are summarized in **Table 2.3**.

**Table 2.3 Status of Environmental Licenses, Notifications and Permits**

Permit / License No. / Notification/ Reference No.	Valid Period		Status	Remarks
	From	To		
Further Environmental Permit				
FEP-01/457/2013/C	28 Feb 2018	End of Project	Valid	--
Wastewater Discharge License				
WT00030290-2018	22 Mar 2018	31 Mar 2023	Valid	Ma Tau Kok
WT00030668-2018	27 Apr 2018	30 Apr 2023	Valid	Site Office at Kai Tak West
WT00030358-2018	27 Apr 2018	30 Apr 2023	Valid	Kai Tak West
WT00030333-2018	27 Apr 2018	30 Apr 2023	Valid	Barging Point at Portions 4B & 4C
WT00030330-2018	27 Apr 2018	30 Apr 2023	Valid	Kowloon Bay
Construction Noise Permit				
GW-RE0108-20	6 Mar 2020	26 Aug 2020	Valid	Barging Point Operation at Kai Tak Barging Point
GW-RE0201-20	16 Apr 2020	15 Jul 2020	Superseded by GW-RE0301-20	Rock Breaking at Ma Tau Kok
GW-RE0301-20	5 May 2020	4 Aug 2020	Valid on 5 May 2020	
GW-RE0986-19	6 Dec 2019	1 Jun 2020	Valid	General Works at Kai Tak
GW-RE1012-19	17 Dec 2019	12 Jun 2020	Valid	Welding and backfilling at Stage 1 Underwater Tunnel
GW-RE0254-20	9 Apr 2020	30 Sep 2020	Valid	Kai Tak Haul Road
Chemical Waste Producer Registration				
5118-247-G2347-47	30 Jan 2018	End of Project	Valid	--
5118-247-G2347-48	30 Jan 2018	End of Project	Valid	--
Marine Dumping Permit				
EP/MD/20-143	16 Apr 2020	30 Jun 2020	Valid	Sediments requiring Type 1 - Open Sea Disposal
EP/MD/20-142	6 Apr 2020	5 May 2020	Valid	Sediments requiring Type 1 (Dedicated Site) and Type 2 Confined Marine Disposal
Billing Account for Construction Waste Disposal				
7029909	22 Jan 2018	End of Project	Account Active	--
7031949	26 Feb 2020	26 May 2020	Account renewed on 27 May 2020	Billing Account for Disposal of Construction Waste (by vessels)
	27 May 2020	26 Aug 2020		
Notification Under Air Pollution Control (Construction Dust) Regulation				
429442	5 Jan 2018	5 Jul 2025	Notified	--



**3 ENVIRONMENTAL MONITORING REQUIREMENTS****3.1 Construction Dust Monitoring*****Monitoring Requirements***

- 3.1.1 In accordance with the approved EM&A Manual, measurement of 24-hour and 1-hour Total Suspended Particulates (TSP) level at the designated air quality monitoring station is required. Impact 24-hour TSP monitoring should be carried out for at least once every 6 days, and 1-hour TSP monitoring should be done at least 3 times every 6 days while the highest dust impact is expected. The Action and Limit Levels of the air quality monitoring is provided in **Appendix D**.

***Monitoring Equipment***

- 3.1.2 24-hour TSP air quality monitoring was performed using High Volume Sampler (HVS) located at the designated monitoring station. The HVS meets all the requirements of the EM&A Manual.
- 3.1.3 A portable direct reading dust meter was used to carry out the 1-hour TSP monitoring.
- 3.1.4 Brand and model of the equipment is given in **Table 3.1**.

**Table 3.1 Air Quality Monitoring Equipment**

Equipment	Brand and Model
High Volume Sampler (24-hour TSP)	Tisch Total Suspended Particulate Mass Flow Controlled High Volume Air Sampler (Model No. TE-5170)
Portable direct reading dust meter (1-hour TSP)	Sibata Digital Dust Monitor (Model No. LD-3)

***Monitoring Locations***

- 3.1.5 The monitoring station for construction dust monitoring pertinent to the Project has been identified based on the approved EM&A Manual for the Project. The location of the construction dust monitoring station is summarized in **Table 3.2** and shown in **Figure 3.1**.

**Table 3.2 Location of Construction Dust Monitoring Station**

Location	Monitoring Station	Description
E-A14a <sup>[1]</sup>	Block B of Merit Industrial Centre	Rooftop (13/F)

Note:

[1] The air monitoring station proposed in the EM&A Manual (i.e. Wyler Gardens with ID: E-A14) was not available for impact dust monitoring, therefore impact monitoring was conducted at E-A14a as an alternative which was agreed by the ER, IEC and EPD.

***Monitoring Methodology*****3.1.6 24-hour TSP Monitoring**

- (a) The HVS was installed in the vicinity of the air sensitive receivers. The following criteria were considered in the installation of the HVS as far as practicable: -
- (i) A horizontal platform with appropriate support to secure the sampler against gusty wind was provided.
  - (ii) Two samplers should not be placed less than 2m apart from each other;
  - (iii) The distance between the HVS and any obstacles, such as buildings, was at least twice the height that the obstacle protrudes above the HVS.
  - (iv) A minimum of 2 meters separation from walls, parapets and penthouse for rooftop sampler.
  - (v) A minimum of 2 meters separation from any supporting structure, measured horizontally is required.
  - (vi) No furnace or incinerator flues nearby.
  - (vii) Airflow around the sampler was unrestricted.
  - (viii) The sampler was located more than 20 meters from any dripline.

- (ix) Any wire fence and gate, required to protect the sampler, did not obstruct the monitoring process.
  - (x) Permission was obtained to set up the samplers and access to the monitoring station.
  - (xi) A secured supply of electricity was obtained to operate the sampler.
- (b) Preparation of Filter Papers
- (i) Glass fibre filters, G810 were labelled and sufficient filters that were clean and without pinholes were selected.
  - (ii) All filters were equilibrated in the conditioning environment for 24 hours before weighing. The conditioning environment temperature was around 25 °C and not variable by more than  $\pm 3$  °C; the relative humidity (RH) was < 50% and not variable by more than  $\pm 5\%$ . A convenient working RH was 40%.
  - (iii) All filter papers were prepared and analysed by ALS Technichem (HK) Pty Ltd., which is a HOKLAS accredited laboratory and has comprehensive quality assurance and quality control programmes.
- (c) Field Monitoring
- (i) The power supply was checked to ensure the HVS works properly.
  - (ii) The filter holder and the area surrounding the filter were cleaned.
  - (iii) The filter holder was removed by loosening the four bolts and a new filter, with stamped number upward, on a supporting screen was aligned carefully.
  - (iv) The filter was properly aligned on the screen so that the gasket formed an airtight seal on the outer edges of the filter.
  - (v) The swing bolts were fastened to hold the filter holder down to the frame. The pressure applied was sufficient to avoid air leakage at the edges.
  - (vi) Then the shelter lid was closed and was secured with the aluminium strip.
  - (vii) The HVS was warmed-up for about 5 minutes to establish run-temperature conditions.
  - (viii) A new flow rate record sheet was set into the flow recorder.
  - (ix) On site temperature and atmospheric pressure readings were taken and the flow rate of the HVS was checked and adjusted at around 1.3 m<sup>3</sup>/min, and complied with the range specified in the EM&A Manual (i.e. 0.6-1.7 m<sup>3</sup>/min).
  - (x) The programmable digital timer was set for a sampling period of 24 hrs, and the starting time, weather condition and the filter number were recorded.
  - (xi) The initial elapsed time was recorded.
  - (xii) At the end of sampling, on site temperature and atmospheric pressure readings were taken and the final flow rate of the HVS was checked and recorded.
  - (xiii) The final elapsed time was recorded.
  - (xiv) The sampled filter was removed carefully and folded in half length so that only surfaces with collected particulate matter were in contact.
  - (xv) It was then placed in a clean envelope and sealed.
  - (xvi) All monitoring information was recorded on a standard data sheet.
  - (xvii) Filters were then sent to ALS Technichem (HK) Pty Ltd. for analysis.
- (d) Maintenance and Calibration
- (i) The HVS and its accessories were maintained in good working condition, such as replacing motor brushes routinely and checking electrical wiring to ensure a continuous power supply.
  - (ii) HVSs were calibrated using TE-5025A Calibration Kit upon installation and thereafter at bi-monthly intervals.
  - (iii) Calibration certificate of the TE-5025A Calibration Kit and the HVSs are provided in **Appendix E**.

### 3.1.7 1-hour TSP Monitoring

- (a) Measuring Procedures
- The measuring procedures of the 1-hour dust meter are in accordance with the Manufacturer's Instruction Manual as follows:
- (i) Turn the power on.
  - (ii) Close the air collecting opening cover.

- (iii) Push the “TIME SETTING” switch to [BG]
  - (iv) Push “START/STOP” switch to perform background measurement for 6 seconds.
  - (v) Turn the knob at SENSI ADJ position to insert the light scattering plate.
  - (vi) Leave the equipment for 1 minute upon “SPAN CHECK” is indicated in the display.
  - (vii) Push “START/STOP” switch to perform automatic sensitivity adjustment. This measurement takes 1 minute.
  - (viii) Pull out the knob and return it to MEASURE position.
  - (ix) Push the “TIME SETTING” switch the time set in the display to 3 hours.
  - (x) Lower down the air collection opening cover.
  - (xi) Push “START/STOP” switch to start measurement.
- (b) Maintenance and Calibration
- (i) The 1-hour TSP meter was calibrated at 1-year intervals against a continuous particulate TEOM Monitor, Series 1400ab. Calibration certificates of the Laser Dust Monitors are provided in **Appendix E**.

***Monitoring Schedule for the Reporting Month***

- 3.1.8 The schedule for environmental monitoring in May 2020 is provided in **Appendix F**.



### 3.2 Construction Noise Monitoring

#### *Monitoring Requirements*

- 3.2.1 In accordance with the EM&A Manual, impact noise monitoring should be conducted for at least once a week during the construction phase of the Project. **Table 3.3** summarizes the monitoring parameters, frequency and duration of impact noise monitoring. The Action and Limit Levels of the noise monitoring is provided in **Appendix D**.

**Table 3.3 Noise Monitoring Parameters, Frequency and Duration**

Parameter and Duration	Frequency
30-mins measurement at each monitoring station between 0700 and 1900 on normal weekdays. $L_{eq}$ , $L_{10}$ and $L_{90}$ would be recorded.	At least once per week

#### *Monitoring Equipment*

- 3.2.2 Noise monitoring was performed using sound level meter at each designated monitoring station. The sound level meters deployed comply with the International Electrotechnical Commission Publications (IEC) 651:1979 (Type 1) and 804:1985 (Type 1) specifications. Acoustic calibrator was deployed to check the sound level meters at a known sound pressure level. Brand and model of the equipment is given in **Table 3.4**.

**Table 3.4 Noise Monitoring Equipment for Regular Noise Monitoring**

Equipment	Brand and Model
Integrated Sound Level Meter	B&K (Model No. 2238)
Acoustic Calibrator	MVI (Model No. CAL21)

#### *Monitoring Locations*

- 3.2.3 The monitoring stations for construction noise monitoring pertinent to the Project have been identified based on the approved EM&A Manual for the Project. Locations of the noise monitoring stations are summarized in **Table 3.5** and shown in **Figure 3.2**.

**Table 3.5 Noise Monitoring Stations during Construction Phase**

Location	Monitoring Station	Description	Measurement
E-N12a <sup>[1]</sup>	19 Hing Yan Street	Rooftop (9/F)	Façade
E-N21a <sup>[1]</sup>	Block B of Merit Industrial Centre	Rooftop (13/F)	Free field <sup>[2]</sup>

Notes:

[1] The noise monitoring stations proposed in the EM&A Manual (i.e. Grand Waterfront Tower 3 with ID: E-N12 and Hang Chien Court Block J with ID: E-N21) were not available for impact noise monitoring, therefore impact monitoring was conducted at E-N12a and E-N21a as an alternative which was agreed by the ER, IEC and EPD.

[2] A correction of +3 dB(A) was made to the free field measurements.

#### *Monitoring Parameters, Frequency and Duration*

- 3.2.4 **Table 3.6** summarizes the monitoring parameters, frequency and duration of impact noise monitoring.

**Table 3.6 Noise Monitoring Parameters, Frequency and Duration**

Location	Parameter and Duration	Frequency
E-N12a and E-N21a	30-mins measurement at each monitoring station between 0700 and 1900 on normal weekdays. L <sub>eq</sub> , L <sub>10</sub> and L <sub>90</sub> would be recorded.	At least once per week

**Monitoring Methodology****3.2.5 Monitoring Procedure**

- (a) The sound level meter was set on a tripod at a height of 1.2 m above the ground.
- (b) Façade measurement was made at E-N12a.
- (c) Free field measurements was made at monitoring location E-N21a. A correction of +3 dB(A) shall be made to the free field measurements.
- (d) The battery condition was checked to ensure the correct functioning of the meter.
- (e) Parameters such as frequency weighting, the time weighting and the measurement time were set as follows:
  - (i) frequency weighting: A
  - (ii) time weighting: Fast
  - (iii) time measurement: L<sub>eq</sub>(30-minutes) during non-restricted hours i.e. 0700 – 1900 on normal weekdays.
- (f) Prior to and after each noise measurement, the meter was calibrated using the acoustic calibrator for 94 dB(A) at 1000 Hz. If the difference in the calibration level before and after measurement was more than 1 dB(A), the measurement would be considered invalid and repeat of noise measurement would be required after re-calibration or repair of the equipment.
- (g) During the monitoring period, the L<sub>eq</sub>, L<sub>10</sub> and L<sub>90</sub> were recorded. In addition, site conditions and noise sources were recorded on a standard record sheet.
- (h) Noise measurement was paused during periods of high intrusive noise (e.g. dog barking, helicopter noise) if possible. Observations were recorded when intrusive noise was unavoidable.
- (i) Noise monitoring was cancelled in the presence of fog, rain, wind with a steady speed exceeding 5m/s, or wind with gusts exceeding 10m/s.

**3.2.6 Maintenance and Calibration**

- (a) The microphone head of the sound level meter was cleaned with soft cloth at regular intervals.
- (b) The meter and calibrator were sent to the supplier or HOKLAS laboratory to check and calibrate at yearly intervals.
- (c) Calibration certificates of the sound level meters and acoustic calibrators are provided in **Appendix E**.

**Monitoring Schedule for the Reporting Month**

3.2.7 The schedule for environmental monitoring in May 2020 is provided in **Appendix F**.

### 3.3 Landscape and Visual

- 3.3.1 As per the EM&A Manuals, the landscape and visual mitigation measures shall be implemented and site inspections should be undertaken once every two weeks during the construction period. A summary of the implementation status is presented in **Section 6**.

## 4 IMPLEMENTATION STATUS OF ENVIRONMENTAL MITIGATION MEASURES

- 4.1.1 The Contractor has implemented environmental mitigation measures and requirements as stated in the EIA Reports, the EP and EM&A Manuals. The implementation status of the environmental mitigation measures during the reporting period is summarized in **Appendix C**. Status of required submissions under the EP during the reporting period is summarised in **Table 4.1**.

**Table 4.1 Status of Required Submission under Environmental Permit**

EP Condition	Submission	Submission Date
Condition 3.4 of EP- 457/2013/C and Condition 3.4 of FEP-01/457/2013/C	Monthly EM&A Report for April 2020	14 May 2020

## 5 MONITORING RESULTS

### 5.1 Construction Dust Monitoring

- 5.1.1 The monitoring results for 24-hour TSP and 1-hour TSP are summarized in **Table 5.1** and **Table 5.2** respectively. Detailed air quality monitoring results and daily extract of meteorological observations are presented in **Appendix G**.

**Table 5.1 Summary of 24-hour TSP Monitoring Result in the Reporting Period**

ID	Average ( $\mu\text{g}/\text{m}^3$ )	Range ( $\mu\text{g}/\text{m}^3$ )	Action Level ( $\mu\text{g}/\text{m}^3$ )	Limit Level ( $\mu\text{g}/\text{m}^3$ )
E-A14a	30.3	20.8 – 41.4	197.3	260

**Table 5.2 Summary of 1-hour TSP Monitoring Result in the Reporting Period**

ID	Average ( $\mu\text{g}/\text{m}^3$ )	Range ( $\mu\text{g}/\text{m}^3$ )	Action Level ( $\mu\text{g}/\text{m}^3$ )	Limit Level ( $\mu\text{g}/\text{m}^3$ )
E-A14a	59.6	56.2 – 61.7	302.4	500

- 5.1.2 No Action and Limit Level exceedance was recorded for 24-hour TSP monitoring at the monitoring location in the reporting month.
- 5.1.3 No Action and Limit Level exceedance was recorded for 1-hour TSP monitoring at the monitoring location in the reporting month.
- 5.1.4 The event and action plan is annexed in **Appendix I**.
- 5.1.5 Major dust sources during the monitoring included construction dust and nearby traffic emission.

### 5.2 Regular Construction Noise Monitoring

- 5.2.1 The monitoring results for noise are summarized in **Table 5.3** and the monitoring data is provided in **Appendix H**.

**Table 5.3 Summary of Construction Noise Monitoring Results in the Reporting Period**

ID	Range, dB(A), $L_{eq}$ (30 mins)	Limit Level, dB(A), $L_{eq}$ (30 mins)
E-N12a	65.0 – 68.1	75
E-N21a	63.8 – 67.5	75

- 5.2.2 One (1) noise related complaint was received in the reporting month. Based on the investigation result, the noise nuisance from the construction site was minimized with the proper implementation of mitigation measures. Therefore, one action level of construction noise was triggered, and the investigation report was finalized on 22 May 2020.
- 5.2.3 No Limit Level exceedance of noise was recorded at the monitoring station in the reporting month.
- 5.2.4 The event and action plan is annexed in **Appendix I**.
- 5.2.5 Major noise sources during the monitoring included construction noise from the Project site and nearby traffic noise.

### 5.3 Waste Management

- 5.3.1 C&D materials and wastes sorting were carried out on site. Receptacles were available for C&D wastes and general refuse collection.
- 5.3.2 According to the Contractor's information, the concerned soil, which assessed under the updated Supplementary Contamination Assessment Report, had been excavated in August 2019. In order to minimize the potentially adverse environmental impacts arising for the handling of potentially contaminated materials, the following environmental mitigation measures are proposed during the course soil excavation, stockpiling and backfilling works:
- Excavation profiles must be properly designed and executed.
  - Stockpiling site(s) shall be lined with impermeable sheeting and bunded. Stockpiles shall be fully covered by impermeable sheeting to reduce dust emission.
  - Excavation and stockpiling should be carried out during dry season as far as possible to minimise potentially contaminated runoffs from the Concerned Soil.
  - Regular site audit will be conducted under the Environmental Monitoring and Audit (EM&A) programme to ensure the soil excavation, stockpiling and backfilling works are carried out in accordance with this report. Findings of the site audit will be presented in **Table 6.1**.
  - The truck transferring Concerned Soil shall be covered entirely by impervious sheeting to ensure that the dusty materials do not leak from the truck.
- 5.3.3 As advised by the Contractor, Total 46,745 m<sup>3</sup> of inert C&D material was generated, 40,742 m<sup>3</sup> inert C&D material was disposed at the Public Fills, 6,003 m<sup>3</sup> was reused in other contract in the reporting month. 36,930 kg general refuse was generated and sent to NENT Landfill in the reporting month. No paper/cardboard packaging, metals and plastics were collected by recycle contractor in the reporting month. No chemical waste was collected by licensed contractor in the reporting period. 6,134 m<sup>3</sup> of Type 1, 1,051 m<sup>3</sup> of Type 2 and no Type 3 Marine sediment were disposed at Confined Marine Disposal Facility to the East of Sha Chau. The waste flow table is annexed in **Appendix K**.
- 5.3.4 The Contractor is advised to properly maintain on site C&D materials and wastes collection, sorting and recording system and maximize reuse / recycle of C&D materials and wastes. The Contractor is reminded to properly maintain the site tidiness and dispose of the wastes accumulated on site regularly and properly.
- 5.3.5 The Contractor is reminded that chemical waste containers should be properly treated and stored temporarily in designated chemical waste storage area on site in accordance with the Code of Practise on the Packaging, Labelling and Storage of Chemical Wastes.

### 5.4 Landscape and Visual

- 5.4.1 Bi-weekly inspection of the implementation of landscape and visual mitigation measures was conducted on 6 and 20 May 2020. A summary of the site inspection is provided in **Appendix C**. The observations and recommendations made during the site inspections are presented in **Table 6.1**.

**6 ENVIRONMENTAL SITE INSPECTION AND AUDIT**

- 6.1.1 Site inspections were carried out on a weekly basis to monitor the implementation of proper environmental pollution control and mitigation measures for the Project. A summary of the mitigation measures implementation schedule is provided in **Appendix C**.
- 6.1.2 In the reporting month, 4 site inspections were carried out on 6, 13, 20 and 27 May 2020. Joint inspections with the IEC, ER, the Contractor and the ET were conducted on 20 May 2020. In addition, no joint inspection with EPD, ER and the Contractor was conducted in May 2020 to check the compliance of the dumping permit condition. No non-compliance was recorded during the site inspection. Details of observations recorded during the site inspections are presented in **Table 6.1**.

**Table 6.1 Observations and Recommendations of Site Audit**

Parameters	Date	Observations and Recommendations	Follow-up
Air Quality	13 May 2020	<ul style="list-style-type: none"> <li>Dark smoke emission was observed at the drill rig in Access Shaft of Ma Tau Kok. The Contractor was reminded to provide proper maintenance for the drill rig to prevent dark smoke emission.</li> </ul>	The item was rectified on 15 May 2020
Noise	Nil	Nil	Nil
Water Quality	6 May 2020	<ul style="list-style-type: none"> <li>Drip tray was not provided for the air compressor at Ma Tau Kok. The Contractor was reminded to provide a drip tray to prevent accidental spillage.</li> </ul>	The item was rectified on 11 May 2020.
		<ul style="list-style-type: none"> <li>Floating debris was observed inside the silt curtain at the Steel Platform. The Contractor was reminded to remove the floating debris regularly.</li> </ul>	The item was rectified on 7 May 2020.
	13 May 2020	<ul style="list-style-type: none"> <li>Inadequate maintenance for the silt curtain at Steel Platform was observed. The Contractor was reminded to provide adequate maintenance for the silt curtain.</li> </ul>	The item was rectified on 19 May 2020.
	20 May 2020	<ul style="list-style-type: none"> <li>Muddy water was observed at the discharge point which near the Steel Platform. The Contractor was advised to provide sufficient measure to ensure the quality of water discharge is complied with the water discharge license.</li> </ul>	The item was rectified on 21 May 2020.
	27 May 2020	<ul style="list-style-type: none"> <li>Accumulated water was observed inside the drip tray for the air compressor at Ma Tau Kok. The Contractor was reminded to remove the stagnant water to maintain the capacity of drip tray for oil interception.</li> </ul>	The item was rectified on 29 May 2020.
		<p><u>Reminder:</u></p> <ul style="list-style-type: none"> <li>Contractor was reminded to provide proper measure for breaker's head at Landing Step Area to prevent oil spillage.</li> </ul>	The item was rectified on 27 May 2020.
Waste/ Chemical Management	Nil	Nil	Nil
Land Contamination	Nil	Nil	Nil
Landscape & Visual	Nil	Nil	Nil
Permits/ Licenses	Nil	Nil	Nil

- 6.1.3 All follow-up actions requested by Contractor's ET and IEC during the site inspection were undertaken as reported by the Contractor and confirmed in the following weekly site inspection conducted during the reporting period. No follow-up action requested by EPD during the site inspection in the reporting month.

**6.2 Summary of Monitoring Exceedances**

- 6.2.1 All 24-hour TSP result was below the Action and Limit Levels at all monitoring locations in the reporting month.
- 6.2.2 All 1-hour TSP result was below the Action and Limit Levels at all monitoring locations in the reporting month.
- 6.2.3 One (1) noise related complaint was received in the reporting month. Based on the investigation result, the noise nuisance from the construction site was minimized with the proper implementation of mitigation measures. Therefore, one action level of construction noise was triggered, and the investigation report was finalized on 22 May 2020.
- 6.2.4 No Limit Level exceedance for noise was recorded at all monitoring stations in the reporting month.

**6.3 Summary of Environmental Non-Compliance**

- 6.3.1 No environmental non-compliance was recorded in the reporting month.

**6.4 Summary of Environmental Complaints**

- 6.4.1 One (1) complaint received by Environmental Protection Department on 7 February 2020 for noise and referred by the Contractor on 16 May 2020, the investigation report was finalized on 22 May 2020. Cumulative statistics on notification of complaint is provided in **Appendix J**

**6.5 Summary of Environmental Summon and Successful Prosecutions**

- 6.5.1 No environmental related prosecution or notification of summons was received in the reporting month. Cumulative statistics on notification of summons and successful prosecutions is provided in **Appendix J**.

## 7 FUTURE KEY ISSUES

### 7.1 Construction Programme for the Next Three Month

7.1.1 The major construction works between June and August 2020 is provided in **Table 7.1**.

**Table 7.1 Construction Activities in the coming three months**

Locations	Site Activities
Kai Tak	<ul style="list-style-type: none"> <li>Base slab and wall, roof slab construction at underpass and depressed road;</li> <li>Excavation and ELS installation at cut &amp; cover tunnel, depressed road and underpass;</li> <li>Backfilling works and ELS removal at Underpass.</li> </ul>
Ma Tau Kok	<ul style="list-style-type: none"> <li>TTM implementation;</li> <li>Rock excavation;</li> <li>Pipe piling works for cut and cover tunnel;</li> <li>Laying of lighting ducts at Metered Carpark area;</li> <li>Fresh water pipe installation works;</li> <li>Covered walkway construction.</li> </ul>
Kowloon Bay	<ul style="list-style-type: none"> <li>Excavation for stage 1 underwater tunnel;</li> <li>S4 - S6 ELS installation;</li> <li>Temporary Grouting;</li> <li>Backfilling and ELS removal works;</li> <li>Blinding layer, base slab and wall construction.</li> </ul>
Barging Point	<ul style="list-style-type: none"> <li>Barging point operation (Spoil Disposal)</li> </ul>

### 7.2 Key Issues for the Coming Month

7.2.1 Potential environmental impacts arising from the above construction activities are mainly associated with construction dust, construction noise, and waste management.

### 7.3 Monitoring Schedule for the Coming Month

7.3.1 The tentative schedule for environmental monitoring in June 2020 is provided in **Appendix F**.



## 8 CONCLUSIONS AND RECOMMENDATIONS

### 8.1 Conclusions

- 8.1.1 24-hour TSP and noise monitoring were carried out in the reporting month.
- 8.1.2 All 24-hour TSP monitoring results complied with the Action / Limit Level at in the reporting month.
- 8.1.3 All 1-hour TSP result was below the Action and Limit Levels at all monitoring locations in the reporting month.
- 8.1.4 One (1) noise related complaint was received in the reporting month. Based on the investigation result, the noise nuisance from the construction site was minimized with the proper implementation of mitigation measures. Therefore, one action level of construction noise was triggered, and the investigation report was finalized on 22 May 2020.
- 8.1.5 No Limit Level exceedance for noise was recorded at all monitoring stations in the reporting month.
- 8.1.6 4 nos. of environmental site inspections and no site inspections with EPD were carried out in May 2020. Recommendations on remedial actions were given to the Contractor for the deficiencies identified during the site audit.
- 8.1.7 One (1) complaint received by Environmental Protection Department on 7 February 2020 for noise and referred by the Contractor on 16 May 2020, the investigation report was finalized on 22 May 2020.
- 8.1.8 No notification of summons and successful prosecution were received in the reporting month.

### 8.2 Recommendations

- 8.2.1 According to the environmental site inspections performed in the reporting month, the following recommendations were provided:

#### Air Quality Impact

- The Contractor was reminded to provide proper maintenance for the drill rig to prevent dark smoke emission.

#### Construction Noise Impact

- No specific observation was identified in the reporting month.

#### Water Quality Impact

- The Contractor was reminded to provide a drip tray to prevent accidental spillage.
- The Contractor was reminded to remove the floating debris regularly.
- The Contractor was reminded to provide adequate maintenance for the silt curtain.
- The Contractor was advised to provide sufficient measure to ensure the quality of water discharge is complied with the water discharge license.
- The Contractor was reminded to remove the stagnant water to maintain the capacity of drip tray for oil interception.
- The Contractor was reminded to provide proper measure for breaker's head at Landing Step Area to prevent oil spillage.

#### Chemical and Waste Management

- No specific observation was identified in the reporting month.

Landscape & Visual Impact

- No specific observation was identified in the reporting month.

Permits/licenses

- No specific observation was identified in the reporting month.

---

## FIGURES

---

ISO A1 594mm x 841mm  
Project Management Initials:  
SDATES  
PLOT BY: SUSERS  
PATH \$FILES

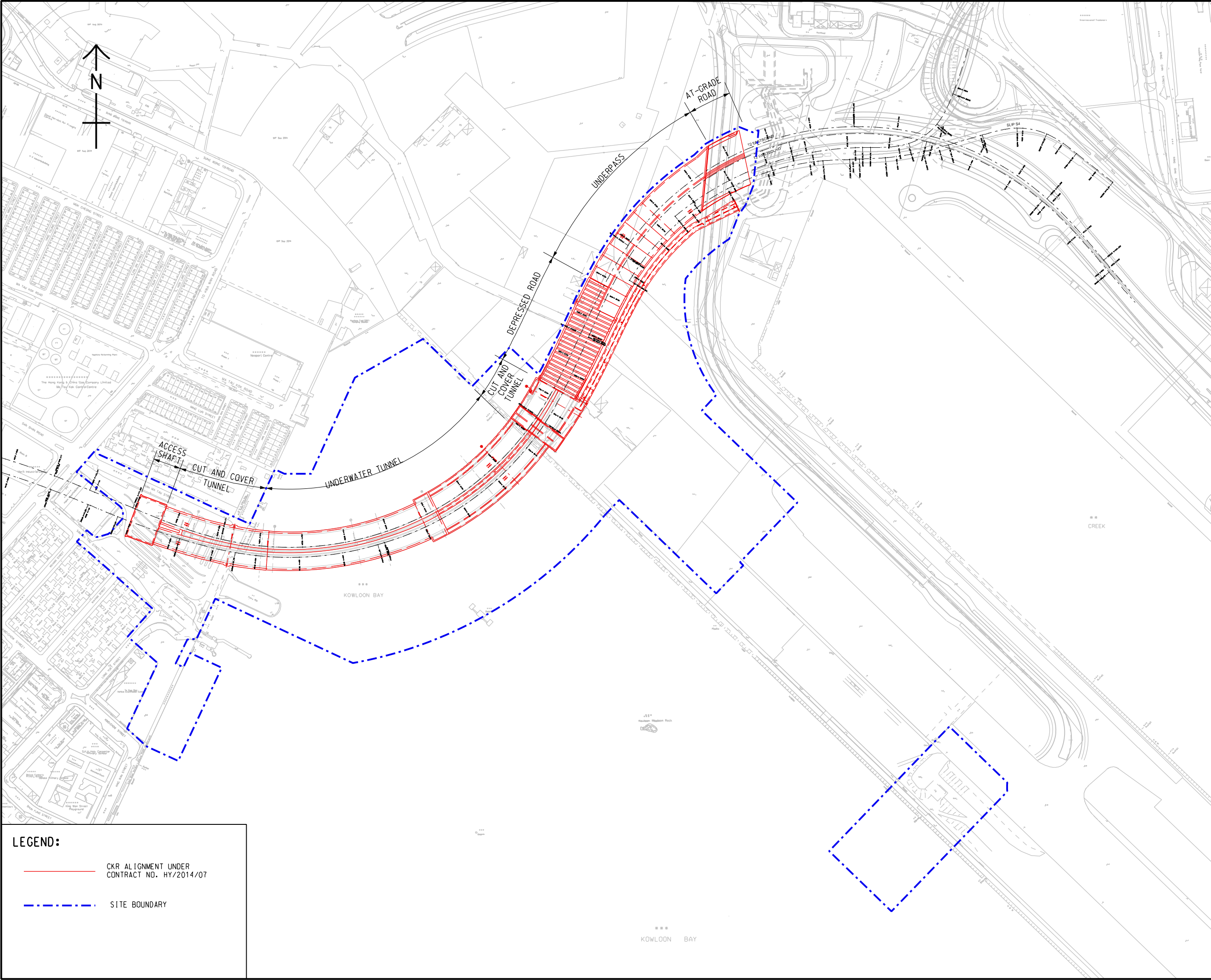

- LEGEND:**
- CKR ALIGNMENT UNDER CONTRACT NO. HY/2014/07
  - SITE BOUNDARY

AECOM

PROJECT

CONTRACT NO.  
HY/2014/07  
CENTRAL KOWLOON  
ROUTE -  
KAI TAK WEST

CLIENT

GAMMON CONSTRUCTION LIMITED

CONSULTANT

AECOM Asia Company Ltd.  
www.aecom.com

SUB-CONSULTANTS

ISSUE/REVISION

I/R	DATE	DESCRIPTION	CHK.
1/1	11/01/2014	ISSUED FOR TENDER	11/01/2014

STATUS

SCALE

A3 1 : 4000

DIMENSION UNIT

METRES

KEY PLAN

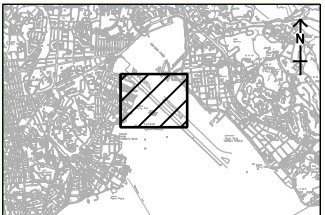

PROJECT NO.

AGREEMENT NO.

SHEET TITLE

SITE LAYOUT PLAN

SHEET NUMBER

FIGURE 1.1



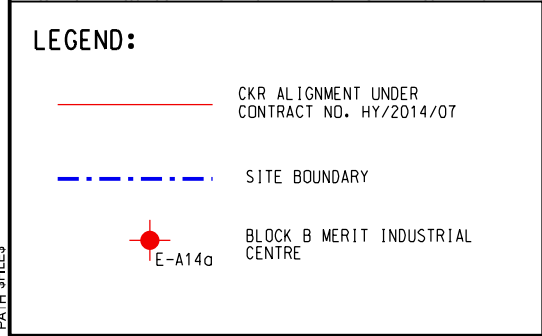

ISO A1 594mm x 841mm  
Project Management Initials: Designer: Checker: Approver:  
PLOT BY: USERS  
DATE: 2014/07/07  
PATH: 1/1

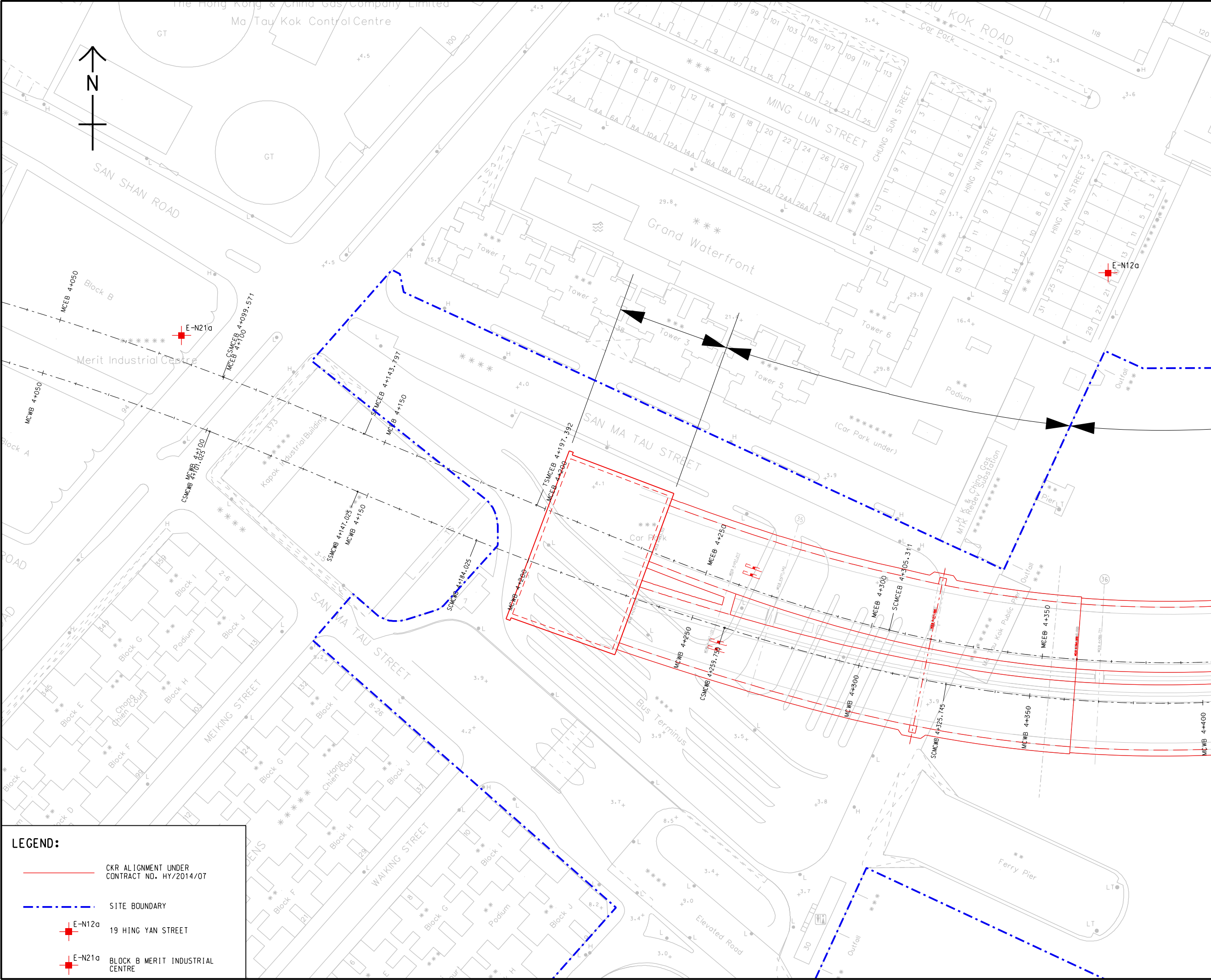

**LEGEND:**

- CKR ALIGNMENT UNDER CONTRACT NO. HY/2014/07
- SITE BOUNDARY
- E-N120 19 HING YAN STREET
- E-N210 BLOCK B MERIT INDUSTRIAL CENTRE

**PROJECT**  
CONTRACT NO. HY/2014/07  
CENTRAL KOWLOON ROUTE - KAI TAK WEST

**CLIENT**  
GAMMON CONSTRUCTION LIMITED

**CONSULTANT**  
AECOM Asia Company Ltd.  
www.aecom.com

**SUB-CONSULTANTS**  
AECOM Asia Company Ltd.

**ISSUE/REVISION**

IR	DATE	DESCRIPTION	CHK.

**STATUS**  
NOT

**SCALE**  
A3 1: 1000

**DIMENSION UNIT**  
METRES

**KEY PLAN**

**PROJECT NO.**  
HY/2014/07

**AGREEMENT NO.**  
1/1

**SHEET TITLE**  
LOCATION OF NOISE MONITORING STATION

**SHEET NUMBER**  
FIGURE 3.2

This drawing has been prepared for the use of AECOM's client. It may not be used, modified, reproduced or relied upon by third parties, except as approved by AECOM or as required by law. AECOM accepts no responsibility, and denies any liability, whatsoever, to any party, for loss or damage of any kind, arising from the use of this drawing without AECOM's express written consent. All measurements must be obtained from the stated dimensions.

---

## **APPENDIX A**

### **Construction Programme**

---













---

## **APPENDIX B**

### **Project Organization Structure**

---

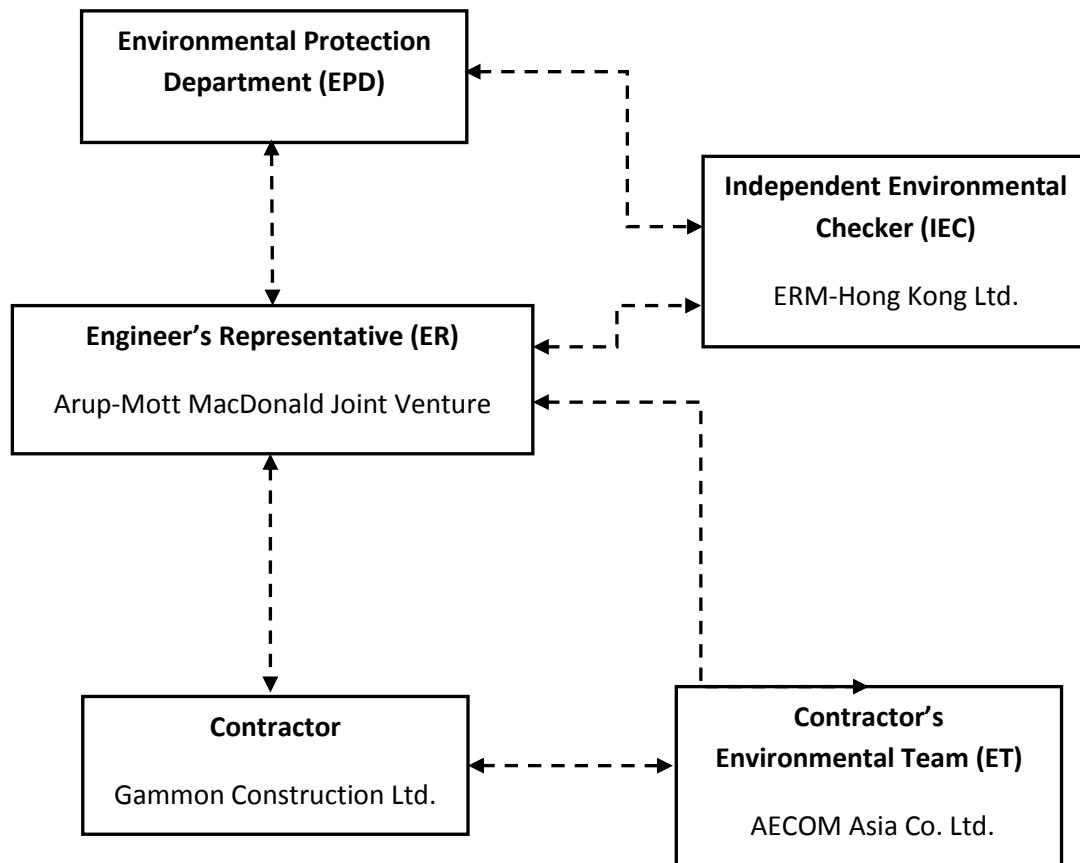
**Appendix B Project Organization Structure**

---

## **APPENDIX C**

### **Implementation Schedule of Environmental Mitigation Measures**

---

**Appendix C – Environmental Mitigation Implementation Schedule**

EIA Ref.	EM&A Log Ref	Recommended Mitigation Measures	Objectives of the Recommended Measures & Main Concern to Address	Who to implement the measures?	Location of the measure	When to implement the measures?	Implementation Status
Air Quality (Construction Phase)							
S4.3.10	D1	The contractor shall follow the procedures and requirements given in the Air Pollution Control (Construction Dust) Regulation	Minimize dust impact at the nearby sensitive receivers	Contractor	All construction sites	Construction stage	@
S4.3.10	D2	<ul style="list-style-type: none"> <li>Mitigation measures in form of regular watering under a good site practice should be adopted. Watering once per hour on exposed worksites and haul road should be conducted to achieve dust removal efficiencies of 91.7%. While the above watering frequencies are to be followed, the extent of watering may vary depending on actual site conditions but should be sufficient to maintain an equivalent intensity of no less than 1.3 L/m<sup>2</sup> to achieve the dust removal efficiency.</li> </ul>	Minimize dust impact at the nearby sensitive receivers	Contractor	All construction sites	Construction stage	V
S4.3.10	D3	<ul style="list-style-type: none"> <li>Proper watering of exposed spoil should be undertaken throughout the construction phase;</li> <li>Any excavated or stockpile of dusty material should be covered entirely by impervious sheeting or sprayed with water to maintain the entire surface wet and then removed or backfilled or reinstated where practicable within 24 hours of the excavation or unloading;</li> <li>Any dusty materials remaining after a stockpile is removed should be wetted with water and cleared from the surface of roads;</li> <li>A stockpile of dusty material should not be extend beyond the pedestrian barriers, fencing or traffic cones.</li> <li>The load of dusty materials on a vehicle leaving a construction site should be covered entirely by impervious sheeting to ensure that the dusty materials do not leak from the vehicle;</li> <li>Where practicable, vehicle washing facilities with high pressure water jet should be provided at every discernible or designated vehicle exit point. The area where vehicle washing takes place and the road section between the washing facilities and the exit point should be paved with concrete, bituminous materials or hardcores;</li> <li>When there are open excavation and reinstatement works, hoarding of not less than 2.4m high should be provided and properly maintained as far as practicable along the site boundary with provision for public crossing; Good site practice shall also be adopted by the Contractor to ensure the conditions of the hoardings are properly maintained throughout the construction period;</li> </ul>	Minimize dust impact at the nearby sensitive receivers	Contractor	All construction sites	Construction stage	V V V V V V

EIA Ref.	EM&A Log Ref	Recommended Mitigation Measures	Objectives of the Recommended Measures & Main Concern to Address	Who to implement the measures?	Location of the measure	When to implement the measures?	Implementation Status
		<ul style="list-style-type: none"> <li>The portion of any road leading only to construction site that is within 30m of a vehicle entrance or exit should be kept clear of dusty materials;</li> <li>Surfaces where any pneumatic or power-driven drilling, cutting, polishing or other mechanical breaking operation takes place should be sprayed with water or a dust suppression chemical continuously;</li> <li>Any area that involves demolition activities should be sprayed with water or a dust suppression chemical immediately prior to, during and immediately after the activities so as to maintain the entire surface wet;</li> <li>Where a scaffolding is erected around the perimeter of a building under construction, effective dust screens, sheeting or netting should be provided to enclose the scaffolding from the ground floor level of the building, or a canopy should be provided from the first floor level up to the highest level of the scaffolding;</li> <li>Any skip hoist for material transport should be totally enclosed by impervious sheeting;</li> <li>Every stock of more than 20 bags of cement or dry pulverised fuel ash (PFA) should be covered entirely by impervious sheeting or placed in an area sheltered on the top and the 3 sides;</li> <li>Cement or dry PFA delivered in bulk should be stored in a closed silo fitted with an audible high level alarm which is interlocked with the material filling line and no overfilling is allowed;</li> <li>Loading, unloading, transfer, handling or storage of bulk cement or dry PFA should be carried out in a totally enclosed system or facility, and any vent or exhaust should be fitted with an effective fabric filter or equivalent air pollution control system; and</li> <li>Exposed earth should be properly treated by compaction, turfing, hydroseeding, vegetation planting or sealing with latex, vinyl, bitumen, shotcrete or other suitable surface stabiliser within six months after the last construction activity on the construction site or part of the construction site where the exposed earth lies.</li> </ul>					V V V V V V V V
S4.3.10	D5	Implement regular dust monitoring under EM&A programme during the construction stage.	Monitoring of dust impact	Contractor	Selected representative dust monitoring station	Construction stage	V
Construction Noise (Airborne)							
S5.4.1	N1	Implement the following good site practices: <ul style="list-style-type: none"> <li>only well-maintained plant should be operated on-site and plant should be serviced</li> </ul>	Control construction airborne noise	Contractor	All construction	Construction stage	V



EIA Ref.	EM&A Log Ref	Recommended Mitigation Measures	Objectives of the Recommended Measures & Main Concern to Address	Who to implement the measures?	Location of the measure	When to implement the measures?	Implementation Status
		regularly during the construction programme; ● machines and plant (such as trucks, cranes) that may be in intermittent use should be shut down between work periods or should be throttled down to a minimum; ● plant known to emit noise strongly in one direction, where possible, be orientated so that the noise is directed away from nearby NSRs; ● silencers or mufflers on construction equipment should be properly fitted and maintained during the construction works; ● mobile plant should be sited as far away from NSRs as possible and practicable; ● material stockpiles, mobile container site office and other structures should be effectively utilised, where practicable, to screen noise from on-site construction activities.			sites		V V V V V
S5.4.1	N2	Install temporary hoarding located on the site boundaries between noisy construction activities and NSRs. The conditions of the hoardings shall be properly maintained throughout the construction period.	Reduce the construction noise levels at low-level zone of NSRs through partial screening.	Contractor	All construction sites	Construction stage	V
S5.4.1	N3	Install movable noise barriers (typical design is wooden framed barrier with a small-cantilevered on a skid footing with 25mm thick internal sound absorptive lining), acoustic mat or full enclosure, screen the noisy plants including air compressors, generators and handheld breakers etc..	Screen the noisy plant items to be used at all construction sites	Contractor	All construction sites where practicable	Construction stage	V
S5.4.1	N4	Use "Quiet plants"	Reduce the noise levels of plant items	Contractor	All construction sites where practicable	Construction stage	V
S5.4.1	N5	Loading/unloading activities should be carried out inside the full enclosure of mucking out points	Reduce the noise levels of loading/unloading activities	Contractor	Mucking out locations	Construction stage	V
S5.4.1	N6	Sequencing operation of construction plants where practicable.	Operate sequentially within the same work site to reduce the	Contractor	All construction sites where practicable	Construction stage	V

EIA Ref.	EM&A Log Ref	Recommended Mitigation Measures	Objectives of the Recommended Measures & Main Concern to Address	Who to implement the measures?	Location of the measure	When to implement the measures?	Implementation Status
			construction airborne noise				
S5.4.1	N7	Implement a noise monitoring under EM&A programme.	Monitor the construction noise levels at the selected representative locations	Contractor	Selected representative noise monitoring station	Construction stage	V
S5.5.2	N8	Install temporary noise barriers along the works area at temporary Kowloon City Ferry Pier Public Transport Interchange	Reduce temporary PTI noise	Contractor	Kowloon City Ferry Pier	Different construction stages	N/A

EIA Ref.	EM&A Log Ref	Recommended Mitigation Measures	Objectives of the Recommended Measures & Main Concern to Address	Who to implement the measures?	Location of the measure	When to implement the measures?	Implementation Status
Water Quality (Construction Phase)							
S6.9.1.1	W1	<p>In accordance with the Practice Note for Professional Persons on Construction Site Drainage, Environmental Protection Department, 1994 (ProPECC PN1/94), construction phase mitigation measures shall include the following:</p> <p><u>Construction Runoff</u></p> <ul style="list-style-type: none"> <li>At the start of site establishment (including the barging facilities), perimeter cut-off drains to direct off-site water around the site should be constructed with internal drainage works and erosion and sedimentation control facilities implemented. Channels (both temporary and permanent drainage pipes and culverts), earth bunds or sand bag barriers should be provided on site to direct stormwater to silt removal facilities. The design of the temporary on-site drainage system will be undertaken by the contractor prior to the commencement of construction.</li> <li>The dikes or embankments for flood protection should be implemented around the boundaries of earthwork areas. Temporary ditches should be provided to facilitate the runoff discharge into an appropriate watercourse, through a site/sediment trap. The sediment/silt traps should be incorporated in the permanent drainage channels to enhance deposition rates.</li> <li>The design of efficient silt removal facilities should be based on the guidelines in Appendix A1 of ProPECC PN 1/94, which states that the retention time for silt/sand traps should be 5 minutes under maximum flow conditions. Sizes may vary depending upon the flow rate, but for a flow rate of 0.1 m<sup>3</sup>/s a sedimentation basin of 30m<sup>3</sup> would be required and for a flow rate of 0.5 m<sup>3</sup>/s the basin would be 150 m<sup>3</sup>. The detailed design of the sand/silt traps shall be undertaken by the contractor prior to the commencement of construction.</li> <li>All exposed earth areas should be completed and vegetated as soon as possible after earthworks have been completed, or alternatively, within 14 days of the cessation of earthworks where practicable. Exposed slope surfaces should be covered by tarpaulin or other means.</li> <li>The overall slope of the site should be kept to a minimum to reduce the erosive potential of surface water flows, and all traffic areas and access roads protected by coarse stone ballast. An additional advantage accruing from the use of crushed stone is the positive traction gained during prolonged periods of inclement weather</li> </ul>	To minimize water quality impact from construction site runoff and general construction activities	Contractor	All construction sites where practicable	Construction stage	<p>V</p> <p>V</p> <p>V</p> <p>V</p>

EIA Ref.	EM&A Log Ref	Recommended Mitigation Measures	Objectives of the Recommended Measures & Main Concern to Address	Who to implement the measures?	Location of the measure	When to implement the measures?	Implementation Status
		<p>and the reduction of surface sheet flows.</p> <ul style="list-style-type: none"> <li>● All drainage facilities and erosion and sediment control structures should be regularly inspected and maintained to ensure proper and efficient operation at all times and particularly following rainstorms. Deposited silt and grit should be removed regularly and disposed of by spreading evenly over stable, vegetated areas.</li> <li>● Measures should be taken to minimize the ingress of site drainage into excavations. If the excavation of trenches in wet periods is necessary, they should be dug and backfilled in short sections wherever practicable. Water pumped out from trenches or foundation excavations should be discharged into storm drains via silt removal facilities.</li> <li>● Open stockpiles of construction materials (for example, aggregates, sand and fill material) of more than 50m<sup>3</sup> should be covered with tarpaulin or similar fabric during rainstorms. Measures should be taken to prevent the washing away of construction materials, soil, silt or debris into any drainage system.</li> <li>● Manholes (including newly constructed ones) should always be adequately covered and temporarily sealed so as to prevent silt, construction materials or debris being washed into the drainage system and storm runoff being directed into foul sewers.</li> <li>● Precautions be taken at any time of year when rainstorms are likely, actions to be taken when a rainstorm is imminent or forecasted, and actions to be taken during or after rainstorms are funneling in Appendix A2 of ProPECC PN 1/94. Particular attention should be paid to the control of silty surface runoff during storm events, especially for areas located near steep slopes.</li> <li>● All vehicles and plant should be cleaned before leaving a construction site to ensure no earth, mud, debris and the like is deposited by them on roads. An adequately designed and sited wheel washing facilities should be provided at every construction site exit where practicable. Wash-water should have sand and silt settled out and removed at least on a weekly basis to ensure the continued efficiency of the process. The section of access road leading to, and exiting from, the wheel-wash bay to the public road should be paved with sufficient backfall toward the wheel-wash bay to prevent vehicle tracking of soil and silty water to public roads and drains.</li> </ul>					<p>@</p> <p>V</p> <p>V</p> <p>V</p> <p>V</p> <p>V</p>

EIA Ref.	EM&A Log Ref	Recommended Mitigation Measures	Objectives of the Recommended Measures & Main Concern to Address	Who to implement the measures?	Location of the measure	When to implement the measures?	Implementation Status
		<ul style="list-style-type: none"> <li>Oil interceptors should be provided in the drainage system downstream of any oil/fuel pollution sources. The oil interceptors should be emptied and cleaned regularly to prevent the release of oil and grease into the storm water drainage system after accidental spillage. A bypass should be provided for the oil interceptors to prevent flushing during heavy rain.</li> <li>Construction solid waste, debris and rubbish on site should be collected, handled and disposed of properly to avoid water quality impacts.</li> <li>All fuel tanks and storage areas should be provided with locks and sited on sealed areas, within bunds of a capacity equal to 110% of the storage capacity of the largest tank to prevent spilled fuel oils from reaching water sensitive receivers nearby.</li> <li>Adopt best management practices</li> <li>All the earth works involving should be conducted sequentially to limit the amount of construction runoff generated from exposed areas during the wet season (April to September) as far as practicable.</li> </ul>					<p>@</p> <p>@</p> <p>@</p> <p>V</p> <p>V</p>
S6.9.1.2	W2	<u>Tunnelling Works and Underground Works</u> <ul style="list-style-type: none"> <li>Cut-&amp;-cover tunneling work should be conducted sequentially to limit the amount of construction runoff generated from exposed areas during the wet season (April to September) as far as practicable.</li> <li>Uncontaminated discharge should pass through sedimentation tanks prior to off-site discharge</li> <li>The wastewater with a high concentration of SS should be treated (e.g. by sedimentation tanks with sufficient retention time) before discharge. Oil interceptors would also be required to remove the oil, lubricants and grease from the wastewater.</li> <li>Direct discharge of the bentonite slurry (as a result of D-wall and bored tunneling construction) is not allowed. It should be reconditioned and reused wherever practicable. Temporary storage locations (typically a properly closed warehouse) should be provided on site for any unused bentonite that needs to be transported away after all the related construction activities are completed. The requirements in ProPECC PN 1/94 should be adhered to in the handling and disposal of bentonite slurries.</li> </ul>	To minimize construction water quality impact from tunneling works	Contractor	All tunneling portion	Construction stage	N/A
S6.9.1.3	W3	<u>Sewage Effluent</u> <ul style="list-style-type: none"> <li>Portable chemical toilets and sewage holding tanks are recommended for handling</li> </ul>	To minimize water quality	Contractor	All construction sites	Construction stage	V

EIA Ref.	EM&A Log Ref	Recommended Mitigation Measures	Objectives of the Recommended Measures & Main Concern to Address	Who to implement the measures?	Location of the measure	When to implement the measures?	Implementation Status
		the construction sewage generated by the workforce. A licensed contractor should be employed to provide appropriate and adequate portable toilets and be responsible for appropriate disposal and maintenance.	from sewage effluent		where practicable		
S6.9.1.5	W4	<p><u>Groundwater from Potential Contaminated Area:</u></p> <ul style="list-style-type: none"> <li>No direct discharge of groundwater from contaminated areas should be adopted.</li> <li>A discharge license under the WPCO through the Regional Office of EPD for groundwater discharge should be applied. Prior to the excavation works within these potentially contaminated areas, the groundwater quality should be reviewed during the process of discharge license application. The compliance to the Technical Memorandum on Standards for Effluents Discharged into Drainage on Sewerage Systems, Inland and Coastal Waters (TM-DSS) and the existence of prohibited substance should be confirmed. If the review results indicated that the groundwater to be generated from the excavation works would be contaminated, the contaminated groundwater should be either properly treated in compliance with the requirements of the TM-DSS or properly recharged into the ground.</li> <li>If wastewater treatment is deployed, the wastewater treatment unit shall deploy suitable treatment process (e.g. oil interceptor / activated carbon) to reduce the pollution level to an acceptable standard and remove any prohibited substances (e.g. TPH) to undetectable range. All treated effluent from wastewater treatment plant shall meet the requirements as stated in TM-DSS and should be discharged into the foul sewers.</li> <li>If groundwater recharging wells are deployed, recharging wells should be installed as appropriate for recharging the contaminated groundwater back into the ground. The recharging wells should be selected at places where the groundwater quality will not be affected by the recharge operation as indicated in the Section 2.3 of TM-DSS. The baseline groundwater quality shall be determined prior to the selection of the recharge wells, and submit a working plan (including the laboratory analytical results showing the quality of groundwater at the proposed recharge location(s) as well as the pollutant levels of groundwater to be recharged) to EPD for agreement. Pollution levels of groundwater to be recharged shall not be higher than pollutant levels of ambient groundwater at the recharge well. Prior to recharge, any prohibited substances such as TPH products should be removed as necessary by installing</li> </ul>	To minimize groundwater quality impact from contaminated area	Contractor	Excavation areas where contamination is found.	Construction stage	<p>V</p> <p>V</p> <p>V</p>

EIA Ref.	EM&A Log Ref	Recommended Mitigation Measures	Objectives of the Recommended Measures & Main Concern to Address	Who to implement the measures?	Location of the measure	When to implement the measures?	Implementation Status
		the petrol interceptor.					
S6.7.2.1	W5	<u>Temporary Reclamation</u> <ul style="list-style-type: none"> <li>During temporary reclamation, regular litter / rubbish clearance and avoidance of illegal discharges within the embayed marine water should be undertaken.</li> <li>During temporary reclamation, the perimeter silt curtain should be deployed.</li> </ul>	To minimize water quality impact from temporary reclamation	Contractor	Temporary Reclamation	Construction stage	V  @
S6.9.1.6	W6	<u>Accidental spillage</u> In order to prevent accidental spillage of chemicals, the following is recommended: <ul style="list-style-type: none"> <li>All the tanks, containers, storage area should be bunded and the locations should be locked as far as possible from the sensitive watercourse and stormwater drains.</li> <li>The Contractor should register as a chemical waste producer if chemical wastes would be generated. Storage of chemical waste arising from the construction activities should be stored with suitable labels and warnings.</li> <li>Disposal of chemical wastes should be conducted in compliance with the requirements as stated in the Waste disposal (Chemical Waste) (General) Regulation.</li> </ul>	To minimize water quality impact from accidental spillage	Contractor	All construction sites where practicable	Construction stage	@  V  V
S6.9.2.2	W7	<u>Dredging Works</u> The following good practice shall apply for the dredging works: <ul style="list-style-type: none"> <li>Install efficient silt curtains, i.e. at least 75% SS reduction, at the point of seawall dredging to control the dispersion of SS;</li> <li>Implement water quality monitoring to ensure effective control of water pollution and recommend additional mitigation measures required;</li> <li>The decent speed of grabs should be controlled to minimize the seabed impact and to reduce the volume of over-dredging;</li> <li>All vessels should be sized so that adequate clearance is maintained between vessels and the seabed in all tide conditions, to ensure that undue turbidity is not generated by turbulence from vessel movement or propeller wash;</li> <li>The dredging rates by closed grab dredgers for temporary marine channel outside pipepile wall shall be less than 1,500 m<sup>3</sup>/day and 125 m<sup>3</sup>/hour (without concurrent dredging with T2 in dry season only) or 750 m<sup>3</sup>/day and 62.5 m<sup>3</sup>/hour for other conditions respectively.</li> <li>Dredging works shall be only for the provision marine channel. No dredging work is</li> </ul>	To minimize sediment suspension during dredging	Contractor	Kai Tak Barging Point during dredging works	Dredging period	N/A  N/A  N/A  N/A  N/A  N/A

EIA Ref.	EM&A Log Ref	Recommended Mitigation Measures	Objectives of the Recommended Measures & Main Concern to Address	Who to implement the measures?	Location of the measure	When to implement the measures?	Implementation Status
		<p>required for temporary reclamation; and</p> <ul style="list-style-type: none"> <li>The workfront of temporary reclamation shall be surrounded by cofferdams and the associated excavation and backfilling works for temporary reclamation shall have no contact with seawater.</li> </ul>					N/A
S6.9.2.2	W8	<ul style="list-style-type: none"> <li>While WSR 2 (Planned Kai Tak Cooling Water Intake). is a planned receiver, the project proponent shall liaise with the project proponent of District Cooling System (DCS) for Kai Tak Development on the implementation programme prior to wet season dredging. In case the DCS would be operated during the dredging period of CKR, additional silt screen to the cooling water intake shall be provided to WSR 2. The following specific mitigation measures shall apply for the dredging works:</li> <li>In dry season, the dredging rate shall be less than 1500m<sup>3</sup>/day if no concurrent projects.</li> <li>In all other scenario, the dredging rate shall be less than 750m<sup>3</sup>/day</li> <li>Dredging works shall be only for the provision marine channel. No dredging work is required for temporary reclamation.</li> <li>The workfront of temporary reclamation shall be surrounded by cofferdams and the associated excavation and backfilling works for temporary reclamation shall have no contact with seawater.</li> <li>In case the DCS would be operated during the dredging period of CKR, silt screen shall be provided for WSR2.</li> </ul>	To minimize sediment suspension during dredging if the District Cooling System for Kai Tak Development would be operated in the same period	Contractor	Kai Tak Barging Point during dredging works	Dredging period	<p>N/A</p> <p>V</p> <p>V</p> <p>V</p> <p>N/A</p> <p>N/A</p>
S6.9.2	W9	<p>Handling of Dredged Sediment / Barging Operation:</p> <ul style="list-style-type: none"> <li>All barges should be fitted with tight bottom seals to prevent leakage of materials during transport;</li> <li>Barges or hoppers should not be filled to a level that will cause overflow of materials or polluted water during loading or transportation;</li> <li>All vessels should be sized so that adequate clearance is maintained between vessels and the seabed in all tide conditions, to ensure that undue turbidity is not generated by turbulence from vessel movement or propeller wash; and</li> <li>Loading of barges and hoppers should be controlled to prevent splashing of material into the surrounding water.</li> <li>Mitigation measures for land-based activities as outlined above should be applied to minimise water quality impacts from site runoff and open stockpile spoils at the</li> </ul>	To minimize and mitigate the water disturbance during dredged sediment handling/barging operation	Contractor	All land- based site and proposed Kwai Chung barging point	Construction stage	<p>N/A</p> <p>V</p> <p>V</p> <p>V</p> <p>N/A</p>



EIA Ref.	EM&A Log Ref	Recommended Mitigation Measures	Objectives of the Recommended Measures & Main Concern to Address	Who to implement the measures?	Location of the measure	When to implement the measures?	Implementation Status
		proposed barging facilities where appropriate.					
S6.9	W10	Implement a marine water quality monitoring programme	Monitor marine water quality prior to and during dredging period	Contractor	At identified monitoring location	Prior to and during dredging period	V

EIA Ref.	EM&A Log Ref	Recommended Mitigation Measures	Objectives of the Recommended Measures & Main Concern to Address	Who to implement the measures?	Location of the measure	When to implement the measures?	Implementation Status
Waste Management (Construction Waste)							
S7.4.1	WM1	<u>On-site sorting of C&amp;D material</u> <ul style="list-style-type: none"> <li>Geological assessment should be carried out by competent persons on site during excavation to identify materials which are not suitable to use as aggregate in structural concrete (e.g. volcanic rock, Aplite dyke rock, etc). Volcanic rock and Aplite dyke rock should be separated at the source sites as far as practicable and stored at designated stockpile areas preventing them from delivering to crushing facilities. The crushing plant operator should also be reminded to set up measures to prevent unsuitable rock from ended up at concrete batching plants and be turned into concrete for structural use. Details regarding control measures at source site and crushing facilities should be submitted by the Contractors for the Engineer to review and agree. In addition, site records should also be kept for the types of rock materials excavated and the traceability of delivery will be ensured with the implementation of Trip Ticket System and enforced by site supervisory staff as stipulated under DEVB TC(W) No. 6/2010 for tracking of the correct delivery to the rock crushing facilities for processing into aggregates. Alternative disposal option for the reuse of volcanic rock and Aplite Dyke rock, etc should also be explored.</li> </ul>	Separation of unsuitable rock from ending up at concrete batching plants and be turned into concrete for structural use	Contractor	All construction sites	Construction stage	V
S7.5.1	WM2	<u>Construction and Demolition Material</u> <ul style="list-style-type: none"> <li>Maintain temporary stockpiles and reuse excavated fill material for backfilling and reinstatement;</li> <li>Carry out on-site sorting;</li> <li>Make provisions in the Contract documents to allow and promote the use of recycled aggregates where appropriate;</li> <li>Adopt 'Selective Demolition' technique to demolish the existing structures and facilities with a view to recovering broken concrete effectively for recycling purpose, where possible;</li> <li>Implement a trip-ticket system for each works contract to ensure that the disposal of C&amp;D materials are properly documented and verified; and</li> <li>Implement an enhanced Waste Management Plan similar to ETWBTC (Works) No. 19/2005 – "Environmental Management on Construction Sites" to encourage on-site sorting of C&amp;D materials and to minimize their generation during the course of construction.</li> </ul>	Good site practice to minimize the waste generation and recycle the C&D materials as far as practicable so as to reduce the amount for final disposal	Contractor	All construction sites	Construction stage	V V V V V V
S7.5.1	WM3	<u>C&amp;D Waste</u> <ul style="list-style-type: none"> <li>Standard formwork or pre-fabrication should be used as far as practicable in order to</li> </ul>	Good site practice to minimize the waste	Contractor	All construction	Construction stage	V

EIA Ref.	EM&A Log Ref	Recommended Mitigation Measures	Objectives of the Recommended Measures & Main Concern to Address	Who to implement the measures?	Location of the measure	When to implement the measures?	Implementation Status
		<p>minimise the arising of C&amp;D materials. The use of more durable formwork or plastic facing for the construction works should be considered. Use of wooden hoardings should not be used, as in other projects. Metal hoarding should be used to enhance the possibility of recycling. The purchasing of construction materials will be carefully planned in order to avoid over ordering and wastage.</p> <ul style="list-style-type: none"> <li>The Contractor should recycle as much of the C&amp;D materials as possible on-site. Public fill and C&amp;D waste should be segregated and stored in different containers or skips to enhance reuse or recycling of materials and their proper disposal. Where practicable, concrete and masonry can be crushed and used as fill. Steel reinforcement bar can be used by scrap steel mills. Different areas of the sites should be considered for such segregation and storage.</li> </ul>	generation and recycle the C&D materials as far as practicable so as to reduce the amount for final disposal		sites		V
S7.5.1	WM5	<p><u>Land-based and Marine-based Sediment</u></p> <ul style="list-style-type: none"> <li>All construction plant and equipment shall be designed and maintained to minimize the risk of silt, sediments, contaminants or other pollutants being released into the water column or deposited in the locations other than designated location;</li> <li>All vessels shall be sized such that adequate draft is maintained between vessels and the sea bed at all states of the tide to ensure that undue turbidity is not generated by turbulence from vessel movement or propeller wash;</li> <li>Before moving the vessels which are used for transporting dredged material, excess material shall be cleaned from the decks and exposed fittings of vessels and the excess materials shall never be dumped into the sea except at the approved locations;</li> <li>Adequate freeboard shall be maintained on barges to ensure that decks are not washed by wave action.</li> <li>The Contractors shall monitor all vessels transporting material to ensure that no dumping outside the approved location takes place. The Contractor shall keep and produce logs and other records to demonstrate compliance and that journeys are consistent with designated locations and copies of such records shall be submitted to the engineers;</li> <li>The Contractors shall comply with the conditions in the dumping licence.</li> <li>All bottom dumping vessels (Hopper barges) shall be fitted with tight fittings seals to their bottom openings to prevent leakage of material;</li> <li>The material shall be placed into the disposal pit by bottom dumping;</li> <li>Contaminated marine mud shall be transported by spit barge of not less than 750m<sup>3</sup> capacity and capable of rapid opening and discharge at the disposal site;</li> </ul>	To control pollution due to marine sediment	Contractor	Along CKR alignment	Construction Stage	N/A

EIA Ref.	EM&A Log Ref	Recommended Mitigation Measures	Objectives of the Recommended Measures & Main Concern to Address	Who to implement the measures?	Location of the measure	When to implement the measures?	Implementation Status
		<ul style="list-style-type: none"> <li>Discharge shall be undertaken rapidly and the hoppers shall be closed immediately. Material adhering to the sides of the hopper shall not be washed out of the hopper and the hopper shall remain closed until the barge returns to the disposal site.</li> <li>For Type 3 special disposal treatment, sealing of contaminant with geosynthetic containment before dropping into designated mud pit would be a possible arrangement. A geosynthetic containment method is a method whereby the sediments are sealed in geosynthetic containers and, the containers would be dropped into the designated contaminated mud pit where they would be covered by further mud disposal and later by the mud pit capping at the disposal site, thereby fulfilling the requirements for fully confined mud disposal.</li> </ul>					
S7.5.1	WM6	<p><u>Chemical Waste</u></p> <ul style="list-style-type: none"> <li>Chemical waste that is produced, as defined by Schedule 1 of the Waste Disposal (Chemical Waste) (General) Regulation, should be handled in accordance with the Code of Practice on the Packaging, Labelling and Storage of Chemical Wastes.</li> <li>Containers used for the storage of chemical wastes should be suitable for the substance they are holding, resistant to corrosion, maintained in a good condition, and securely closed; have a capacity of less than 450 liters unless the specification has been approved by the EPD; and display a label in English and Chinese in accordance with instructions prescribed in Schedule 2 of the regulation.</li> <li>The storage area for chemical wastes should be clearly labelled and used solely for the storage of chemical waste; enclosed on at least 3 sides; have an impermeable floor and bunding of sufficient capacity to accommodate 110% of the volume of the largest container or 20 % of the total volume of waste stored in that area, whichever is the greatest; have adequate ventilation; covered to prevent rainfall entering; and arranged so that incompatible materials are adequately separated.</li> <li>Disposal of chemical waste should be via a licensed waste collector; be to a facility licensed to receive chemical waste, such as the Chemical Waste Treatment Centre which also offers a chemical waste collection service and can supply the necessary storage containers; or be to a reuser of the waste, under approval from the EPD.</li> </ul>	Control the chemical waste and ensure proper storage, handling and disposal.	Contractor	All construction sites	Construction stage	<p>V</p> <p>V</p> <p>V</p> <p>V</p>

EIA Ref.	EM&A Log Ref	Recommended Mitigation Measures	Objectives of the Recommended Measures & Main Concern to Address	Who to implement the measures?	Location of the measure	When to implement the measures?	Implementation Status
S7.5.1	WM7	<u>General Refuse</u> <ul style="list-style-type: none"> <li>● General refuse generated on-site should be stored in enclosed bins or compaction units separately from construction and chemical wastes.</li> <li>● A reputable waste collector should be employed by the Contractor to remove general refuse from the site, separately from construction and chemical wastes, on a daily basis to minimize odour, pest and litter impacts. Burning of refuse on construction sites is prohibited by law.</li> <li>● Aluminium cans are often recovered from the waste stream by individual collectors if they are segregated and made easily accessible. Separate labelled bins for their deposit should be provided if feasible.</li> <li>● Office wastes can be reduced through the recycling of paper if volumes are large enough to warrant collection. Participation in a local collection scheme should be considered by the Contractor.</li> </ul>	Minimize production of the general refuse and avoid odour, pest and litter impacts	Contractor	All construction sites	Construction stage	V  V  V  V

EIA Ref.	EM&A Log Ref	Recommended Mitigation Measures	Objectives of the Recommended Measures & Main Concern to Address	Who to implement the measures?	Location of the measure	When to implement the measures?	Implementation Status
Land Contamination							
S8.10, S8.12 & Appendix 8.4	LC1	<p>Land contamination investigation works (including field works and laboratory testing at the Kowloon City Ferry Pier Public Transport Interchange (KCFP-PTI) and the To Kwa Wan Vehicle Examination Centre (TKW-VEC) were carried out from 14 April 2018 to 2 January 2019. In order to minimise the potentially adverse environmental impacts arising from the handling of potentially contaminated materials, the following environmental mitigation measures are proposed during the course of soil excavation, stockpiling and backfilling works:</p> <ul style="list-style-type: none"> <li>● Excavation profiles must be properly designed and executed.</li> <li>● Stockpiling site(s) shall be lined with impermeable sheeting and bunded. Stockpiles shall be fully covered by impermeable sheeting to reduce dust emission.</li> <li>● Excavation and stockpiling should be carried out during dry season as far as possible to minimise potentially contaminated runoffs from the Concerned Soil.</li> <li>● The truck transferring Concerned Soil shall be covered entirely by impervious sheeting to ensure that the dusty materials do not leak from the truck.</li> <li>● Temporary fencing or warning ribbons will be provided to the boundary of excavation, slope crest and temporarily stockpiled areas. Where necessary, the exposed areas should be temporarily covered with impermeable sheeting during heavy rainstorm.</li> </ul>	Minimize the potentially adverse environmental impacts arising from the handling of potentially contaminated materials	Contractor	EBH1, EBH2 and EBH3	Commencement of construction works at the Kowloon City Ferry Pier Public Transport Interchange (PTI) (for EBH1 & EBH2) and the works area adjacent to the To Kwa Wan Vehicle Examination Centre (for EBH3)	<p>V</p> <p>V</p> <p>V</p> <p>V</p> <p>V</p>

EIA Ref.	EM&A Log Ref	Recommended Mitigation Measures	Objectives of the Recommended Measures & Main Concern to Address	Who to implement the measures?	Location of the measure	When to implement the measures?	Implementation Status
Landscape & Visual							
S10.10.1 Table 10.11	LV3	<ul style="list-style-type: none"> <li><u>Good Site Management</u> Large temporary stockpiles of excavated material shall be covered with unobtrusive sheeting to prevent dust and dirt spreading to adjacent landscape areas and vegetation, and to create a neat and tidy visual appearance. Construction plant and building material shall be orderly and carefully stored in order to create a neat and tidy visual appearance.</li> </ul>	Minimize visual impact	Contractor	Within Project Site	Construction Phase	V
S10.10.1 Table 10.11	LV4	<ul style="list-style-type: none"> <li><u>Screen Hoarding</u> Decorative screen hoarding should be erected to screen the public from the construction area. It should be designed to be compatible with the existing urban context.</li> </ul>	Minimize visual impact	Contractor	Within Project Site	Construction Phase	V
S10.10.1 Table 10.11	LV5	<ul style="list-style-type: none"> <li><u>Lighting Control during Construction</u> All lighting in the construction site shall be carefully controlled to minimize light pollution and night-time glare to nearby residencies and GIC. The contractor shall consider other security measures, which shall minimize the visual impacts.</li> </ul>	Minimize visual impact	Contractor	Within Project Site	Construction Phase	V
S10.10.1 Table 10.11	LV6	<ul style="list-style-type: none"> <li><u>Erosion Control</u> The potential for soil erosion shall be reduced by minimizing the extent of vegetation disturbance on site and by providing a protective cover over newly exposed soil.</li> </ul>	Minimize landscape impact	Contractor	Within Project Site	Construction Phase	V
S10.10.1 Table 10.11	LV7	<ul style="list-style-type: none"> <li><u>Tree Protection &amp; Preservation</u> Carefully protected during construction. Tree protection measures will be detailed at the Tree Removal Application stage and plans submitted to the relevant Government Department for approval in due course in accordance with ETWB TC no. 3/2006.</li> </ul>	Minimize landscape and visual impact	Contractor	Within Project Site	Design and Construction Phase	V
S10.10.1 Table 10.11	LV9	<ul style="list-style-type: none"> <li><u>Compensatory Planting</u> For trees unavoidably affected by the Project that have to be removed, where practical transplantation will be chosen as the top priority method of removal but if this is not possible or practical compensatory planting will be provided for trees unavoidably felled. All felled trees shall be compensated for by planting trees to the satisfaction of relevant Government departments. Required numbers and locations of compensatory trees shall be determined and agreed separately with Government during the Tree Felling Application process under ETWBTC 3/2006. Compensatory tree planting may be incorporated into public open spaces and along roadside amenity areas affected by the construction works and therefore be part of the bigger wider planting plans. Onsite compensation planting is preferred but if necessary,</li> </ul>	Minimize landscape and visual impact	Contractor	Within Project Site and designated off-site locations	Construction Phase	N/A

EIA Ref.	EM&A Log Ref	Recommended Mitigation Measures	Objectives of the Recommended Measures & Main Concern to Address	Who to implement the measures?	Location of the measure	When to implement the measures?	Implementation Status
		additional receptor sites outside the Works Area shall be agreed separately with Government during the Tree Felling Application process.					
S10.10.1 Table 10.11	LV10	<ul style="list-style-type: none"> <li><u>Screen Planting</u> Tall screen/buffer trees, shrubs and climbers should be planted, in so far as is possible, to soften and screen proposed structures such as roads and central strip, vertical edges and buildings and to enhance streetscape greening effect where appropriate. Indiscriminate use of trees for screening must be avoided and the principle of 'right tree for the right place' must be followed. This detail will be provided at the Detailed Design stage. This measure may additionally form part of the compensatory planting and will improve and create a pleasant pedestrian environment.</li> </ul>	Minimize visual impact and also enhance landscape.	Contractor	Within Project Site	Construction Phase	N/A
S10.10.1 Table 10.11	LV11	<ul style="list-style-type: none"> <li><u>Green Roof</u> Roof greening will be established on ventilation and administration buildings to reduce exposure to untreated concrete surfaces and particularly mitigate visual impact to VSRs at high levels.</li> </ul>	Minimize landscape and visual impact	Contractor	Within Project Site	Construction Phase	N/A
S10.10.1 Table 10.11	LV12	<ul style="list-style-type: none"> <li><u>Reinstatement</u> All works areas, excavated areas and disturbed areas for tunnel construction and temporary road diversion or any other proposed works shall be reinstated to former conditions or better, with reasonable landscape treatment and to the satisfaction of the relevant Government departments. (Specific mitigation for disturbance to public open space is detailed separately under LV14)</li> </ul>	Minimize landscape impact	Contractor	Within Project Site	Construction Phase	N/A
S10.10.1 Table 10.11	LV14	<ul style="list-style-type: none"> <li><u>Landscape enhancement</u> Implement a comprehensive landscape plan to maximize the greening opportunity and create a unique landscape for the project to blend in with the surrounding, including in re-provisioned areas. In particular: <ul style="list-style-type: none"> <li>- landscape enhancement of re-provisioned Public Transport Interchange;</li> <li>- landscape deck on tunnel portals;</li> <li>- viaduct planters for trailer planting;</li> <li>- vertical greening of piers and walls with climbers or trailer planting;</li> <li>- roadside planting i.e. planting along central dividers and on road islands e.g. in the middle of roundabouts.</li> </ul> (Roadside planting i.e. at the road edge and not in the central divider or road island, and vertical greening may be considered part of Screen Planting). <ul style="list-style-type: none"> <li>- Purpose-built maintenance access without temporary traffic arrangement must be</li> </ul> </li> </ul>	Minimize landscape and visual impact	Contractor	Along tunnel alignment	Construction phase	N/A



EIA Ref.	EM&A Log Ref	Recommended Mitigation Measures	Objectives of the Recommended Measures & Main Concern to Address	Who to implement the measures?	Location of the measure	When to implement the measures?	Implementation Status
		provided and detailed design of landscape decks and planting, including details of maintenance access locations, will be sent to maintenance and management parties for endorsement and ensures these mitigation measures are feasible.					

EIA Ref.	EM&A Log Ref	Recommended Mitigation Measures	Objectives of the Recommended Measures & Main Concern to Address	Who to implement the measures?	Location of the measure	When to implement the measures?	Implementation Status
Cultural Heritage Impact (Construction and Operational Phase)							
S11.4.4	CH1	<ul style="list-style-type: none"> <li>The contractor should be alerted during the construction on the possibility of locating archaeological remains and as a precautionary measure, AMO shall be informed immediately in case of discovery of antiquities or supposed antiquities in the subject sites.</li> </ul>	To preserve any cultural heritage items which may be removed and damaged by the excavation.	Contractor	During construction works for cut and cover tunnels	During the construction phase	N/A
S11.6 para 3	CH2	<ul style="list-style-type: none"> <li>The dredging contractor should be alerted during the construction on the possibility of locating archaeological remains, such as cannon and AMO shall be informed immediately in case of discovery of antiquities or supposed antiquities in the subject areas.</li> </ul>	To preserve any cultural heritage items which may be removed and damaged by the dredging.	Contractor	During construction of underwater tunnel (north of To Kwa Wan Typhoon Shelter)	During the construction phase	N/A
S12.6.1, Table 12.2	CH8	<ul style="list-style-type: none"> <li>A monitoring system for settlement, vibration and tilting will be determined and implemented pending determination of the future grading. A monitoring proposal will be submitted to AMO before commencement of work if a historic building grade is accorded.</li> </ul>	Protect the structure from damage from construction works	Contractor	Kowloon City Ferry Pier (CKR-13)	During the construction phase	N/A
S12.6.1, Table 12.2	CH9	<ul style="list-style-type: none"> <li>No mitigation is required at present. If the public pier is granted Grade 1, Grade 2 or Grade 3 status, the mitigation will be revised to adhere to the requirements for protective measures for Graded Historic Buildings</li> </ul>	To be determined	Contractor	Ma Tau Kok Public Pier (CKR-16)	During the construction phase	N/A
S12.6.1, Table 12.2	CH10	<ul style="list-style-type: none"> <li>A monitoring system for settlement, vibration and tilting will be determined and implemented pending determination of the future grading. A monitoring proposal will be submitted to AMO before commencement of work if a historic building grade is accorded.</li> </ul>	Protect the structure from damage from construction works	Contractor	The Kowloon City Vehicular Ferry Pier (CKR-17)	During the construction phase	N/A

EIA Ref.	EM&A Log Ref	Recommended Mitigation Measures	Objectives of the Recommended Measures & Main Concern to Address	Who to implement the measures?	Location of the measure	When to implement the measures?	Implementation Status
EM&A Project							
S13.2	EM1	An Independent Environmental Checker needs to be employed as per the EM&A Manual.	Control Performance EM&A	Highways Department	All construction sites	Construction stage	V
S13.2 –13.4	EM2	1) An Environmental Team needs to be employed as per the EM&A Manual. 2) Prepare a systematic Environmental Management Plan to ensure effective implementation of the mitigation measures. 3) An environmental impact monitoring needs to be implementing by the Environmental Team to ensure all the requirements given in the EM&A Manual are fully complied with.	Perform environmental monitoring & auditing	Highways Department / Contractor	All construction sites	Construction stage	V  V  V

## Legends:

V = implemented;

X = not implemented;

@ = partially implemented;

N/A = not applicable

---

## **APPENDIX D**

### **Summary of Action and Limit Levels**

---

## Appendix D – Summary of Action and Limit Levels

**Table 1      Action and Limit Levels for 24-hour TSP**

ID	Location	Action Level	Limit Level
E-A14a	Block B of Merit Industrial Centre	197.3 $\mu\text{g}/\text{m}^3$	260 $\mu\text{g}/\text{m}^3$

**Table 2      Action and Limit Levels for 1-hour TSP**

ID	Location	Action Level	Limit Level
E-A14a	Block B of Merit Industrial Centre	302.4 $\mu\text{g}/\text{m}^3$	500 $\mu\text{g}/\text{m}^3$

**Table 3      Action and Limit Levels for Construction Noise  
(0700 – 1900 hrs of normal weekdays)**

ID	Location	Action Level	Limit Level
E-N12a	19 Hing Yan Street	When one documented complaint is received	75 dB(A)
E-N21a	Block B of Merit Industrial Centre	When one documented complaint is received	75 dB(A)

---

## **APPENDIX E**

### **Calibration Certificates of Equipments**

---

## Certificate of Calibration

### Calibration Certification Information

Cal. Date: June 6, 2019      Rootsmeter S/N: 438320      Ta: 295 °K  
 Operator: Jim Tisch      Pa: 748.0 mm Hg  
 Calibration Model #: TE-5025A      Calibrator S/N: 0988

Run	Vol. Init (m3)	Vol. Final (m3)	ΔVol. (m3)	ΔTime (min)	ΔP (mm Hg)	ΔH (in H2O)
1	1	2	1	1.3640	3.2	2.00
2	3	4	1	0.9680	6.3	4.00
3	5	6	1	0.8680	7.8	5.00
4	7	8	1	0.8250	8.7	5.50
5	9	10	1	0.6800	12.6	8.00

### Data Tabulation

Vstd (m3)	Qstd (x-axis)	$\sqrt{\Delta H \left( \frac{Pa}{Pstd} \right) \left( \frac{Tstd}{Ta} \right)}$ (y-axis)	Va	Qa (x-axis)	$\sqrt{\Delta H \left( \frac{Ta}{Pa} \right)}$ (y-axis)
0.9900	0.7258	1.4101	0.9957	0.7300	0.8881
0.9859	1.0185	1.9943	0.9916	1.0244	1.2560
0.9839	1.1335	2.2296	0.9896	1.1401	1.4042
0.9827	1.1911	2.3385	0.9884	1.1980	1.4728
0.9775	1.4375	2.8203	0.9832	1.4458	1.7762
<b>QSTD</b>	m=	<b>1.98356</b>	<b>QA</b>	m=	<b>1.24207</b>
	b=	<b>-0.02592</b>		b=	<b>-0.01633</b>
	r=	<b>0.99996</b>		r=	<b>0.99996</b>

### Calculations

Vstd=	$\Delta Vol((Pa-\Delta P)/Pstd)(Tstd/Ta)$	Va=	$\Delta Vol((Pa-\Delta P)/Pa)$
Qstd=	Vstd/ΔTime	Qa=	Va/ΔTime
For subsequent flow rate calculations:			
Qstd=	$1/m \left( \left( \sqrt{\Delta H \left( \frac{Pa}{Pstd} \right) \left( \frac{Tstd}{Ta} \right)} \right) - b \right)$	Qa=	$1/m \left( \left( \sqrt{\Delta H \left( \frac{Ta}{Pa} \right)} \right) - b \right)$

### Standard Conditions

Tstd: 298.15 °K  
 Pstd: 760 mm Hg

### Key

ΔH: calibrator manometer reading (in H2O)  
 ΔP: rootsmeter manometer reading (mm Hg)  
 Ta: actual absolute temperature (°K)  
 Pa: actual barometric pressure (mm Hg)  
 b: intercept  
 m: slope

### RECALIBRATION

US EPA recommends annual recalibration per 1998 40 Code of Federal Regulations Part 50 to 51, Appendix B to Part 50, Reference Method for the Determination of Suspended Particulate Matter in the Atmosphere, 9.2.17, page 30

**AECOM Asia Company Limited**  
**Tisch TSP Mass Flow Controlled High Volume Air Sampler**  
**Field Calibration Report**

Station	Block B, Merit Industrial Centre ( E-A14a )	Operator:	Choi Wing Ho
Cal. Date:	26/3/2020	Next Due Date:	26/5/2020
Model No.:	TE-5170	Serial No.	10380
Equipment No.:	A-001-15T		

Ambient Condition			
Temperature, Ta (K)	299	Pressure, Pa (mmHg)	758.9

Orifice Transfer Standard Information					
Serial No:	988	Slope, mc	1.98356	Intercept, bc	-0.02592
Last Calibration Date:	6-六月-19	$mc \times Qstd + bc = [H \times (Pa/760) \times (298/Ta)]^{1/2}$			
Next Calibration Date:	6-六月-20				

Calibration of TSP Sampler					
Resistance Plate No.	Orifice			HVS Flow Recorder	
	DH (orifice), in. of water	$[DH \times (Pa/760) \times (298/Ta)]^{1/2}$	Qstd (m <sup>3</sup> /min) X axis	Flow Recorder Reading (CFM)	Continuous Flow Recorder Reading IC (CFM) Y-axis
18	7.0	2.64	1.34	46.0	45.89
13	6.1	2.46	1.26	40.0	39.90
10	4.9	2.21	1.13	36.0	35.91
7	3.4	1.84	0.94	28.0	27.93
5	2.4	1.55	0.79	22.0	21.95

By Linear Regression of Y on X

Slope, mw = 41.9345                      Intercept, bw = -11.4577

Correlation Coefficient\* = 0.9926

\*If Correlation Coefficient < 0.990, check and recalibrate.

Set Point Calculation
From the TSP Field Calibration Curve, take Qstd = 1.30m <sup>3</sup> /min
From the Regression Equation, the "Y" value according to
$mw \times Qstd + bw = IC \times [(Pa/760) \times (298/Ta)]^{1/2}$
Therefore, Set Point; IC = ( mw x Qstd + bw ) x [ ( 760 / Pa ) x ( Ta / 298 ) ] <sup>1/2</sup> = <u>43.16</u>

Remarks: \_\_\_\_\_

QC Reviewer: W.S                      Signature: W.S                      Date: 26/3/20



**AECOM Asia Company Limited**

## Tisch TSP Mass Flow Controlled High Volume Air Sampler Field Calibration Report

Station	Block B, Merit Industrial Centre ( E-A14a )	Operator:	Choi Wing Ho
Cal. Date:	25/5/2020	Next Due Date:	25/7/2020
Model No.:	TE-5170	Serial No.	10380
Equipment No.:	A-001-15T		

Ambient Condition			
Temperature, Ta (K)	303	Pressure, Pa (mmHg)	756.5

Orifice Transfer Standard Information					
Serial No:	988	Slope, mc	1.98356	Intercept, bc	-0.02592
Last Calibration Date:	6-Jun-19	$mc \times Qstd + bc = [H \times (Pa/760) \times (298/Ta)]^{1/2}$			
Next Calibration Date:	6-Jun-20				

Calibration of TSP Sampler					
Resistance Plate No.	Orifice			HVS Flow Recorder	
	DH (orifice), in. of water	$[DH \times (Pa/760) \times (298/Ta)]^{1/2}$	Qstd (m <sup>3</sup> /min) X-axis	Flow Recorder Reading (CFM)	Continuous Flow Recorder Reading IC (CFM) Y-axis
18	7.1	2.64	1.34	46.0	45.51
13	6.1	2.44	1.25	41.0	40.57
10	5.0	2.21	1.13	35.0	34.63
7	3.8	1.93	0.99	29.0	28.69
5	2.8	1.66	0.85	22.0	21.77

### By Linear Regression of Y on X

**Slope , mw = 47.4601**

Intercept, bw = -18.4359

Correlation Coefficient\* = 0.9988

\*If Correlation Coefficient < 0.990, check and recalibrate.

### Set Point Calculation

From the TSP Field Calibration Curve, take  $Q_{std} = 1.30 \text{ m}^3/\text{min}$

From the Regression Equation, the "Y" value according to

$$mw \times Q_{std} + bw = IC \times [(Pa/760) \times (298/Ta)]^{1/2}$$

Therefore, Set Point; IC = ( mw x Qstd + bw ) x [( 760 / Pa ) x ( Ta / 298 )]<sup>1/2</sup>= **43.72**

Remarks: \_\_\_\_\_

QC Reviewer: WS

Signature: 

Date: 25/5/20

## EQUIPMENT CALIBRATION RECORD

Type: Laser Dust Monitor  
 Manufacturer/Brand: SIBATA  
 Model No.: LD-3  
 Equipment No.: A.005.07a  
 Sensitivity Adjustment Scale Setting: 557 CPM  
 Operator: Mike Shek (MSKM)

### Standard Equipment

Equipment: Rupprecht & Patashnick TEOM®  
 Venue: Cyberport (Pui Ying Secondary School)  
 Model No.: Series 1400AB  
 Serial No: Control: 140AB219899803  
 Sensor: 1200C143659803 K<sub>0</sub>: 12500  
 Last Calibration Date\*: 1 May 2020

\*Remarks: Recommended interval for hardware calibration is 1 year

### Calibration Result

Sensitivity Adjustment Scale Setting (Before Calibration): 557 CPM  
 Sensitivity Adjustment Scale Setting (After Calibration): 557 CPM

Hour	Date (dd-mm-yy)	Time	Ambient Condition		Concentration <sup>1</sup> (mg/m <sup>3</sup> ) <b>Y-axis</b>	Total Count <sup>2</sup>	Count/ Minute <sup>3</sup> <b>X-axis</b>
			Temp (°C)	R.H. (%)			
1	02-05-20	09:15 - 10:15	26.7	77	0.04836	1945	32.42
2	02-05-20	10:15 - 11:15	26.7	77	0.05134	2056	34.27
3	02-05-20	11:15 - 12:15	26.8	77	0.05331	2130	35.50
4	02-05-20	12:15 - 13:15	26.8	77	0.05535	2214	36.90

Note: 1. Monitoring data was measured by Rupprecht & Patashnick TEOM®  
 2. Total Count was logged by Laser Dust Monitor  
 3. Count/minute was calculated by (Total Count/60)

By Linear Regression of Y or X

Slope (K-factor): 0.0015  
 Correlation coefficient: 0.9976

Validity of Calibration Record: 2 May 2021

Remarks:

QC Reviewer: YW Fung

Signature: 

Date: 04 May 2020

## EQUIPMENT CALIBRATION RECORD

Type: Laser Dust Monitor  
 Manufacturer/Brand: SIBATA  
 Model No.: LD-3  
 Equipment No.: A.005.09a  
 Sensitivity Adjustment Scale Setting: 797 CPM  
 Operator: Mike Shek (MSKM)

### Standard Equipment

Equipment: Rupprecht & Patashnick TEOM®  
 Venue: Cyberport (Pui Ying Secondary School)  
 Model No.: Series 1400AB  
 Serial No: Control: 140AB219899803  
 Sensor: 1200C143659803 Ko: 12500  
 Last Calibration Date\*: 1 May 2020

\*Remarks: Recommended interval for hardware calibration is 1 year

### Calibration Result

Sensitivity Adjustment Scale Setting (Before Calibration): 797 CPM  
 Sensitivity Adjustment Scale Setting (After Calibration): 797 CPM

Hour	Date (dd-mm-yy)	Time	Ambient Condition		Concentration <sup>1</sup> (mg/m <sup>3</sup> ) Y-axis	Total Count <sup>2</sup>	Count/ Minute <sup>3</sup> X-axis
			Temp (°C)	R.H. (%)			
1	02-05-20	09:45 - 10:45	26.7	77	0.04884	1956	32.60
2	02-05-20	10:45 - 11:45	26.7	77	0.05157	2070	34.50
3	02-05-20	11:45 - 12:45	26.8	77	0.05355	2158	35.97
4	02-05-20	12:45 - 13:45	26.8	77	0.05593	2241	37.35

Note: 1. Monitoring data was measured by Rupprecht & Patashnick TEOM®  
 2. Total Count was logged by Laser Dust Monitor  
 3. Count/minute was calculated by (Total Count/60)

By Linear Regression of Y or X

Slope (K-factor): 0.0015  
 Correlation coefficient: 0.9974

Validity of Calibration Record: 2 May 2021

Remarks:

QC Reviewer: YW Fung

Signature: 

Date: 04 May 2020



## CERTIFICATE OF CALIBRATION

Certificate No.: 19CA0912 01

Page 1 of 2

### Item tested

Description:	Sound Level Meter (Type 1)	Microphone
Manufacturer:	B & K	B & K
Type/Model No.:	2238	4188
Serial/Equipment No.:	2800927	2791211
Adaptors used:	-	-

### Item submitted by

Customer Name: AECOM ASIA CO., LTD.  
Address of Customer: -  
Request No.: -  
Date of receipt: 12-Sep-2019

Date of test: 16-Sep-2019

### Reference equipment used in the calibration

Description:	Model:	Serial No.	Expiry Date:	Traceable to:
Multi function sound calibrator	B&K 4226	2288444	23-Aug-2020	CIGISMEC
Signal generator	DS 360	61227	26-Dec-2019	CEPREI

### Ambient conditions

Temperature:  $21 \pm 1$  °C  
Relative humidity:  $55 \pm 10$  %  
Air pressure:  $1000 \pm 5$  hPa

### Test specifications

- 1, The Sound Level Meter has been calibrated in accordance with the requirements as specified in BS 7580: Part 1: 1997 and the lab calibration procedure SMTP004-CA-152.
- 2, The electrical tests were performed using an electrical signal substituted for the microphone which was removed and replaced by an equivalent capacitance within a tolerance of  $\pm 20\%$ .
- 3, The acoustic calibration was performed using an B&K 4226 sound calibrator and corrections was applied for the difference between the free-field and pressure response of the Sound Level Meter.

### Test results

This is to certify that the Sound Level Meter conforms to BS 7580: Part 1: 1997 for the conditions under which the test was performed.

Details of the performed measurements are presented on page 2 of this certificate.

Actual Measurement data are documented on worksheets.

Approved Signatory:

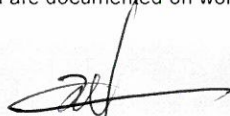
  
Feng Junqi

Date: 16-Sep-2019

Company Chop:



Comments: The results reported in this certificate refer to the condition of the instrument on the date of calibration and carry no implication regarding the long-term stability of the instrument.

**CERTIFICATE OF CALIBRATION**

(Continuation Page)

Certificate No.: 19CA0912 01

Page 2 of 2

**1, Electrical Tests**

The electrical tests were performed using an equivalent capacitance substituted for the microphone. The results are given in below with test status and the estimated uncertainties. The "Pass" means the result of the test is inside the tolerances stated in the test specifications. The "-" means the result of test is outside these tolerances.

Test:	Subtest:	Status:	Expanded Uncertainty (dB)	Coverage Factor
Self-generated noise	A	Pass	0.3	
	C	Pass	1.0	2.1
	Lin	Pass	2.0	2.2
Linearity range for Leq	At reference range, Step 5 dB at 4 kHz	Pass	0.3	
	Reference SPL on all other ranges	Pass	0.3	
	2 dB below upper limit of each range	Pass	0.3	
	2 dB above lower limit of each range	Pass	0.3	
		Pass	0.3	
Linearity range for SPL	At reference range, Step 5 dB at 4 kHz	Pass	0.3	
	A	Pass	0.3	
Frequency weightings	C	Pass	0.3	
	Lin	Pass	0.3	
Time weightings	Single Burst Fast	Pass	0.3	
	Single Burst Slow	Pass	0.3	
Peak response	Single 100µs rectangular pulse	Pass	0.3	
R.M.S. accuracy	Crest factor of 3	Pass	0.3	
Time weighting I	Single burst 5 ms at 2000 Hz	Pass	0.3	
	Repeated at frequency of 100 Hz	Pass	0.3	
Time averaging	1 ms burst duty factor 1/10 <sup>3</sup> at 4kHz	Pass	0.3	
	1 ms burst duty factor 1/10 <sup>4</sup> at 4kHz	Pass	0.3	
Pulse range	Single burst 10 ms at 4 kHz	Pass	0.4	
Sound exposure level	Single burst 10 ms at 4 kHz	Pass	0.4	
Overload indication	SPL	Pass	0.3	
	Leq	Pass	0.4	

**2, Acoustic tests**

The complete sound level meter was calibrated on the reference range using a B&K 4226 acoustic calibrator with 1000Hz and SPL 94 dB. The sensitivity of the sound level meter was adjusted. The test result at 125 Hz and 8000 Hz are given in below with test status and the estimated uncertainties.

Test:	Subtest	Status	Expanded Uncertainty (dB)	Coverage Factor
Acoustic response	Weighting A at 125 Hz	Pass	0.3	
	Weighting A at 8000 Hz	Pass	0.5	

**3, Response to associated sound calibrator**

N/A

The expanded uncertainties have been calculated in accordance with the ISO Publication "Guide to the expression of uncertainty in measurement", and gives an interval estimated to have a level of confidence of 95%. A coverage factor of 2 is assumed unless explicitly stated.

- End -

Calibrated by:

Fung Chi Yip

Date: 16-Sep-2019

Checked by:

Shek Kwong Tai

Date: 16-Sep-2019

The standard(s) and equipment used in the calibration are traceable to national or international recognised standards and are calibrated on a schedule to maintain the required accuracy level.





## CERTIFICATE OF CALIBRATION

Certificate No.: 20CA0324 01

Page: 1 of 2

### Item tested

Description: Acoustical Calibrator (Class 1)  
Manufacturer: MVI  
Type/Model No.: CAL21  
Serial/Equipment No.: 34113610(2011) / N.004.11  
Adaptors used: Yes (BAC21)

### Item submitted by

Customer: AECOM ASIA CO., LTD.  
Address of Customer: -  
Request No.: -  
Date of receipt: 24-Mar-2020

Date of test: 25-Mar-2020

### Reference equipment used in the calibration

Description:	Model:	Serial No.	Expiry Date:	Traceable to:
Lab standard microphone	B&K 4180	2341427	03-May-2020	SCL
Preamplifier	B&K 2673	2239857	17-May-2020	CEPREI
Measuring amplifier	B&K 2610	2346941	05-Jun-2020	CEPREI
Signal generator	DS 360	33873	10-May-2020	CEPREI
Digital multi-meter	34401A	US36087050	08-May-2020	CEPREI
Audio analyzer	8903B	GB41300350	13-May-2020	CEPREI
Universal counter	53132A	MY40003662	10-May-2020	CEPREI

### Ambient conditions

Temperature:  $22 \pm 1$  °C  
Relative humidity:  $55 \pm 10$  %  
Air pressure:  $1005 \pm 5$  hPa

### Test specifications

- The Sound Calibrator has been calibrated in accordance with the requirements as specified in IEC 60942 1997 Annex B and the lab calibration procedure SMTP004-CA-156.
- The calibrator was tested with its axis vertical facing downwards at the specific frequency using insert voltage technique.
- The results are rounded to the nearest 0.01 dB and 0.1 Hz and have not been corrected for variations from a reference pressure of 1013.25 hectoPascals as the maker's information indicates that the instrument is insensitive to pressure changes.

### Test results

This is to certify that the sound calibrator conforms to the requirements of annex B of IEC 60942: 1997 for the conditions under which the test was performed. This does not imply that the sound calibrator meets IEC 60942 under any other conditions.

Details of the performed measurements are presented on **page 2** of this certificate.

Approved Signatory:

  
Feng Junqi

Date: 26-Mar-2020

Company Chop:



Comments: The results reported in this certificate refer to the condition of the instrument on the date of calibration and carry no implication regarding the long-term stability of the instrument.

**CERTIFICATE OF CALIBRATION**

(Continuation Page)

Certificate No.: 20CA0324 01

Page: 2 of 2

**1, Measured Sound Pressure Level**

The output Sound Pressure Level in the calibrator head was measured at the setting and frequency shown using a calibrated laboratory standard microphone and insert voltage technique. The results are given in below with the estimated uncertainties.

Frequency Shown Hz	Output Sound Pressure Level Setting dB	Measured Output Sound Pressure Level dB	(Output level in dB re 20 $\mu$ Pa)
			Estimated Expanded Uncertainty dB
1000	94.00	94.14	0.10

**2, Sound Pressure Level Stability - Short Term Fluctuations**

The Short Term Fluctuations was determined by measuring the maximum and minimum of the fast weighted DC output of the B&K 2610 measuring amplifier over a 20 second time interval as required in the standard. The Short Term Fluctuation was found to be:

**At 1000 Hz** **STF = 0.014 dB**

Estimated expanded uncertainty 0.005 dB

**3, Actual Output Frequency**

The determination of actual output frequency was made using a B&K 4180 microphone together with a B&K 2673 preamplifier connected to a B&K 2610 measuring amplifier. The AC output of the B&K 2610 was taken to an universal counter which was used to determine the frequency averaged over 20 second of operation as required by the standard. The actual output frequency at 1 KHz was:

**At 1000 Hz** **Actual Frequency = 1002.6 Hz**

Estimated expanded uncertainty 0.1 Hz Coverage factor k = 2.2

**4, Total Noise and Distortion**

For the Total Noise and Distortion measurement, the unfiltered AC output of the B&K 2610 measuring amplifier was connected to an Agilent Type 8903 B distortion analyser. The TND result at 1 KHz was:

**At 1000 Hz** **TND = 1.5 %**

Estimated expanded uncertainty 0.7 %

The expanded uncertainties have been calculated in accordance with the ISO Publication "Guide to the expression of uncertainty in measurement", and gives an interval estimated to have a level of confidence of 95%. A coverage factor of 2 is assumed unless explicitly stated.

Calibrated by:

Date:

Fung Chi Yip  
25-Mar-2020

- End -

Checked by:

Date:

Shek Kwong Tat  
26-Mar-2020

The standard(s) and equipment used in the calibration are traceable to national or international recognised standards and are calibrated on a schedule to maintain the required accuracy level.

---

## **APPENDIX F**

### **EM&A Monitoring Schedules**

---



**Central Kowloon Route – Kai Tak West**  
**Impact Environmental Monitoring Schedule for May 2020**

Sunday	Monday	Tuesday	Wednesday	Thursday	Friday	Saturday
					1-May	2-May
3-May	4-May	5-May	6-May	7-May	8-May	9-May
		24-hour TSP 1-hour TSP Noise				
10-May	11-May	12-May	13-May	14-May	15-May	16-May
	24-hour TSP 1-hour TSP Noise					24-hour TSP 1-hour TSP
17-May	18-May	19-May	20-May	21-May	22-May	23-May
				24-hour TSP 1-hour TSP Noise		
24-May	25-May	26-May	27-May	28-May	29-May	30-May
			24-hour TSP 1-hour TSP Noise			
31-May						

The schedule is subject to change due to unforeseeable circumstances (e.g. adverse weather, etc)

**Air Quality Monitoring Station**

E-A14a: Block B of Merit Industrial Centre

**Noise Monitoring Stations**

E-N12a: 19 Hing Yan Street

E-N21a: Block B of Merit Industrial Centre

**Monitoring Frequency**

24-hour TSP: Once every 6 days

1-hour TSP: 3 times every 6 days (as required in case of complaints)

**Monitoring Frequency**

Once per week

**Central Kowloon Route – Kai Tak West**  
**Tentative Impact Environmental Monitoring Schedule for June 2020**

Sunday	Monday	Tuesday	Wednesday	Thursday	Friday	Saturday
	1-Jun	2-Jun	3-Jun	4-Jun	5-Jun	6-Jun
		24-hour TSP 1-hour TSP Noise				
7-Jun	8-Jun	9-Jun	10-Jun	11-Jun	12-Jun	13-Jun
	24-hour TSP 1-hour TSP Noise					24-hour TSP 1-hour TSP
14-Jun	15-Jun	16-Jun	17-Jun	18-Jun	19-Jun	20-Jun
			24-hour TSP 1-hour TSP Noise			24-hour TSP 1-hour TSP
21-Jun	22-Jun	23-Jun	24-Jun	25-Jun	26-Jun	27-Jun
					24-hour TSP 1-hour TSP Noise	
28-Jun	29-Jun	30-Jun				

The schedule is subject to change due to unforeseeable circumstances (e.g. adverse weather, etc)

**Air Quality Monitoring Station**

E-A14a: Block B of Merit Industrial Centre

**Noise Monitoring Stations**

E-N12a: 19 Hing Yan Street

E-N21a: Block B of Merit Industrial Centre

**Monitoring Frequency**

24-hour TSP: Once every 6 days

1-hour TSP: 3 times every 6 days (as required in case of complaints)

**Monitoring Frequency**

Once per week

---

## **APPENDIX G**

### **Air Quality Monitoring Results and their Graphical Presentations**

---

**Appendix G**  
**Air Quality Monitoring Results**

**24-hour TSP Monitoring Results at Station E-A14a (Block B, Merit Industrial Centre)**

Date	Weather Condition	Air Temp. (°C)	Atmospheric Pressure (hPa)	Flow Rate (m <sup>3</sup> /min.)		Av. flow (m <sup>3</sup> /min)	Total vol. (m <sup>3</sup> )	Filter Weight (g)		Particulate weight(g)	Elapse Time		Sampling Time(hrs.)	Conc. (µg/m <sup>3</sup> )
				Initial	Final			Initial	Final		Initial	Final		
5-May-20	Sunny	27.9	1008.8	1.33	1.33	1.33	1916.6	2.6629	2.7038	0.0409	9594.33	9618.33	24.00	21.3
11-May-20	Fine	28.9	1010.3	1.33	1.33	1.33	1916.6	2.6643	2.7437	0.0794	9618.33	9642.33	24.00	41.4
16-May-20	Sunny	28.9	1007.5	1.33	1.33	1.33	1916.6	2.6776	2.7349	0.0573	9642.33	9666.33	24.00	29.9
21-May-20	Cloudy	27.6	1006.1	1.33	1.33	1.33	1916.6	2.6513	2.6911	0.0398	9666.33	9690.33	24.00	20.8
27-May-20	Fine	28.2	1008.6	1.33	1.33	1.33	1916.6	2.8544	2.9277	0.0733	9690.33	9714.33	24.00	38.2
													<b>Average</b>	<b>30.3</b>
													<b>Minimum</b>	<b>20.8</b>
													<b>Maximum</b>	<b>41.4</b>

## Appendix G

### Air Quality Monitoring Results

#### 1-hour TSP Monitoring Results at Station E-A14a (Block B, Merit Industrial Centre)

Date	Start Time (hh:mm)	Weather Condition	1st Hour Conc. ( $\mu\text{g}/\text{m}^3$ )	2nd Hour Conc. ( $\mu\text{g}/\text{m}^3$ )	3rd Hour Conc. ( $\mu\text{g}/\text{m}^3$ )
5-May-20	13:00	Sunny	58.6	59.7	60.2
11-May-20	11:50	Sunny	59.8	61.7	60.5
16-May-20	13:35	Sunny	59.7	61.6	59.2
21-May-20	13:00	Cloudy	58.2	57.1	56.2
27-May-20	10:00	Fine	61.2	59.6	60.4
				Average	59.6
				Min	56.2
				Max	61.7

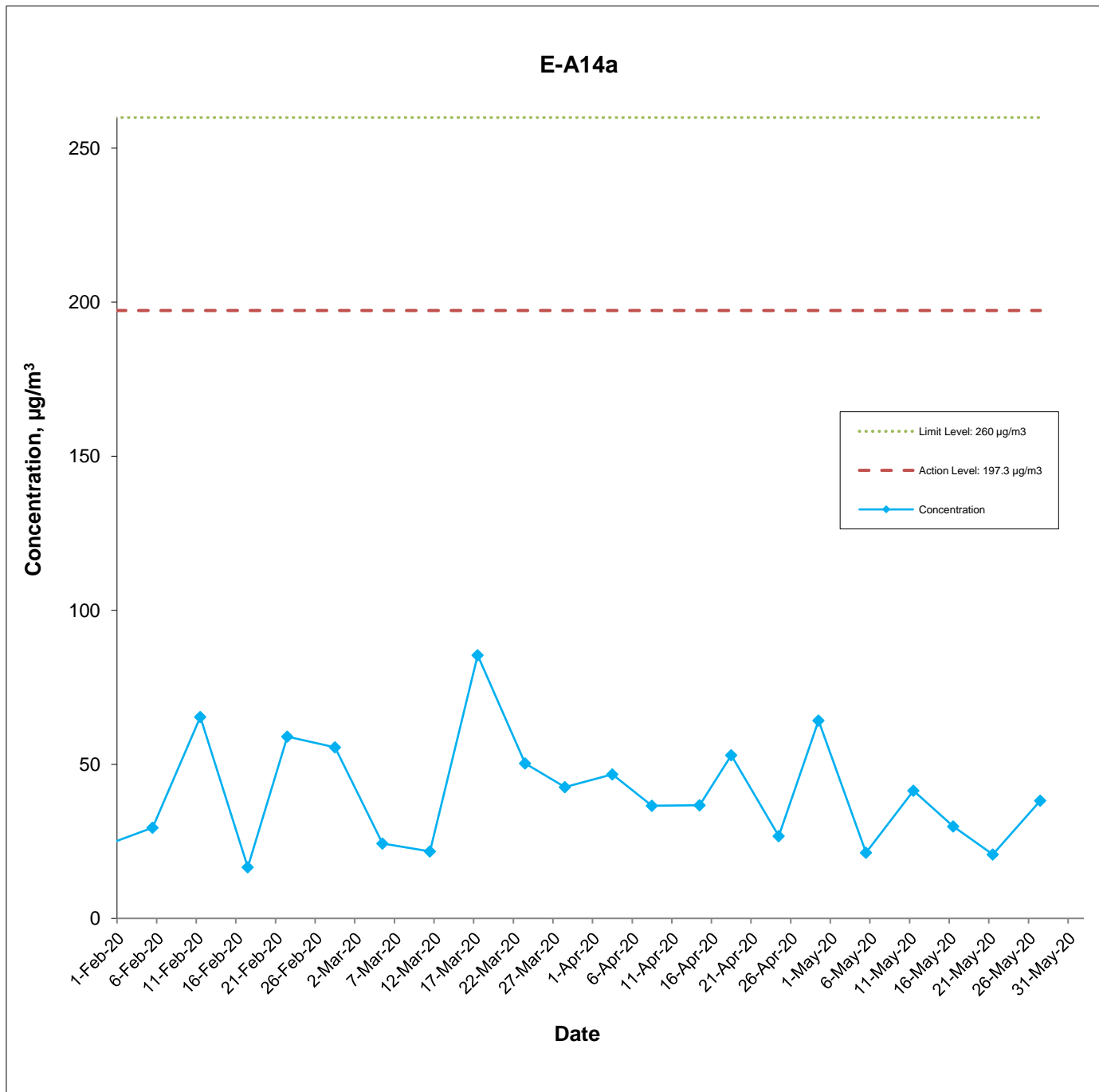

This Drawing has been prepared for the use of AECOM's client. It may not be used, modified, reproduced or relied upon by third parties, except as agreed by AECOM or as required by law. AECOM accepts no responsibility, and denies any liability whatsoever, to any party that uses or relies on this drawing without AECOM's express written consent.

Central Kowloon Route - Kai Tak West (Contract No. HY/2014/07)



#### Graphical Presentation of Impact 24-hour TSP Monitoring Results

Date: June 2020

Appendix G

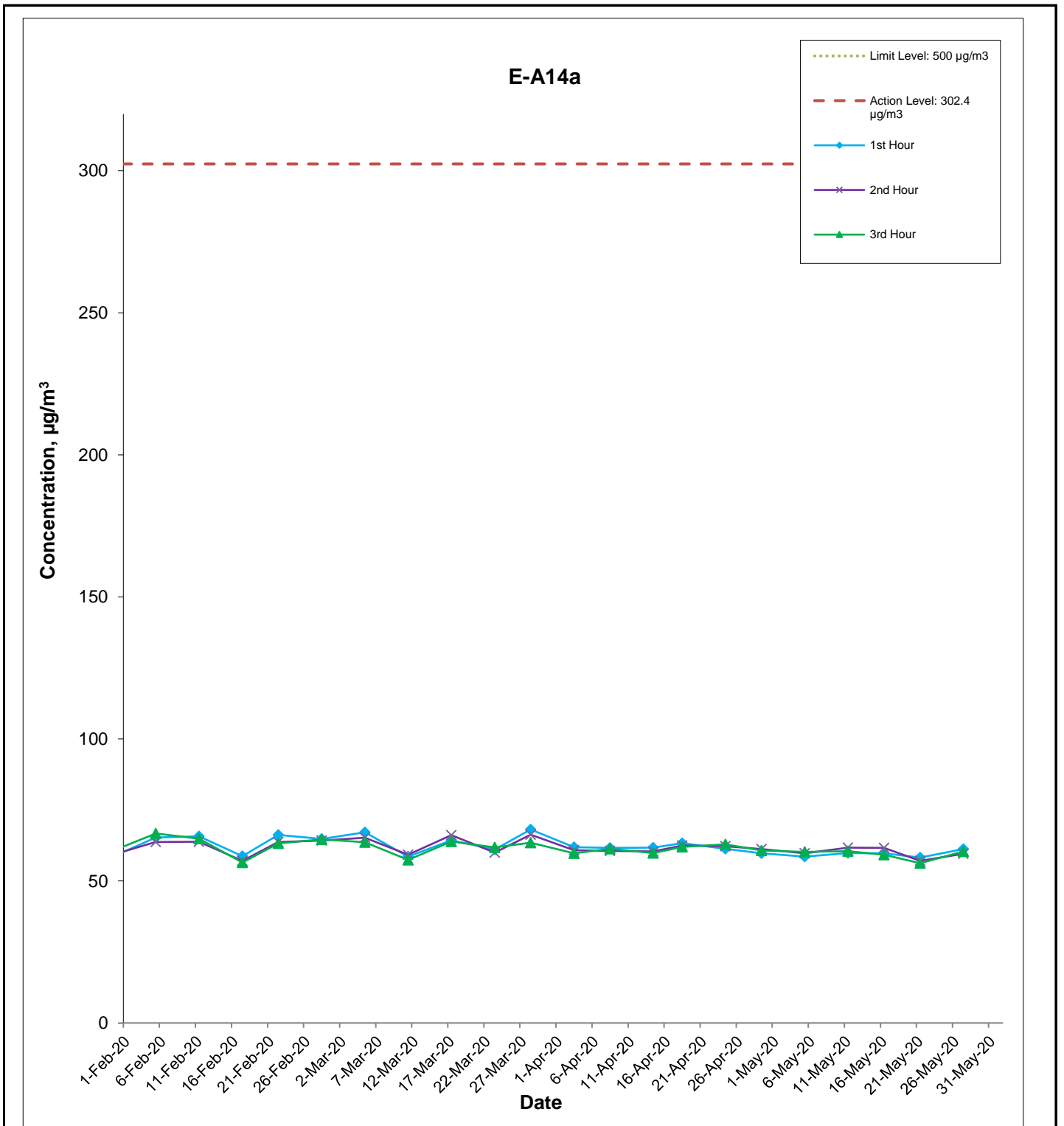

This Drawing has been prepared for the use of AECOM's client. It may not be used, modified, reproduced or relied upon by third parties, except as agreed by AECOM or as required by law. AECOM accepts no responsibility, and denies any liability whatsoever, to any party that uses or relies on this drawing without AECOM's express written consent.

Central Kowloon Route - Kai Tak West (Contract No. HY/2014/07)



### Graphical Presentation of Impact 1-hour TSP Monitoring Results

Date: June 2020

Appendix G

## Data of Wind Direction Extracted from Kai Tak Wind Station of the Hong Kong Observatory

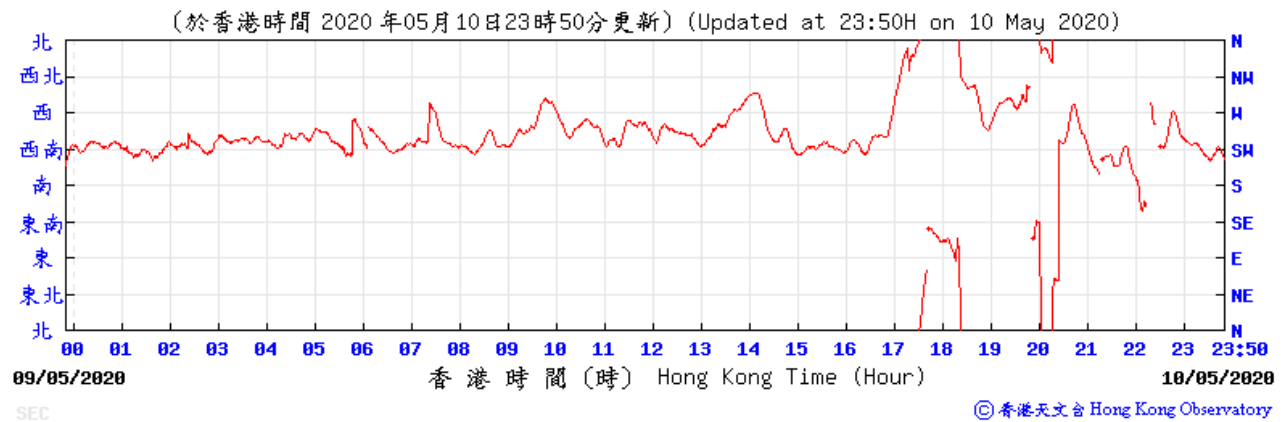
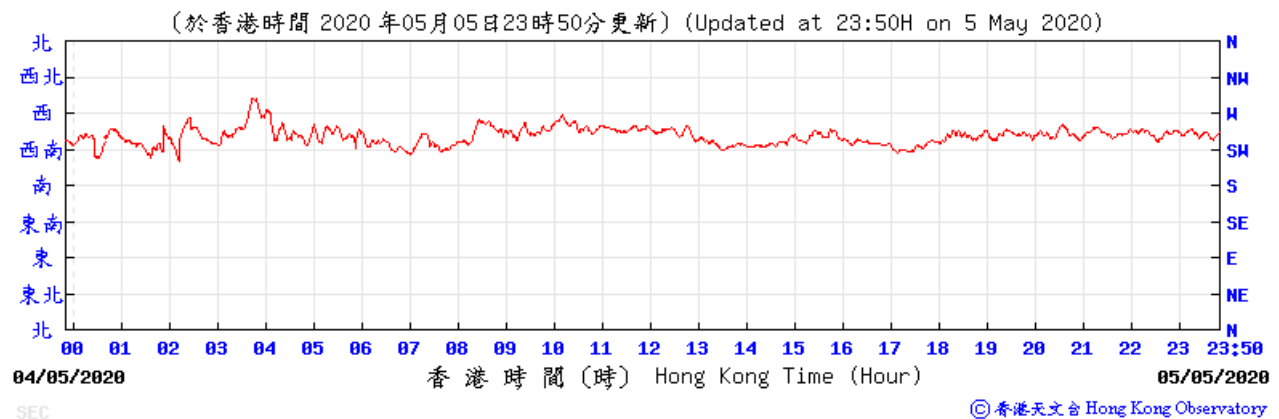
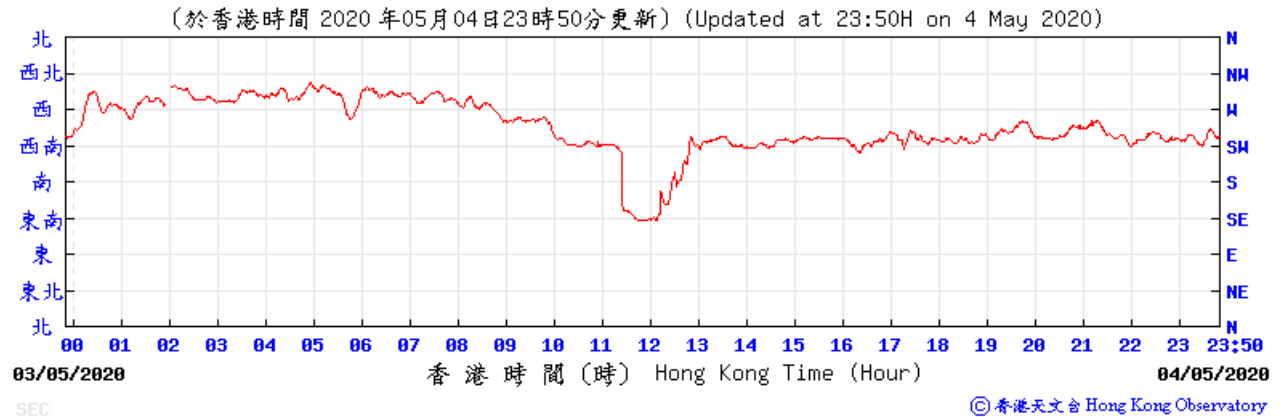



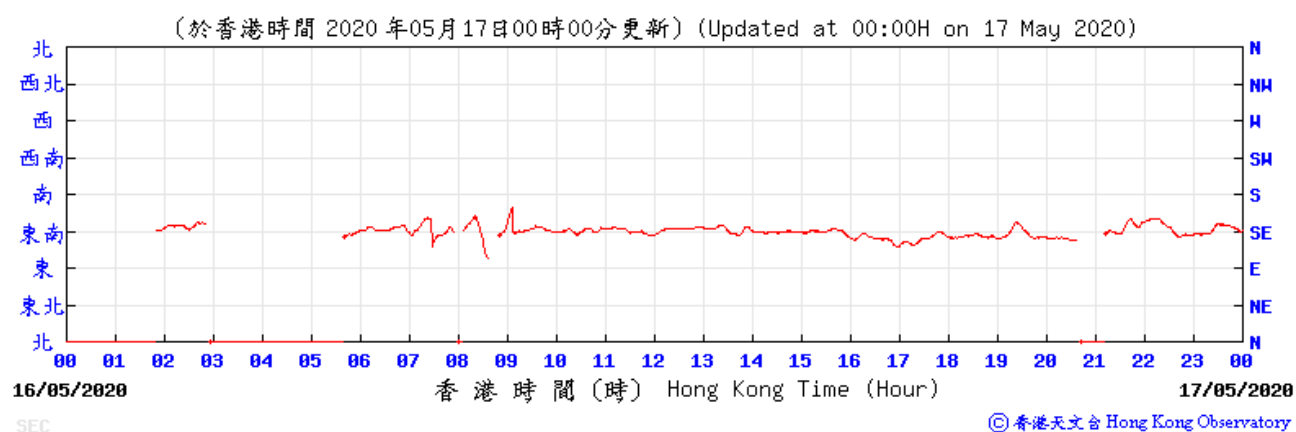
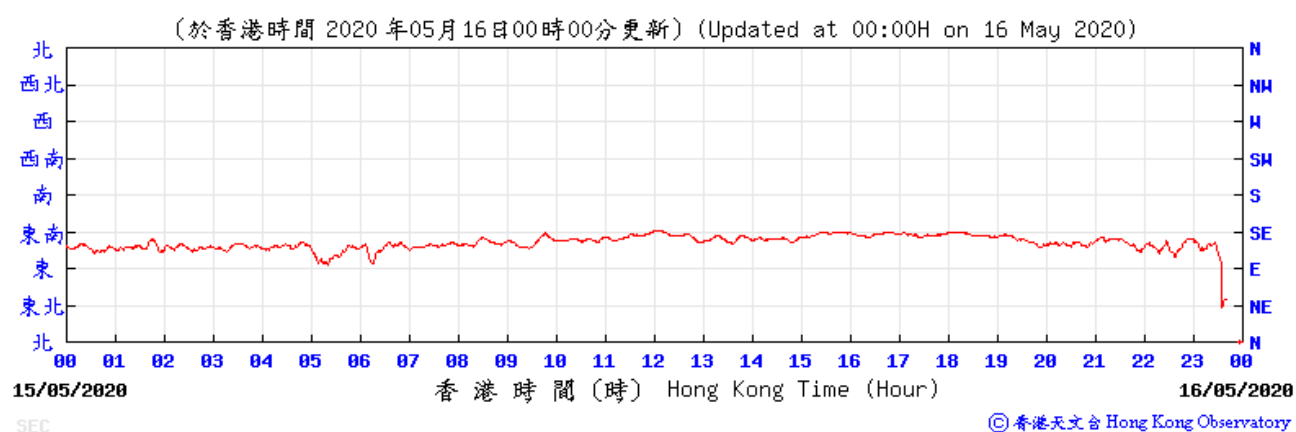
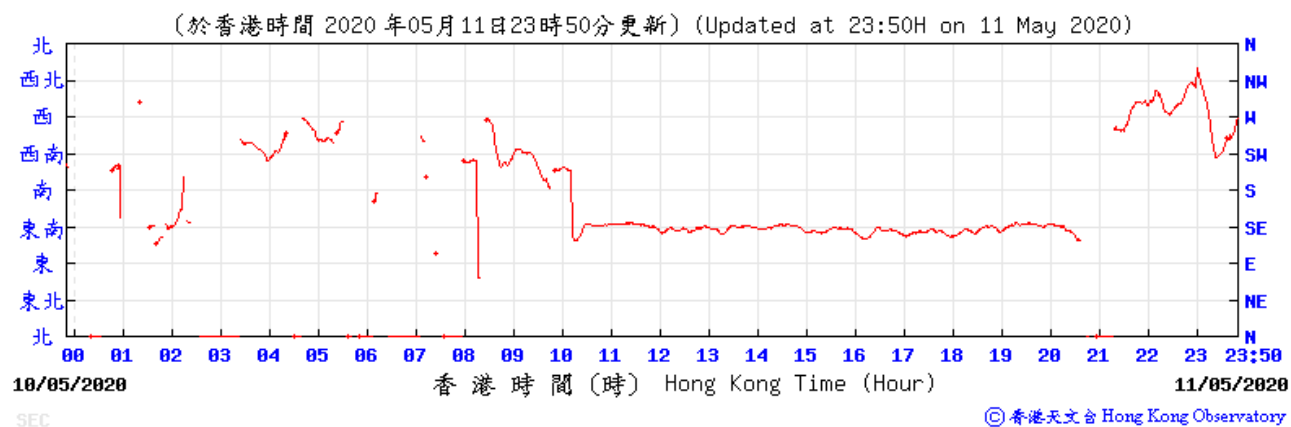

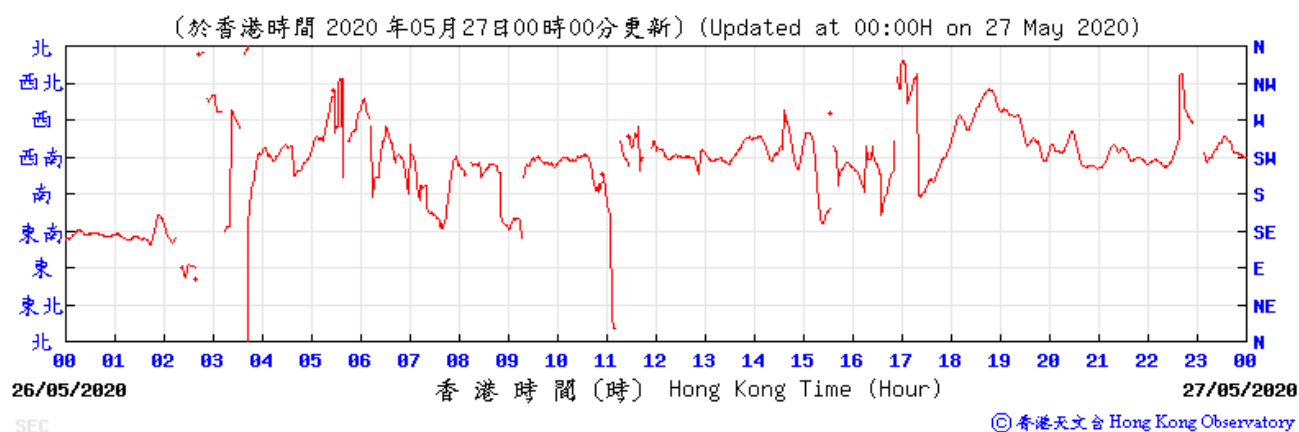
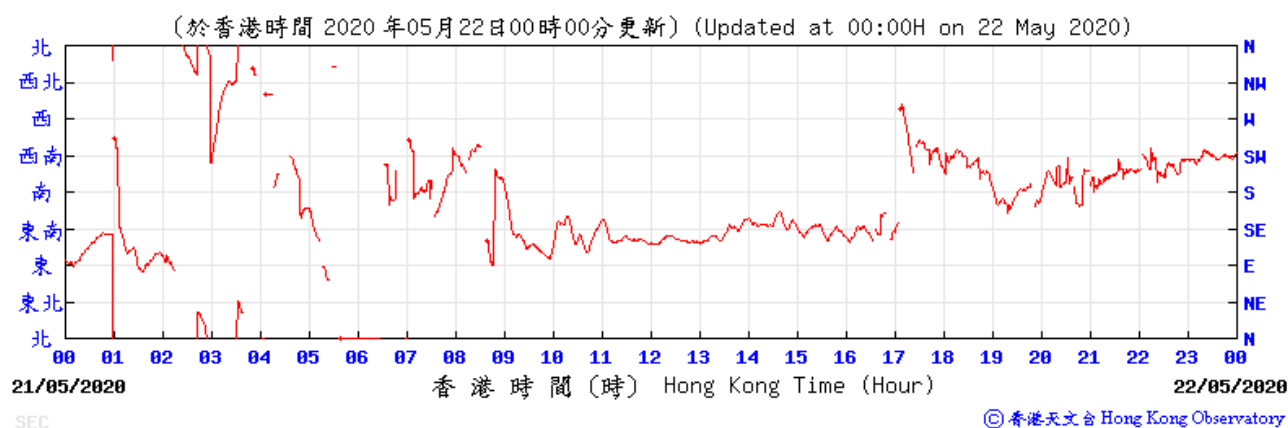
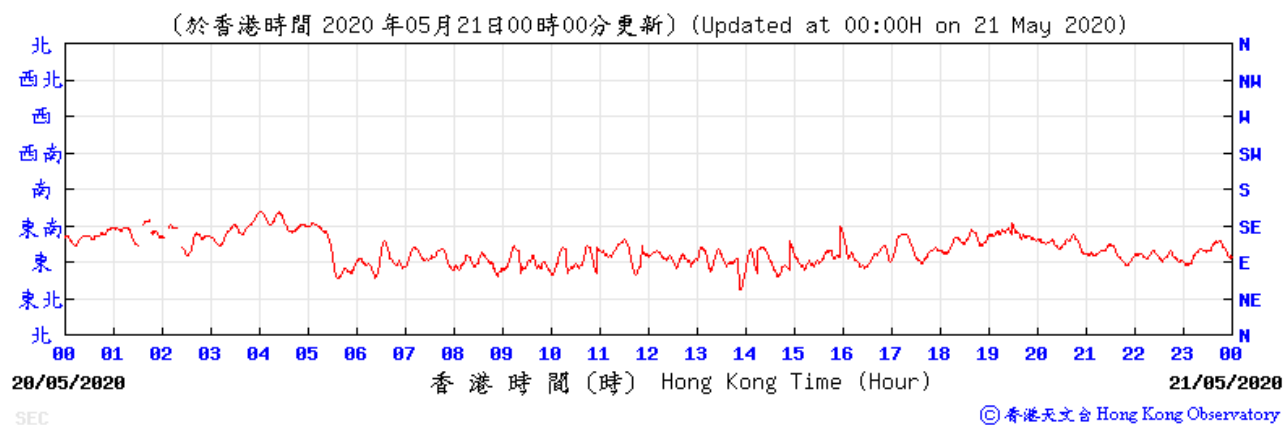

(於香港時間 2020 年05月28日00時00分更新) (Updated at 00:00H on 28 May 2020)

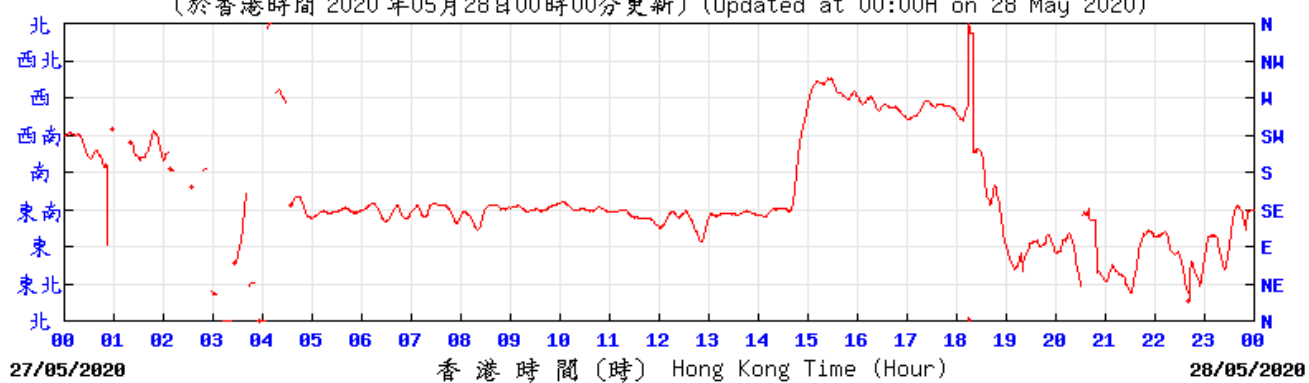

© 香港天文台 Hong Kong Observatory

## Data of Wind Speed Extracted from Kai Tak Wind Station of the Hong Kong Observatory

(公里/小時) (於香港時間 2020 年 5 月 4 日 23 時 50 分更新) (Updated at 23:50H on 4 May 2020)

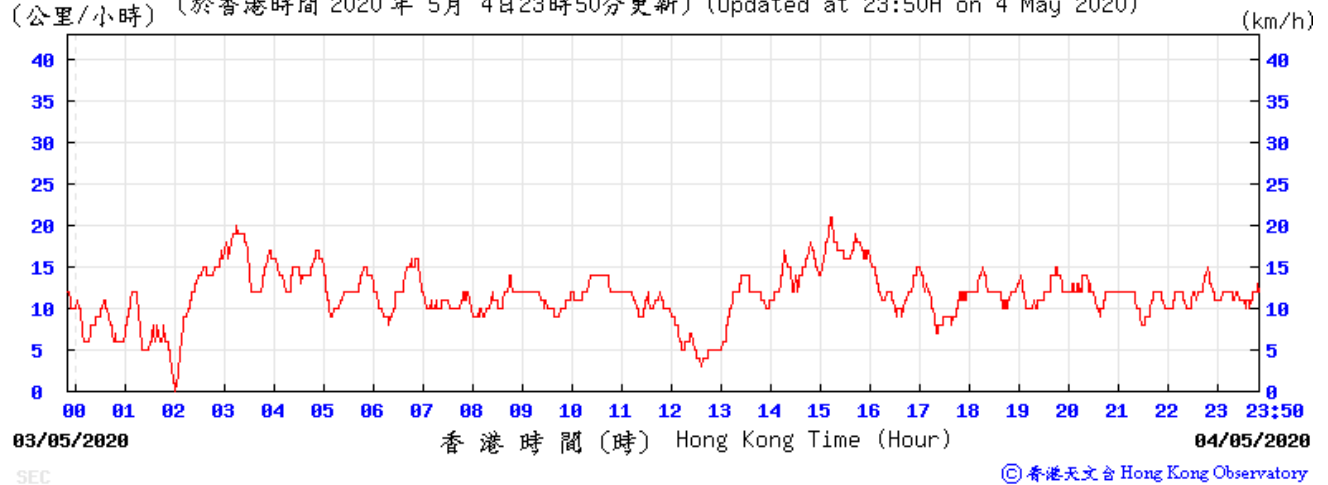

(公里/小時) (於香港時間 2020 年 5 月 5 日 23 時 50 分更新) (Updated at 23:50H on 5 May 2020)

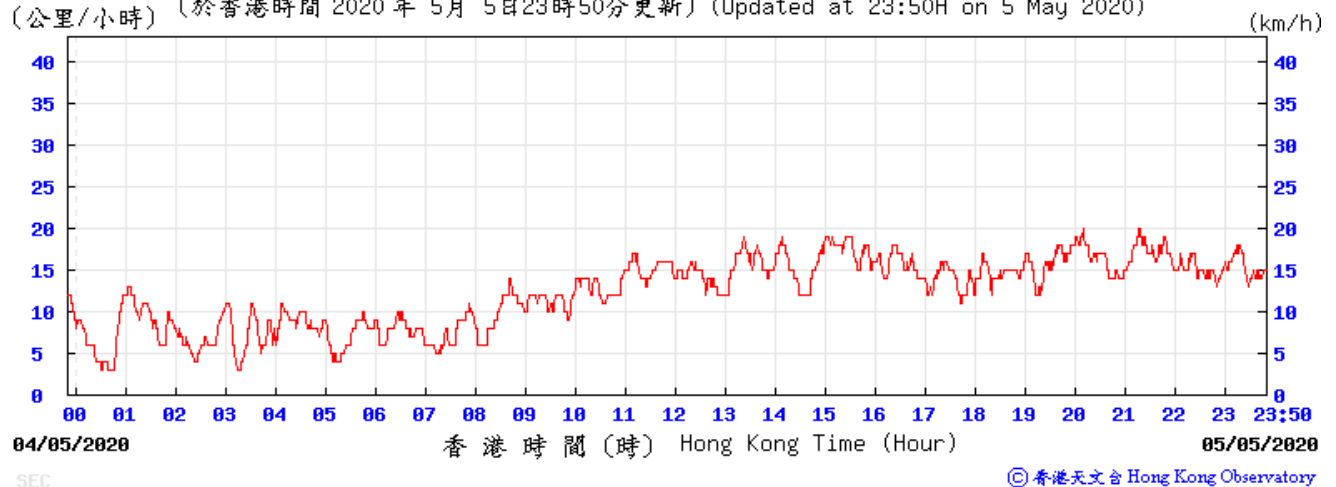

(公里/小時) (於香港時間 2020 年 5 月 10 日 23 時 50 分更新) (Updated at 23:50H on 10 May 2020)

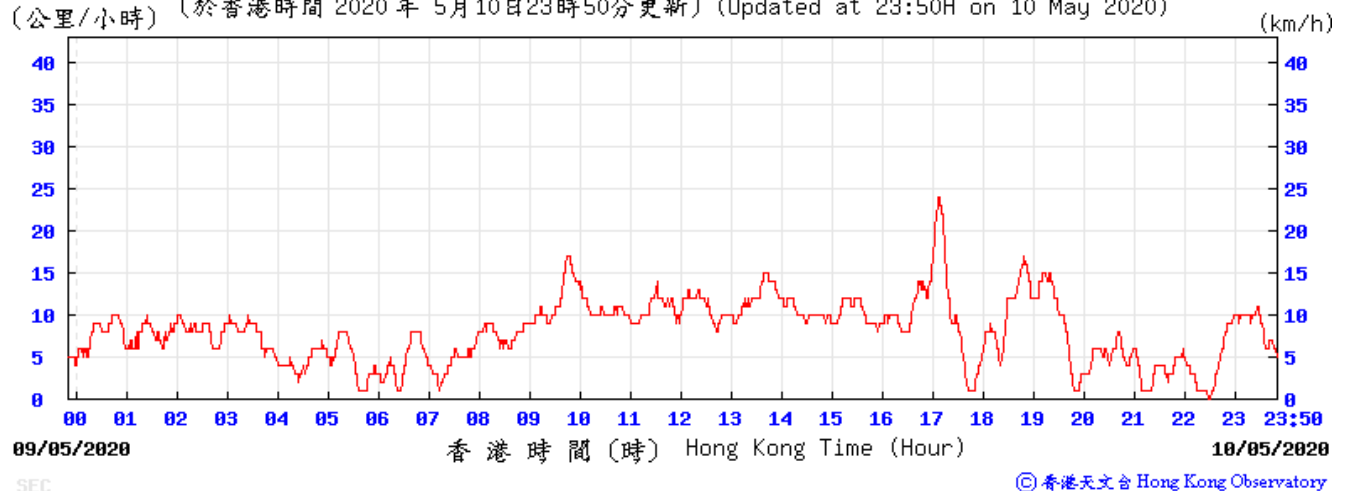

(公里/小時) (於香港時間 2020 年 5月11日23時50分更新) (Updated at 23:50H on 11 May 2020)



© 香港天文台 Hong Kong Observatory

(公里/小時) (於香港時間 2020 年 5月16日 0時 0分更新) (Updated at 00:00H on 16 May 2020)

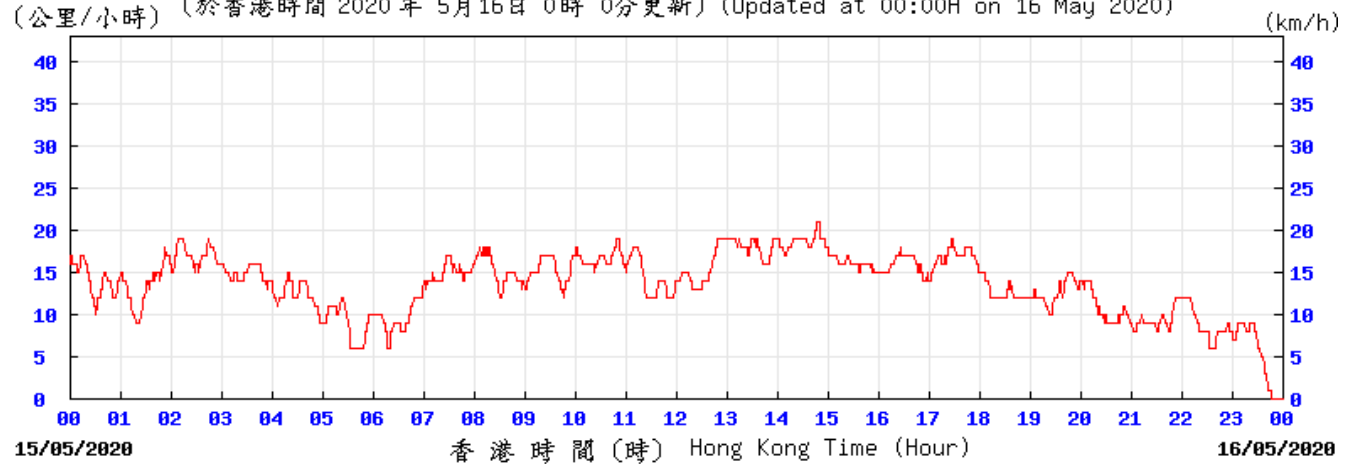

© 香港天文台 Hong Kong Observatory

(公里/小時) (於香港時間 2020 年 5月17日 0時 0分更新) (Updated at 00:00H on 17 May 2020)

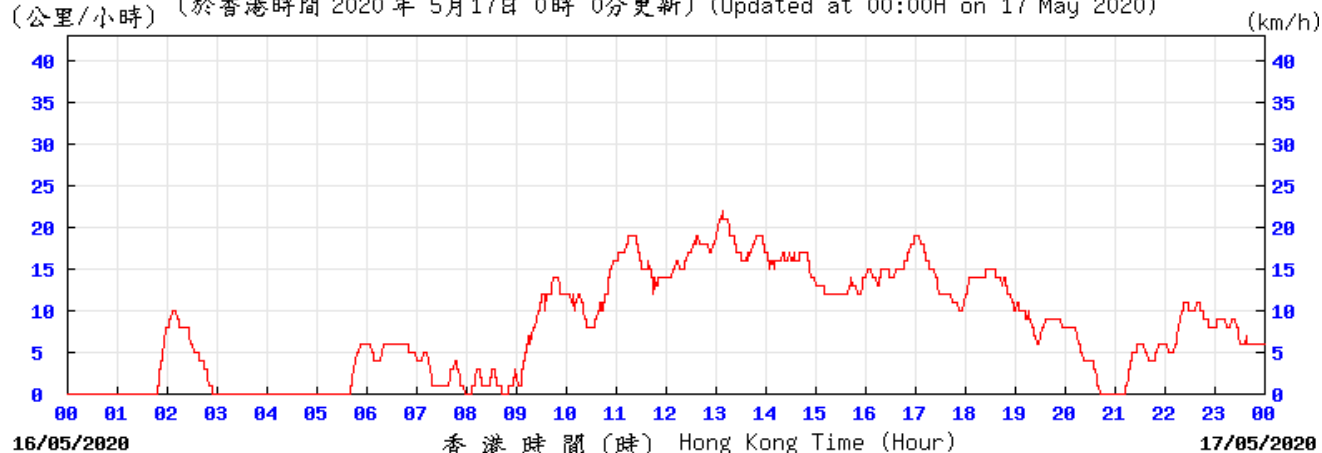

SEC

© 香港天文台 Hong Kong Observatory

(公里/小時) (於香港時間 2020 年 5月21日 0時 0分更新) (Updated at 00:00H on 21 May 2020)

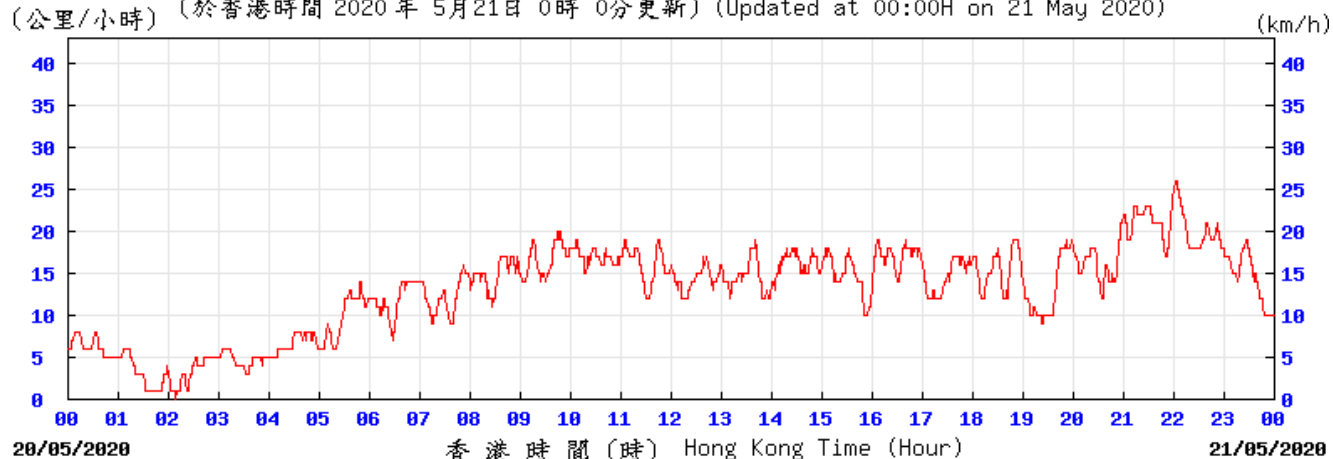

SEC

© 香港天文台 Hong Kong Observatory

(公里/小時) (於香港時間 2020 年 5月22日 0時 0分更新) (Updated at 00:00H on 22 May 2020)

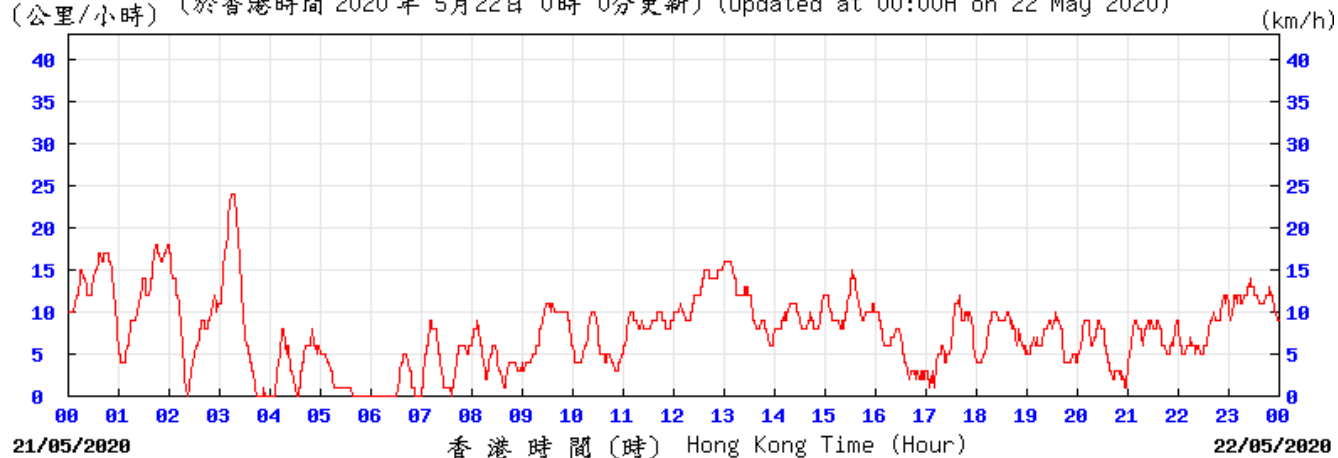

SEC

© 香港天文台 Hong Kong Observatory

(公里/小時) (於香港時間 2020 年 5月27日 0時 0分更新) (Updated at 00:00H on 27 May 2020)

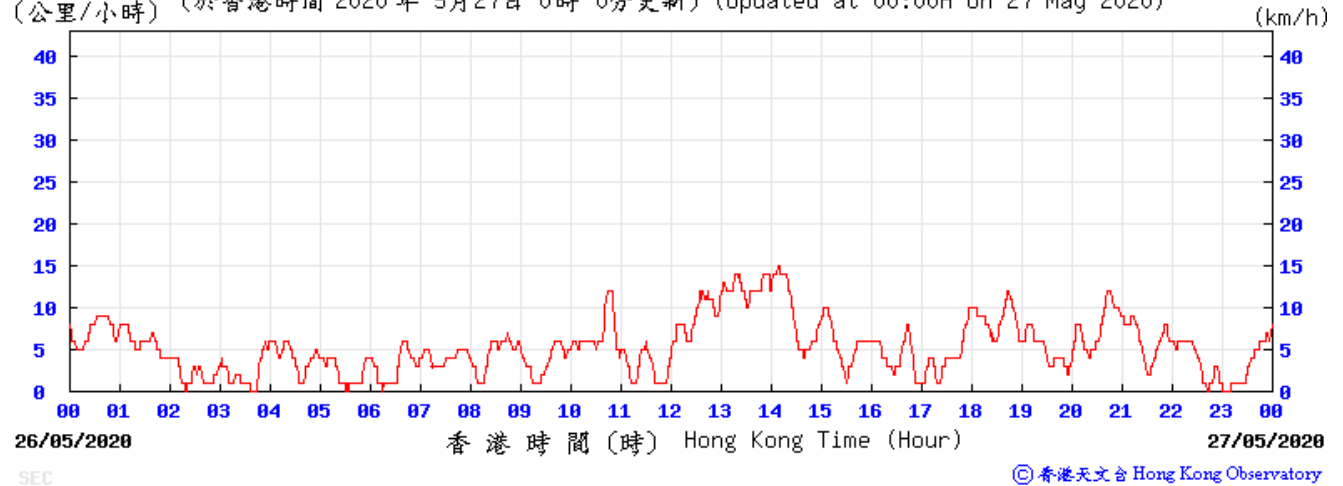

(公里/小時) (於香港時間 2020 年 5月28日 0時 0分更新) (Updated at 00:00H on 28 May 2020)

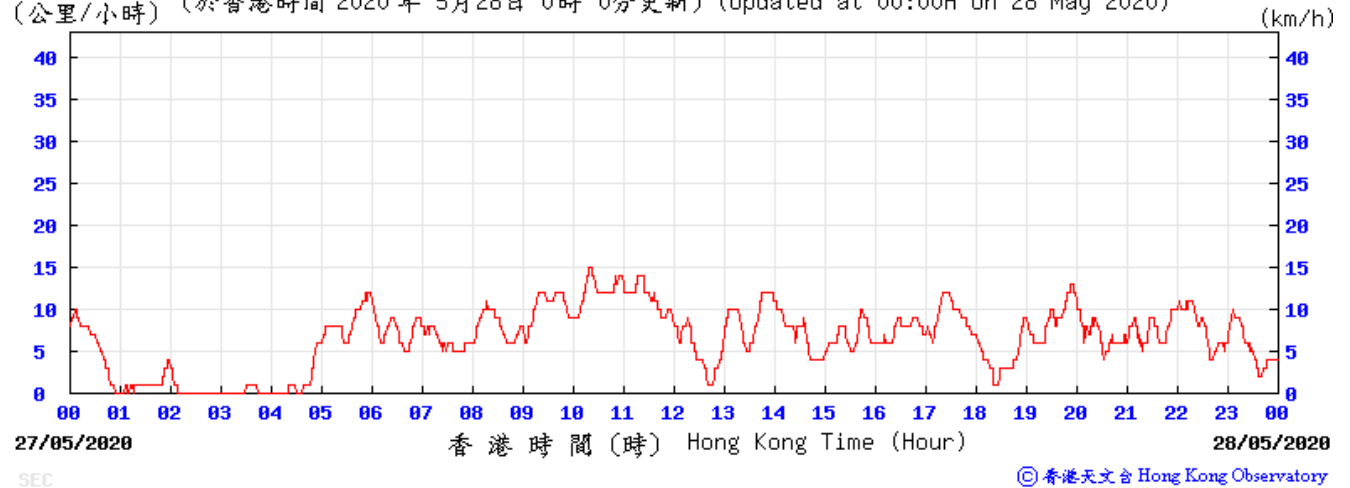

---

## **APPENDIX H**

### **Noise Monitoring Results and their Graphical Presentations**

---



## Appendix H Regular Construction Noise Monitoring Results

Daytime Noise Monitoring Results at Station E-N12a (19 Hing Yan Street)

Date	Weather Condition	Noise Level for 30-min, dB(A) <sup>+</sup>				Limit Level, dB(A)	Exceedance (Y/N)
		Time	L90	L10	Leq		
5-May-20	Sunny	13:00	66.0	69.0	68.1	75	N
11-May-20	Sunny	15:10	62.0	66.5	65.0	75	N
21-May-20	Cloudy	14:00	64.5	68.5	66.8	75	N
27-May-20	Fine	10:55	64.3	68.4	67.2	75	N

Daytime Noise Monitoring Results at Station E-N21a (Block B of Merit Industrial Centre)

Date	Weather Condition	Noise Level for 30-min, dB(A) <sup>#</sup>				Limit Level, dB(A)	Exceedance (Y/N)
		Time	L90	L10	Leq		
5-May-20	Sunny	14:00	65.0	67.5	66.7	75	N
11-May-20	Sunny	14:01	62.5	65.0	63.8	75	N
21-May-20	Cloudy	13:00	63.0	66.5	65.7	75	N
27-May-20	Fine	10:05	66.8	68.2	67.5	75	N

<sup>+</sup> - Façade measurement.

<sup>#</sup> - A correction of +3dB(A) was made to the free field measurement.

<sup>\*</sup> - Limit Level of 70dB(A) applies to education institutes while 65dB(A) applies during school

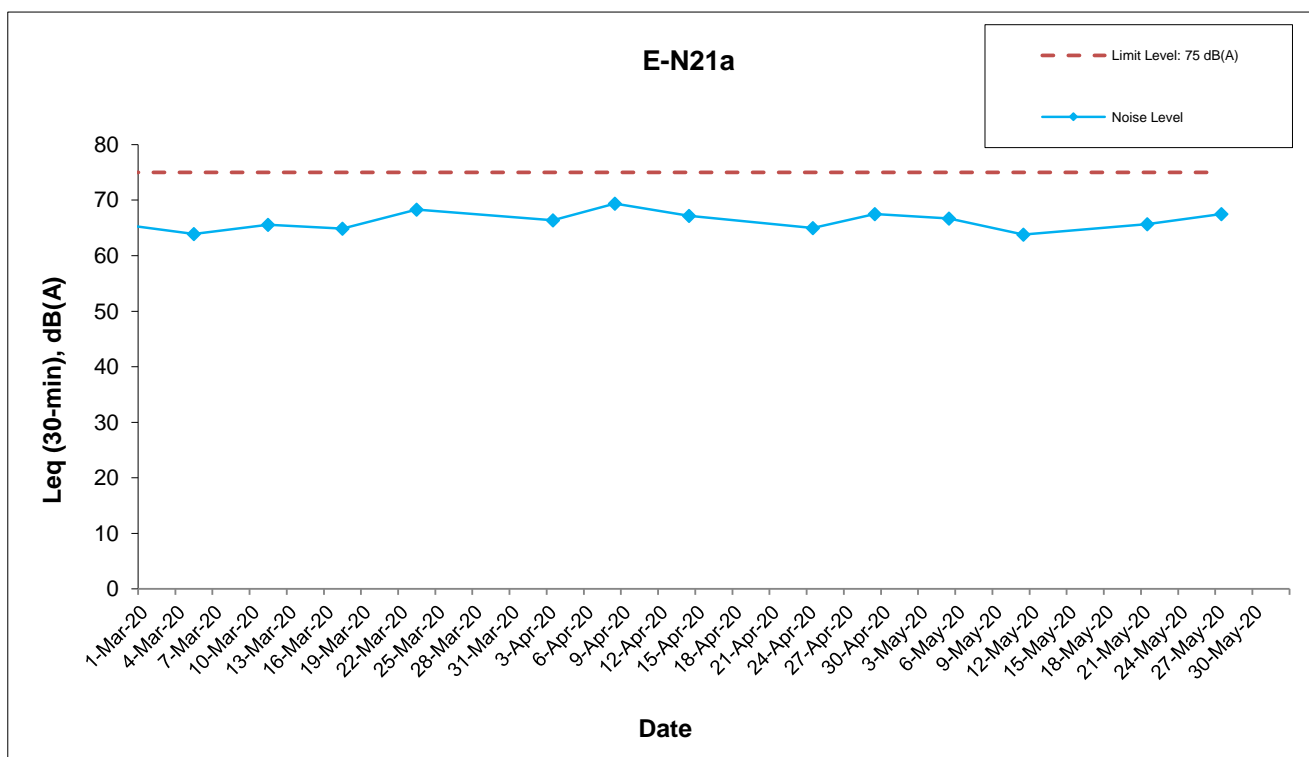
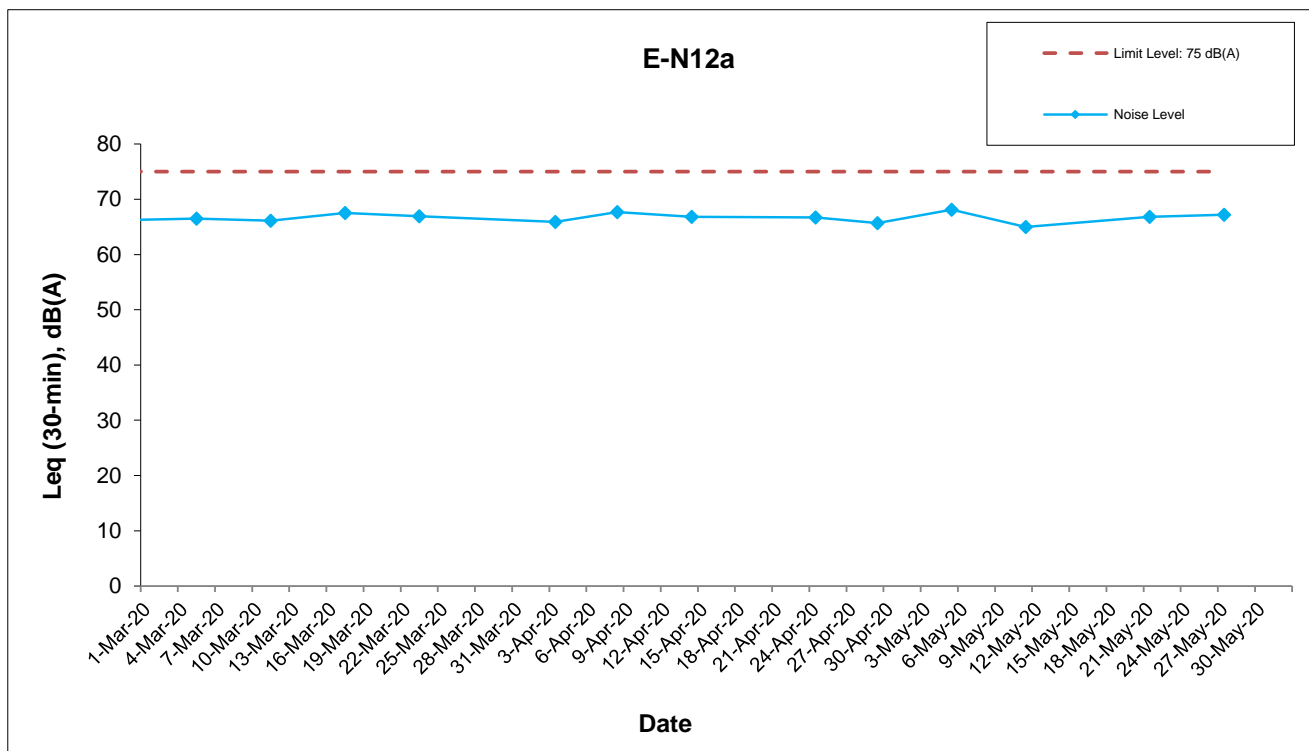

This Drawing has been prepared for the use of AECOM's client. It may not be used, modified, reproduced or relied upon by third parties, except as agreed by AECOM or as required by law. AECOM accepts no responsibility, and denies any liability whatsoever, to any party that uses or relies on this drawing without AECOM's express written consent.

Central Kowloon Route - Kai Tak West (Contract No. HY/2014/07)



#### Graphical Presentation of Impact Noise Monitoring Results

Date: June 2020

Appendix H

---

**APPENDIX I**

**Event Action Plan**

---

## Appendix I Event Action Plan

### Event / Action Plan for Construction Dust Monitoring

EVENT	ACTION			
	ET	IEC	ER	Contractor
<b>ACTION LEVEL</b>				
Exceedance for one sample	<ol style="list-style-type: none"> <li>1. Inform the Contractor, IEC and ER;</li> <li>2. Discuss with the Contractor and IEC on the remedial measures required;</li> <li>3. Repeat measurement to confirm findings;</li> <li>4. Increase monitoring frequency</li> </ol>	<ol style="list-style-type: none"> <li>1. Check monitoring data submitted by the ET;</li> <li>2. Check Contractor's working method;</li> <li>3. Review and advise the ET and ER on the effectiveness of the proposed remedial measures.</li> </ol>	<ol style="list-style-type: none"> <li>1. Confirm receipt of notification of exceedance in writing.</li> </ol>	<ol style="list-style-type: none"> <li>1. Identify source(s), investigate the causes of exceedance and propose remedial measures;</li> <li>2. Implement remedial measures;</li> <li>3. Amend working methods agreed with the ER as appropriate.</li> </ol>
Exceedance for two or more consecutive samples	<ol style="list-style-type: none"> <li>1. Inform the Contractor, IEC and ER;</li> <li>2. Discuss with the ER, IEC and Contractor on the remedial measures required;</li> <li>3. Repeat measurements to confirm findings;</li> <li>4. Increase monitoring frequency to daily;</li> <li>5. If exceedance continues, arrange meeting with the IEC, ER and Contractor;</li> <li>6. If exceedance stops, cease additional monitoring.</li> </ol>	<ol style="list-style-type: none"> <li>1. Check monitoring data submitted by the ET;</li> <li>2. Check Contractor's working method;</li> <li>3. Review and advise the ET and ER on the effectiveness of the proposed remedial measures.</li> </ol>	<ol style="list-style-type: none"> <li>1. Confirm receipt of notification of exceedance in writing;</li> <li>2. Review and agree on the remedial measures proposed by the Contractor;</li> <li>3. Supervise Implementation of remedial measures.</li> </ol>	<ol style="list-style-type: none"> <li>1. Identify source and investigate the causes of exceedance;</li> <li>2. Submit proposals for remedial measures to the ER with a copy to ET and IEC within three working days of notification;</li> <li>3. Implement the agreed proposals;</li> <li>4. Amend proposal as appropriate.</li> </ol>

## Appendix I Event Action Plan

EVENT	ACTION			
	ET	IEC	ER	Contractor
<b>LIMIT LEVEL</b>				
Exceedance for one sample	<ol style="list-style-type: none"> <li>1. Inform the Contractor, IEC, EPD and ER;</li> <li>2. Repeat measurement to confirm findings;</li> <li>3. Increase monitoring frequency to daily;</li> <li>4. Discuss with the ER, IEC and contractor on the remedial measures and assess the effectiveness.</li> </ol>	<ol style="list-style-type: none"> <li>1. Check monitoring data submitted by the ET;</li> <li>2. Check the Contractor's working method;</li> <li>3. Discuss with the ET, ER and Contractor on possible remedial measures;</li> <li>4. Review and advise the ER and ET on the effectiveness of Contractor's remedial measures.</li> </ol>	<ol style="list-style-type: none"> <li>1. Confirm receipt of notification of exceedance in writing;</li> <li>2. Review and agree on the remedial measures proposed by the Contractor;</li> <li>3. Supervise implementation of remedial measures.</li> </ol>	<ol style="list-style-type: none"> <li>1. Identify source(s) and investigate the causes of exceedance;</li> <li>2. Take immediate action to avoid further exceedance;</li> <li>3. Submit proposals for remedial measures to ER with a copy to ET and IEC within three working days of notification;</li> <li>4. Implement the agreed proposals;</li> <li>5. Amend proposal if appropriate.</li> </ol>
Exceedance for two or more consecutive samples	<ol style="list-style-type: none"> <li>1. Notify Contractor, IEC, EPD and ER ;</li> <li>2. Repeat measurement to confirm findings;</li> <li>3. Increase monitoring frequency to daily;</li> <li>4. Carry out analysis of the Contractor's working procedures with the ER to determine possible mitigation to be implemented;</li> <li>5. Arrange meeting with the IEC and ER to discuss the remedial measures to be taken;</li> <li>6. Review the effectiveness of the Contractor's remedial measures and keep IEC, EPD and ER informed of the results;</li> <li>7. If exceedance stops, cease additional monitoring.</li> </ol>	<ol style="list-style-type: none"> <li>1. Check monitoring data submitted by the ET;</li> <li>2. Check the Contractor's working method;</li> <li>3. Discuss with ET, ER, and Contractor on the potential remedial measures;</li> <li>4. Review and advise the ER and ET on the effectiveness of Contractor's remedial measures.</li> </ol>	<ol style="list-style-type: none"> <li>1. Confirm receipt of notification of exceedance in writing;</li> <li>2. In consultation with the ET and IEC, agree with the Contractor on the remedial measures to be implemented;</li> <li>3. Supervise the implementation of remedial measures;</li> <li>4. If exceedance continues, consider what portion of the work is responsible and instruct the Contractor to stop that portion of work until the exceedance is abated.</li> </ol>	<ol style="list-style-type: none"> <li>1. Identify source(s) and investigate the causes of exceedance;</li> <li>2. Take immediate action to avoid further exceedance;</li> <li>3. Submit proposals for remedial measures to the ER with a copy to the IEC and ET within three working days of notification;</li> <li>4. Implement the agreed proposals;</li> <li>5. Revise and resubmit proposals if problem still not under control;</li> <li>6. Stop the relevant portion of works as determined by the ER until the exceedance is abated.</li> </ol>

## Appendix I Event Action Plan

### Event and Action Plan for Construction Noise Monitoring

EVENT	ACTION			
	ET	IEC	ER	Contractor
Exceedance of Action Level	<ol style="list-style-type: none"> <li>1. Notify the Contractor, IEC and ER;</li> <li>2. Discuss with the ER, IEC and Contractor on the remedial measures required; and</li> <li>3. Increase monitoring frequency to check mitigation effectiveness.</li> </ol>	<ol style="list-style-type: none"> <li>1. Review the investigation results submitted by the contractor; and</li> <li>2. Review and advise the ET and ER on the effectiveness of the remedial measures proposed by the Contractor.</li> </ol>	<ol style="list-style-type: none"> <li>1. Confirm receipt of notification of complaint in writing;</li> <li>2. Review and agree on the remedial measures proposed by the Contractor; and</li> <li>3. Supervise implementation of remedial measures.</li> </ol>	<ol style="list-style-type: none"> <li>1. Investigate the complaint and propose remedial measures;</li> <li>2. Report the results of investigation to the IEC, ET and ER;</li> <li>3. Submit noise mitigation proposals to the ER with copy to the IEC and ET within 3 working days of notification; and</li> <li>4. Implement noise mitigation proposals.</li> </ol>
Exceedance of Limit Level	<ol style="list-style-type: none"> <li>1. Notify the Contractor, IEC, EPD and ER ;</li> <li>2. Repeat measurement to confirm findings;</li> <li>3. Increase monitoring frequency;</li> <li>4. Carry out analysis of Contractor's working procedures to determine possible mitigation to be implemented;</li> <li>5. Arrange meeting with the IEC and ER to discuss the remedial measures to be taken;</li> <li>6. Inform IEC, ER and EPD the causes and actions taken for the exceedances;</li> <li>7. Review the effectiveness of Contractor's remedial measures and keep IEC, EPD and ER informed of the results; and</li> <li>8. If exceedance stops, cease additional monitoring.</li> </ol>	<ol style="list-style-type: none"> <li>1. Check monitoring data submitted by the ET;</li> <li>2. Check the Contractor's working method;</li> <li>3. Discuss with the ER, ET and Contractor on the potential remedial measures; and</li> <li>4. Review and advise the ET and ER on the effectiveness of the remedial measures proposed by the Contractor.</li> </ol>	<ol style="list-style-type: none"> <li>1. Confirm receipt of notification of exceedance in writing;</li> <li>2. In consultation with the ET and IEC, agree with the Contractor on the remedial measures to be implemented;</li> <li>3. Supervise the implementation of remedial measures; and</li> <li>4. If exceedance continues, consider what portion of the work is responsible and instruct the Contractor to stop that portion of work until the exceedance is abated.</li> </ol>	<ol style="list-style-type: none"> <li>1. Identify source and investigate the causes of exceedance;</li> <li>2. Take immediate action to avoid further exceedance;</li> <li>3. Submit proposals for remedial measures to the ER with copy to the IEC and ET within 3 working days of notification;</li> <li>4. Implement the agreed proposals;</li> <li>5. Revise and resubmit proposals if problem still not under control; and</li> <li>6. Stop the relevant portion of works as determined by the ER until the exceedance is abated.</li> </ol>

## Appendix I Event Action Plan

### Event and Action Plan for Continuous Noise Monitoring

EVENT	ACTION			
	ET	IEC	ER	CONTRACTOR
<b>Action/Limit Level</b>	<ol style="list-style-type: none"> <li>1. Identify source ;</li> <li>2. Repeat measurement. If two consecutive measurements exceed Action/Limit Level, the exceedance is then confirmed;</li> <li>3. If exceedance is confirmed, notify IEC, ER and Contractor;</li> <li>4. Investigate the cause of exceedance and check Contractor's working procedures to determine possible mitigation to be implemented;</li> <li>5. Discuss jointly with the IEC, ER and Contractor and formulate remedial measures; and</li> <li>6. Assess effectiveness of Contractor's remedial actions and keep IEC and ER informed of the results.</li> </ol>	<ol style="list-style-type: none"> <li>1. Check monitoring data submitted by the Works Contract 1123 ET;</li> <li>2. Check the Contractor's working method;</li> <li>3. Discuss with the ER, Works Contract 1123 ET and Contractor on the potential remedial measures; and</li> <li>4. Review and advise the Works Contract 1123 ET and ER on the effectiveness of the remedial measures proposed by the Contractor.</li> </ol>	<ol style="list-style-type: none"> <li>1. Confirm receipt of notification of exceedance in writing;</li> <li>2. In consultation with the Works Contract 1123 ET and IEC, agree with the Contractor on the remedial measures to be implemented;</li> <li>3. Ensure the proper implementation of remedial measures; and</li> <li>4. If exceedance continues, consider what portion of the work is responsible and instruct the Contractor to stop that portion of work until the exceedance is abated.</li> </ol>	<ol style="list-style-type: none"> <li>1. Identify source with the Works Contract 1123 ET;</li> <li>2. If exceedance is confirmed, investigation the cause of exceedance and take immediate action to avoid further exceedance;</li> <li>3. Submit proposals for remedial measures to the ER with copy to the IEC and ET of notification;</li> <li>4. Implement the agreed proposals;</li> <li>5. Liaise with ER to optimize the effectiveness of the agreed mitigation;</li> <li>6. Revise and resubmit proposals if problem still not under control; and</li> <li>7. Stop the relevant portion of works as determined by the ER until the exceedance is abated.</li> </ol>

---

## **APPENDIX J**

### **Cumulative Statistics on Complaints, Notification of Summons and Successful Prosecutions**

---



## Appendix J

## Cumulative Statistics on Complaints, Notification of Summons and Successful Prosecutions

	Date received	Subject	Status	Total no. received in this month	Total no. received since project commencement
Environmental complaints	7 February 2020 (Referred by the Contractor on 16 May 2020)	<p>Environmental Complaint No: EC-024-CKRKTW20200516_01_C040</p> <p><b><u>Details of Complaint</u></b></p> <p>A complaint (reference no.: EP3/K10/RE/00003904-20) was received by Environmental Protection Department on 7 February 2020 and referred by the Contractor on 16 May 2020. The complaint related the noise concern was detailed as follows:</p> <ul style="list-style-type: none"> <li>- Complainant said that noise from the carrying out of construction works at the site caused noise problem during daytime and also night till 23:00 p.m.</li> </ul> <p><b><u>Details of Investigation and findings</u></b></p> <p>Based on the Contractor's information, no works was conducted at Landing Step Area and the construction activities from 0700 – 1900 hours according to the requirement set out in the Technical Memorandum of Environmental Impact Assessment Ordinance (EIAO-TM) on 7 February 2020 at Ma Tau Kok:</p> <ul style="list-style-type: none"> <li>• Rock breaking at S6 layer (around 22.5m below of the ground level);</li> <li>• S6 ELS installation;</li> <li>• Lifting rock debris by crane for disposal;</li> <li>• Concreting at the Deck;</li> <li>• Pipe piling work for Cut and Cover Tunnel.</li> </ul> <p>To complied with the requirement of approved Construction Noise Mitigation Measure Plan (CNMMP), some mitigation measures for the noise nuisance source were implemented by Contractor at Ma Tau Kok for daily work, such as the acoustic deck had been installed on the Access Shaft Deck, acoustic sheet barrier had been erected along the site boundary, additional acoustic panel also partial covered to minimize the opening of the shaft and enhance the performance of noise screening and movable noise barrier was erected for powered mechanical equipment (PMEs). Furthermore, the operation of breaking and drilling were only conducted inside the access shaft with the acoustic deck which located around 22.5m below of the ground level.</p> <p>According to the Contractor's information, acoustic deck was made by the sheet pile, which filled in concrete, and additional noise absorption panel was installed underneath the deck to enhance the effectiveness of the noise minimization.</p> <p>Regular site inspections were conducted by ET on 5 and 12 February 2020, there were no breaking activity on the exposed area at Ma Tau Kok. The detectable noise source was coming from the underground breaking activity and pipe piling. Besides, some of mitigation measures for noise were also observed during site inspection. However, some rectified actions</p>	Closed	1	24

	<b>Date received</b>	<b>Subject</b>	<b>Status</b>	<b>Total no. received in this month</b>	<b>Total no. received since project commencement</b>
		<p>were requested by ET to enhance the performance of noise screening and those had been rectified by the Contractor immediately.</p> <p>According to the EM&amp;A monitoring schedule and the additional environmental monitoring at Grand Waterfront in February 2020, noise monitoring was conducted at EM&amp;A stations and additional monitoring station at Grand Waterfront on 5 and 11 February 2020.</p> <p>Based on the monitoring result on 5 and 11 February 2020, all readings were recorded under the criteria stipulated in EIAO-TM. No Limit level for Noise was triggered.</p> <p>As observed by ET's in-situ observation during the monitoring at the EM&amp;A station, the detectable noise sources mostly came from traffic noise from To Kwa Wan Road and noise from the Kowloon Bay and Ma Tau Kok work areas was also intermittently heard at E-N12a and E-N21a.</p> <p>For the additional monitoring station at the second refuge floor of Grand Waterfront, intermittence breaking noise, which mitigated by the acoustic deck, and noise from pipe piling were also heard from the Ma Tau Kok. In addition, no breaking activity was observed on the exposed area of Ma Tau Kok.</p> <p>According to the Contractor's information, two hydraulic breakers and one drilling rig were operated from 19:00 to 23:00 for rock breaking at S6 layer which only located around 22.5m below of the ground level in the Access Shaft and no work was conducted after 23:00 on 7 February 2020. To minimize the noise nuisance from the nighttime works, All opening had been covered by acoustic enclosure for noise screening and the door of tally room at the Access Shaft had been closed during the nighttime works. Besides, valid Construction Noise Permit (CNP no.: GW-RE1013-19) had been granted from EPD to cover the operation time of PME's were covered from 19:00 to 24:00.</p> <p>From the results of the compliance check, no non-compliance was found under the conditions in the granted CNP.</p> <p>It is considered that the mitigation measure was implemented properly and remedial action was conducted by the Contractor to minimize the noise nuisance to public during daily and nighttime works, and the data results at the EM&amp;A stations and additional environmental monitoring station at the Grand Waterfront on 5 and 11 February 2020 were also complied with the noise criteria stipulated in EIAO-TM. However, the mitigation measures should be recommended to review daily before commencement of and during construction.</p>			
<b>Notification of summons</b>	--	--	--	0	0
<b>Successful prosecutions</b>	--	--	--	0	0

---

## APPENDIX K

### Waste Flow Table

---

Appendix K  
Monthly Summary Waste Flow Table

Monthly Summary Waste Flow Table for 2020

Month	Actual Quantities of Inert C&D Materials Generated Monthly (Note 1)												Actual Quantities of Non-inert C&D Wastes) Generated Monthly					Actual Quantities of Contaminated Soil Monthly		Actual Quantities of Land-based Sediment Monthly	Actual Quantities of Marine-based sediment Monthly			
	Generated					Disposed				Reused			Recycled			Disposed		Reused	Reused	Disposed		Disposed		
	Fill Material	Artificial Material			Total Quantity Generated	Disposed as Public Fills at TKO137	Disposed as Public Fills at TM38	Disposed as Public Fills at CWPFBP	Total Quantity Disposal	Reused in the Contract	Reused in Other Projects	Total Quantity Reused	Metals	Paper/ cardboard packaging (Note 3)	Plastics	Chemical Waste	General Refuse (Note 2)	Reused in the Contract	Reused in the Contract	Disposed at Designated Site		Disposed at Designated Site		
		Soil and Rock	Broken Concrete	Asphalt																Building Derbis	Type 1 (Cat. L)	Type 1 (Cat. M <sub>p</sub> )	Type 2 (Cat. M <sub>i</sub> , Cat. H)	Type 1 (Cat. L, Cat. M <sub>p</sub> )
Unit	('000m <sup>3</sup> )	('000m <sup>3</sup> )	('000m <sup>3</sup> )	('000m <sup>3</sup> )	('000m <sup>3</sup> )	('000m <sup>3</sup> )	('000m <sup>3</sup> )	('000m <sup>3</sup> )	('000m <sup>3</sup> )	('000m <sup>3</sup> )	('000m <sup>3</sup> )	('000m <sup>3</sup> )	('000Kg)	('000Kg)	('000Kg)	('000L)	('000Kg)	('000m <sup>3</sup> )	('000m <sup>3</sup> )	('000m <sup>3</sup> )	('000m <sup>3</sup> )	('000m <sup>3</sup> )	('000m <sup>3</sup> )	('000m <sup>3</sup> )
Jan	35.394	0.008	0.000	0.000	35.402	0.000	0.031	0.000	0.031	0.000	35.371	35.371	33.130	0.180	0.000	0.000	21.510	0.000	0.000	0.000	0.000	0.000	0.309	0.000
Feb	48.036	0.000	0.023	0.000	48.058	0.000	1.065	0.000	1.065	0.000	46.993	46.993	0.000	0.000	0.000	0.000	13.800	0.000	0.000	0.000	0.000	0.724	4.126	0.000
Mar	40.020	0.008	0.000	0.000	40.029	5.760	0.024	0.000	5.784	0.000	34.245	34.245	0.000	0.214	0.000	0.000	33.740	0.000	0.000	0.000	0.000	6.496	8.543	0.000
Apr	46.955	0.003	0.002	0.000	46.960	24.984	0.895	0.000	25.879	0.000	21.081	21.081	0.000	0.172	0.000	1.400	38.070	0.000	0.000	0.000	0.000	10.151	8.900	0.000
May	46.664	0.007	0.074	0.000	46.745	35.045	5.697	0.000	40.742	0.000	6.003	6.003	0.000	0.000	0.000	0.000	36.930	0.000	0.000	0.000	0.000	6.134	1.051	0.000
Jun	0.000	0.000	0.000	0.000	0.000	0.000	0.000	0.000	0.000	0.000	0.000	0.000	0.000	0.000	0.000	0.000	0.000	0.000	0.000	0.000	0.000	0.000	0.000	0.000
SUB-TOTAL	217.069	0.026	0.099	0.000	217.194	65.790	7.711	0.000	73.501	0.000	143.694	143.694	33.130	0.566	0.000	1.400	144.050	0.000	0.000	0.000	0.000	23.505	22.929	0.000
Jul	0.000	0.000	0.000	0.000	0.000	0.000	0.000	0.000	0.000	0.000	0.000	0.000	0.000	0.000	0.000	0.000	0.000	0.000	0.000	0.000	0.000	0.000	0.000	0.000
Aug	0.000	0.000	0.000	0.000	0.000	0.000	0.000	0.000	0.000	0.000	0.000	0.000	0.000	0.000	0.000	0.000	0.000	0.000	0.000	0.000	0.000	0.000	0.000	0.000
Sep	0.000	0.000	0.000	0.000	0.000	0.000	0.000	0.000	0.000	0.000	0.000	0.000	0.000	0.000	0.000	0.000	0.000	0.000	0.000	0.000	0.000	0.000	0.000	0.000
Oct	0.000	0.000	0.000	0.000	0.000	0.000	0.000	0.000	0.000	0.000	0.000	0.000	0.000	0.000	0.000	0.000	0.000	0.000	0.000	0.000	0.000	0.000	0.000	0.000
Nov	0.000	0.000	0.000	0.000	0.000	0.000	0.000	0.000	0.000	0.000	0.000	0.000	0.000	0.000	0.000	0.000	0.000	0.000	0.000	0.000	0.000	0.000	0.000	0.000
Dec	0.000	0.000	0.000	0.000	0.000	0.000	0.000	0.000	0.000	0.000	0.000	0.000	0.000	0.000	0.000	0.000	0.000	0.000	0.000	0.000	0.000	0.000	0.000	0.000
TOTAL	217.069	0.026	0.099	0.000	217.194	65.790	7.711	0.000	73.501	0.000	143.694	143.694	33.130	0.566	0.000	1.400	144.050	0.000	0.000	0.000	0.000	23.505	22.929	0.000

Notes:

1. Assume the density of fill is 2 ton/m<sup>3</sup>.

2. Refuse disposed to NENT landfill.