

D1-7

D1-5

D1-4

D1-2

D1-1

D1-3

B3-7

B3-16

Lok Ma Chau Tunnel
Ventilation Shaft

Sewage Pumping Station

SHEUNG YUE RIVER (RIVER BEAS)

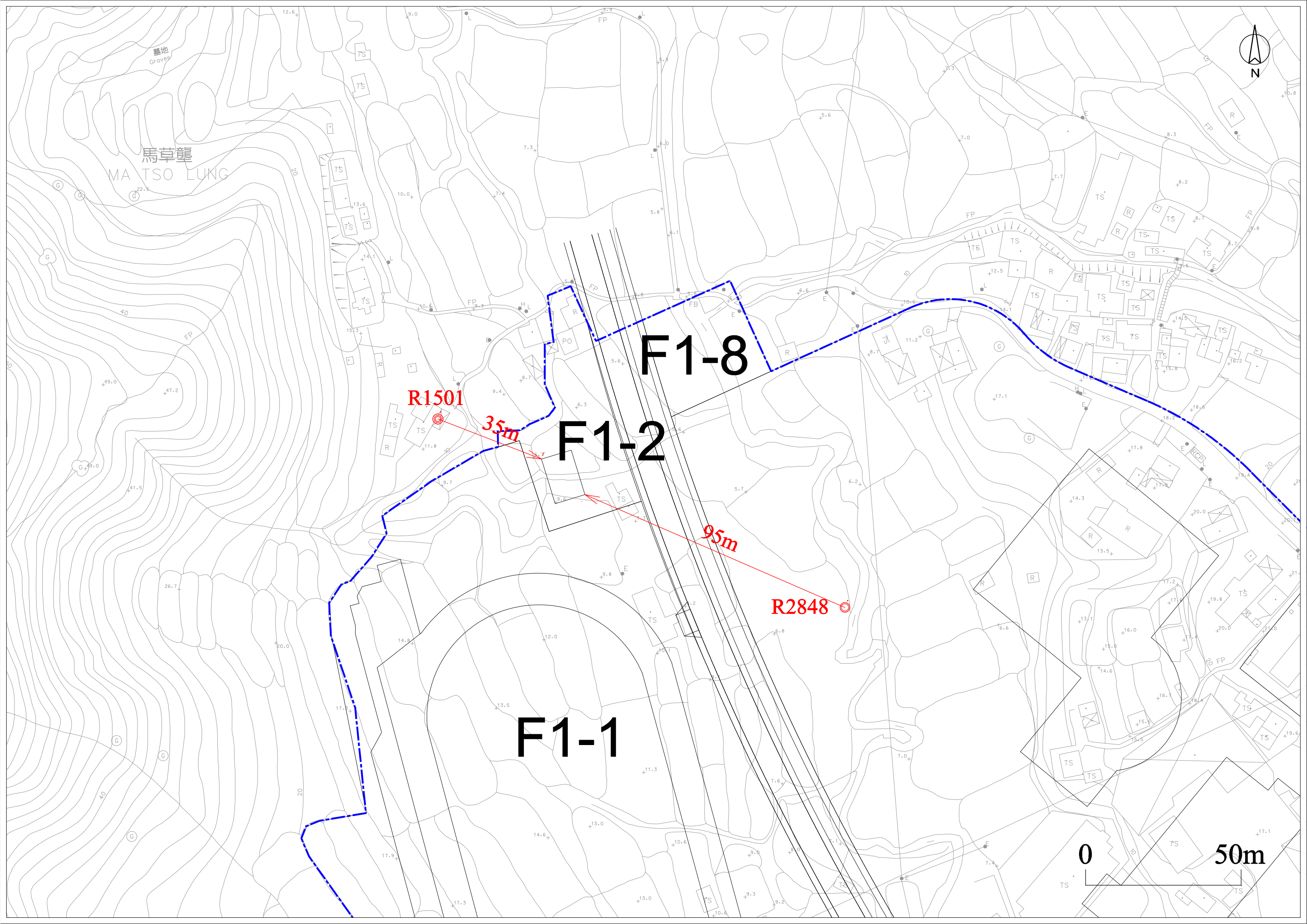

0 50m

F1-8

F1-2

F1-1

R1501

R2848

35m

95m

馬草壟
MA TSO LUNG

墓地
Graves

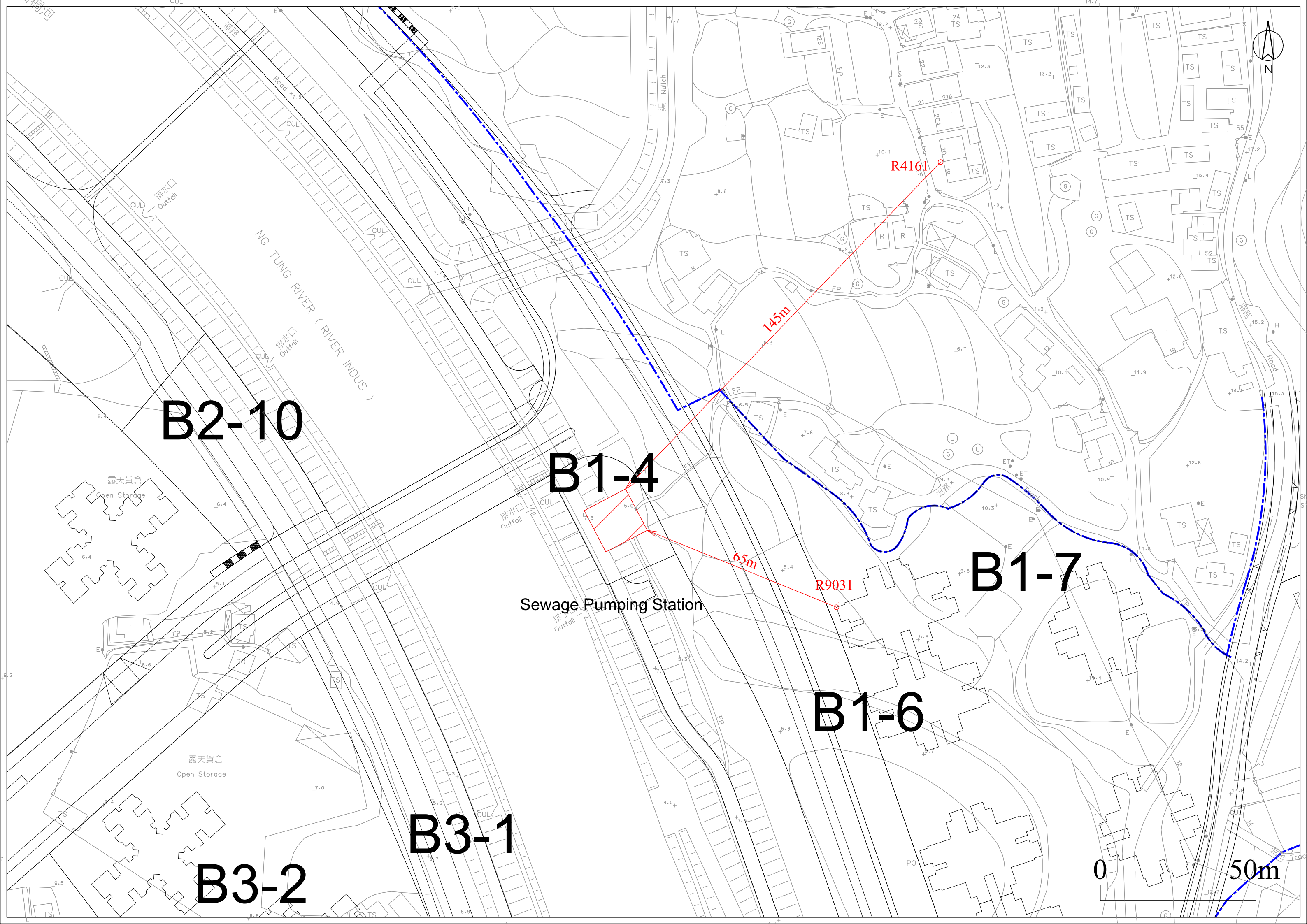

B2-10

B1-4

B1-7

B1-6

B3-1

B3-2

Sewage Pumping Station

R4161

R9031

145m

65m

50m

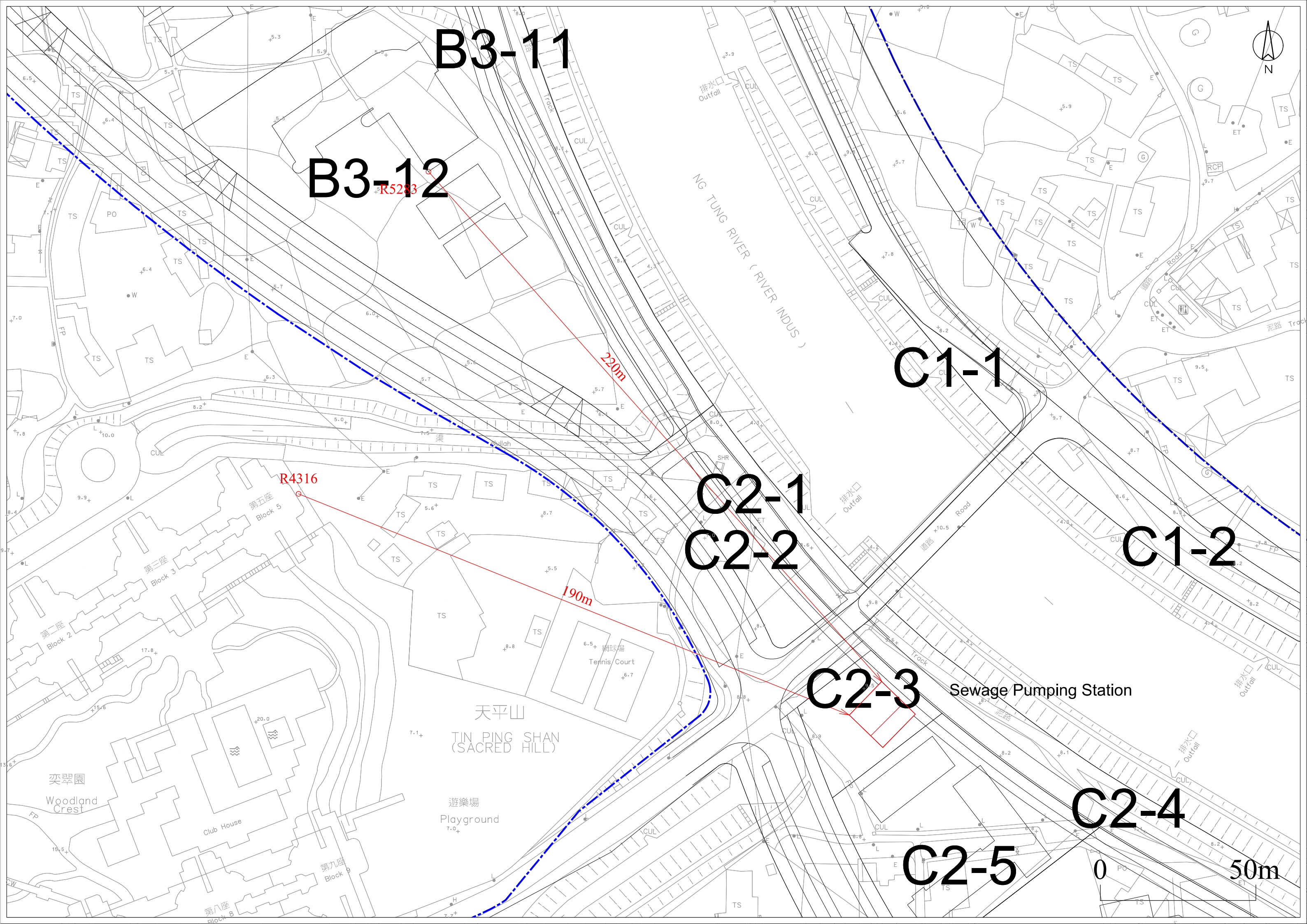

B3-11

B3-12

C1-1

C1-2

C2-1

C2-2

C2-3

C2-4

C2-5

Sewage Pumping Station

R5283

R4316

220m

190m

50m

0

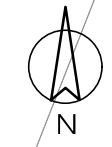

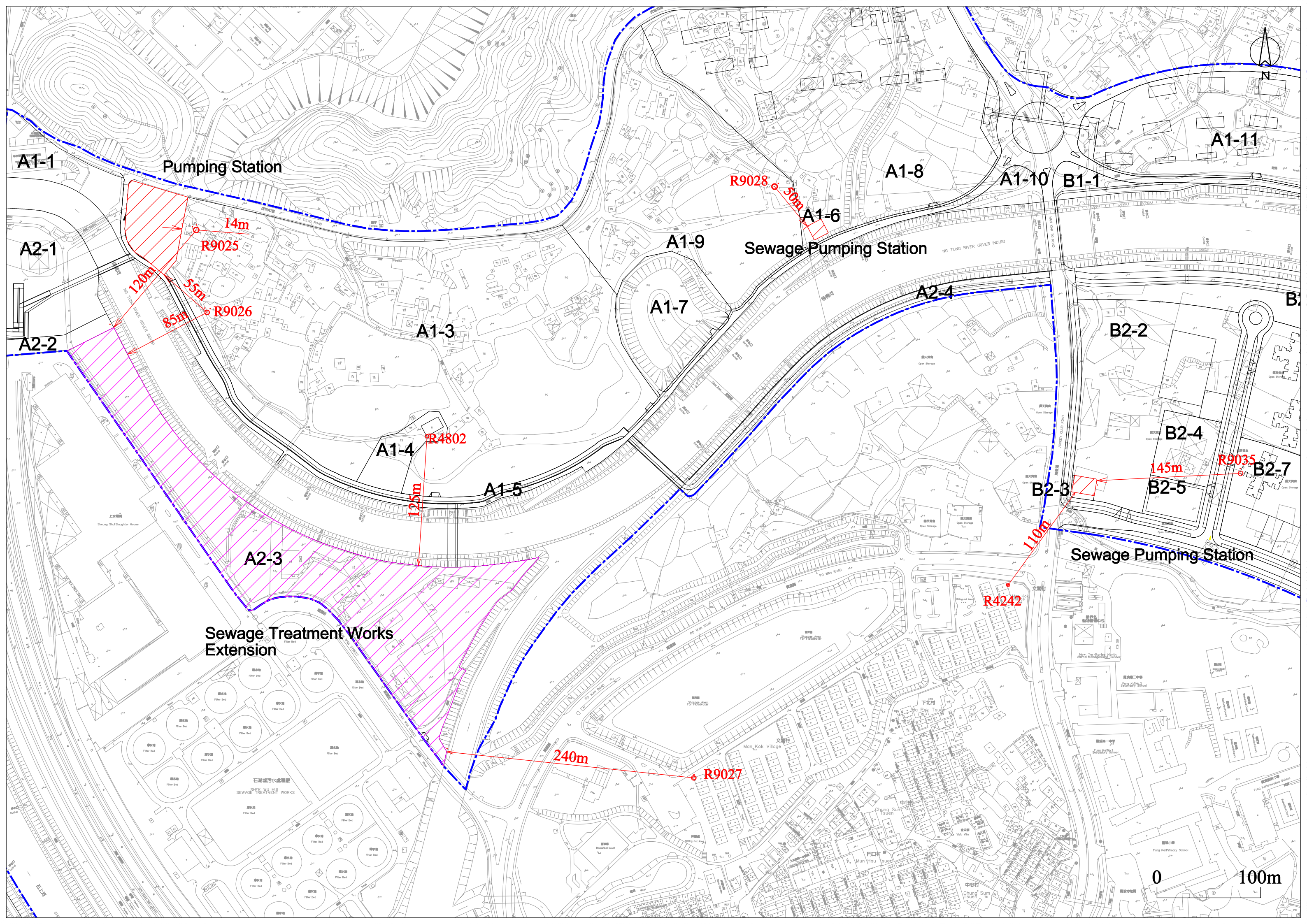

Project: 25278 Agreement No. CE61/2007 (CE) North East New Territories New Development Areas Planning and Engineering Study

Tilt: Predicted Noise Level from Sewage Pumping Station / Pumping Station (KTN D1-3, KTN F1-2, FLN A1-2, FLN A1-6, FLNB1-4, FLN B2-3, FLN C2-3)

Maximum Sound Power Level for the Sewage Pumping Station / Pumping Station

NSR	AP [1]	Noise Criteria [2], dB(A)	Distance to NSR, m	Correction, dB(A)					Maximum Allowable SWL, dB(A)
				Distance	Facade	Tonality	Screening	Cumulative Impact	
KTN D1-7	R2781	50	105	48	3	3	0	3	89
KTN D1-7	R2782	50	110	49	3	3	0	3	90
KTN D1-5	R3803	50	135	51	3	3	0	3	95
FN-10	R4161	50	145	51	3	3	0	-	95
FLN B1-7	R9031	50	65	44	3	3	0	-	88
FN-18	R4242	50	110	49	3	3	0	-	93
FLN B2-7	R9035	50	145	51	3	3	0	-	95
FN-22	R4316	50	190	54	3	3	0	-	98
FLN B3-12	R5283	50	220	55	3	3	0	-	99
FLN A1-9	R9028	50	50	42	3	3	0	-	86
FLN A1-3 [3]	R9025	45	14	31	3	3	0	3	67
FLN A1-3 [3]	R9026	45	55	43	3	3	0	3	79
KTN-45	R1501	46	35	39	3	3	0	3	76
KTN F1-3	R2848	46	95	48	3	3	0	3	85

Note:

[1] Refer to the attached drawing.

[2] Only night time criteria is assessed as worst case scenario.

[3] According to AEP-218/2005 "Expansion of Shek Wu Hui Sewage Treatment Works", the predicted noise level is 48dB(A).

Cumulative impact from planned pumping station is also included.

Cumulative impacts from Lok Ma Chau Ventilation Shaft (KTN D1-2) and Sewage Pumping Station (KTN D1-3)

Noise Source	NSR	AP	SWL, dB(A)	Distance to NSR, m	Correction, dB(A)				Predicted SPL, dB(A)	Noise Criertia,	Compliance [Y/N]
					Distance	Facade	Tonality	Screening			
KTN D1-3	KTN D1-7	R2781	89	105	-48	3	3	0	47		
KTN D1-2 [1]			83	60	-44	3	3	0	46		
Cumulative Impacts									49	50	Y
KTN D1-3	KTN D1-7	R2782	89	110	-49	3	3	0	47		
KTN D1-2 [1]			83	90	-47	3	3	0	42		
Cumulative Impacts									48	50	Y
KTN D1-3	KTN D1-5	R3803	89	135	-51	3	3	0	45		
KTN D1-2 [1]			83	90	-47	3	3	0	42		
Cumulative Impacts									47	50	Y

Note:

[1] SWL refers to Lok Ma Chau Ventilation Shaft calculation.