

NOTE:

1. COORDINATES AREA RELATED TO HONG KONG METRIC GRID (1980)
2. CONCENTRATION SHOWN IN THIS DRAWING IS IN  $\mu\text{g}/\text{m}^3$
3. THE AQO CRITERIA FOR 24-HOUR AVERAGE CONCENTRATION OF RSP AT 1.5m ABOVE GROUND IS 180  $\mu\text{g}/\text{m}^3$

LEGEND:

- SITE BOUNDARY
- AIR SENSITIVE RECEIVER
- 500m FROM SITE BOUNDARY

Rev.	Date	Description	Drawn	Checked
修訂	日期	內容摘要	繪圖	核對

Department (Project Proponent) 部門 (項目營辦人):

Food and Environmental  
Hygiene Department  
食物環境衛生署

Department (Works) 部門 (工程):

Architectural Services Department  
建築署

Lead Architect (Consultancy Agreement No. 9AX 034):  
建築顧問 (顧問合約編號 9AX 034)

P&T  
Architects and Engineers Ltd  
巴馬丹拿建築及工程師有限公司

Project Title 項目名稱  
REPROVISIONING OF FEHD SAI YEE STREET  
ENVIRONMENTAL HYGIENE  
OFFICES-CUM-VEHICLE DEPOT AT YEN MING  
ROAD, WEST KOWLOON RECLAMATION AREA  
在西九龍填海區欽明路重置食物環境衛生署  
洗衣街環境衛生辦事處暨車房

Drawing Title 圖則名稱

Contours of 24-Hour Average  
Concentration of RSP  
at 1.5m Above Ground

Drawing No. 圖則編號	Figure 4-5A			
Designed 設計	Drawn 繪圖	Checked 核對	Scale 比例	AS SHOWN
TKHO	DCYO	ICWR	JUN	2013
Approved 核准	HTMI	Status 狀態	2013	FINAL

URS  
URS Hong Kong Ltd



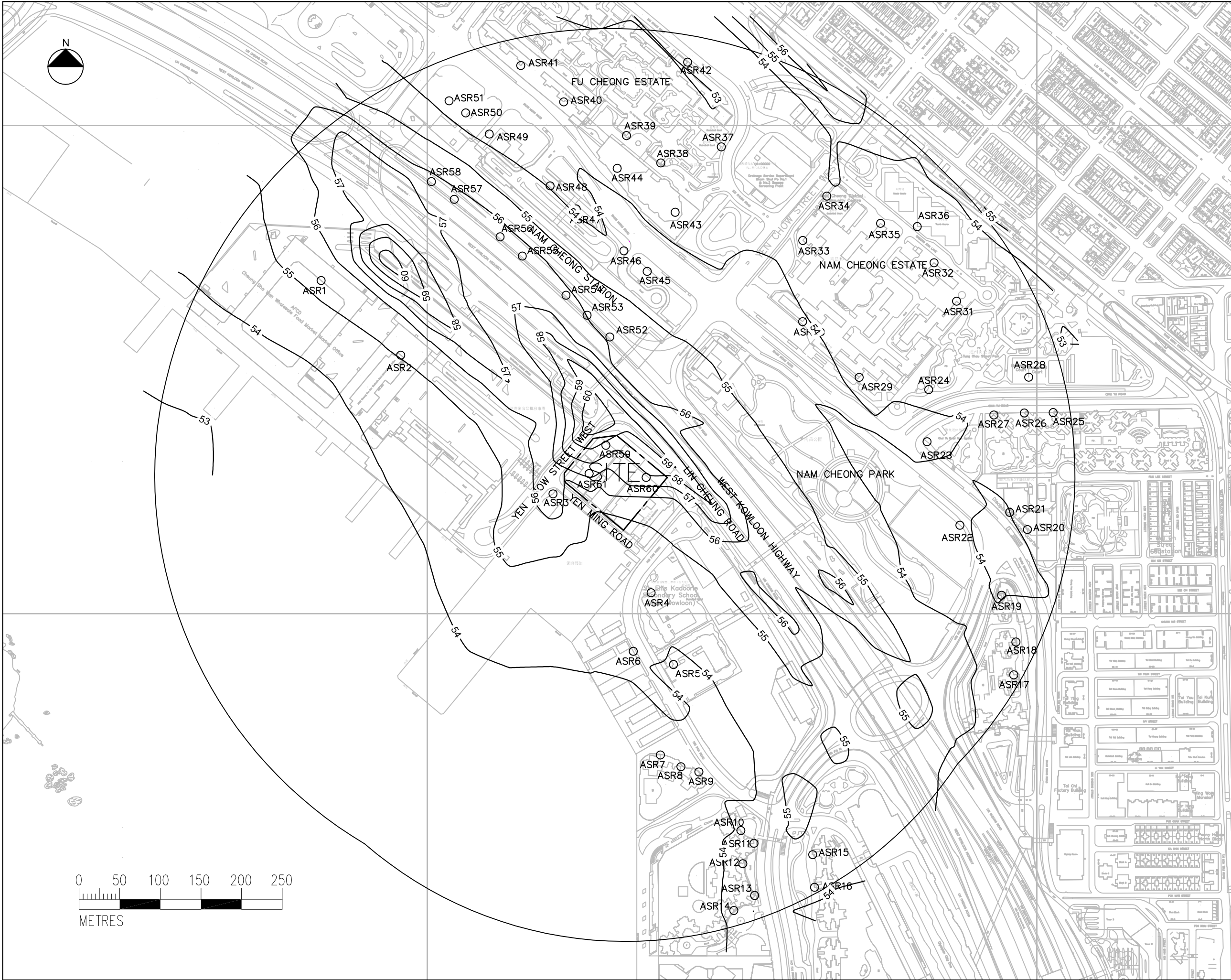

- NOTE:
1. COORDINATES AREA RELATED TO HONG KONG METRIC GRID (1980)
  2. CONCENTRATION SHOWN IN THIS DRAWING IS IN  $\mu\text{g}/\text{m}^3$
  3. THE AQO CRITERIA FOR 24-HOUR AVERAGE CONCENTRATION OF RSP AT 5m ABOVE GROUND IS  $180 \mu\text{g}/\text{m}^3$

- LEGEND:
- SITE BOUNDARY
  - AIR SENSITIVE RECEIVER
  - 500m FROM SITE BOUNDARY

Rev.	Date	Description	Drawn	Checked
01	2013	Initial Issue	DCYO	ICWR

Department (Project Proponent) 部門 (項目營辦人):

Food and Environmental Hygiene Department  
食物環境衛生署

Department (Works) 部門 (工程):

Architectural Services Department  
建築署

Lead Architect (Consultancy Agreement No. 9AX 034):  
建築顧問 (顧問合約編號 9AX 034)

P&T  
Architects and Engineers Ltd  
巴馬丹拿建築及工程師有限公司

Project Title 項目名稱  
REPROVISIONING OF FEHD SAI YEE STREET ENVIRONMENTAL HYGIENE OFFICES-CUM-VEHICLE DEPOT AT YEN MING ROAD, WEST KOWLOON RECLAMATION AREA  
在西九龍填海區欽明路重置食物環境衛生署洗衣街環境衛生辦事處暨車房

Drawing Title 圖則名稱

Contours of 24-Hour Average Concentration of RSP at 5m Above Ground

Drawing No.	Figure 4-5B
Designed	Drawn
設計 TKHO	繪圖 DCYO
Checked	ICWR
校核	校核
Approved	Date JUN
核准	日期 2013
	Status
	狀態 FINAL

URS  
URS Hong Kong Ltd



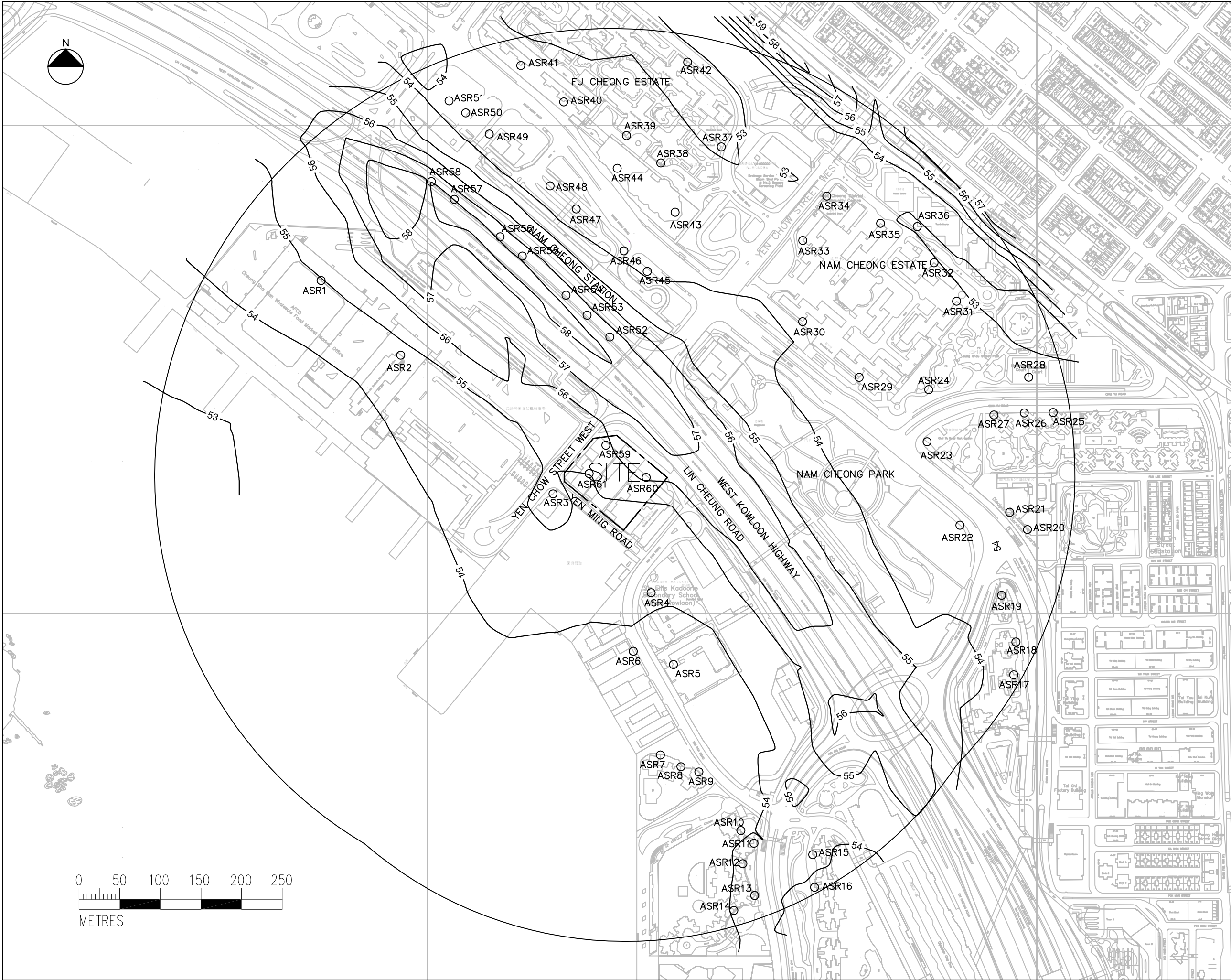

- NOTE:
1. COORDINATES AREA RELATED TO HONG KONG METRIC GRID (1980)
  2. CONCENTRATION SHOWN IN THIS DRAWING IS IN  $\mu\text{g}/\text{m}^3$
  3. THE AQO CRITERIA FOR 24-HOUR AVERAGE CONCENTRATION OF RSP AT 10m ABOVE GROUND IS  $180 \mu\text{g}/\text{m}^3$

- LEGEND:
- SITE BOUNDARY
  - AIR SENSITIVE RECEIVER
  - 500m FROM SITE BOUNDARY

Rev.	Date	Description	Drawn	Checked
01	10/06/2013	Initial Issue	DCYO	ICWR
02	10/06/2013	Revised	DCYO	ICWR
03	10/06/2013	Revised	DCYO	ICWR
04	10/06/2013	Revised	DCYO	ICWR
05	10/06/2013	Revised	DCYO	ICWR
06	10/06/2013	Revised	DCYO	ICWR
07	10/06/2013	Revised	DCYO	ICWR
08	10/06/2013	Revised	DCYO	ICWR
09	10/06/2013	Revised	DCYO	ICWR
10	10/06/2013	Revised	DCYO	ICWR
11	10/06/2013	Revised	DCYO	ICWR
12	10/06/2013	Revised	DCYO	ICWR
13	10/06/2013	Revised	DCYO	ICWR
14	10/06/2013	Revised	DCYO	ICWR
15	10/06/2013	Revised	DCYO	ICWR
16	10/06/2013	Revised	DCYO	ICWR
17	10/06/2013	Revised	DCYO	ICWR
18	10/06/2013	Revised	DCYO	ICWR
19	10/06/2013	Revised	DCYO	ICWR
20	10/06/2013	Revised	DCYO	ICWR
21	10/06/2013	Revised	DCYO	ICWR
22	10/06/2013	Revised	DCYO	ICWR
23	10/06/2013	Revised	DCYO	ICWR
24	10/06/2013	Revised	DCYO	ICWR
25	10/06/2013	Revised	DCYO	ICWR
26	10/06/2013	Revised	DCYO	ICWR
27	10/06/2013	Revised	DCYO	ICWR
28	10/06/2013	Revised	DCYO	ICWR
29	10/06/2013	Revised	DCYO	ICWR
30	10/06/2013	Revised	DCYO	ICWR
31	10/06/2013	Revised	DCYO	ICWR
32	10/06/2013	Revised	DCYO	ICWR
33	10/06/2013	Revised	DCYO	ICWR
34	10/06/2013	Revised	DCYO	ICWR
35	10/06/2013	Revised	DCYO	ICWR
36	10/06/2013	Revised	DCYO	ICWR
37	10/06/2013	Revised	DCYO	ICWR
38	10/06/2013	Revised	DCYO	ICWR
39	10/06/2013	Revised	DCYO	ICWR
40	10/06/2013	Revised	DCYO	ICWR
41	10/06/2013	Revised	DCYO	ICWR
42	10/06/2013	Revised	DCYO	ICWR
43	10/06/2013	Revised	DCYO	ICWR
44	10/06/2013	Revised	DCYO	ICWR
45	10/06/2013	Revised	DCYO	ICWR
46	10/06/2013	Revised	DCYO	ICWR
47	10/06/2013	Revised	DCYO	ICWR
48	10/06/2013	Revised	DCYO	ICWR
49	10/06/2013	Revised	DCYO	ICWR
50	10/06/2013	Revised	DCYO	ICWR
51	10/06/2013	Revised	DCYO	ICWR
52	10/06/2013	Revised	DCYO	ICWR
53	10/06/2013	Revised	DCYO	ICWR
54	10/06/2013	Revised	DCYO	ICWR
55	10/06/2013	Revised	DCYO	ICWR
56	10/06/2013	Revised	DCYO	ICWR
57	10/06/2013	Revised	DCYO	ICWR
58	10/06/2013	Revised	DCYO	ICWR
59	10/06/2013	Revised	DCYO	ICWR
60	10/06/2013	Revised	DCYO	ICWR
61	10/06/2013	Revised	DCYO	ICWR

Department (Project Proponent) 部門 (項目營辦人):

Food and Environmental Hygiene Department  
食物環境衛生署

Department (Works) 部門 (工程):

Architectural Services Department  
建築署

Lead Architect (Consultancy Agreement No. 9AX 034):  
建築顧問 (顧問合約編號 9AX 034)

P&T Architects and Engineers Ltd  
巴馬丹拿建築及工程師有限公司

Project Title 項目名稱:  
REPROVISIONING OF FEHD SAI YEE STREET ENVIRONMENTAL HYGIENE OFFICES-CUM-VEHICLE DEPOT AT YEN MING ROAD, WEST KOWLOON RECLAMATION AREA  
在西九龍填海區欽明路重置食物環境衛生署洗衣街環境衛生辦事處暨車房

Drawing Title 圖則名稱:  
Contours of 24-Hour Average Concentration of RSP at 10m Above Ground

Drawing No. 圖則編號:  
Figure 4-5C

Designed 設計	TKHO	Drawn 繪圖	DCYO	Checked 校核	ICWR	Scale 比例	AS SHOWN
Approved 校核	HTMI	Date 日期	JUN 2013	Status 狀態	FINAL		

URS URS Hong Kong Ltd



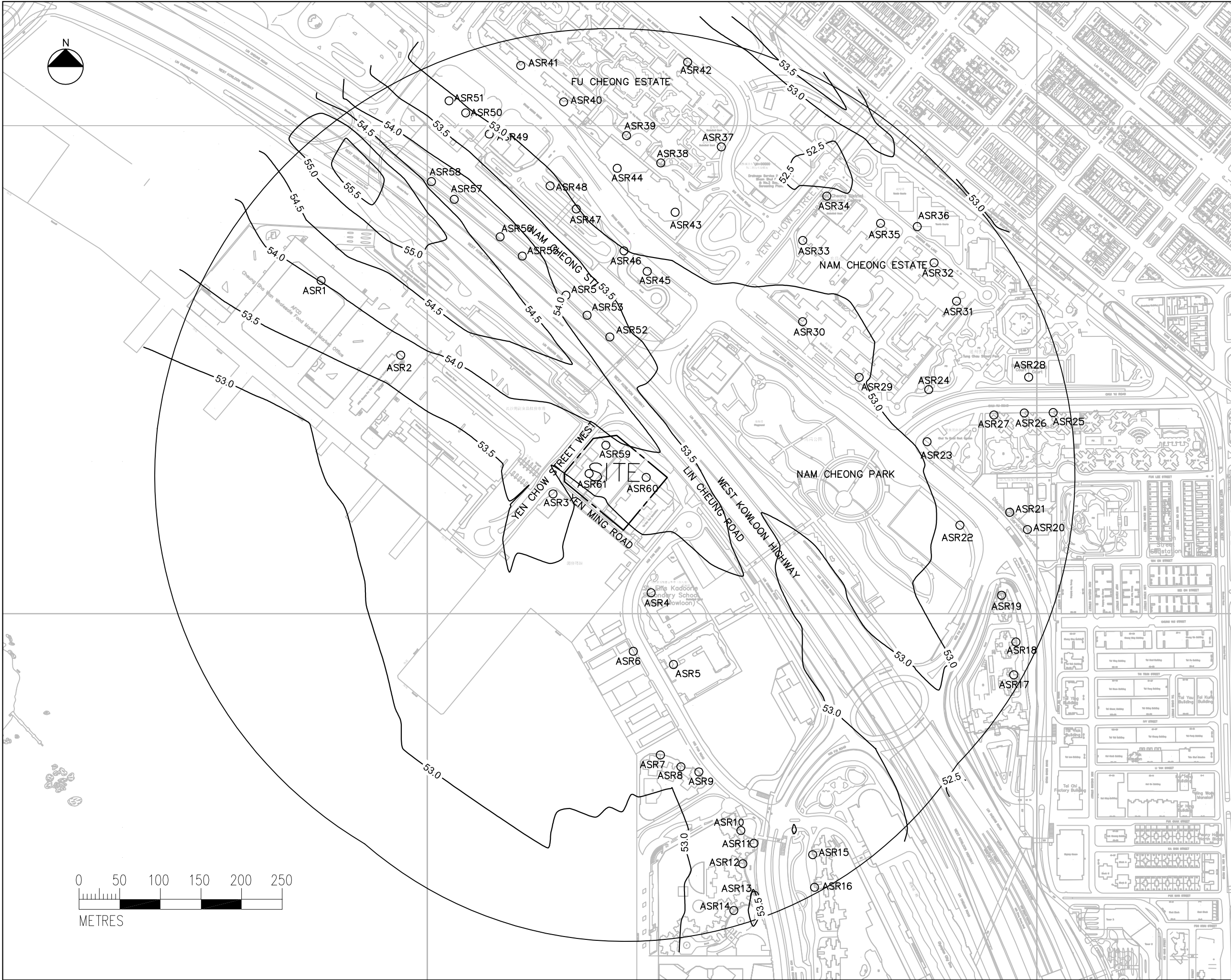

NOTE:

1. COORDINATES AREA RELATED TO HONG KONG METRIC GRID (1980)
2. CONCENTRATION SHOWN IN THIS DRAWING IS IN  $\mu\text{g}/\text{m}^3$
3. THE AQO CRITERIA FOR 24-HOUR AVERAGE CONCENTRATION OF RSP AT 20m ABOVE GROUND IS  $180 \mu\text{g}/\text{m}^3$

LEGEND:

- SITE BOUNDARY
- AIR SENSITIVE RECEIVER
- 500m FROM SITE BOUNDARY

Rev.	Date	Description	Drawn	Checked
修訂	日期	內容摘要	繪圖	校核

Department (Project Proponent) 部門 (項目倡議人):

Food and Environmental  
Hygiene Department  
食物環境衛生署

Department (Works) 部門 (工程):

Architectural Services Department  
建築署

Lead Architect (Consultancy Agreement No. 9AX 034):  
建築顧問 (顧問合約編號 9AX 034)

P&T  
Architects and Engineers Ltd  
巴馬丹拿建築及工程師有限公司

Project Title 項目名稱:  
REPROVISIONING OF FEHD SAI YEE STREET  
ENVIRONMENTAL HYGIENE  
OFFICES-CUM-VEHICLE DEPOT AT YEN MING ROAD,  
WEST KOWLOON RECLAMATION AREA  
在西九龍填海區欽明路重置食物環境衛生署  
洗衣街環境衛生辦事處處置車房

Drawing Title 圖則名稱:

Contours of 24-Hour Average  
Concentration of RSP  
at 20m Above Ground

Drawing No. 圖則編號	Figure 4-5D			
Designed 設計	TKHO	Drawn 繪圖	DCYO	Checked 校核
Approved 批准	HTMI	Date 日期	JUN 2013	Status 狀態
			AS SHOWN	FINAL

URS  
URS Hong Kong Ltd



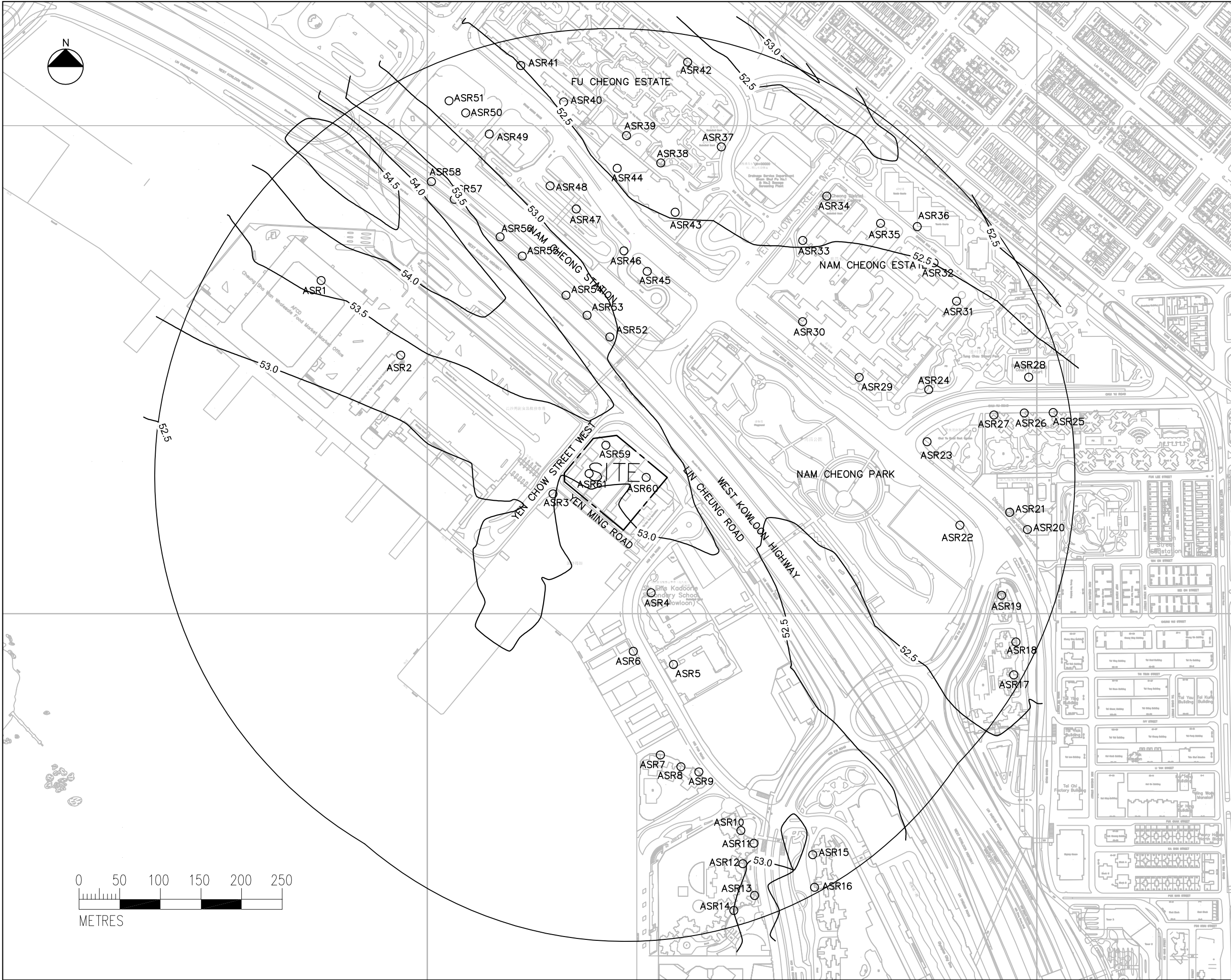

- NOTE:
1. COORDINATES AREA RELATED TO HONG KONG METRIC GRID (1980)
  2. CONCENTRATION SHOWN IN THIS DRAWING IS IN  $\mu\text{g}/\text{m}^3$
  3. THE AQO CRITERIA FOR 24-HOUR AVERAGE CONCENTRATION OF RSP AT 25m ABOVE GROUND IS  $180 \mu\text{g}/\text{m}^3$

- LEGEND:
- SITE BOUNDARY
  - AIR SENSITIVE RECEIVER
  - 500m FROM SITE BOUNDARY

Rev.	Date	Description	Drawn	Checked
01	10/06/2013	Initial Issue	JLCM	ICWR
02	10/06/2013	Revised	JLCM	ICWR
03	10/06/2013	Revised	JLCM	ICWR
04	10/06/2013	Revised	JLCM	ICWR
05	10/06/2013	Revised	JLCM	ICWR
06	10/06/2013	Revised	JLCM	ICWR
07	10/06/2013	Revised	JLCM	ICWR
08	10/06/2013	Revised	JLCM	ICWR
09	10/06/2013	Revised	JLCM	ICWR
10	10/06/2013	Revised	JLCM	ICWR
11	10/06/2013	Revised	JLCM	ICWR
12	10/06/2013	Revised	JLCM	ICWR
13	10/06/2013	Revised	JLCM	ICWR
14	10/06/2013	Revised	JLCM	ICWR
15	10/06/2013	Revised	JLCM	ICWR
16	10/06/2013	Revised	JLCM	ICWR
17	10/06/2013	Revised	JLCM	ICWR
18	10/06/2013	Revised	JLCM	ICWR
19	10/06/2013	Revised	JLCM	ICWR
20	10/06/2013	Revised	JLCM	ICWR
21	10/06/2013	Revised	JLCM	ICWR
22	10/06/2013	Revised	JLCM	ICWR
23	10/06/2013	Revised	JLCM	ICWR
24	10/06/2013	Revised	JLCM	ICWR
25	10/06/2013	Revised	JLCM	ICWR
26	10/06/2013	Revised	JLCM	ICWR
27	10/06/2013	Revised	JLCM	ICWR
28	10/06/2013	Revised	JLCM	ICWR
29	10/06/2013	Revised	JLCM	ICWR
30	10/06/2013	Revised	JLCM	ICWR
31	10/06/2013	Revised	JLCM	ICWR
32	10/06/2013	Revised	JLCM	ICWR
33	10/06/2013	Revised	JLCM	ICWR
34	10/06/2013	Revised	JLCM	ICWR
35	10/06/2013	Revised	JLCM	ICWR
36	10/06/2013	Revised	JLCM	ICWR
37	10/06/2013	Revised	JLCM	ICWR
38	10/06/2013	Revised	JLCM	ICWR
39	10/06/2013	Revised	JLCM	ICWR
40	10/06/2013	Revised	JLCM	ICWR
41	10/06/2013	Revised	JLCM	ICWR
42	10/06/2013	Revised	JLCM	ICWR
43	10/06/2013	Revised	JLCM	ICWR
44	10/06/2013	Revised	JLCM	ICWR
45	10/06/2013	Revised	JLCM	ICWR
46	10/06/2013	Revised	JLCM	ICWR
47	10/06/2013	Revised	JLCM	ICWR
48	10/06/2013	Revised	JLCM	ICWR
49	10/06/2013	Revised	JLCM	ICWR
50	10/06/2013	Revised	JLCM	ICWR
51	10/06/2013	Revised	JLCM	ICWR
52	10/06/2013	Revised	JLCM	ICWR
53	10/06/2013	Revised	JLCM	ICWR
54	10/06/2013	Revised	JLCM	ICWR
55	10/06/2013	Revised	JLCM	ICWR
56	10/06/2013	Revised	JLCM	ICWR
57	10/06/2013	Revised	JLCM	ICWR
58	10/06/2013	Revised	JLCM	ICWR
59	10/06/2013	Revised	JLCM	ICWR
60	10/06/2013	Revised	JLCM	ICWR
61	10/06/2013	Revised	JLCM	ICWR

Department (Project Proponent) 部門 (項目營辦人):

Food and Environmental Hygiene Department  
食物環境衛生署

Department (Works) 部門 (工程):

Architectural Services Department  
建築署

Lead Architect (Consultancy Agreement No. 9AX 034):  
建築顧問 (顧問合約編號 9AX 034)

P&T Architects and Engineers Ltd  
巴馬丹拿建築及工程師有限公司

Project Title 項目名稱:  
REPROVISIONING OF FEHD SAI YEE STREET ENVIRONMENTAL HYGIENE OFFICES-CUM-VEHICLE DEPOT AT YEN MING ROAD, WEST KOWLOON RECLAMATION AREA  
在西九龍填海區欽明路重置食物環境衛生署洗衣街環境衛生辦事處暨車房

Drawing Title 圖則名稱:  
Contours of 24-Hour Average Concentration of RSP at 25m Above Ground

Drawing No. 圖則編號:  
Figure 4-5E

Designed 設計	TKHO	Drawn 繪圖	JLCM	Checked 校核	ICWR	Scale 比例	AS SHOWN
Approved 校核	HTMI	Date 日期	JUN 2013	Status 狀態	FINAL		

URS URS Hong Kong Ltd



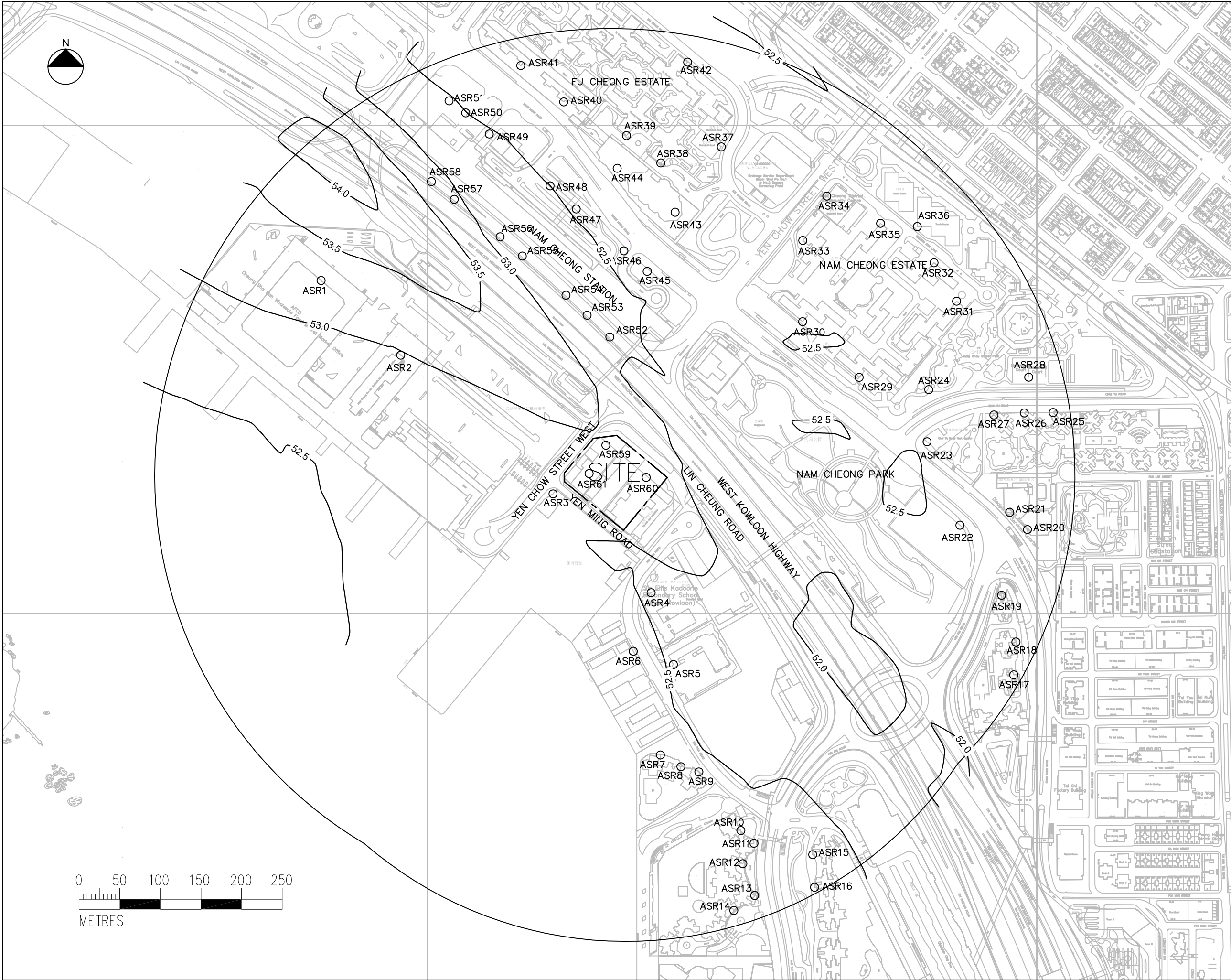

- NOTE:
1. COORDINATES AREA RELATED TO HONG KONG METRIC GRID (1980)
  2. CONCENTRATION SHOWN IN THIS DRAWING IS IN  $\mu\text{g}/\text{m}^3$
  3. THE AQO CRITERIA FOR 24-HOUR AVERAGE CONCENTRATION OF RSP AT 30m ABOVE GROUND IS  $180 \mu\text{g}/\text{m}^3$

- LEGEND:
- SITE BOUNDARY
  - AIR SENSITIVE RECEIVER
  - 500m FROM SITE BOUNDARY

Rev.	Date	Description	Drawn	Checked
01	10/06/2013	Initial Issue	JLCM	ICWR

Department (Project Proponent) 部門 (項目營辦人):

Food and Environmental Hygiene Department  
食物環境衛生署

Department (Works) 部門 (工程):

Architectural Services Department  
建築署

Lead Architect (Consultancy Agreement No. 9AX 034):  
建築顧問 (顧問合約編號 9AX 034):

P&T Architects and Engineers Ltd  
巴馬丹拿建築及工程師有限公司

Project Title 項目名稱:  
REPROVISIONING OF FEHD SAI YEE STREET ENVIRONMENTAL HYGIENE OFFICES-CUM-VEHICLE DEPOT AT YEN MING ROAD, WEST KOWLOON RECLAMATION AREA  
在西九龍填海區欽明路重置食物環境衛生署洗衣街環境衛生辦事處暨車房

Drawing Title 圖則名稱:  
Contours of 24-Hour Average Concentration of RSP at 30m Above Ground

Drawing No.	Figure 4-5F
Designed 設計 TKHO	Drawn 繪圖 JLCM
Checked 校核 ICWR	Scale 比例 AS SHOWN
Approved 核准 HTMI	Status 日期 2013 狀態 FINAL

URS URS Hong Kong Ltd